

---

**GOVERNMENT NOTICES • GOEWERMENTSKENNISGEWINGS**

---

**DEPARTMENT OF TRANSPORT**

NO. 6696

1 October 2025

**THE SOUTH AFRICAN NATIONAL ROADS  
AGENCY SOC LIMITED**Registration No: 1998/009584/30

---

**DECLARATION AMENDMENT OF NATIONAL ROAD R63 SECTION 7**

AMENDMENT OF DECLARATION No. 305 OF 2012.

By virtue of section 40(1)(b) of the South African National Roads Agency Limited and the National Roads Act 1998 (Act No. 7 of 1998), I hereby amend Declaration No. 305 of 2012 by substituting paragraph D(I) of the Schedule, being the descriptive declaration of the route from its junction with the Eastern / Western Cape Provincial Border up to its junction with National Road N9 Section 5 in Graaff-Reinette, with the accompanying sheets 1 to 16 of Plan No. P1196/20.

In the town of Graaff-Reinette the R63 Section 7 enters the town from the north and follows the street known as Stockenstroom Street and Caledon Street, at time of declaration.

**(National Road R63 Section 7: Eastern/Western Cape Provincial Boundary – Graaff-Reinette)**  
**MINISTER OF TRANSPORT**

## DEPARTEMENT VAN VERVOER

NO. 6696

1 Oktober 2025

**DIE SUID-AFRIKAANSE NASIONALE  
PADAGENTSKAP MSB BEPERK**

Registrasie No: 1998/009584/30

**VERKLARING WYSIGING VAN NASIONALE PAD R63 SEKSIE 7**

WYSIGING VAN VERKLARING No. 305 VAN 2012.

Kragtens Artikel 40(1)(b) van die Suid-Afrikaanse Nasionale Padagentskap Beperk en Nasionale Paaie Wet 1998 (Wet No. 7 van 1998), wysig ek hiermee Verklaring No. 305 van 2012 deur paragraaf D(I) van die Skedule te vervang, synde die gedeelte van die beskrywende verklaring van die pad vanaf die aansluiting met die Oos / Wes Kaap Provinsiale Grens tot by die aansluiting met Nasionale Pad N9 Seksie 5 in Graaff-Reinette, met bygaande velle 1 tot 16 van Plan No. P1196/20.

In die dorp Graaff-Reinette kom die R63 Seksie 7 die dorp binne vanuit die noorde en volg dan die strate bekend as Stockenstroomstraat en Caledonstraat, tydens datum van verklaring.

**(Nasionale Pad R63 Seksie 7: Oos/Wes Kaap Provinsiale Grens – Graaff-Reinette)**  
**MINISTER VAN VERVOER**

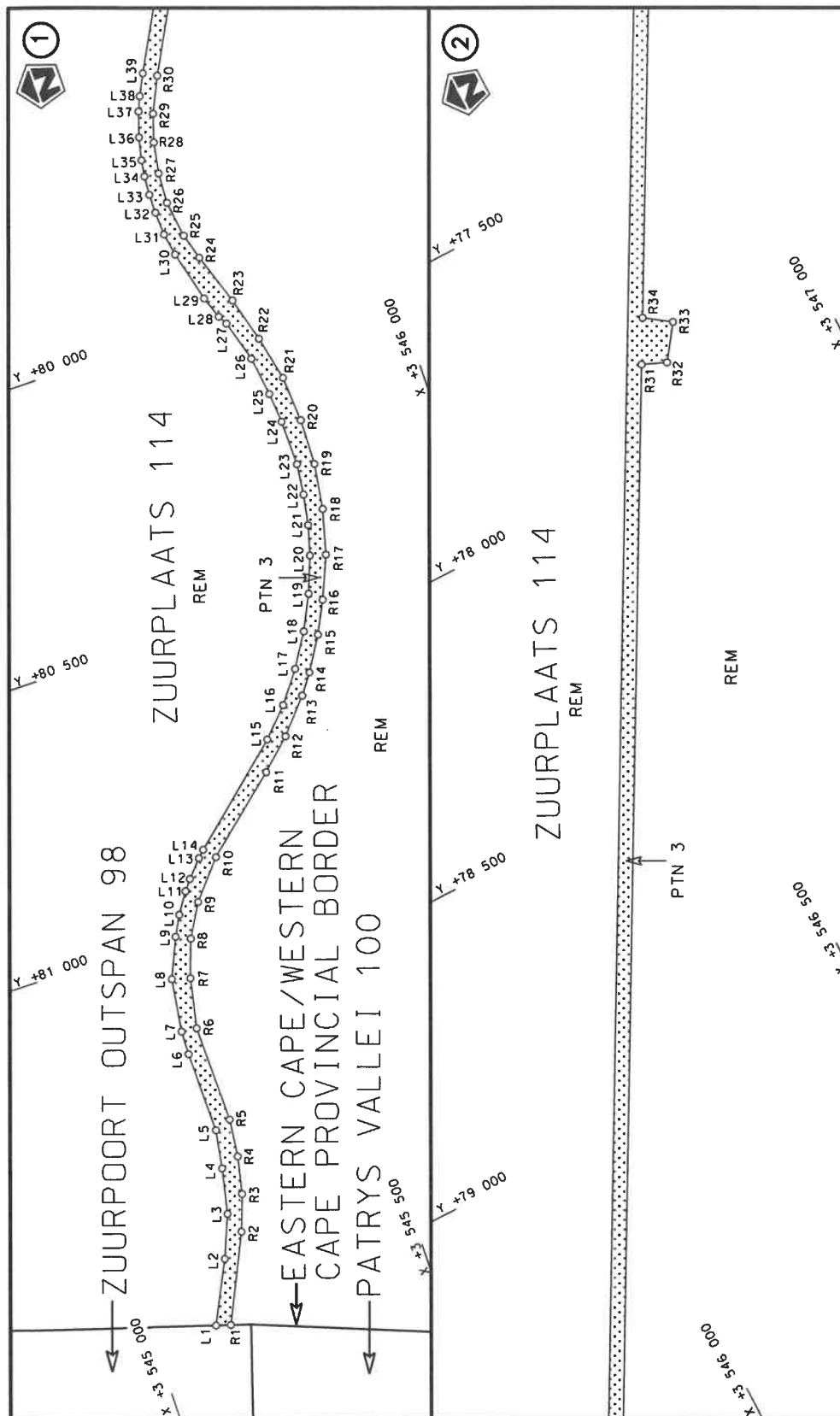

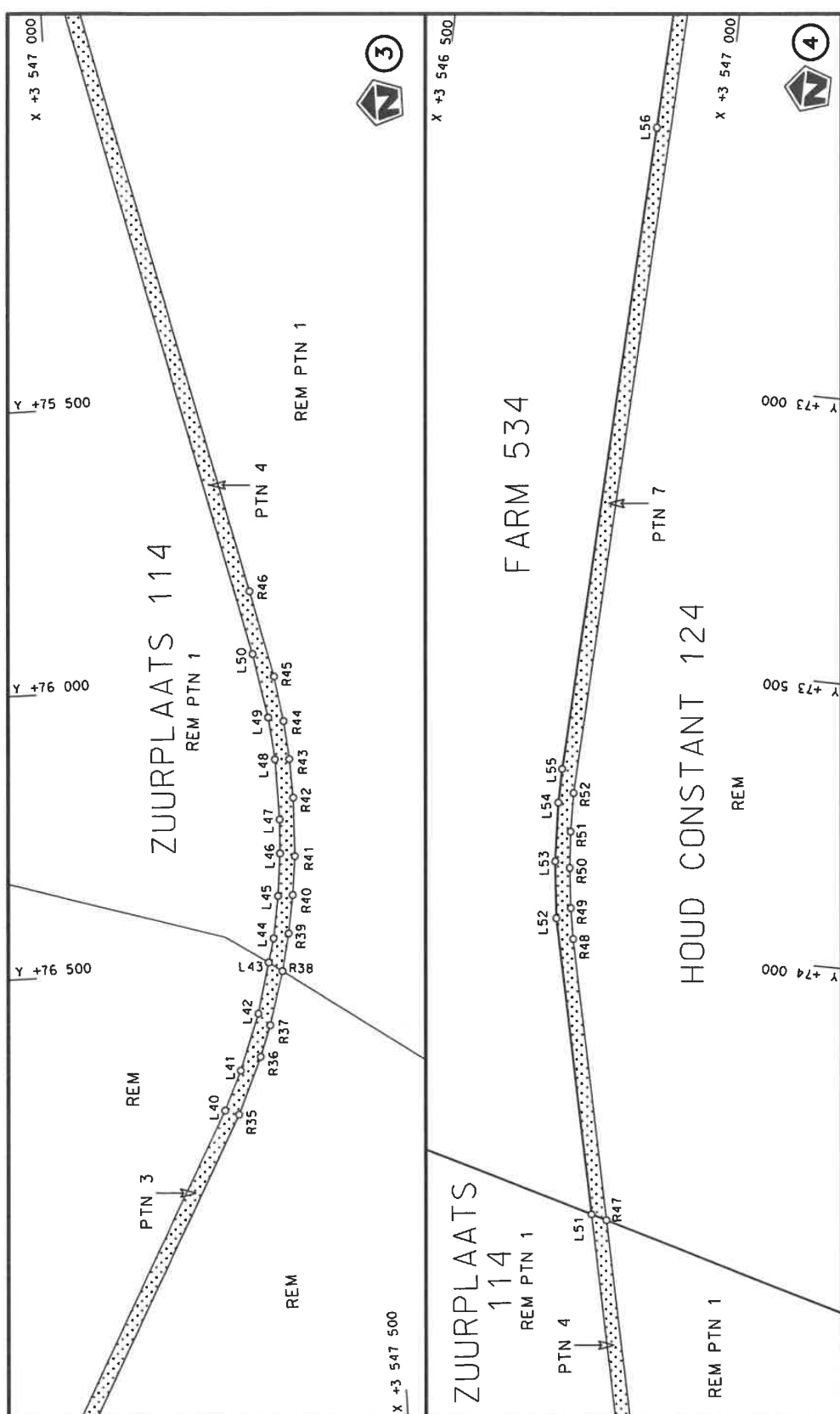

Die Suid Afrikaanse Nasionale Padagentskap MSB Bpk	Die figuur getoon		stel die podreserwe voor van 'n gedeelte represents the road reserve of a portion van Nasionale Roete R63 of National Route	Vel Sheet	1 of	16
The South African National Roads Agency SOC Ltd	The figure shown			7	Plan	P1196/20



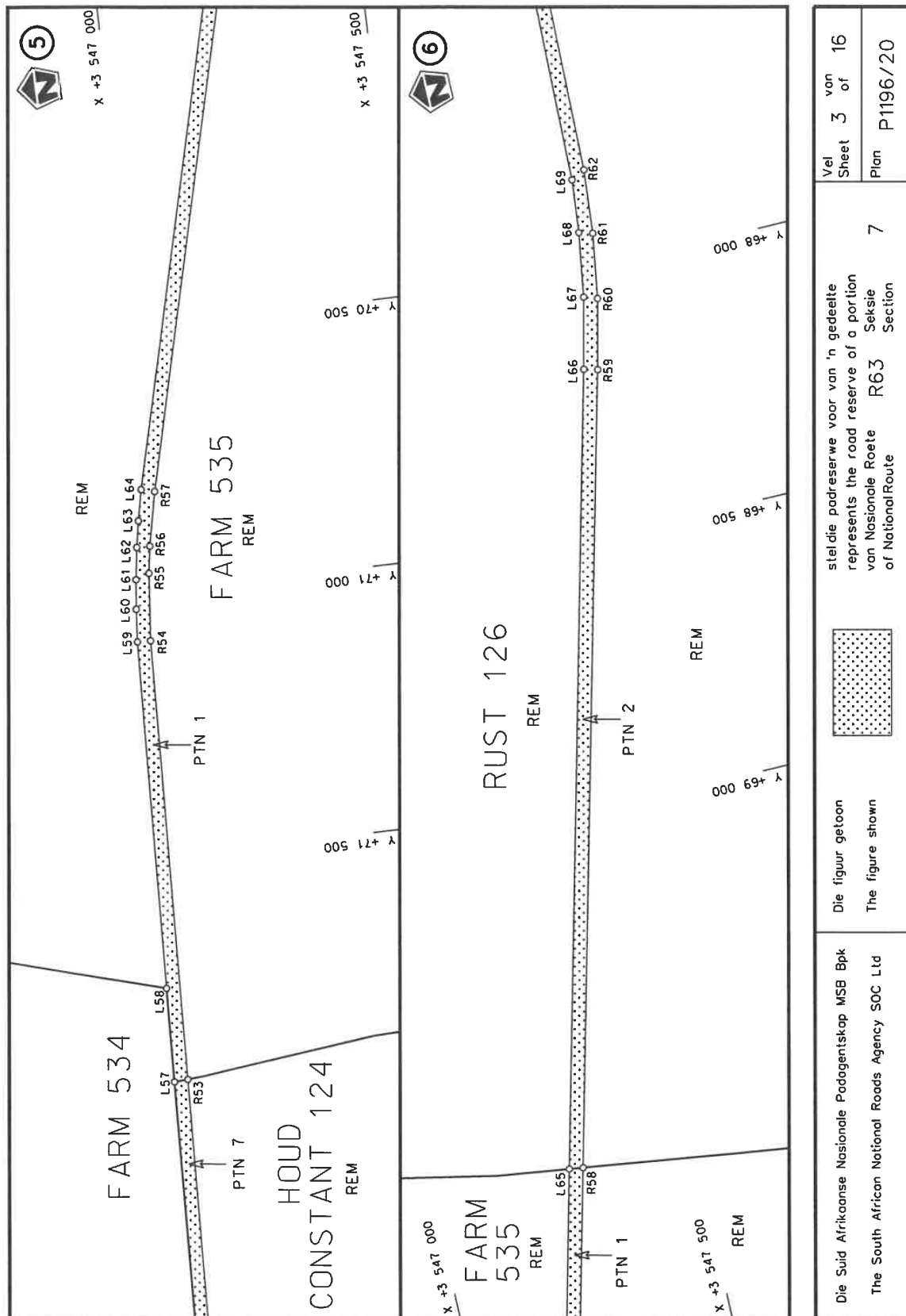

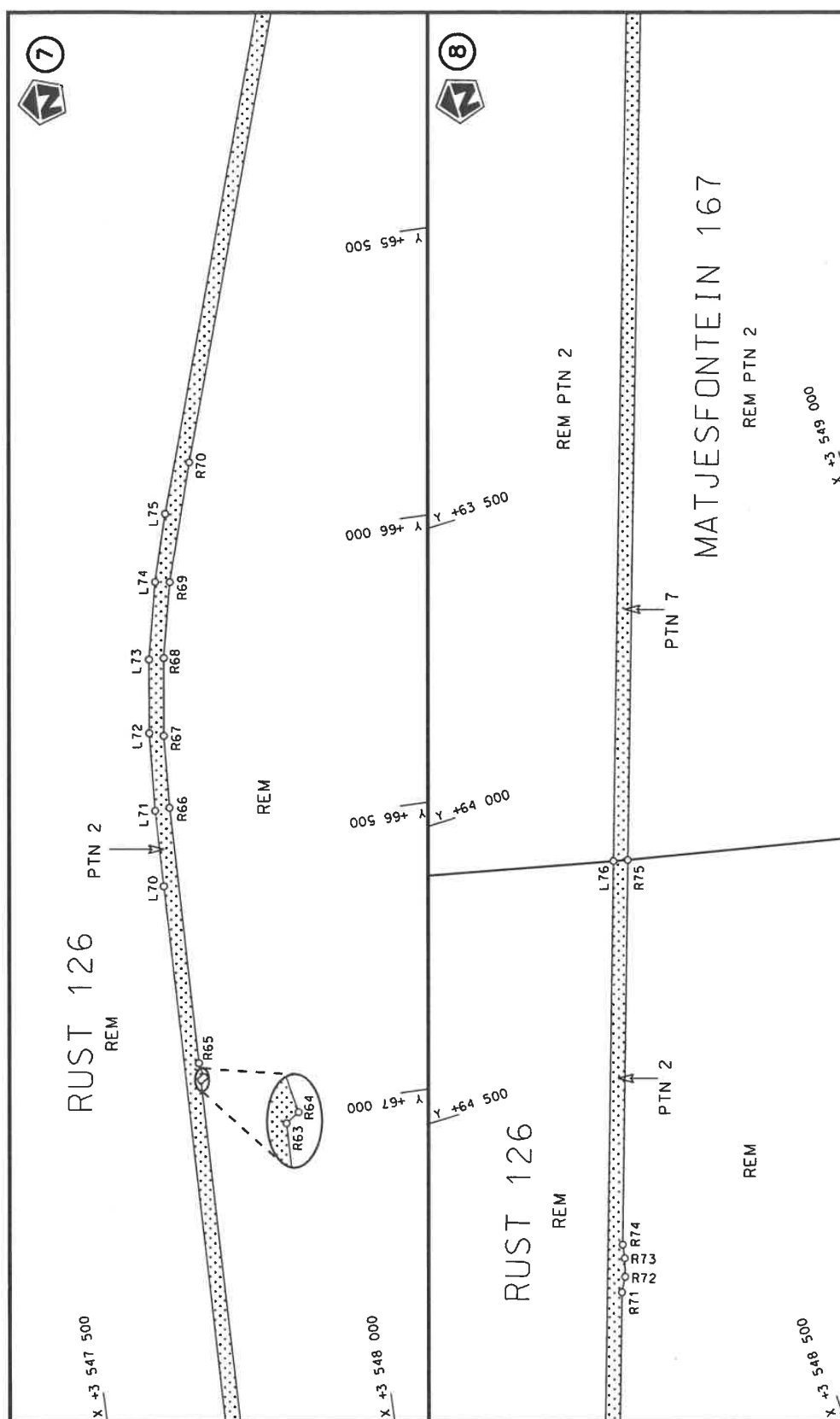
Die Suid Afrikaanse Nasionale Podogentskop MSB Bpk	Die figuur getoon		stel die padreserwe voor van 'n gedeelte represents the road reserve of a portion van Nasionale Roete R63 of National Route	Vel	2 of 16
The South African National Roads Agency SOC Ltd	The figure shown			7	Plan



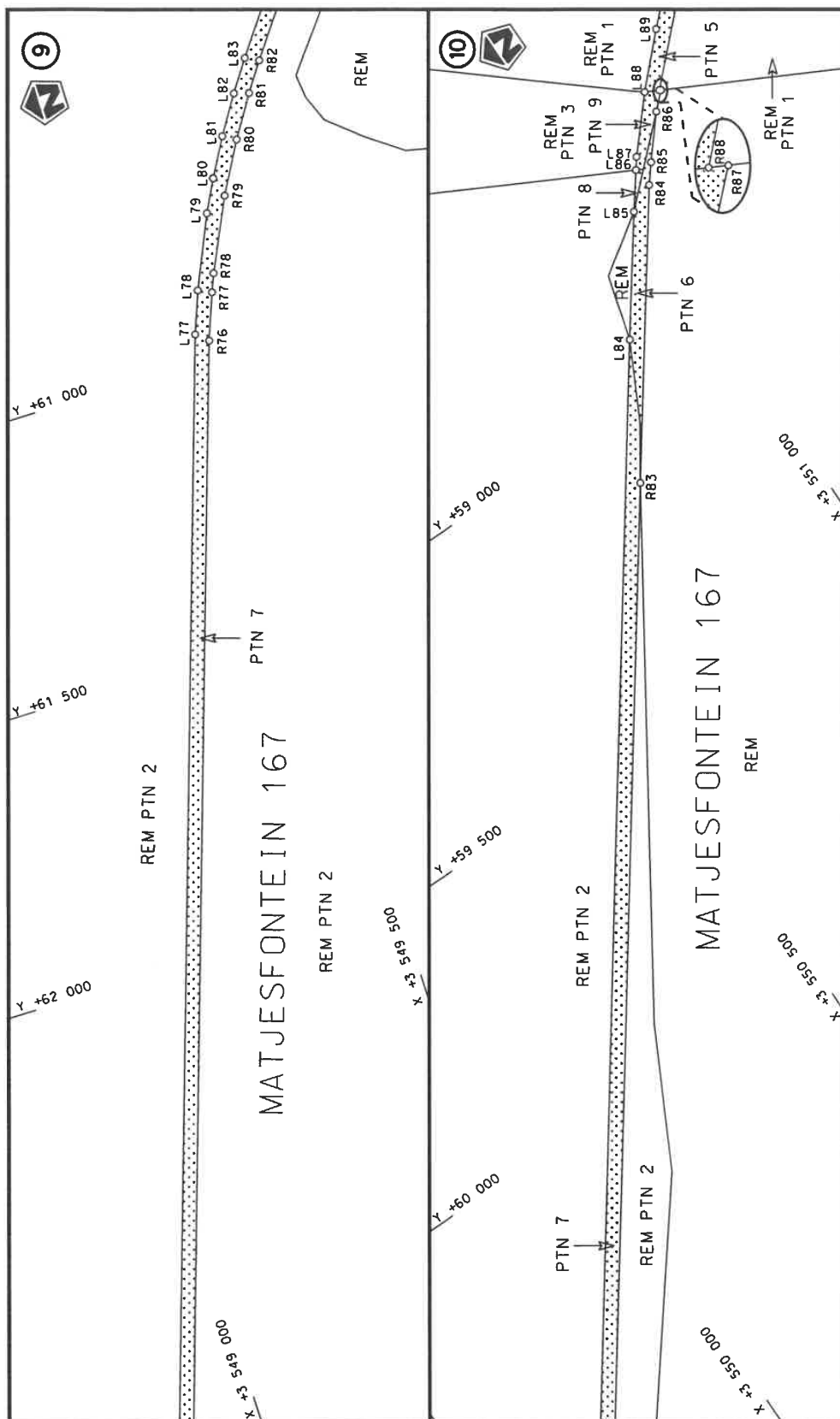

Die Suid Afrikaanse Nasionale Padagentskap MSB Bpk	Die figuur getoon		stel die padreserwe voor van 'n gedeelte represents the road reserve of a portion van Nasionale Roete R63 of National Route	Vel	4	van	16
The South African National Roads Agency SOC Ltd	The figure shown			7	Plan	P1196/20	



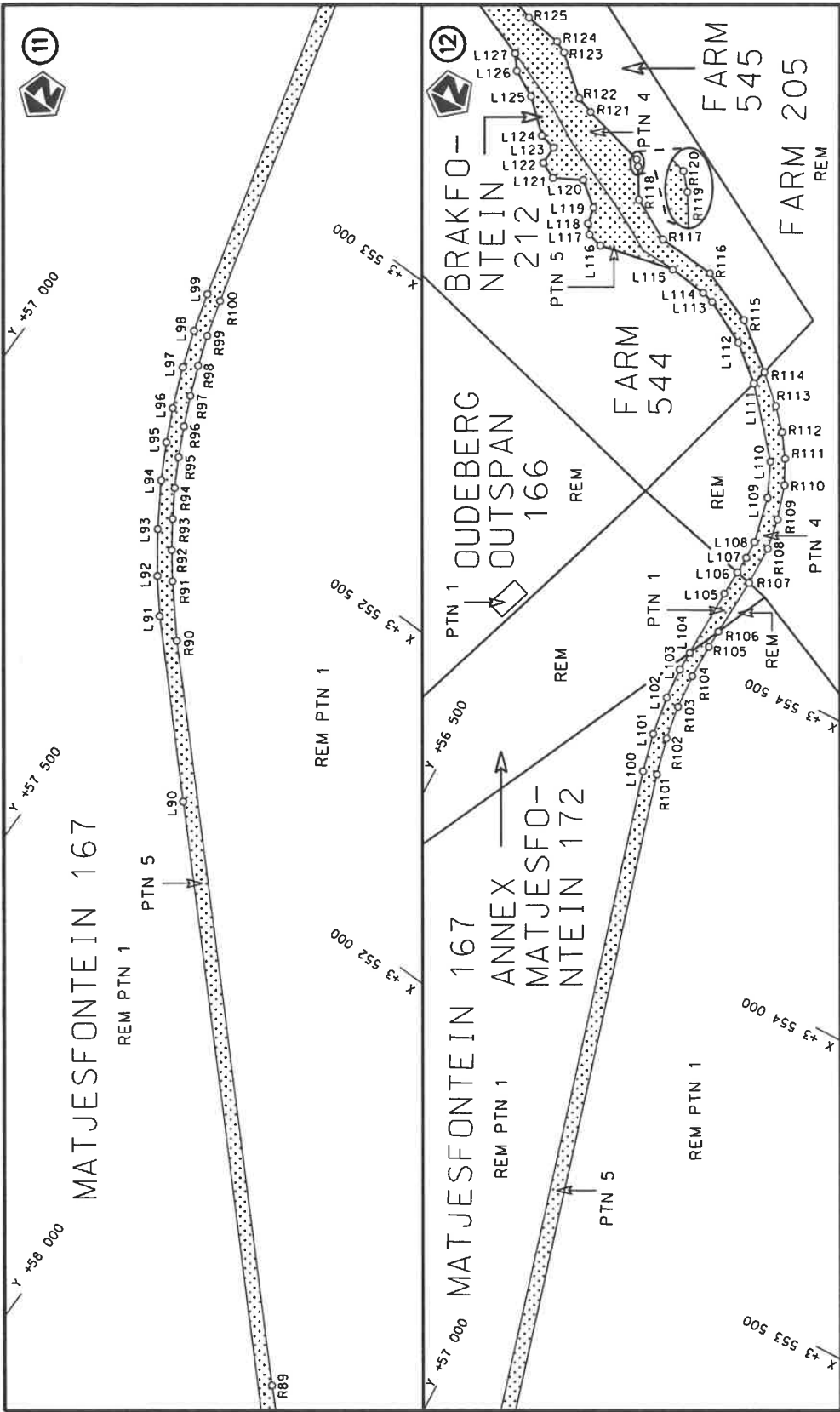

Die Suid Afrikaanse Nasionale Padagentskap MSB Bpk	Die figuur getoon		steldie padreserwe voor van 'n gedeelte represents the road reserve of a portion van Nasionale Roete R63 of National Route	Vel Sheet	5 of	16
The South African National Roads Agency SOC Ltd	The figure shown			7	Plan	P1196/20

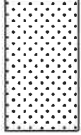

Die Suid Afrikaanse Nasionale Padagentskap MSB Bpk The South African National Roads Agency SOC Ltd	Die figuur getoon The figure shown		steldie podreserwe voor van 'n gedeelte represents the road reserve of a portion van Nasionale Roete R63 of National Route	7 Seksie Section	Vel Sheet	van of	16
					Plan	P1196/20	

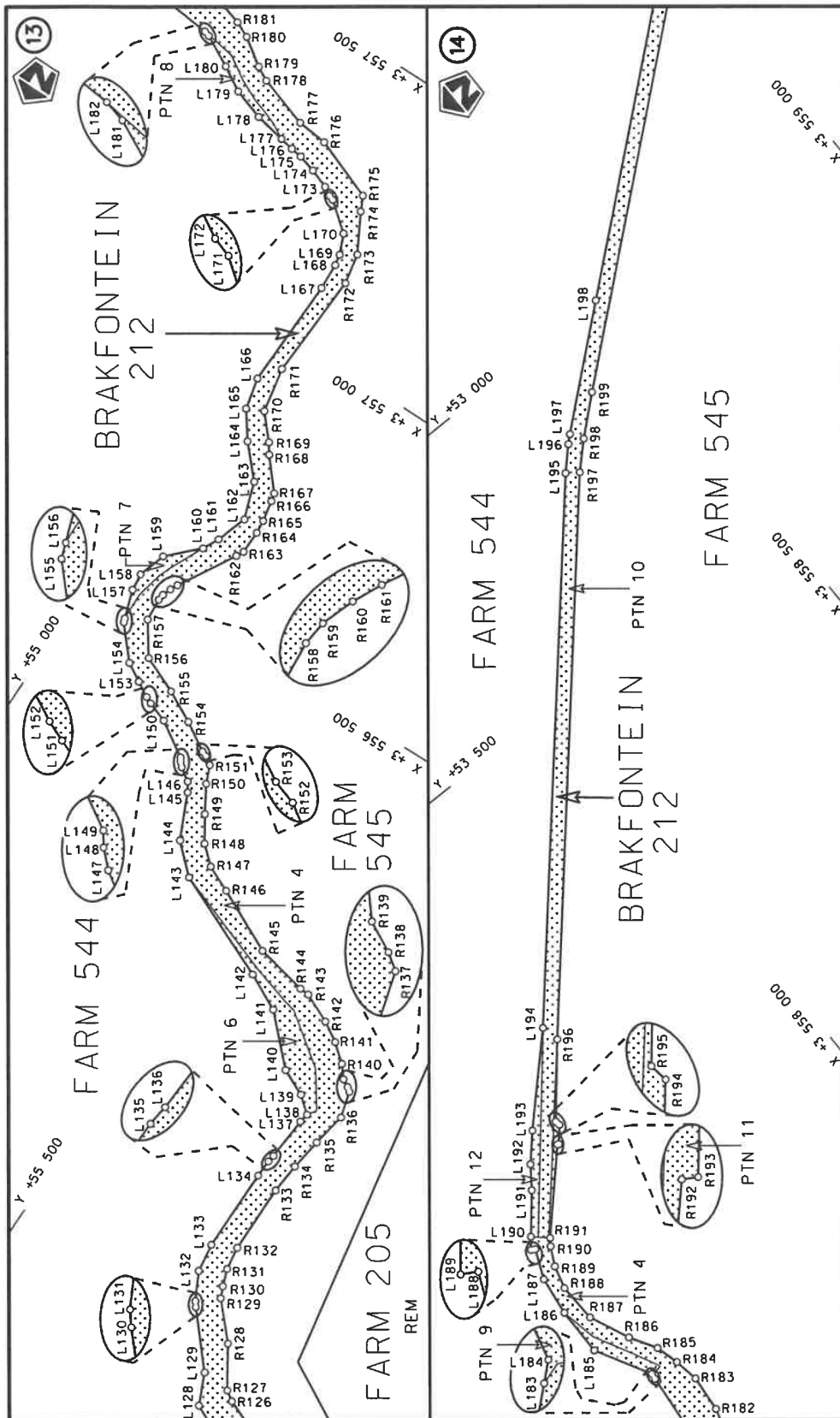



Die Suid Afrikaanse Nasionale Padagentskap MSB Bpk The South African National Roads Agency SOC Ltd	Die figuur getoon The figure shown		stel die padreserwe voor van 'n gedeelte represents the road reserve of a portion van Nasionale Roete R63 of National Route Section	Vel Sheet 7 van of 16	Plan P1196/20
---	---------------------------------------	---	--	--------------------------------------	------------------

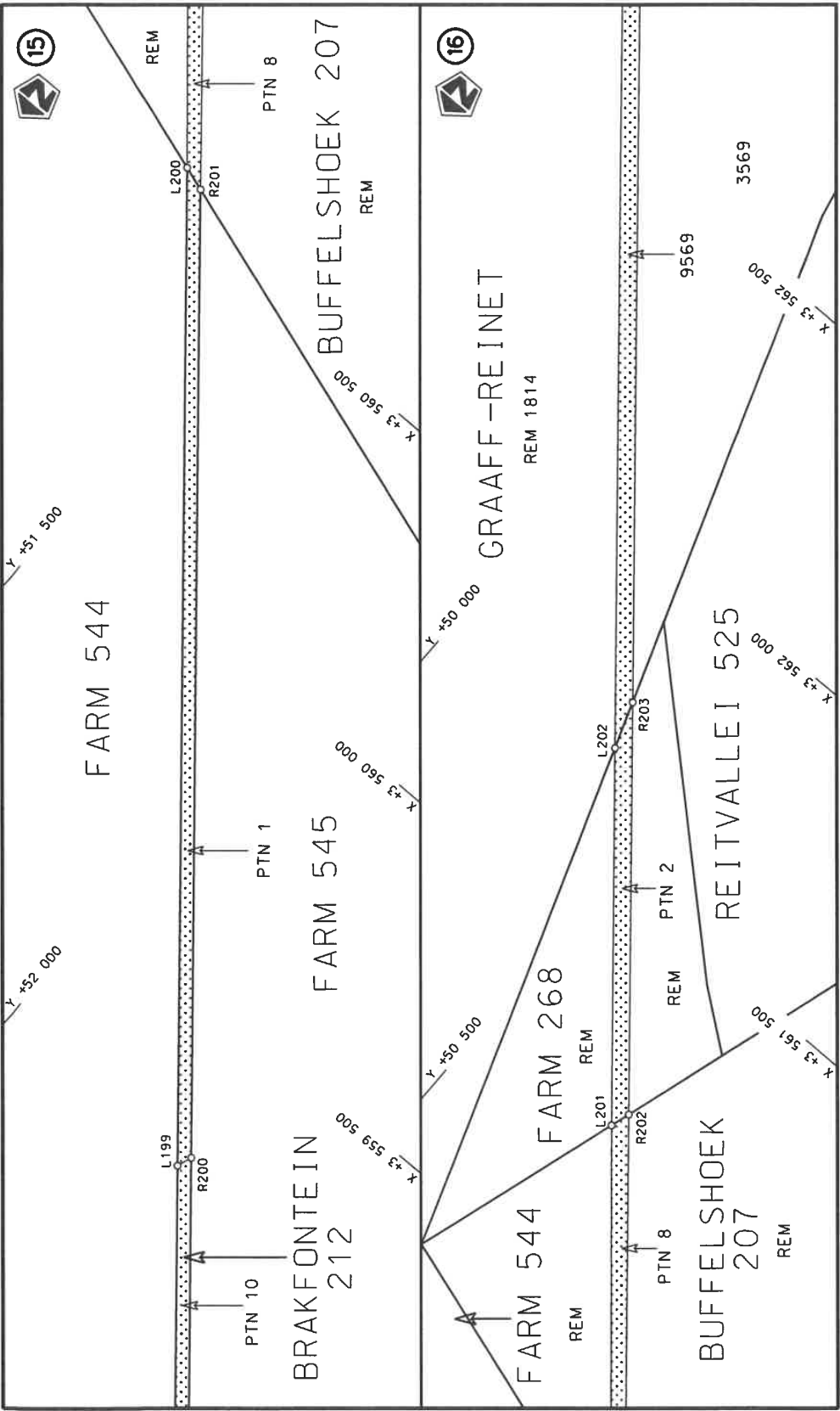

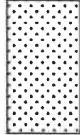

Die Suid Afrikaanse Nasionale Padagentskap MSB Bpk The South African National Roads Agency SOC Ltd	Die figuur getoon The figure shown		steldie padreserwe voor van 'n gedeelte represents the road reserve of a portion van Nasionale Roete R63 of National Route	7
			Vel Sheet 8 of 16	Plan P1196/20

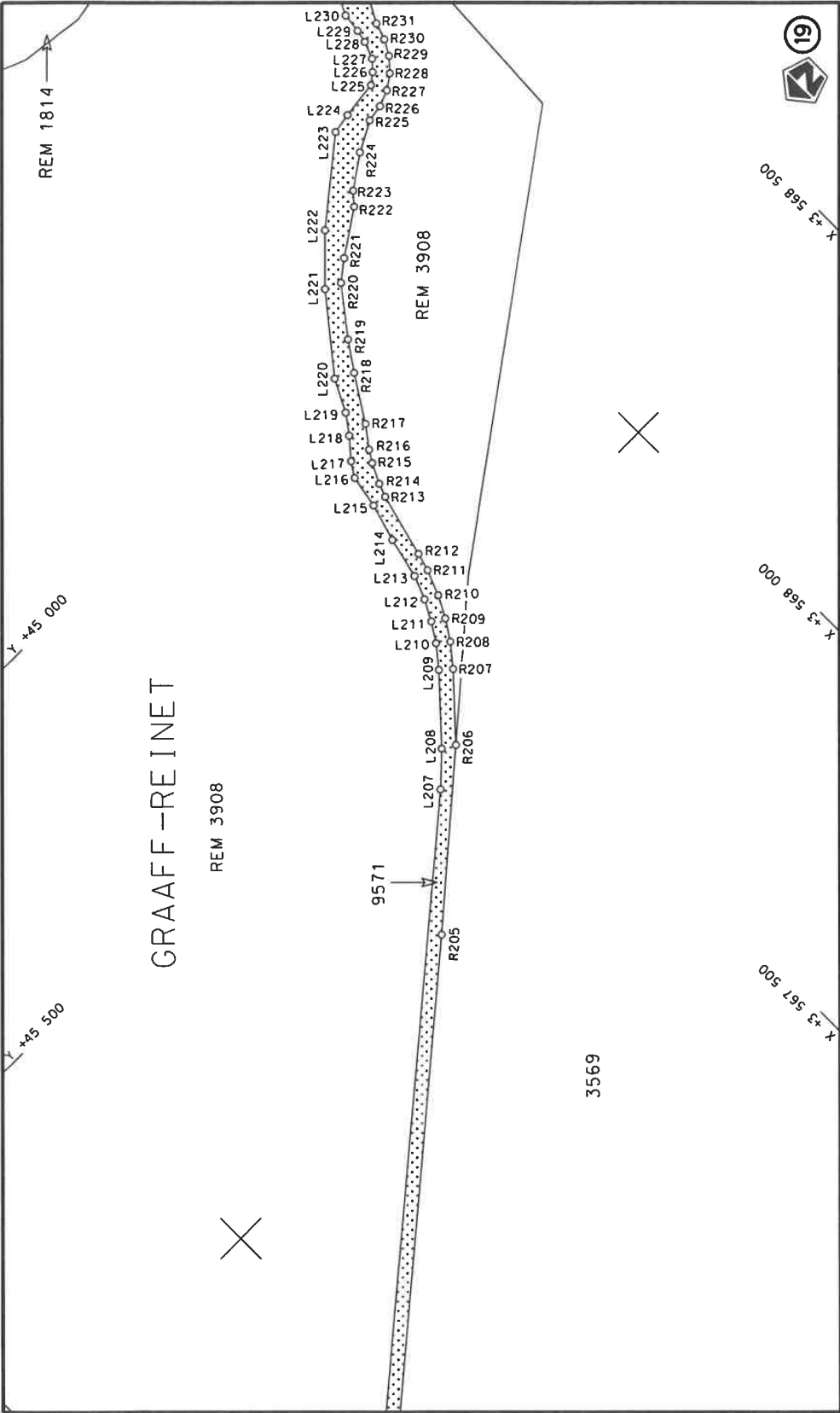

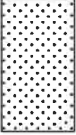

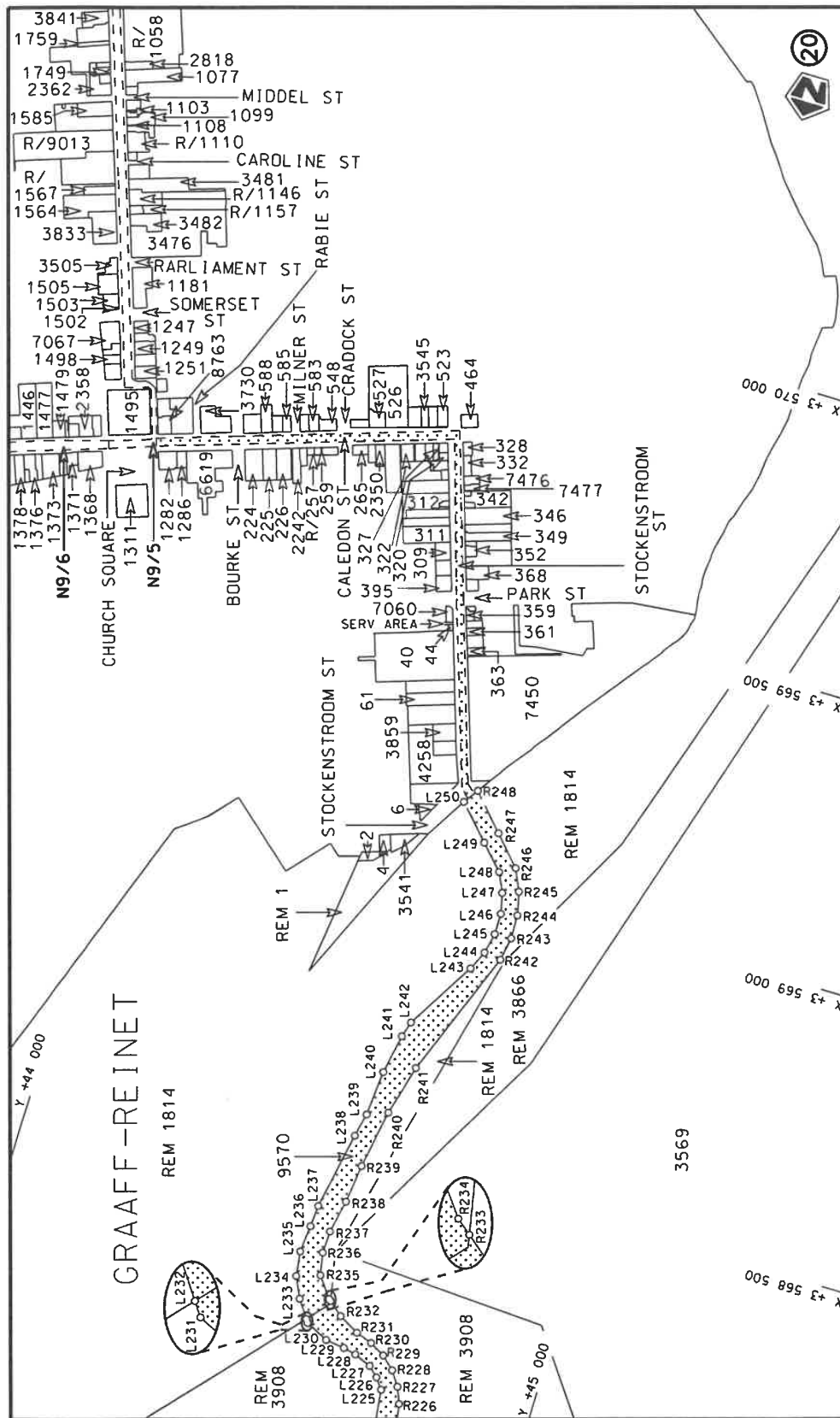
Die Suid Afrikaanse Nasionale Padagentenskap MSB Bpk The South African National Roads Agency SOC Ltd	Die figuur getoon The figure shown		stel die padreserwe voor van 'n gedeelte represents the road reserve of a portion van Nasionale Roete R63 of National Route	7	Vel Sheet	van of	16
					Plan	P1196/20	



Vel Sheet	11 of 16
Plan	P1196/20
Die Suid Afrikaanse Nasionale Padagentskap MSB Bpk The South African National Roads Agency SOC Ltd	<p>steldie padreserwe voor van 'n gedeelte represents the road reserve of a portion van Nasionale Roete R63 Sektie of National Route Section</p>
Die figuur getoon The figure shown	

PADRESERWE KOÖRDINATE / ROAD RESERVE CO-ORDINATES							
LINKERKANT/LEFT HAND SIDE				REGTERKANT/RIGHT HAND SIDE			
	Y	X	WG 25°		Y	X	
L1	81 672.06	3 545 112.26		R1	81 679.83	3 545 137.09	
L2	81 566.33	3 545 164.89		R2	81 530.62	3 545 208.52	
L3	81 493.13	3 545 195.17		R3	81 468.29	3 545 231.07	
L4	81 414.36	3 545 212.27		R4	81 403.39	3 545 245.24	
L5	81 347.24	3 545 223.96		R5	81 337.33	3 545 252.75	
L6	81 205.42	3 545 222.40		R6	81 166.62	3 545 250.57	
L7	81 164.15	3 545 224.03		R7	81 080.02	3 545 268.94	
L8	81 071.31	3 545 237.71		R8	81 014.58	3 545 292.24	
L9	81 002.79	3 545 268.34		R9	80 957.63	3 545 325.48	
L10	80 968.39	3 545 287.07		R10	80 893.26	3 545 380.37	
L11	80 932.67	3 545 310.89		R11	80 780.78	3 545 512.75	
L12	80 914.82	3 545 324.91		R12	80 732.10	3 545 565.23	
L13	80 885.33	3 545 351.64		R13	80 674.10	3 545 616.16	
L14	80 873.83	3 545 363.57		R14	80 639.57	3 545 641.23	
L15	80 727.24	3 545 533.20		R15	80 581.67	3 545 677.17	
L16	80 678.98	3 545 579.26		R16	80 526.51	3 545 704.87	
L17	80 625.73	3 545 619.92		R17	80 453.50	3 545 736.04	
L18	80 568.35	3 545 655.62		R18	80 375.88	3 545 756.85	
L19	80 508.43	3 545 685.09		R19	80 296.49	3 545 768.91	
L20	80 445.84	3 545 708.84		R20	80 216.19	3 545 771.16	
L21	80 394.16	3 545 723.17		R21	80 135.76	3 545 765.87	
L22	80 341.10	3 545 733.33		R22	80 057.08	3 545 748.07	
L23	80 286.96	3 545 739.75		R23	79 978.62	3 545 725.79	
L24	80 207.73	3 545 738.47		R24	79 888.56	3 545 695.33	
L25	80 154.80	3 545 733.92		R25	79 843.71	3 545 682.21	
L26	80 085.94	3 545 724.12		R26	79 779.55	3 545 672.98	
L27	80 013.49	3 545 702.64		R27	79 725.99	3 545 675.75	
L28	79 997.66	3 545 693.82		R28	79 671.95	3 545 685.46	
L29	79 958.99	3 545 680.00		R29	79 623.73	3 545 700.47	
L30	79 869.92	3 545 657.08		R30	79 563.36	3 545 728.73	
L31	79 830.22	3 545 649.96		R31	77 829.50	3 546 660.43	
L32	79 789.16	3 545 648.03		R32	77 846.66	3 546 701.44	
L33	79 756.19	3 545 648.39		R33	77 788.30	3 546 743.04	
L34	79 722.82	3 545 650.65		R34	77 757.51	3 546 699.20	
L35	79 694.51	3 545 654.95		R35	76 760.84	3 547 234.36	
L36	79 655.20	3 545 663.81		R36	76 661.02	3 547 278.77	
L37	79 611.81	3 545 677.78		R37	76 606.33	3 547 298.67	
L38	79 587.16	3 545 688.37		R38	76 511.98	3 547 326.21	
L39	79 550.92	3 545 706.52		R39	76 446.03	3 547 340.81	
L40	76 752.28	3 547 210.33		R40	76 378.78	3 547 351.98	
L41	76 683.38	3 547 241.93		R41	76 310.73	3 547 359.84	
L42	76 584.53	3 547 279.07		R42	76 207.18	3 547 363.17	
L43	76 495.28	3 547 302.62		R43	76 138.66	3 547 360.26	
L44	76 453.30	3 547 313.69		R44	76 071.10	3 547 354.17	
L45	76 378.98	3 547 326.29		R45	75 991.33	3 547 341.83	
L46	76 304.02	3 547 334.14		R46	75 838.61	3 547 307.44	
L47	76 244.11	3 547 336.99		R47	74 487.48	3 546 995.36	
L48	76 137.59	3 547 334.82		R48	73 999.29	3 546 883.39	
L49	76 062.88	3 547 327.40		R49	73 945.56	3 546 873.26	
L50	75 949.49	3 547 306.47		R50	73 875.03	3 546 863.55	
L51	74 479.94	3 546 967.77		R51	73 811.12	3 546 858.35	
				Vel Sheet	12	Van of 16	P1196/20



PADRESERVE KOÖRDINATE / ROAD RESERVE CO-ORDINATES									
LINKERKANT/LEFT HAND SIDE					REGTERKANT/RIGHT HAND SIDE				
	Y		X	WG 25°		Y		X	
L52	73 966.12	3	546 849.89		R52	73 742.74	3	546 856.30	
L53	73 866.47	3	546 837.07		R53	71 921.55	3	546 924.01	
L54	73 762.56	3	546 831.37		R54	71 089.53	3	546 955.62	
L55	73 702.69	3	546 831.52		R55	70 962.54	3	546 968.09	
L56	72 559.47	3	546 875.47		R56	70 911.67	3	546 975.98	
L57	71 923.28	3	546 898.63		R57	70 810.36	3	546 997.35	
L58	71 745.67	3	546 905.13		R58	69 653.74	3	547 291.10	
L59	71 088.63	3	546 930.69		R59	68 190.72	3	547 662.68	
L60	71 027.16	3	546 935.86		R60	68 059.79	3	547 693.03	
L61	70 971.68	3	546 942.36		R61	67 937.91	3	547 712.22	
L62	70 911.48	3	546 951.25		R62	67 817.33	3	547 723.44	
L63	70 861.74	3	546 960.30		R63	66 929.41	3	547 745.21	
L64	70 803.77	3	546 972.78		R64	66 925.31	3	547 751.17	
L65	69 650.24	3	547 265.45		R65	66 899.55	3	547 745.88	
L66	68 184.15	3	547 637.74		R66	66 447.32	3	547 757.07	
L67	68 051.22	3	547 668.40		R67	66 320.55	3	547 764.69	
L68	67 930.72	3	547 687.27		R68	66 185.22	3	547 783.61	
L69	67 830.80	3	547 697.37		R69	66 054.44	3	547 812.34	
L70	66 582.70	3	547 728.15		R70	65 850.77	3	547 875.44	
L71	66 449.18	3	547 731.57		R71	64 883.44	3	548 193.64	
L72	66 312.53	3	547 740.11		R72	64 859.27	3	548 207.12	
L73	66 184.44	3	547 757.63		R73	64 827.71	3	548 216.12	
L74	66 050.88	3	547 787.01		R74	64 803.96	3	548 220.04	
L75	65 934.58	3	547 821.20		R75	64 160.19	3	548 430.89	
L76	64 154.38	3	548 406.30		R76	60 970.55	3	549 480.46	
L77	60 952.74	3	549 460.27		R77	60 891.05	3	549 510.36	
L78	60 880.49	3	549 487.52		R78	60 859.87	3	549 522.75	
L79	60 756.34	3	549 543.04		R79	60 736.02	3	549 581.74	
L80	60 701.14	3	549 571.48		R80	60 648.52	3	549 631.08	
L81	60 635.66	3	549 608.79		R81	60 577.50	3	549 675.84	
L82	60 570.11	3	549 650.35		R82	60 528.22	3	549 709.65	
L83	60 516.80	3	549 686.87		R83	59 124.44	3	550 727.49	
L84	58 906.93	3	550 853.80		R84	58 702.53	3	551 034.61	
L85	58 725.99	3	550 986.37		R85	58 671.22	3	551 059.77	
L86	58 667.63	3	551 030.25		R86	58 603.16	3	551 117.28	
L87	58 649.32	3	551 044.03		R87	58 576.84	3	551 145.32	
L88	58 563.57	3	551 119.88		R88	58 575.44	3	551 142.63	
L89	58 483.95	3	551 198.26		R89	58 450.15	3	551 270.29	
L90	57 715.60	3	552 010.29		R90	57 539.44	3	552 232.85	
L91	57 489.55	3	552 250.26		R91	57 471.48	3	552 313.05	
L92	57 444.73	3	552 305.05		R92	57 437.95	3	552 356.69	
L93	57 396.31	3	552 372.06		R93	57 407.06	3	552 402.06	
L94	57 350.75	3	552 444.98		R94	57 377.69	3	552 448.20	
L95	57 318.43	3	552 504.52		R95	57 351.16	3	552 496.05	
L96	57 291.73	3	552 559.89		R96	57 326.44	3	552 545.29	
L97	57 263.55	3	552 628.30		R97	57 303.84	3	552 595.25	
L98	57 241.28	3	552 691.67		R98	57 283.47	3	552 646.20	
L99	57 222.21	3	552 757.32		R99	57 265.49	3	552 697.85	
L100	56 824.51	3	554 262.16		R100	57 247.35	3	552 760.69	
L101	56 810.23	3	554 329.00		R101	56 848.86	3	554 268.39	
L102	56 802.03	3	554 396.73		R102	56 834.89	3	554 332.69	
					Vel Sheet	13	Van of	16	P1196/20

PADRESERWE KOÖRDINATE / ROAD RESERVE CO-ORDINATES						
LINKERKANT/LEFT HAND SIDE				REGTERKANT/RIGHT HAND SIDE		
	Y	X	WG 25°		Y	X
L103	56 799.87	3 554 451.37		R103	56 827.31	3 554 391.35
L104	56 801.82	3 554 485.44		R104	56 824.93	3 554 451.06
L105	56 808.74	3 554 606.37		R105	56 827.38	3 554 510.53
L106	56 811.92	3 554 650.25		R106	56 830.09	3 554 542.12
L107	56 814.11	3 554 680.37		R107	56 838.82	3 554 643.52
L108	56 814.42	3 554 711.35		R108	56 840.27	3 554 711.74
L109	56 798.54	3 554 791.43		R109	56 832.40	3 554 765.46
L110	56 773.96	3 554 850.42		R110	56 815.20	3 554 824.65
L111	56 684.83	3 554 959.36		R111	56 794.49	3 554 866.96
L112	56 627.44	3 555 010.54		R112	56 768.42	3 554 906.07
L113	56 553.41	3 555 053.14		R113	56 737.76	3 554 941.80
L114	56 532.12	3 555 059.86		R114	56 692.16	3 554 985.46
L115	56 465.48	3 555 072.14		R115	56 618.35	3 555 050.58
L116	56 332.48	3 555 050.69		R116	56 526.70	3 555 096.25
L117	56 306.47	3 555 059.03		R117	56 425.73	3 555 110.98
L118	56 295.24	3 555 074.93		R118	56 355.77	3 555 153.48
L119	56 291.10	3 555 104.47		R119	56 327.53	3 555 204.91
L120	56 252.58	3 555 139.26		R120	56 319.81	3 555 214.80
L121	56 203.95	3 555 117.87		R121	56 209.07	3 555 251.31
L122	56 176.66	3 555 133.85		R122	56 180.24	3 555 263.69
L123	56 180.43	3 555 165.83		R123	56 119.73	3 555 322.95
L124	56 152.31	3 555 174.99		R124	56 099.90	3 555 334.48
L125	56 103.53	3 555 227.86		R125	56 036.47	3 555 349.12
L126	56 060.78	3 555 256.01		R126	55 988.04	3 555 370.16
L127	56 044.03	3 555 282.12		R127	55 970.86	3 555 381.97
L128	55 943.58	3 555 332.46		R128	55 927.66	3 555 451.80
L129	55 920.34	3 555 387.11		R129	55 874.04	3 555 512.11
L130	55 845.62	3 555 475.42		R130	55 865.92	3 555 531.89
L131	55 839.31	3 555 483.89		R131	55 855.81	3 555 561.76
L132	55 815.69	3 555 531.83		R132	55 850.71	3 555 602.56
L133	55 809.66	3 555 582.35		R133	55 852.27	3 555 723.38
L134	55 812.92	3 555 729.01		R134	55 857.56	3 555 776.70
L135	55 814.60	3 555 759.80		R135	55 866.78	3 555 832.70
L136	55 816.55	3 555 772.57		R136	55 878.91	3 555 892.69
L137	55 823.18	3 555 848.58		R137	55 866.93	3 555 938.45
L138	55 826.34	3 555 864.87		R138	55 859.93	3 555 943.87
L139	55 798.47	3 555 888.69		R139	55 846.57	3 555 951.35
L140	55 753.17	3 555 910.92		R140	55 829.57	3 555 972.85
L141	55 677.95	3 555 988.86		R141	55 798.97	3 555 998.84
L142	55 614.62	3 556 021.61		R142	55 764.99	3 556 019.94
L143	55 429.39	3 556 104.72		R143	55 714.60	3 556 043.60
L144	55 381.17	3 556 151.03		R144	55 697.65	3 556 045.17
L145	55 346.86	3 556 229.09		R145	55 606.95	3 556 065.61
L146	55 336.65	3 556 245.36		R146	55 496.86	3 556 120.39
L147	55 314.49	3 556 260.76		R147	55 451.07	3 556 141.38
L148	55 307.43	3 556 268.07		R148	55 420.23	3 556 169.29
L149	55 303.34	3 556 274.34		R149	55 392.80	3 556 213.45
L150	55 243.79	3 556 312.58		R150	55 366.07	3 556 259.57
L151	55 208.43	3 556 326.02		R151	55 353.90	3 556 290.56
L152	55 196.27	3 556 331.58		R152	55 339.67	3 556 300.31
L153	55 169.91	3 556 346.72		R153	55 330.34	3 556 303.56
				Vel Sheet	14      Van of      16	P1196/20



PADRESERVE KOÖRDINATE / ROAD RESERVE CO-ORDINATES						
LINKERKANT/LEFT HAND SIDE				REGTERKANT/RIGHT HAND SIDE		
	Y	X	WG 25°		Y	X
L154	55 138.73	3 556 365.71		R154	55 281.38	3 556 333.98
L155	55 091.89	3 556 420.06		R155	55 226.75	3 556 362.84
L156	55 089.67	3 556 427.12		R156	55 162.68	3 556 391.02
L157	55 073.95	3 556 476.54		R157	55 124.71	3 556 446.89
L158	55 071.45	3 556 506.77		R158	55 122.18	3 556 486.39
L159	55 087.75	3 556 554.68		R159	55 123.72	3 556 497.72
L160	55 139.22	3 556 604.40		R160	55 129.54	3 556 512.83
L161	55 153.68	3 556 632.36		R161	55 136.33	3 556 525.73
L162	55 172.70	3 556 686.24		R162	55 195.45	3 556 624.87
L163	55 151.57	3 556 751.11		R163	55 202.13	3 556 637.59
L164	55 103.73	3 556 804.34		R164	55 203.49	3 556 678.03
L165	55 070.61	3 556 851.10		R165	55 201.88	3 556 701.72
L166	55 058.74	3 556 906.39		R166	55 194.85	3 556 738.46
L167	55 066.76	3 557 099.67		R167	55 191.85	3 556 752.42
L168	55 065.32	3 557 146.38		R168	55 148.06	3 556 804.92
L169	55 062.01	3 557 165.96		R169	55 135.85	3 556 823.13
L170	55 047.72	3 557 200.69		R170	55 099.87	3 556 864.82
L171	55 000.23	3 557 240.20		R171	55 085.55	3 556 943.50
L172	54 991.27	3 557 243.35		R172	55 097.33	3 557 129.16
L173	54 976.53	3 557 252.30		R173	55 087.74	3 557 182.30
L174	54 943.16	3 557 264.78		R174	55 051.96	3 557 248.95
L175	54 912.02	3 557 274.02		R175	55 040.26	3 557 274.50
L176	54 891.95	3 557 277.22		R176	54 933.06	3 557 317.09
L177	54 867.62	3 557 282.15		R177	54 879.34	3 557 323.24
L178	54 813.48	3 557 293.14		R178	54 790.62	3 557 353.67
L179	54 759.37	3 557 311.37		R179	54 766.21	3 557 367.13
L180	54 717.37	3 557 336.45		R180	54 720.30	3 557 399.73
L181	54 663.69	3 557 365.16		R181	54 692.85	3 557 412.55
L182	54 653.71	3 557 368.09		R182	54 639.13	3 557 429.69
L183	54 530.90	3 557 380.72		R183	54 575.01	3 557 435.84
L184	54 520.37	3 557 381.80		R184	54 532.12	3 557 428.97
L185	54 424.82	3 557 330.28		R185	54 491.62	3 557 418.53
L186	54 340.84	3 557 331.86		R186	54 445.62	3 557 391.49
L187	54 272.63	3 557 341.43		R187	54 375.47	3 557 361.39
L188	54 222.71	3 557 363.59		R188	54 307.31	3 557 359.44
L189	54 218.75	3 557 356.85		R189	54 267.31	3 557 370.66
L190	54 200.79	3 557 371.42		R190	54 235.50	3 557 387.41
L191	54 138.50	3 557 424.38		R191	54 223.45	3 557 396.02
L192	54 101.83	3 557 451.50		R192	54 104.75	3 557 510.04
L193	54 058.37	3 557 491.75		R193	54 106.06	3 557 512.18
L194	53 930.66	3 557 620.27		R194	54 080.18	3 557 534.56
L195	53 203.26	3 558 267.85		R195	54 071.72	3 557 533.43
L196	53 167.11	3 558 303.98		R196	53 961.76	3 557 626.92
L197	53 155.28	3 558 316.83		R197	53 217.71	3 558 288.05
L198	53 002.48	3 558 500.22		R198	53 176.39	3 558 330.72
L199	52 394.57	3 559 232.94		R199	53 122.46	3 558 393.50
L200	51 269.07	3 560 589.72		R200	52 404.01	3 559 259.24
L201	50 785.75	3 561 162.62		R201	51 312.04	3 560 575.75
L202	50 359.63	3 561 676.23		R202	50 796.76	3 561 197.20
L203	48 926.83	3 563 402.18		R203	50 331.43	3 561 758.14
L204	48 899.45	3 563 440.12		R204	48 596.69	3 563 848.12
				Vel Sheet	15 Van of	16 P1196/20

PADRESERWE KOÖRDINATE / ROAD RESERVE CO-ORDINATES						
LINKERKANT/LEFT HAND SIDE				REGTERKANT/RIGHT HAND SIDE		
	Y	X	WG 25°		Y	X
L205	48 579.47	3 563 831.56		R205	45 874.86	3 567 127.57
L206	48 443.99	3 563 992.86		R206	45 657.76	3 567 382.74
L207	45 693.71	3 567 308.18		R207	45 560.36	3 567 474.45
L208	45 644.63	3 567 360.81		R208	45 523.21	3 567 505.13
L209	45 543.84	3 567 455.70		R209	45 488.25	3 567 528.06
L210	45 507.30	3 567 485.85		R210	45 450.76	3 567 548.36
L211	45 474.58	3 567 507.13		R211	45 406.66	3 567 566.72
L212	45 438.88	3 567 526.36		R212	45 375.04	3 567 576.13
L213	45 397.56	3 567 543.44		R213	45 263.22	3 567 606.50
L214	45 325.51	3 567 561.22		R214	45 239.91	3 567 615.50
L215	45 259.69	3 567 581.61		R215	45 205.68	3 567 632.98
L216	45 202.21	3 567 592.68		R216	45 185.13	3 567 645.70
L217	45 177.09	3 567 608.99		R217	45 148.78	3 567 673.66
L218	45 142.97	3 567 638.52		R218	45 071.61	3 567 723.25
L219	45 110.17	3 567 663.14		R219	45 022.63	3 567 757.35
L220	45 054.52	3 567 691.88		R220	44 944.17	3 567 819.38
L221	44 931.86	3 567 791.80		R221	44 917.54	3 567 854.09
L222	44 859.00	3 567 865.20		R222	44 866.26	3 567 930.73
L223	44 750.90	3 568 000.92		R223	44 845.41	3 567 949.51
L224	44 744.98	3 568 036.80		R224	44 806.72	3 568 005.67
L225	44 737.33	3 568 102.81		R225	44 779.11	3 568 057.71
L226	44 723.27	3 568 121.29		R226	44 774.34	3 568 087.76
L227	44 705.83	3 568 137.20		R227	44 763.14	3 568 116.02
L228	44 676.06	3 568 149.33		R228	44 745.86	3 568 141.03
L229	44 653.63	3 568 154.30		R229	44 723.40	3 568 161.51
L230	44 619.56	3 568 158.64		R230	44 696.91	3 568 176.41
L231	44 579.88	3 568 177.72		R231	44 667.86	3 568 186.57
L232	44 575.49	3 568 183.96		R232	44 632.25	3 568 206.34
L233	44 554.04	3 568 214.48		R233	44 607.26	3 568 226.60
L234	44 536.66	3 568 251.21		R234	44 604.14	3 568 229.14
L235	44 531.05	3 568 294.55		R235	44 577.40	3 568 264.61
L236	44 535.87	3 568 342.41		R236	44 569.89	3 568 304.02
L237	44 538.64	3 568 380.35		R237	44 571.31	3 568 343.25
L238	44 564.88	3 568 517.42		R238	44 583.32	3 568 401.64
L239	44 573.96	3 568 559.17		R239	44 591.66	3 568 469.81
L240	44 580.52	3 568 639.12		R240	44 609.44	3 568 573.26
L241	44 593.48	3 568 708.71		R241	44 633.22	3 568 662.32
L242	44 602.08	3 568 736.57		R242	44 720.12	3 568 887.29
L243	44 674.68	3 568 857.71		R243	44 727.58	3 568 928.88
L244	44 690.16	3 568 891.40		R244	44 726.48	3 568 970.64
L245	44 698.02	3 568 927.63		R245	44 717.01	3 569 011.32
L246	44 697.88	3 568 964.71		R246	44 699.54	3 569 049.26
L247	44 689.75	3 569 000.88		R247	44 653.38	3 569 099.47
L248	44 674.02	3 569 034.45		R248	44 597.31	3 569 160.47
L249	44 634.40	3 569 076.55				
L250	44 579.67	3 569 134.64				
				<div> <div>Vel</div> <div>16</div> <div>Van</div> <div>16</div> <div>Sheet</div> <div>of</div> <div>P1196/20</div> </div>		

