GOVERNMENT NOTICES • GOEWERMENTSKENNISGEWINGS

DEPARTMENT OF TRANSPORT

NO. 6659

19 September 2025

**THE SOUTH AFRICAN NATIONAL ROADS
AGENCY SOC LIMITED**Registration No: 1998/009584/30

DECLARATION AMENDMENT OF NATIONAL ROAD R579 SECTION 3

AMENDMENT OF DECLARATION No. 538 OF 2014.

By virtue of section 40(1)(b) of the South African National Roads Agency Limited and the National Roads Act 1998 (Act No. 7 of 1998), I hereby amend Declaration No. 538 of 2014 by substituting paragraph O(III) and O(IV) of the Schedule, being the descriptive declaration of the route from Maleetse up to the intersection with National Road R37 Section 1, with the accompanying sheets 1 to 19 of Plan No. P994/17.

(National Road R579 Section 3: Maleetse – R37 Intersection)
MINISTER OF TRANSPORT

DEPARTEMENT VAN VERVOER

NO. 6659

19 September 2025

**DIE SUID-AFRIKAANSE NASIONALE
PADAGENTSKAP MSB BEPERK**Registrasie No: 1998/009584/30

VERKLARING WYSIGING VAN NASIONALE PAD R579 SEKSIE 3

WYSIGING VAN VERKLARING No. 538 VAN 2014.

Kragtens Artikel 40(1)(b) van die Wet op die Suid-Afrikaanse Nasionale Padagentskap Beperk en op Nasionale Paaie Wet 1998 (Wet No. 7 van 1998), wysig ek hiermee Verklaring No. 538 van 2014 deur paragraaf O(III) en O(IV) van die Skedule te vervang, synde die gedeelte van die beskrywende verklaring van die pad vanaf Maleetse tot by die interseksie met Nasionale Pad R37 Seksie 1, met bygaande velle 1 tot 19 van Plan No. P994/17.

(Nasionale Pad R579 Seksie 3: Maleetse – R37 Interseksie)
MINISTER VAN VERVOER

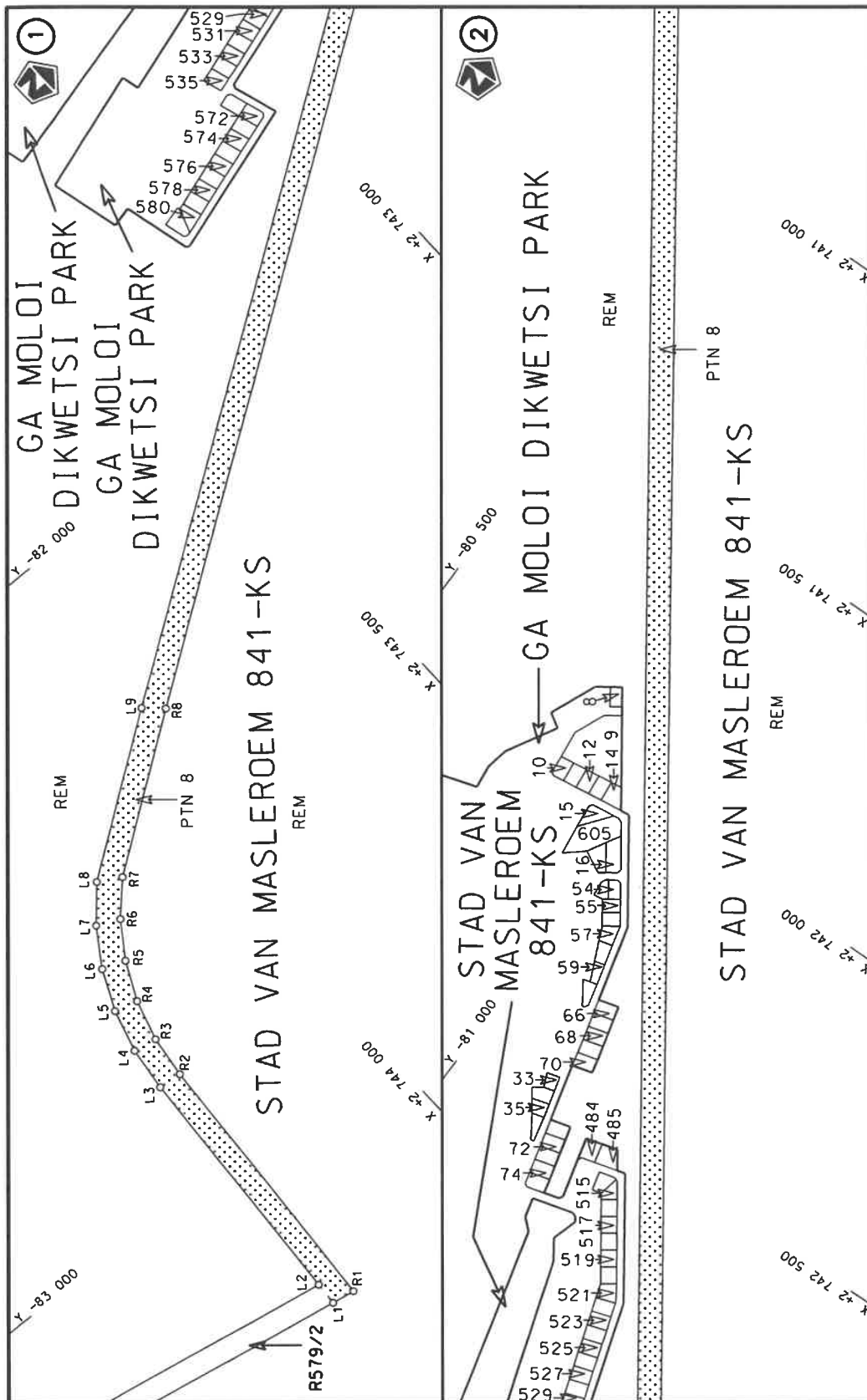

Die Suid Afrikaanse Nasionale Podogentskop MSB Bpk	Die figuur getoon		steldie padreserwe voor van 'n gedeelte represents the road reserve of a portion van Nasionale Roete R579 Seksie of National Route Section	Vel Sheet 1 of 19
The South African National Roads Agency SOC Ltd	The figure shown			3 Plan p994/17

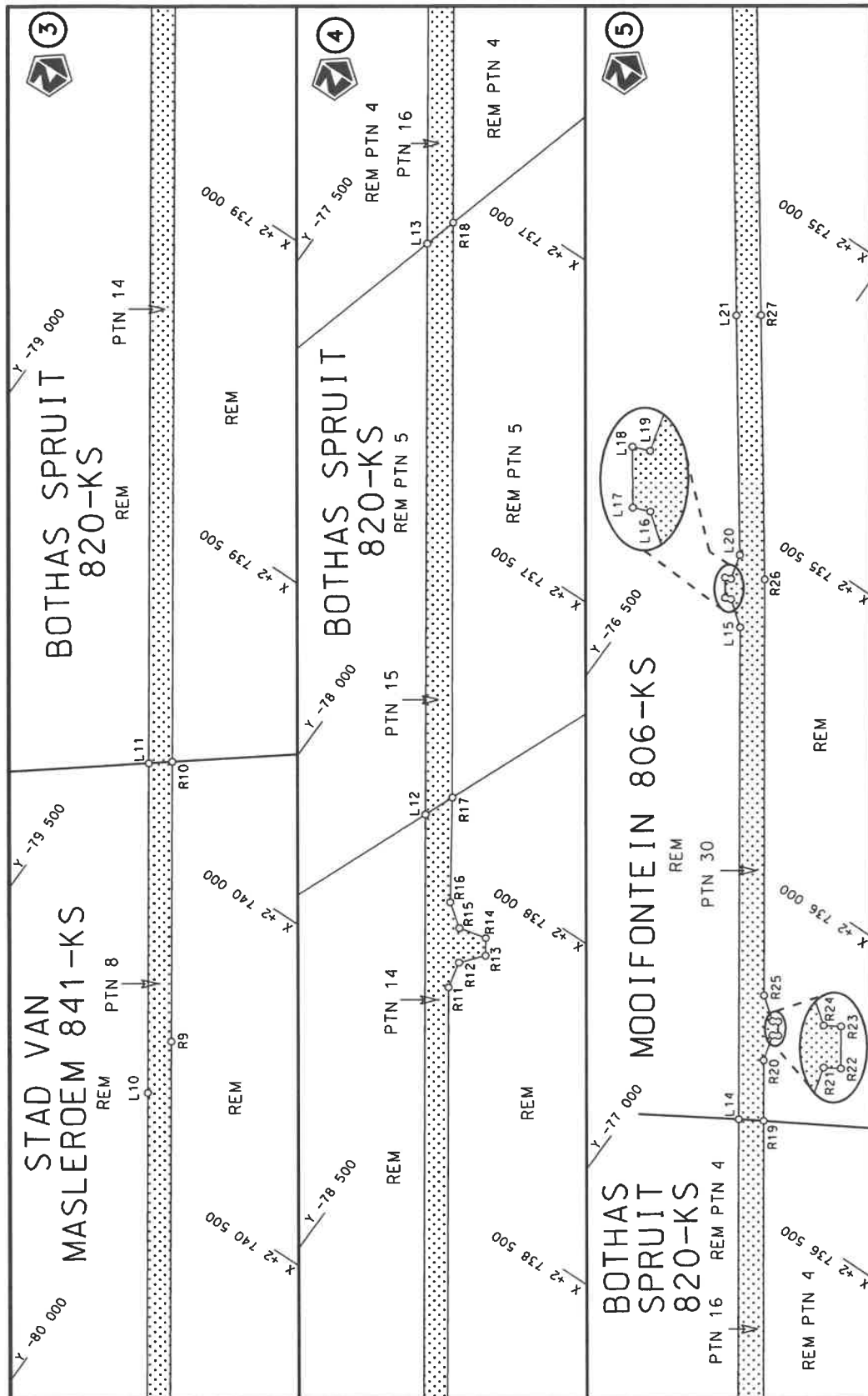

Die Suid Afrikaanse Nasionale Padagentskap MSB Bpk The South African National Roads Agency SOC Ltd	Die figuur getoon The figure shown	stelt die padreserwe voor van 'n gedeelte van Nasionale Roete R579 represents the road reserve of a portion of National Route	3	Vel Sheet 2 of 19	Plan p994/17
---	---------------------------------------	--	---	----------------------	-----------------

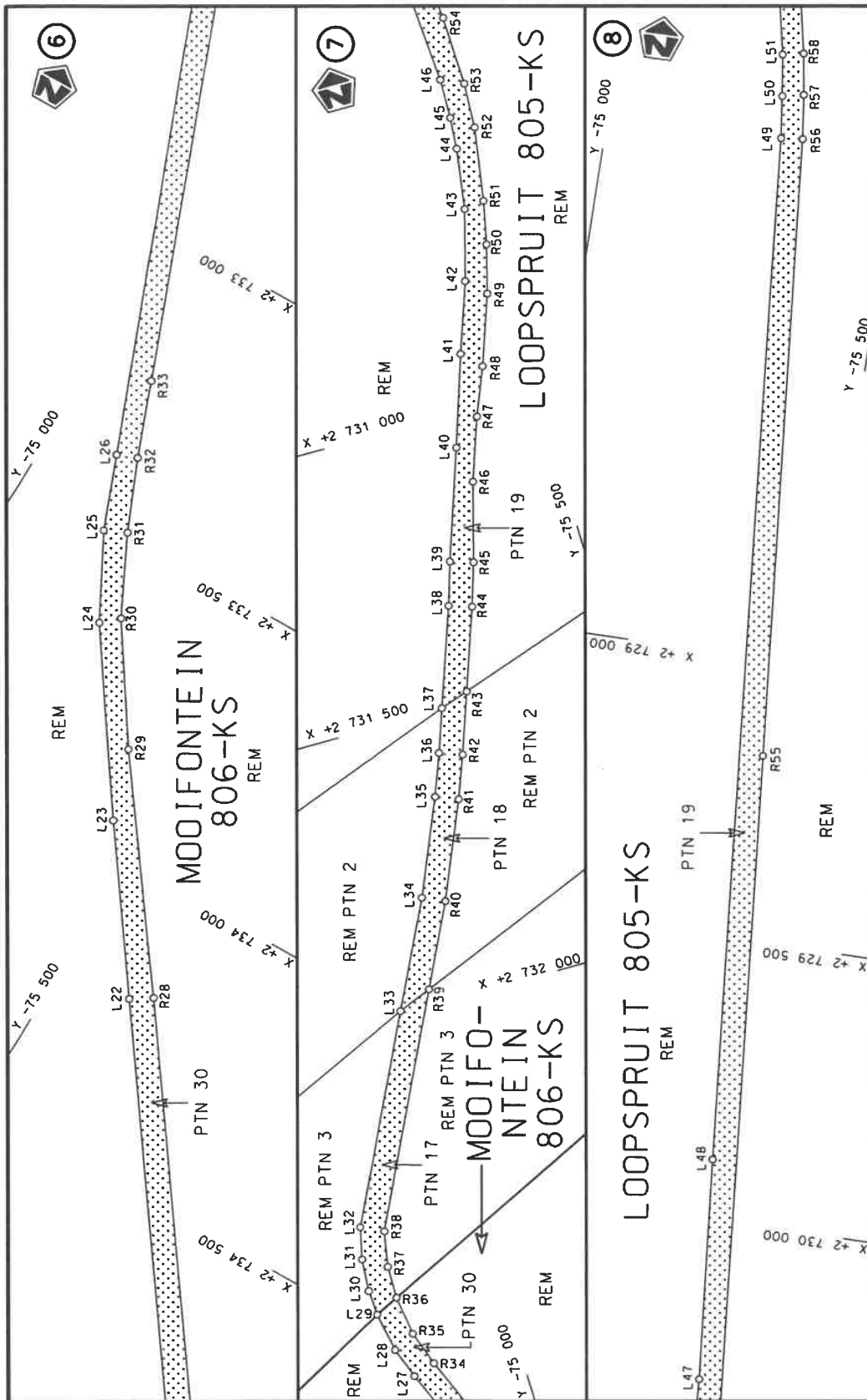

Vel Sheet 3 of 19	steldie padreserwe voor van 'n gedeelte represents the road reserve of a portion van Nasionale Roete R579 Seksie of National Route Section 3		Die figuur getoon The figure shown	Die Suid Afrikaanse Nasionale Padogentskop MSB Bpk The South African National Roads Agency SOC Ltd
----------------------	---	--	---------------------------------------	---

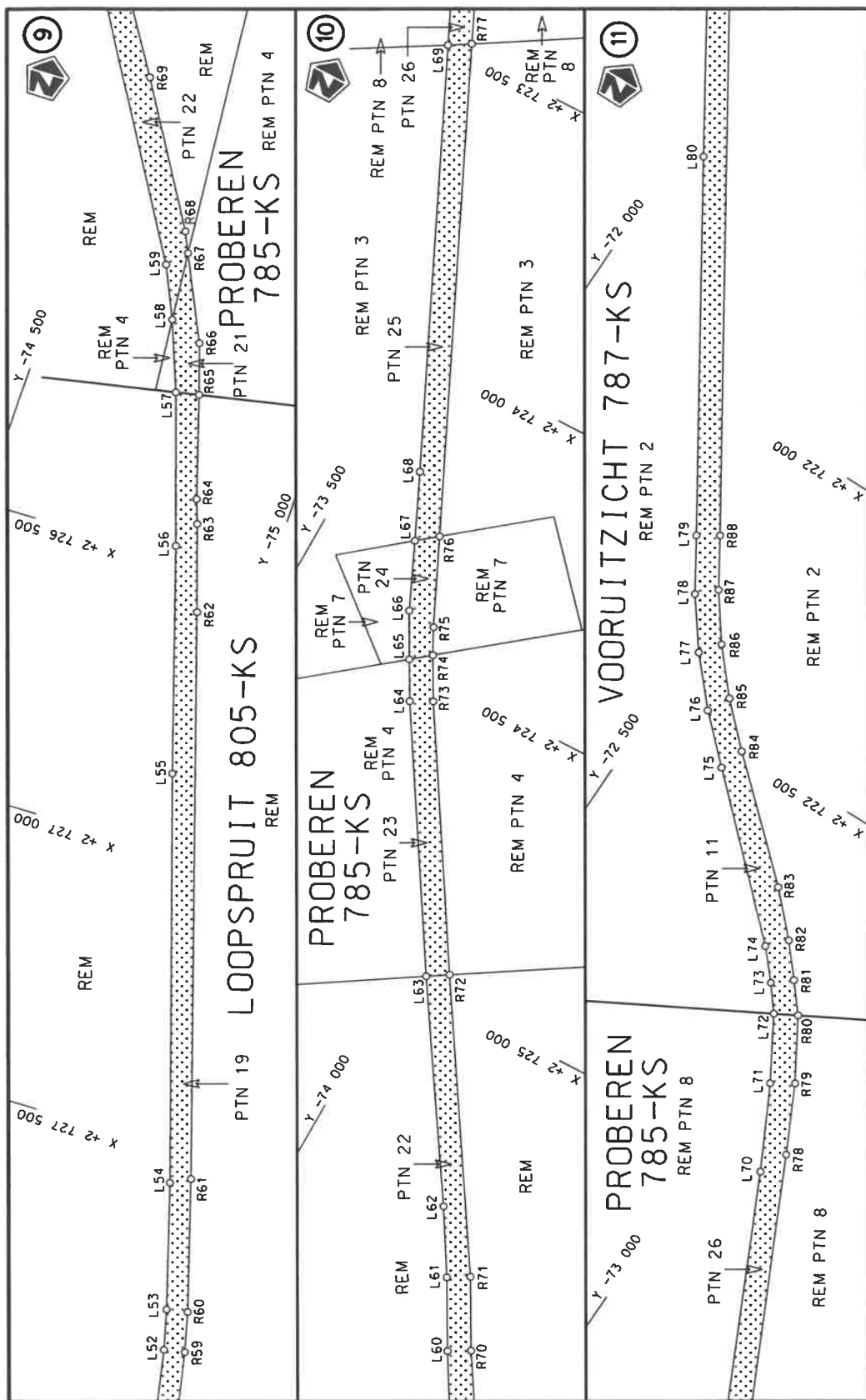

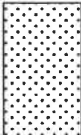
Die Suid Afrikaanse Nasionale Podagentskop MSB Bpk The South African National Roads Agency SOC Ltd	Die figuur getoon The figure shown		steldie padreserwe voor van 'n gedeelte represents the road reserve of a portion van Nasionale Roete R579 of National Route Section	Vel Sheet 4 of 19 Plan P994/17
---	---------------------------------------	---	--	--------------------------------------

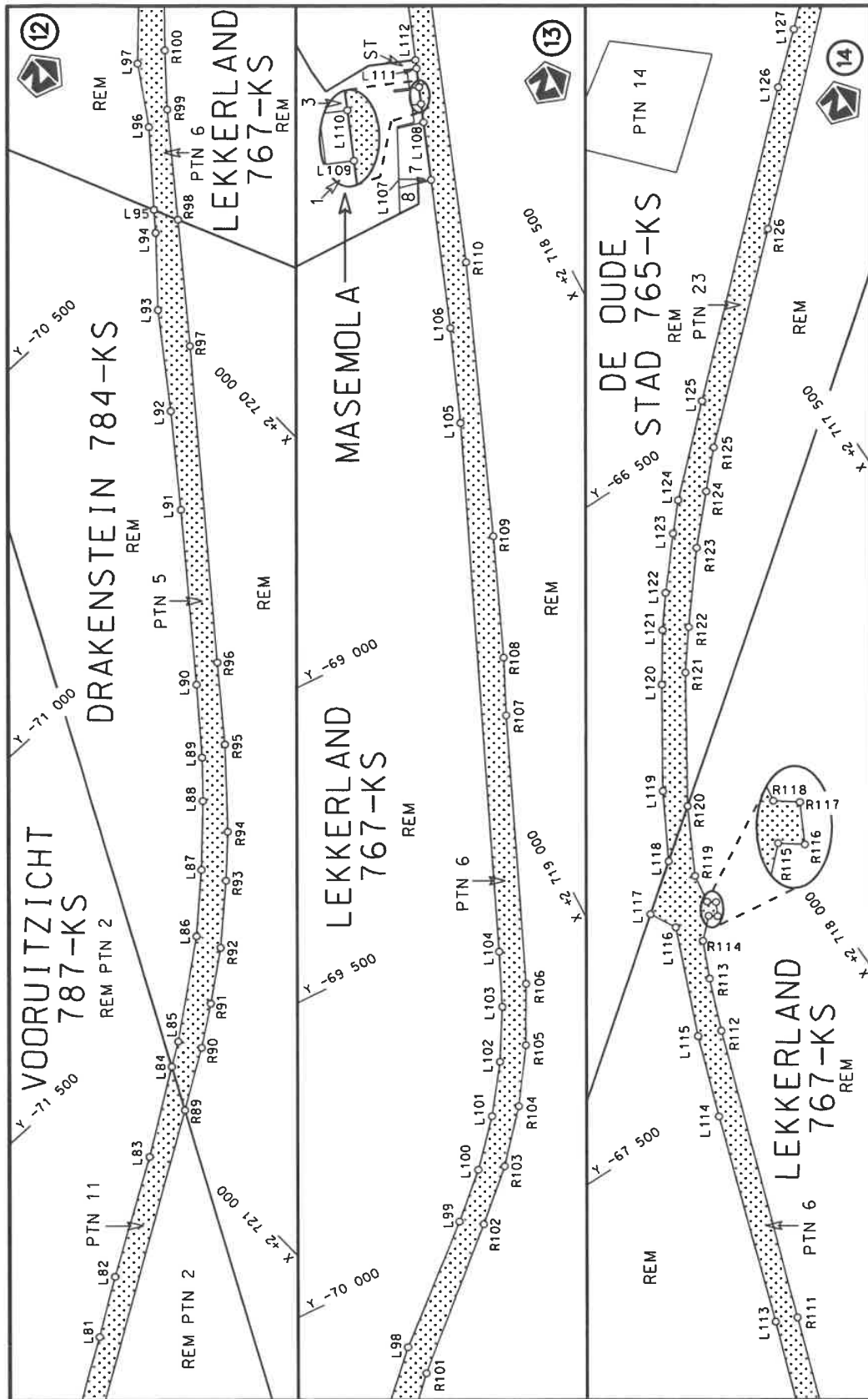

Die Suid Afrikaanse Nasionale Padagentskap MSB Bpk The South African National Roads Agency SOC Ltd	Die figuur getoon The figure shown	 steldie padreserwe voor van 'n gedeelte represents the road reserve of a portion van Nasionale Roete R579 of National Route	Vel Sheet 5 of 19 Plan P994/17
---	---------------------------------------	---	-----------------------------------

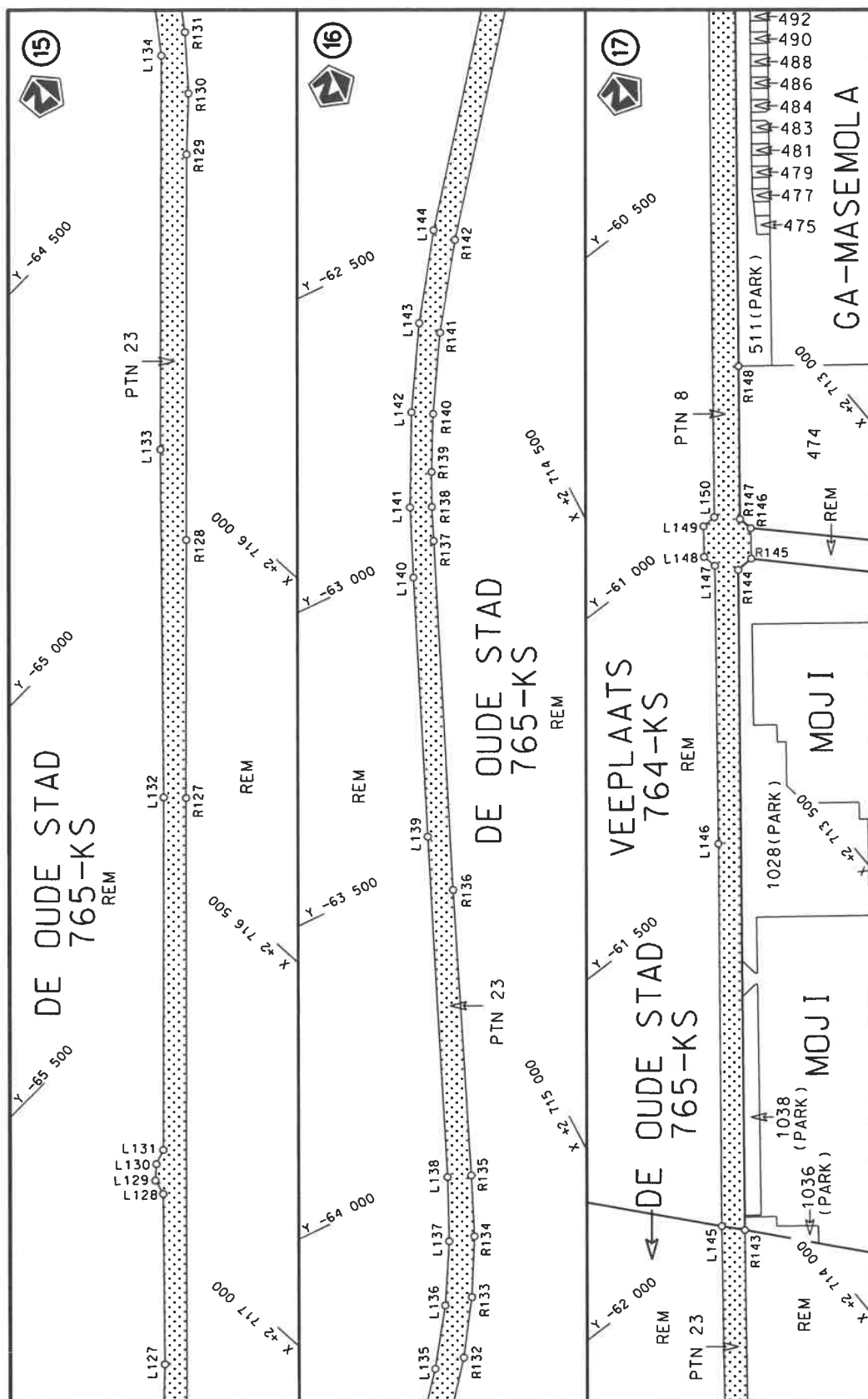

Die Suid Afrikaanse Nasionale Padagentskap MSB Bpk The South African National Roads Agency SOC Ltd	Die figuur getoon The figure shown	steldie padreserwe voor van 'n gedeelte represents the road reserve of a portion van Nasionale Roete R579 of National Route	3	Vel Sheet 6 of 19	Plan P994/17
---	---------------------------------------	--	---	----------------------	--------------

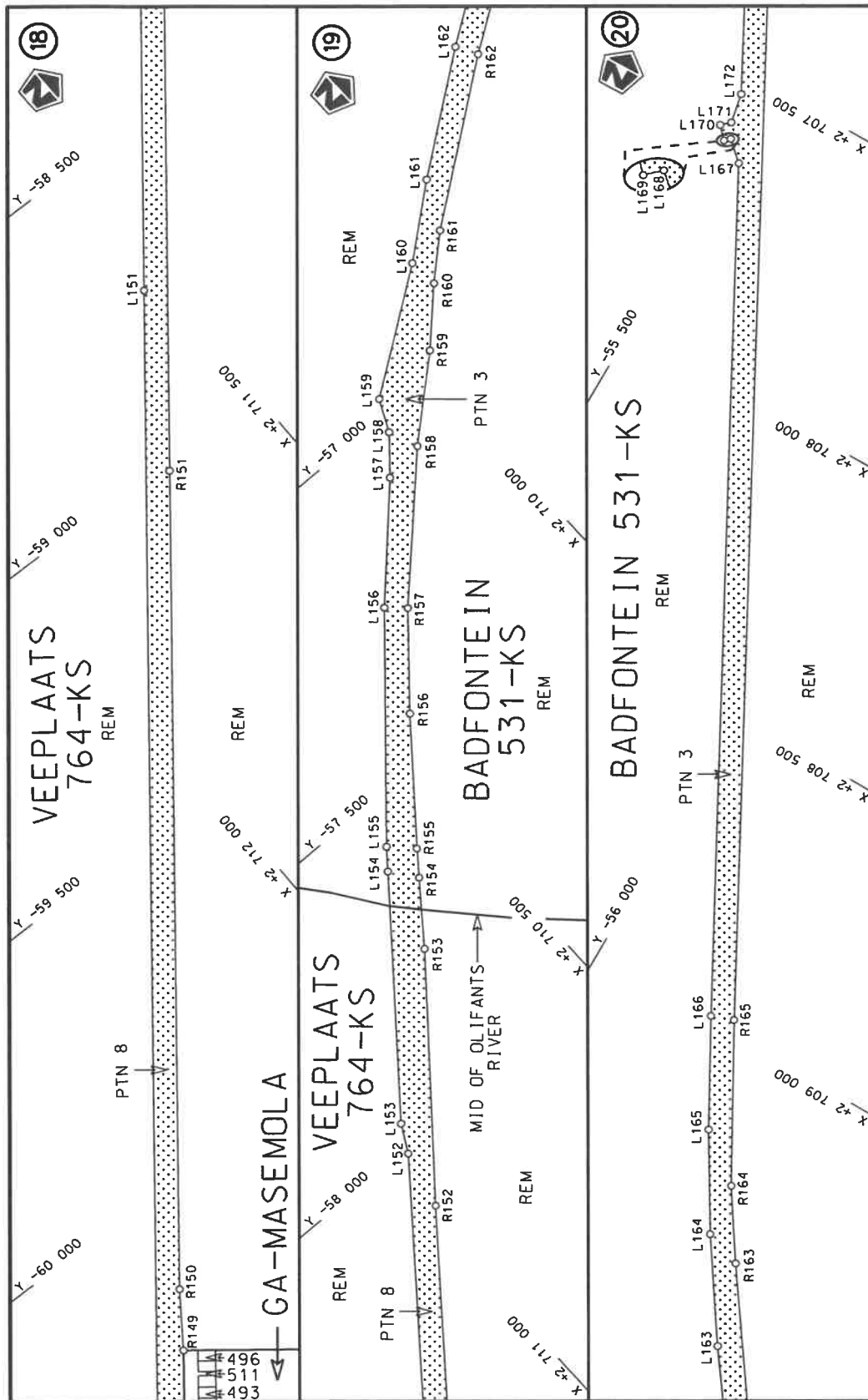

Die Suid Afrikaanse Nasionale Padogenskap MSB Bpk The South African National Roads Agency SOC Ltd	Die figuur getoon The figure shown		steldie podreserwe voor van 'n gedeelte represents the road reserve of a portion van Nasionale Roete R579 of National Route	Vel Sheet 7 of 19 Plan P994/17
--	---------------------------------------	---	--	--------------------------------------

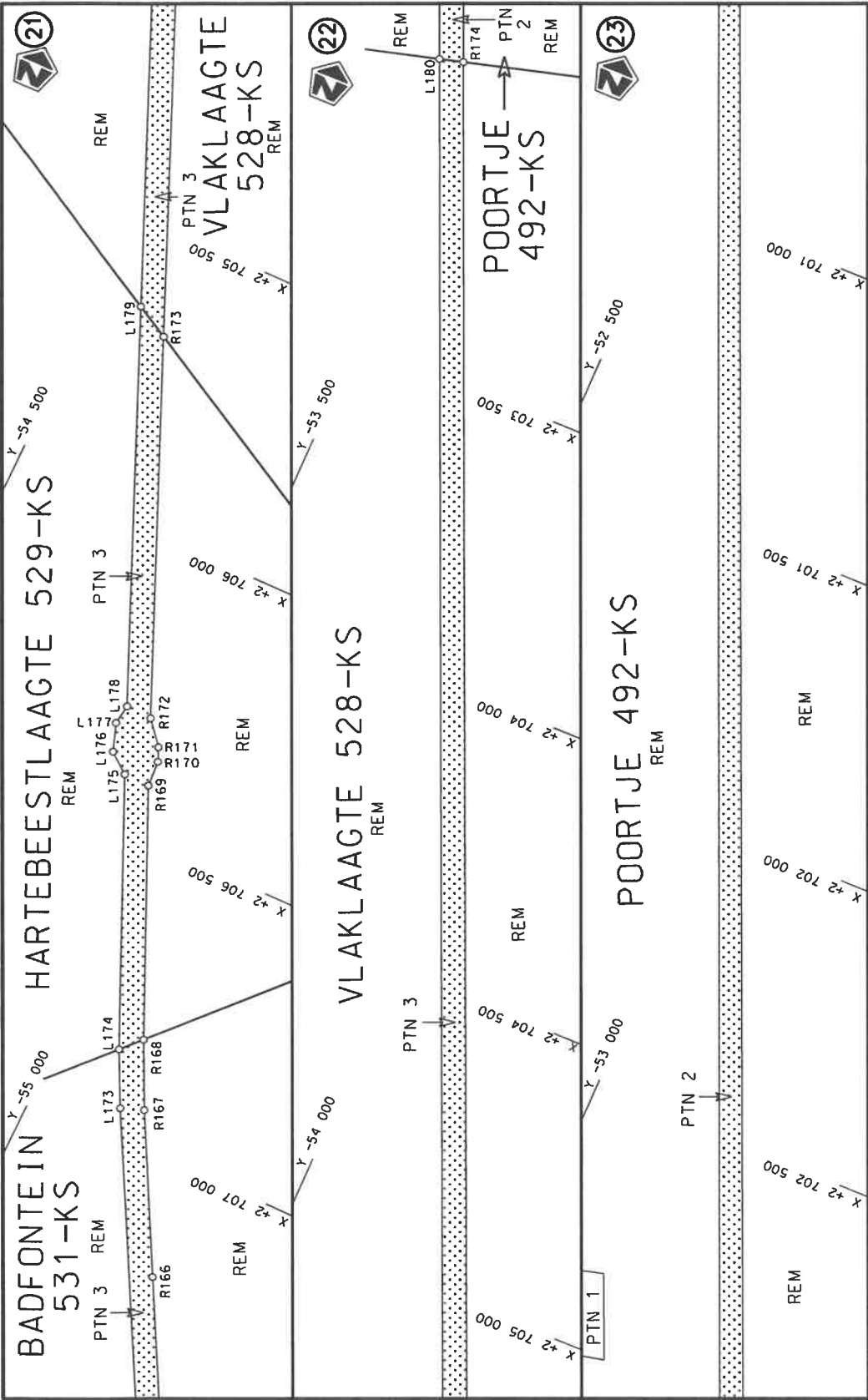

Die Suid Afrikaanse Nasionale Podogentskap MSB Bpk The South African National Roads Agency SOC Ltd	Die figuur getoon The figure shown		steldie podreserwe voor van 'n gedeelte represents the road reserve of a portion van Nasionale Roete of National Route	R579 Seksie Section	3	Vel Sheet	8 of 19	Plan	P994/17
---	---------------------------------------	--	---	---------------------------	---	--------------	---------	------	---------

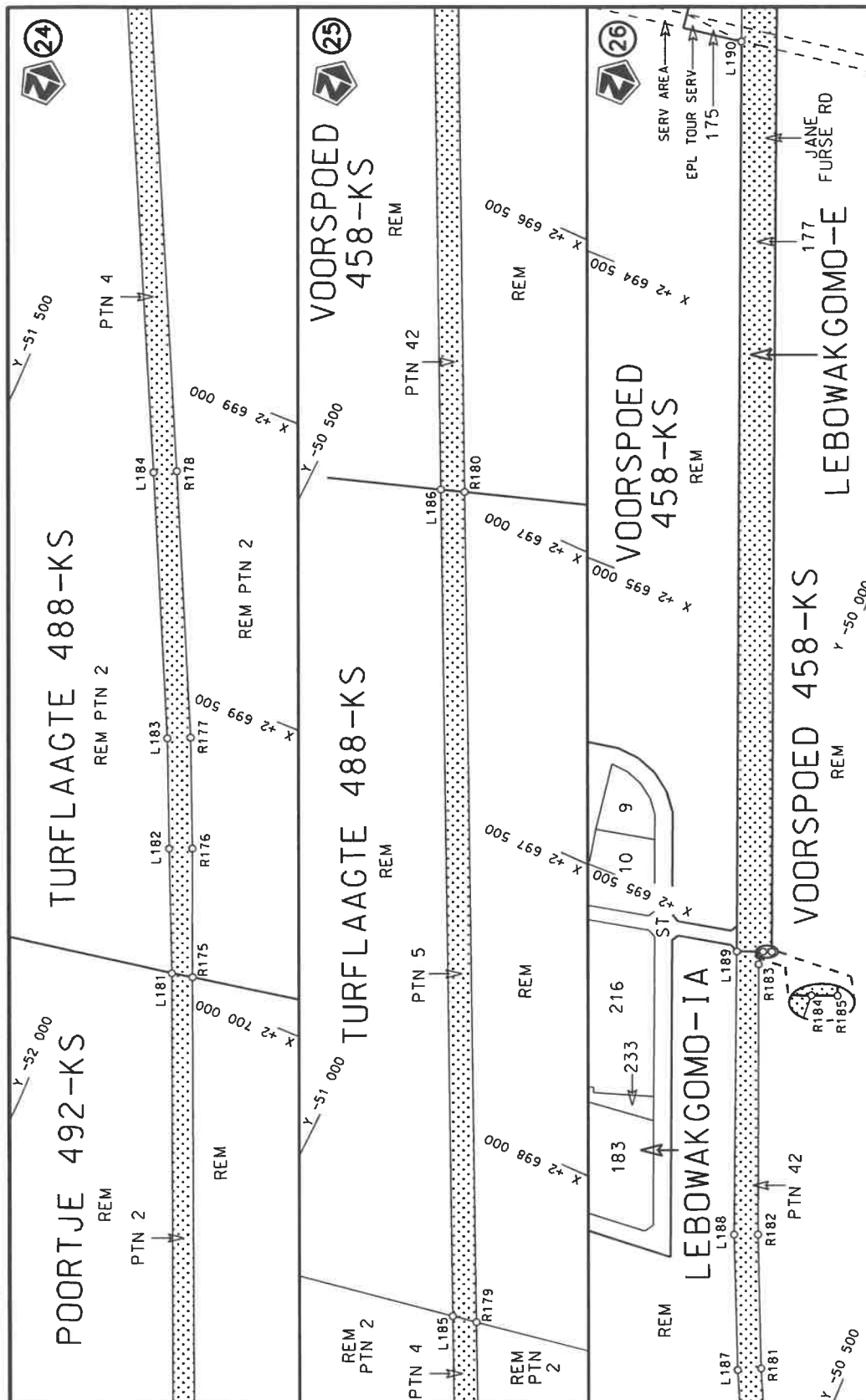

Die Suid Afrikaanse Nasionale Podogentskap MSB Bpk	Die figuur getoon		steldie padreserwe voor van 'n gedeelte represents the road reserve of a portion van Nasionale Roete R579 Sektie of National Route of National Route	Vel Sheet 9 of 19
The South African National Roads Agency SOC Ltd	The figure shown			Plan p994/17

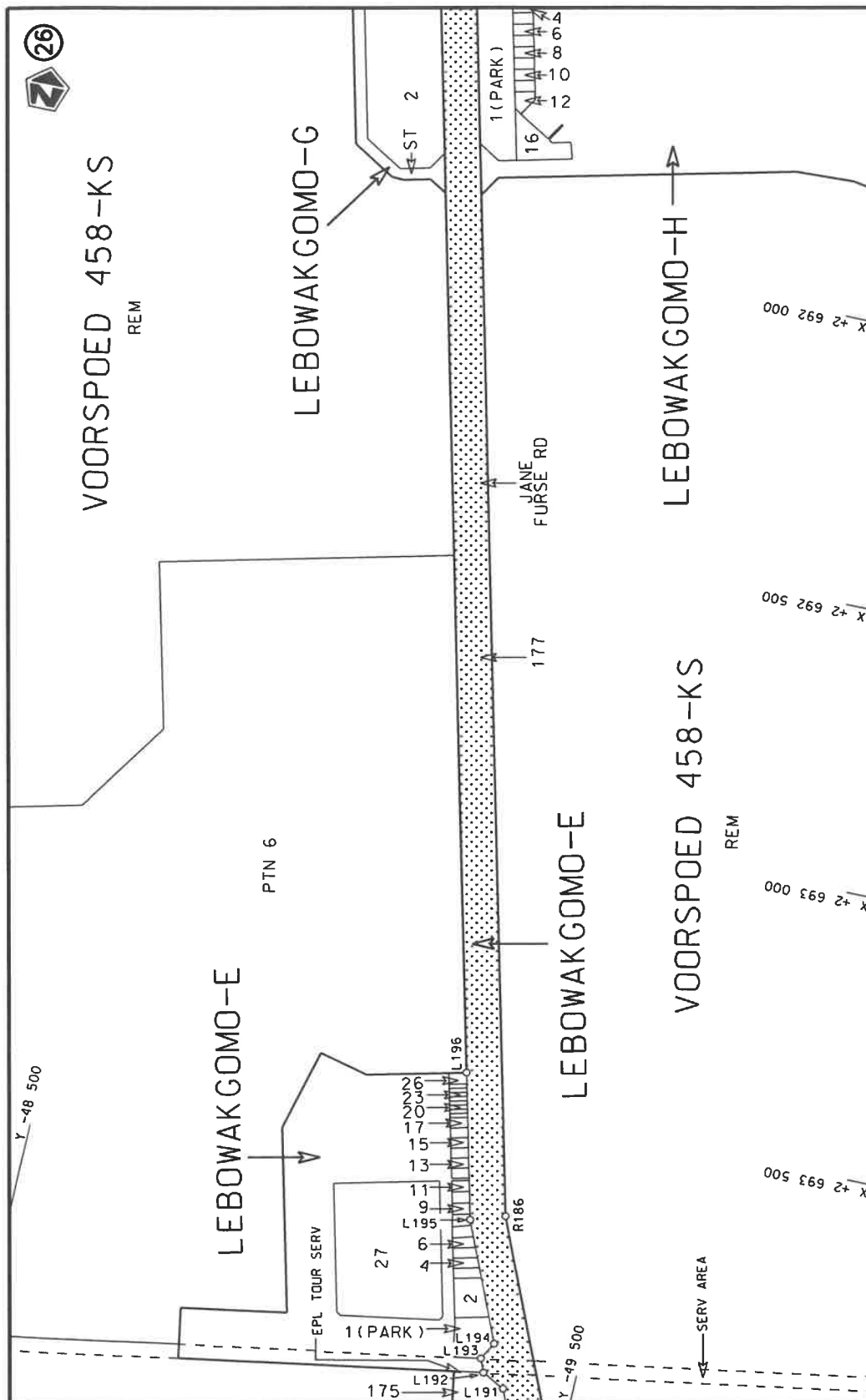

Die Suid-Afrikaanse Nasionale Podagogeneskop MSB Bpk The South African National Roads Agency SOC Ltd	Die figuur getoon The figure shown		steldie padreserwe voor van 'n gedeelte represents the road reserve of a portion van Nasionale Roete R579 of National Route	Vel Sheet 10 of 19
			3	Plan P994/17

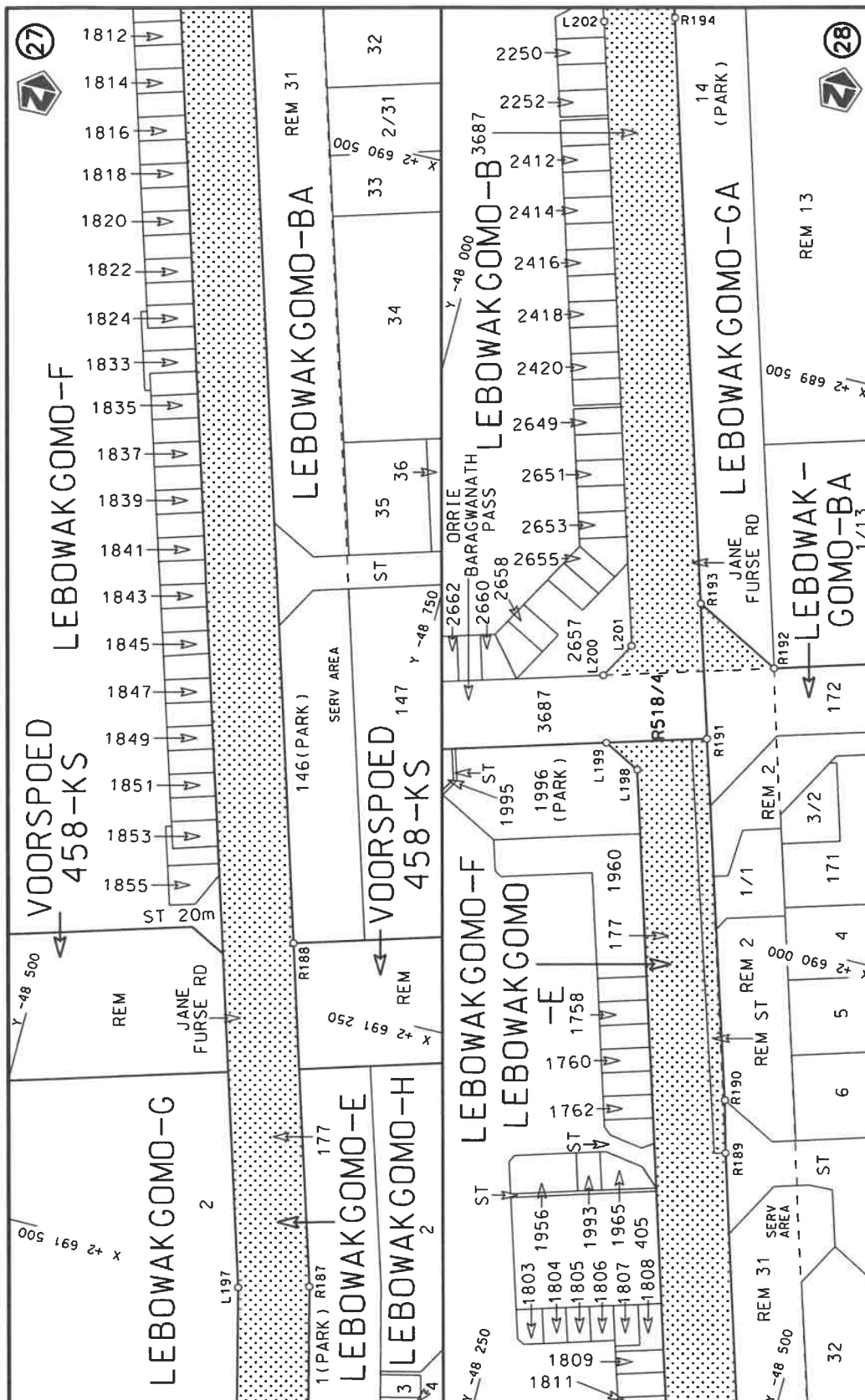

Die Suid Afrikaanse Nasionale Padagentskap MSB Bpk	Die figuur getoon		stel die padreserwe voor van 'n gedeelte represents the road reserve of a portion van Nasionale Roete R579 Seksie of National Route of National Route	Vel Sheet 11 van of 19
The South African National Roads Agency SOC Ltd	The figure shown			3

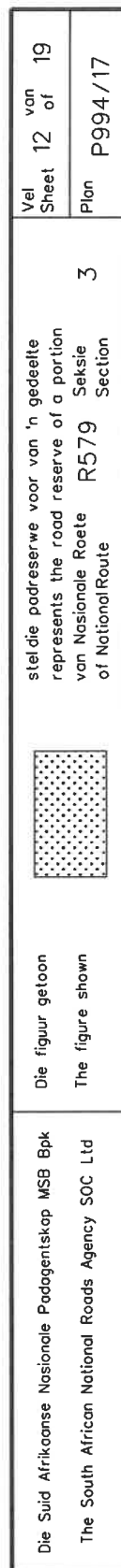

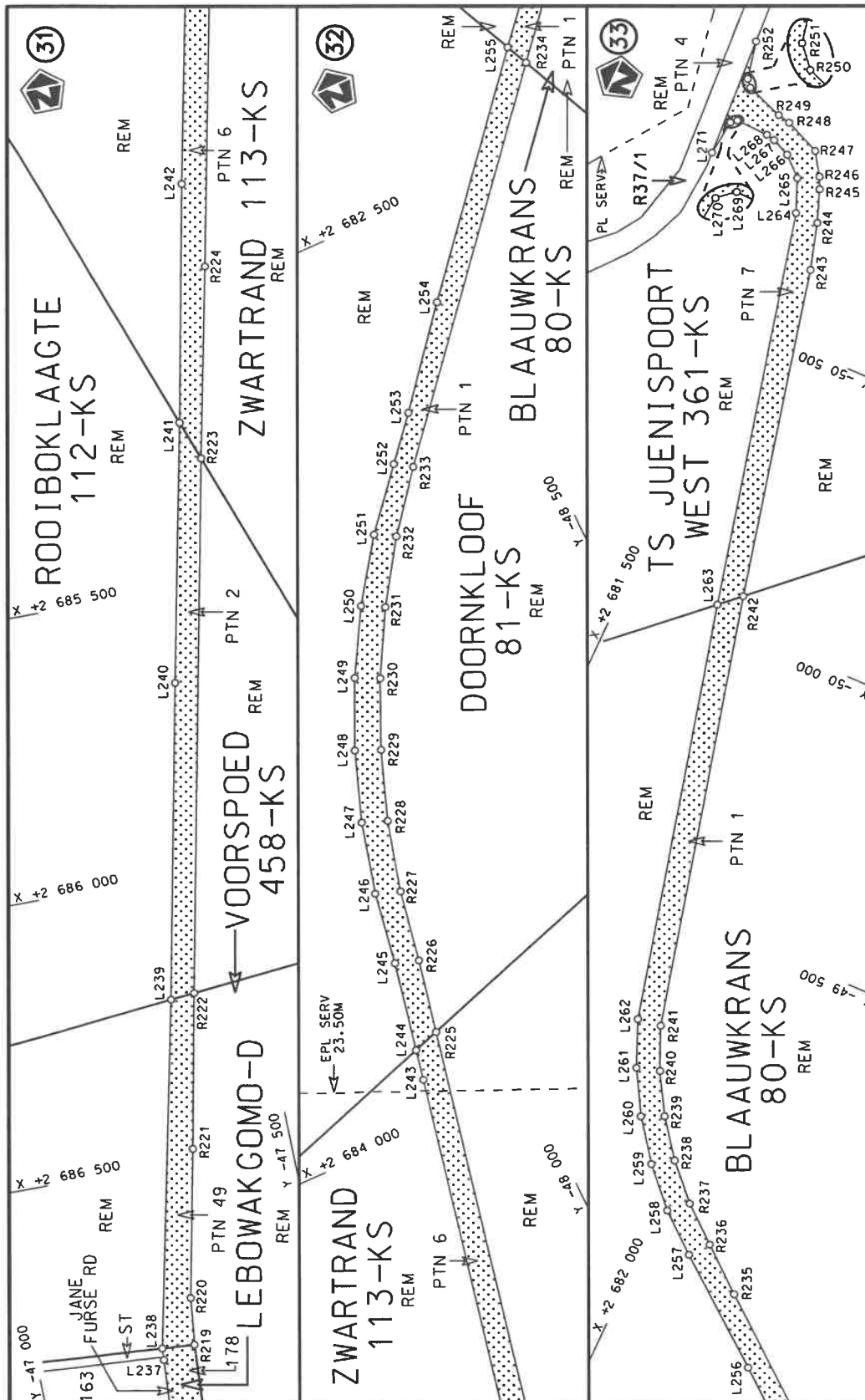

Vel Sheet 13 of 19	Plan P994/17
steldie padreserwe voor van 'n gedeelte represents the road reserve of a portion van Nasionale Roete R579 of National Route R579	Die figuur getoon The figure shown
3	Die Suid Afrikaanse Nasionale Padagentskap MSB Bpk The South African National Roads Agency SOC Ltd

PADRESERWE KOÖRDINATE / ROAD RESERVE CO-ORDINATES									
LINKERKANT/LEFT HAND SIDE					REGTERKANT/RIGHT HAND SIDE				
	Y	X	WG 29°			Y	X		
L1	-83 318.93	2 744 363.87		R1	-83 326.54	2 744 324.06			
L2	-83 278.73	2 744 361.08		R2	-82 842.86	2 744 290.48			
L3	-82 838.67	2 744 330.59		R3	-82 769.37	2 744 280.39			
L4	-82 761.43	2 744 320.21		R4	-82 698.00	2 744 258.80			
L5	-82 686.67	2 744 298.35		R5	-82 630.91	2 744 226.30			
L6	-82 616.05	2 744 265.52		R6	-82 569.80	2 744 183.65			
L7	-82 551.16	2 744 222.39		R7	-82 516.10	2 744 131.93			
L8	-82 493.71	2 744 170.29		R8	-82 338.96	2 743 879.84			
L9	-82 311.26	2 743 909.67		R9	-79 881.46	2 740 294.55			
L10	-79 900.40	2 740 392.54		R10	-79 599.87	2 739 882.98			
L11	-79 568.36	2 739 908.03		R11	-78 444.42	2 738 197.24			
L12	-78 237.26	2 737 965.91		R12	-78 434.12	2 738 150.97			
L13	-77 662.96	2 737 128.14		R13	-78 464.38	2 738 115.25			
L14	-77 161.95	2 736 397.18		R14	-78 446.78	2 738 089.06			
L15	-76 666.48	2 735 674.31		R15	-78 399.86	2 738 099.81			
L16	-76 625.02	2 735 641.98		R16	-78 360.83	2 738 070.80			
L17	-76 615.40	2 735 645.65		R17	-78 257.93	2 737 915.10			
L18	-76 594.79	2 735 616.06		R18	-77 678.19	2 737 072.46			
L19	-76 604.42	2 735 612.38		R19	-77 198.51	2 736 375.26			
L20	-76 592.89	2 735 568.58		R20	-77 137.31	2 736 286.32			
L21	-76 345.71	2 735 221.46		R21	-77 124.60	2 736 241.02			
L22	-75 625.57	2 734 206.89		R22	-77 133.16	2 736 235.84			
L23	-75 440.91	2 733 946.99		R23	-77 118.99	2 736 215.18			
L24	-75 242.34	2 733 655.93		R24	-77 110.42	2 736 220.35			
L25	-75 165.48	2 733 510.66		R25	-77 072.14	2 736 190.91			
L26	-75 115.63	2 733 384.41		R26	-76 652.55	2 735 580.06			
L27	-74 816.49	2 732 627.25		R27	-76 380.03	2 735 197.19			
L28	-74 797.83	2 732 573.37		R28	-75 659.77	2 734 184.50			
L29	-74 785.86	2 732 504.31		R29	-75 398.94	2 733 825.00			
L30	-74 783.60	2 732 459.95		R30	-75 269.73	2 733 630.85			
L31	-74 788.43	2 732 402.89		R31	-75 201.89	2 733 494.04			
L32	-74 801.14	2 732 347.03		R32	-75 148.89	2 733 370.90			
L33	-74 973.82	2 731 996.23		R33	-75 099.13	2 733 241.76			
L34	-75 064.41	2 731 812.42		R34	-74 854.31	2 732 614.08			
L35	-75 135.38	2 731 646.01		R35	-74 834.77	2 732 553.96			
L36	-75 163.46	2 731 572.96		R36	-74 826.02	2 732 484.42			
L37	-75 189.96	2 731 497.62		R37	-74 826.83	2 732 427.66			
L38	-75 251.22	2 731 325.90		R38	-74 838.81	2 732 365.31			
L39	-75 275.15	2 731 250.96		R39	-75 030.77	2 731 972.10			
L40	-75 341.51	2 731 059.63		R40	-75 100.55	2 731 829.17			
L41	-75 394.13	2 730 901.60		R41	-75 172.32	2 731 661.12			
L42	-75 437.20	2 730 779.31		R42	-75 200.86	2 731 586.52			
L43	-75 471.72	2 730 656.08		R43	-75 238.46	2 731 480.53			
L44	-75 488.36	2 730 549.77		R44	-75 288.85	2 731 338.54			
L45	-75 492.75	2 730 494.08		R45	-75 313.13	2 731 263.19			
L46	-75 495.19	2 730 424.60		R46	-75 351.76	2 731 125.40			
L47	-75 487.53	2 730 284.30		R47	-75 390.12	2 731 015.92			
L48	-75 452.47	2 729 893.90		R48	-75 423.79	2 730 932.63			
L49	-75 297.13	2 728 081.46		R49	-75 467.25	2 730 810.98			
L50	-75 288.02	2 728 007.32		R50	-75 490.03	2 730 726.58			
L51	-75 277.45	2 727 934.36		R51	-75 506.24	2 730 651.03			
					Vel Sheet	14	Van of	19	P994/17

PADRESERVE KOÖRDINATE / ROAD RESERVE CO-ORDINATES									
LINKERKANT/LEFT HAND SIDE					REGTERKANT/RIGHT HAND SIDE				
	Y	X	WG 29°			Y	X		
L52	-75 258.41	2 727 841.20		R52	-75 527.71	2 730 521.43			
L53	-75 240.29	2 727 771.39		R53	-75 532.41	2 730 442.24			
L54	-75 175.99	2 727 554.54		R54	-75 530.02	2 730 320.43			
L55	-74 953.72	2 726 859.81		R55	-75 430.58	2 729 170.73			
L56	-74 833.65	2 726 472.62		R56	-75 333.62	2 728 077.61			
L57	-74 749.00	2 726 212.76		R57	-75 323.77	2 727 999.90			
L58	-74 703.02	2 726 091.79		R58	-75 312.51	2 727 927.40			
L59	-74 662.49	2 726 002.10		R59	-75 293.51	2 727 834.00			
L60	-74 393.72	2 725 545.87		R60	-75 276.19	2 727 764.44			
L61	-74 329.67	2 725 431.01		R61	-75 208.06	2 727 537.11			
L62	-74 264.06	2 725 322.53		R62	-74 904.82	2 726 573.34			
L63	-74 041.62	2 724 976.34		R63	-74 856.37	2 726 424.00			
L64	-73 782.54	2 724 559.44		R64	-74 841.78	2 726 382.54			
L65	-73 746.12	2 724 494.19		R65	-74 787.91	2 726 204.82			
L66	-73 704.57	2 724 418.13		R66	-74 760.04	2 726 117.21			
L67	-73 653.44	2 724 304.38		R67	-74 691.96	2 725 970.93			
L68	-73 602.13	2 724 192.61		R68	-74 675.35	2 725 935.87			
L69	-73 279.85	2 723 504.12		R69	-74 533.06	2 725 694.55			
L70	-73 100.74	2 723 120.56		R70	-74 428.48	2 725 526.01			
L71	-73 029.76	2 722 978.69		R71	-74 364.35	2 725 410.91			
L72	-72 968.03	2 722 870.84		R72	-74 075.47	2 724 954.90			
L73	-72 933.88	2 722 827.08		R73	-73 817.90	2 724 540.62			
L74	-72 890.60	2 722 777.33		R74	-73 777.91	2 724 468.66			
L75	-72 655.72	2 722 550.22		R75	-73 755.14	2 724 424.29			
L76	-72 580.73	2 722 477.66		R76	-73 686.45	2 724 277.64			
L77	-72 512.13	2 722 398.95		R77	-73 314.38	2 723 482.79			
L78	-72 450.43	2 722 314.74		R78	-73 121.58	2 723 070.93			
L79	-72 396.02	2 722 225.61		R79	-73 065.93	2 722 955.64			
L80	-72 041.71	2 721 652.40		R80	-73 004.80	2 722 850.84			
L81	-71 853.11	2 721 345.01		R81	-72 964.87	2 722 801.77			
L82	-71 793.24	2 721 252.04		R82	-72 919.05	2 722 746.94			
L83	-71 679.08	2 721 062.58		R83	-72 852.57	2 722 676.82			
L84	-71 588.70	2 720 924.67		R84	-72 669.14	2 722 507.34			
L85	-71 563.72	2 720 885.87		R85	-72 600.38	2 722 439.15			
L86	-71 449.64	2 720 733.90		R86	-72 537.22	2 722 365.36			
L87	-71 369.41	2 720 646.44		R87	-72 480.52	2 722 286.70			
L88	-71 282.30	2 720 560.47		R88	-72 430.27	2 722 203.82			
L89	-71 225.20	2 720 508.31		R89	-71 660.28	2 720 961.78			
L90	-71 124.94	2 720 425.69		R90	-71 599.65	2 720 864.44			
L91	-70 880.83	2 720 231.13		R91	-71 553.03	2 720 798.83			
L92	-70 741.76	2 720 122.92		R92	-71 492.56	2 720 718.35			
L93	-70 596.60	2 720 015.27		R93	-71 412.26	2 720 629.55			
L94	-70 494.11	2 719 923.81		R94	-71 351.23	2 720 567.40			
L95	-70 462.44	2 719 897.88		R95	-71 235.15	2 720 463.92			
L96	-70 349.97	2 719 803.09		R96	-71 120.57	2 720 372.85			
L97	-70 255.02	2 719 739.63		R97	-70 680.38	2 720 019.79			
L98	-70 131.01	2 719 618.49		R98	-70 503.45	2 719 880.39			
L99	-69 971.38	2 719 438.73		R99	-70 348.93	2 719 759.00			
L100	-69 903.71	2 719 368.23		R100	-70 269.91	2 719 690.05			
L101	-69 829.28	2 719 304.23		R101	-70 186.32	2 719 611.87			
L102	-69 748.99	2 719 247.92		R102	-69 994.13	2 719 403.99			
					<div> <div>Vel</div> <div>Sheet</div> </div> <div>15</div> <div>Van</div> <div>of</div> <div>19</div> <div>P994/17</div>				

PADRESERVE KOÖRDINATE / ROAD RESERVE CO-ORDINATES									
LINKERKANT/LEFT HAND SIDE					REGTERKANT/RIGHT HAND SIDE				
	Y	X	WG 29°			Y	X		
L103	-69 663.57	2 719	199.86		R103	-69 918.38	2 719	325.39	
L104	-69 573.89	2 719	160.11		R104	-69 834.12	2 719	255.40	
L105	-68 706.21	2 718	791.70		R105	-69 742.71	2 719	195.00	
L106	-68 548.06	2 718	730.55		R106	-69 645.33	2 719	145.03	
L107	-68 298.65	2 718	640.46		R107	-69 204.72	2 718	958.40	
L108	-68 201.93	2 718	605.53		R108	-69 111.00	2 718	915.62	
L109	-68 171.00	2 718	594.35		R109	-68 910.86	2 718	833.29	
L110	-68 142.78	2 718	584.16		R110	-68 455.90	2 718	653.64	
L111	-68 111.27	2 718	572.78		R111	-67 895.38	2 718	454.22	
L112	-68 097.14	2 718	567.67		R112	-67 399.72	2 718	275.78	
L113	-67 880.75	2 718	489.52		R113	-67 311.69	2 718	240.37	
L114	-67 524.19	2 718	364.68		R114	-67 249.83	2 718	212.18	
L115	-67 386.08	2 718	313.73		R115	-67 218.24	2 718	179.18	
L116	-67 204.39	2 718	236.85		R116	-67 227.26	2 718	166.96	
L117	-67 161.07	2 718	259.31		R117	-67 204.84	2 718	155.25	
L118	-67 100.12	2 718	181.06		R118	-67 195.80	2 718	167.40	
L119	-66 991.07	2 718	119.36		R119	-67 146.57	2 718	158.44	
L120	-66 833.14	2 718	014.85		R120	-67 036.67	2 718	099.50	
L121	-66 753.30	2 717	959.73		R121	-66 837.49	2 717	969.72	
L122	-66 701.38	2 717	918.32		R122	-66 773.50	2 717	919.82	
L123	-66 620.90	2 717	848.92		R123	-66 664.50	2 717	830.21	
L124	-66 576.68	2 717	808.67		R124	-66 589.83	2 717	760.66	
L125	-66 452.85	2 717	676.65		R125	-66 532.18	2 717	706.30	
L126	-66 062.94	2 717	258.39		R126	-66 261.62	2 717	413.18	
L127	-65 992.06	2 717	178.89		R127	-65 329.84	2 716	415.18	
L128	-65 782.74	2 716	958.26		R128	-65 016.83	2 716	078.73	
L129	-65 756.88	2 716	949.81		R129	-64 549.54	2 715	577.00	
L130	-65 738.13	2 716	927.30		R130	-64 477.98	2 715	495.29	
L131	-65 729.34	2 716	900.78		R131	-64 399.34	2 715	420.14	
L132	-65 301.46	2 716	440.30		R132	-64 314.54	2 715	352.13	
L133	-64 875.20	2 715	990.71		R133	-64 224.11	2 715	291.59	
L134	-64 398.81	2 715	477.90		R134	-64 128.89	2 715	239.26	
L135	-64 311.10	2 715	404.36		R135	-64 029.34	2 715	195.45	
L136	-64 217.17	2 715	338.60		R136	-63 559.96	2 714	996.00	
L137	-64 117.78	2 715	281.51		R137	-62 989.02	2 714	747.84	
L138	-64 014.00	2 715	233.02		R138	-62 933.45	2 714	723.51	
L139	-63 455.81	2 714	992.21		R139	-62 877.60	2 714	696.21	
L140	-63 031.96	2 714	808.10		R140	-62 786.16	2 714	647.68	
L141	-62 917.68	2 714	757.74		R141	-62 662.05	2 714	573.04	
L142	-62 767.08	2 714	679.80		R142	-62 525.52	2 714	477.01	
L143	-62 630.85	2 714	597.29		R143	-62 016.02	2 714	075.71	
L144	-62 494.16	2 714	501.62		R144	-61 094.65	2 713	343.32	
L145	-61 985.40	2 714	102.06		R145	-61 093.11	2 713	313.35	
L146	-61 452.24	2 713	677.23		R146	-61 050.42	2 713	279.87	
L147	-61 063.91	2 713	370.08		R147	-61 026.36	2 713	284.01	
L148	-61 039.81	2 713	374.28		R148	-60 813.22	2 713	114.63	
L149	-60 997.14	2 713	340.92		R149	-60 250.44	2 712	667.38	
L150	-60 995.88	2 713	316.21		R150	-60 161.60	2 712	603.79	
L151	-58 745.03	2 711	531.36		R151	-59 020.93	2 711	699.23	
L152	-58 008.85	2 710	948.96		R152	-58 108.93	2 710	975.59	
L153	-57 960.94	2 710	922.83		R153	-57 754.42	2 710	686.32	
					Vel Sheet	16	Van of	19	P994/17

PADRESERVE KOÖRDINATE / ROAD RESERVE CO-ORDINATES														
LINKERKANT/LEFT HAND SIDE					REGTERKANT/RIGHT HAND SIDE									
	Y	X	WG	29°		Y	X							
L154	-57 610.48	2 710 641.62			R154	-57 653.61	2 710 609.11							
L155	-57 575.97	2 710 614.00			R155	-57 612.52	2 710 577.68							
L156	-57 255.68	2 710 334.61			R156	-57 425.05	2 710 427.29							
L157	-57 089.10	2 710 174.37			R157	-57 282.45	2 710 305.47							
L158	-57 027.72	2 710 122.03			R158	-57 077.89	2 710 102.45							
L159	-56 972.67	2 710 095.38			R159	-56 964.60	2 709 974.00							
L160	-56 829.04	2 709 893.71			R160	-56 879.92	2 709 889.94							
L161	-56 734.04	2 709 777.28			R161	-56 816.57	2 709 820.31							
L162	-56 589.66	2 709 585.26			R162	-56 624.88	2 709 565.16							
L163	-56 522.10	2 709 488.25			R163	-56 475.79	2 709 345.24							
L164	-56 412.76	2 709 321.31			R164	-56 401.16	2 709 228.78							
L165	-56 318.39	2 709 160.81			R165	-56 259.39	2 708 969.88							
L166	-56 221.79	2 708 982.88			R166	-55 322.10	2 707 199.04							
L167	-55 512.55	2 707 643.25			R167	-55 183.71	2 706 935.55							
L168	-55 479.50	2 707 612.50			R168	-55 129.60	2 706 822.51							
L169	-55 470.76	2 707 620.68			R169	-54 945.70	2 706 409.44							
L170	-55 451.46	2 707 599.99			R170	-54 942.17	2 706 364.54							
L171	-55 465.80	2 707 586.61			R171	-54 932.12	2 706 340.60							
L172	-55 455.41	2 707 534.90			R172	-54 898.17	2 706 299.57							
L173	-55 145.74	2 706 949.38			R173	-54 630.83	2 705 676.18							
L174	-55 099.57	2 706 855.46			R174	-53 471.77	2 702 972.85							
L175	-54 901.22	2 706 408.22			R175	-52 185.46	2 699 973.15							
L176	-54 866.37	2 706 380.11			R176	-52 095.97	2 699 762.88							
L177	-54 849.37	2 706 331.38			R177	-52 016.08	2 699 583.00							
L178	-54 853.55	2 706 297.24			R178	-51 809.76	2 699 157.36							
L179	-54 573.60	2 705 644.03			R179	-51 396.78	2 698 316.35							
L180	-53 432.79	2 702 983.47			R180	-50 747.00	2 696 992.89							
L181	-52 150.15	2 699 980.56			R181	-50 363.71	2 696 211.24							
L182	-52 059.25	2 699 778.81			R182	-50 265.72	2 695 994.19							
L183	-51 979.86	2 699 599.83			R183	-50 079.25	2 695 551.69							
L184	-51 773.83	2 699 174.88			R184	-50 077.68	2 695 528.01							
L185	-51 355.93	2 698 323.80			R185	-50 091.47	2 695 522.34							
L186	-50 708.88	2 697 006.21			R186	-49 322.05	2 693 687.47							
L187	-50 327.83	2 696 229.37			R187	-48 791.93	2 691 496.02							
L188	-50 228.18	2 696 010.34			R188	-48 704.58	2 691 203.35							
L189	-50 036.00	2 695 545.45			R189	-48 402.67	2 690 191.67							
L190	-49 412.05	2 694 057.54			R190	-48 390.74	2 690 146.34							
L191	-49 383.07	2 693 988.45			R191	-48 297.37	2 689 838.79							
L192	-49 344.73	2 693 967.36			R192	-48 337.71	2 689 764.15							
L193	-49 334.88	2 693 943.65			R193	-48 263.05	2 689 723.80							
L194	-49 351.54	2 693 913.25			R194	-48 114.53	2 689 226.12							
L195	-49 264.80	2 693 706.20			R195	-48 066.92	2 689 079.62							
L196	-49 203.21	2 693 451.60			R196	-48 058.38	2 689 062.10							
L197	-48 733.88	2 691 511.52			R197	-48 058.71	2 689 028.55							
L198	-48 247.01	2 689 879.90			R198	-48 047.76	2 689 006.08							
L199	-48 215.90	2 689 863.09			R199	-48 021.12	2 688 985.70							
L200	-48 198.76	2 689 805.61			R200	-47 982.16	2 688 905.83							
L201	-48 215.56	2 689 774.51			R201	-47 933.28	2 688 824.48							
L202	-48 057.24	2 689 243.97			R202	-47 890.47	2 688 758.55							
L203	-48 011.16	2 689 102.15			R203	-47 840.89	2 688 692.76							
L204	-47 998.97	2 689 077.17			R204	-47 785.68	2 688 626.96							
					<table><tr><td>Vel Sheet</td><td>17</td><td>Van of</td><td>19</td><td>P994/17</td></tr></table>					Vel Sheet	17	Van of	19	P994/17
Vel Sheet	17	Van of	19	P994/17										

PADRESERWE KOÖRDINATE / ROAD RESERVE CO-ORDINATES														
LINKERKANT/LEFT HAND SIDE					REGTERKANT/RIGHT HAND SIDE									
	Y		X	WG 29°		Y		X						
L205	-47 985.71	2	689 061.38		R205	-47 770.16	2	688 611.44						
L206	-47 976.95	2	689 043.40		R206	-47 722.14	2	688 563.42						
L207	-47 972.68	2	689 023.24		R207	-47 660.71	2	688 506.13						
L208	-47 929.38	2	688 934.48		R208	-47 560.53	2	688 398.70						
L209	-47 882.39	2	688 856.28		R209	-47 552.86	2	688 384.79						
L210	-47 841.29	2	688 792.99		R210	-47 538.28	2	688 370.79						
L211	-47 793.92	2	688 730.12		R211	-47 474.64	2	688 279.90						
L212	-47 741.40	2	688 667.54		R212	-47 415.17	2	688 178.88						
L213	-47 680.43	2	688 606.57		R213	-47 360.64	2	688 071.86						
L214	-47 618.25	2	688 548.59		R214	-47 305.72	2	687 928.79						
L215	-47 600.46	2	688 529.51		R215	-47 269.52	2	687 793.69						
L216	-47 489.35	2	688 410.36		R216	-47 243.62	2	687 661.50						
L217	-47 491.50	2	688 408.59		R217	-47 234.15	2	687 551.83						
L218	-47 449.56	2	688 348.68		R218	-47 229.44	2	687 414.58						
L219	-47 412.04	2	688 337.57		R219	-47 269.40	2	686 826.38						
L220	-47 400.28	2	688 309.95		R220	-47 279.58	2	686 743.56						
L221	-47 408.52	2	688 285.25		R221	-47 335.34	2	686 484.26						
L222	-47 362.55	2	688 207.83		R222	-47 392.08	2	686 212.94						
L223	-47 349.39	2	688 182.00		R223	-47 590.34	2	685 284.47						
L224	-47 305.76	2	688 096.37		R224	-47 663.29	2	684 951.96						
L225	-47 248.59	2	687 947.41		R225	-47 899.14	2	683 852.79						
L226	-47 211.03	2	687 807.25		R226	-47 926.44	2	683 725.17						
L227	-47 184.32	2	687 669.82		R227	-47 950.05	2	683 600.85						
L228	-47 177.66	2	687 593.69		R228	-47 983.46	2	683 478.43						
L229	-47 174.33	2	687 555.63		R229	-48 026.46	2	683 359.14						
L230	-47 174.67	2	687 536.34		R230	-48 078.94	2	683 243.65						
L231	-47 172.99	2	687 517.18		R231	-48 140.38	2	683 132.65						
L232	-47 170.73	2	687 452.46		R232	-48 210.56	2	683 027.00						
L233	-47 149.84	2	687 431.35		R233	-48 288.67	2	682 927.07						
L234	-47 147.01	2	687 391.19		R234	-48 764.32	2	682 358.33						
L235	-47 173.82	2	687 367.43		R235	-48 916.39	2	682 176.85						
L236	-47 192.26	2	687 122.12		R236	-48 980.45	2	682 102.85						
L237	-47 213.26	2	686 842.91		R237	-49 033.49	2	682 042.32						
L238	-47 214.82	2	686 822.09		R238	-49 093.14	2	681 988.04						
L239	-47 351.46	2	686 216.79		R239	-49 158.47	2	681 940.79						
L240	-47 469.24	2	685 666.52		R240	-49 228.78	2	681 901.20						
L241	-47 567.24	2	685 215.52		R241	-49 303.08	2	681 869.90						
L242	-47 653.50	2	684 800.85		R242	-50 058.12	2	681 690.97						
L243	-47 843.34	2	683 920.66		R243	-50 634.07	2	681 562.88						
L244	-47 854.53	2	683 867.80		R244	-50 715.15	2	681 540.12						
L245	-47 887.46	2	683 712.79		R245	-50 771.36	2	681 519.78						
L246	-47 909.30	2	683 586.44		R246	-50 791.73	2	681 510.41						
L247	-47 942.20	2	683 462.21		R247	-50 830.38	2	681 485.14						
L248	-47 985.79	2	683 341.36		R248	-50 858.17	2	681 424.01						
L249	-48 039.83	2	683 224.73		R249	-50 863.22	2	681 401.98						
L250	-48 103.76	2	683 113.30		R250	-50 887.87	2	681 337.89						
L251	-48 177.28	2	683 007.88		R251	-50 900.36	2	681 327.24						
L252	-48 260.93	2	682 908.72		R252	-50 966.67	2	681 313.61						
L253	-48 321.53	2	682 836.67											
L254	-48 448.46	2	682 679.57											
L255	-48 747.67	2	682 320.56											
					<table><tr><td>Vel Sheet</td><td>18</td><td>Van of</td><td>19</td><td>P994/17</td></tr></table>					Vel Sheet	18	Van of	19	P994/17
Vel Sheet	18	Van of	19	P994/17										

This gazette is also available free online at www.gpwnonline.co.za