GOVERNMENT NOTICES • GOEWERMENTSKENNISGEWINGS

DEPARTMENT OF TRANSPORT

NO. 6656

19 September 2025

**THE SOUTH AFRICAN NATIONAL ROADS
AGENCY SOC LIMITED**Registration No: 1998/009584/30

**DECLARATION AMENDMENT OF NATIONAL ROAD R510 SECTION 3 AND DECLARATION OF
EXISTING ROAD THROUGH THE TOWN OF THABAZIMBI AND LEPHALALE AS PART OF
NATIONAL ROAD R510 SECTION 3**

- i) By virtue of Section 40 (1)(a) of The South African National Road Agency Limited and National Roads Act 1998 (Act No. 7 of 1998), I hereby declare the section of the road, known as Provincial Road, at the time of declaration, commencing from the intersection with the street known as Warmbad Avenue in Thabazimbi, at the time of declaration, up to points L1 and R1 on sheet 1 of Plan No. P755/09 of Declaration No. 989 of 2010, as a National Road.
- ii) By virtue of Section 40 (1)(a) of The South African National Road Agency Limited and National Roads Act 1998 (Act No. 7 of 1998), I hereby declare the section of the road known as OR Tambo Road, at the time of declaration, commencing from points L532 and R512 on sheet 19 of Plan No. P755/09 of Declaration No. 989 of 2010, up to the intersection between streets known as OR Tambo Road and Fox Odendaal Street in Lephalale, at the time of declaration, as a National Road.
- iii) By virtue of section 40(1)(b) of the South African National Roads Agency Limited and the National Roads Act 1998 (Act No. 7 of 1998), I hereby amend Declaration No. 989 of 2010 by substituting it in its entirety, with the accompanying sheets 1 to 39 of Plan No. P1180/19.

(National Road R510 Section 3: Thabazimbi – Lephalale)
MINISTER OF TRANSPORT

DEPARTEMENT VAN VERVOER

NO. 6656

19 September 2025

**DIE SUID-AFRIKAANSE NASIONALE
PADAGENTSAP MSB BEPERK**

Registrasie No: 1998/009584/30

**VERKLARING WYSIGING VAN NASIONALE PAD R510 SEKSIE 3 EN VERKLARING VAN
BESTAANDE PAD DEUR DIE DORPSGEBIED VAN THABAZIMBI EN LEPHALALE DEEL VAN
NASIONALE PAD R510 SEKSIE 3**

- i) Kragtens Artikel 40(1)(a) van die Suid-Afrikaanse Nasionale Padagentskap Beperk en Nasionale Paaie Wet 1998 (Wet No. 7 van 1998), verklaar ek hiermee die gedeelte van die pad bekend as Provinsiale Weg, tydens datum van verklaring, vanaf die interseksie met die straat bekend as Warmbadlaan in Thabazimbi, tydens datum van verklaring, tot by punte L1 en R1 op vel 1 van Plan No. P755/09 van Verklaring No. 989 van 2010, as 'n Nasionale Pad.
- ii) Kragtens Artikel 40(1)(a) van die Suid-Afrikaanse Nasionale Padagentskap Beperk en Nasionale Paaie Wet 1998 (Wet No. 7 van 1998), verklaar ek hiermee die gedeelte van die pad bekend as OR Tambo Weg tydens datum van verklaring, vanaf punte L532 en R512 op vel 19 van Plan No. P755/09 van Verklaring No. 989 van 2010, tot by die interseksie tussen die strate bekend as OR Tambo Weg en Fox Odendaalstraat in Lephalale, tydens datum van verklaring, as 'n Nasionale Pad.
- iii) Kragtens Artikel 40(1)(b) van die Suid-Afrikaanse Nasionale Padagentskap Beperk en Nasionale Paaie Wet 1998 (Wet No. 7 van 1998), wysig ek hiermee Verklaring No. 989 van 2010 deur dit in sy geheel te vervang, met bygaande velle 1 tot 39 van Plan No. P1180/19.

(Nasionale Pad R510 Seksie 3: Thabazimbi – Lephalale)
MINISTER VAN VERVOER

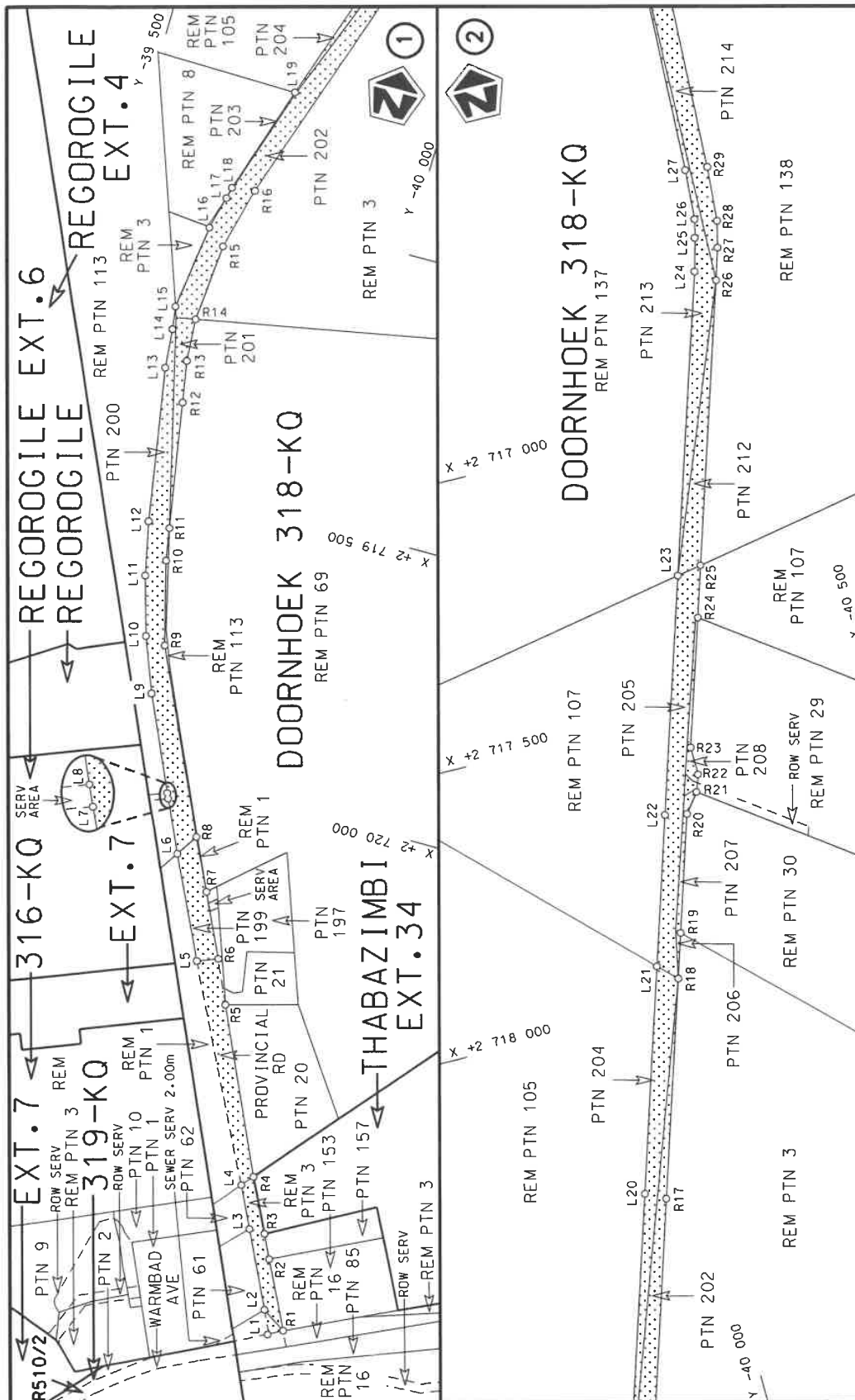

Die Suid Afrikaanse Nasionale Padagentskap MSB Bpk	Die figuur getoon		steldie padreserwe voor van 'n gedeelte represents the road reserve of a portion	Vel Sheet 1 of 39
The South African National Roads Agency SOC Ltd	The figure shown		van Nasionale Roete R510 of National Route	Plan P1180/19

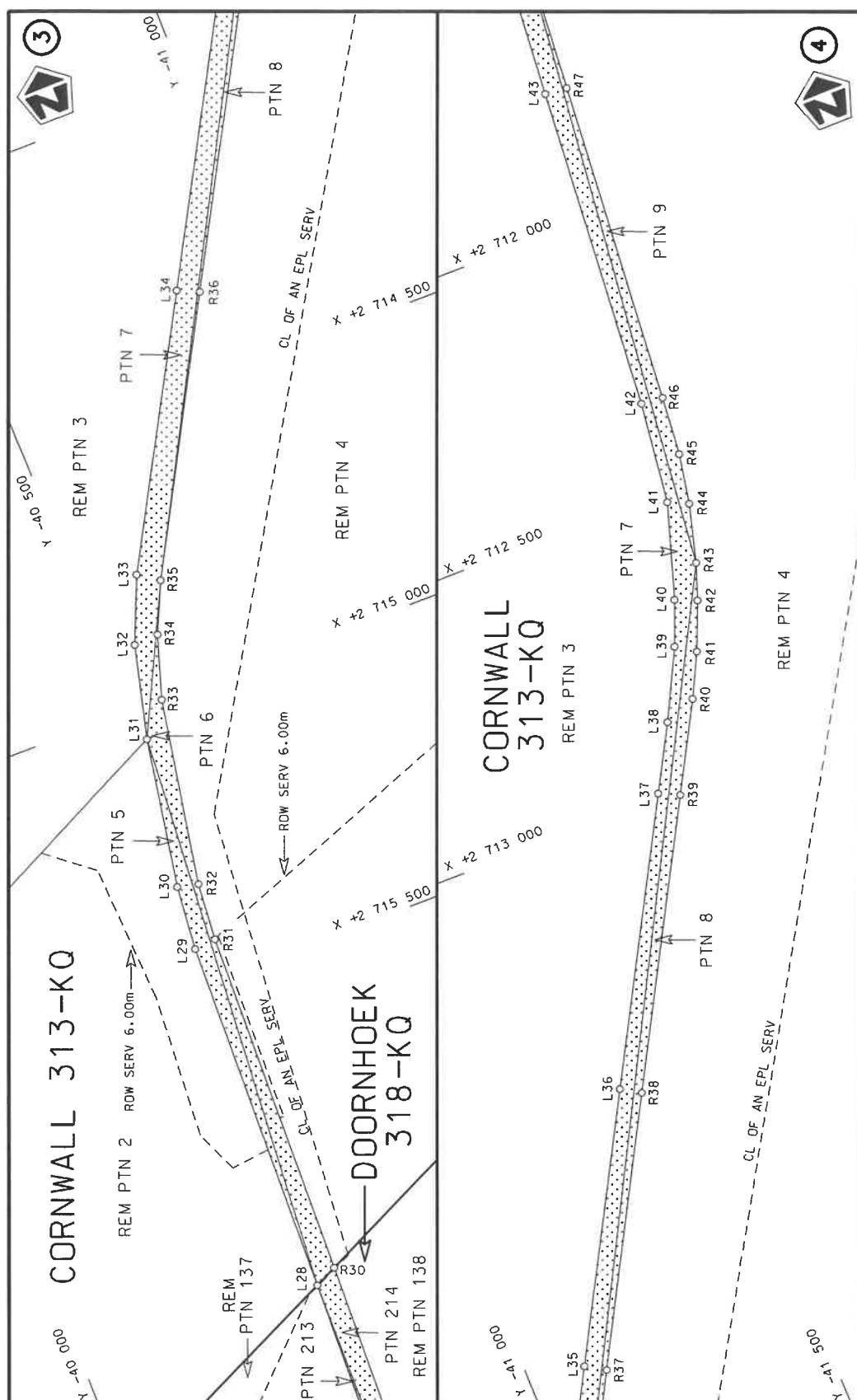

Die Suid Afrikaanse Nasionale Podagentskap MSB Bpk	Die figuur getoon		steldie padreserwe voor van 'n gedeelte represents the road reserve of a portion van Nasionale Roete R510 of National Route	Vel Sheet 2 of 39
The South African National Roads Agency SOC Ltd	The figure shown			3 Plan P1180/19

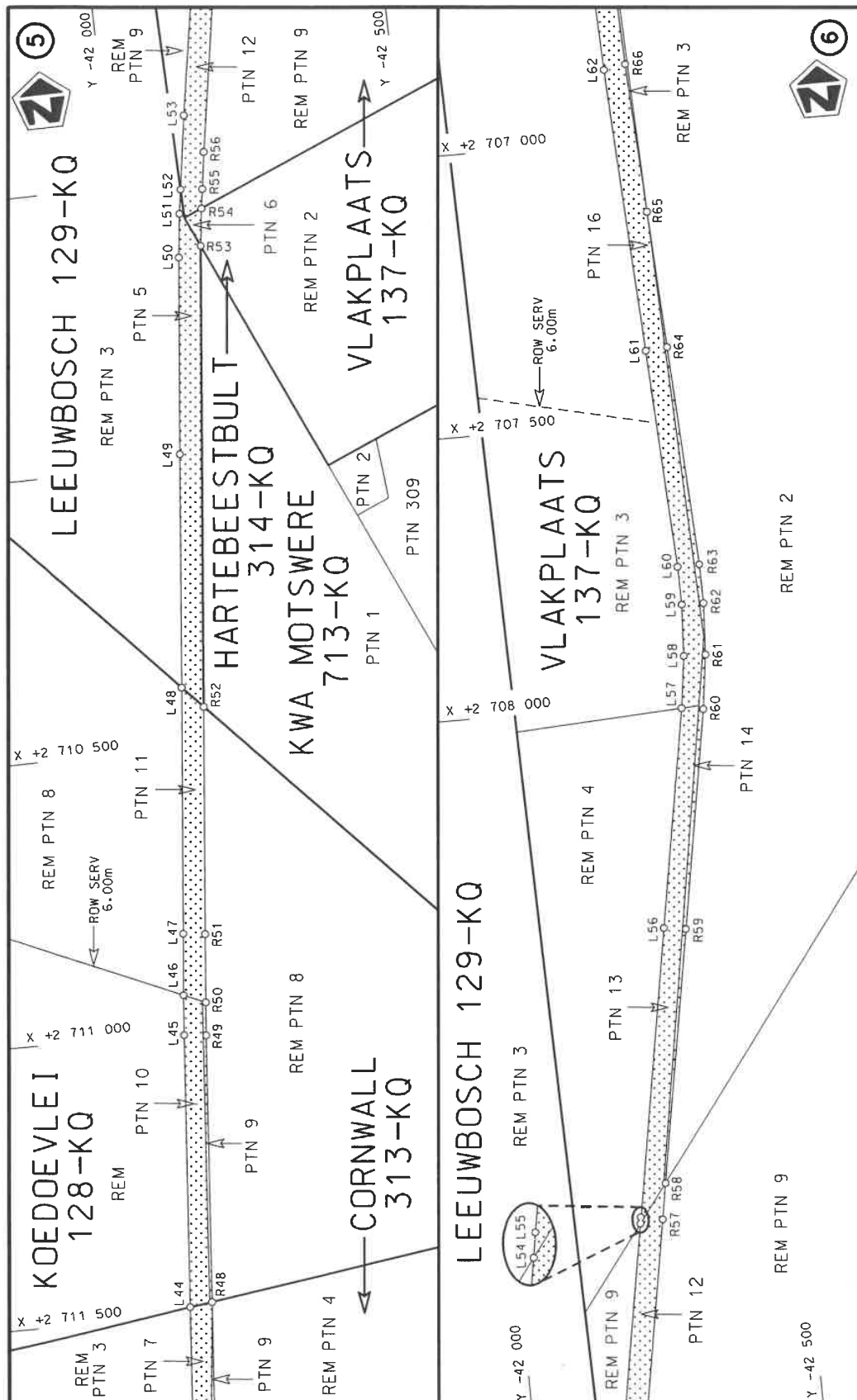

Die Suid Afrikaanse Nasionale Podagentskap MSB Bpk	Die figuur getoon		stel die padreserwe voor van 'n gedeelte represents the road reserve of a portion	Vel Sheet 3 of 39
The South African National Roads Agency SOC Ltd	The figure shown			

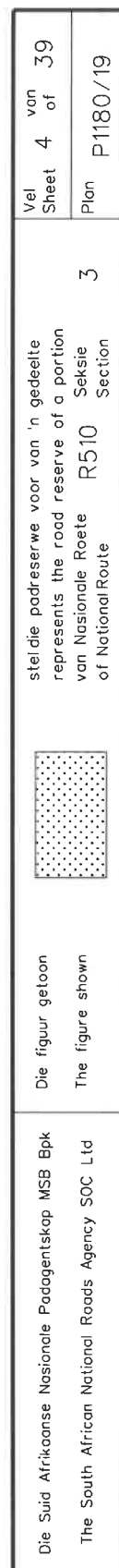

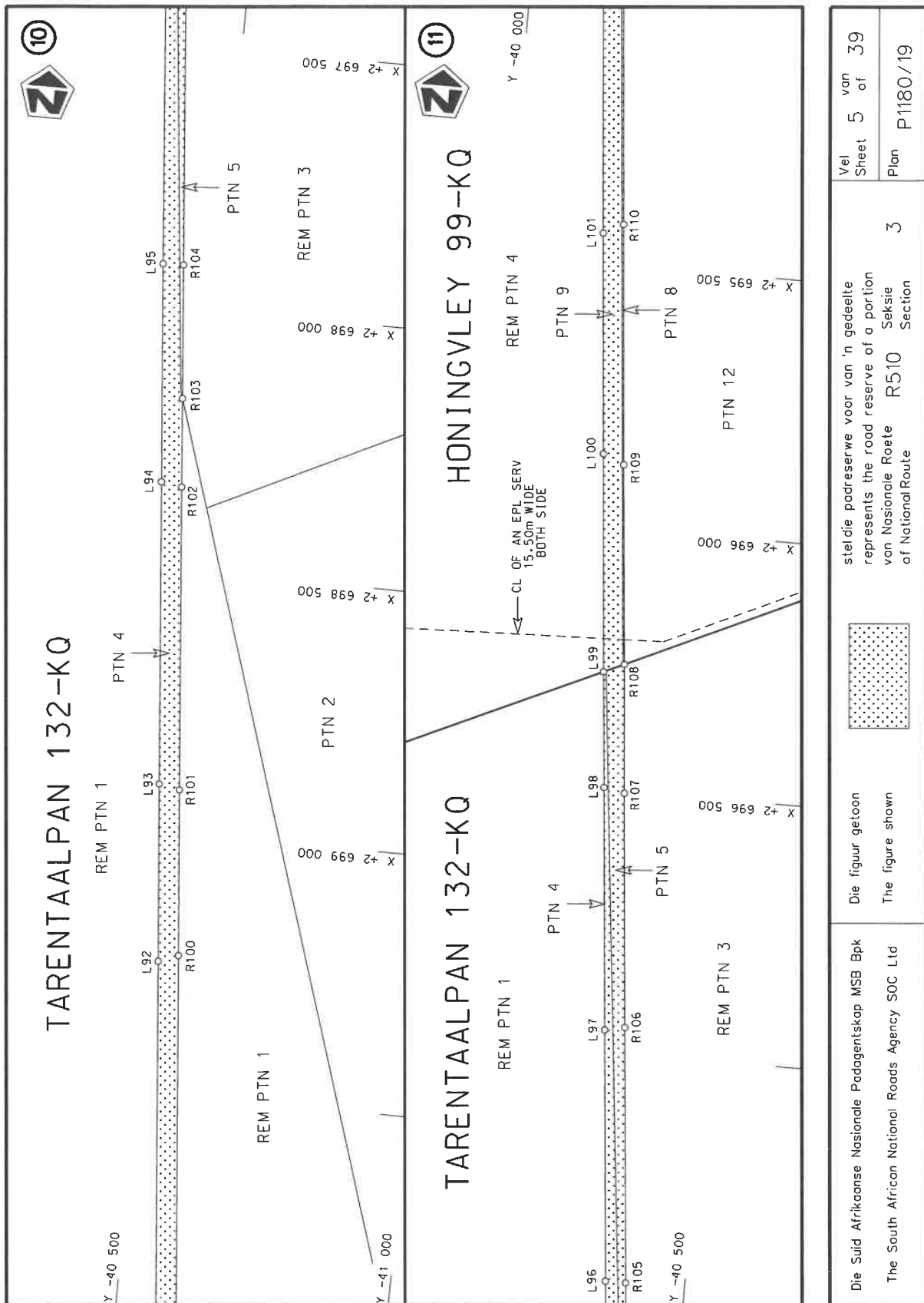

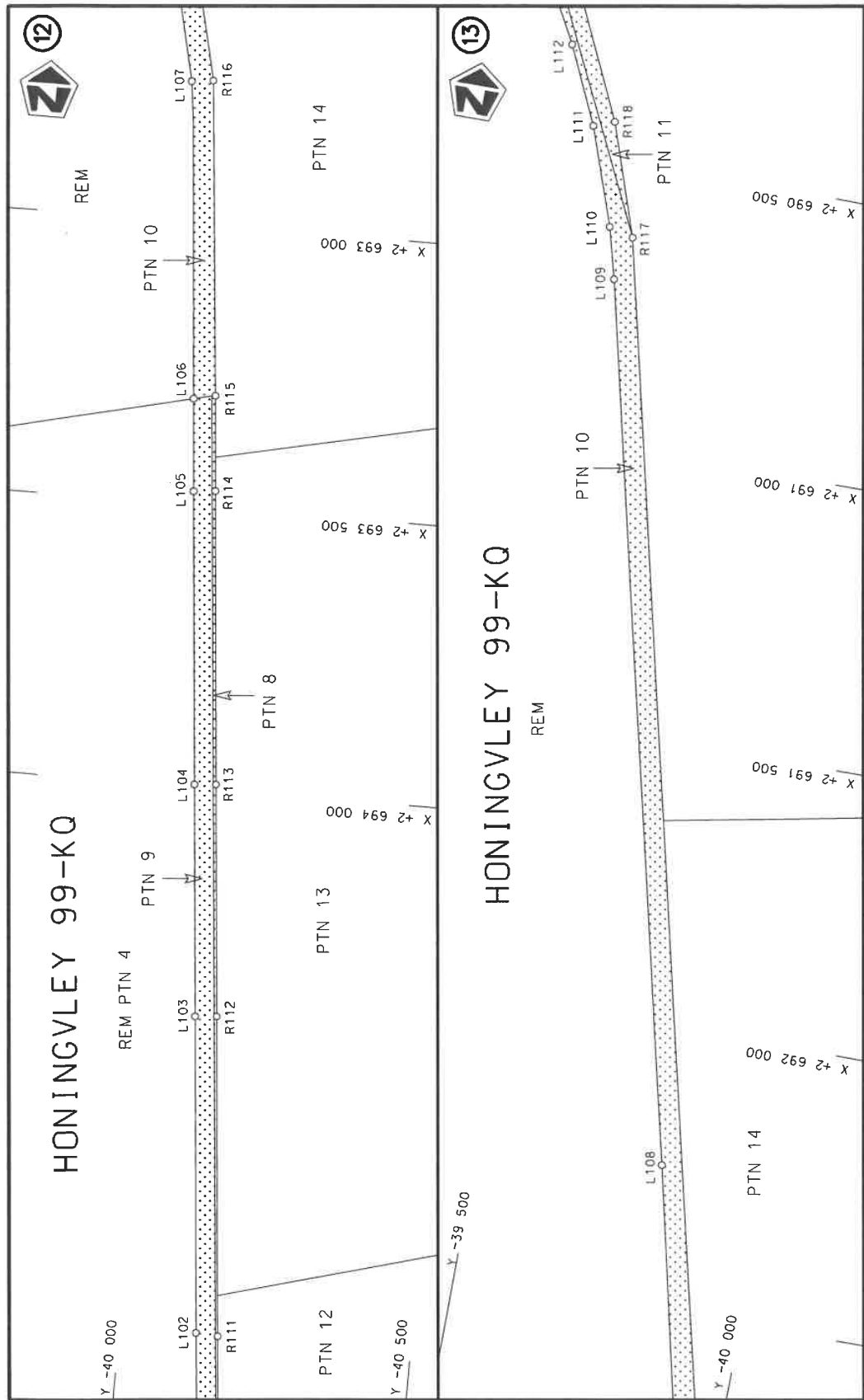

Die Suid Afrikaanse Nasionale Padagentskap MSB Bpk The South African National Roads Agency SOC Ltd	Die figuur getoon The figure shown	stel die padreserwe voor van 'n gedeelte represents the road reserve of a portion van Nasionale Roete R510 of National Route	Vel Sheet 6 of 39
		3	Plan P1180/19

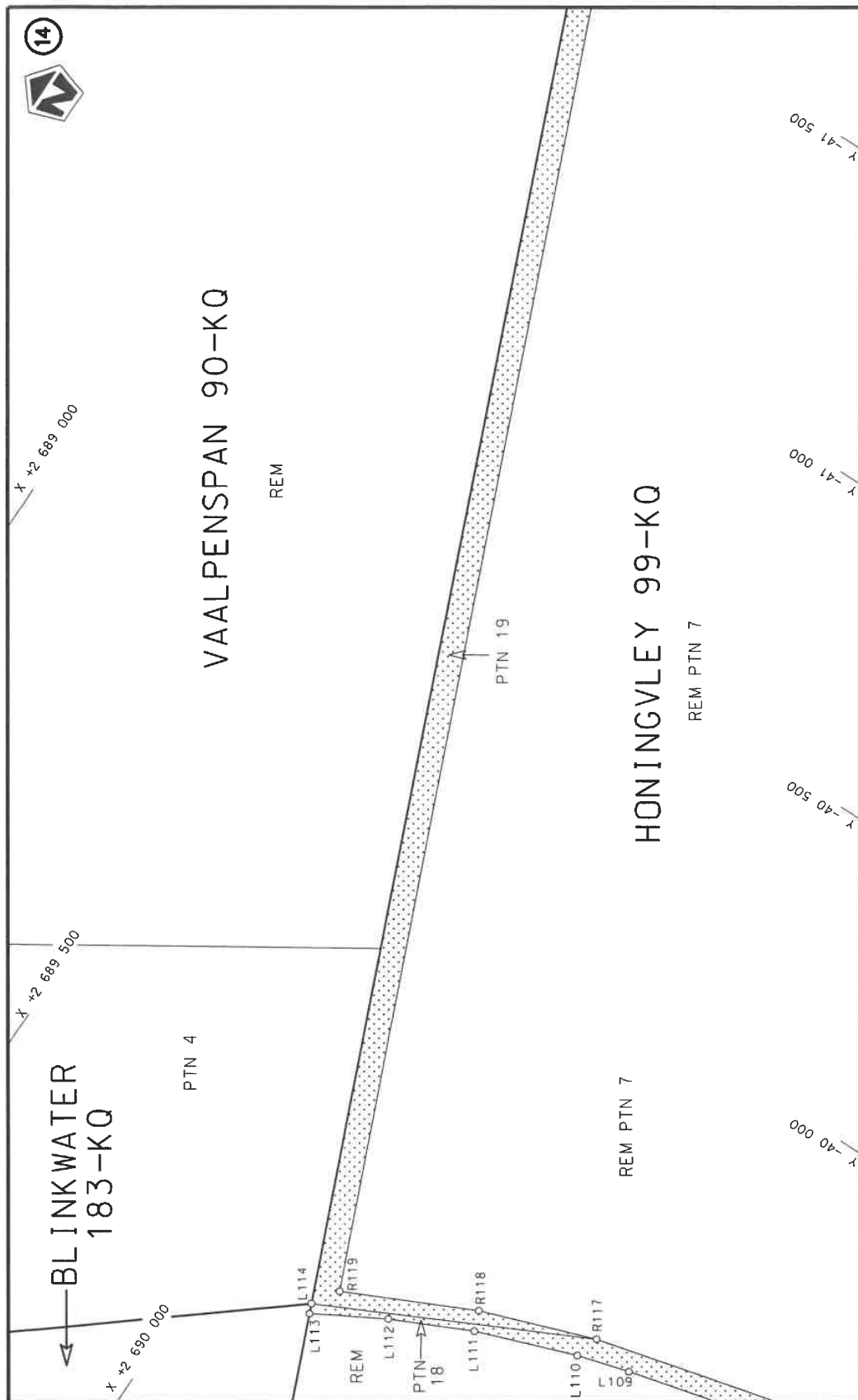

Die Suid Afrikaanse Nasionale Padagentskap MSB Bpk The South African National Roads Agency SOC Ltd	Die figuur getoon The figure shown		stel die padreserwe voor van 'n gedeelte represents the road reserve of a portion van Nasionale Roete R510 of National Route of National Route	Vel Sheet 7 of 39 Plan P1180/19
---	---------------------------------------	--	---	---------------------------------------

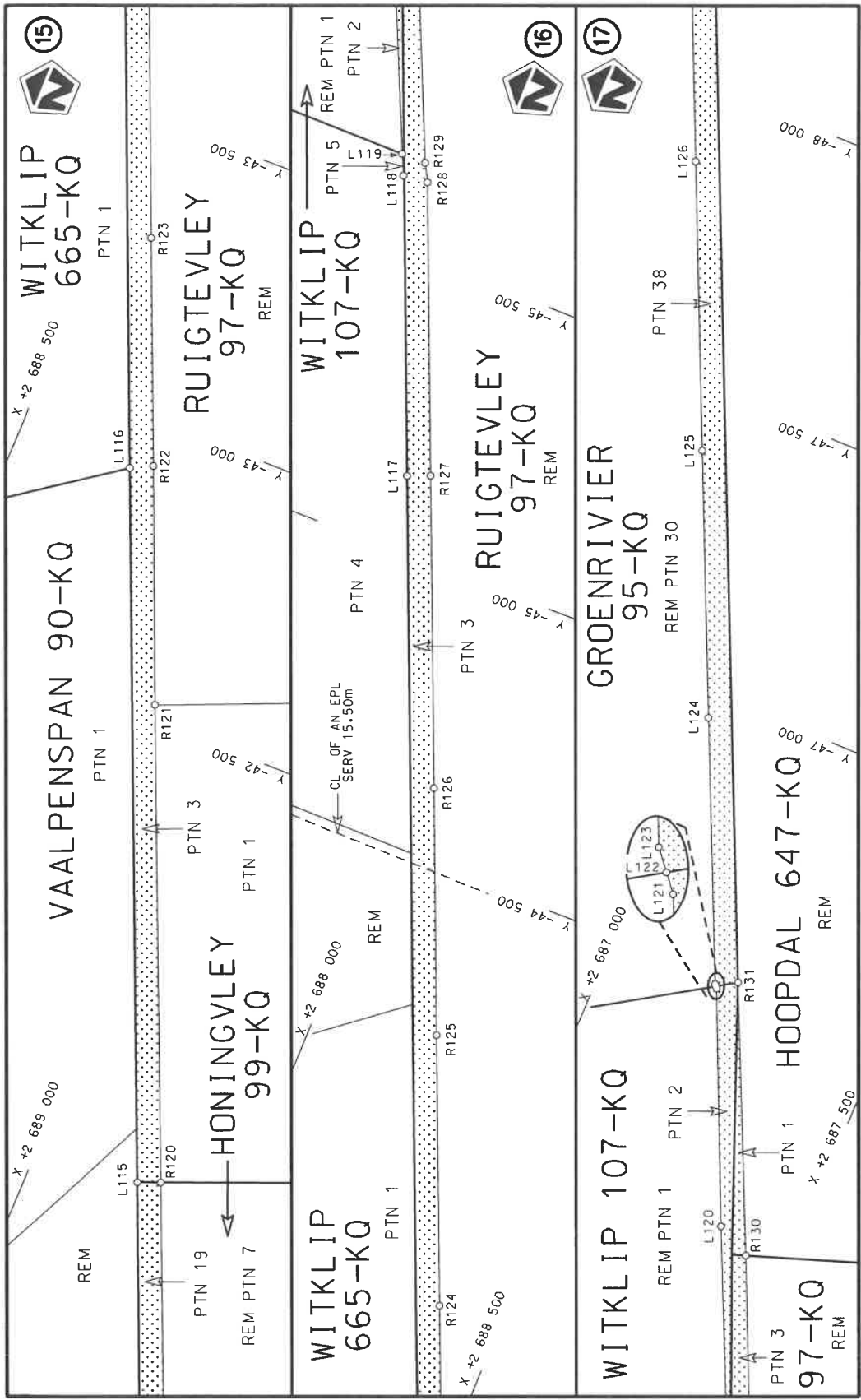

Die Suid Afrikaanse Nasionale Padagentskap MSB Bpk The South African National Roads Agency SOC Ltd	Die figuur getoon The figure shown	steldie padreserwe voor van 'n gedeelte represents the road reserve of a portion van Nasionale Roete R510 of National Route	Vel Sheet	van 8	of 39
			Plan	P1180/19	

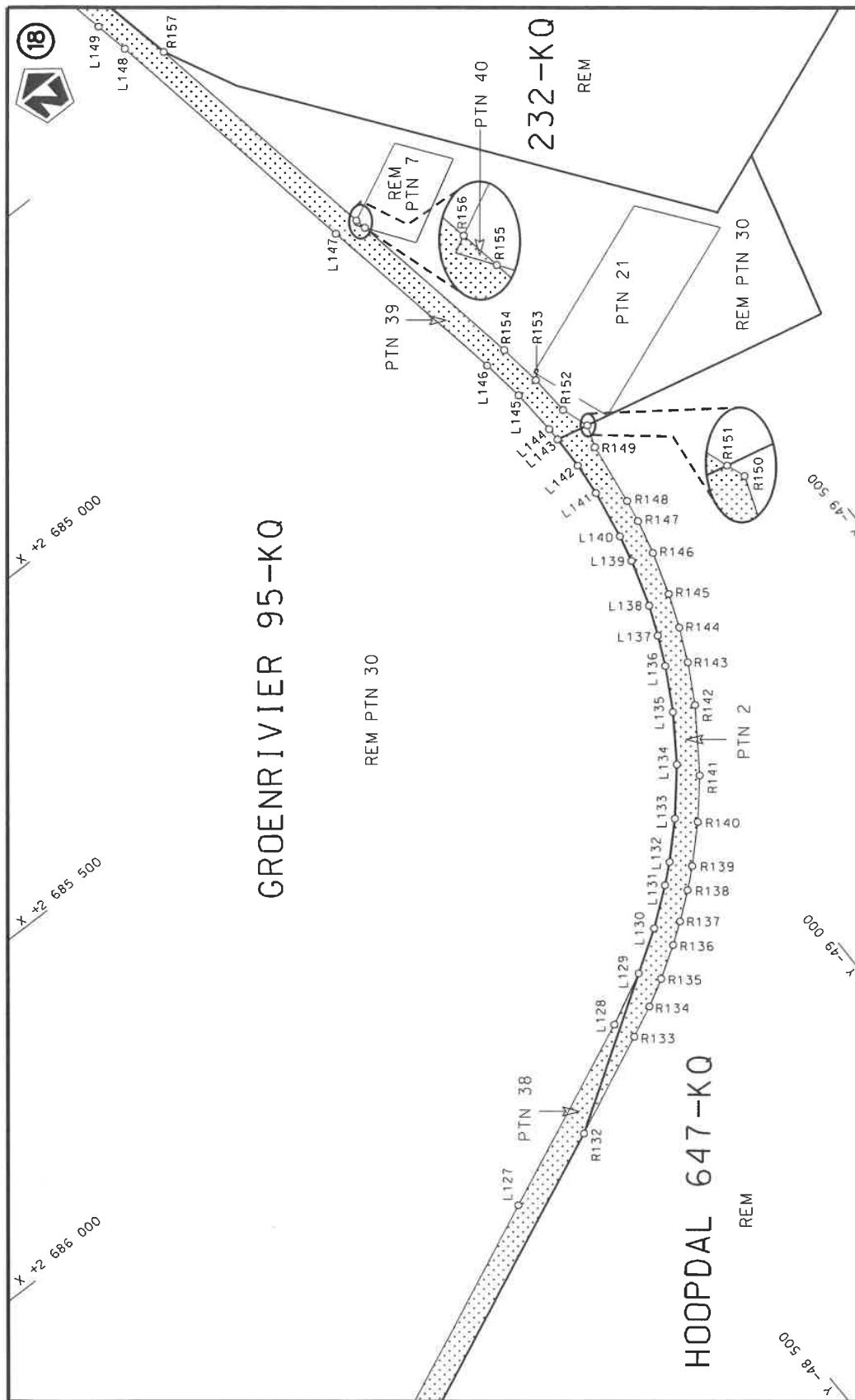

Vel Sheet 9 of 39 Plan P1180/19	steldie padreserwe voor van 'n gedeelte represents the road reserve of a portion van Nasionale Roete R510 of National Route Seksie Section 3	Die Suid Afrikaanse Nasionale Padagentskap MSB Bpk The South African National Roads Agency SOC Ltd
	Die figuur getoon The figure shown	

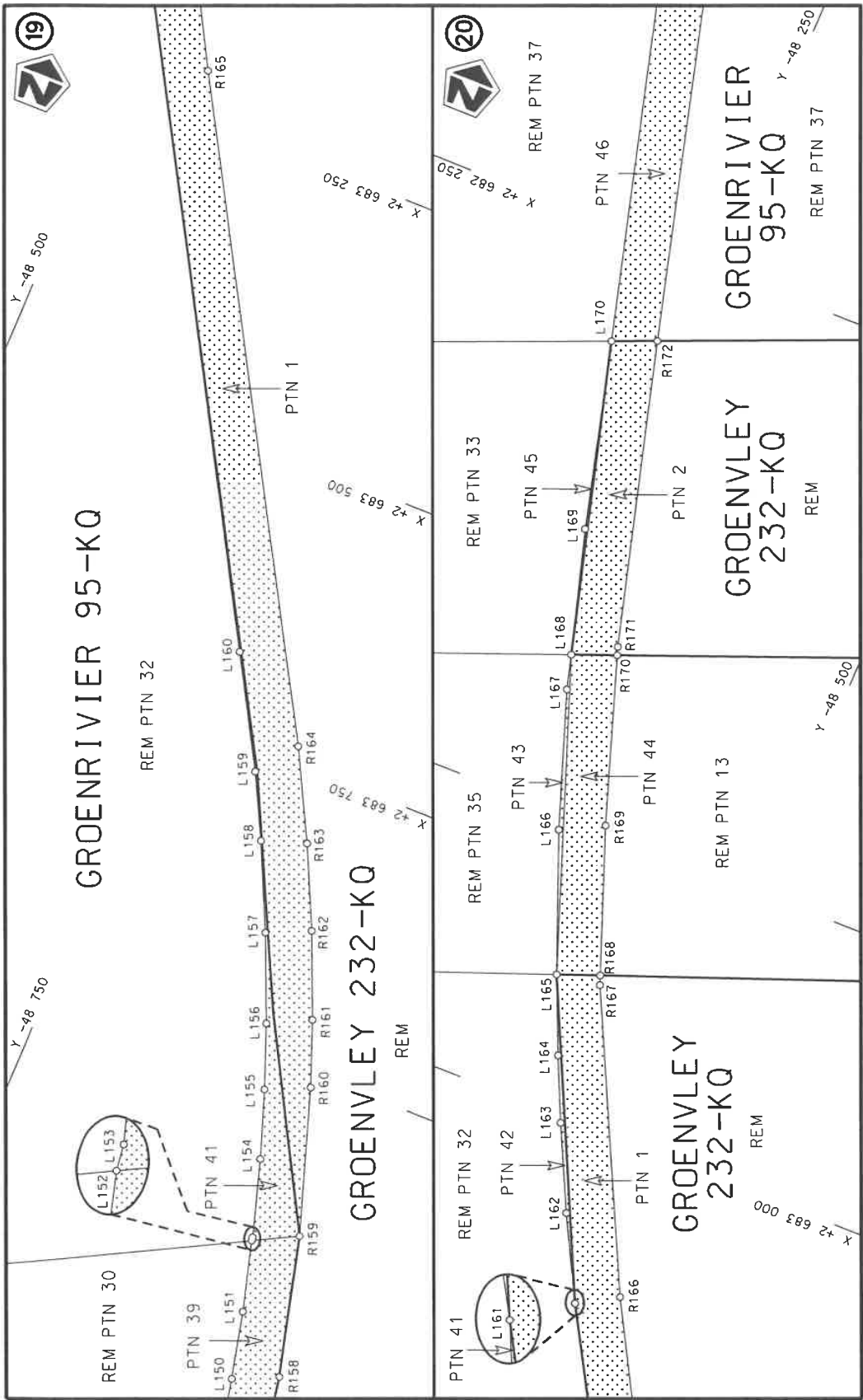

Die Suid Afrikaanse Nasionale Padagentskap MSB Bpk The South African National Roads Agency SOC Ltd	Die figuur getoon The figure shown	steldie padreserwe voor van 'n gedeelte represents the road reserve of a portion van Nasionale Roete R510 of National Route Section	Vel Sheet 10 of 39
		3	Plan P1180/19

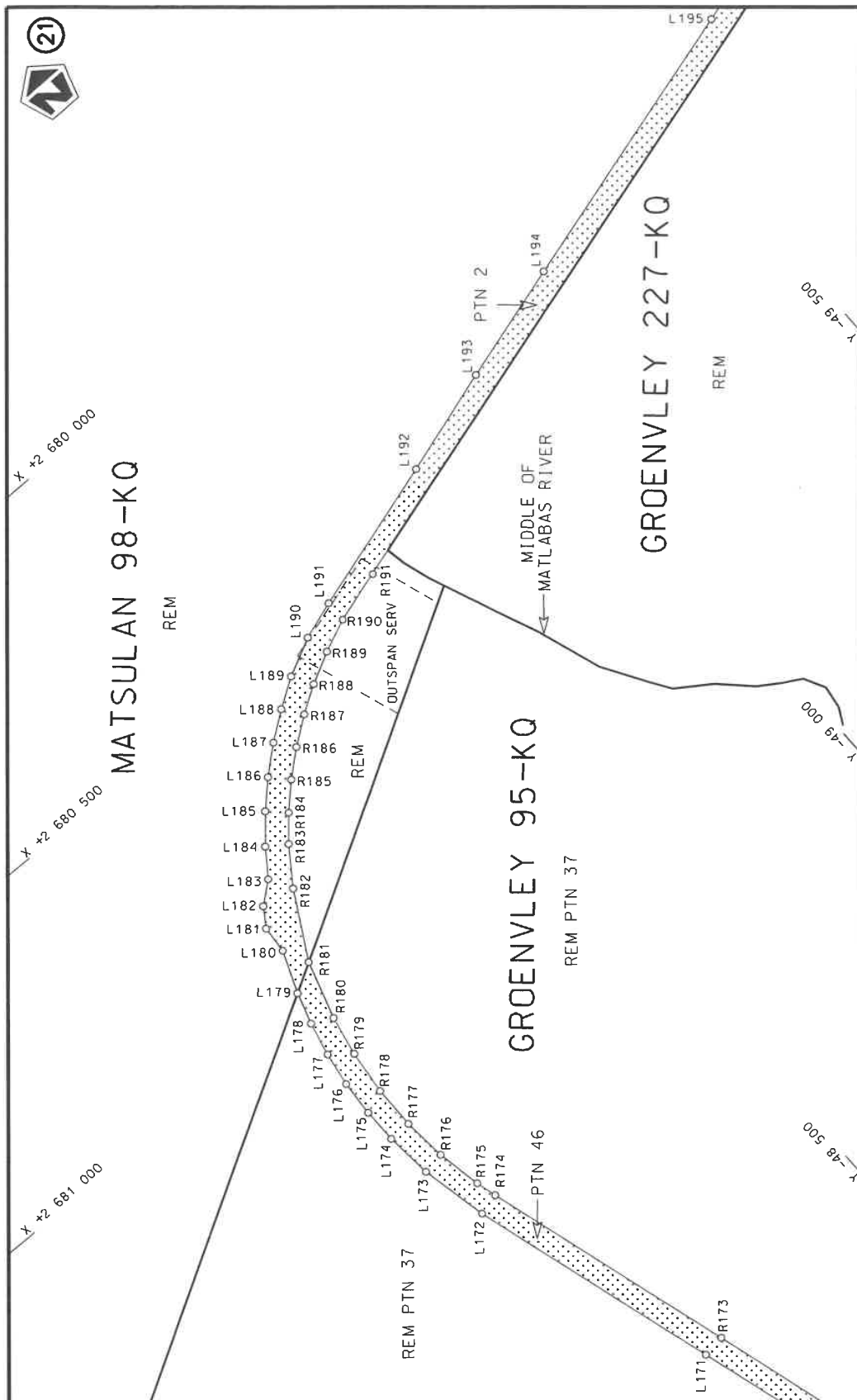

Vel Sheet 11 of 39	steldie podreserwe voor van 'n gedeelte represents the road reserve of a portion van Nasionale Roete R510 of National Route Section 3	Die figuur getoon The figure shown	Die Suid Afrikaanse Nasionale Podogentskap MSB Bpk The South African National Roads Agency SOC Ltd
--------------------------	--	---------------------------------------	---

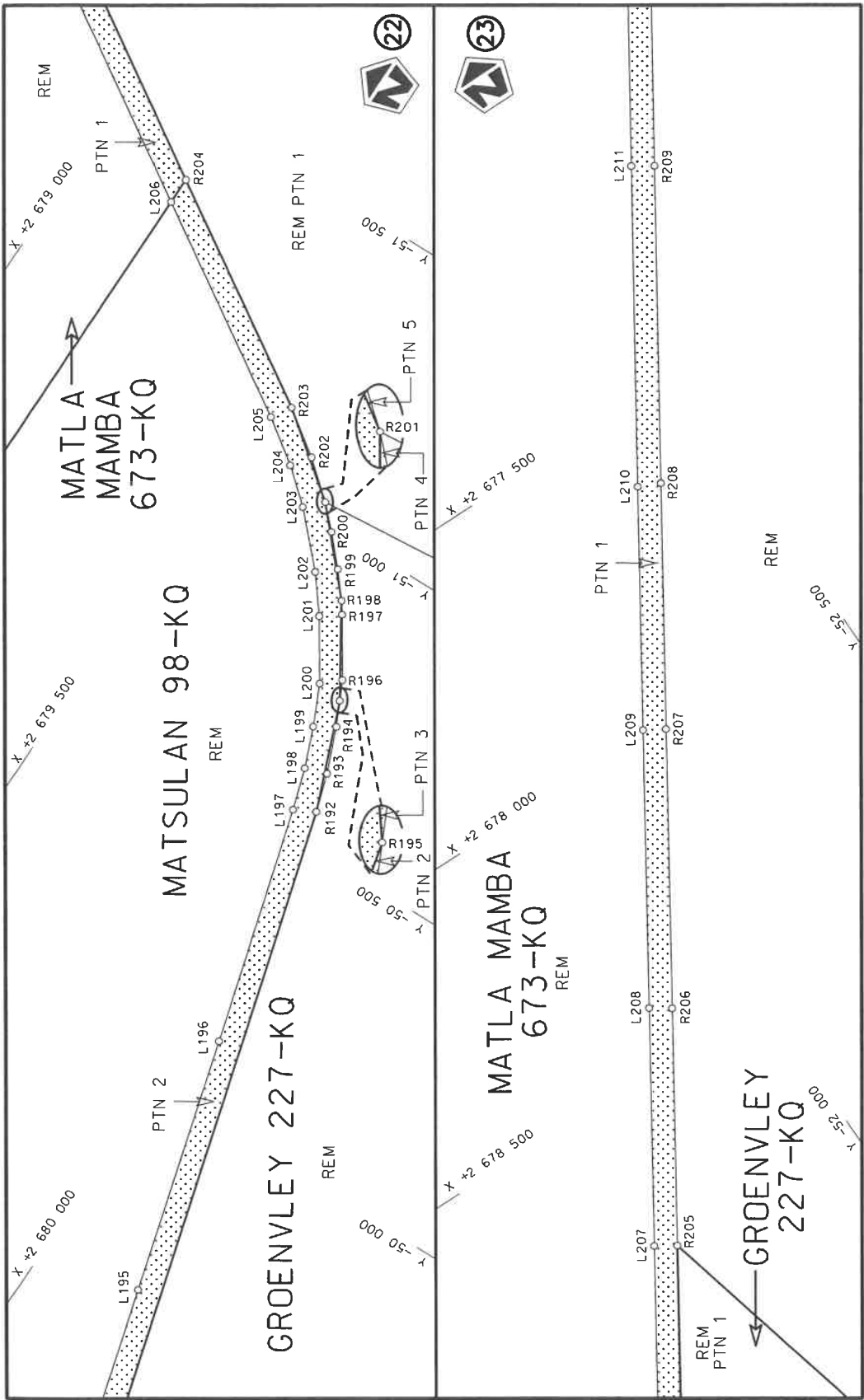

Die Suid Afrikaanse Nasionale Padagentskap MSB Bpk The South African National Roads Agency SOC Ltd	Die figuur getoon The figure shown	stelt die podreserwe voor van 'n gedeelte represents the road reserve of a portion van Nasionale Roete R510 of National Route Section	Vel Sheet 12 of 39
		3	Plan P1180/19

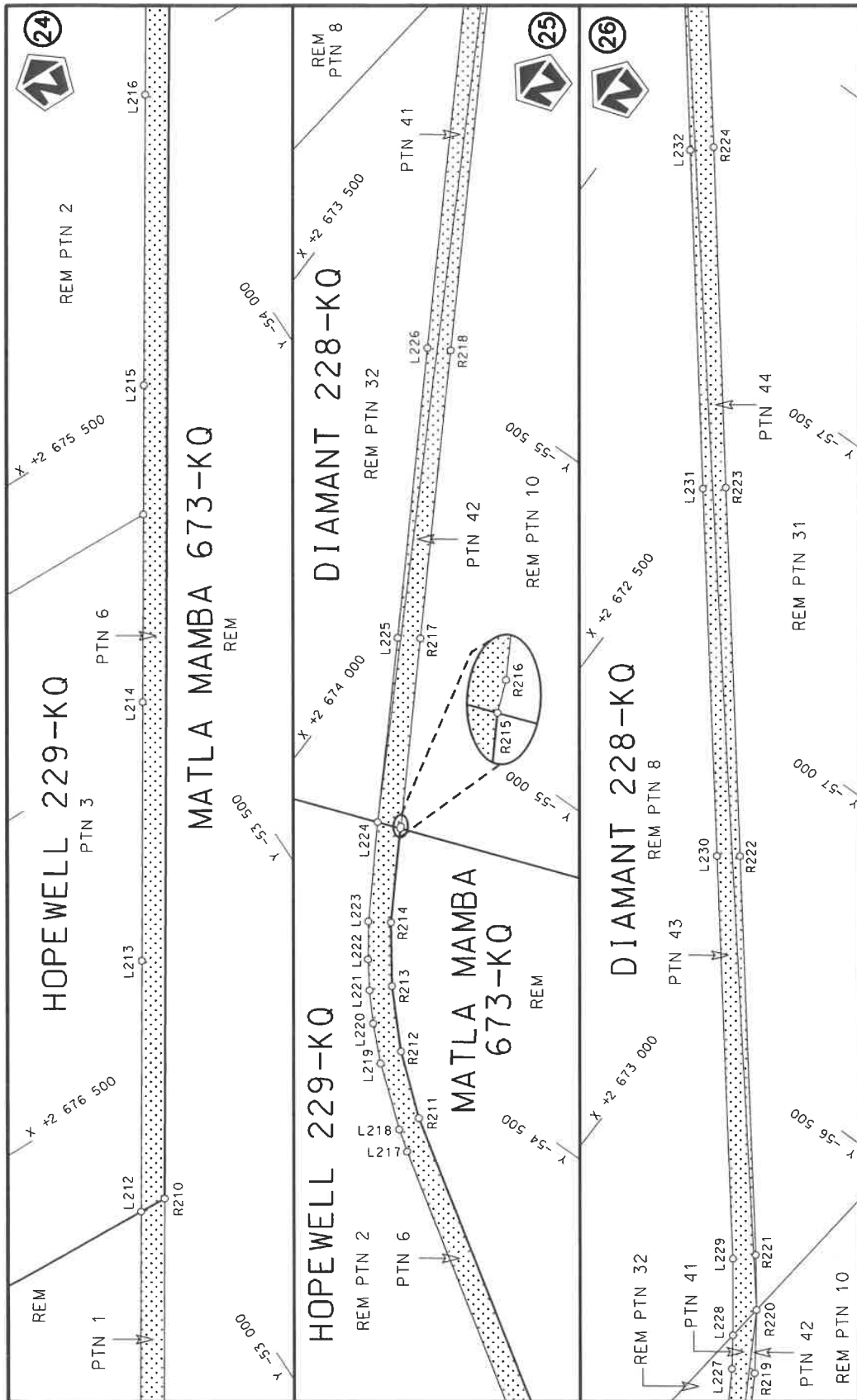

Die Suid Afrikaanse Nasionale Padagentskap MSB Bpk The South African National Roads Agency SOC Ltd	Die figuur getoon The figure shown	stel die padreserwe voor van 'n gedeelte represents the road reserve of a portion van Nasionale Roete R510 of National Route Section	Vel Sheet 13 of 39
		Plan P1180/19	

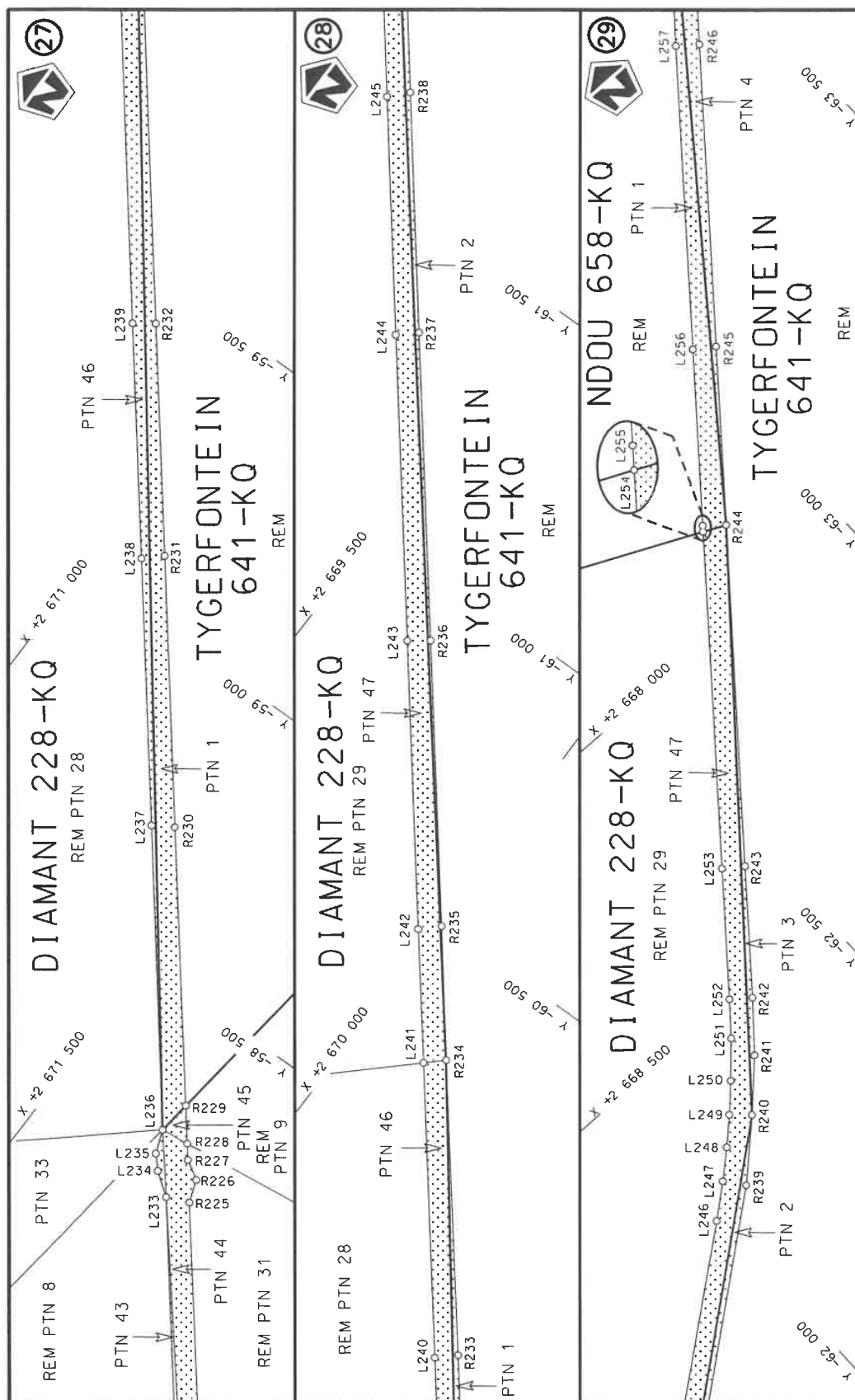

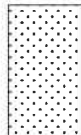
Vel Sheet 14 of 39	steldie padreserwe voor van 'n gedeelte represents the road reserve of a portion van Nasionale Roete R510 of National Route Seksie 3 Section P1180/19		Die figuur getoon The figure shown	Die Suid Afrikaanse Nasionale Padagentskap MSB Bpk The South African National Roads Agency SOC Ltd
--------------------------	--	---	---------------------------------------	---

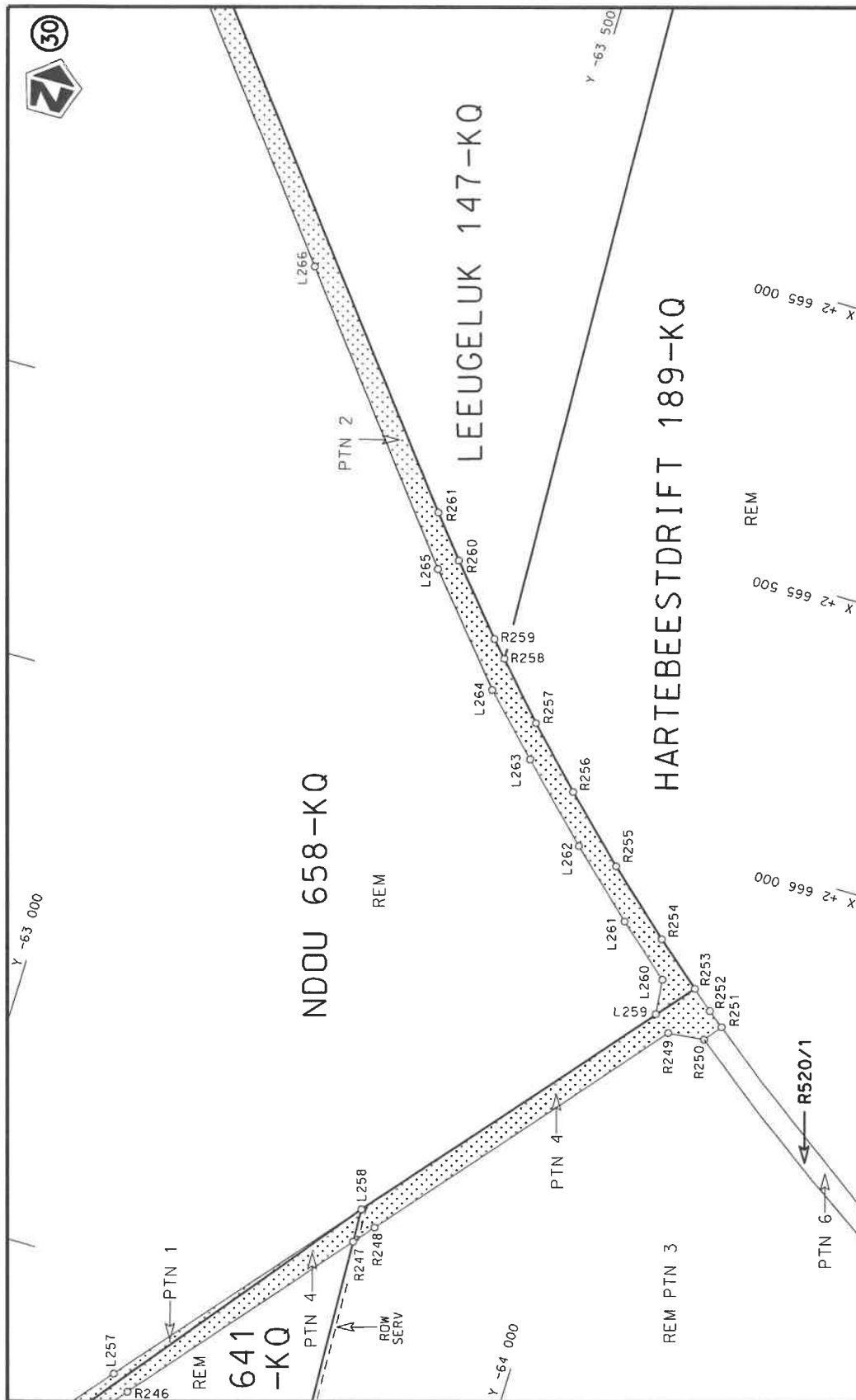

Die Suid Afrikaanse Nasionale Padagentskap MSB Bpk The South African National Roads Agency SOC Ltd	Die figuur getoon The figure shown	steldie padreserwe voor van 'n gedeelte represents the road reserve of a portion van Nasionale Roete R510 of National Route Section	3	Vel Sheet 15 of 39	Plan P1180/19
---	---------------------------------------	--	---	-----------------------	---------------

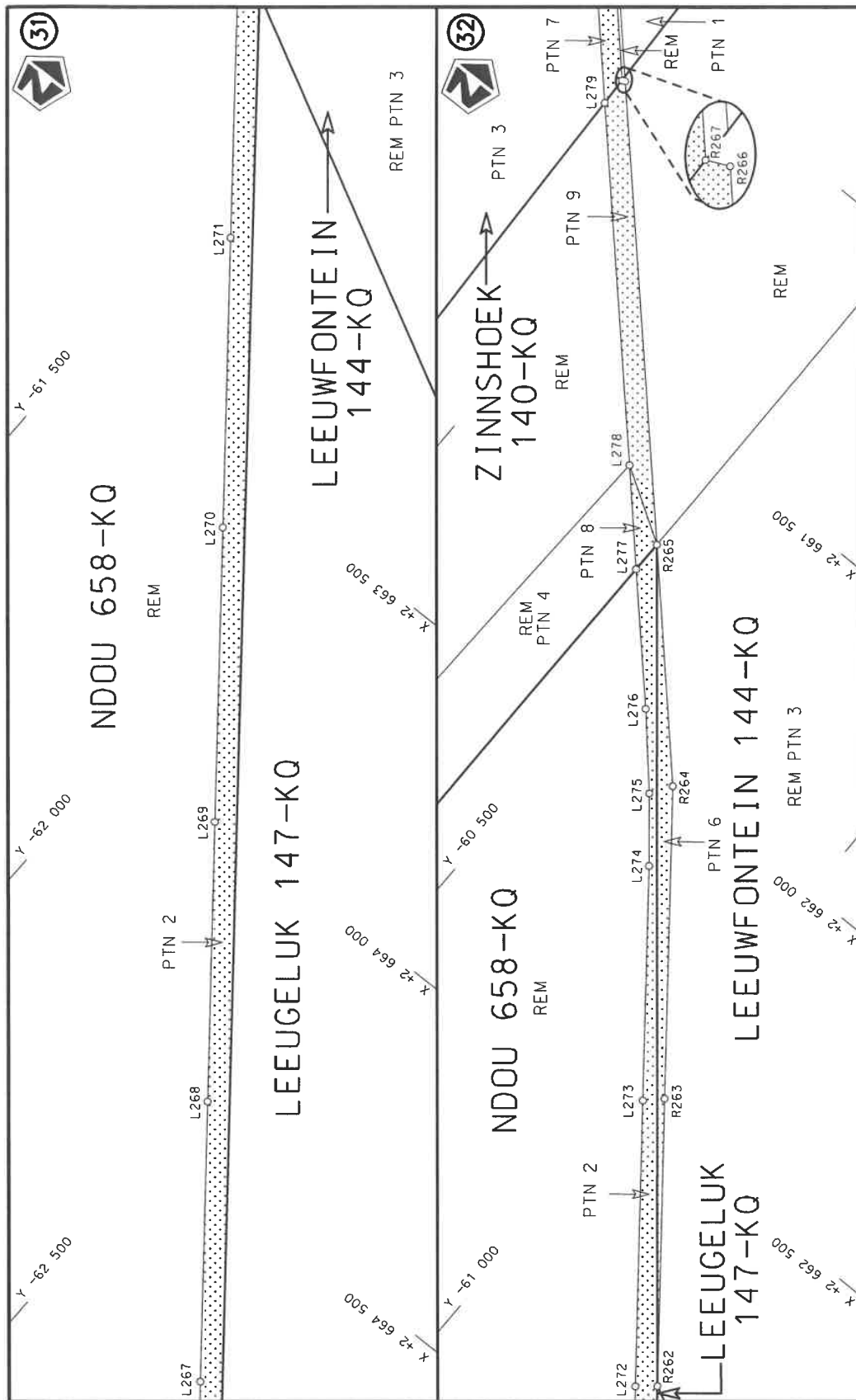

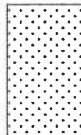
Vel Sheet 16 of 39 Plan P1180/19	steldie padreserwe voor van 'n gedeelte represents the road reserve of a portion van Nasionale Roete R510 of National Route of National Route Seksie Section 3	Die figuur getoon The figure shown 	Die Suid Afrikaanse Nasionale Padagentskap MSB Bpk The South African National Roads Agency SOC Ltd
--	--	--	---

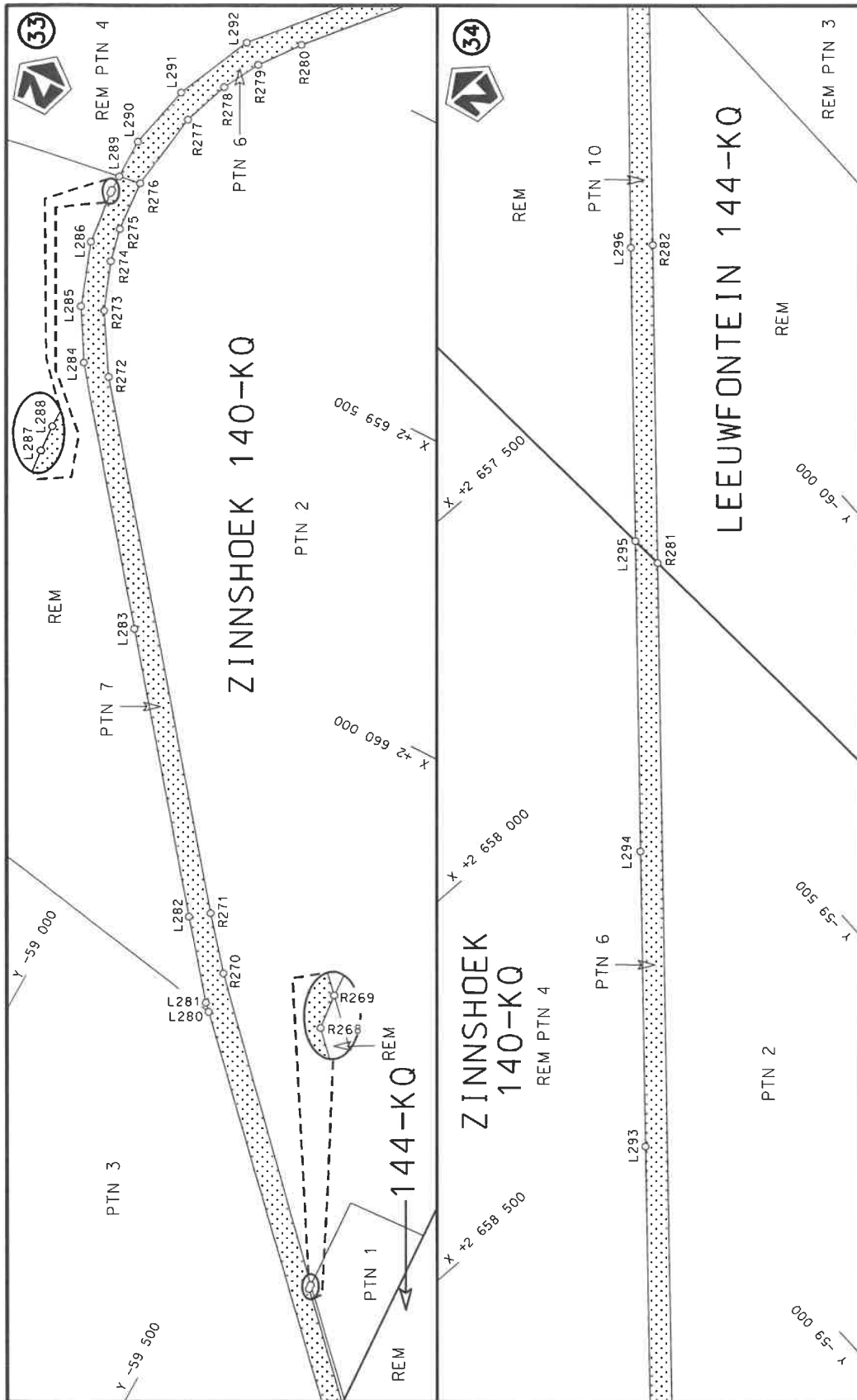

Vel Sheet 17 of 39 Plan P1180/19	steldie padreserwe voor van 'n gedeelte represents the road reserve of a portion van Nasionale Roete R510 of National Route Section	Die figuur getoon The figure shown	Die Suid Afrikaanse Nasionale Padagentskap MSB Bpk The South African National Roads Agency SOC Ltd
--	--	---------------------------------------	---

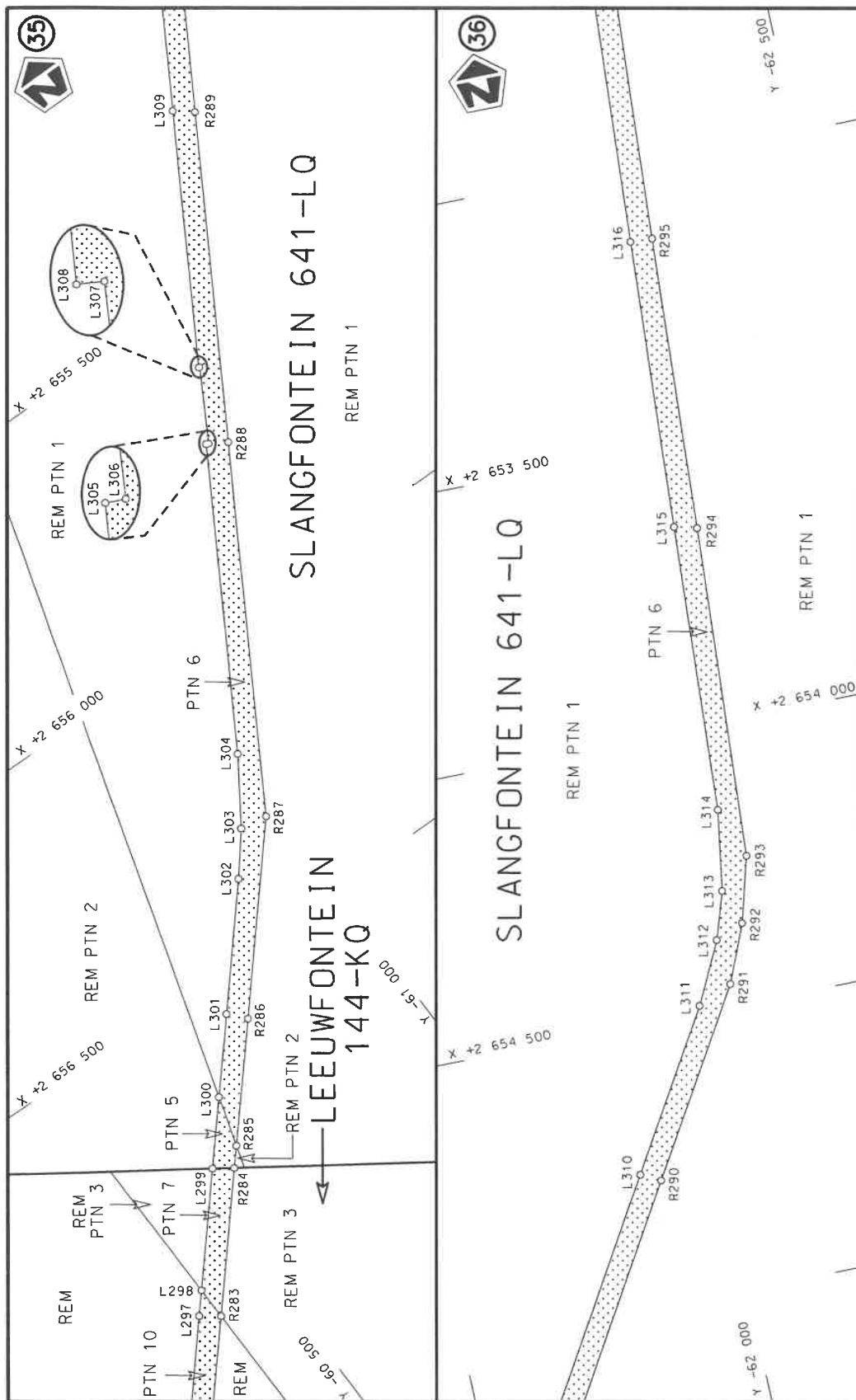

Vel Sheet 18 of 39 Plan P1180/19	steldie padreserwe voor van 'n gedeelte represents the road reserve of a portion van Nasionale Roete R510 of National Route Section	Die figuur getoon The figure shown	Die Suid Afrikaanse Nasionale Padogentskap MSB Bpk The South African National Roads Agency SOC Ltd
--	--	---------------------------------------	---

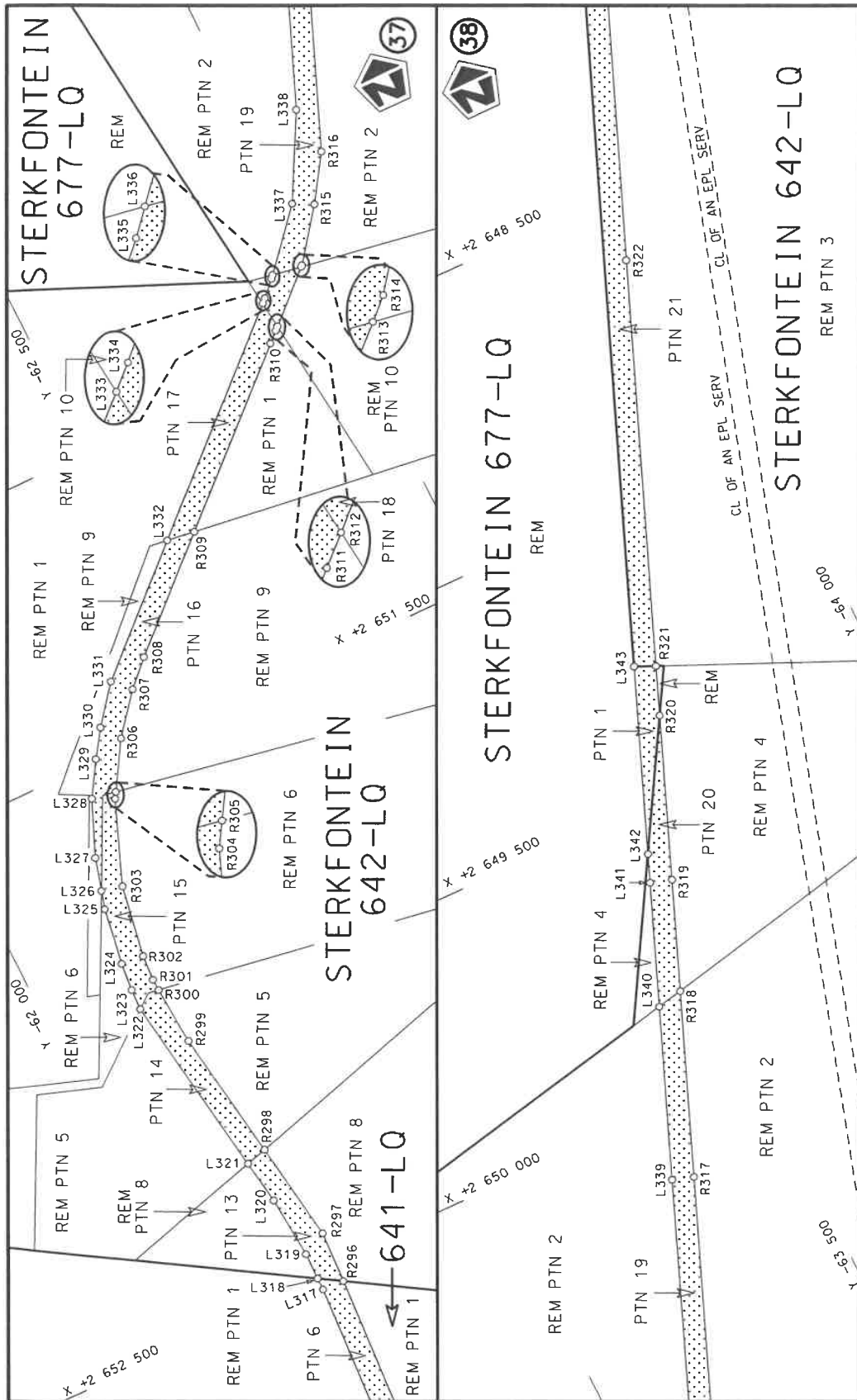

Die Suid Afrikaanse Nasionale Padagentskap MSB Bpk The South African National Roads Agency SOC Ltd	Die figuur getoon The figure shown	steldie padreserwe voor van 'n gedeelte represents the road reserve of a portion van Nasionale Roete R510 of National Route 510	Vel Sheet 19 of 39 Plan P1180/19
---	---------------------------------------	--	--

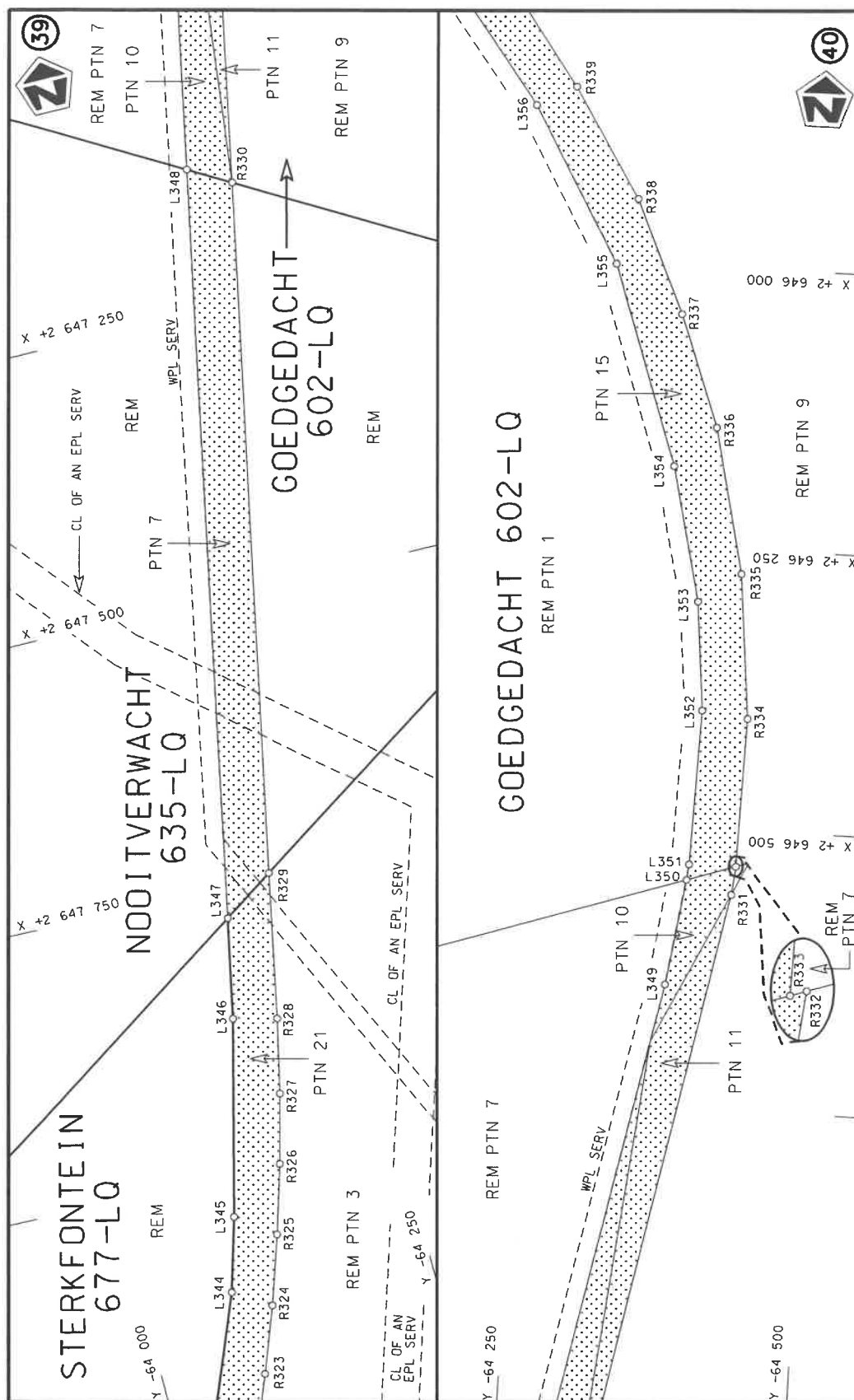

Die Suid Afrikaanse Nasionale Podagentskap MSB Bpk	Die figuur getoon		stel die padreserwe voor van 'n gedeelte represents the road reserve of a portion van Nasionale Roete R510 of National Route	3	Vel Sheet 20 of 39
The South African National Roads Agency SOC Ltd	The figure shown				Plan P1180/19

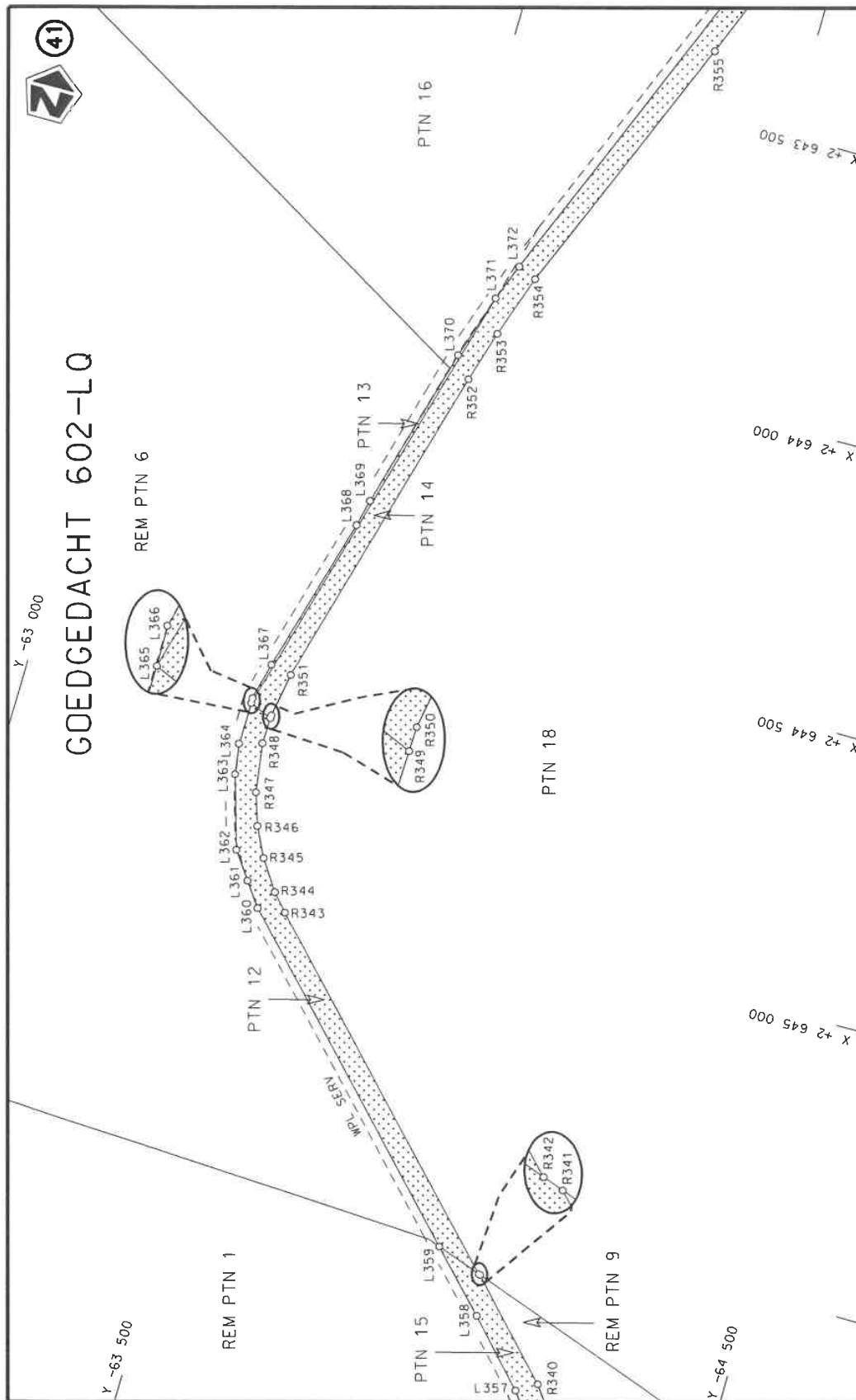

Die Suid Afrikaanse Nasionale Padagentskap MSB Bpk The South African National Roads Agency SOC Ltd	Die figuur getoon The figure shown	<div data-bbox="1294 1077 1378 1218" data-label="Image"> </div>	steldie padreserwe voor van 'n gedeelte represents the road reserve of a portion van Nasionale Roete R510 of National Route Seksie Section	Vel Sheet 21 of 39 Plan P1180/19
---	---------------------------------------	---	---	---

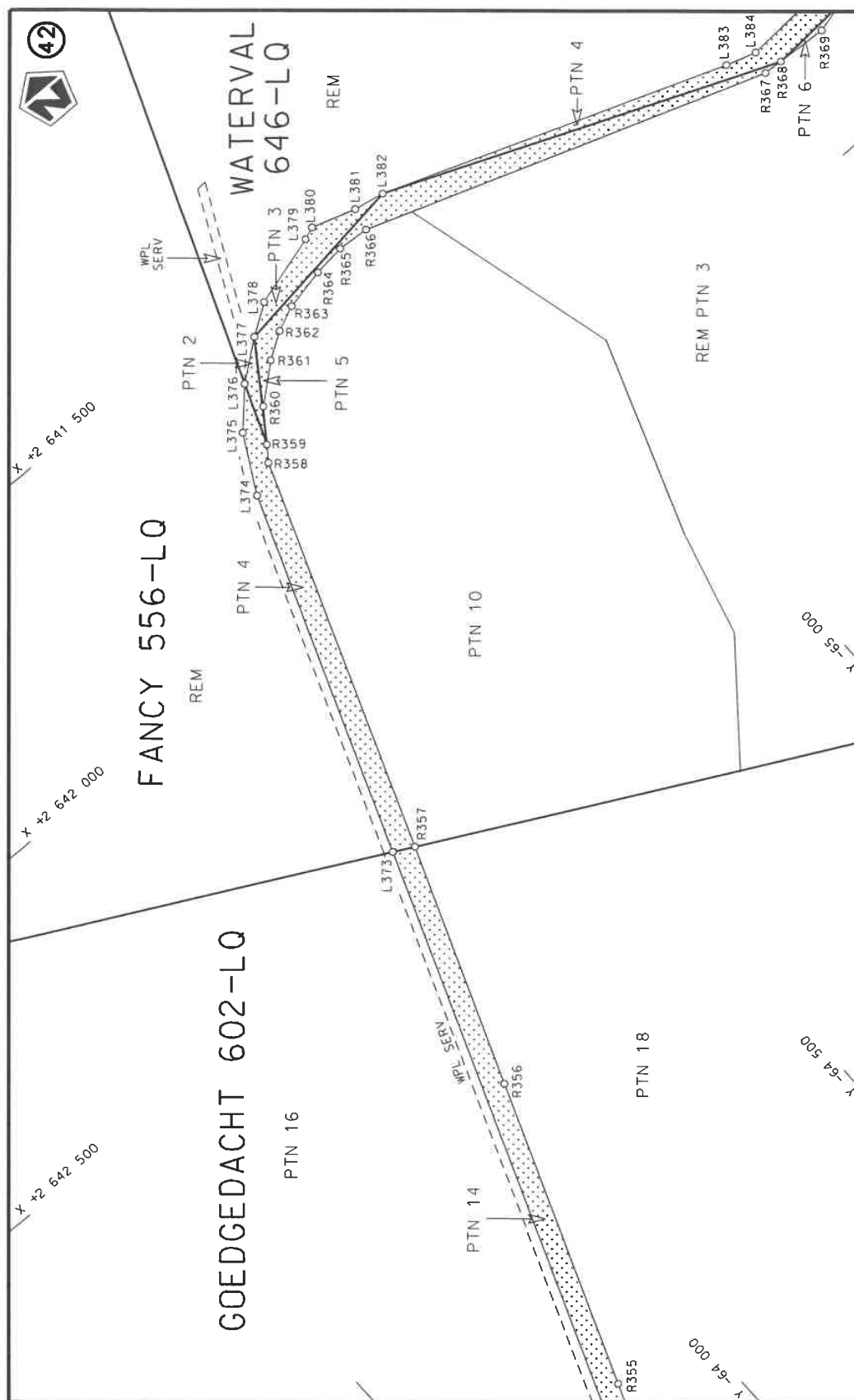

Die Suid Afrikaanse Nasionale Padagentskap MSB Bpk The South African National Roads Agency SOC Ltd	Die figuur getoon The figure shown	stel die padreserwe voor van 'n gedeelte represents the road reserve of a portion van Nasionale Roete R510 of National Route	Vel Sheet 22 of 39 Plan P1180/19
---	---------------------------------------	---	--

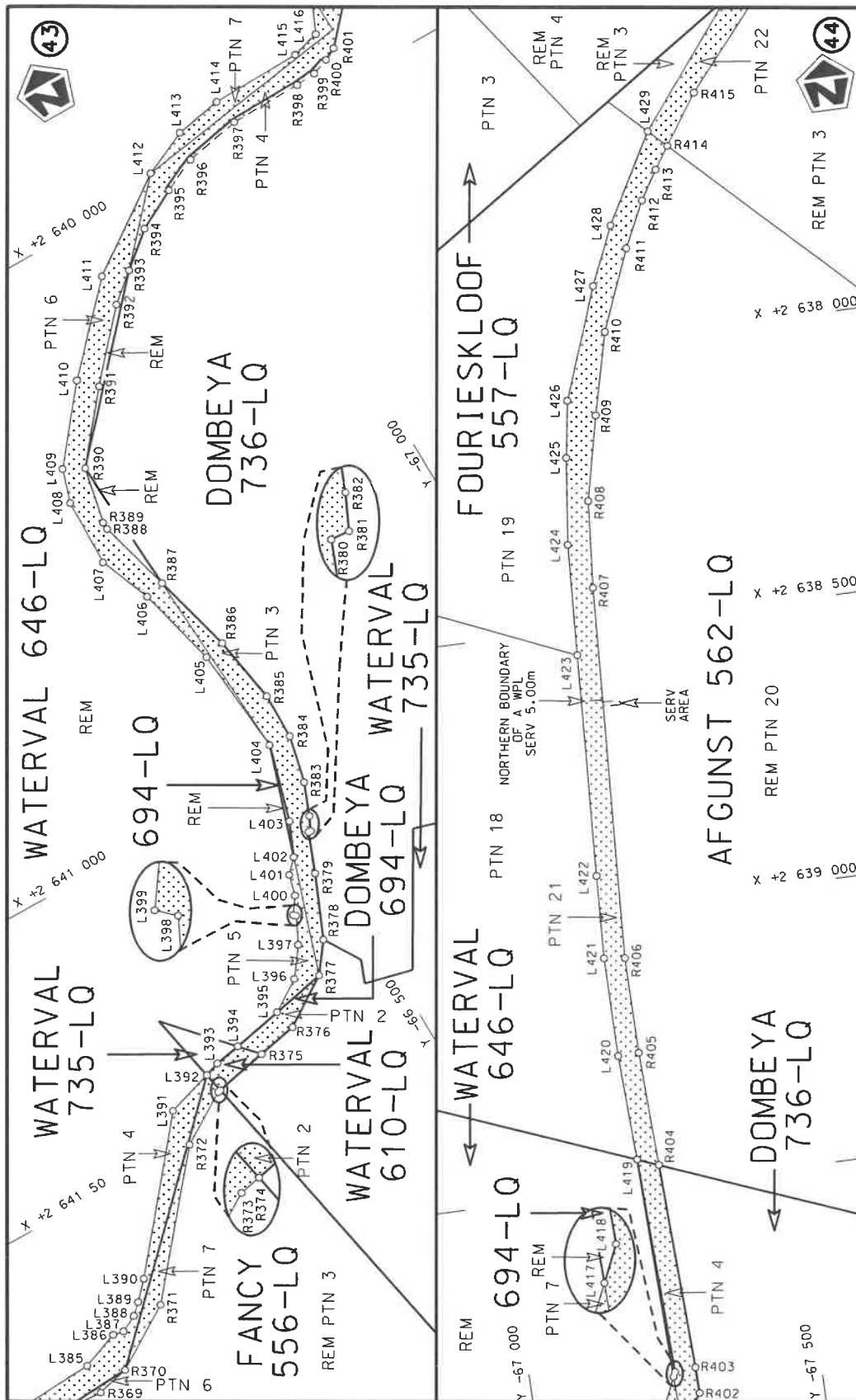

Vel van 39 Sheet 23 of Plan P1180/19	steldie padreserwe voor van 'n gedeelte represents the road reserve of a portion van Nasionale Roete R510 of National Route 3	Die figuur getoon The figure shown	Die Suid Afrikaanse Nasionale Padagentskap MSB Bpk The South African National Roads Agency SOC Ltd
--	---	---------------------------------------	---

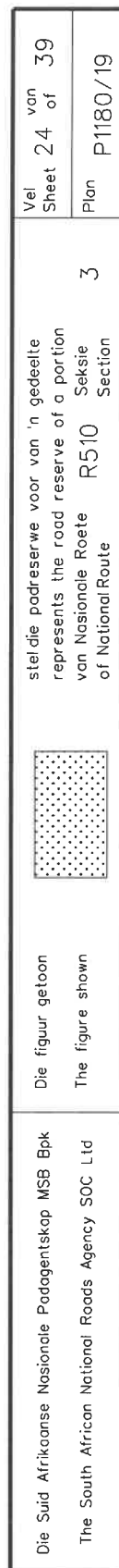

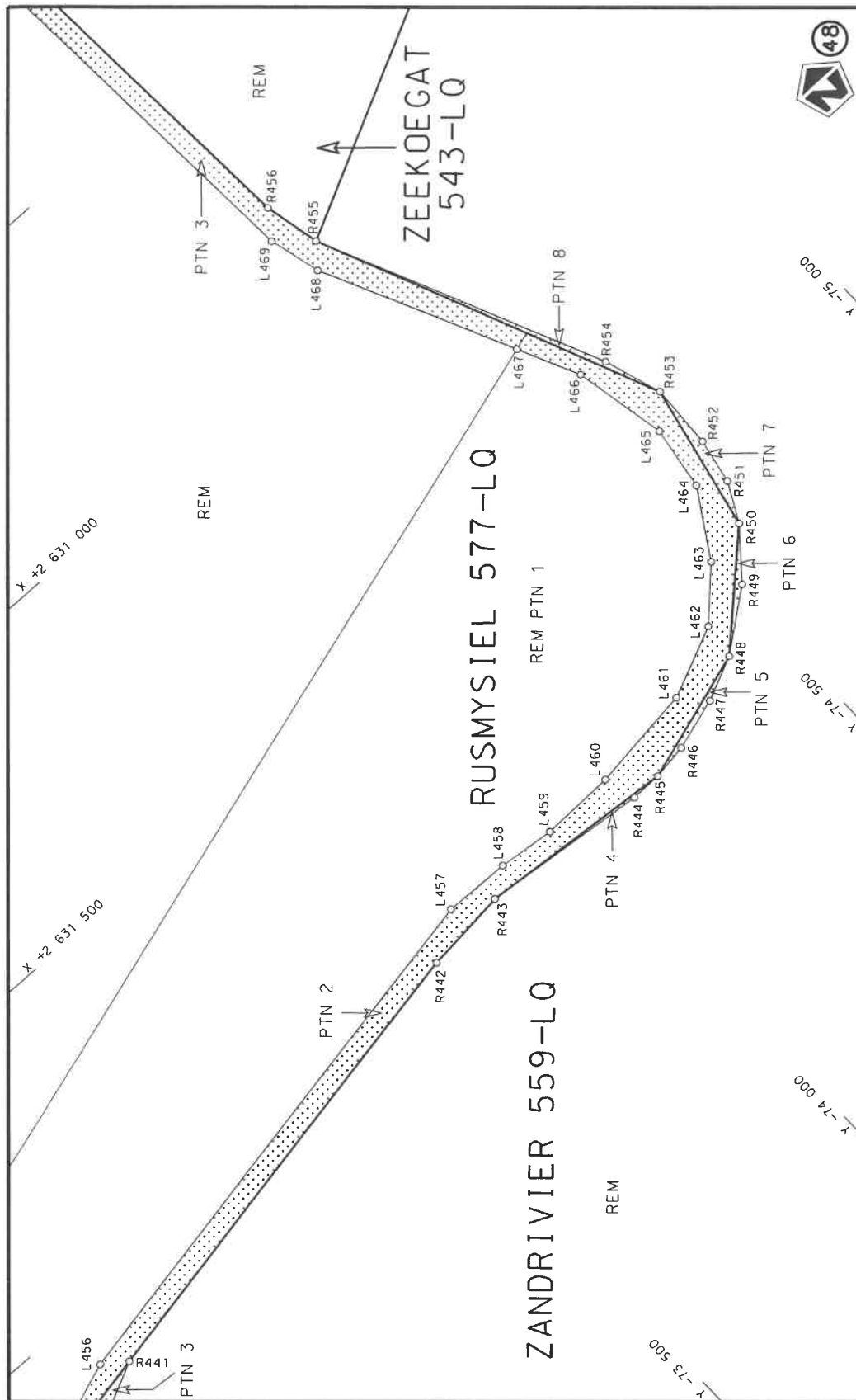

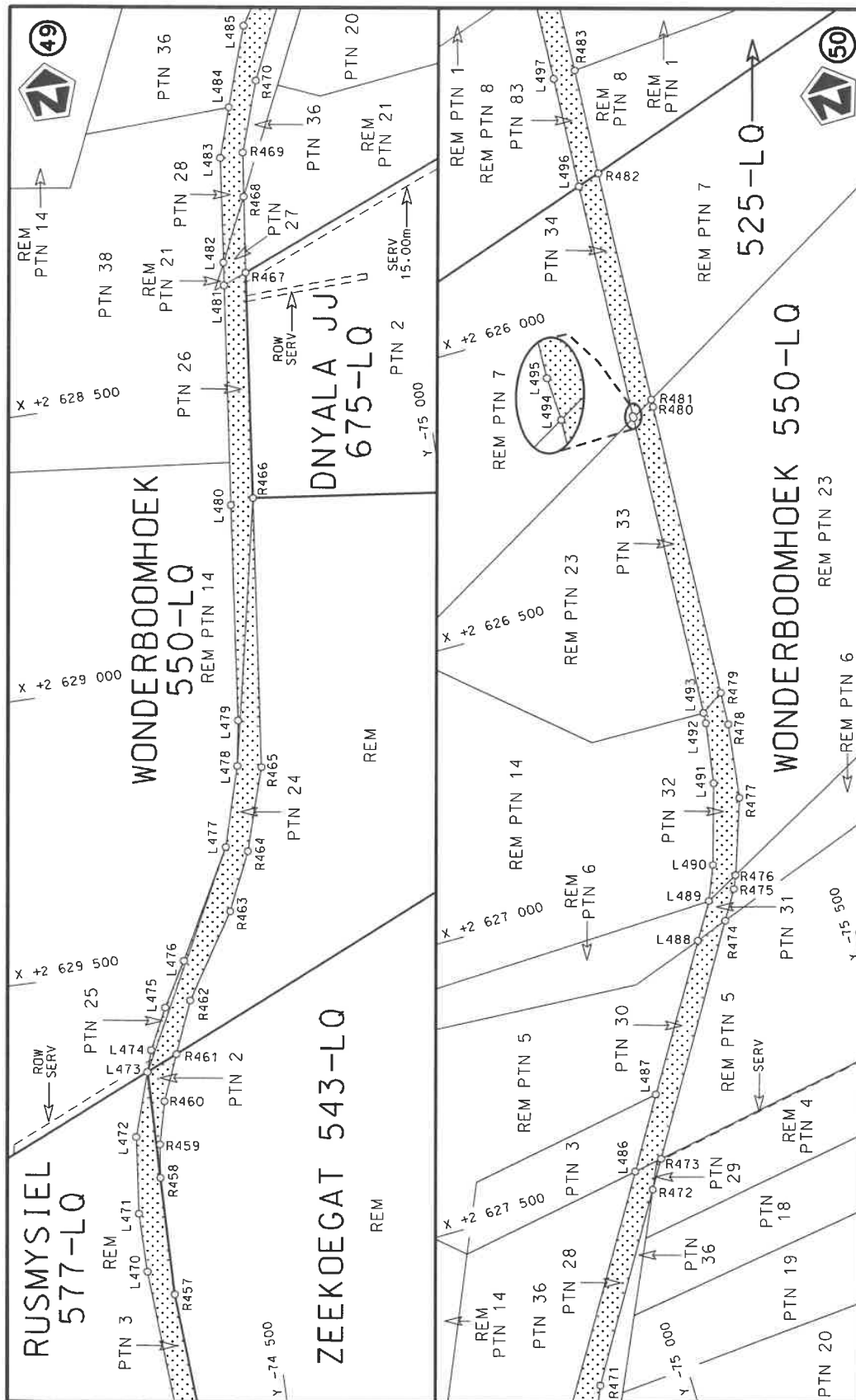

Die Suid Afrikaanse Nasionale Padagentskap MSB Bpk The South African National Roads Agency SOC Ltd	Die figuur getoon The figure shown	steldie padreserwe voor van 'n gedeelte represents the road reserve of a portion van Nasionale Roete R510 of National Route Section	3	Plan P1180/19	Vel Sheet 25 of 39
---	---------------------------------------	--	---	---------------	-----------------------

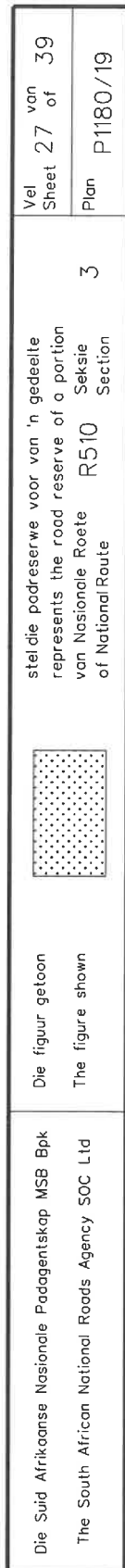

Die Suid Afrikaanse Nasionale Padagentskap MSB Bpk The South African National Roads Agency SOC Ltd	Die figuur getoon The figure shown	stel die padreserwe voor van 'n gedeelte represents the road reserve of a portion van Nasionale Roete of National Route	Vel Sheet 26 of 39	Plan P1180/19
3	R510	Sektie Section	3	P1180/19

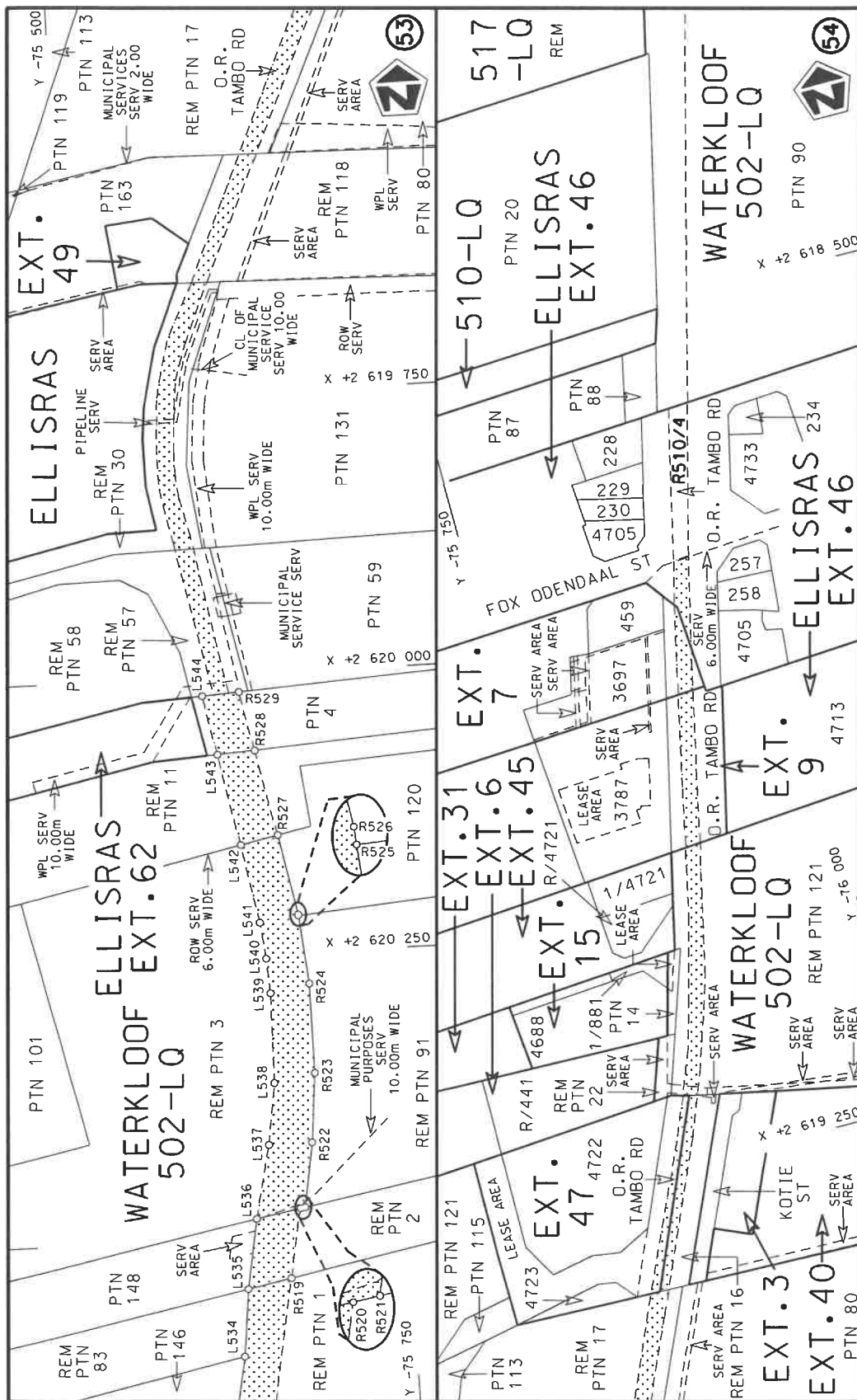



Die Suid Afrikaanse Nasionale Padagentskap MSB Bpk The South African National Roads Agency SOC Ltd	Die figuur getoon The figure shown		steldie padreserwe voor van 'n gedeelte represents the road reserve of a portion van Nasionale Roete R510 of National Route Section
Vel Sheet 28 of 39	Plan P1180/19	3	3

PADRESERVE KOÖRDINATE / ROAD RESERVE CO-ORDINATES									
LINKERKANT/LEFT HAND SIDE					REGTERKANT/RIGHT HAND SIDE				
	Y	X	WG 27°			Y	X		
L1	-40 299.80	2 720 910.53			R1	-40 322.83	2 720 898.13		
L2	-40 281.95	2 720 870.90			R2	-40 265.72	2 720 782.51		
L3	-40 218.09	2 720 739.65			R3	-40 245.24	2 720 740.91		
L4	-40 183.32	2 720 668.21			R4	-40 199.52	2 720 648.32		
L5	-40 001.05	2 720 305.63			R5	-40 069.26	2 720 367.33		
L6	-39 916.93	2 720 131.25			R6	-40 035.61	2 720 291.69		
L7	-39 874.98	2 720 041.34			R7	-39 983.15	2 720 182.72		
L8	-39 870.85	2 720 032.22			R8	-39 940.15	2 720 093.66		
L9	-39 796.77	2 719 869.27			R9	-39 795.10	2 719 780.91		
L10	-39 759.89	2 719 773.65			R10	-39 756.08	2 719 635.44		
L11	-39 729.46	2 719 670.78			R11	-39 746.02	2 719 578.43		
L12	-39 708.74	2 719 576.64			R12	-39 707.06	2 719 357.65		
L13	-39 661.43	2 719 306.70			R13	-39 693.54	2 719 284.88		
L14	-39 654.46	2 719 237.62			R14	-39 687.94	2 719 209.83		
L15	-39 648.47	2 719 197.35			R15	-39 697.92	2 719 072.62		
L16	-39 666.27	2 719 046.99			R16	-39 723.96	2 718 962.92		
L17	-39 680.08	2 718 988.87			R17	-39 921.48	2 718 328.69		
L18	-39 684.44	2 718 968.48			R18	-40 038.51	2 717 954.42		
L19	-39 742.34	2 718 776.39			R19	-40 062.64	2 717 876.78		
L20	-39 887.71	2 718 311.17			R20	-40 125.67	2 717 674.69		
L21	-40 008.54	2 717 924.36			R21	-40 151.08	2 717 640.78		
L22	-40 088.87	2 717 667.18			R22	-40 161.06	2 717 611.14		
L23	-40 215.46	2 717 260.71			R23	-40 160.88	2 717 561.86		
L24	-40 376.37	2 716 744.83			R24	-40 230.12	2 717 341.43		
L25	-40 391.26	2 716 687.15			R25	-40 257.56	2 717 252.58		
L26	-40 399.17	2 716 655.03			R26	-40 408.52	2 716 769.02		
L27	-40 405.42	2 716 566.73			R27	-40 425.05	2 716 713.40		
L28	-40 425.72	2 716 069.43			R28	-40 436.04	2 716 667.19		
L29	-40 451.11	2 715 435.25			R29	-40 443.33	2 716 570.52		
L30	-40 463.14	2 715 321.09			R30	-40 464.13	2 716 050.97		
L31	-40 511.91	2 715 057.72			R31	-40 489.02	2 715 431.78		
L32	-40 554.47	2 714 893.88			R32	-40 498.82	2 715 329.74		
L33	-40 603.15	2 714 778.85			R33	-40 561.04	2 715 001.59		
L34	-40 851.69	2 714 333.60			R34	-40 596.96	2 714 890.97		
L35	-41 097.76	2 713 892.12			R35	-40 637.39	2 714 802.97		
L36	-41 340.39	2 713 457.02			R36	-40 887.64	2 714 350.25		
L37	-41 599.38	2 712 993.68			R37	-41 130.83	2 713 912.79		
L38	-41 662.07	2 712 881.79			R38	-41 372.80	2 713 477.52		
L39	-41 723.48	2 712 761.66			R39	-41 633.48	2 713 010.15		
L40	-41 754.62	2 712 684.31			R40	-41 717.21	2 712 859.31		
L41	-41 808.31	2 712 518.77			R41	-41 755.62	2 712 783.93		
L42	-41 832.56	2 712 339.77			R42	-41 790.75	2 712 700.11		
L43	-41 884.84	2 711 767.22			R43	-41 813.67	2 712 637.25		
L44	-41 910.81	2 711 490.84			R44	-41 842.11	2 712 535.30		
L45	-41 954.79	2 711 008.52			R45	-41 859.23	2 712 446.98		
L46	-41 961.71	2 710 938.01			R46	-41 870.43	2 712 343.59		
L47	-41 973.48	2 710 829.32			R47	-41 922.93	2 711 771.21		
L48	-42 019.68	2 710 394.46			R48	-41 948.97	2 711 485.66		
L49	-42 063.02	2 709 982.36			R49	-41 992.35	2 711 013.27		
L50	-42 099.98	2 709 635.68			R50	-41 998.31	2 710 954.90		
L51	-42 109.57	2 709 558.72			R51	-42 010.64	2 710 834.10		
					<div> <div>Vel</div> <div>29</div> <div>Van</div> <div>39</div> <div>Sheet</div> <div>of</div> <div>P1180/19</div> </div>				

PADRESERWE KOÖRDINATE / ROAD RESERVE CO-ORDINATES									
LINKERKANT/LEFT HAND SIDE					REGTERKANT/RIGHT HAND SIDE				
	Y	X	WG 27°			Y	X		
L52	-42 116.29	2 709	516.12	R52	-42 053.42	2 710	432.51		
L53	-42 136.38	2 709	386.16	R53	-42 139.52	2 709	618.98		
L54	-42 215.19	2 708	919.10	R54	-42 148.20	2 709	553.43		
L55	-42 216.94	2 708	907.90	R55	-42 153.25	2 709	519.25		
L56	-42 302.70	2 708	398.86	R56	-42 162.98	2 709	453.99		
L57	-42 367.76	2 708	012.64	R57	-42 254.06	2 708	914.82		
L58	-42 380.14	2 707	920.61	R58	-42 264.54	2 708	851.20		
L59	-42 384.73	2 707	829.51	R59	-42 340.04	2 708	404.05		
L60	-42 383.51	2 707	761.89	R60	-42 405.06	2 708	017.42		
L61	-42 363.55	2 707	375.37	R61	-42 417.53	2 707	921.33		
L62	-42 336.40	2 706	873.43	R62	-42 421.97	2 707	830.13		
L63	-42 330.20	2 706	723.58	R63	-42 421.07	2 707	760.86		
L64	-42 308.10	2 706	027.38	R64	-42 400.74	2 707	372.19		
L65	-42 291.56	2 705	501.56	R65	-42 387.48	2 707	130.10		
L66	-42 274.52	2 704	966.47	R66	-42 373.61	2 706	866.20		
L67	-42 268.18	2 704	777.33	R67	-42 367.73	2 706	721.41		
L68	-42 261.61	2 704	695.44	R68	-42 351.88	2 706	230.38		
L69	-42 246.07	2 704	606.59	R69	-42 345.52	2 706	026.51		
L70	-42 202.17	2 704	463.07	R70	-42 335.54	2 705	720.77		
L71	-42 165.09	2 704	380.40	R71	-42 328.88	2 705	499.54		
L72	-42 000.64	2 704	036.57	R72	-42 312.77	2 704	981.64		
L73	-41 994.43	2 704	022.06	R73	-42 312.00	2 704	965.69		
L74	-41 783.70	2 703	582.63	R74	-42 305.99	2 704	785.92		
L75	-41 557.59	2 703	109.39	R75	-42 298.79	2 704	692.77		
L76	-41 307.34	2 702	585.99	R76	-42 297.67	2 704	687.21		
L77	-41 236.86	2 702	437.71	R77	-42 280.34	2 704	587.83		
L78	-41 113.56	2 702	180.97	R78	-42 250.35	2 704	492.59		
L79	-41 013.78	2 701	972.38	R79	-42 239.64	2 704	458.20		
L80	-40 973.99	2 701	879.50	R80	-42 199.81	2 704	366.98		
L81	-40 944.23	2 701	791.86	R81	-42 036.95	2 704	025.31		
L82	-40 932.01	2 701	746.78	R82	-42 029.95	2 704	009.50		
L83	-40 804.50	2 701	248.51	R83	-41 822.65	2 703	577.03		
L84	-40 684.35	2 700	779.48	R84	-41 591.63	2 703	093.58		
L85	-40 655.45	2 700	666.20	R85	-41 345.12	2 702	577.92		
L86	-40 637.01	2 700	580.56	R86	-41 298.88	2 702	482.31		
L87	-40 634.94	2 700	565.87	R87	-41 164.93	2 702	201.22		
L88	-40 627.46	2 700	512.71	R88	-41 150.70	2 702	171.12		
L89	-40 624.58	2 700	484.92	R89	-41 048.02	2 701	956.32		
L90	-40 618.50	2 700	411.57	R90	-41 009.47	2 701	866.54		
L91	-40 573.26	2 699	910.77	R91	-40 971.95	2 701	750.49		
L92	-40 514.11	2 699	248.10	R92	-40 840.88	2 701	239.47		
L93	-40 483.86	2 698	910.36	R93	-40 794.50	2 701	058.21		
L94	-40 432.76	2 698	335.37	R94	-40 721.35	2 700	771.65		
L95	-40 395.58	2 697	920.89	R95	-40 690.84	2 700	652.87		
L96	-40 352.47	2 697	437.02	R96	-40 674.13	2 700	573.86		
L97	-40 309.74	2 696	958.26	R97	-40 661.84	2 700	481.95		
L98	-40 268.56	2 696	496.31	R98	-40 653.66	2 700	395.69		
L99	-40 248.40	2 696	276.34	R99	-40 610.94	2 699	912.19		
L100	-40 212.03	2 695	861.48	R100	-40 550.35	2 699	233.69		
L101	-40 174.65	2 695	442.12	R101	-40 522.20	2 698	918.31		
L102	-40 132.35	2 694	967.88	R102	-40 470.73	2 698	341.54		
					Vel Sheet	30	Van of	39	P1180/19

PADRESERVE KOÖRDINATE / ROAD RESERVE CO-ORDINATES									
LINKERKANT/LEFT HAND SIDE					REGTERKANT/RIGHT HAND SIDE				
	Y	X	WG 27°			Y	X		
L103	-40 082.36	2 694 406.08		R103	-40 456.01	2 698 173.15			
L104	-40 045.57	2 693 994.51		R104	-40 433.20	2 697 919.55			
L105	-39 999.26	2 693 475.29		R105	-40 389.95	2 697 437.01			
L106	-39 984.88	2 693 311.24		R106	-40 346.54	2 696 950.25			
L107	-39 932.16	2 692 749.95		R107	-40 306.71	2 696 504.16			
L108	-39 817.55	2 692 245.07		R108	-40 285.45	2 696 258.93			
L109	-39 456.58	2 690 708.39		R109	-40 251.24	2 695 878.92			
L110	-39 432.52	2 690 618.16		R110	-40 210.68	2 695 422.21			
L111	-39 372.81	2 690 446.64		R111	-40 170.27	2 694 970.28			
L112	-39 311.23	2 690 311.21		R112	-40 119.68	2 694 402.54			
L113	-39 245.53	2 690 191.95		R113	-40 083.11	2 693 991.49			
L114	-39 262.12	2 690 185.20		R114	-40 036.83	2 693 471.55			
L115	-41 725.06	2 689 182.90		R115	-40 021.80	2 693 302.26			
L116	-42 905.49	2 688 701.17		R116	-39 969.64	2 692 745.30			
L117	-45 131.06	2 687 793.64		R117	-39 474.86	2 690 630.08			
L118	-45 625.61	2 687 590.66		R118	-39 407.75	2 690 433.13			
L119	-45 660.90	2 687 574.18		R119	-39 306.90	2 690 213.79			
L120	-46 128.41	2 687 366.39		R120	-41 739.93	2 689 220.68			
L121	-46 517.59	2 687 197.10		R121	-42 528.70	2 688 897.39			
L122	-46 521.06	2 687 194.32		R122	-42 923.62	2 688 737.69			
L123	-46 524.47	2 687 191.59		R123	-43 299.59	2 688 584.05			
L124	-46 959.09	2 686 999.51		R124	-43 774.56	2 688 390.54			
L125	-47 395.02	2 686 807.09		R125	-44 222.14	2 688 208.01			
L126	-47 865.92	2 686 599.07		R126	-44 630.45	2 688 041.67			
L127	-48 278.38	2 686 417.02		R127	-45 146.23	2 687 831.11			
L128	-48 609.48	2 686 270.65		R128	-45 629.59	2 687 633.17			
L129	-48 699.39	2 686 226.20		R129	-45 660.46	2 687 616.84			
L130	-48 770.58	2 686 180.55		R130	-46 096.45	2 687 426.17			
L131	-48 833.52	2 686 132.46		R131	-46 542.07	2 687 227.51			
L132	-48 865.60	2 686 105.30		R132	-48 446.54	2 686 388.34			
L133	-48 921.13	2 686 050.93		R133	-48 622.30	2 686 308.90			
L134	-48 984.48	2 685 978.30		R134	-48 676.72	2 686 283.54			
L135	-49 037.81	2 685 901.62		R135	-48 723.52	2 686 257.97			
L136	-49 079.19	2 685 829.51		R136	-48 777.18	2 686 223.91			
L137	-49 103.22	2 685 779.66		R137	-48 813.01	2 686 198.80			
L138	-49 125.48	2 685 728.96		R138	-48 857.99	2 686 163.70			
L139	-49 151.67	2 685 648.06		R139	-48 891.28	2 686 134.94			
L140	-49 163.84	2 685 601.45		R140	-48 947.91	2 686 080.11			
L141	-49 180.18	2 685 515.56		R141	-49 002.55	2 686 017.83			
L142	-49 186.63	2 685 458.03		R142	-49 075.16	2 685 915.39			
L143	-49 188.93	2 685 400.19		R143	-49 113.51	2 685 848.74			
L144	-49 189.44	2 685 376.89		R144	-49 141.13	2 685 791.35			
L145	-49 186.26	2 685 297.22		R145	-49 164.58	2 685 733.79			
L146	-49 176.98	2 685 221.79		R146	-49 189.43	2 685 660.08			
L147	-49 123.11	2 684 876.61		R147	-49 205.02	2 685 599.68			
L148	-49 048.34	2 684 393.96		R148	-49 212.99	2 685 560.14			
L149	-49 038.08	2 684 335.09		R149	-49 230.09	2 685 450.86			
L150	-49 026.59	2 684 278.49		R150	-49 244.66	2 685 413.04			
L151	-49 012.75	2 684 219.56		R151	-49 244.57	2 685 412.78			
L152	-48 995.91	2 684 157.88		R152	-49 229.14	2 685 365.23			
L153	-48 995.51	2 684 154.89		R153	-49 226.28	2 685 294.68			
					Vel Sheet	31	Van of	39	P1180/19

PADRESERWE KOÖRDINATE / ROAD RESERVE CO-ORDINATES									
LINKERKANT/LEFT HAND SIDE					REGTERKANT/RIGHT HAND SIDE				
	Y	X	WG 27°			Y	X		
L154	-48 975.27	2 684	087.72		R154	-49 217.39	2 685	219.06	
L155	-48 955.19	2 684	028.89		R155	-49 167.96	2 684	899.46	
L156	-48 934.41	2 683	973.67		R156	-49 164.99	2 684	880.36	
L157	-48 903.01	2 683	899.20		R157	-49 096.46	2 684	440.02	
L158	-48 868.51	2 683	824.94		R158	-49 063.91	2 684	261.39	
L159	-48 840.58	2 683	769.70		R159	-49 032.51	2 684	138.49	
L160	-48 787.86	2 683	676.22		R160	-48 991.29	2 684	012.16	
L161	-48 489.40	2 683	150.00		R161	-48 969.80	2 683	955.74	
L162	-48 451.98	2 683	078.20		R162	-48 939.23	2 683	882.65	
L163	-48 417.04	2 683	005.60		R163	-48 906.06	2 683	812.03	
L164	-48 392.30	2 682	950.80		R164	-48 866.40	2 683	734.86	
L165	-48 363.91	2 682	884.56		R165	-48 566.58	2 683	208.68	
L166	-48 316.75	2 682	764.42		R166	-48 523.23	2 683	130.01	
L167	-48 275.84	2 682	646.17		R167	-48 401.67	2 682	879.18	
L168	-48 267.59	2 682	616.16		R168	-48 398.72	2 682	871.20	
L169	-48 236.07	2 682	508.26		R169	-48 352.40	2 682	745.72	
L170	-48 193.64	2 682	345.05		R170	-48 304.34	2 682	601.61	
L171	-48 083.70	2 681	931.24		R171	-48 301.95	2 682	594.46	
L172	-47 966.39	2 681	488.36		R172	-48 230.30	2 682	329.81	
L173	-47 944.51	2 681	368.63		R173	-48 123.55	2 681	926.70	
L174	-47 939.23	2 681	285.17		R174	-48 005.19	2 681	479.16	
L175	-47 940.85	2 681	224.21		R175	-47 996.26	2 681	442.64	
L176	-47 947.31	2 681	161.06		R176	-47 983.47	2 681	362.95	
L177	-47 958.84	2 681	101.15		R177	-47 979.20	2 681	285.15	
L178	-47 974.51	2 681	041.41		R178	-47 982.02	2 681	209.10	
L179	-47 993.54	2 680	985.60		R179	-47 993.48	2 681	130.32	
L180	-48 025.76	2 680	912.92		R180	-48 009.64	2 681	059.56	
L181	-48 030.89	2 680	864.89		R181	-48 044.80	2 680	957.33	
L182	-48 053.92	2 680	831.94		R182	-48 112.88	2 680	842.60	
L183	-48 092.46	2 680	801.76		R183	-48 160.34	2 680	779.01	
L184	-48 127.59	2 680	755.61		R184	-48 197.67	2 680	737.60	
L185	-48 169.69	2 680	708.94		R185	-48 240.26	2 680	696.84	
L186	-48 213.38	2 680	667.15		R186	-48 285.30	2 680	659.49	
L187	-48 261.53	2 680	627.89		R187	-48 334.04	2 680	625.31	
L188	-48 311.14	2 680	592.52		R188	-48 382.03	2 680	596.19	
L189	-48 362.71	2 680	560.35		R189	-48 437.53	2 680	568.41	
L190	-48 429.85	2 680	528.06		R190	-48 495.35	2 680	544.42	
L191	-48 496.95	2 680	506.57		R191	-48 587.51	2 680	517.39	
L192	-48 767.94	2 680	429.87		R192	-50 559.27	2 679	970.04	
L193	-48 955.61	2 680	374.13		R193	-50 626.49	2 679	948.81	
L194	-49 165.15	2 680	315.86		R194	-50 705.12	2 679	917.09	
L195	-49 676.59	2 680	174.02		R195	-50 747.68	2 679	896.76	
L196	-50 124.41	2 680	050.32		R196	-50 780.80	2 679	880.84	
L197	-50 540.55	2 679	934.03		R197	-50 878.42	2 679	817.17	
L198	-50 613.70	2 679	910.99		R198	-50 898.84	2 679	802.87	
L199	-50 683.89	2 679	883.17		R199	-50 942.39	2 679	767.19	
L200	-50 754.47	2 679	851.10		R200	-50 992.23	2 679	722.00	
L201	-50 854.80	2 679	785.32		R201	-51 031.02	2 679	684.17	
L202	-50 917.05	2 679	736.99		R202	-51 085.07	2 679	621.20	
L203	-51 002.47	2 679	656.31		R203	-51 140.65	2 679	544.26	
L204	-51 053.24	2 679	597.74		R204	-51 382.17	2 679	171.99	
					<div> <div>Vel</div> <div>32</div> <div>Van</div> <div>39</div> <div>Sheet</div> <div>of</div> <div>P1180/19</div> </div>				

PADRESERVE KOÖRDINATE / ROAD RESERVE CO-ORDINATES									
LINKERKANT/LEFT HAND SIDE					REGTERKANT/RIGHT HAND SIDE				
	Y	X	WG 27°			Y	X		
L205	-51 107.10	2 679	523.01		R205	-51 633.70	2 678	787.30	
L206	-51 335.35	2 679	172.17		R206	-51 864.81	2 678	432.92	
L207	-51 600.36	2 678	765.49		R207	-52 136.54	2 678	015.88	
L208	-51 832.27	2 678	410.19		R208	-52 375.54	2 677	649.22	
L209	-52 102.57	2 677	995.20		R209	-52 683.71	2 677	176.58	
L210	-52 338.99	2 677	631.97		R210	-52 988.25	2 676	709.42	
L211	-52 650.45	2 677	154.62		R211	-54 397.10	2 674	548.58	
L212	-52 942.06	2 676	707.28		R212	-54 474.91	2 674	454.17	
L213	-53 185.72	2 676	333.61		R213	-54 559.91	2 674	373.14	
L214	-53 436.79	2 675	948.25		R214	-54 650.53	2 674	305.34	
L215	-53 743.98	2 675	477.08		R215	-54 795.23	2 674	220.07	
L216	-54 025.18	2 675	045.65		R216	-54 798.71	2 674	218.67	
L217	-54 336.94	2 674	567.18		R217	-55 088.35	2 674	049.44	
L218	-54 360.95	2 674	533.30		R218	-55 532.16	2 673	790.45	
L219	-54 437.07	2 674	438.15		R219	-56 063.16	2 673	480.26	
L220	-54 487.01	2 674	386.22		R220	-56 156.33	2 673	416.70	
L221	-54 531.01	2 674	346.38		R221	-56 234.59	2 673	358.08	
L222	-54 574.00	2 674	312.06		R222	-56 792.31	2 672	918.95	
L223	-54 629.00	2 674	272.91		R223	-57 307.09	2 672	513.90	
L224	-54 781.38	2 674	182.08		R224	-57 782.35	2 672	141.03	
L225	-55 066.37	2 674	017.38		R225	-58 200.91	2 671	811.47	
L226	-55 512.09	2 673	755.89		R226	-58 240.47	2 671	797.43	
L227	-56 046.42	2 673	443.82		R227	-58 260.73	2 671	764.92	
L228	-56 095.66	2 673	410.15		R228	-58 283.72	2 671	746.83	
L229	-56 205.91	2 673	330.10		R229	-58 336.96	2 671	705.01	
L230	-56 769.02	2 672	886.62		R230	-58 726.71	2 671	397.93	
L231	-57 282.09	2 672	482.91		R231	-59 106.56	2 671	099.61	
L232	-57 754.41	2 672	111.25		R232	-59 431.55	2 670	844.13	
L233	-58 184.99	2 671	773.40		R233	-59 895.49	2 670	479.39	
L234	-58 214.17	2 671	734.04		R234	-60 308.81	2 670	153.71	
L235	-58 237.23	2 671	713.27		R235	-60 497.10	2 670	006.77	
L236	-58 278.31	2 671	698.00		R236	-60 896.92	2 669	692.27	
L237	-58 705.83	2 671	363.70		R237	-61 327.56	2 669	353.43	
L238	-59 079.43	2 671	069.97		R238	-61 662.81	2 669	089.93	
L239	-59 408.33	2 670	811.45		R239	-62 078.95	2 668	761.96	
L240	-59 868.37	2 670	449.60		R240	-62 170.84	2 668	676.03	
L241	-60 281.97	2 670	124.85		R241	-62 245.47	2 668	600.10	
L242	-60 469.25	2 669	977.26		R242	-62 311.82	2 668	521.79	
L243	-60 872.91	2 669	659.67		R243	-62 459.65	2 668	339.48	
L244	-61 300.67	2 669	323.55		R244	-62 843.15	2 667	867.83	
L245	-61 633.19	2 669	062.07		R245	-63 042.87	2 667	621.00	
L246	-61 998.57	2 668	774.62		R246	-63 381.50	2 667	203.77	
L247	-62 053.89	2 668	729.28		R247	-63 678.48	2 666	837.48	
L248	-62 099.57	2 668	689.08		R248	-63 706.74	2 666	802.67	
L249	-62 141.79	2 668	649.17		R249	-64 092.20	2 666	327.73	
L250	-62 184.35	2 668	606.08		R250	-64 154.86	2 666	321.30	
L251	-62 235.81	2 668	550.51		R251	-64 177.80	2 666	291.61	
L252	-62 280.20	2 668	497.04		R252	-64 149.91	2 666	269.65	
L253	-62 427.39	2 668	315.88		R253	-64 114.02	2 666	239.00	
L254	-62 805.57	2 667	850.30		R254	-64 034.64	2 666	170.64	
L255	-62 812.45	2 667	841.73		R255	-63 922.53	2 666	068.31	
					<div> <div>Vel</div> <div>33</div> <div>Van</div> <div>39</div> <div>Sheet</div> <div>of</div> <div>P1180/19</div> </div>				

PADRESERWE KOÖRDINATE / ROAD RESERVE CO-ORDINATES									
LINKERKANT/LEFT HAND SIDE					REGTERKANT/RIGHT HAND SIDE				
	Y	X	WG 27°			Y	X		
L256	-63 010.03	2 667	598.28		R256	-63 813.79	2 665	962.27	
L257	-63 349.82	2 667	179.26		R257	-63 718.06	2 665	863.08	
L258	-63 676.01	2 666	777.89		R258	-63 633.91	2 665	768.56	
L259	-64 062.31	2 666	301.37		R259	-63 607.54	2 665	739.73	
L260	-64 055.91	2 666	239.36		R260	-63 509.94	2 665	623.25	
L261	-63 964.00	2 666	158.46		R261	-63 452.54	2 665	550.96	
L262	-63 850.47	2 666	051.91		R262	-61 351.56	2 662	847.68	
L263	-63 726.63	2 665	927.93		R263	-61 036.82	2 662	443.56	
L264	-63 629.43	2 665	827.81		R264	-60 695.25	2 662	004.19	
L265	-63 480.23	2 665	647.78		R265	-60 401.77	2 661	689.84	
L266	-63 126.01	2 665	192.17		R266	-59 837.15	2 661	088.70	
L267	-62 819.48	2 664	797.88		R267	-59 832.16	2 661	091.03	
L268	-62 513.27	2 664	403.81		R268	-59 687.84	2 660	936.18	
L269	-62 207.74	2 664	010.90		R269	-59 687.05	2 660	928.43	
L270	-61 886.26	2 663	597.16		R270	-59 298.52	2 660	506.59	
L271	-61 570.19	2 663	190.73		R271	-59 229.50	2 660	421.70	
L272	-61 322.76	2 662	872.20		R272	-58 634.74	2 659	658.26	
L273	-61 010.08	2 662	470.07		R273	-58 573.53	2 659	558.00	
L274	-60 753.24	2 662	139.99		R274	-58 542.89	2 659	474.75	
L275	-60 672.15	2 662	040.05		R275	-58 529.77	2 659	417.11	
L276	-60 571.98	2 661	927.68		R276	-58 522.84	2 659	329.28	
L277	-60 401.89	2 661	746.23		R277	-58 542.95	2 659	191.51	
L278	-60 276.07	2 661	610.42		R278	-58 571.36	2 659	111.83	
L279	-59 834.39	2 661	140.71		R279	-58 605.11	2 659	049.79	
L280	-59 307.72	2 660	578.94		R280	-58 654.14	2 658	984.08	
L281	-59 295.70	2 660	566.52		R281	-59 684.50	2 657	806.60	
L282	-59 199.40	2 660	444.38		R282	-60 055.72	2 657	382.30	
L283	-58 879.97	2 660	034.27		R283	-60 391.38	2 656	998.82	
L284	-58 585.23	2 659	655.61		R284	-60 565.91	2 656	799.48	
L285	-58 534.57	2 659	569.40		R285	-60 592.07	2 656	769.60	
L286	-58 496.80	2 659	460.05		R286	-60 741.82	2 656	598.55	
L287	-58 486.30	2 659	367.88		R287	-60 980.07	2 656	326.04	
L288	-58 486.05	2 659	361.99		R288	-61 320.35	2 655	750.72	
L289	-58 485.77	2 659	335.02		R289	-61 620.05	2 655	243.31	
L290	-58 485.04	2 659	265.83		R290	-61 894.25	2 654	778.62	
L291	-58 510.52	2 659	154.45		R291	-62 082.81	2 654	460.42	
L292	-58 569.14	2 659	024.06		R292	-62 125.11	2 654	358.45	
L293	-58 973.51	2 658	561.90		R293	-62 157.15	2 654	242.45	
L294	-59 319.11	2 658	166.89		R294	-62 192.85	2 653	654.52	
L295	-59 682.06	2 657	752.19		R295	-62 222.43	2 653	135.20	
L296	-60 024.81	2 657	360.67		R296	-62 258.85	2 652	515.53	
L297	-60 361.05	2 656	976.70		R297	-62 263.91	2 652	423.43	
L298	-60 391.25	2 656	942.19		R298	-62 238.79	2 652	246.53	
L299	-60 534.79	2 656	778.17		R299	-62 206.13	2 652	016.51	
L300	-60 618.93	2 656	682.02		R300	-62 199.15	2 651	912.47	
L301	-60 716.83	2 656	570.15		R301	-62 198.34	2 651	891.97	
L302	-60 876.05	2 656	388.27		R302	-62 201.56	2 651	846.70	
L303	-60 932.83	2 656	318.50		R303	-62 223.50	2 651	719.46	
L304	-61 006.49	2 656	207.91		R304	-62 279.25	2 651	573.86	
L305	-61 287.62	2 655	731.14		R305	-62 285.71	2 651	563.20	
L306	-61 291.68	2 655	732.97		R306	-62 335.19	2 651	481.46	
					<div> <div>Vel</div> <div>34</div> <div>Van</div> <div>39</div> <div>Sheet</div> <div>of</div> <div>P1180/19</div> </div>				

PADRESERVE KOÖRDINATE / ROAD RESERVE CO-ORDINATES									
LINKERKANT/LEFT HAND SIDE					REGTERKANT/RIGHT HAND SIDE				
	Y	X	WG 27°			Y	X		
L307	-61 359.08	2 655 614.34		R307	-62 391.01	2 651 411.62			
L308	-61 357.76	2 655 613.61		R308	-62 433.26	2 651 368.56			
L309	-61 590.32	2 655 219.44		R309	-62 607.33	2 651 205.30			
L310	-61 861.13	2 654 761.14		R310	-62 868.87	2 650 960.02			
L311	-62 022.80	2 654 487.45		R311	-62 886.95	2 650 943.51			
L312	-62 075.74	2 654 378.80		R312	-62 893.08	2 650 937.72			
L313	-62 103.01	2 654 295.08		R313	-62 975.03	2 650 860.28			
L314	-62 125.25	2 654 152.26		R314	-62 977.34	2 650 858.10			
L315	-62 154.70	2 653 644.39		R315	-63 043.12	2 650 770.17			
L316	-62 184.75	2 653 133.19		R316	-63 094.46	2 650 690.90			
L317	-62 221.00	2 652 513.91		R317	-63 315.09	2 650 132.62			
L318	-62 221.19	2 652 492.43		R318	-63 437.04	2 649 824.61			
L319	-62 221.98	2 652 444.69		R319	-63 510.10	2 649 640.08			
L320	-62 213.67	2 652 334.71		R320	-63 617.66	2 649 367.73			
L321	-62 202.56	2 652 256.99		R321	-63 649.94	2 649 285.98			
L322	-62 156.22	2 651 929.73		R322	-63 915.69	2 648 614.61			
L323	-62 157.57	2 651 892.48		R323	-64 087.26	2 648 181.36			
L324	-62 162.28	2 651 843.21		R324	-64 108.36	2 648 123.69			
L325	-62 178.22	2 651 743.04		R325	-64 127.51	2 648 063.17			
L326	-62 187.10	2 651 711.08		R326	-64 145.15	2 648 002.74			
L327	-62 203.01	2 651 653.86		R327	-64 160.54	2 647 941.86			
L328	-62 243.48	2 651 556.60		R328	-64 174.41	2 647 876.36			
L329	-62 279.90	2 651 496.04		R329	-64 199.00	2 647 748.74			
L330	-62 311.57	2 651 448.82		R330	-64 316.77	2 647 144.90			
L331	-62 363.19	2 651 383.07		R331	-64 427.72	2 646 557.63			
L332	-62 558.98	2 651 199.18		R332	-64 430.53	2 646 532.24			
L333	-62 887.89	2 650 890.28		R333	-64 430.09	2 646 532.39			
L334	-62 895.27	2 650 883.35		R334	-64 433.22	2 646 400.37			
L335	-62 920.03	2 650 857.53		R335	-64 420.86	2 646 271.93			
L336	-62 924.76	2 650 851.99		R336	-64 392.43	2 646 142.92			
L337	-63 009.41	2 650 752.76		R337	-64 356.88	2 646 043.75			
L338	-63 087.83	2 650 605.58		R338	-64 313.77	2 645 943.42			
L339	-63 279.16	2 650 121.01		R339	-64 255.32	2 645 846.79			
L340	-63 392.81	2 649 834.14		R340	-64 190.43	2 645 755.59			
L341	-63 474.15	2 649 628.80		R341	-64 042.76	2 645 594.98			
L342	-63 493.00	2 649 581.21		R342	-64 040.41	2 645 594.11			
L343	-63 615.82	2 649 270.70		R343	-63 544.65	2 645 065.42			
L344	-64 077.03	2 648 103.97		R344	-63 518.18	2 645 034.91			
L345	-64 095.37	2 648 039.08		R345	-63 483.11	2 644 981.93			
L346	-64 137.42	2 647 867.29		R346	-63 457.77	2 644 929.73			
L347	-64 154.67	2 647 779.26		R347	-63 438.99	2 644 872.78			
L348	-64 281.52	2 647 124.26		R348	-63 426.04	2 644 785.74			
L349	-64 375.25	2 646 640.47		R349	-63 427.08	2 644 739.58			
L350	-64 388.54	2 646 546.36		R350	-63 427.21	2 644 733.99			
L351	-64 390.00	2 646 532.49		R351	-63 439.75	2 644 655.66			
L352	-64 393.64	2 646 394.93		R352	-63 590.73	2 644 066.79			
L353	-64 384.71	2 646 298.53		R353	-63 616.50	2 643 975.77			
L354	-64 357.60	2 646 179.09		R354	-63 652.04	2 643 864.90			
L355	-64 298.09	2 646 002.06		R355	-63 837.22	2 643 391.92			
L356	-64 221.68	2 645 865.08		R356	-64 042.14	2 642 860.24			
L357	-64 156.78	2 645 776.56		R357	-64 205.06	2 642 441.37			
					Vel Sheet	35	Van of	39	P1180/19

PADRESERWE KOÖRDINATE / ROAD RESERVE CO-ORDINATES									
LINKERKANT/LEFT HAND SIDE					REGTERKANT/RIGHT HAND SIDE				
	Y	X	WG 27°			Y	X		
L358	-64 057.04	2 645 666.60		R358	-64 466.55	2 641 761.95			
L359	-63 961.74	2 645 565.13		R359	-64 485.80	2 641 735.62			
L360	-63 497.63	2 645 070.33		R360	-64 525.97	2 641 680.37			
L361	-63 467.54	2 645 028.16		R361	-64 589.78	2 641 627.15			
L362	-63 434.52	2 644 980.35		R362	-64 635.49	2 641 598.01			
L363	-63 396.05	2 644 851.49		R363	-64 679.82	2 641 578.27			
L364	-63 387.79	2 644 797.34		R364	-64 753.02	2 641 562.54			
L365	-63 388.26	2 644 722.35		R365	-64 809.72	2 641 555.71			
L366	-63 388.12	2 644 713.14		R366	-64 865.23	2 641 559.27			
L367	-63 402.89	2 644 647.28		R367	-65 565.25	2 641 800.59			
L368	-63 476.19	2 644 368.61		R368	-65 598.51	2 641 802.93			
L369	-63 486.98	2 644 320.87		R369	-65 688.15	2 641 807.78			
L370	-63 562.34	2 644 030.52		R370	-65 744.46	2 641 794.01			
L371	-63 596.51	2 643 916.07		R371	-65 854.71	2 641 723.83			
L372	-63 619.91	2 643 850.98		R372	-66 041.35	2 641 502.28			
L373	-64 170.39	2 642 423.33		R373	-66 131.04	2 641 446.11			
L374	-64 413.63	2 641 792.92		R374	-66 135.99	2 641 445.05			
L375	-64 468.61	2 641 692.47		R375	-66 229.46	2 641 424.99			
L376	-64 528.21	2 641 629.02		R376	-66 299.24	2 641 410.02			
L377	-64 595.81	2 641 577.12		R377	-66 385.04	2 641 353.18			
L378	-64 648.91	2 641 541.66		R378	-66 423.66	2 641 301.86			
L379	-64 776.15	2 641 504.43		R379	-66 470.43	2 641 192.94			
L380	-64 798.27	2 641 495.96		R380	-66 497.82	2 641 123.75			
L381	-64 875.18	2 641 519.62		R381	-66 502.02	2 641 124.06			
L382	-64 928.81	2 641 529.75		R382	-66 513.48	2 641 099.68			
L383	-65 523.56	2 641 745.34		R383	-66 535.64	2 641 043.37			
L384	-65 576.47	2 641 762.16		R384	-66 555.36	2 640 960.11			
L385	-65 692.31	2 641 754.95		R385	-66 557.11	2 640 878.60			
L386	-65 758.33	2 641 729.73		R386	-66 538.40	2 640 758.93			
L387	-65 776.80	2 641 733.16		R387	-66 502.69	2 640 614.93			
L388	-65 805.59	2 641 718.19		R388	-66 470.53	2 640 485.25			
L389	-65 824.22	2 641 700.61		R389	-66 470.18	2 640 472.11			
L390	-65 853.63	2 641 669.49		R390	-66 492.16	2 640 373.07			
L391	-66 047.09	2 641 436.20		R391	-66 585.52	2 640 259.16			
L392	-66 129.54	2 641 410.10		R392	-66 684.03	2 640 148.13			
L393	-66 155.45	2 641 401.32		R393	-66 733.16	2 640 106.48			
L394	-66 201.02	2 641 392.71		R394	-66 793.16	2 640 055.62			
L395	-66 289.64	2 641 373.67		R395	-66 862.86	2 640 017.39			
L396	-66 345.14	2 641 337.25		R396	-66 922.31	2 639 988.98			
L397	-66 381.31	2 641 287.85		R397	-67 020.45	2 639 969.20			
L398	-66 404.28	2 641 241.61		R398	-67 146.27	2 639 965.90			
L399	-66 400.53	2 641 238.03		R399	-67 181.92	2 639 962.80			
L400	-66 420.51	2 641 209.72		R400	-67 211.48	2 639 952.08			
L401	-66 430.76	2 641 172.71		R401	-67 233.17	2 639 940.77			
L402	-66 453.13	2 641 149.23		R402	-67 285.15	2 639 883.23			
L403	-66 479.16	2 641 090.49		R403	-67 286.26	2 639 830.25			
L404	-66 517.55	2 640 956.30		R404	-67 272.66	2 639 464.61			
L405	-66 502.60	2 640 767.03		R405	-67 265.56	2 639 262.14			
L406	-66 469.01	2 640 623.25		R406	-67 264.77	2 639 091.90			
L407	-66 434.79	2 640 533.13		R407	-67 299.51	2 638 432.06			
L408	-66 438.98	2 640 414.11		R408	-67 311.95	2 638 278.08			
					Vel Sheet	36	Van of	39	P1180/19

PADRESERVE KOÖRDINATE / ROAD RESERVE CO-ORDINATES																			
LINKERKANT/LEFT HAND SIDE					REGTERKANT/RIGHT HAND SIDE														
	Y	X	WG 27°			Y	X												
L409	-66 457.85	2 640 355.06			R409	-67 345.25	2 638 129.28												
L410	-66 557.90	2 640 231.47			R410	-67 380.59	2 637 984.29												
L411	-66 687.89	2 640 092.56			R411	-67 437.07	2 637 842.30												
L412	-66 851.28	2 639 975.82			R412	-67 475.14	2 637 761.54												
L413	-66 930.39	2 639 938.62			R413	-67 505.78	2 637 710.42												
L414	-67 011.81	2 639 922.59			R414	-67 531.28	2 637 671.63												
L415	-67 169.97	2 639 917.72			R415	-67 588.74	2 637 583.91												
L416	-67 219.16	2 639 903.64			R416	-67 734.36	2 637 408.48												
L417	-67 246.63	2 639 841.94			R417	-67 799.10	2 637 350.58												
L418	-67 250.31	2 639 833.67			R418	-67 884.80	2 637 279.99												
L419	-67 236.93	2 639 450.20			R419	-68 328.61	2 636 977.67												
L420	-67 229.57	2 639 263.13			R420	-68 345.14	2 636 966.41												
L421	-67 228.76	2 639 087.62			R421	-68 815.77	2 636 646.05												
L422	-67 236.28	2 638 940.52			R422	-68 981.24	2 636 529.84												
L423	-67 256.55	2 638 547.06			R423	-69 189.45	2 636 387.72												
L424	-67 266.54	2 638 350.56			R424	-69 245.68	2 636 344.90												
L425	-67 284.74	2 638 196.91			R425	-69 251.24	2 636 340.67												
L426	-67 300.36	2 638 096.55			R426	-69 286.21	2 636 312.24												
L427	-67 371.54	2 637 900.90			R427	-69 358.66	2 636 254.08												
L428	-67 415.57	2 637 798.43			R428	-69 497.96	2 636 094.37												
L429	-67 501.29	2 637 641.43			R429	-69 854.00	2 635 648.78												
L430	-67 651.34	2 637 443.70			R430	-69 857.02	2 635 657.10												
L431	-67 677.38	2 637 417.29			R431	-70 235.70	2 635 186.22												
L432	-67 760.08	2 637 333.43			R432	-70 632.76	2 634 687.81												
L433	-67 883.27	2 637 233.78			R433	-70 972.53	2 634 260.67												
L434	-67 890.65	2 637 227.42			R434	-71 282.60	2 633 879.19												
L435	-68 305.33	2 636 945.08			R435	-71 611.20	2 633 462.46												
L436	-68 783.66	2 636 618.88			R436	-71 960.04	2 633 022.17												
L437	-69 139.67	2 636 376.49			R437	-72 240.41	2 632 671.23												
L438	-69 258.81	2 636 285.97			R438	-72 619.80	2 632 217.62												
L439	-69 369.44	2 636 183.43			R439	-72 614.39	2 632 210.88												
L440	-69 445.57	2 636 098.67			R440	-72 618.43	2 632 206.06												
L441	-69 468.62	2 636 071.27			R441	-72 800.84	2 632 121.22												
L442	-69 838.42	2 635 605.96			R442	-73 669.81	2 631 958.20												
L443	-70 195.48	2 635 159.32			R443	-73 821.31	2 631 943.37												
L444	-70 569.83	2 634 689.67			R444	-74 120.67	2 631 974.14												
L445	-70 928.22	2 634 240.04			R445	-74 176.14	2 631 973.70												
L446	-71 248.34	2 633 838.54			R446	-74 240.00	2 631 964.12												
L447	-71 572.50	2 633 432.33			R447	-74 332.80	2 631 935.77												
L448	-71 922.32	2 632 993.58			R448	-74 410.88	2 631 900.00												
L449	-72 197.05	2 632 649.14			R449	-74 514.00	2 631 821.42												
L450	-72 393.99	2 632 401.31			R450	-74 583.61	2 631 738.29												
L451	-72 539.50	2 632 220.01			R451	-74 619.95	2 631 669.40												
L452	-72 586.47	2 632 176.06			R452	-74 636.50	2 631 588.52												
L453	-72 587.44	2 632 177.27			R453	-74 642.76	2 631 474.38												
L454	-72 621.25	2 632 154.92			R454	-74 610.10	2 631 371.87												
L455	-72 665.20	2 632 124.16			R455	-74 390.25	2 630 877.08												
L456	-72 760.17	2 632 090.89			R456	-74 369.83	2 630 778.00												
L457	-73 752.73	2 631 905.32			R457	-74 337.33	2 630 083.86												
L458	-73 871.40	2 631 909.02			R458	-74 343.53	2 629 875.00												
L459	-73 971.90	2 631 919.61			R459	-74 351.22	2 629 815.91												
					<table><tr><td>Vel</td><td>37</td><td>Van</td><td>39</td><td>P1180/19</td></tr><tr><td>Sheet</td><td></td><td>of</td><td></td><td></td></tr></table>					Vel	37	Van	39	P1180/19	Sheet		of		
Vel	37	Van	39	P1180/19															
Sheet		of																	

PADRESERWE KOÖRDINATE / ROAD RESERVE CO-ORDINATES									
LINKERKANT/LEFT HAND SIDE					REGTERKANT/RIGHT HAND SIDE				
	Y	X	WG 27°			Y	X		
L460	-74 105.41	2 631	916.76		R460	-74 370.12	2 629	741.08	
L461	-74 294.20	2 631	892.64		R461	-74 402.71	2 629	660.92	
L462	-74 420.48	2 631	836.68		R462	-74 439.80	2 629	569.68	
L463	-74 502.22	2 631	755.83		R463	-74 530.72	2 629	422.66	
L464	-74 575.49	2 631	638.96		R464	-74 576.17	2 629	321.32	
L465	-74 594.43	2 631	525.10		R465	-74 621.02	2 629	176.47	
L466	-74 562.81	2 631	359.12		R466	-74 676.26	2 628	701.27	
L467	-74 512.76	2 631	251.56		R467	-74 721.40	2 628	303.25	
L468	-74 357.13	2 630	917.16		R468	-74 737.42	2 628	169.07	
L469	-74 334.24	2 630	825.97		R469	-74 747.27	2 628	091.46	
L470	-74 297.28	2 630	037.29		R470	-74 787.91	2 627	968.49	
L471	-74 297.98	2 629	932.93		R471	-74 848.19	2 627	832.62	
L472	-74 313.30	2 629	797.00		R472	-75 033.61	2 627	523.17	
L473	-74 349.16	2 629	685.35		R473	-75 062.79	2 627	474.48	
L474	-74 360.88	2 629	647.62		R474	-75 289.43	2 627	099.10	
L475	-74 395.80	2 629	576.14		R475	-75 319.62	2 627	049.10	
L476	-74 439.54	2 629	498.75		R476	-75 329.28	2 627	026.26	
L477	-74 539.66	2 629	308.38		R477	-75 374.69	2 626	896.14	
L478	-74 580.67	2 629	168.60		R478	-75 393.12	2 626	765.45	
L479	-74 593.58	2 629	088.71		R479	-75 396.68	2 626	708.06	
L480	-74 637.16	2 628	708.16		R480	-75 428.44	2 626	187.77	
L481	-74 681.64	2 628	320.23		R481	-75 429.11	2 626	174.57	
L482	-74 686.54	2 628	280.01		R482	-75 454.53	2 625	763.42	
L483	-74 707.90	2 628	095.56		R483	-75 467.13	2 625	577.11	
L484	-74 735.25	2 628	008.71		R484	-75 477.22	2 625	396.38	
L485	-74 780.88	2 627	869.28		R485	-75 493.03	2 625	165.55	
L486	-75 013.93	2 627	483.65		R486	-75 509.72	2 624	918.90	
L487	-75 086.61	2 627	361.86		R487	-75 538.15	2 624	775.22	
L488	-75 233.43	2 627	119.82		R488	-75 639.13	2 624	430.09	
L489	-75 272.03	2 627	057.45		R489	-75 681.07	2 624	277.46	
L490	-75 296.87	2 626	997.87		R490	-75 682.54	2 624	267.00	
L491	-75 339.18	2 626	858.90		R491	-75 696.66	2 624	101.31	
L492	-75 356.44	2 626	752.67		R492	-75 669.76	2 623	821.19	
L493	-75 357.65	2 626	733.87		R493	-75 654.52	2 623	661.39	
L494	-75 390.54	2 626	197.09		R494	-75 634.37	2 623	447.59	
L495	-75 390.42	2 626	193.66		R495	-75 610.71	2 623	199.56	
L496	-75 416.21	2 625	776.55		R496	-75 606.19	2 623	158.66	
L497	-75 428.29	2 625	581.18		R497	-75 592.47	2 623	011.69	
L498	-75 438.81	2 625	409.55		R498	-75 571.65	2 622	795.82	
L499	-75 453.17	2 625	178.54		R499	-75 516.94	2 622	462.90	
L500	-75 464.22	2 624	997.75		R500	-75 487.87	2 622	284.33	
L501	-75 472.22	2 624	916.74		R501	-75 477.79	2 622	224.96	
L502	-75 489.66	2 624	808.34		R502	-75 445.17	2 622	022.82	
L503	-75 595.23	2 624	445.07		R503	-75 435.17	2 621	927.78	
L504	-75 639.19	2 624	281.79		R504	-75 435.04	2 621	927.01	
L505	-75 652.70	2 624	180.00		R505	-75 429.57	2 621	859.66	
L506	-75 655.25	2 624	098.20		R506	-75 430.88	2 621	761.43	
L507	-75 651.33	2 624	019.97		R507	-75 449.68	2 621	606.40	
L508	-75 633.60	2 623	833.93		R508	-75 497.69	2 621	347.38	
L509	-75 617.78	2 623	668.81		R509	-75 562.85	2 620	993.45	
L510	-75 598.15	2 623	460.50		R510	-75 566.27	2 620	981.42	
					<div> <div>Vel</div> <div>38</div> <div>Van</div> <div>39</div> <div>Sheet</div> <div>of</div> <div>P1180/19</div> </div>				

PADRESERWE KOÖRDINATE / ROAD RESERVE CO-ORDINATES									
LINKERKANT/LEFT HAND SIDE					REGTERKANT/RIGHT HAND SIDE				
	Y		X	WG 27°		Y		X	
L511	-75 574.09	2	623	212.67	R511	-75 591.63	2	620	912.34
L512	-75 555.87	2	623	024.87	R512	-75 637.92	2	620	862.48
L513	-75 535.40	2	622	818.03	R513	-75 637.92	2	620	862.24
L514	-75 481.71	2	622	474.52	R514	-75 641.39	2	620	812.53
L515	-75 452.35	2	622	298.86	R515	-75 616.50	2	620	773.89
L516	-75 441.86	2	622	236.81	R516	-75 620.57	2	620	699.19
L517	-75 407.82	2	622	028.61	R517	-75 616.75	2	620	700.02
L518	-75 395.78	2	621	938.86	R518	-75 619.03	2	620	687.14
L519	-75 393.08	2	621	915.20	R519	-75 645.64	2	620	538.92
L520	-75 391.45	2	621	837.88	R520	-75 657.25	2	620	477.40
L521	-75 393.40	2	621	760.01	R521	-75 661.10	2	620	476.68
L522	-75 403.01	2	621	651.92	R522	-75 670.56	2	620	419.14
L523	-75 457.80	2	621	356.57	R523	-75 676.43	2	620	357.70
L524	-75 493.34	2	621	166.73	R524	-75 676.26	2	620	277.81
L525	-75 524.75	2	621	001.45	R525	-75 670.51	2	620	216.85
L526	-75 540.99	2	620	913.79	R526	-75 670.42	2	620	215.85
L527	-75 534.09	2	620	863.06	R527	-75 656.95	2	620	144.33
L528	-75 492.57	2	620	840.12	R528	-75 641.53	2	620	068.06
L529	-75 499.83	2	620	800.77	R529	-75 630.88	2	620	015.37
L530	-75 546.96	2	620	793.87					
L531	-75 571.30	2	620	750.04					
L532	-75 579.08	2	620	707.96					
L533	-75 582.82	2	620	707.17					
L534	-75 601.50	2	620	606.47					
L535	-75 608.11	2	620	546.59					
L536	-75 619.05	2	620	484.56					
L537	-75 633.72	2	620	419.35					
L538	-75 641.52	2	620	364.57					
L539	-75 642.89	2	620	284.56					
L540	-75 640.95	2	620	253.65					
L541	-75 637.35	2	620	221.36					
L542	-75 624.80	2	620	151.36					
L543	-75 609.22	2	620	070.05					
L544	-75 599.10	2	620	017.28					