GOVERNMENT NOTICES • GOEWERMENTSKENNISGEWINGS

DEPARTMENT OF TRANSPORT

NO. 6423

11 July 2025

**THE SOUTH AFRICAN NATIONAL ROADS
AGENCY SOC LIMITED**Registration No: 1998/009584/30

**DECLARATION AMENDMENT OF NATIONAL ROAD R510 SECTION 2 AND DECLARATION OF
EXISTING ROAD THROUGH THE TOWN OF THABAZIMBI AS PART OF NATIONAL ROAD R510
SECTION 2**

- i) By virtue of Section 40 (1)(a) of The South African National Road Agency Limited and National Roads Act 1998 (Act No. 7 of 1998), I hereby declare the section of the road, commencing from points L214 and R181 on accompanying sheet 9 of Plan No. P1173/19, up to its junction with the street known as Provincial Avenue in Thabazimbi at the time of declaration, at points L258 and R223 on the accompanying sheet 10 of Plan No. P1173/19, as a National Road.
- ii) By virtue of section 40(1)(b) of the South African National Roads Agency Limited and the National Roads Act 1998 (Act No. 7 of 1998), I hereby amend Declaration No. 190 of 2009 by substituting it in its entirety, with the accompanying sheets 1 to 15 of Plan No. P1173/19.

(National Road R510 Section 2: Northam – Thabazimbi)
MINISTER OF TRANSPORT

DEPARTEMENT VAN VERVOER

NO. 6423

11 Julie 2025

**DIE SUID-AFRIKAANSE NASIONALE
PADAGENTSKAP MSB BEPERK**

* Registrasie No: 1998/009584/30

**VERKLARING WYSIGING VAN NASIONALE PAD R510 SEKSIE 2 EN VERKLARING VAN
BESTAANDE PAD DEUR DIE DORPSGEBIED VAN THABAZIMBI DEEL VAN NASIONALE PAD R510
SEKSIE 2**

- i) Kragtens Artikel 40(1)(a) van die Suid-Afrikaanse Nasionale Padagentskap Beperk en Nasionale Paaie Wet 1998 (Wet No. 7 van 1998), verklaar ek hiermee die gedeelte van die pad, vanaf punte L214 en R181 op bygaande vel 9 van Plan No. P1173/19, tot by die aansluiting met die straat bekend as Provincial Weg, tydens datum van verklaring, by punte L258 en R223 op bygaande vel 10 van Plan No. P1173/19, as 'n Nasionale Pad.
- ii) Kragtens Artikel 40(1)(b) van die Suid-Afrikaanse Nasionale Padagentskap Beperk en Nasionale Paaie Wet 1998 (Wet No. 7 van 1998), wysig ek hiermee Verklaring No. 190 van 2009 deur dit in sy geheel te vervang, met bygaande velle 1 tot 15 van Plan No. P1173/19.

(Nasionale Pad R510 Seksie 2: Northam – Thabazimbi)
MINISTER VAN VERVOER

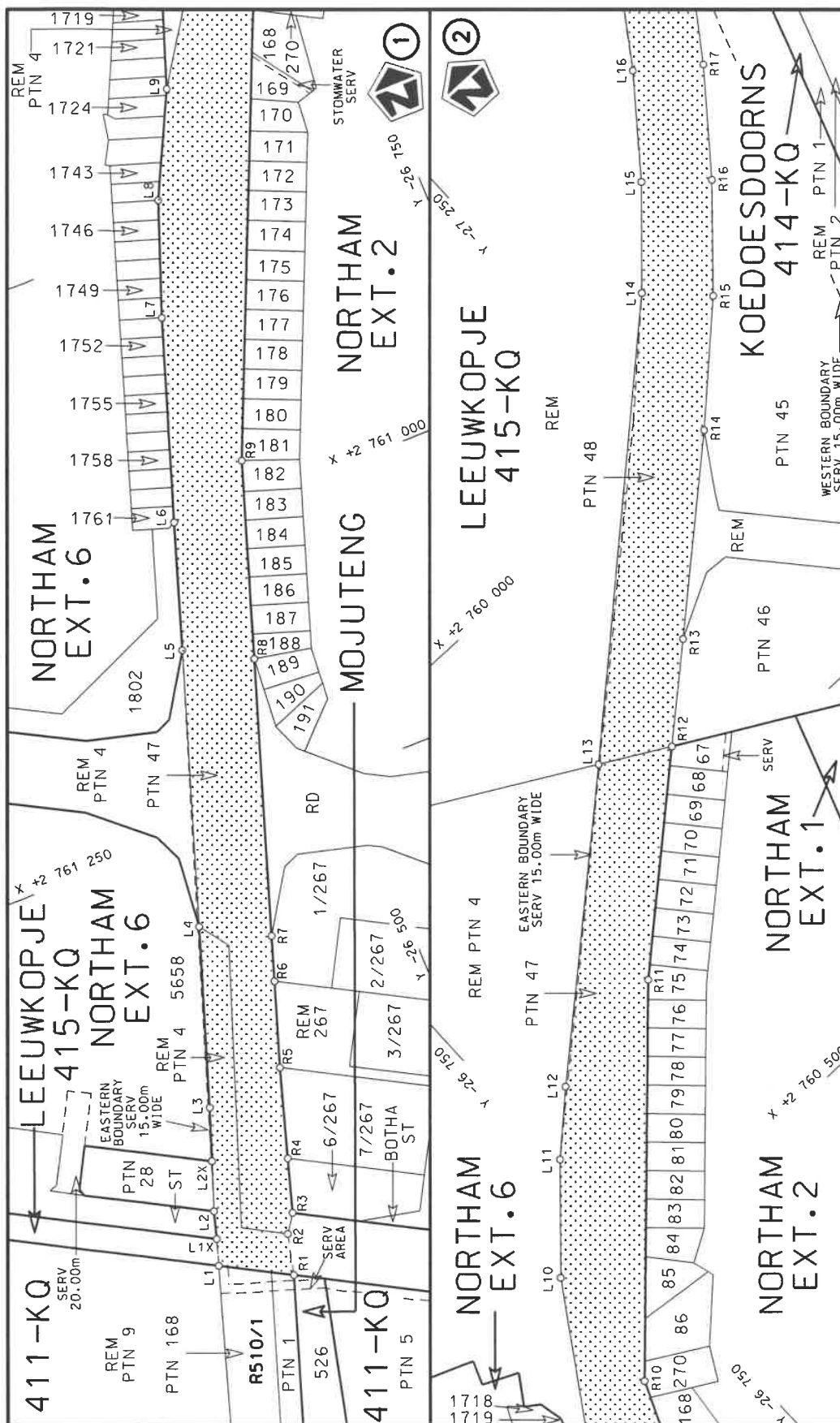

Die Suid Afrikaanse Nasionale Padagentskap MSB Bpk	Die figuur getoon		steldie padreserwe voor van 'n gedeelte represents the road reserve of a portion van Nasionale Roete R510 Seksie of National Route Section	Vel Sheet	1 of	15
The South African National Roads Agency SOC Ltd	The figure shown			2	Plan	P1173/19

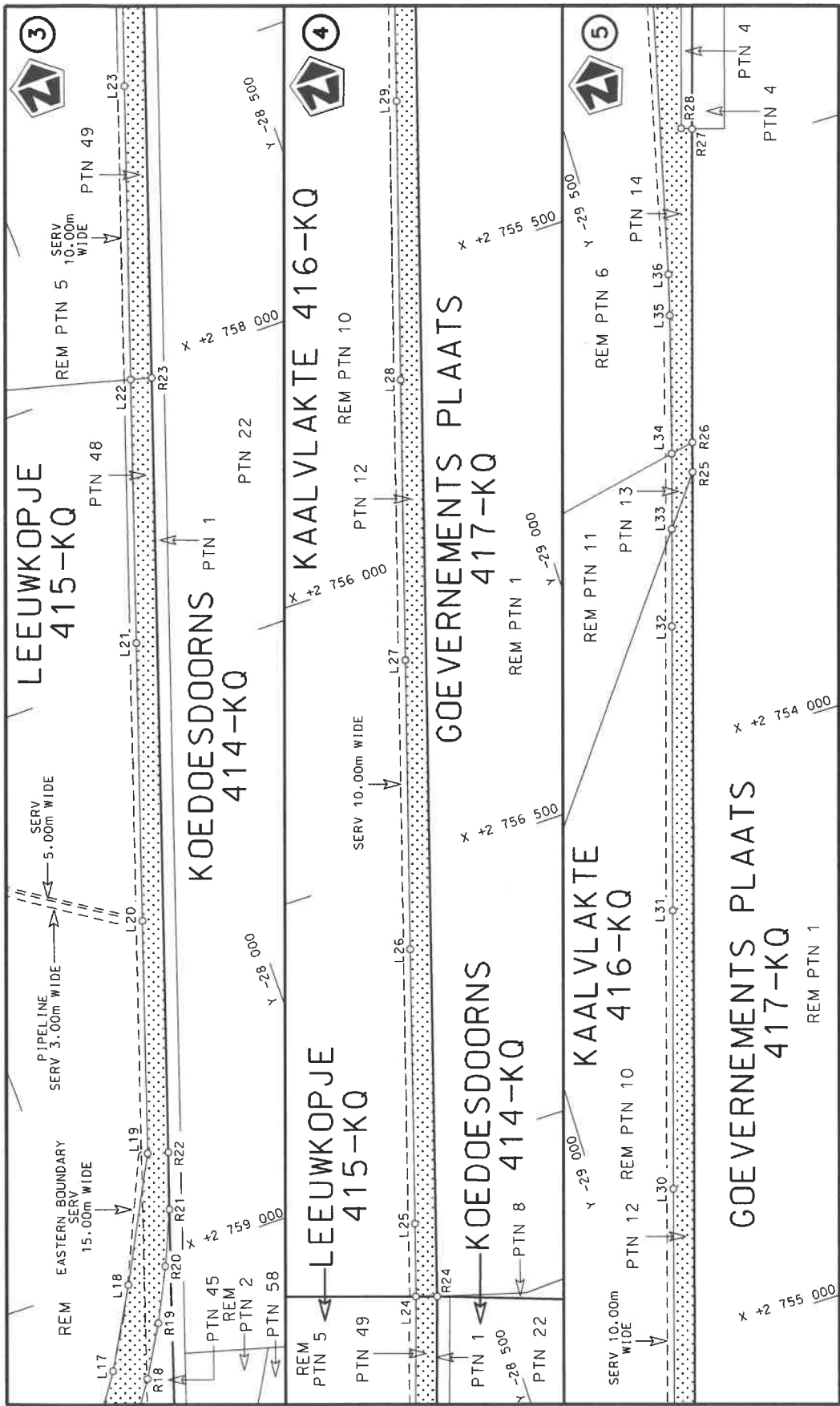

Die Suid Afrikaanse Nasionale Padagentskap MSB Bpk The South African National Roads Agency SOC Ltd	Die figuur getoon The figure shown		steldie padreserwe voor van 'n gedeelte represents the road reserve of a portion van Nasionale Roete of National Route	2	Plan P1173/19

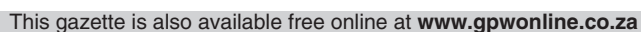

Die Suid Afrikaanse Nasionale Padagentskap MSB Bpk	Die figuur getoon		steldie podreserwe voor van 'n gedeelte represents the road reserve of a portion	Vel Sheet	3 of	15
The South African National Roads Agency SOC Ltd	The figure shown		van Nasionale Roete of National Route	2	Plan	P1173/19

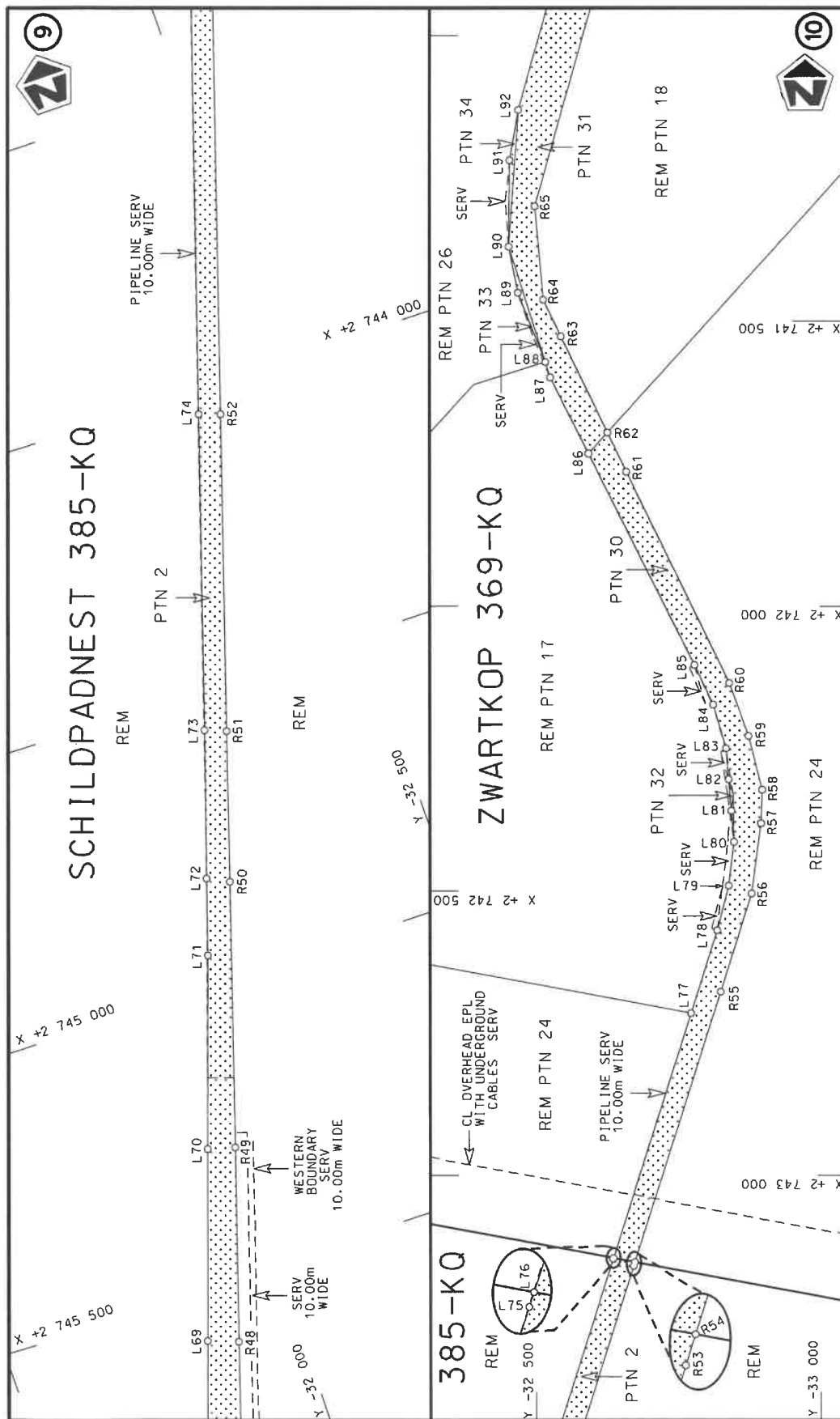

Die Suid-Afrikaanse Nasionale Padagentskap MSB Bpk The South African National Roads Agency SOC Ltd	Die figuur getoon The figure shown	steldie padreserwe voor van 'n gedeelte represents the road reserve of a portion van Nasionale Roete R510 of National Route	Vel Sheet 4 van of 15 Plan P1173/19
---	---------------------------------------	--	---

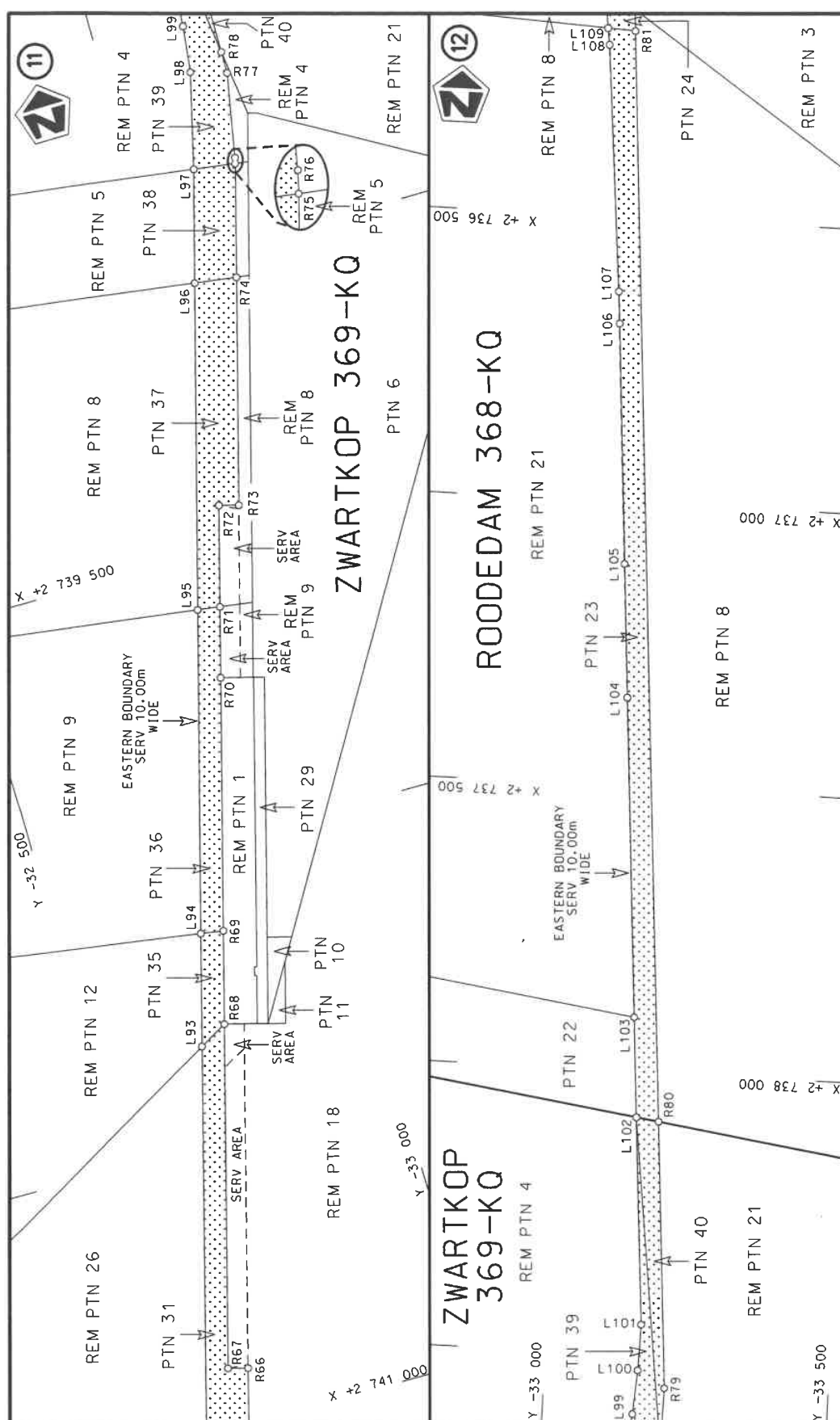

Die Suid Afrikaanse Nasionale Padagentskap MSB Bpk The South African National Roads Agency SOC Ltd	Die figuur getoon The figure shown		steldie padreserwe voor van 'n gedeelte represents the road reserve of a portion van Nasionale Roete R510 of National Route	2	Vel Sheet 5 of 15
					Plan P1173/19

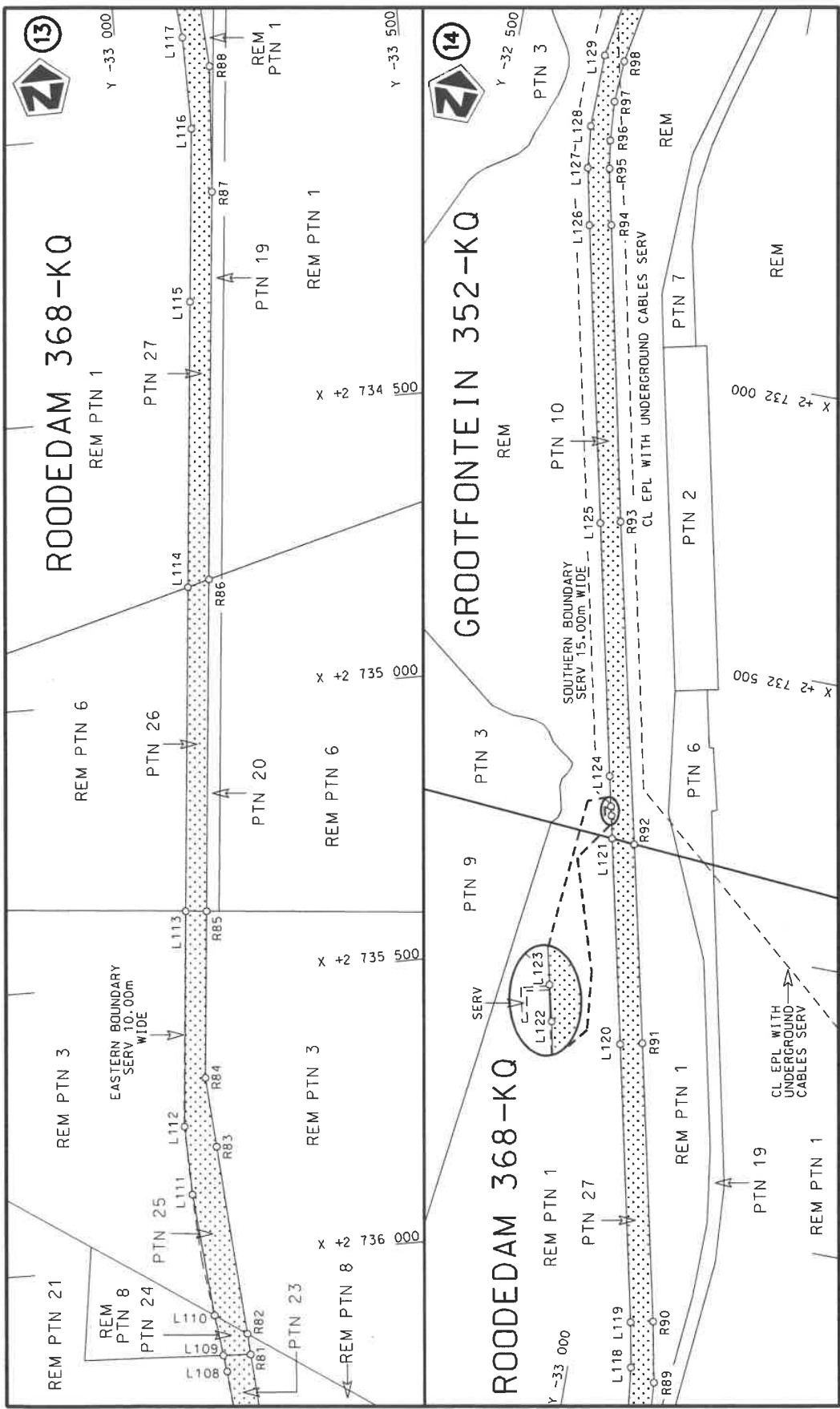

Die Suid Afrikaanse Nasionale Padagentskap MSB Bpk The South African National Roads Agency SOC Ltd	Die figuur getoon The figure shown	stel die padreserwe voor van 'n gedeelte represents the road reserve of a portion van Nasionale Roete of National Route	Vel Sheet	van 6	of 15
			Plan	P1173/19	

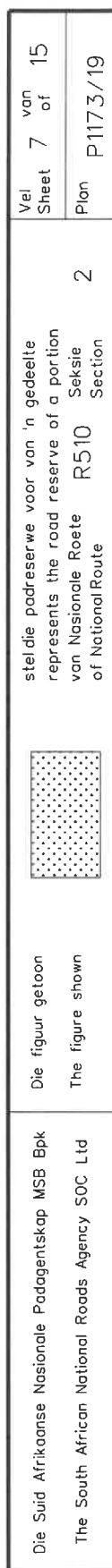

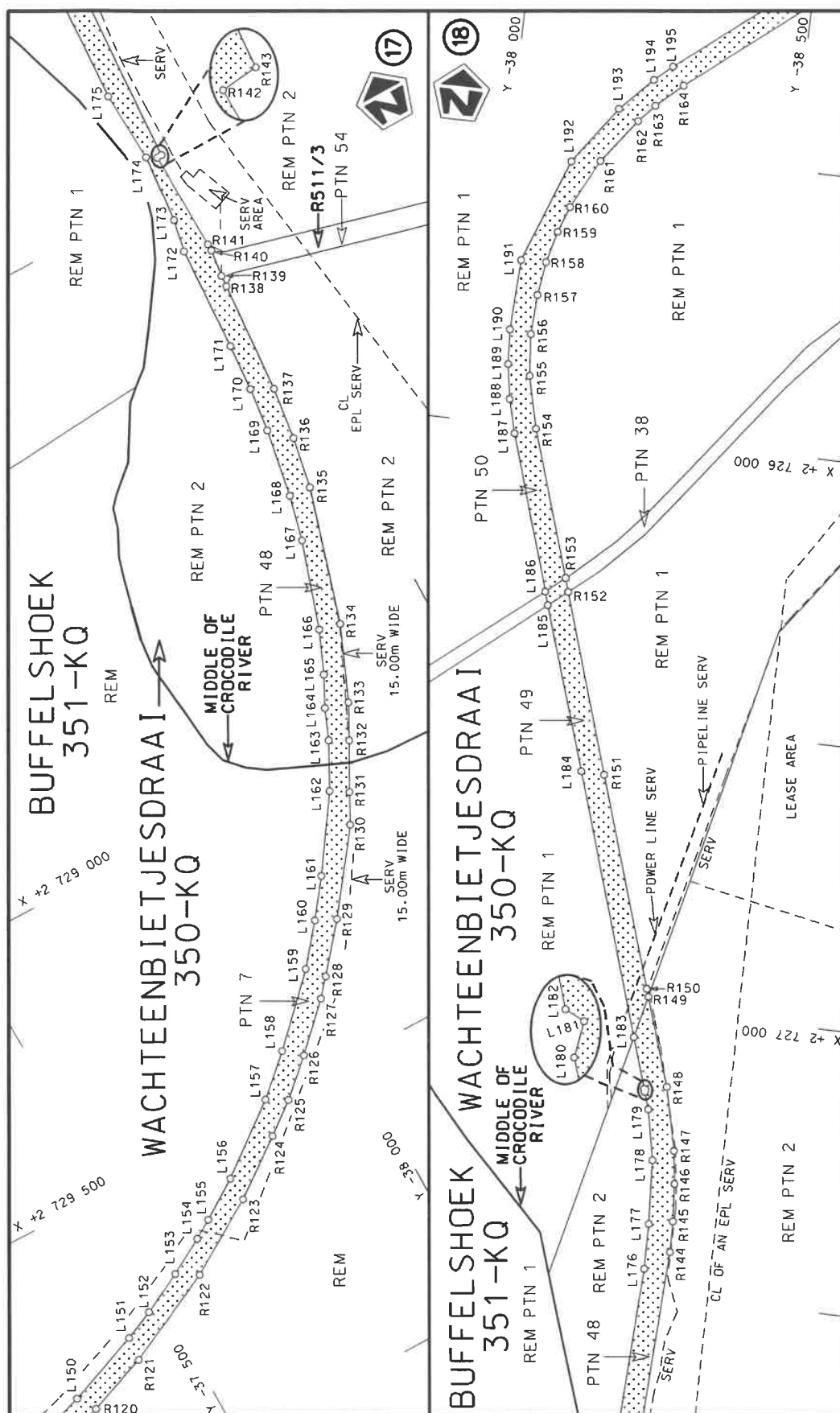

Die Suid Afrikaanse Nasionale Padagentskap MSB Bpk The South African National Roads Agency SOC Ltd	Die figuur getoon The figure shown	<div data-bbox="1300 1075 1380 1220" data-label="Image"> </div>	stel die padreserwe voor van 'n gedeelte represents the road reserve of a portion van Nasionale Roete of National Route	Vel Sheet 8 of 15 Plan P1173/19
---	---------------------------------------	---	--	---

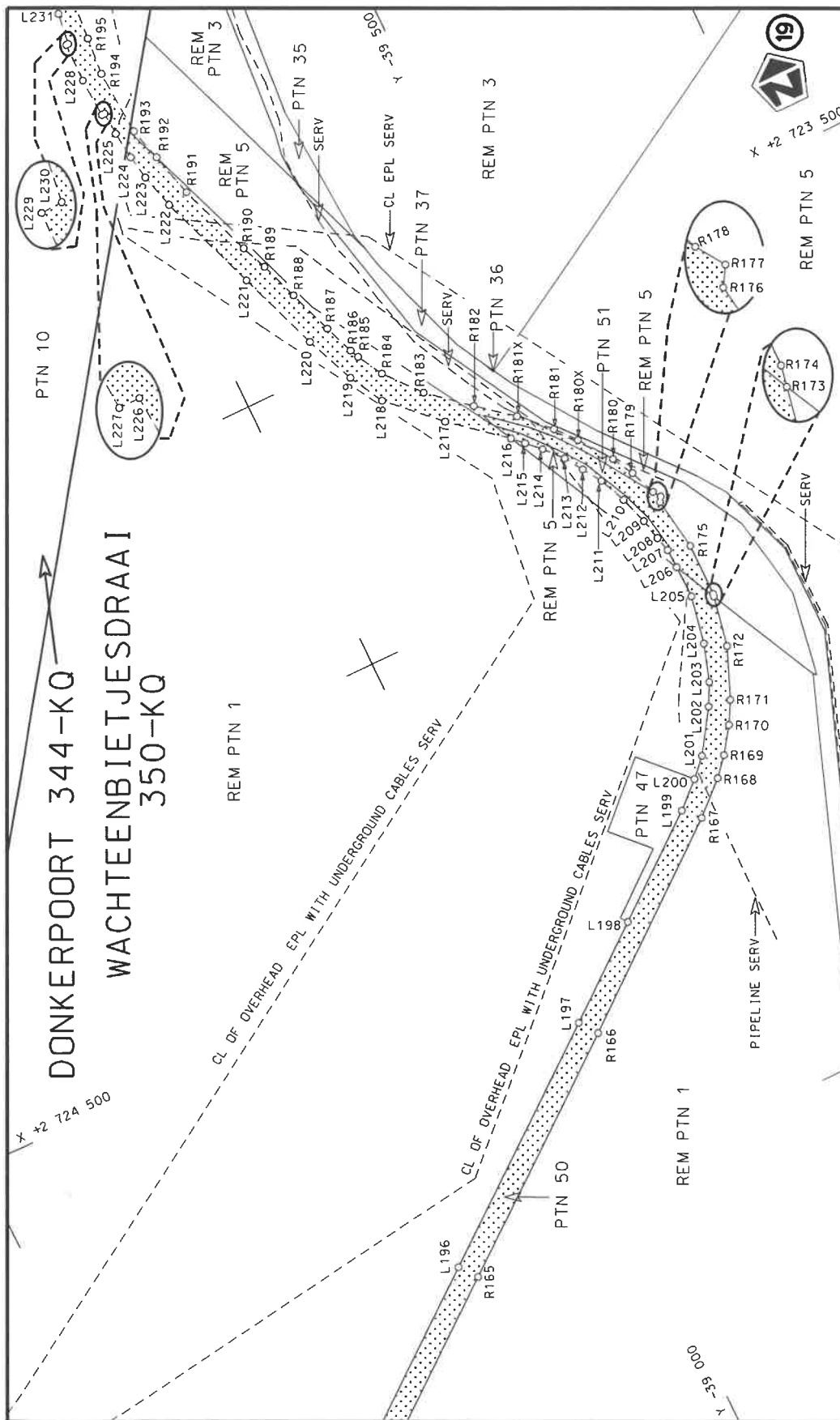

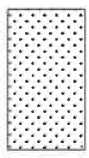
Die Suid Afrikaanse Nasionale Padagentskap MSB Bpk The South African National Roads Agency SOC Ltd	Die figuur getoon The figure shown		steldie padreserwe voor van 'n gedeelte represents the road reserve of a portion van Nasionale Roete R510 of National Route	Vel Sheet 9 of 15	Plan P1173/19
---	---------------------------------------	---	--	----------------------	------------------

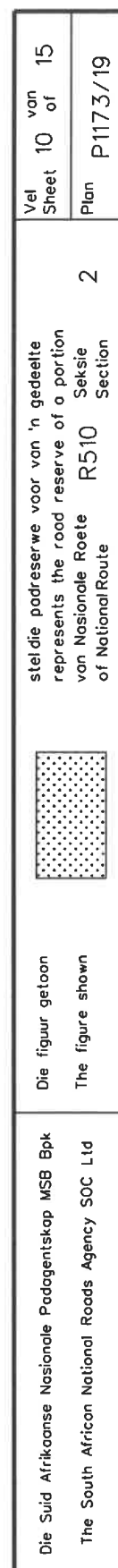

PADRESERWE KOÖRDINATE / ROAD RESERVE CO-ORDINATES									
LINKERKANT/LEFT HAND SIDE					REGTERKANT/RIGHT HAND SIDE				
	Y	X	WG 27 ^a		Y	X			
L1	-26 235.24	2 761 611.59		R1	-26 292.78	2 761 643.15			
L1X	-26 242.29	2 761 589.11		R2	-26 301.18	2 761 607.74			
L2	-26 249.05	2 761 565.61		R3	-26 311.93	2 761 592.11			
L2X	-26 263.74	2 761 524.13		R4	-26 325.81	2 761 546.27			
L3	-26 279.39	2 761 479.99		R5	-26 349.04	2 761 469.83			
L4	-26 329.67	2 761 329.29		R6	-26 372.75	2 761 397.83			
L5	-26 405.74	2 761 099.03		R7	-26 385.19	2 761 360.04			
L6	-26 440.79	2 760 992.58		R8	-26 461.18	2 761 129.21			
L7	-26 496.82	2 760 822.41		R9	-26 515.51	2 760 964.18			
L8	-26 531.93	2 760 725.85		R10	-26 676.24	2 760 587.77			
L9	-26 574.88	2 760 638.23		R11	-26 916.32	2 760 330.60			
L10	-26 683.71	2 760 471.92		R12	-27 069.62	2 760 193.93			
L11	-26 753.40	2 760 395.12		R13	-27 140.35	2 760 131.04			
L12	-26 800.16	2 760 351.17		R14	-27 277.43	2 760 008.73			
L13	-27 012.01	2 760 162.51		R15	-27 362.49	2 759 927.50			
L14	-27 318.01	2 759 883.62		R16	-27 429.90	2 759 851.99			
L15	-27 383.31	2 759 811.66		R17	-27 492.39	2 759 772.40			
L16	-27 443.18	2 759 734.93		R18	-27 549.81	2 759 688.77			
L17	-27 497.27	2 759 655.26		R19	-27 600.83	2 759 601.74			
L18	-27 573.76	2 759 520.26		R20	-27 646.39	2 759 510.65			
L19	-27 683.61	2 759 311.10		R21	-27 686.82	2 759 418.07			
L20	-27 812.59	2 758 919.04		R22	-27 718.83	2 759 321.64			
L21	-27 966.59	2 758 450.74		R23	-28 148.14	2 758 016.65			
L22	-28 112.35	2 758 007.41		R24	-28 402.17	2 757 244.48			
L23	-28 274.44	2 757 513.92		R25	-29 540.70	2 753 528.10			
L24	-28 366.48	2 757 233.03		R26	-29 556.13	2 753 477.74			
L25	-28 404.80	2 757 109.63		R27	-29 718.56	2 752 947.54			
L26	-28 547.48	2 756 643.75		R28	-29 700.48	2 752 940.96			
L27	-28 697.96	2 756 153.52		R29	-29 822.64	2 752 540.90			
L28	-28 843.49	2 755 678.65		R30	-29 878.68	2 752 358.63			
L29	-28 988.22	2 755 206.90		R31	-29 896.11	2 752 363.97			
L30	-29 132.92	2 754 732.85		R32	-30 042.02	2 751 889.17			
L31	-29 277.92	2 754 260.50		R33	-30 188.02	2 751 416.05			
L32	-29 425.19	2 753 778.74		R34	-30 332.93	2 750 940.25			
L33	-29 475.88	2 753 613.89		R35	-30 396.37	2 750 733.57			
L34	-29 515.09	2 753 486.22		R36	-30 561.09	2 750 195.24			
L35	-29 583.84	2 753 251.20		R37	-30 579.76	2 750 068.27			
L36	-29 602.82	2 753 181.18		R38	-30 559.92	2 749 940.68			
L37	-29 718.69	2 752 712.14		R39	-30 488.77	2 749 714.85			
L38	-29 740.84	2 752 635.42		R40	-30 503.83	2 749 545.71			
L39	-29 790.64	2 752 483.94		R41	-30 872.99	2 748 789.95			
L40	-29 839.00	2 752 357.08		R42	-30 920.29	2 748 671.63			
L41	-29 917.57	2 752 150.45		R43	-31 401.19	2 747 157.79			
L42	-29 978.48	2 751 972.04		R44	-31 368.17	2 747 147.20			
L43	-30 006.64	2 751 880.87		R45	-31 552.60	2 746 566.33			
L44	-30 151.94	2 751 405.79		R46	-31 585.86	2 746 576.64			
L45	-30 297.85	2 750 929.34		R47	-31 726.99	2 746 132.19			
L46	-30 350.99	2 750 755.99		R48	-31 893.19	2 745 607.93			
L47	-30 466.11	2 750 378.06		R49	-31 997.00	2 745 282.54			
L48	-30 490.21	2 750 258.89		R50	-32 138.38	2 744 837.25			
L49	-30 493.20	2 750 019.54		R51	-32 218.06	2 744 585.17			
					Vel Sheet	11 Van of 15	P1173/19		

PADRESERWE KOÖRDINATE / ROAD RESERVE CO-ORDINATES									
LINKERKANT/LEFT HAND SIDE					REGTERKANT/RIGHT HAND SIDE				
	Y		X	WG 27º		Y		X	
L50	-30 463.15	2 749	839.62		R52	-32 386.74	2 744	055.00	
L51	-30 443.41	2 749	688.50		R53	-32 671.06	2 743	159.11	
L52	-30 454.23	2 749	542.37		R54	-32 673.23	2 743	152.28	
L53	-30 501.80	2 749	427.06		R55	-32 824.32	2 742	676.99	
L54	-30 623.38	2 749	181.12		R56	-32 878.97	2 742	504.43	
L55	-30 753.47	2 748	918.85		R57	-32 895.33	2 742	380.99	
L56	-30 782.35	2 748	860.16		R58	-32 897.35	2 742	321.84	
L57	-30 789.09	2 748	812.46		R59	-32 873.41	2 742	227.56	
L58	-30 804.02	2 748	782.13		R60	-32 839.57	2 742	134.70	
L59	-30 836.93	2 748	749.21		R61	-32 658.72	2 741	764.11	
L60	-30 864.15	2 748	693.88		R62	-32 625.47	2 741	695.31	
L61	-30 948.46	2 748	425.71		R63	-32 544.04	2 741	526.78	
L62	-31 078.32	2 747	990.40		R64	-32 512.80	2 741	462.37	
L63	-31 217.63	2 747	522.17		R65	-32 497.90	2 741	298.72	
L64	-31 220.29	2 747	486.72		R66	-32 608.85	2 740	901.61	
L65	-31 249.62	2 747	405.06		R67	-32 575.10	2 740	892.19	
L66	-31 363.27	2 747	022.79		R68	-32 738.74	2 740	308.01	
L67	-31 510.45	2 746	566.85		R69	-32 782.95	2 740	149.82	
L68	-31 661.16	2 746	119.79		R70	-32 902.83	2 739	720.85	
L69	-31 841.70	2 745	589.13		R71	-32 936.48	2 739	600.67	
L70	-31 950.27	2 745	269.59		R72	-32 984.58	2 739	428.83	
L71	-32 060.08	2 744	947.47		R73	-33 017.84	2 739	438.13	
L72	-32 101.41	2 744	818.90		R74	-33 125.59	2 739	052.28	
L73	-32 181.73	2 744	571.08		R75	-33 179.08	2 738	859.77	
L74	-32 350.16	2 744	042.69		R76	-33 181.59	2 738	849.69	
L75	-32 634.70	2 743	146.84		R77	-33 209.58	2 738	703.03	
L76	-32 635.22	2 743	145.22		R78	-33 210.07	2 738	665.01	
L77	-32 772.15	2 742	714.70		R79	-33 211.53	2 738	554.75	
L78	-32 818.24	2 742	568.74		R80	-33 177.46	2 738	086.22	
L79	-32 838.47	2 742	490.41		R81	-33 035.46	2 736	173.01	
L80	-32 847.65	2 742	413.56		R82	-33 033.17	2 736	135.70	
L81	-32 843.30	2 742	358.95		R83	-33 008.30	2 735	800.09	
L82	-32 838.56	2 742	303.61		R84	-32 999.21	2 735	676.45	
L83	-32 833.88	2 742	249.13		R85	-33 027.24	2 735	382.18	
L84	-32 811.19	2 742	172.38		R86	-33 083.04	2 734	796.29	
L85	-32 778.16	2 742	103.08		R87	-33 147.82	2 734	112.94	
L86	-32 592.18	2 741	732.07		R88	-33 162.66	2 733	891.36	
L87	-32 525.31	2 741	598.59		R89	-33 154.75	2 733	775.65	
L88	-32 516.75	2 741	571.68		R90	-33 134.33	2 733	668.94	
L89	-32 468.44	2 741	450.18		R91	-33 029.24	2 733	185.92	
L90	-32 452.41	2 741	369.34		R92	-32 953.23	2 732	840.69	
L91	-32 453.84	2 741	217.82		R93	-32 828.94	2 732	281.76	
L92	-32 468.97	2 741	129.82		R94	-32 720.10	2 731	767.57	
L93	-32 690.42	2 740	335.21		R95	-32 699.36	2 731	669.74	
L94	-32 744.11	2 740	143.66		R96	-32 691.94	2 731	620.59	
L95	-32 897.86	2 739	595.21		R97	-32 686.84	2 731	551.64	
L96	-33 053.03	2 739	041.98		R98	-32 691.16	2 731	478.62	
L97	-33 107.02	2 738	849.55		R99	-32 707.72	2 731	385.86	
L98	-33 148.49	2 738	684.19		R100	-32 726.52	2 731	320.59	
L99	-33 158.26	2 738	603.27		R101	-32 783.50	2 731	201.23	
L100	-33 163.57	2 738	525.83		R102	-32 920.44	2 731	042.26	
					Vel 12 Van 15 Sheet of P1173/19				

PADRESERVE KOÖRDINATE / ROAD RESERVE CO-ORDINATES						
LINKERKANT/LEFT HAND SIDE				REGTERKANT/RIGHT HAND SIDE		
	Y	X	WG 27 ^a		Y	X
L101	-33 165.51	2 738 445.01		R103	-32 992.03	2 730 984.74
L102	-33 138.31	2 738 080.56		R104	-33 013.26	2 730 966.10
L103	-33 125.29	2 737 904.60		R105	-33 180.20	2 730 895.98
L104	-33 083.75	2 737 343.26		R106	-33 239.01	2 730 880.39
L105	-33 066.56	2 737 108.71		R107	-33 612.28	2 730 825.20
L106	-33 035.56	2 736 687.40		R108	-33 617.50	2 730 824.77
L107	-33 031.21	2 736 631.12		R109	-33 632.36	2 730 822.61
L108	-32 991.49	2 736 199.43		R110	-33 637.80	2 730 821.51
L109	-32 987.42	2 736 170.59		R111	-33 924.60	2 730 778.81
L110	-32 978.23	2 736 098.32		R112	-34 063.64	2 730 748.82
L111	-32 958.47	2 735 880.74		R113	-34 396.68	2 730 654.63
L112	-32 954.97	2 735 759.50		R114	-34 883.32	2 730 516.77
L113	-32 990.52	2 735 378.84		R115	-35 369.89	2 730 379.03
L114	-33 044.70	2 734 806.79		R116	-35 837.75	2 730 246.59
L115	-33 092.72	2 734 303.46		R117	-36 320.61	2 730 109.65
L116	-33 121.66	2 733 998.86		R118	-36 772.22	2 729 981.72
L117	-33 119.40	2 733 836.57		R119	-37 230.20	2 729 850.44
L118	-33 110.23	2 733 756.28		R120	-37 305.50	2 729 828.03
L119	-33 095.68	2 733 677.07		R121	-37 412.41	2 729 788.09
L120	-32 991.06	2 733 194.17		R122	-37 578.54	2 729 708.23
L121	-32 912.96	2 732 837.36		R123	-37 709.83	2 729 627.82
L122	-32 905.04	2 732 797.44		R124	-37 808.68	2 729 554.44
L123	-32 901.22	2 732 781.56		R125	-37 864.01	2 729 511.56
L124	-32 889.38	2 732 729.13		R126	-37 925.30	2 729 455.39
L125	-32 794.38	2 732 290.46		R127	-37 999.64	2 729 381.88
L126	-32 682.10	2 731 774.53		R128	-38 025.92	2 729 351.32
L127	-32 661.54	2 731 675.14		R129	-38 092.02	2 729 271.87
L128	-32 653.41	2 731 601.49		R130	-38 192.64	2 729 137.09
L129	-32 655.51	2 731 474.18		R131	-38 219.29	2 729 085.88
L130	-32 671.40	2 731 382.93		R132	-38 262.76	2 729 005.55
L131	-32 712.40	2 731 262.25		R133	-38 293.84	2 728 946.24
L132	-32 759.42	2 731 166.18		R134	-38 347.80	2 728 817.81
L133	-32 781.72	2 731 134.63		R135	-38 417.09	2 728 581.41
L134	-32 843.73	2 731 060.54		R136	-38 433.71	2 728 491.10
L135	-32 906.08	2 730 998.03		R137	-38 445.67	2 728 398.53
L136	-32 982.96	2 730 944.54		R138	-38 459.04	2 728 200.24
L137	-33 010.51	2 730 924.79		R139	-38 460.41	2 728 179.84
L138	-33 124.14	2 730 874.67		R140	-38 466.35	2 728 132.02
L139	-33 208.27	2 730 848.19		R141	-38 466.00	2 728 119.49
L140	-33 631.84	2 730 786.72		R142	-38 461.09	2 727 942.73
L141	-33 856.23	2 730 753.41		R143	-38 469.81	2 727 941.76
L142	-34 299.60	2 730 644.64		R144	-38 496.36	2 727 420.94
L143	-34 387.54	2 730 619.71		R145	-38 495.37	2 727 366.74
L144	-34 875.56	2 730 481.05		R146	-38 490.94	2 727 300.46
L145	-35 358.65	2 730 344.11		R147	-38 483.48	2 727 242.70
L146	-35 826.56	2 730 211.14		R148	-38 458.79	2 727 131.21
L147	-36 312.03	2 730 073.62		R149	-38 409.39	2 726 976.61
L148	-36 764.09	2 729 946.28		R150	-38 405.11	2 726 963.22
L149	-37 219.60	2 729 816.56		R151	-38 289.08	2 726 595.56
L150	-37 284.73	2 729 796.47		R152	-38 191.04	2 726 281.70
L151	-37 416.45	2 729 746.38		R153	-38 183.97	2 726 257.82
				Vel Sheet	13 Van of 15	P1173/19

PADRESERWE KOÖRDINATE / ROAD RESERVE CO-ORDINATES						
LINKERKANT/LEFT HAND SIDE				REGTERKANT/RIGHT HAND SIDE		
	Y	X	WG 27 ^a		Y	X
L152	-37 468.83	2 729 722.97		R154	-38 102.51	2 726 001.91
L153	-37 541.39	2 729 686.23		R155	-38 081.43	2 725 910.31
L154	-37 605.79	2 729 650.30		R156	-38 075.26	2 725 837.11
L155	-37 638.63	2 729 630.22		R157	-38 078.73	2 725 767.14
L156	-37 707.77	2 729 584.94		R158	-38 087.46	2 725 708.12
L157	-37 829.02	2 729 491.87		R159	-38 101.65	2 725 652.71
L158	-37 895.64	2 729 430.72		R160	-38 118.12	2 725 607.10
L159	-38 001.52	2 729 323.29		R161	-38 161.54	2 725 520.44
L160	-38 056.88	2 729 255.73		R162	-38 219.01	2 725 443.40
L161	-38 104.90	2 729 192.52		R163	-38 245.90	2 725 412.88
L162	-38 189.33	2 729 067.73		R164	-38 290.89	2 725 328.01
L163	-38 231.26	2 728 988.35		R165	-38 698.42	2 725 049.33
L164	-38 252.80	2 728 935.30		R166	-39 072.88	2 724 754.18
L165	-38 279.64	2 728 882.55		R167	-39 401.28	2 724 492.77
L166	-38 310.74	2 728 809.05		R168	-39 457.11	2 724 442.39
L167	-38 359.92	2 728 656.67		R169	-39 484.67	2 724 410.83
L168	-38 379.14	2 728 577.46		R170	-39 515.37	2 724 366.85
L169	-38 400.20	2 728 457.46		R171	-39 536.88	2 724 328.16
L170	-38 409.07	2 728 379.45		R172	-39 572.40	2 724 240.62
L171	-38 414.88	2 728 296.22		R173	-39 589.18	2 724 152.23
L172	-38 423.25	2 728 110.13		R174	-39 590.08	2 724 147.49
L173	-38 434.38	2 728 053.15		R175	-39 590.08	2 724 054.05
L174	-38 444.51	2 727 932.99		R176	-39 575.64	2 723 961.86
L175	-38 437.53	2 727 807.35		R177	-39 580.82	2 723 953.27
L176	-38 455.04	2 727 455.47		R178	-39 572.18	2 723 940.35
L177	-38 454.30	2 727 375.62		R179	-39 554.01	2 723 895.18
L178	-38 448.17	2 727 263.23		R180	-39 533.60	2 723 857.93
L179	-38 430.95	2 727 174.55		R180X	-39 492.39	2 723 801.35
L180	-38 421.40	2 727 144.37		R181	-39 462.84	2 723 765.82
L181	-38 422.04	2 727 140.28		R181X	-39 415.13	2 723 717.66
L182	-38 419.88	2 727 139.18		R182	-39 355.14	2 723 669.00
L183	-38 392.01	2 727 050.37		R183	-39 287.14	2 723 610.53
L184	-38 248.76	2 726 593.93		R184	-39 236.23	2 723 548.91
L185	-38 158.13	2 726 309.11		R185	-39 211.47	2 723 504.27
L186	-38 151.03	2 726 285.55		R186	-39 204.34	2 723 488.69
L187	-38 066.03	2 726 014.16		R187	-39 184.15	2 723 436.32
L188	-38 050.74	2 725 955.02		R188	-39 156.27	2 723 358.23
L189	-38 041.26	2 725 894.01		R189	-39 131.85	2 723 291.28
L190	-38 037.52	2 725 832.91		R190	-39 112.94	2 723 246.48
L191	-38 043.37	2 725 709.42		R191	-39 064.87	2 723 113.75
L192	-38 111.40	2 725 526.77		R192	-39 044.06	2 723 035.99
L193	-38 183.26	2 725 425.81		R193	-39 028.57	2 722 978.09
L194	-38 238.31	2 725 368.03		R194	-39 021.43	2 722 864.11
L195	-38 268.75	2 725 340.99		R195	-39 026.86	2 722 798.12
L196	-38 675.22	2 725 019.44		R196	-39 031.04	2 722 738.99
L197	-39 049.88	2 724 723.29		R197	-39 049.51	2 722 624.30
L198	-39 204.92	2 724 601.21		R198	-39 060.25	2 722 564.61
L199	-39 375.25	2 724 466.12		R199	-39 066.11	2 722 527.64
L200	-39 419.33	2 724 426.02		R200	-39 070.46	2 722 504.24
L201	-39 448.79	2 724 394.94		R201	-39 081.25	2 722 442.24
L202	-39 497.02	2 724 322.17		R202	-39 095.55	2 722 379.66
				Vel Sheet	14 Van of	15 P1173/19

PADRESERWE KOÖRDINATE / ROAD RESERVE CO-ORDINATES					
LINKERKANT/LEFT HAND SIDE			REGTERKANT/RIGHT HAND SIDE		
	Y	X	WG 27 ^a	Y	X
L203	-39 516.72	2 724 283.83		R203	-39 097.24 2 722 372.21
L204	-39 537.29	2 724 218.98		R204	-39 114.74 2 722 308.12
L205	-39 553.39	2 724 134.69		R205	-39 147.62 2 722 213.86
L206	-39 552.11	2 724 077.51		R206	-39 174.68 2 722 162.63
L207	-39 551.11	2 724 043.53		R207	-39 207.50 2 722 116.68
L208	-39 544.86	2 724 016.62		R208	-39 267.71 2 722 024.56
L209	-39 536.39	2 723 979.38		R209	-39 287.43 2 721 997.53
L210	-39 520.21	2 723 930.64		R210	-39 353.93 2 721 928.91
L211	-39 498.58	2 723 883.77		R211	-39 460.38 2 721 836.39
L212	-39 477.66	2 723 851.31		R212	-39 551.22 2 721 757.03
L213	-39 457.59	2 723 820.17		R213	-39 595.58 2 721 714.45
L214	-39 429.98	2 723 788.88		R214	-39 644.37 2 721 660.83
L215	-39 406.99	2 723 766.17		R215	-39 763.33 2 721 485.35
L216	-39 388.66	2 723 748.07		R216	-39 944.55 2 721 218.04
L217	-39 299.15	2 723 672.30		R217	-40 010.17 2 721 139.64
L218	-39 216.15	2 723 591.69		R218	-40 022.08 2 721 125.41
L219	-39 183.57	2 723 531.63		R219	-40 075.90 2 721 068.09
L220	-39 146.65	2 723 444.26		R220	-40 133.09 2 721 024.63
L221	-39 092.96	2 723 299.03		R221	-40 150.19 2 721 013.08
L222	-39 028.28	2 723 121.12		R222	-40 257.15 2 720 961.57
L223	-39 011.91	2 723 059.98		R223	-40 335.83 2 720 924.09
L224	-39 003.81	2 723 016.67			
L225	-38 998.48	2 722 968.90			
L226	-38 995.95	2 722 928.84			
L227	-38 991.07	2 722 928.92			
L228	-38 986.91	2 722 860.67			
L229	-38 988.18	2 722 792.07			
L230	-38 992.09	2 722 791.91			
L231	-38 999.03	2 722 736.52			
L232	-39 001.40	2 722 712.35			
L233	-39 003.73	2 722 701.56			
L234	-39 036.59	2 722 514.08			
L235	-39 030.53	2 722 510.31			
L236	-39 054.92	2 722 375.42			
L237	-39 065.57	2 722 332.69			
L238	-39 077.45	2 722 294.48			
L239	-39 119.86	2 722 200.56			
L240	-39 178.66	2 722 091.16			
L241	-39 224.86	2 722 024.96			
L242	-39 291.74	2 721 944.48			
L243	-39 373.80	2 721 865.28			
L244	-39 494.61	2 721 756.67			
L245	-39 572.20	2 721 686.92			
L246	-39 630.50	2 721 618.77			
L247	-39 697.63	2 721 520.52			
L248	-39 783.68	2 721 394.59			
L249	-39 843.83	2 721 306.55			
L250	-39 899.08	2 721 225.70			
L251	-39 958.76	2 721 140.18			
L252	-39 971.35	2 721 125.93			
L253	-40 020.56	2 721 068.86			
			LINKERKANT/LEFT HAND SIDE		
			Y	X	
			L254	-40 043.37 2 721 042.41	
			L255	-40 069.21 2 721 029.28	
			L256	-40 115.17 2 721 005.92	
			L257	-40 247.35 2 720 938.75	
			L258	-40 322.83 2 720 898.13	
			Vel Sheet	15 Van of 15	P1173/19