

---

**GOVERNMENT NOTICES • GOEWERMENTSKENNISGEWINGS**

---

**DEPARTMENT OF TRANSPORT**

NO. 6422

11 July 2025

**THE SOUTH AFRICAN NATIONAL ROADS  
AGENCY SOC LIMITED**Registration No: 1998/009584/30

---

**DECLARATION AMENDMENT OF NATIONAL ROAD R21 SECTION 2**

AMENDMENT OF DECLARATION No. 303 OF 2018.

By virtue of section 40(1)(b) of the South African National Roads Agency Limited and the National Roads Act, 1998 (Act No. 7 of 1998), I hereby amend Declaration No. 303 of 2018 by substituting sheets 1, 2 and 9 with the accompanying sheets 1A, 2A and 9A of Plan No. P921/16.

**(National Road R21 Section 2: Olifantsfontein I/C – Hans Strydom Drive)**  
**MINISTER OF TRANSPORT**

DEPARTEMENT VAN VERVOER

NO. 6422

11 Julie 2025

**DIE SUID-AFRIKAANSE NASIONALE  
PADAGENTSKAP MSB BEPERK**

Registrasie No: 1998/009584/30

**VERKLARING WYSIGING VAN NASIONALE PAD R21 SEKSIE 2**

WYSIGING VAN VERKLARING No. 303 VAN 2018.

Kragtens Artikel 40(1)(b) van die Wet op die Suid-Afrikaanse Nasionale Padagentskap Beperk en op Nasionale Paaie, 1998 (Wet No. 7 van 1998), wysig ek hiermee Verklaring No. 303 van 2018 deur velle 1, 2 en 9 te vervang met bygaande velle 1A, 2A en 9A van Plan No. P921/16.

**(Nasionale Pad R21 Seksie 2: Olifantsfontein wisselaar – Hans Strydomweg)**



**MINISTER VAN VERVOER**

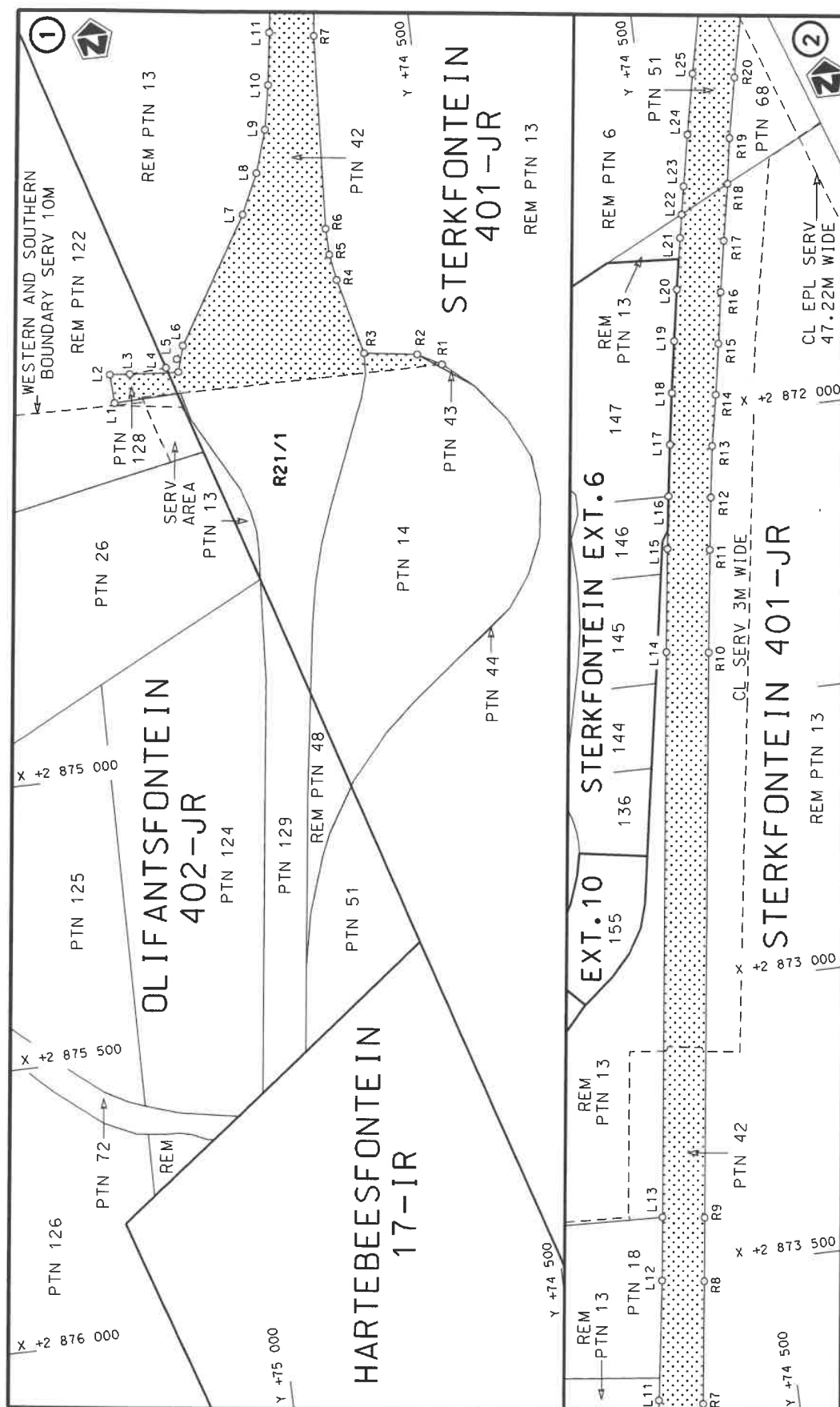

|   |                                       |  |  |                       |
|---|---------------------------------------|--|--|-----------------------|
| Die Suid Afrikaanse Nasionale Padagentskap MSB Bpk<br>The South African National Roads Agency SOC Ltd | Die figuur getoon<br>The figure shown |  | steldie padreserwe voor van 'n gedeelte<br>represents the road reserve of a portion<br>van Nasionale Roete R21 Seksie<br>of National Route Section | Vel<br>Sheet 1A of 12 |
|   |                                       |  | 2  | Plan<br>P921/16       |

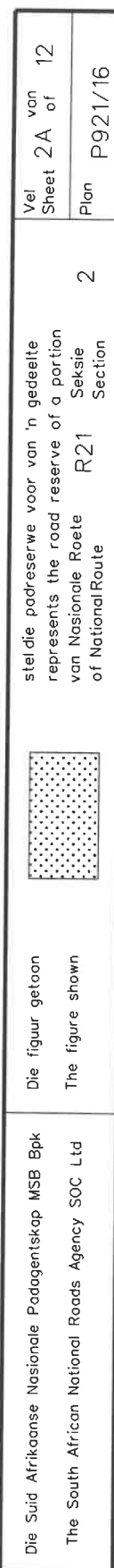

| PADRESERVE KOÖRDINATE / ROAD RESERVE CO-ORDINATES |           |              |        |                            |                 |              |
|---|-----------|--------------|--------|----------------------------|-----------------|--------------|
| LINKERKANT/LEFT HAND SIDE                         |           |              |        | REGTERKANT/RIGHT HAND SIDE |                 |              |
|   | Y         | X            | WG 29° |                            | Y               | X            |
| L1  | 75 096.23 | 2 874 345.35 |        | R1                         | 74 513.78       | 2 874 346.46 |
| L2  | 75 098.49 | 2 874 294.45 |        | R2                         | 74 555.13       | 2 874 323.67 |
| L3  | 75 063.13 | 2 874 297.46 |        | R3                         | 74 648.85       | 2 874 310.04 |
| L4  | 74 998.48 | 2 874 293.59 |        | R4                         | 74 681.50       | 2 874 175.08 |
| L5  | 74 977.57 | 2 874 280.72 |        | R5                         | 74 689.11       | 2 874 129.34 |
| L6  | 74 964.13 | 2 874 258.30 |        | R6                         | 74 690.00       | 2 874 082.99 |
| L7  | 74 832.74 | 2 874 040.03 |        | R7                         | 74 670.25       | 2 873 741.37 |
| L8  | 74 799.82 | 2 873 970.21 |        | R8                         | 74 641.59       | 2 873 524.47 |
| L9  | 74 775.74 | 2 873 895.57 |        | R9                         | 74 627.37       | 2 873 412.55 |
| L10   | 74 760.49 | 2 873 817.72 |        | R10                        | 74 498.45       | 2 872 416.68 |
| L11   | 74 747.70 | 2 873 725.67 |        | R11                        | 74 474.50       | 2 872 235.67 |
| L12   | 74 716.01 | 2 873 514.72 |        | R12                        | 74 461.51       | 2 872 143.85 |
| L13   | 74 701.76 | 2 873 402.79 |        | R13                        | 74 448.02       | 2 872 053.68 |
| L14   | 74 572.86 | 2 872 406.87 |        | R14                        | 74 430.83       | 2 871 964.11 |
| L15   | 74 548.87 | 2 872 225.28 |        | R15                        | 74 415.23       | 2 871 874.88 |
| L16   | 74 535.80 | 2 872 132.73 |        | R16                        | 74 400.28       | 2 871 784.58 |
| L17   | 74 522.20 | 2 872 042.12 |        | R17                        | 74 384.01       | 2 871 694.84 |
| L18   | 74 507.94 | 2 871 951.51 |        | R18                        | 74 365.40       | 2 871 595.55 |
| L19   | 74 492.99 | 2 871 860.90 |        | R19                        | 74 352.20       | 2 871 515.20 |
| L20   | 74 477.30 | 2 871 770.52 |        | R20                        | 74 330.48       | 2 871 409.89 |
| L21   | 74 460.85 | 2 871 680.29 |        | R21                        | 74 289.84       | 2 871 223.16 |
| L22   | 74 453.00 | 2 871 639.34 |        | R22                        | 74 225.48       | 2 870 930.90 |
| L23   | 74 443.59 | 2 871 590.30 |        | R23                        | 74 144.49       | 2 870 563.16 |
| L24   | 74 425.87 | 2 871 500.08 |        | R24                        | 74 109.81       | 2 870 420.32 |
| L25   | 74 403.87 | 2 871 393.98 |        | R25                        | 74 092.03       | 2 870 342.02 |
| L26   | 74 364.87 | 2 871 214.98 |        | R26                        | 74 037.09       | 2 870 101.61 |
| L27   | 74 337.24 | 2 871 089.57 |        | R27                        | 74 016.84       | 2 870 018.24 |
| L28   | 74 314.92 | 2 870 988.31 |        | R28                        | 73 992.01       | 2 869 936.14 |
| L29   | 74 204.56 | 2 870 487.41 |        | R29                        | 73 976.14       | 2 869 896.82 |
| L30   | 74 074.32 | 2 869 895.98 |        | R30                        | 73 951.64       | 2 869 862.29 |
| L31   | 74 037.36 | 2 869 721.21 |        | R31                        | 73 920.84       | 2 869 832.60 |
| L32   | 74 024.91 | 2 869 654.70 |        | R32                        | 73 820.85       | 2 869 754.53 |
| L33   | 74 034.52 | 2 869 630.42 |        | R33                        | 73 802.65       | 2 869 729.87 |
| L34   | 74 267.19 | 2 869 656.96 |        | R34                        | 73 790.91       | 2 869 701.81 |
| L35   | 74 269.44 | 2 869 637.27 |        | R35                        | 73 778.68       | 2 869 607.04 |
| L36   | 74 290.53 | 2 869 640.38 |        | R36                        | 73 761.90       | 2 869 590.21 |
| L37   | 74 324.13 | 2 869 646.68 |        | R37                        | 73 705.91       | 2 869 582.65 |
| L38   | 74 327.15 | 2 869 628.20 |        | R38                        | 73 694.43       | 2 869 580.20 |
| L39   | 74 332.14 | 2 869 596.74 |        | R39                        | 73 627.79       | 2 869 572.88 |
| L40   | 74 250.04 | 2 869 583.58 |        | R40                        | 73 630.67       | 2 869 551.48 |
| L41   | 74 178.25 | 2 869 551.31 |        | R41                        | 73 636.56       | 2 869 507.66 |
| L42   | 74 162.58 | 2 869 457.85 |        | R42                        | 73 714.45       | 2 869 518.12 |
| L43   | 74 151.71 | 2 869 431.00 |        | R43                        | 73 741.87       | 2 869 521.80 |
| L44   | 74 133.34 | 2 869 405.31 |        | R44                        | 73 780.49       | 2 869 525.71 |
| L45   | 74 049.16 | 2 869 328.83 |        | R45                        | 73 820.98       | 2 869 506.89 |
| L46   | 74 017.46 | 2 869 292.21 |        | R46                        | 73 844.84       | 2 869 509.09 |
| L47   | 73 998.05 | 2 869 248.17 |        | R47                        | 73 881.20       | 2 869 535.07 |
| L48   | 73 985.69 | 2 869 201.90 |        | R48                        | 73 928.33       | 2 869 539.03 |
| L49   | 73 976.37 | 2 869 134.43 |        | R49                        | 73 925.12       | 2 869 516.12 |
| L50   | 73 971.36 | 2 869 067.11 |        | R50                        | 73 915.85       | 2 869 424.32 |
| L51   | 73 968.55 | 2 869 046.94 |        | R51                        | 73 904.33       | 2 869 332.53 |
|   |           |              |        | Vel<br>Sheet               | 9A Van<br>of 12 | P921/16      |