GOVERNMENT NOTICES • GOEWERMENTSKENNISGEWINGS

DEPARTMENT OF TRANSPORT

NO. 6246

30 May 2025

**THE SOUTH AFRICAN NATIONAL ROADS
AGENCY SOC LIMITED****Registration No: 1998/009584/30**

DECLARATION AMENDMENT OF NATIONAL ROAD N2 SECTION 12

AMENDMENT OF DECLARATION No. 54 OF 1987.

By virtue of Section 40 (1)(b) of The South African National Roads Agency Limited and National Roads Act, 1998 (Act No. 7 of 1998), I hereby amend Declaration No. 54 of 1987 by substituting it in its entirety with the accompanying sheets 1 to 12 of Plan No. P1199/20.

(National Road N2 Section 12: Vetmaakvlakte – Leeuwenbosch)
MINISTER OF TRANSPORT

DEPARTEMENT VAN VERVOER

NO. 6246

30 Mei 2025

**DIE SUID-AFRIKAANSE NASIONALE
PADAGENTSKAP MSB BEPERK**

Registrasie No: 1998/009584/30

VERKLARING WYSIGING VAN NASIONALE PAD N2 SEKSIE 12

WYSIGING VAN VERKLARING No. 54 VAN 1987.

Kragtens Artikel 40(1)(b) van die Wet op die Suid-Afrikaanse Nasionale Padagentskap Beperk en op Nasionale Paaie, 1998 (Wet No. 7 van 1998), wysig ek hiermee Verklaring No. 54 van 1987 deur dit in sy geheel te vervang met bygaande velle 1 tot 12 van Plan No. P1199/20.

(Nasionale Pad N2 Seksie 12: Vetmaakvlakte – Leeuwenbosch)

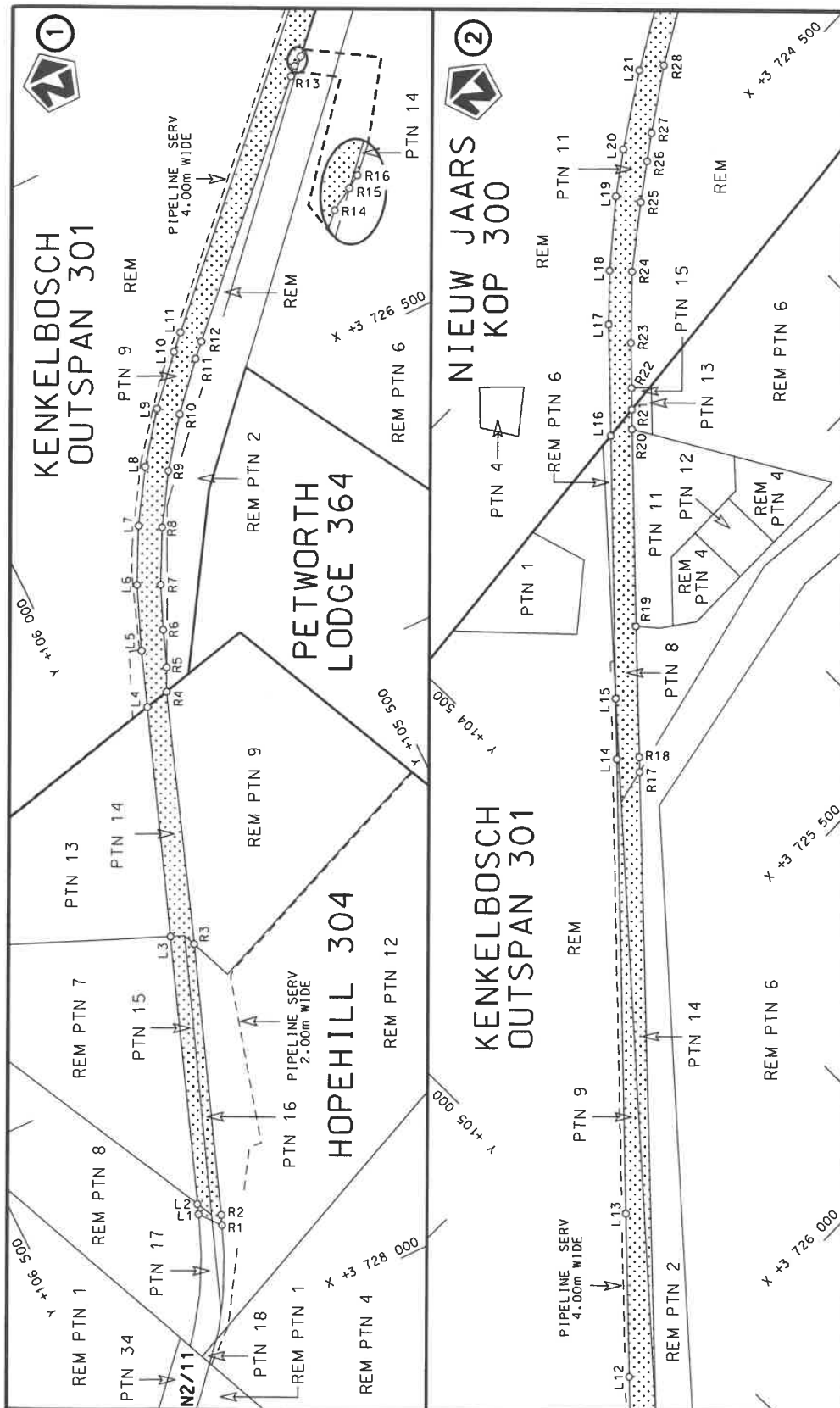

MINISTER VAN VERVOER

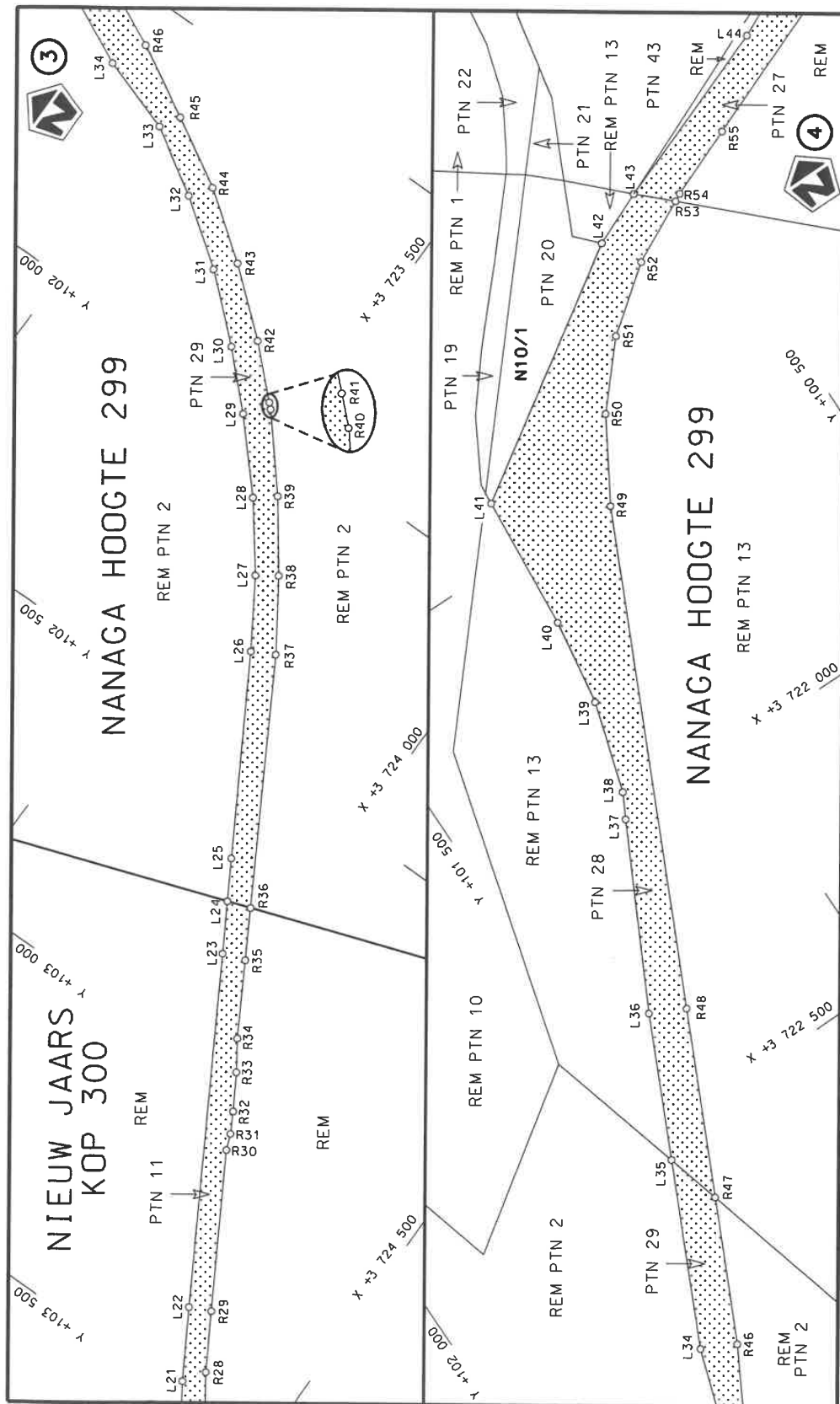

Die Suid Afrikaanse Nasionale Padagentskap MSB Bpk	Die figuur getoon		stelt die padreserwe voor van 'n gedeelte represents the road reserve of a portion	Vel Sheet	1 of	12
The South African National Roads Agency SOC Ltd	The figure shown		van Nasionale Roete of National Route	N2 Section	12	Plan

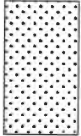

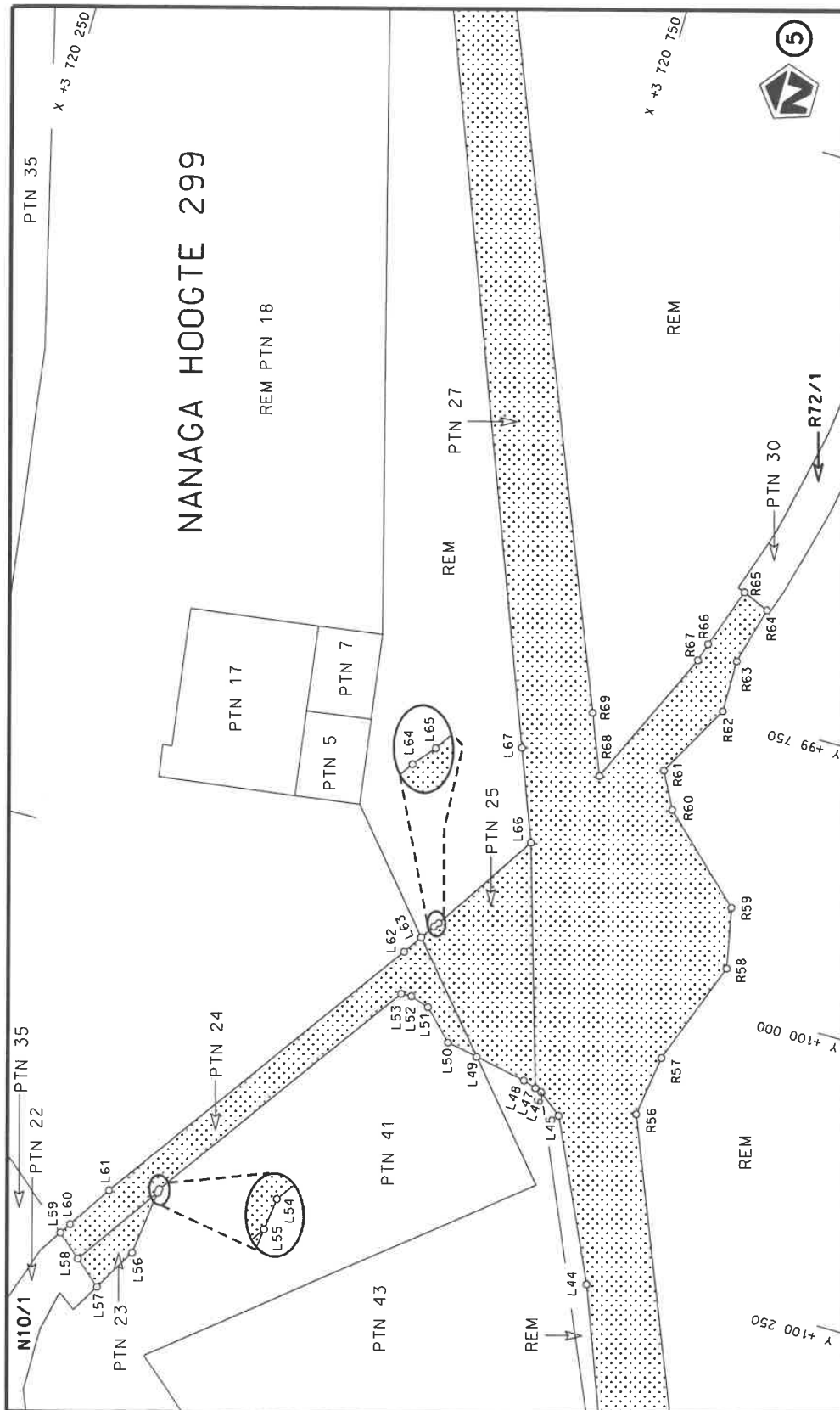
Die Suid Afrikaanse Nasionale Padagentskap MSB Bpk The South African National Roads Agency SOC Ltd	Die figuur getoon The figure shown		steldie padreserwe voor van 'n gedeelte represents the road reserve of a portion van Nasionale Roete N2 of National Route Section	Vel Sheet	van 2	of 12
				Plan	P1199/20	



Die Suid Afrikaanse Nasionale Podagentskap MSB Bpk	Die figuur getoon		stelt die padreserwe voor van 'n gedeelte represents the road reserve of a portion	Vel Sheet	3 of	12
The South African National Roads Agency SOC Ltd	The figure shown		van Nasionale Roete of National Route	N2	12	Plan P1199/20

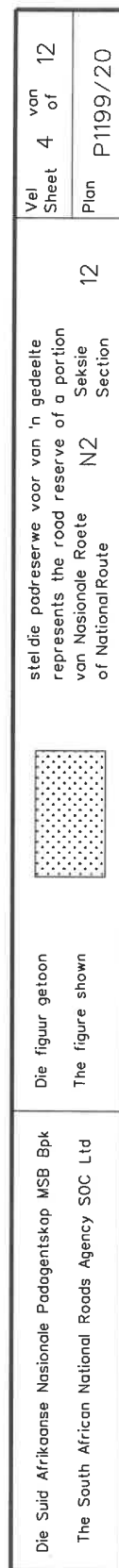

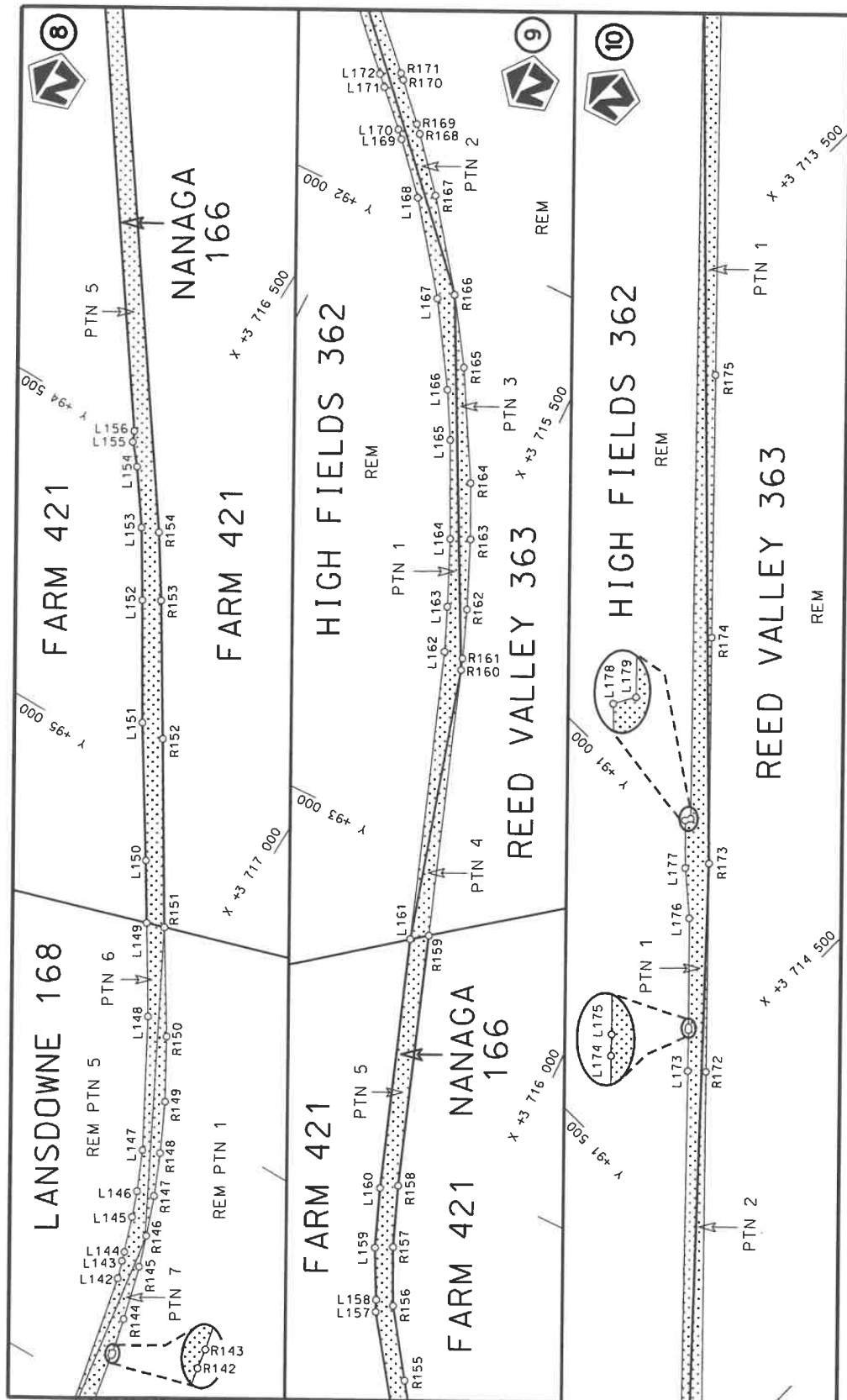

Die Suid Afrikaanse Nasionale Padagentskap MSB Bpk The South African National Roads Agency SOC Ltd	Die figuur getoon The figure shown		steldie padreserwe voor van 'n gedeelte represents the road reserve of a portion van Nasionale Roete N2 of National Route	Vel Sheet	van 5	of 12
				Plan	P1199/20	

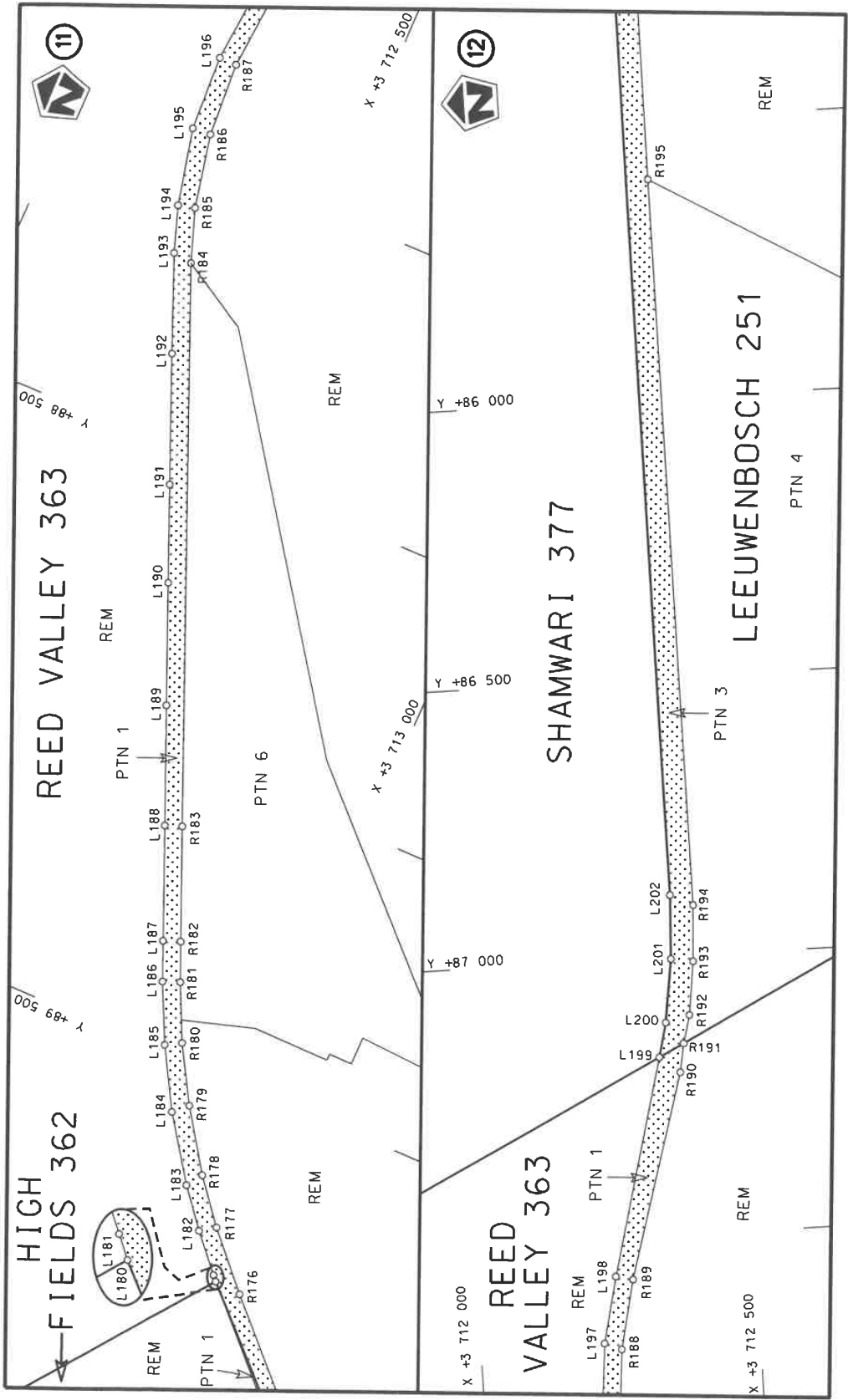

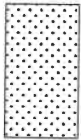
Die Suid Afrikaanse Nasionale Padagentskap MSB Bpk The South African National Roads Agency SOC Ltd	Die figuur getoon The figure shown		steldie padreserwe voor van 'n gedeelte represents the road reserve of a portion van Nasionale Roete N2 of National Route	12	Vel Sheet	6	van of	12
					Plan	P1199/20		

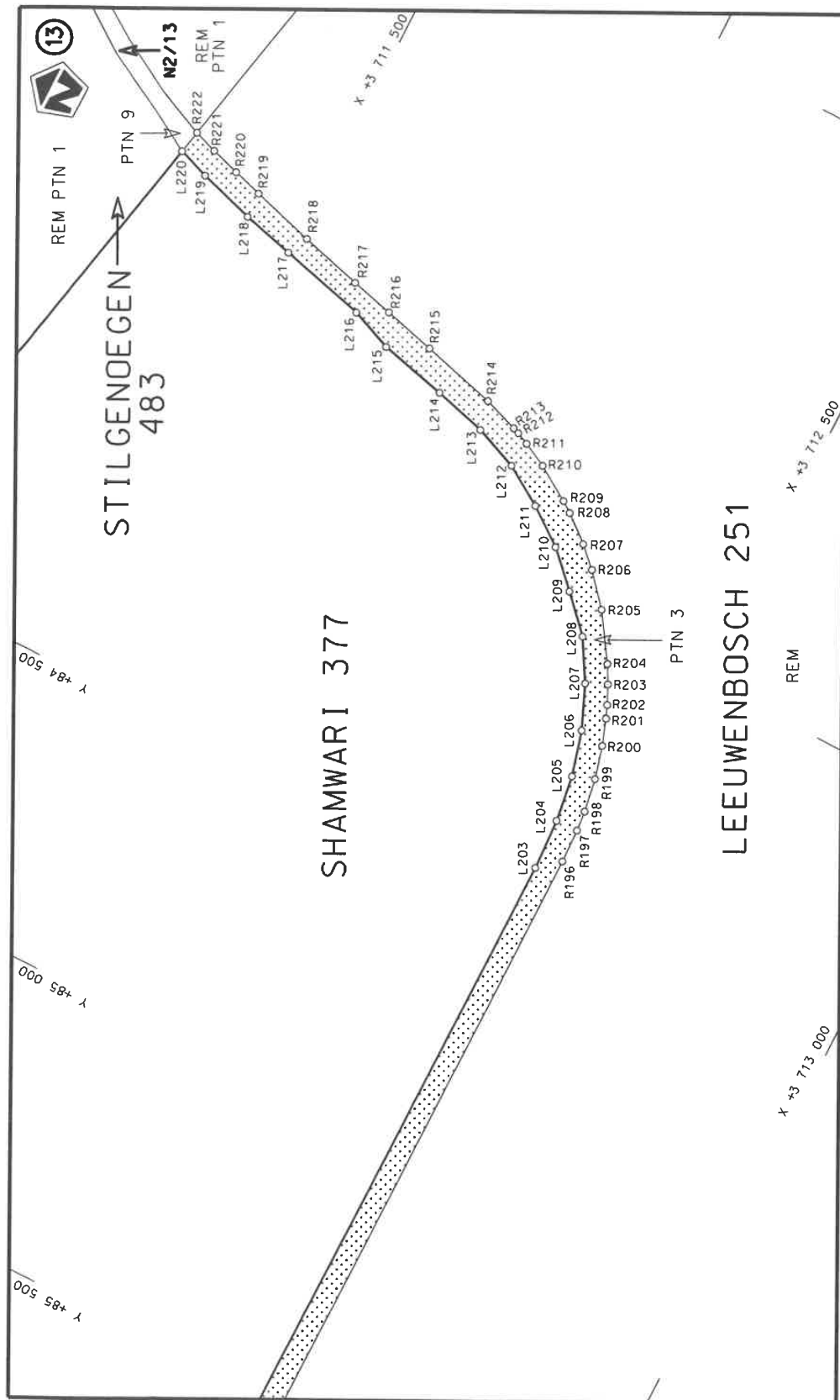

Die Suid Afrikaanse Nasionale Padagentskap MSB Bpk The South African National Roads Agency SOC Ltd	Die figuur getoon The figure shown		steldie padreserwe voor van 'n gedeelte represents the road reserve of a portion van Nasionale Roete N2 of National Route	Vel Sheet	7 of	12
				Plan	P1199/20	12

PADRESERWE KOÖRDINATE / ROAD RESERVE CO-ORDINATES					
LINKERKANT/LEFT HAND SIDE			REGTERKANT/RIGHT HAND SIDE		
	Y	X	WG 27°	Y	X
L1	106 206.73	3 727 775.52		R1	106 178.12 3 727 810.95
L2	106 200.48	3 727 758.46		R2	106 171.19 3 727 793.91
L3	106 036.86	3 727 311.26		R3	106 005.41 3 727 341.28
L4	105 896.52	3 726 928.20		R4	105 854.67 3 726 918.23
L5	105 862.40	3 726 834.48		R5	105 835.84 3 726 879.63
L6	105 818.93	3 726 726.08		R6	105 812.44 3 726 817.11
L7	105 770.96	3 726 633.18		R7	105 781.85 3 726 743.37
L8	105 715.20	3 726 544.39		R8	105 735.31 3 726 653.47
L9	105 652.11	3 726 460.72		R9	105 681.81 3 726 568.45
L10	105 581.34	3 726 383.04		R10	105 620.40 3 726 486.79
L11	105 556.32	3 726 357.31		R11	105 552.64 3 726 410.92
L12	105 134.97	3 725 924.97		R12	105 530.24 3 726 387.83
L13	104 933.02	3 725 718.04		R13	105 185.39 3 726 034.23
L14	104 370.70	3 725 142.22		R14	105 171.75 3 726 020.51
L15	104 296.00	3 725 065.87		R15	105 155.08 3 726 010.80
L16	103 971.14	3 724 733.80		R16	105 153.67 3 726 009.88
L17	103 833.67	3 724 593.28		R17	104 358.78 3 725 186.93
L18	103 764.98	3 724 527.73		R18	104 340.54 3 725 168.22
L19	103 663.49	3 724 443.40		R19	104 179.61 3 725 001.55
L20	103 595.44	3 724 394.37		R20	103 936.50 3 724 752.74
L21	103 476.44	3 724 316.90		R21	103 911.81 3 724 727.81
L22	103 362.42	3 724 249.86		R22	103 885.11 3 724 700.73
L23	102 814.88	3 723 933.35		R23	103 829.20 3 724 644.04
L24	102 733.99	3 723 886.39		R24	103 738.06 3 724 557.12
L25	102 667.56	3 723 847.83		R25	103 640.17 3 724 481.88
L26	102 347.73	3 723 662.52		R26	103 580.86 3 724 439.01
L27	102 232.87	3 723 590.60		R27	103 540.11 3 724 409.70
L28	102 122.81	3 723 507.12		R28	103 439.80 3 724 341.28
L29	102 011.33	3 723 406.69		R29	103 345.24 3 724 286.25
L30	101 925.76	3 723 320.76		R30	103 096.03 3 724 141.44
L31	101 832.47	3 723 215.54		R31	103 068.40 3 724 130.72
L32	101 751.48	3 723 103.92		R32	103 033.07 3 724 111.48
L33	101 681.53	3 722 990.46		R33	102 973.04 3 724 075.56
L34	101 637.96	3 722 857.59		R34	102 922.93 3 724 042.07
L35	101 493.25	3 722 549.13		R35	102 801.40 3 723 972.68
L36	101 381.10	3 722 310.11		R36	102 720.07 3 723 926.20
L37	101 222.83	3 722 000.24		R37	102 326.86 3 723 701.50
L38	101 199.97	3 721 957.05		R38	102 209.58 3 723 624.71
L39	101 151.53	3 721 796.83		R39	102 095.34 3 723 541.24
L40	101 127.79	3 721 643.29		R40	101 976.54 3 723 441.44
L41	101 107.10	3 721 402.35		R41	101 968.20 3 723 432.64
L42	100 687.76	3 721 126.34		R42	101 890.90 3 723 352.42
L43	100 591.99	3 721 085.19		R43	101 799.36 3 723 243.94
L44	100 268.60	3 720 963.83		R44	101 715.35 3 723 130.10
L45	100 131.47	3 720 900.69		R45	101 646.60 3 723 011.26
L46	100 115.27	3 720 880.34		R46	101 578.12 3 722 887.19
L47	100 113.37	3 720 874.54		R47	101 465.47 3 722 648.11
L48	100 109.62	3 720 862.99		R48	101 320.43 3 722 340.27
L49	100 100.42	3 720 817.20		R49	100 934.69 3 721 522.85
L50	100 094.94	3 720 789.53		R50	100 850.89 3 721 381.74
L51	100 069.48	3 720 764.41		R51	100 758.41 3 721 277.18
			Vel Sheet	8 Van of	12 P1199/20

PADRESERVE KOÖRDINATE / ROAD RESERVE CO-ORDINATES									
LINKERKANT/LEFT HAND SIDE					REGTERKANT/RIGHT HAND SIDE				
	Y	X	WG 27°			Y	X		
L52	100 063.96	3 720 747.84			R52	100 648.11	3 721 192.75		
L53	100 064.46	3 720 738.71			R53	100 537.77	3 721 137.10		
L54	100 287.52	3 720 580.01			R54	100 523.98	3 721 130.14		
L55	100 291.14	3 720 579.53			R55	100 399.80	3 721 080.68		
L56	100 347.97	3 720 571.94			R56	100 111.72	3 720 966.26		
L57	100 385.14	3 720 550.16			R57	100 058.02	3 720 974.47		
L58	100 365.41	3 720 527.38			R58	99 966.67	3 721 008.62		
L59	100 347.41	3 720 506.60			R59	99 913.78	3 720 998.44		
L60	100 338.00	3 720 512.80			R60	99 844.14	3 720 925.42		
L61	100 300.06	3 720 537.93			R61	99 812.63	3 720 909.14		
L62	100 027.80	3 720 731.31			R62	99 748.44	3 720 945.08		
L63	100 011.55	3 720 742.36			R63	99 702.76	3 720 945.31		
L64	99 999.52	3 720 750.53			R64	99 652.22	3 720 958.82		
L65	99 995.48	3 720 753.92			R65	99 642.22	3 720 935.65		
L66	99 905.34	3 720 813.35			R66	99 694.94	3 720 917.03		
L67	99 826.61	3 720 783.38			R67	99 710.87	3 720 912.17		
L68	99 183.84	3 720 540.08			R68	99 832.43	3 720 855.77		
L69	99 129.88	3 720 518.98			R69	99 780.13	3 720 835.20		
L70	99 087.19	3 720 495.18			R70	99 169.30	3 720 593.36		
L71	99 037.48	3 720 444.27			R71	99 131.56	3 720 578.30		
L72	98 995.97	3 720 394.42			R72	99 109.22	3 720 568.50		
L73	98 957.38	3 720 343.60			R73	99 076.75	3 720 551.06		
L74	98 939.87	3 720 297.15			R74	99 043.65	3 720 531.57		
L75	98 927.34	3 720 246.71			R75	98 966.40	3 720 430.56		
L76	98 931.53	3 720 143.81			R76	98 938.20	3 720 382.90		
L77	98 942.82	3 719 919.92			R77	98 922.09	3 720 352.12		
L78	98 943.92	3 719 873.11			R78	98 899.64	3 720 269.80		
L79	98 936.16	3 719 842.30			R79	98 893.43	3 720 205.17		
L80	98 934.43	3 719 822.51			R80	98 905.93	3 719 916.32		
L81	98 914.22	3 719 757.96			R81	98 905.98	3 719 915.09		
L82	98 886.01	3 719 701.03			R82	98 904.51	3 719 841.75		
L83	98 842.08	3 719 642.51			R83	98 881.41	3 719 765.01		
L84	98 770.20	3 719 559.72			R84	98 872.06	3 719 744.81		
L85	98 735.97	3 719 509.03			R85	98 857.95	3 719 714.91		
L86	98 715.81	3 719 464.44			R86	98 813.01	3 719 657.15		
L87	98 705.14	3 719 429.68			R87	98 741.58	3 719 574.02		
L88	98 707.27	3 719 392.73			R88	98 707.98	3 719 522.98		
L89	98 710.19	3 719 344.84			R89	98 688.00	3 719 478.54		
L90	98 712.82	3 719 316.73			R90	98 663.01	3 719 410.23		
L91	98 741.83	3 719 097.27			R91	98 652.36	3 719 350.16		
L92	98 744.62	3 719 085.41			R92	98 651.94	3 719 285.61		
L93	98 747.35	3 719 073.45			R93	98 664.19	3 719 250.12		
L94	98 751.92	3 719 037.20			R94	98 700.07	3 719 163.43		
L95	98 745.53	3 718 928.52			R95	98 707.31	3 719 127.79		
L96	98 725.69	3 718 872.30			R96	98 711.49	3 719 079.24		
L97	98 699.42	3 718 831.86			R97	98 712.11	3 719 042.84		
L98	98 676.03	3 718 804.07			R98	98 709.21	3 719 006.26		
L99	98 660.13	3 718 785.79			R99	98 696.58	3 718 946.77		
L100	98 628.80	3 718 748.49			R100	98 676.11	3 718 888.96		
L101	98 625.51	3 718 744.94			R101	98 657.97	3 718 843.33		
L102	98 621.82	3 718 730.28			R102	98 648.44	3 718 821.67		
					<div> <div>Vel</div> <div>9</div> <div>Van</div> <div>12</div> <div>Sheet</div> <div>of</div> <div>P1199/20</div> </div>				

PADRESERWE KOÖRDINATE / ROAD RESERVE CO-ORDINATES						
LINKERKANT/LEFT HAND SIDE				REGTERKANT/RIGHT HAND SIDE		
	Y	X	WG 27°		Y	X
L103	98 554.39	3 718 669.90		R103	98 626.89	3 718 792.57
L104	98 445.46	3 718 545.65		R104	98 603.51	3 718 767.66
L105	98 381.21	3 718 498.85		R105	98 587.02	3 718 749.96
L106	98 327.54	3 718 470.03		R106	98 536.90	3 718 696.15
L107	98 213.56	3 718 425.13		R107	98 410.36	3 718 560.26
L108	98 195.34	3 718 418.74		R108	98 371.63	3 718 531.05
L109	98 151.00	3 718 372.69		R109	98 319.16	3 718 500.91
L110	98 098.53	3 718 315.02		R110	98 247.58	3 718 475.74
L111	98 087.41	3 718 294.94		R111	98 165.46	3 718 438.99
L112	98 066.40	3 718 252.35		R112	98 099.48	3 718 395.13
L113	98 042.69	3 718 200.97		R113	98 048.54	3 718 328.49
L114	98 029.87	3 718 152.79		R114	98 032.83	3 718 302.70
L115	98 018.55	3 718 054.96		R115	98 006.32	3 718 244.08
L116	98 003.48	3 718 012.20		R116	97 993.11	3 718 137.56
L117	97 988.82	3 717 990.35		R117	97 981.57	3 718 130.68
L118	97 964.14	3 717 951.37		R118	97 973.47	3 718 069.25
L119	97 954.67	3 717 937.27		R119	97 956.52	3 718 010.84
L120	97 913.52	3 717 893.47		R120	97 924.60	3 717 952.64
L121	97 893.50	3 717 880.07		R121	97 896.36	3 717 924.45
L122	97 831.53	3 717 838.62		R122	97 876.87	3 717 908.35
L123	97 639.23	3 717 774.98		R123	97 845.35	3 717 885.35
L124	97 599.12	3 717 756.94		R124	97 790.18	3 717 859.72
L125	97 546.70	3 717 725.23		R125	97 736.37	3 717 844.50
L126	97 387.60	3 717 625.71		R126	97 624.28	3 717 803.31
L127	97 342.62	3 717 606.41		R127	97 538.79	3 717 764.20
L128	97 284.29	3 717 590.64		R128	97 514.25	3 717 748.64
L129	97 122.47	3 717 550.10		R129	97 475.54	3 717 719.96
L130	97 051.46	3 717 538.84		R130	97 447.60	3 717 701.04
L131	96 773.17	3 717 484.57		R131	97 389.08	3 717 666.61
L132	96 693.73	3 717 470.90		R132	97 301.16	3 717 629.12
L133	96 607.80	3 717 428.66		R133	97 258.77	3 717 617.70
L134	96 598.29	3 717 414.58		R134	97 000.04	3 717 564.39
L135	96 568.11	3 717 405.63		R135	96 739.94	3 717 511.41
L136	96 523.73	3 717 385.99		R136	96 669.10	3 717 491.84
L137	96 416.00	3 717 314.47		R137	96 590.25	3 717 465.53
L138	96 301.74	3 717 253.97		R138	96 379.55	3 717 328.19
L139	96 202.91	3 717 229.36		R139	96 333.09	3 717 304.43
L140	96 155.05	3 717 221.58		R140	96 275.10	3 717 281.33
L141	96 073.81	3 717 207.36		R141	96 151.11	3 717 253.41
L142	95 802.67	3 717 151.99		R142	95 926.13	3 717 213.10
L143	95 772.34	3 717 142.78		R143	95 921.64	3 717 212.47
L144	95 756.27	3 717 137.71		R144	95 859.86	3 717 198.74
L145	95 695.75	3 717 117.49		R145	95 765.45	3 717 173.88
L146	95 651.91	3 717 101.34		R146	95 711.62	3 717 156.66
L147	95 583.86	3 717 071.98		R147	95 643.69	3 717 131.96
L148	95 374.54	3 716 957.64		R148	95 572.47	3 717 101.55
L149	95 232.42	3 716 869.59		R149	95 489.27	3 717 061.69
L150	95 137.64	3 716 810.75		R150	95 388.11	3 717 003.92
L151	94 930.01	3 716 678.80		R151	95 223.02	3 716 900.23
L152	94 742.74	3 716 566.13		R152	94 936.33	3 716 724.67
L153	94 632.71	3 716 498.25		R153	94 726.34	3 716 595.12
				Vel Sheet	10 Van of	12 P1199/20

PADRESERWE KOÖRDINATE / ROAD RESERVE CO-ORDINATES									
LINKERKANT/LEFT HAND SIDE					REGTERKANT/RIGHT HAND SIDE				
	Y	X	WG 27°			Y	X		
L154	94 543.78	3 716 435.49			R154	94 623.93	3 716 529.20		
L155	94 509.80	3 716 406.31			R155	93 867.81	3 716 000.05		
L156	94 491.96	3 716 398.48			R156	93 756.52	3 715 923.40		
L157	93 779.72	3 715 900.75			R157	93 662.08	3 715 877.69		
L158	93 759.98	3 715 892.04			R158	93 559.69	3 715 838.10		
L159	93 677.15	3 715 849.57			R159	93 133.86	3 715 691.72		
L160	93 577.26	3 715 811.08			R160	92 682.43	3 715 536.32		
L161	93 154.09	3 715 665.09			R161	92 663.17	3 715 529.76		
L162	92 666.11	3 715 495.55			R162	92 580.85	3 715 498.69		
L163	92 591.73	3 715 465.12			R163	92 465.76	3 715 449.73		
L164	92 480.78	3 715 416.92			R164	92 375.49	3 715 406.02		
L165	92 322.17	3 715 339.99			R165	92 195.61	3 715 305.21		
L166	92 244.21	3 715 296.20			R166	92 086.36	3 715 233.78		
L167	92 105.64	3 715 209.01			R167	91 942.42	3 715 125.76		
L168	91 959.63	3 715 099.16			R168	91 856.24	3 715 052.55		
L169	91 878.62	3 715 027.63			R169	91 842.45	3 715 040.27		
L170	91 865.49	3 715 014.92			R170	91 782.44	3 714 984.15		
L171	91 808.72	3 714 959.65			R171	91 773.66	3 714 975.74		
L172	91 791.01	3 714 942.55			R172	91 278.03	3 714 497.32		
L173	91 299.54	3 714 473.55			R173	91 009.95	3 714 239.53		
L174	91 246.47	3 714 422.90			R174	90 720.35	3 713 959.40		
L175	91 242.99	3 714 419.61			R175	90 383.32	3 713 634.39		
L176	91 103.85	3 714 283.52			R176	89 846.66	3 713 116.54		
L177	91 044.95	3 714 215.63			R177	89 752.52	3 713 031.38		
L178	90 984.87	3 714 155.49			R178	89 676.32	3 712 971.20		
L179	90 975.72	3 714 160.62			R179	89 570.71	3 712 900.83		
L180	89 842.34	3 713 068.36			R180	89 472.35	3 712 844.60		
L181	89 833.09	3 713 060.32			R181	89 373.27	3 712 798.58		
L182	89 770.27	3 713 005.55			R182	89 305.96	3 712 770.51		
L183	89 703.86	3 712 952.54			R183	89 114.95	3 712 691.40		
L184	89 593.19	3 712 876.92			R184	88 181.75	3 712 306.70		
L185	89 487.55	3 712 817.50			R185	88 088.10	3 712 274.28		
L186	89 384.61	3 712 769.02			R186	87 956.89	3 712 247.12		
L187	89 317.19	3 712 741.04			R187	87 824.56	3 712 239.42		
L188	89 125.75	3 712 662.20			R188	87 698.06	3 712 250.81		
L189	88 926.74	3 712 579.85			R189	87 573.90	3 712 278.86		
L190	88 723.75	3 712 496.29			R190	87 207.31	3 712 386.14		
L191	88 560.79	3 712 428.89			R191	87 155.87	3 712 395.37		
L192	88 343.86	3 712 340.02			R192	87 105.63	3 712 408.63		
L193	88 176.70	3 712 272.16			R193	87 009.81	3 712 421.56		
L194	88 095.87	3 712 244.94			R194	86 908.99	3 712 427.55		
L195	87 959.18	3 712 214.08			R195	85 606.86	3 712 426.49		
L196	87 824.55	3 712 208.06			R196	84 403.68	3 712 425.38		
L197	87 685.45	3 712 220.63			R197	84 342.77	3 712 423.14		
L198	87 566.65	3 712 248.51			R198	84 306.43	3 712 419.64		
L199	87 178.22	3 712 350.49			R199	84 246.41	3 712 409.58		
L200	87 116.99	3 712 365.44			R200	84 187.70	3 712 393.88		
L201	87 003.37	3 712 381.80			R201	84 141.55	3 712 377.64		
L202	86 888.66	3 712 387.24			R202	84 119.08	3 712 368.33		
L203	84 436.06	3 712 387.55			R203	84 085.73	3 712 352.77		
L204	84 343.80	3 712 382.99			R204	84 053.75	3 712 335.38		
					<div> <div>Vel</div> <div>11</div> <div>Van</div> <div>12</div> <div>Sheet</div> <div>of</div> <div>P1199/20</div> </div>				

This gazette is also available free online at www.gpwnonline.co.za