GOVERNMENT NOTICES • GOEWERMENTSKENNISGEWINGS

DEPARTMENT OF TRANSPORT

NO. 6238

30 May 2025

**THE SOUTH AFRICAN NATIONAL ROADS
AGENCY SOC LIMITED****Registration No: 1998/009584/30**

DECLARATION AMENDMENT OF NATIONAL ROAD N2 SECTION 32**AMENDMENT OF DECLARATION No. 376 OF 2016**

By virtue of Section 40 (1)(b) of The South African National Roads Agency Limited and National Roads Act, 1998 (Act No. 7 of 1998), I hereby amend Declaration No. 376 of 2016 by substituting it in its entirety, the accompanying sheets 1 to 26 of Plan No. P1175/19.

In the town of Pongola the N2 Section 32 enters the town from the east and follows the street known as Piet Retief Road, at time of declaration.

(National Road N2 Section 32: Pongola River – KwaZulu Natal/Mpumalanga Provincial Border)

MINISTER OF TRANSPORT

DEPARTEMENT VAN VERVOER

NO. 6238

30 Mei 2025

**DIE SUID-AFRIKAANSE NASIONALE
PADAGENTSKAP MSB BEPERK**Registrasie No: 1998/009584/30

VERKLARING WYSIGING VAN NASIONALE PAD N2 SEKSIE 32

WYSIGING VAN VERKLARING NO. 376 VAN 2016.

Kragtens Artikel 40(1)(b) van die Wet op die Suid-Afrikaanse Nasionale Padagentskap Beperk en op Nasionale Paaie, 1998 (Wet no. 7 van 1998), wysig ek hiermee Verklaring No.376 van 2016 deur dit in sy geheel, te vervang met meegaande velle 1 tot 26 van Plan no. P1175/19.

In die dorp Pongola kom die N2 Seksie 32 die dorp binne vanuit die ooste en volg dan die straat bekend as Piet Retiefstraat, tydens datum van verklaring.

(Nasionale Pad N2 Seksie 32: Pongolarivier – KwaZulu Natal/Mpumalanga Provinsiale Grens)
MINISTER VAN VERVOER

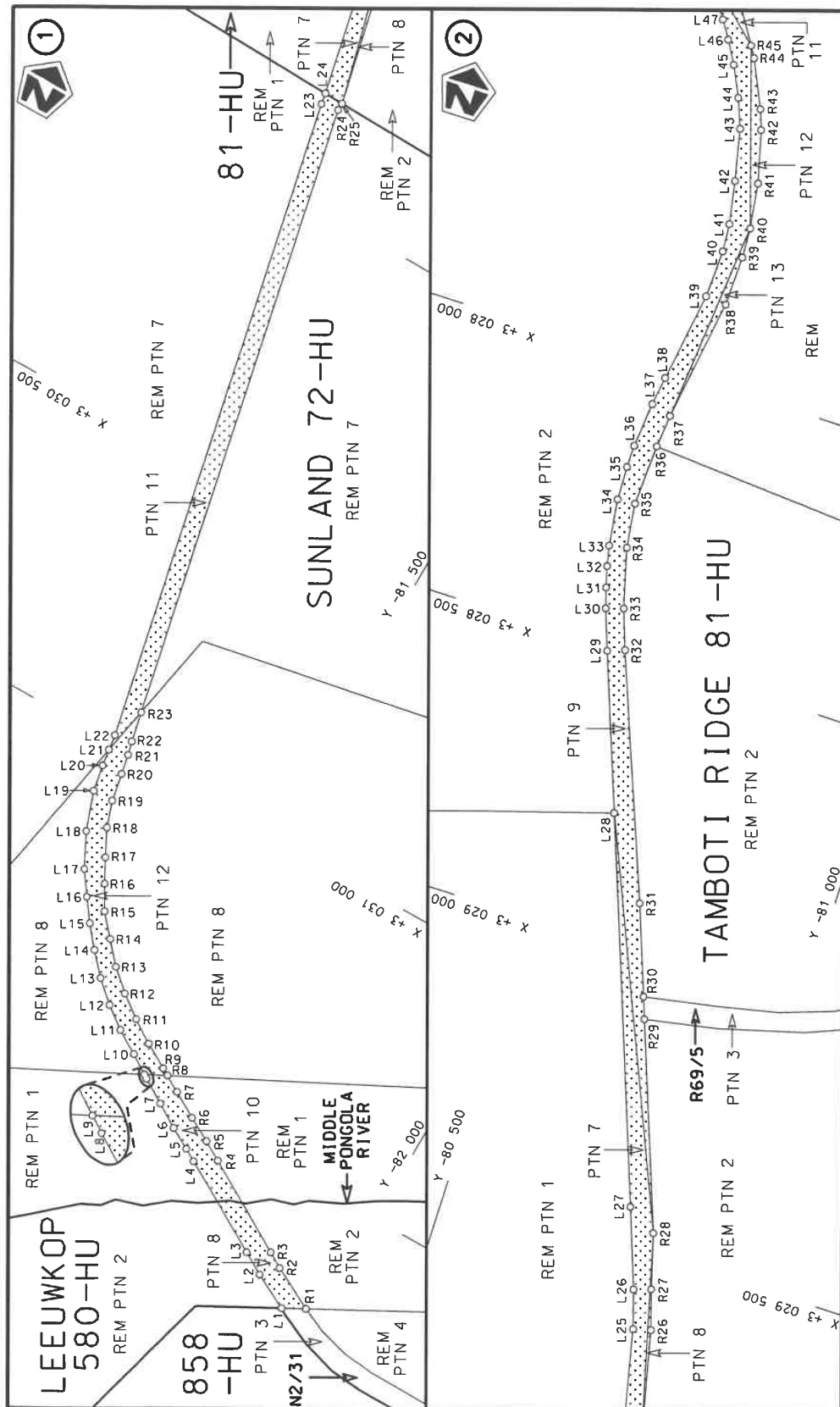

Die Suid Afrikaanse Nasionale Padagentskap MSB Bpk The South African National Roads Agency SOC Ltd	Die figuur getoon The figure shown	 steldie padreserwe voor van 'n gedeelte represents the road reserve of a portion van Nasionale Roete of National Route	Vel Sheet 1 of 26 Plan P1175/19
---	---------------------------------------	--	---

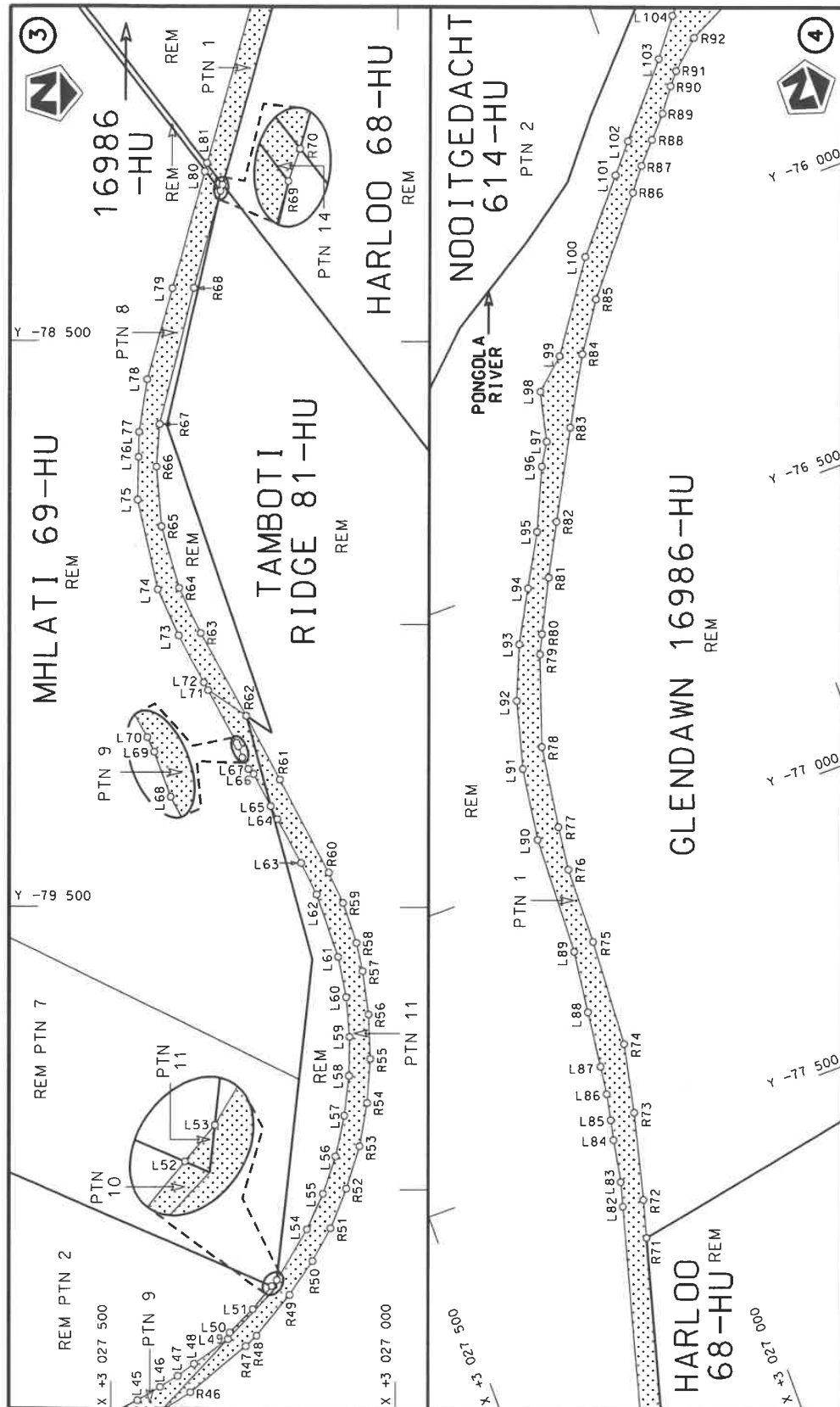

Die Suid Afrikaanse Nasionale Padagentskap MSB Bpk The South African National Roads Agency SOC Ltd	Die figuur getoon The figure shown	steldie podreserwe voor van 'n gedeelte represents the road reserve of a portion van Nasionale Roete N2 of National Route	Vel Sheet 2 of 26 Plan P1175/19
---	---------------------------------------	--	---------------------------------------

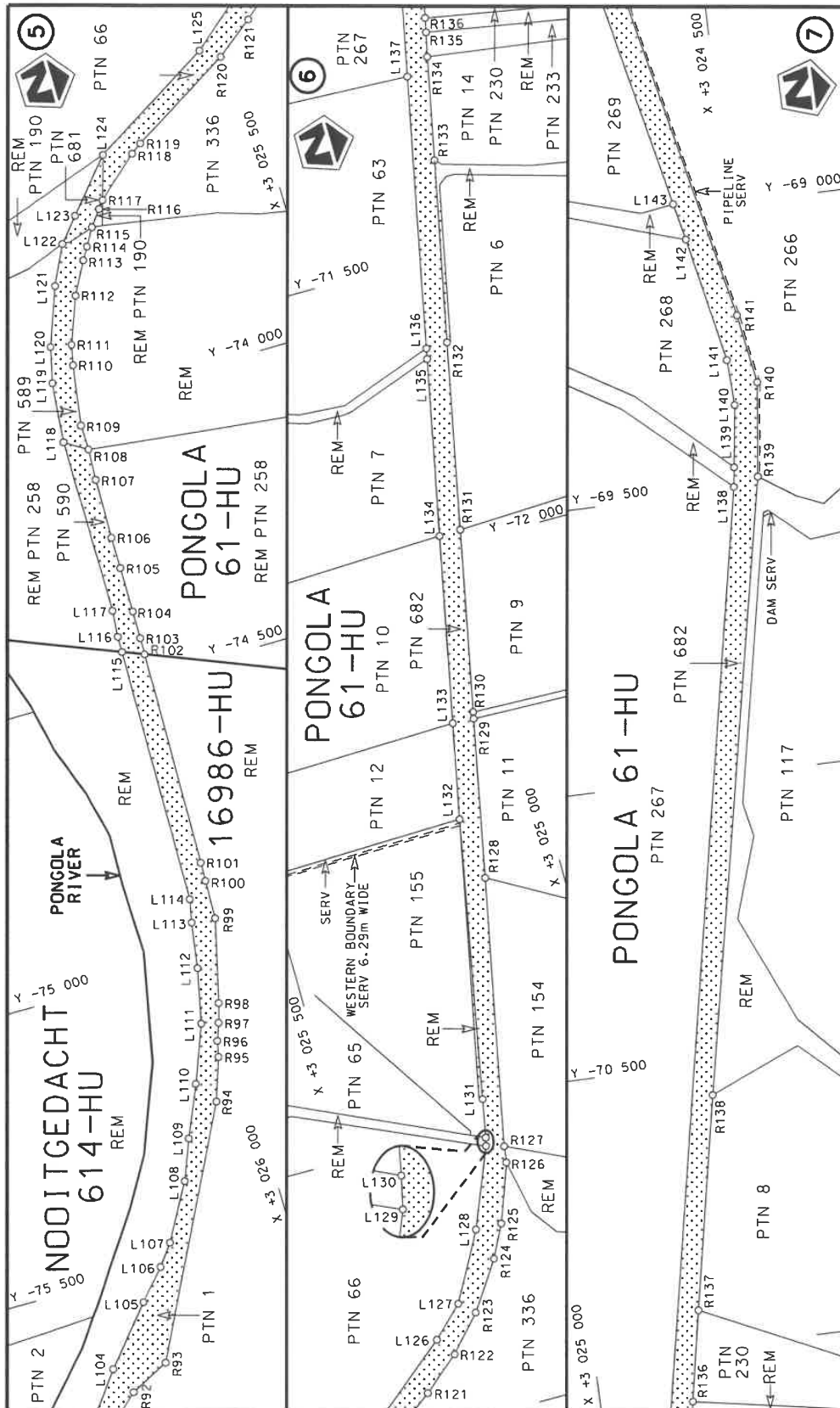

Vol 3 of 26
Sheet 32
Plan P1175/19

stel die padreserwe voor van 'n gedeelte
represents the road reserve of a portion
van Nasionale Roete N2
of National Route



Die figuur getoon
The figure shown

Die Suid Afrikaanse Nasionale Padagentskap MSB Bpk
The South African National Roads Agency SOC Ltd

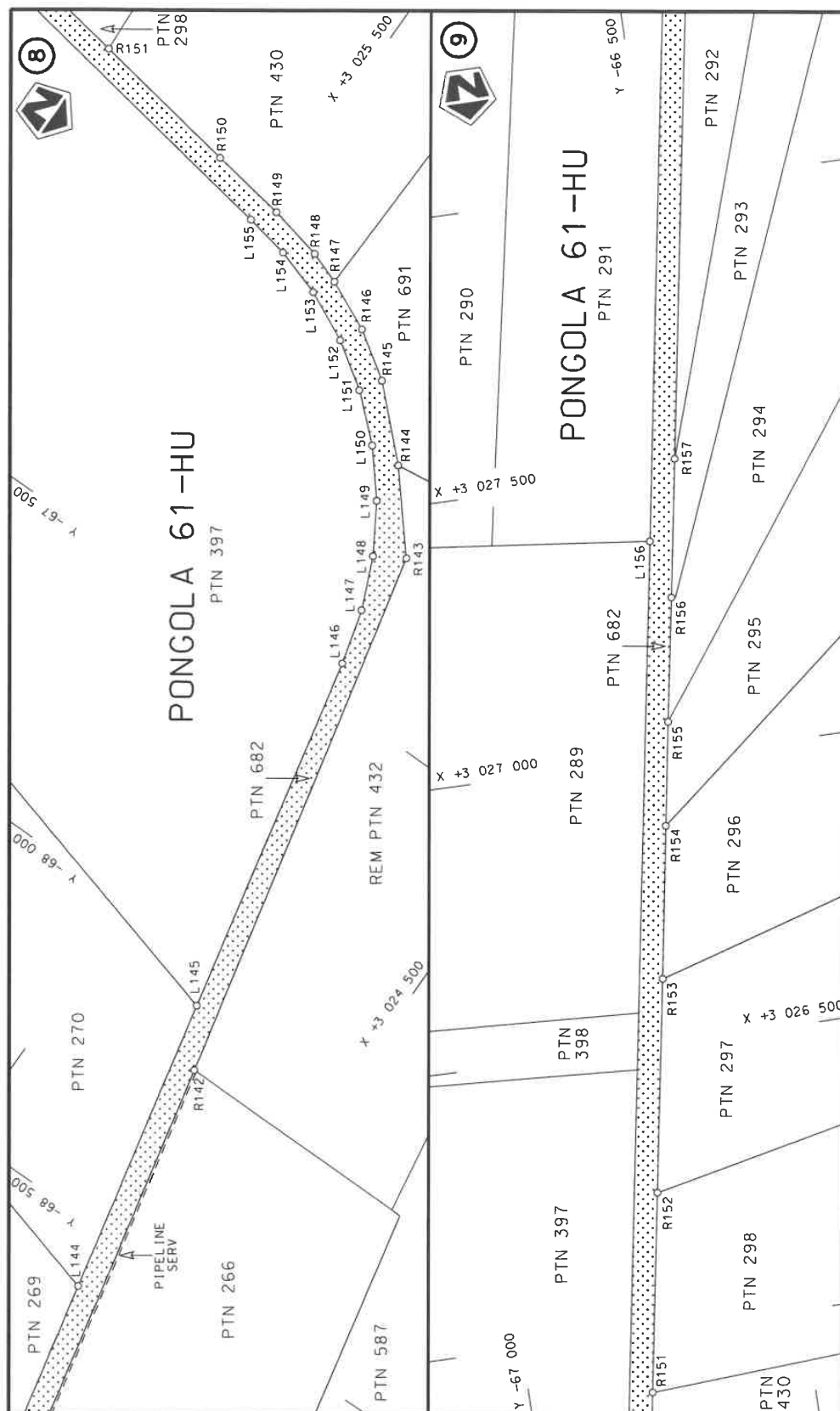

Die Sud Afrikaanse Nasionale Podagentskap MSB Bpk	Die figuur getoon		stel die padreserwe voor van 'n gedeelte represents the road reserve of a portion van Nasionale Roete N2 of National Route	32 Seksie Section	Vel Sheet	4 of	26 of
The South African National Roads Agency SOC Ltd	The figure shown				Plan	P1175/19	

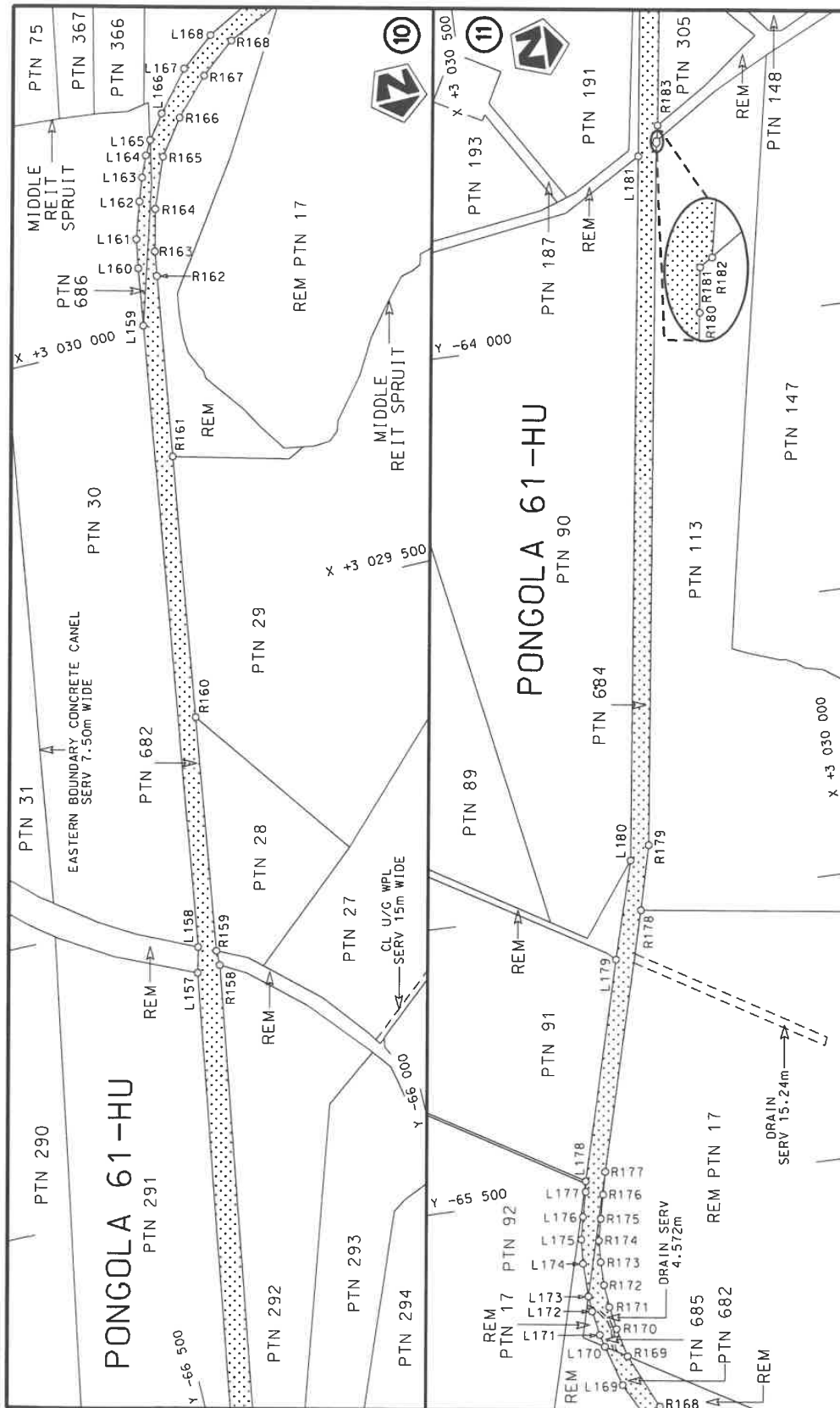

Die Suid Afrikaanse Nasionale Padagentskap MSB Bpk The South African National Roads Agency SOC Ltd	Die figuur getoon The figure shown	steldie padreserwe voor van 'n gedeelte represents the road reserve of a portion van Nasionale Roete N2 of National Route	Vel Sheet 5 of 26 Plan P1175/19
---	---------------------------------------	--	---------------------------------------

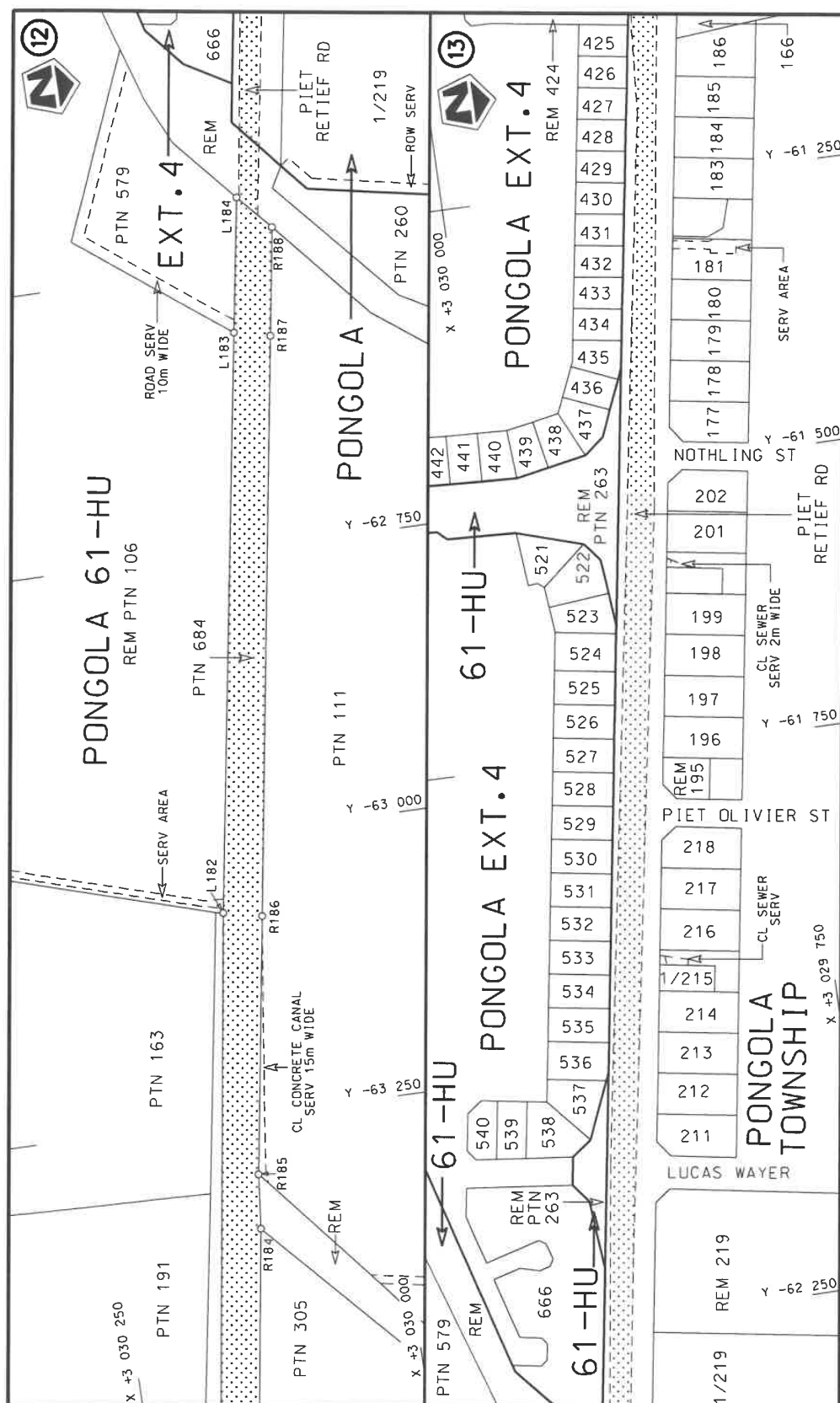

Die Suid Afrikaanse Nasionale Padagentskap MSB Bpk The South African National Roads Agency SOC Ltd	Die figuur getoon The figure shown	stel die padreserwe voor van 'n gedeelte represents the road reserve of a portion van Nasionale Roete N2 of National Route		Vel Sheet	van 6	of 26
				Plan	32	P1175/19

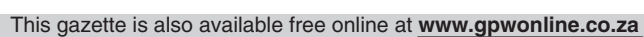

Die Suid Afrikaanse Nasionale Padagentskap MSB Bpk	Die figuur getoon		stelt die padreserwe voor van 'n gedeelte represents the road reserve of a portion	Vel Sheet	7 of	26
The South African National Roads Agency SOC Ltd	The figure shown		van Nasionale Roete of National Route	32	Plan	P1175/19

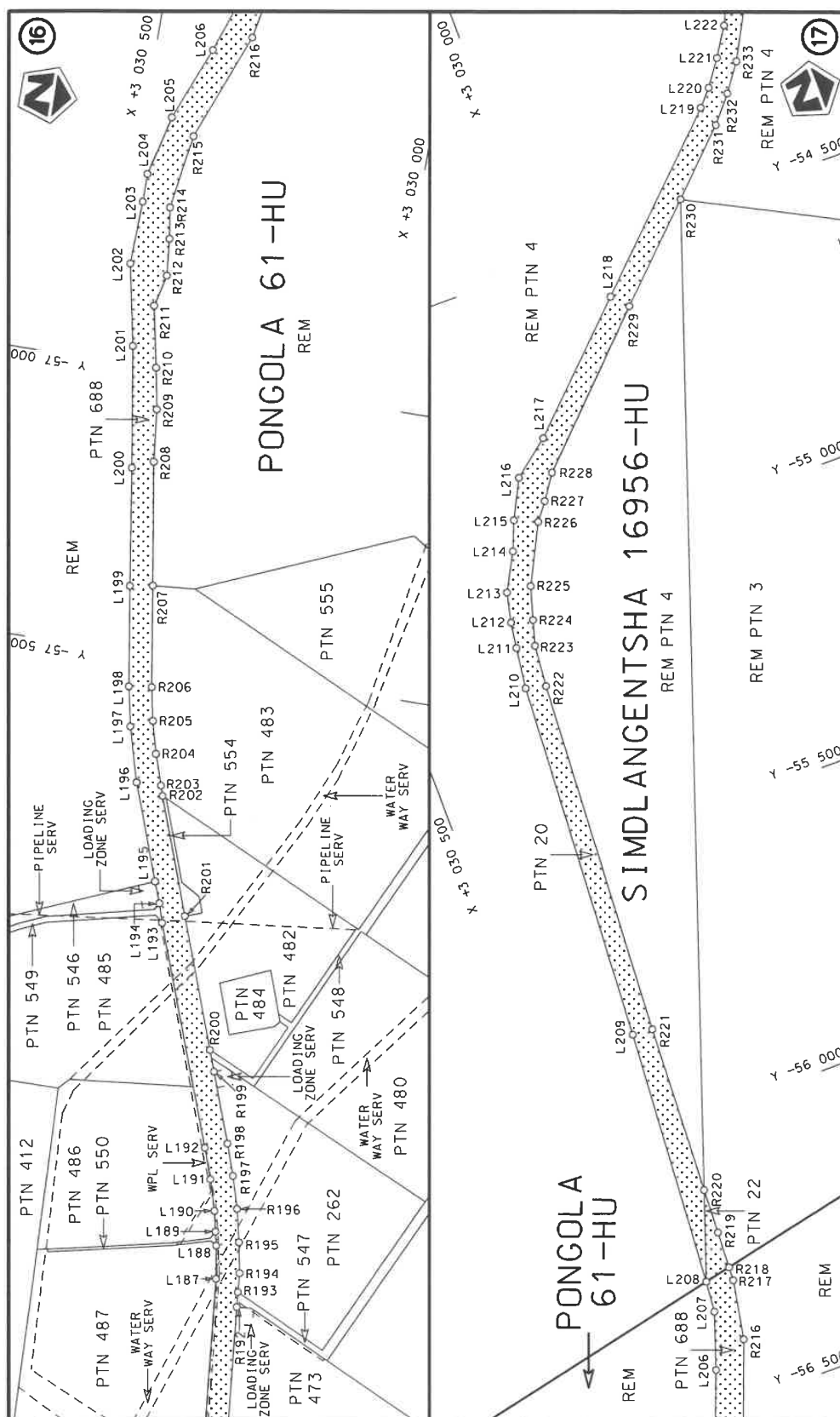

Vel Sheet 8 of 26	steldie padreserwe voor van 'n gedeelte represents the road reserve of a portion van Nasionale Roete N2 Seksie Section of National Route 32		Die figuur getoon The figure shown	Die Suid Afrikaanse Nasionale Padagentskap MSB Bpk The South African National Roads Agency SOC Ltd
-------------------------	---	--	---------------------------------------	---

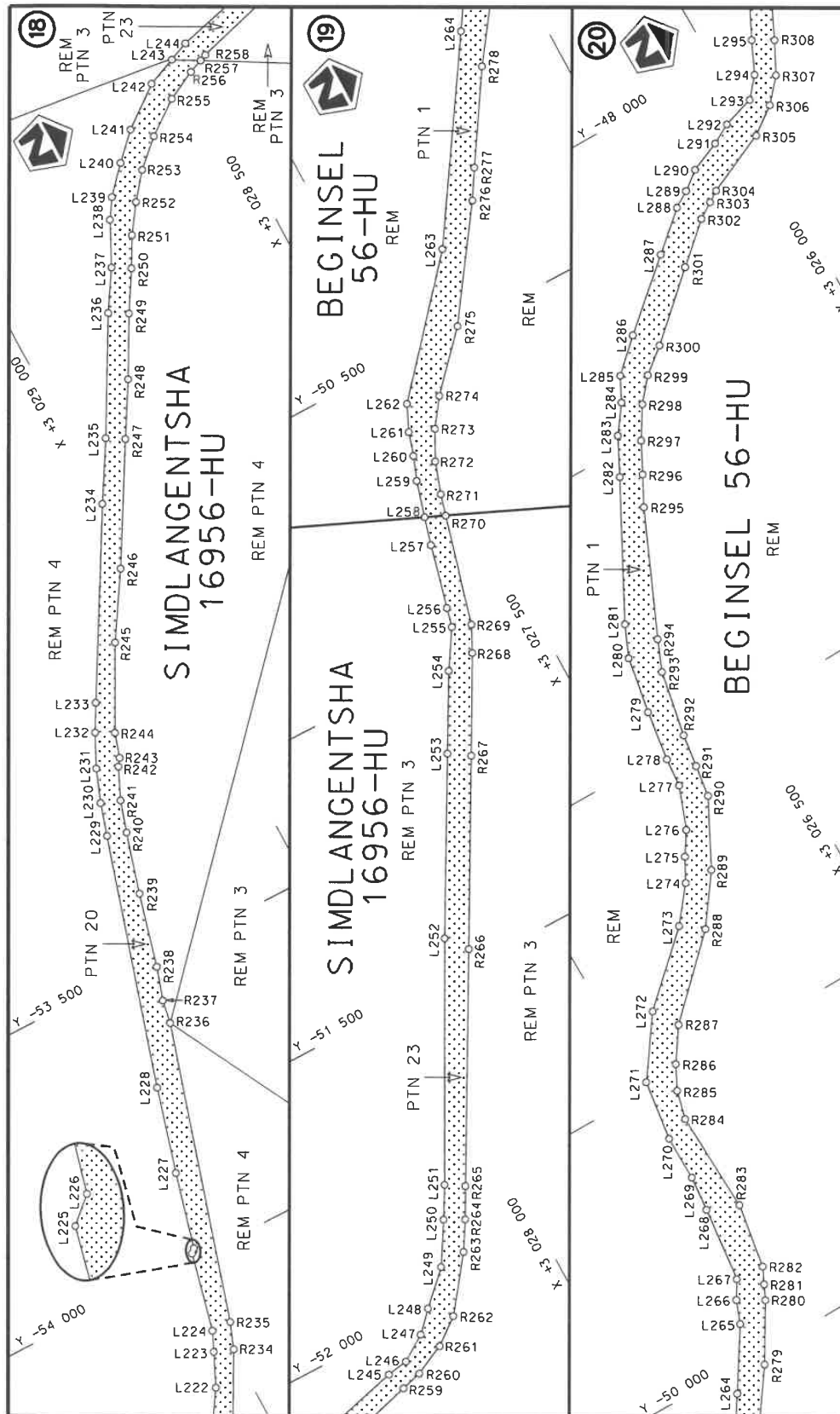

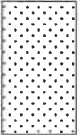
Die Suid Afrikaanse Nasionale Padagentskap MSB Bpk The South African National Roads Agency SOC Ltd	Die figuur getoon The figure shown		steldie padreserwe voor van 'n gedeelte represents the road reserve of a portion van Nasionale Roete N2 of National Route	Vel Sheet	van 9	of 26	Plan P1175/19
			Seksie Section		32		

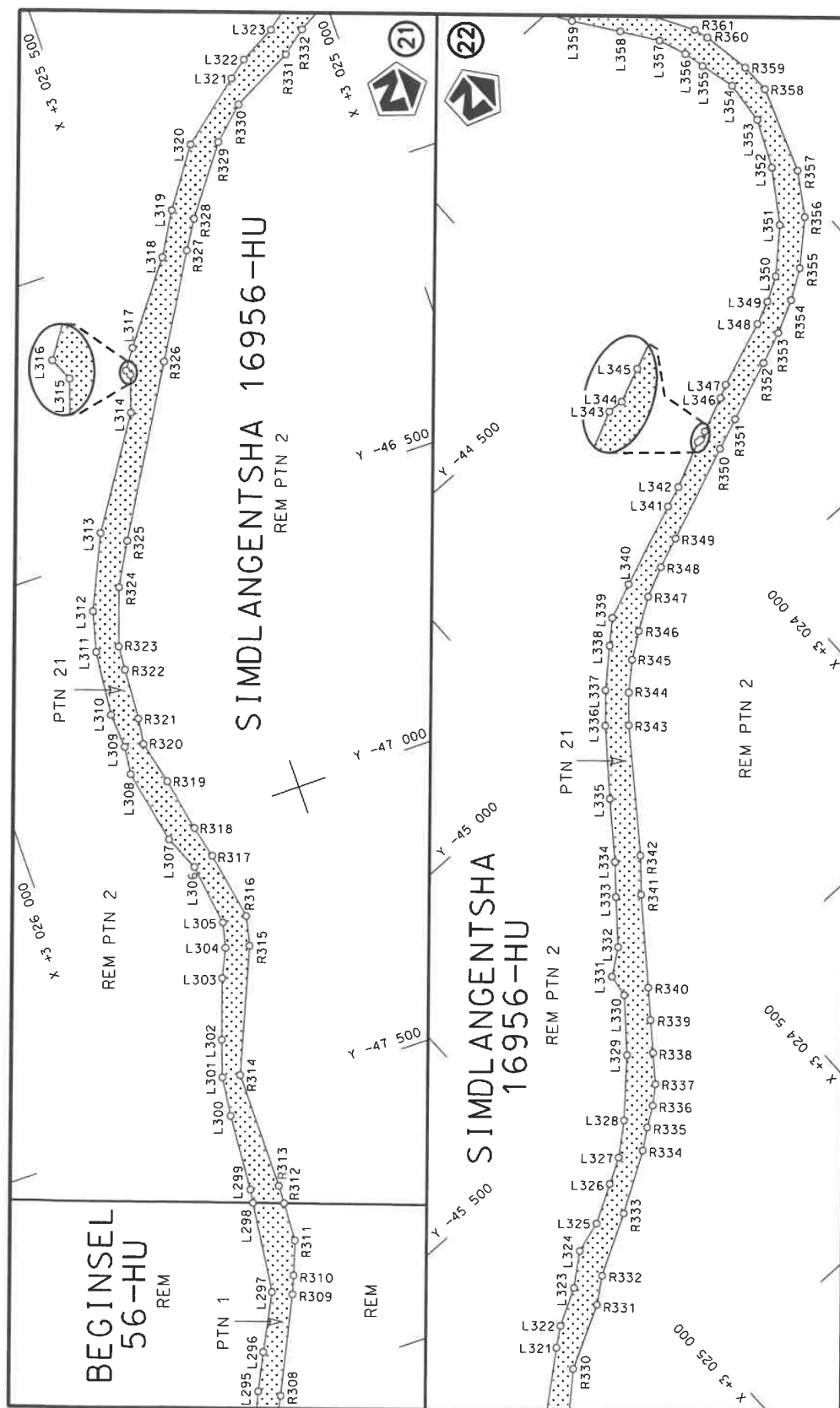

Die Suid Afrikaanse Nasionale Padagentskap MSB Bpk The South African National Roads Agency SOC Ltd	Die figuur getoon The figure shown	<p>steeldie podreserwe voor van 'n gedeelte represents the road reserve of a portion van Nasionale Roete N2 Sekse of National Route Section</p>	Vel Sheet	10 of	26
			Plan	P1175/19	

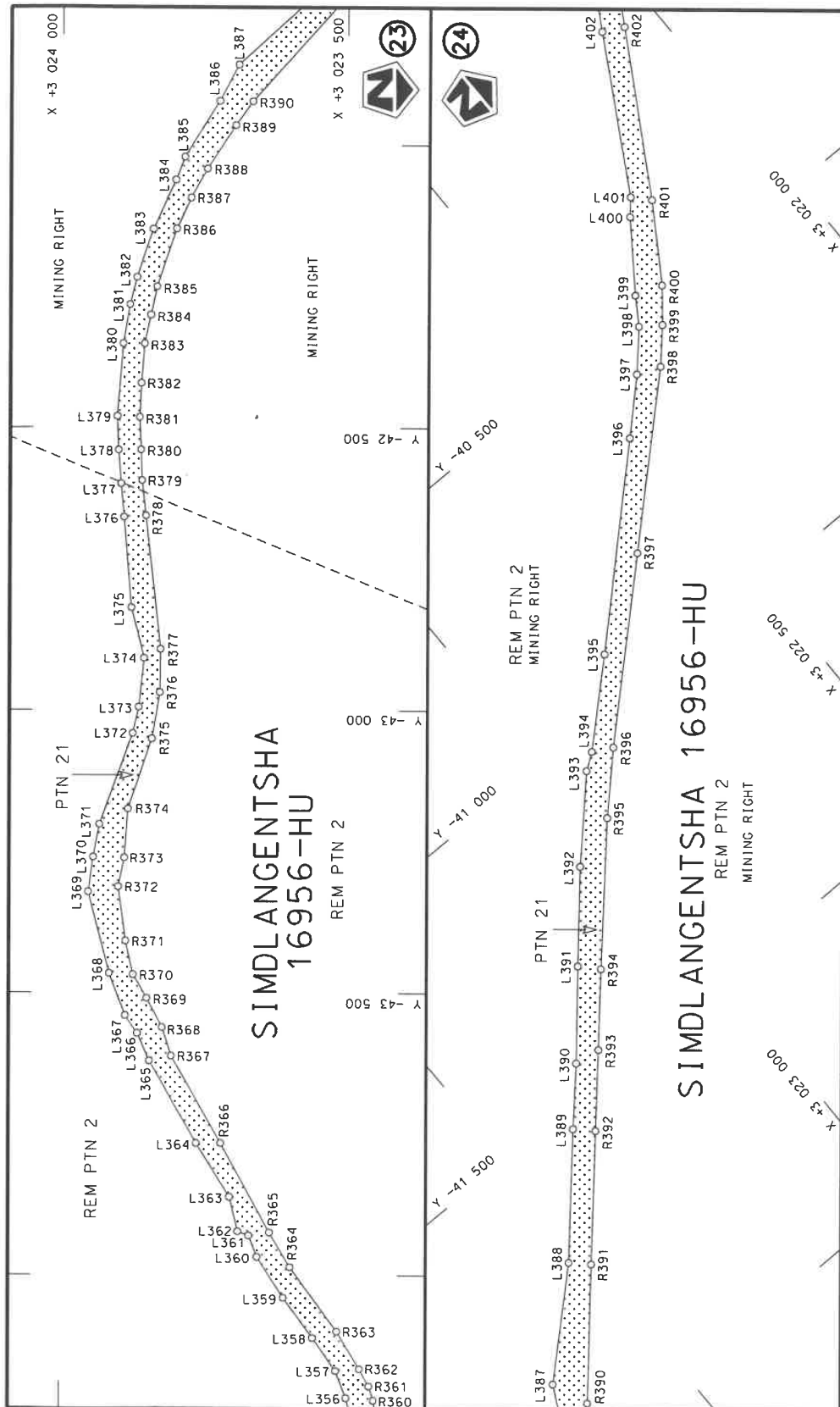

Die Suid Afrikaanse Nasionale Padagentskap MSB Bpk The South African National Roads Agency SOC Ltd	Die figuur getoon The figure shown	<div data-bbox="1267 1061 1347 1196" data-label="Image"> </div>	Vel Sheet 11 of 26 Plan P1175/19
---	---------------------------------------	---	--

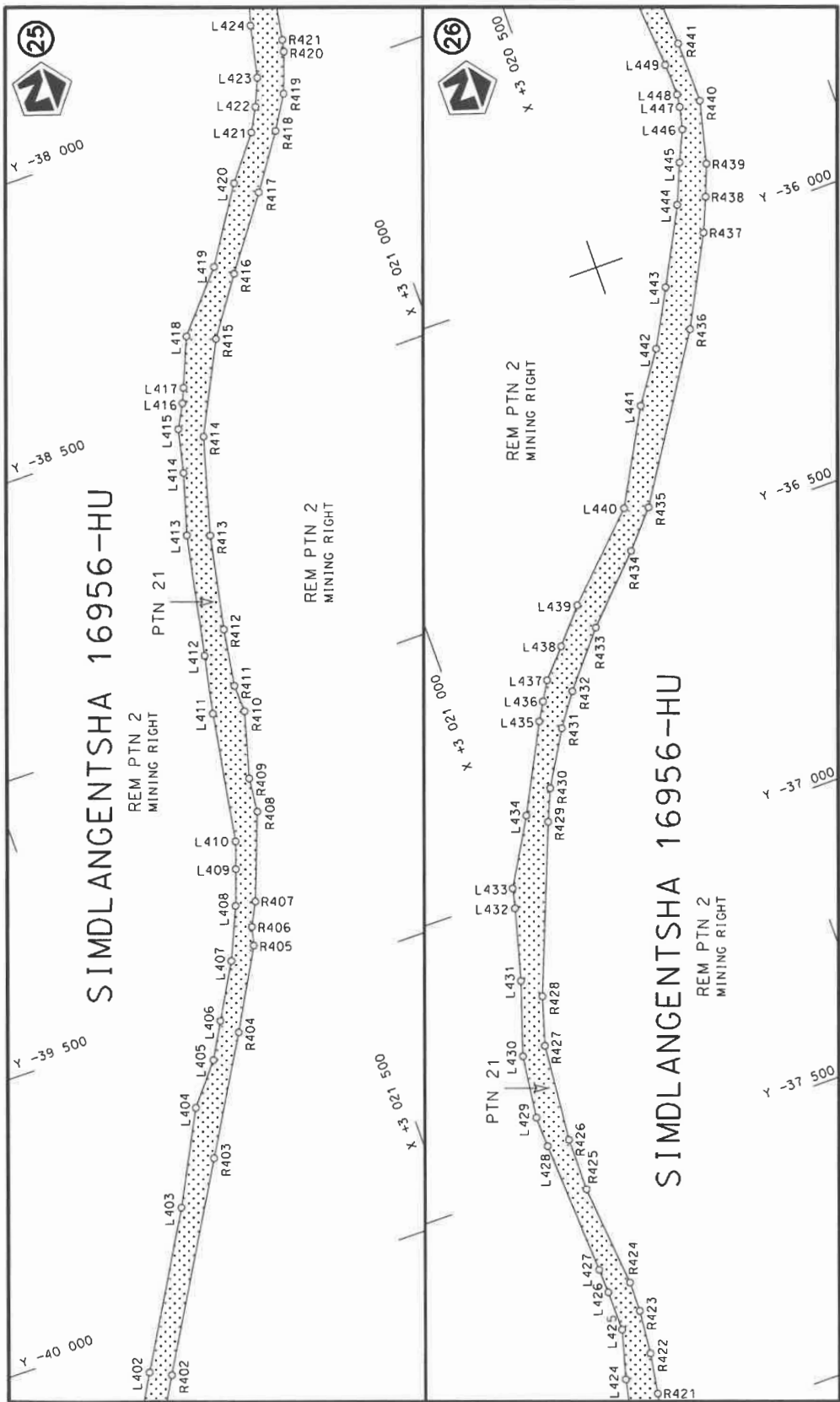

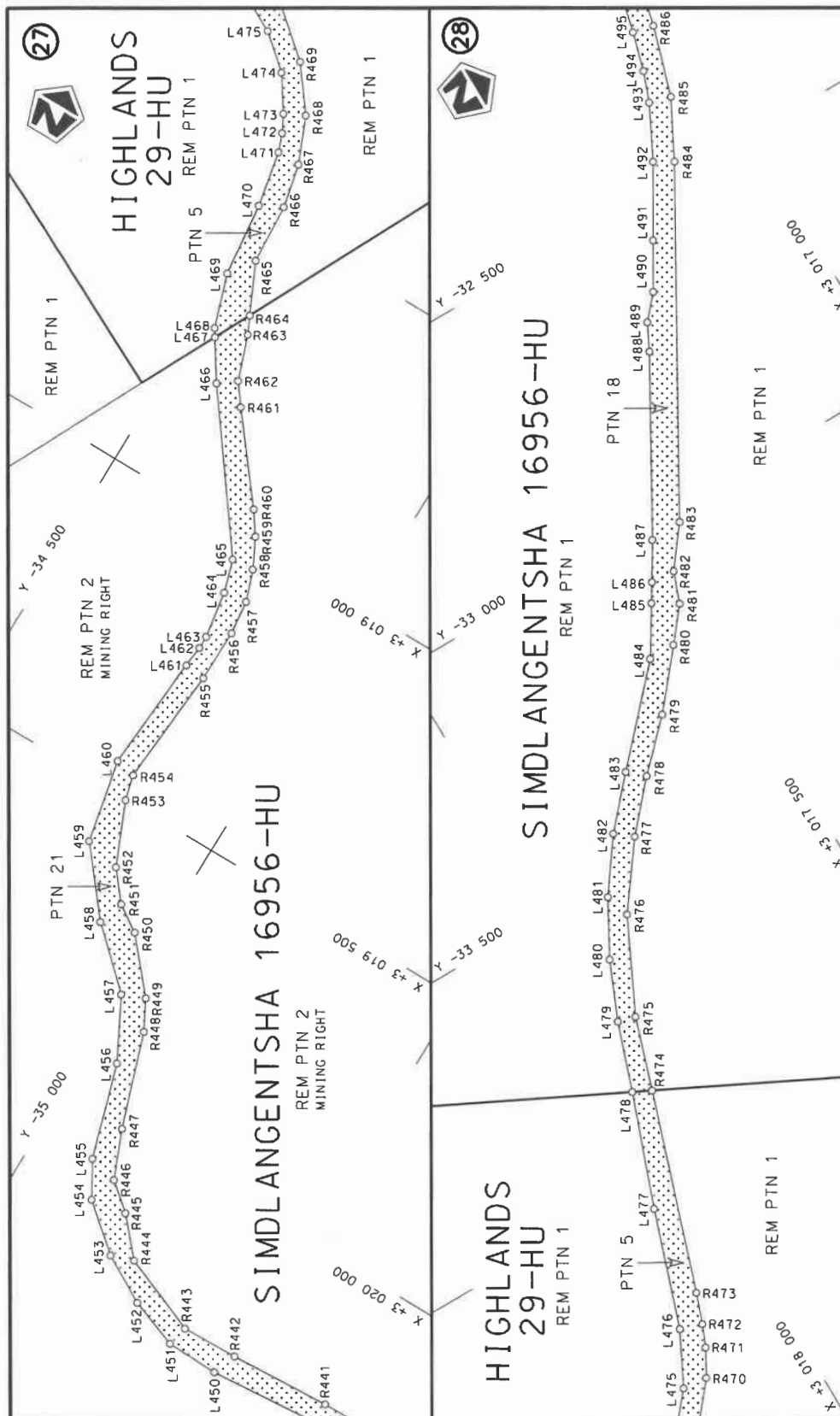

Die Suid Afrikaanse Nasionale Padagentskap MSB Bpk The South African National Roads Agency SOC Ltd	Die figuur getoon The figure shown		steldie padreserwe voor van 'n gedeelte represents the road reserve of a portion van Nasionale Roete N2 of National Route	32	Plan P1175/19
				Vel Sheet 12 of 26	

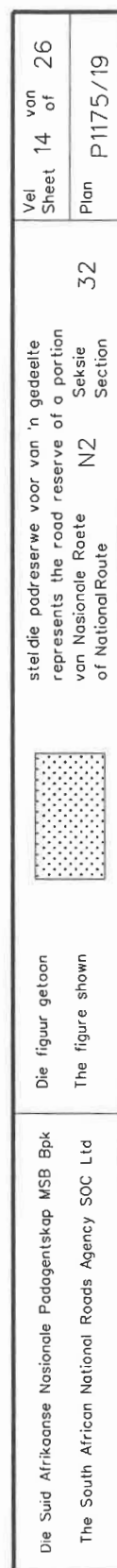

Die Suid Afrikaanse Nasionale Padagentskap MSB Bpk	Die figuur getoon		steldie padreserwe voor van 'n gedeelte represents the road reserve of a portion van Nasionale Roete N2 of National Route	Vel Sheet 13 of 26
The South African National Roads Agency SOC Ltd	The figure shown			32

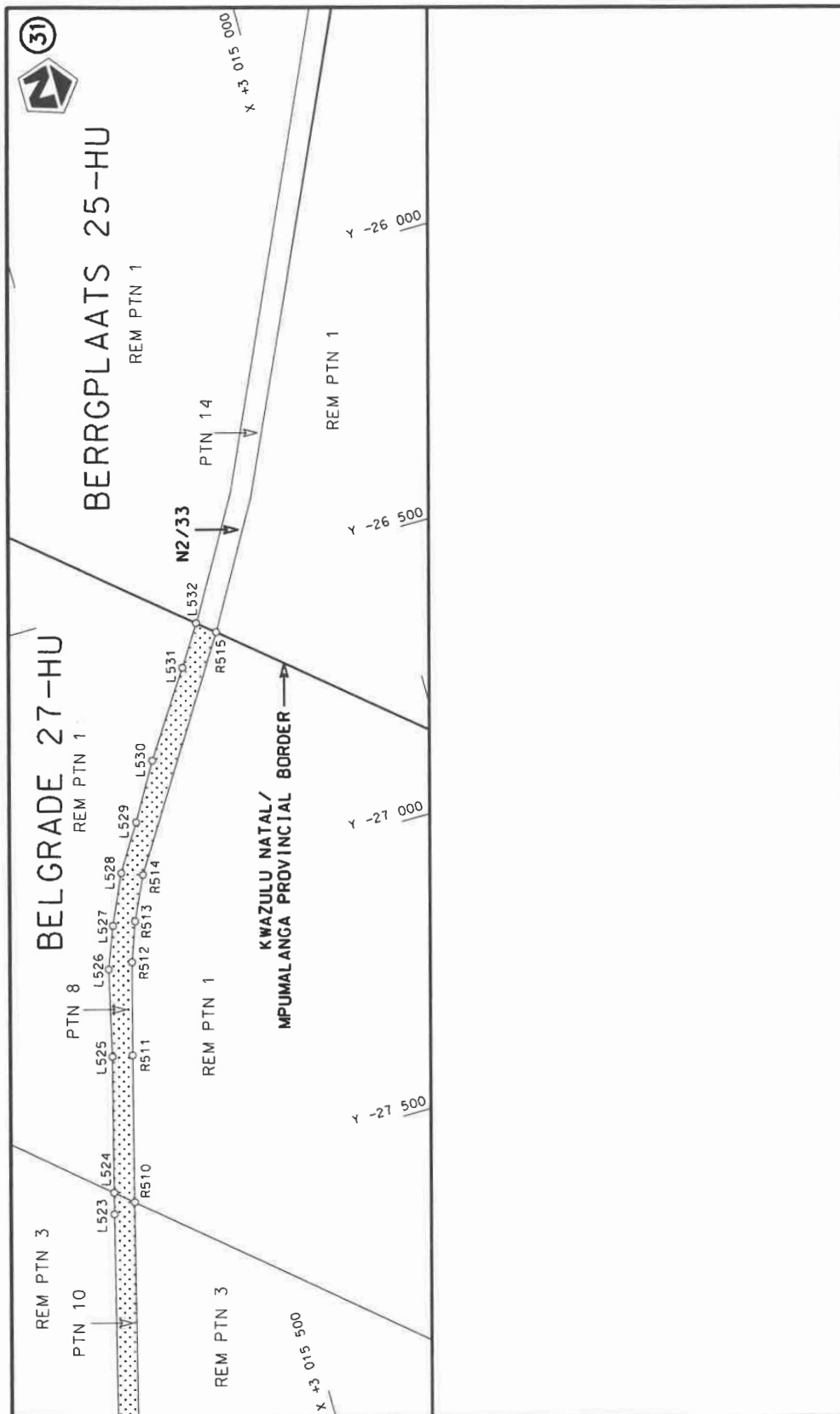



Die Suid Afrikaanse Nasionale Padagentskap MSB Bpk The South African National Roads Agency SOC Ltd	Die figuur getoon The figure shown	 steldie padreserwe voor van 'n gedeelte represents the road reserve of a portion van Nasionale Roete N2 of National Route	Vel Sheet 15 of 26 Plan P1175/19
---	---------------------------------------	---	--

PADRESERWE KOÖRDINATE / ROAD RESERVE CO-ORDINATES									
LINKERKANT/LEFT HAND SIDE					REGTERKANT/RIGHT HAND SIDE				
	Y		X	WG 31°		Y		X	
L1	-81 936.21	3	031	719.13	R1	-81 973.92	3	031	698.63
L2	-81 873.41	3	031	686.90	R2	-81 897.99	3	031	659.11
L3	-81 833.66	3	031	663.80	R3	-81 870.35	3	031	642.91
L4	-81 672.87	3	031	570.35	R4	-81 709.23	3	031	548.43
L5	-81 651.13	3	031	557.72	R5	-81 674.96	3	031	528.33
L6	-81 613.69	3	031	536.83	R6	-81 632.48	3	031	504.95
L7	-81 571.35	3	031	510.91	R7	-81 586.55	3	031	478.30
L8	-81 528.90	3	031	484.96	R8	-81 557.78	3	031	461.46
L9	-81 521.52	3	031	480.15	R9	-81 547.05	3	031	455.18
L10	-81 487.62	3	031	458.07	R10	-81 501.11	3	031	429.12
L11	-81 445.81	3	031	432.85	R11	-81 460.15	3	031	402.61
L12	-81 407.19	3	031	404.01	R12	-81 420.51	3	031	372.85
L13	-81 369.48	3	031	370.66	R13	-81 382.93	3	031	339.99
L14	-81 335.33	3	031	332.94	R14	-81 349.96	3	031	302.27
L15	-81 304.78	3	031	295.92	R15	-81 316.70	3	031	264.65
L16	-81 276.80	3	031	257.79	R16	-81 292.33	3	031	222.06
L17	-81 248.12	3	031	217.77	R17	-81 270.25	3	031	181.18
L18	-81 217.85	3	031	157.70	R18	-81 246.45	3	031	134.14
L19	-81 193.80	3	031	089.22	R19	-81 230.83	3	031	088.10
L20	-81 184.82	3	031	042.68	R20	-81 221.44	3	031	038.94
L21	-81 180.80	3	031	012.69	R21	-81 214.59	3	031	003.97
L22	-81 177.13	3	030	985.33	R22	-81 208.18	3	030	979.95
L23	-80 932.61	3	029	837.44	R23	-81 196.91	3	030	927.06
L24	-80 929.52	3	029	817.77	R24	-80 963.58	3	029	831.72
L25	-80 890.26	3	029	637.19	R25	-80 963.85	3	029	818.57
L26	-80 869.43	3	029	570.02	R26	-80 920.73	3	029	629.16
L27	-80 819.36	3	029	432.17	R27	-80 899.28	3	029	559.98
L28	-80 578.68	3	028	776.51	R28	-80 872.20	3	029	464.38
L29	-80 478.83	3	028	506.90	R29	-80 741.24	3	029	107.92
L30	-80 453.47	3	028	436.20	R30	-80 727.45	3	029	070.40
L31	-80 442.54	3	028	400.85	R31	-80 670.32	3	028	914.89
L32	-80 432.77	3	028	364.54	R32	-80 508.41	3	028	496.12
L33	-80 425.04	3	028	328.82	R33	-80 483.57	3	028	426.83
L34	-80 414.21	3	028	246.23	R34	-80 456.00	3	028	322.72
L35	-80 412.33	3	028	186.65	R35	-80 445.68	3	028	244.01
L36	-80 413.20	3	028	147.08	R36	-80 451.39	3	028	136.01
L37	-80 420.80	3	028	066.98	R37	-80 456.87	3	028	077.62
L38	-80 428.29	3	028	016.14	R38	-80 490.57	3	027	860.02
L39	-80 452.98	3	027	856.42	R39	-80 493.27	3	027	771.47
L40	-80 456.57	3	027	771.81	R40	-80 490.60	3	027	718.37
L41	-80 453.00	3	027	722.47	R41	-80 479.34	3	027	638.55
L42	-80 439.31	3	027	646.80	R42	-80 455.55	3	027	547.20
L43	-80 419.60	3	027	556.37	R43	-80 442.92	3	027	512.44
L44	-80 399.57	3	027	505.43	R44	-80 404.44	3	027	430.20
L45	-80 374.02	3	027	452.58	R45	-80 392.70	3	027	410.74
L46	-80 350.75	3	027	413.17	R46	-80 359.67	3	027	359.49
L47	-80 331.01	3	027	382.30	R47	-80 277.80	3	027	261.87
L48	-80 309.43	3	027	352.98	R48	-80 259.58	3	027	243.22
L49	-80 265.79	3	027	293.34	R49	-80 186.98	3	027	185.56
L50	-80 253.91	3	027	290.22	R50	-80 126.81	3	027	145.06
L51	-80 212.58	3	027	250.03	R51	-80 068.64	3	027	113.96
					Vel	16	Van	26	P1175/19
					Sheet		of		

PADRESERVE KOÖRDINATE / ROAD RESERVE CO-ORDINATES									
LINKERKANT/LEFT HAND SIDE					REGTERKANT/RIGHT HAND SIDE				
	Y		X	WG 31°		Y		X	
L52	-80 171.45	3	027	216.36	R52	-79 998.51	3	027	086.17
L53	-80 160.68	3	027	207.54	R53	-79 923.14	3	027	063.49
L54	-80 070.65	3	027	155.11	R54	-79 846.68	3	027	050.03
L55	-80 007.63	3	027	127.05	R55	-79 768.57	3	027	044.49
L56	-79 941.54	3	027	105.17	R56	-79 690.08	3	027	047.28
L57	-79 869.10	3	027	089.84	R57	-79 613.26	3	027	058.25
L58	-79 798.46	3	027	081.75	R58	-79 563.20	3	027	069.21
L59	-79 729.64	3	027	080.97	R59	-79 492.74	3	027	092.50
L60	-79 659.42	3	027	086.94	R60	-79 438.99	3	027	117.53
L61	-79 588.23	3	027	101.39	R61	-79 274.94	3	027	203.58
L62	-79 477.85	3	027	138.79	R62	-79 162.13	3	027	262.72
L63	-79 422.02	3	027	165.89	R63	-79 016.29	3	027	343.27
L64	-79 344.88	3	027	207.73	R64	-78 936.53	3	027	381.76
L65	-79 321.91	3	027	219.73	R65	-78 827.72	3	027	412.87
L66	-79 264.83	3	027	249.53	R66	-78 722.30	3	027	421.62
L67	-79 256.29	3	027	258.93	R67	-78 647.03	3	027	416.25
L68	-79 236.14	3	027	269.50	R68	-78 406.30	3	027	356.30
L69	-79 216.35	3	027	276.79	R69	-78 235.15	3	027	310.17
L70	-79 209.89	3	027	279.77	R70	-78 224.11	3	027	306.26
L71	-79 116.86	3	027	330.29	R71	-77 665.83	3	027	152.71
L72	-79 103.19	3	027	337.71	R72	-77 600.89	3	027	134.55
L73	-79 020.20	3	027	382.53	R73	-77 450.35	3	027	096.53
L74	-78 938.80	3	027	418.96	R74	-77 330.17	3	027	071.58
L75	-78 780.87	3	027	454.24	R75	-77 141.62	3	027	060.53
L76	-78 705.11	3	027	452.90	R76	-77 006.72	3	027	057.19
L77	-78 661.23	3	027	451.76	R77	-76 930.29	3	027	047.79
L78	-78 567.87	3	027	438.23	R78	-76 787.29	3	027	026.31
L79	-78 406.78	3	027	394.37	R79	-76 632.48	3	026	972.98
L80	-78 199.22	3	027	337.38	R80	-76 599.93	3	026	957.29
L81	-78 187.78	3	027	334.24	R81	-76 510.37	3	026	912.16
L82	-77 599.80	3	027	172.81	R82	-76 422.16	3	026	865.22
L83	-77 557.76	3	027	161.22	R83	-76 274.19	3	026	785.44
L84	-77 483.45	3	027	147.50	R84	-76 159.90	3	026	721.08
L85	-77 448.71	3	027	140.01	R85	-76 076.97	3	026	665.24
L86	-77 402.95	3	027	131.00	R86	-75 922.41	3	026	539.97
L87	-77 353.65	3	027	124.53	R87	-75 882.85	3	026	509.95
L88	-77 255.66	3	027	112.09	R88	-75 846.04	3	026	476.75
L89	-77 146.73	3	027	097.68	R89	-75 809.24	3	026	443.74
L90	-76 938.85	3	027	089.73	R90	-75 768.39	3	026	414.09
L91	-76 812.28	3	027	071.00	R91	-75 746.56	3	026	395.77
L92	-76 695.63	3	027	039.69	R92	-75 702.29	3	026	346.46
L93	-76 603.35	3	027	000.97	R93	-75 668.26	3	026	278.26
L94	-76 515.75	3	026	952.55	R94	-75 250.27	3	026	061.78
L95	-76 427.14	3	026	903.40	R95	-75 175.56	3	026	036.00
L96	-76 321.89	3	026	855.95	R96	-75 147.84	3	026	030.05
L97	-76 283.52	3	026	832.68	R97	-75 117.93	3	026	018.76
L98	-76 196.60	3	026	812.83	R98	-75 084.29	3	026	008.91
L99	-76 149.38	3	026	759.60	R99	-74 938.86	3	025	972.41
L100	-76 000.29	3	026	657.25	R100	-74 870.73	3	025	970.31
L101	-75 883.00	3	026	558.06	R101	-74 837.50	3	025	969.26
L102	-75 834.09	3	026	517.01	R102	-74 456.82	3	025	959.54
Vel Sheet					17	Van of		26	P1175/19

PADRESERWE KOÖRDINATE / ROAD RESERVE CO-ORDINATES									
LINKERKANT/LEFT HAND SIDE					REGTERKANT/RIGHT HAND SIDE				
	Y		X	WG 31°		Y		X	
L103	-75 716.13	3	026	417.02	R103	-74 427.33	3	025	958.79
L104	-75 652.86	3	026	368.91	R104	-74 378.56	3	025	958.11
L105	-75 554.21	3	026	284.94	R105	-74 298.83	3	025	957.53
L106	-75 503.21	3	026	238.90	R106	-74 243.44	3	025	957.10
L107	-75 466.56	3	026	210.89	R107	-74 137.66	3	025	954.70
L108	-75 369.59	3	026	155.01	R108	-74 082.86	3	025	951.74
L109	-75 299.20	3	026	127.24	R109	-74 038.85	3	025	952.49
L110	-75 210.24	3	026	087.97	R110	-73 932.75	3	025	935.62
L111	-75 110.64	3	026	048.47	R111	-73 897.60	3	025	928.10
L112	-75 014.70	3	026	027.16	R112	-73 816.56	3	025	896.79
L113	-74 934.58	3	026	014.48	R113	-73 760.37	3	025	866.69
L114	-74 893.86	3	026	006.08	R114	-73 738.98	3	025	853.74
L115	-74 441.74	3	025	996.42	R115	-73 708.89	3	025	835.52
L116	-74 414.19	3	025	995.83	R116	-73 667.96	3	025	804.36
L117	-74 367.58	3	025	991.58	R117	-73 603.73	3	025	731.79
L118	-74 058.50	3	025	990.00	R118	-73 590.22	3	025	713.10
L119	-73 952.93	3	025	979.36	R119	-73 483.43	3	025	535.32
L120	-73 890.81	3	025	964.46	R120	-73 433.92	3	025	470.23
L121	-73 790.23	3	025	926.42	R121	-73 379.87	3	025	406.86
L122	-73 722.33	3	025	893.48	R122	-73 318.27	3	025	352.12
L123	-73 591.64	3	025	781.58	R123	-73 234.50	3	025	296.49
L124	-73 462.52	3	025	568.11	R124	-73 177.73	3	025	267.67
L125	-73 347.02	3	025	430.14	R125	-73 076.07	3	025	230.75
L126	-73 295.10	3	025	377.22	R126	-73 047.32	3	025	227.01
L127	-73 176.58	3	025	312.97	R127	-72 580.86	3	025	133.96
L128	-73 038.80	3	025	257.45	R128	-71 651.67	3	024	949.68
L129	-73 024.19	3	025	254.13	R129	-71 650.83	3	024	943.38
L130	-72 957.14	3	025	241.22	R130	-71 380.96	3	024	889.44
L131	-72 956.38	3	025	247.47	R131	-71 336.36	3	024	887.02
L132	-72 469.45	3	025	149.51	R132	-71 157.09	3	024	851.48
L133	-71 652.59	3	024	987.23	R133	-71 114.59	3	024	842.27
L134	-71 181.62	3	024	894.09	R134	-71 089.89	3	024	837.17
L135	-69 496.40	3	024	556.94	R135	-70 930.80	3	024	806.37
L136	-69 462.13	3	024	552.18	R136	-70 556.50	3	024	732.14
L137	-69 353.43	3	024	537.02	R137	-69 483.70	3	024	512.66
L138	-69 272.95	3	024	540.85	R138	-69 318.54	3	024	492.28
L139	-69 052.68	3	024	585.73	R139	-69 197.00	3	024	512.71
L140	-68 988.25	3	024	599.92	R140	-68 173.82	3	024	735.33
L141	-67 436.99	3	024	936.14	R141	-67 220.41	3	024	950.11
L142	-67 340.81	3	024	962.27	R142	-67 094.46	3	025	055.78
L143	-67 251.18	3	025	000.43	R143	-66 988.80	3	025	165.47
L144	-67 167.37	3	025	051.40	R144	-66 934.94	3	025	245.82
L145	-67 092.05	3	025	113.64	R145	-66 894.13	3	025	333.71
L146	-67 025.30	3	025	188.18	R146	-66 873.50	3	025	390.27
L147	-66 972.55	3	025	266.28	R147	-66 851.69	3	025	486.93
L148	-66 930.44	3	025	353.74	R148	-66 829.68	3	025	622.01
L149	-66 903.38	3	025	436.63	R149	-66 785.08	3	025	891.69
L150	-66 887.94	3	025	515.55	R150	-66 727.24	3	026	240.19
L151	-66 579.01	3	027	380.99	R151	-66 665.13	3	026	613.10
L152	-66 332.52	3	028	885.39	R152	-66 621.82	3	026	879.92
L153	-66 320.98	3	028	929.42	R153	-66 592.13	3	027	061.15
Vel Sheet					18	Van of		26	P1175/19

PADRESERWE KOÖRDINATE / ROAD RESERVE CO-ORDINATES									
LINKERKANT/LEFT HAND SIDE					REGTERKANT/RIGHT HAND SIDE				
	Y	X	WG 31°			Y	X		
L154	-66 159.09	3 030	020.75		R154	-66 555.71	3 027	277.70	
L155	-66 144.09	3 030	121.54		R155	-66 515.79	3 027	519.11	
L156	-66 135.45	3 030	171.93		R156	-66 291.46	3 028	889.66	
L157	-66 114.75	3 030	235.63		R157	-66 291.23	3 028	915.39	
L158	-66 100.58	3 030	275.73		R158	-66 230.30	3 029	326.17	
L159	-66 084.87	3 030	312.14		R159	-66 162.38	3 029	783.99	
L160	-66 071.47	3 030	337.35		R160	-66 115.63	3 030	100.84	
L161	-66 064.19	3 030	349.84		R161	-66 108.81	3 030	143.81	
L162	-66 040.62	3 030	378.01		R162	-66 100.66	3 030	183.20	
L163	-65 983.58	3 030	445.67		R163	-66 087.29	3 030	221.57	
L164	-65 949.62	3 030	471.71		R164	-66 068.69	3 030	277.68	
L165	-65 925.00	3 030	495.35		R165	-66 049.50	3 030	313.27	
L166	-65 884.99	3 030	513.03		R166	-66 011.65	3 030	363.51	
L167	-65 863.16	3 030	521.64		R167	-65 952.22	3 030	425.45	
L168	-65 833.08	3 030	530.17		R168	-65 925.48	3 030	447.93	
L169	-65 798.32	3 030	549.21		R169	-65 895.08	3 030	470.36	
L170	-65 773.08	3 030	556.20		R170	-65 821.75	3 030	500.90	
L171	-65 751.11	3 030	562.21		R171	-65 797.94	3 030	514.44	
L172	-65 707.94	3 030	570.07		R172	-65 790.36	3 030	518.65	
L173	-65 680.82	3 030	572.68		R173	-65 744.83	3 030	531.47	
L174	-65 622.15	3 030	574.45		R174	-65 704.61	3 030	538.85	
L175	-65 579.31	3 030	571.31		R175	-65 664.65	3 030	542.76	
L176	-65 539.67	3 030	562.79		R176	-65 623.69	3 030	542.95	
L177	-65 496.63	3 030	552.29		R177	-65 585.18	3 030	540.74	
L178	-65 477.91	3 030	549.49		R178	-65 547.36	3 030	532.18	
L179	-65 096.17	3 030	442.61		R179	-65 505.60	3 030	522.19	
L180	-64 925.69	3 030	392.94		R180	-65 475.17	3 030	515.20	
L181	-63 693.94	3 030	209.59		R181	-65 105.47	3 030	412.40	
L182	-63 067.88	3 030	118.92		R182	-65 015.54	3 030	387.02	
L183	-62 558.19	3 030	038.24		R183	-64 903.12	3 030	357.61	
L184	-62 439.76	3 030	019.48		R184	-63 671.68	3 030	174.44	
L185	-59 513.14	3 029	943.04		R185	-63 644.62	3 030	168.59	
L186	-59 479.21	3 029	946.21		R186	-63 350.80	3 030	125.08	
L187	-58 554.17	3 030	032.59		R187	-63 302.47	3 030	120.49	
L188	-58 502.92	3 030	041.50		R188	-62 470.05	3 029	992.31	
L189	-58 478.66	3 030	046.88		R189	-59 548.14	3 029	892.52	
L190	-58 442.93	3 030	054.81		R190	-59 521.49	3 029	896.37	
L191	-58 389.08	3 030	071.21		R191	-59 403.87	3 029	912.51	
L192	-58 335.86	3 030	089.92		R192	-58 603.50	3 029	987.81	
L193	-57 957.73	3 030	230.42		R193	-58 577.39	3 029	990.25	
L194	-57 924.50	3 030	240.77		R194	-58 543.87	3 029	992.91	
L195	-57 887.49	3 030	254.34		R195	-58 490.31	3 030	003.09	
L196	-57 721.27	3 030	315.29		R196	-58 432.68	3 030	016.11	
L197	-57 625.93	3 030	342.50		R197	-58 376.61	3 030	033.19	
L198	-57 556.82	3 030	356.99		R198	-58 322.17	3 030	052.35	
L199	-57 382.15	3 030	384.84		R199	-58 200.79	3 030	096.86	
L200	-57 176.63	3 030	416.07		R200	-58 164.53	3 030	110.15	
L201	-56 965.43	3 030	450.51		R201	-57 938.96	3 030	192.87	
L202	-56 823.34	3 030	479.45		R202	-57 736.84	3 030	266.98	
L203	-56 712.57	3 030	476.92		R203	-57 719.40	3 030	272.74	
L204	-56 663.20	3 030	476.82		R204	-57 665.97	3 030	290.40	
					<div> <div>Vel Sheet</div> <div>19</div> <div>Van of</div> <div>26</div> <div>P1175/19</div> </div>				

PADRESERWE KOÖRDINATE / ROAD RESERVE CO-ORDINATES									
LINKERKANT/LEFT HAND SIDE					REGTERKANT/RIGHT HAND SIDE				
	Y		X	WG 31°		Y		X	
L205	-56 557.83	3	030	451.79	R205	-57 609.69	3	030	305.44
L206	-56 429.34	3	030	400.87	R206	-57 551.33	3	030	317.35
L207	-56 331.95	3	030	367.32	R207	-57 374.81	3	030	345.58
L208	-56 277.59	3	030	361.97	R208	-57 159.81	3	030	380.52
L209	-55 824.16	3	030	330.25	R209	-57 068.13	3	030	391.00
L210	-55 186.96	3	030	292.12	R210	-56 995.84	3	030	404.34
L211	-55 114.76	3	030	282.24	R211	-56 888.96	3	030	426.24
L212	-55 069.76	3	030	275.51	R212	-56 833.32	3	030	413.47
L213	-55 017.58	3	030	263.67	R213	-56 768.76	3	030	419.94
L214	-54 953.42	3	030	228.40	R214	-56 714.27	3	030	428.16
L215	-54 902.78	3	030	207.50	R215	-56 583.83	3	030	408.69
L216	-54 835.86	3	030	173.18	R216	-56 395.78	3	030	336.50
L217	-54 785.49	3	030	108.85	R217	-56 291.79	3	030	316.84
L218	-54 594.02	3	029	910.79	R218	-56 267.71	3	030	315.66
L219	-54 338.64	3	029	646.38	R219	-56 203.39	3	030	312.52
L220	-54 310.61	3	029	620.93	R220	-56 124.67	3	030	308.79
L221	-54 266.90	3	029	589.26	R221	-55 827.47	3	030	294.70
L222	-54 217.79	3	029	557.52	R222	-55 195.76	3	030	257.29
L223	-54 160.46	3	029	531.01	R223	-55 122.64	3	030	250.68
L224	-54 126.45	3	029	515.51	R224	-55 078.96	3	030	237.92
L225	-53 989.60	3	029	483.19	R225	-55 021.53	3	030	220.78
L226	-53 982.77	3	029	475.81	R226	-54 920.21	3	030	168.74
L227	-53 850.85	3	029	441.64	R227	-54 890.07	3	030	145.37
L228	-53 703.02	3	029	399.74	R228	-54 847.48	3	030	115.54
L229	-53 270.63	3	029	269.15	R229	-54 621.36	3	029	885.59
L230	-53 214.38	3	029	251.90	R230	-54 476.93	3	029	735.73
L231	-53 157.31	3	029	230.19	R231	-54 376.62	3	029	632.28
L232	-53 100.53	3	029	202.28	R232	-54 331.56	3	029	593.82
L233	-53 054.89	3	029	176.42	R233	-54 284.31	3	029	559.23
L234	-52 751.70	3	029	002.48	R234	-54 172.47	3	029	498.07
L235	-52 652.44	3	028	943.05	R235	-54 127.38	3	029	480.99
L236	-52 460.27	3	028	836.11	R236	-53 613.15	3	029	326.50
L237	-52 392.56	3	028	793.62	R237	-53 572.33	3	029	318.97
L238	-52 317.38	3	028	756.71	R238	-53 514.80	3	029	300.43
L239	-52 283.61	3	028	735.05	R239	-53 387.09	3	029	266.58
L240	-52 237.48	3	028	693.70	R240	-53 281.32	3	029	236.33
L241	-52 193.91	3	028	650.78	R241	-53 226.67	3	029	218.93
L242	-52 140.34	3	028	580.43	R242	-53 172.38	3	029	194.26
L243	-52 119.14	3	028	529.42	R243	-53 159.76	3	029	185.39
L244	-52 104.84	3	028	495.01	R244	-53 116.97	3	029	171.77
L245	-52 068.51	3	028	354.29	R245	-52 976.97	3	029	097.01
L246	-52 062.02	3	028	317.30	R246	-52 866.86	3	029	027.64
L247	-52 032.55	3	028	271.84	R247	-52 669.44	3	028	913.18
L248	-51 997.99	3	028	239.03	R248	-52 579.42	3	028	859.86
L249	-51 944.11	3	028	184.66	R249	-52 477.82	3	028	804.48
L250	-51 872.24	3	028	141.20	R250	-52 409.81	3	028	763.38
L251	-51 818.86	3	028	110.96	R251	-52 358.87	3	028	735.20
L252	-51 435.98	3	027	906.94	R252	-52 310.69	3	028	701.59
L253	-51 151.16	3	027	749.91	R253	-52 265.87	3	028	665.60
L254	-51 023.76	3	027	679.67	R254	-52 223.26	3	028	619.80
L255	-50 958.13	3	027	638.60	R255	-52 179.73	3	028	561.39
Vel Sheet					20	Van of		26	P1175/19

PADRESERVE KOÖRDINATE / ROAD RESERVE CO-ORDINATES									
LINKERKANT/LEFT HAND SIDE					REGTERKANT/RIGHT HAND SIDE				
	Y	X	WG 31°			Y	X		
L256	-50 924.71	3 027 630.65			R256	-52 153.68	3 028 509.97		
L257	-50 813.76	3 027 603.73			R257	-52 143.94	3 028 485.77		
L258	-50 765.34	3 027 590.41			R258	-52 139.12	3 028 473.78		
L259	-50 702.18	3 027 573.04			R259	-52 101.78	3 028 343.29		
L260	-50 661.02	3 027 557.44			R260	-52 091.81	3 028 306.46		
L261	-50 619.91	3 027 544.94			R261	-52 065.79	3 028 252.32		
L262	-50 574.97	3 027 524.43			R262	-52 030.39	3 028 206.22		
L263	-50 363.84	3 027 342.11			R263	-51 939.06	3 028 136.94		
L264	-50 041.59	3 027 134.48			R264	-51 889.80	3 028 107.51		
L265	-49 937.91	3 027 068.44			R265	-51 837.97	3 028 079.63		
L266	-49 897.91	3 027 053.06			R266	-51 472.35	3 027 878.38		
L267	-49 866.41	3 027 033.83			R267	-51 173.73	3 027 714.80		
L268	-49 733.92	3 027 018.47			R268	-51 015.15	3 027 628.48		
L269	-49 672.17	3 027 012.35			R269	-50 970.38	3 027 606.47		
L270	-49 592.90	3 027 012.36			R270	-50 780.19	3 027 556.30		
L271	-49 487.07	3 026 997.31			R271	-50 742.84	3 027 546.44		
L272	-49 384.47	3 026 924.92			R272	-50 687.34	3 027 528.07		
L273	-49 277.62	3 026 809.77			R273	-50 636.37	3 027 501.80		
L274	-49 217.62	3 026 761.91			R274	-50 589.20	3 027 467.68		
L275	-49 176.78	3 026 739.84			R275	-50 496.01	3 027 381.92		
L276	-49 137.32	3 026 714.37			R276	-50 313.10	3 027 255.67		
L277	-49 063.33	3 026 685.97			R277	-50 263.73	3 027 225.80		
L278	-49 012.78	3 026 681.42			R278	-50 113.19	3 027 130.69		
L279	-48 924.85	3 026 668.65			R279	-50 021.47	3 027 066.56		
L280	-48 825.57	3 026 650.36			R280	-49 924.03	3 027 008.58		
L281	-48 770.69	3 026 626.26			R281	-49 898.59	3 026 996.32		
L282	-48 542.02	3 026 504.71			R282	-49 870.32	3 026 982.81		
L283	-48 477.61	3 026 471.40			R283	-49 756.03	3 026 964.42		
L284	-48 430.26	3 026 436.72			R284	-49 577.03	3 026 970.88		
L285	-48 388.34	3 026 415.05			R285	-49 526.80	3 026 957.93		
L286	-48 337.58	3 026 360.31			R286	-49 485.17	3 026 936.55		
L287	-48 239.18	3 026 247.52			R287	-49 427.57	3 026 897.59		
L288	-48 182.03	3 026 181.80			R288	-49 305.05	3 026 772.65		
L289	-48 164.76	3 026 153.67			R289	-49 220.24	3 026 711.50		
L290	-48 140.05	3 026 121.58			R290	-49 104.32	3 026 651.33		
L291	-48 117.76	3 026 067.67			R291	-49 048.65	3 026 643.17		
L292	-48 099.19	3 026 033.03			R292	-48 990.94	3 026 635.03		
L293	-48 082.17	3 025 976.60			R293	-48 875.31	3 026 612.17		
L294	-48 048.36	3 025 947.20			R294	-48 821.85	3 026 589.66		
L295	-47 992.94	3 025 921.24			R295	-48 609.06	3 026 494.61		
L296	-47 929.61	3 025 889.94			R296	-48 558.23	3 026 467.80		
L297	-47 833.80	3 025 839.93			R297	-48 505.25	3 026 440.14		
L298	-47 673.11	3 025 819.82			R298	-48 451.01	3 026 406.51		
L299	-47 649.27	3 025 816.17			R299	-48 411.38	3 026 372.84		
L300	-47 514.18	3 025 806.59			R300	-48 376.49	3 026 328.94		
L301	-47 444.69	3 025 797.77			R301	-48 279.32	3 026 221.44		
L302	-47 380.88	3 025 777.12			R302	-48 220.17	3 026 154.71		
L303	-47 277.76	3 025 740.35			R303	-48 202.67	3 026 126.98		
L304	-47 228.58	3 025 717.06			R304	-48 190.49	3 026 107.51		
L305	-47 184.58	3 025 706.87			R305	-48 142.21	3 025 997.95		
L306	-47 074.91	3 025 721.90			R306	-48 107.97	3 025 950.54		
					<div> <div>Vel Sheet</div> <div>21</div> <div>Van of</div> <div>26</div> <div>P1175/19</div> </div>				

PADRESERWE KOÖRDINATE / ROAD RESERVE CO-ORDINATES					
LINKERKANT/LEFT HAND SIDE			REGTERKANT/RIGHT HAND SIDE		
	Y	X	WG 31°	Y	X
L307	-47 013.87	3 025 748.64		R307	-48 067.88 3 025 914.92
L308	-46 882.26	3 025 774.47		R308	-48 013.30 3 025 886.44
L309	-46 832.91	3 025 768.53		R309	-47 849.78 3 025 807.05
L310	-46 771.47	3 025 772.44		R310	-47 818.45 3 025 794.09
L311	-46 657.77	3 025 760.39		R311	-47 760.43 3 025 771.57
L312	-46 587.26	3 025 742.19		R312	-47 691.68 3 025 768.18
L313	-46 460.68	3 025 683.96		R313	-47 659.52 3 025 766.60
L314	-46 276.28	3 025 563.81		R314	-47 450.87 3 025 766.66
L315	-46 212.46	3 025 542.66		R315	-47 238.82 3 025 675.49
L316	-46 202.37	3 025 547.21		R316	-47 186.99 3 025 663.82
L317	-46 168.31	3 025 523.43		R317	-47 066.46 3 025 685.48
L318	-46 033.47	3 025 421.17		R318	-47 009.61 3 025 699.31
L319	-45 960.08	3 025 378.43		R319	-46 915.23 3 025 717.67
L320	-45 860.98	3 025 308.56		R320	-46 838.96 3 025 735.37
L321	-45 774.02	3 025 202.13		R321	-46 793.40 3 025 729.17
L322	-45 749.57	3 025 170.44		R322	-46 703.66 3 025 723.05
L323	-45 715.57	3 025 107.80		R323	-46 661.16 3 025 719.73
L324	-45 673.44	3 025 056.01		R324	-46 561.95 3 025 684.74
L325	-45 657.35	3 025 000.98		R325	-46 488.82 3 025 644.21
L326	-45 620.77	3 024 936.72		R326	-46 209.30 3 025 479.03
L327	-45 596.32	3 024 893.34		R327	-46 036.31 3 025 376.03
L328	-45 553.46	3 024 842.04		R328	-45 987.45 3 025 345.92
L329	-45 470.42	3 024 760.31		R329	-45 873.16 3 025 260.90
L330	-45 388.00	3 024 692.77		R330	-45 821.80 3 025 205.35
L331	-45 349.13	3 024 686.83		R331	-45 765.42 3 025 097.38
L332	-45 317.38	3 024 643.73		R332	-45 732.95 3 025 055.92
L333	-45 248.49	3 024 587.08		R333	-45 676.22 3 024 953.29
L334	-45 201.03	3 024 546.58		R334	-45 615.71 3 024 853.30
L335	-45 111.58	3 024 478.28		R335	-45 590.14 3 024 819.78
L336	-45 009.53	3 024 397.59		R336	-45 568.02 3 024 786.56
L337	-44 962.89	3 024 355.11		R337	-45 542.60 3 024 757.37
L338	-44 909.26	3 024 296.74		R338	-45 498.36 3 024 723.07
L339	-44 875.70	3 024 260.00		R339	-45 452.12 3 024 687.60
L340	-44 850.33	3 024 198.70		R340	-45 406.41 3 024 652.23
L341	-44 794.30	3 024 054.52		R341	-45 275.42 3 024 551.11
L342	-44 780.81	3 024 017.82		R342	-45 222.95 3 024 505.55
L343	-44 744.33	3 023 939.05		R343	-45 036.93 3 024 366.08
L344	-44 744.75	3 023 932.00		R344	-44 993.69 3 024 327.01
L345	-44 738.51	3 023 917.14		R345	-44 954.05 3 024 283.89
L346	-44 713.25	3 023 857.18		R346	-44 924.31 3 024 240.99
L347	-44 701.73	3 023 834.19		R347	-44 890.02 3 024 187.90
L348	-44 659.33	3 023 720.30		R348	-44 865.96 3 024 135.87
L349	-44 641.57	3 023 681.19		R349	-44 845.58 3 024 082.56
L350	-44 618.02	3 023 640.05		R350	-44 779.57 3 023 917.59
L351	-44 554.97	3 023 573.64		R351	-44 758.70 3 023 862.71
L352	-44 469.43	3 023 516.68		R352	-44 717.85 3 023 758.86
L353	-44 389.59	3 023 478.90		R353	-44 695.69 3 023 703.76
L354	-44 314.91	3 023 471.80		R354	-44 667.51 3 023 648.17
L355	-44 253.93	3 023 487.56		R355	-44 635.43 3 023 598.84
L356	-44 217.51	3 023 495.91		R356	-44 573.96 3 023 531.55
L357	-44 169.50	3 023 514.01		R357	-44 504.13 3 023 486.27
			Vel Sheet	22 Van of 26	P1175/19

PADRESERVE KOÖRDINATE / ROAD RESERVE CO-ORDINATES									
LINKERKANT/LEFT HAND SIDE					REGTERKANT/RIGHT HAND SIDE				
	Y		X	WG 31°		Y		X	
L358	-44 111.14	3	023	554.79	R358	-44 358.32	3	023	433.02
L359	-44 039.89	3	023	606.40	R359	-44 306.71	3	023	433.11
L360	-43 967.52	3	023	652.54	R360	-44 221.90	3	023	447.54
L361	-43 929.79	3	023	666.98	R361	-44 196.77	3	023	455.20
L362	-43 922.65	3	023	685.96	R362	-44 166.01	3	023	472.21
L363	-43 861.40	3	023	700.70	R363	-44 099.70	3	023	512.31
L364	-43 766.58	3	023	759.31	R364	-43 985.57	3	023	594.56
L365	-43 620.77	3	023	841.97	R365	-43 924.26	3	023	630.74
L366	-43 571.67	3	023	863.57	R366	-43 766.20	3	023	716.37
L367	-43 540.41	3	023	884.59	R367	-43 611.93	3	023	803.65
L368	-43 465.59	3	023	913.17	R368	-43 561.34	3	023	820.09
L369	-43 321.37	3	023	950.84	R369	-43 509.44	3	023	846.95
L370	-43 259.67	3	023	941.75	R370	-43 467.81	3	023	871.01
L371	-43 201.96	3	023	930.98	R371	-43 408.14	3	023	884.21
L372	-43 040.90	3	023	872.63	R372	-43 312.31	3	023	897.37
L373	-42 994.26	3	023	862.64	R373	-43 261.15	3	023	886.96
L374	-42 907.91	3	023	853.35	R374	-43 174.63	3	023	880.49
L375	-42 818.45	3	023	875.38	R375	-43 050.42	3	023	839.02
L376	-42 658.34	3	023	889.22	R376	-42 968.62	3	023	825.70
L377	-42 599.19	3	023	894.48	R377	-42 891.77	3	023	824.63
L378	-42 539.57	3	023	899.18	R378	-42 655.72	3	023	850.58
L379	-42 479.97	3	023	901.60	R379	-42 593.60	3	023	857.89
L380	-42 351.42	3	023	891.64	R380	-42 539.29	3	023	859.90
L381	-42 282.74	3	023	879.78	R381	-42 481.74	3	023	862.34
L382	-42 234.29	3	023	867.62	R382	-42 421.49	3	023	859.76
L383	-42 149.14	3	023	839.75	R383	-42 351.66	3	023	853.97
L384	-42 062.13	3	023	800.31	R384	-42 300.91	3	023	843.45
L385	-42 021.64	3	023	784.84	R385	-42 251.01	3	023	833.02
L386	-41 922.79	3	023	723.77	R386	-42 148.23	3	023	798.46
L387	-41 858.61	3	023	690.61	R387	-42 093.40	3	023	773.42
L388	-41 710.64	3	023	530.95	R388	-42 042.36	3	023	745.31
L389	-41 533.62	3	023	373.64	R389	-41 965.53	3	023	695.42
L390	-41 447.39	3	023	294.89	R390	-41 923.16	3	023	665.81
L391	-41 317.17	3	023	182.72	R391	-41 737.99	3	023	502.58
L392	-41 184.27	3	023	066.65	R392	-41 561.24	3	023	345.48
L393	-41 061.46	3	022	949.77	R393	-41 454.33	3	023	249.61
L394	-41 040.84	3	022	920.99	R394	-41 346.95	3	023	154.54
L395	-40 922.41	3	022	793.52	R395	-41 148.16	3	022	974.98
L396	-40 656.63	3	022	515.02	R396	-41 059.06	3	022	886.77
L397	-40 577.71	3	022	433.28	R397	-40 821.77	3	022	634.61
L398	-40 515.19	3	022	376.66	R398	-40 594.08	3	022	392.45
L399	-40 469.10	3	022	346.49	R399	-40 539.55	3	022	342.86
L400	-40 356.38	3	022	264.79	R400	-40 485.18	3	022	298.93
L401	-40 330.02	3	022	241.67	R401	-40 358.26	3	022	216.11
L402	-40 073.85	3	022	093.82	R402	-40 091.97	3	022	058.22
L403	-39 816.68	3	021	941.36	R403	-39 753.25	3	021	857.09
L404	-39 657.79	3	021	857.02	R404	-39 556.74	3	021	740.16
L405	-39 588.32	3	021	799.13	R405	-39 420.16	3	021	662.97
L406	-39 526.81	3	021	764.10	R406	-39 387.72	3	021	655.07
L407	-39 432.98	3	021	709.73	R407	-39 347.28	3	021	633.74
L408	-39 342.94	3	021	669.54	R408	-39 197.99	3	021	576.45
					<div> <div>Vel</div> <div>23</div> <div>Van</div> <div>of</div> <div>26</div> </div> <div>P1175/19</div>				

PADRESERWE KOÖRDINATE / ROAD RESERVE CO-ORDINATES					
LINKERKANT/LEFT HAND SIDE			REGTERKANT/RIGHT HAND SIDE		
	Y	X	WG 31°	Y	X
L409	-39 281.55	3 021 647.20		R409	-39 137.69 3 021 570.18
L410	-39 235.07	3 021 630.76		R410	-39 022.41 3 021 537.62
L411	-39 007.74	3 021 591.83		R411	-38 973.97 3 021 539.16
L412	-38 905.83	3 021 570.72		R412	-38 873.36 3 021 522.88
L413	-38 693.88	3 021 528.14		R413	-38 708.14 3 021 489.22
L414	-38 587.63	3 021 496.14		R414	-38 538.77 3 021 441.03
L415	-38 511.27	3 021 478.57		R415	-38 382.69 3 021 361.72
L416	-38 470.43	3 021 456.35		R416	-38 284.82 3 021 292.43
L417	-38 445.02	3 021 445.26		R417	-38 163.23 3 021 202.79
L418	-38 360.97	3 021 409.34		R418	-38 070.65 3 021 137.82
L419	-38 261.05	3 021 321.79		R419	-38 013.32 3 021 102.44
L420	-38 133.48	3 021 238.57		R420	-37 943.25 3 021 077.07
L421	-38 058.70	3 021 179.46		R421	-37 922.67 3 021 072.41
L422	-38 018.36	3 021 157.37		R422	-37 850.80 3 021 060.31
L423	-37 970.78	3 021 136.77		R423	-37 773.13 3 021 052.50
L424	-37 879.77	3 021 117.28		R424	-37 719.73 3 021 051.95
L425	-37 794.01	3 021 093.29		R425	-37 537.34 3 021 068.89
L426	-37 723.19	3 021 094.13		R426	-37 444.14 3 021 068.17
L427	-37 680.09	3 021 095.82		R427	-37 272.12 3 021 052.05
L428	-37 442.10	3 021 107.82		R428	-37 187.84 3 021 026.39
L429	-37 387.64	3 021 109.35		R429	-36 898.82 3 020 912.10
L430	-37 276.68	3 021 094.99		R430	-36 843.71 3 020 888.22
L431	-37 149.37	3 021 053.16		R431	-36 750.41 3 020 832.86
L432	-37 024.05	3 021 019.29		R432	-36 694.71 3 020 793.19
L433	-36 989.11	3 021 011.27		R433	-36 602.12 3 020 715.66
L434	-36 875.57	3 020 944.56		R434	-36 494.77 3 020 610.71
L435	-36 725.57	3 020 866.54		R435	-36 432.55 3 020 555.65
L436	-36 694.30	3 020 848.27		R436	-36 159.11 3 020 380.05
L437	-36 661.37	3 020 828.66		R437	-36 005.71 3 020 299.59
L438	-36 612.94	3 020 784.94		R438	-35 947.09 3 020 275.00
L439	-36 553.78	3 020 733.38		R439	-35 892.24 3 020 253.77
L440	-36 419.23	3 020 597.13		R440	-35 783.20 3 020 227.42
L441	-36 257.88	3 020 507.99		R441	-35 674.72 3 020 229.68
L442	-36 171.89	3 020 448.16		R442	-35 495.90 3 020 239.71
L443	-36 074.45	3 020 395.83		R443	-35 397.72 3 020 242.45
L444	-35 943.62	3 020 327.25		R444	-35 259.65 3 020 186.39
L445	-35 874.07	3 020 298.08		R445	-35 203.42 3 020 123.23
L446	-35 820.75	3 020 273.67		R446	-35 155.76 3 020 083.19
L447	-35 781.34	3 020 264.83		R447	-35 121.14 3 019 998.98
L448	-35 759.22	3 020 261.84		R448	-35 065.20 3 019 833.77
L449	-35 702.89	3 020 263.96		R449	-35 037.55 3 019 781.56
L450	-35 480.88	3 020 281.76		R450	-34 961.19 3 019 692.87
L451	-35 388.68	3 020 278.85		R451	-34 915.33 3 019 662.75
L452	-35 302.86	3 020 246.66		R452	-34 873.81 3 019 611.89
L453	-35 219.44	3 020 199.66		R453	-34 826.74 3 019 502.49
L454	-35 140.15	3 020 133.01		R454	-34 815.40 3 019 458.20
L455	-35 104.20	3 020 070.97		R455	-34 831.62 3 019 249.13
L456	-35 054.03	3 019 905.69		R456	-34 832.07 3 019 156.35
L457	-34 997.60	3 019 798.19		R457	-34 825.01 3 019 096.25
L458	-34 900.44	3 019 708.22		R458	-34 805.66 3 019 041.55
L459	-34 809.90	3 019 596.97		R459	-34 779.37 3 018 989.81
			Vel Sheet	24 Van of 26	P1175/19

PADRESERVE KOÖRDINATE / ROAD RESERVE CO-ORDINATES									
LINKERKANT/LEFT HAND SIDE					REGTERKANT/RIGHT HAND SIDE				
	Y		X	WG 31°		Y		X	
L460	-34 779.38	3 019	450.75		R460	-34 752.12	3 018	950.55	
L461	-34 794.59	3 019	244.97		R461	-34 639.72	3 018	808.96	
L462	-34 798.05	3 019	207.21		R462	-34 612.08	3 018	772.01	
L463	-34 798.08	3 019	184.42		R463	-34 583.93	3 018	694.23	
L464	-34 784.34	3 019	101.91		R464	-34 569.46	3 018	663.56	
L465	-34 766.49	3 019	044.47		R465	-34 528.30	3 018	576.27	
L466	-34 582.25	3 018	795.14		R466	-34 521.27	3 018	470.70	
L467	-34 537.87	3 018	727.27		R467	-34 504.24	3 018	393.89	
L468	-34 529.12	3 018	713.89		R468	-34 470.68	3 018	313.73	
L469	-34 497.84	3 018	620.83		R469	-34 413.34	3 018	238.75	
L470	-34 482.79	3 018	491.34		R470	-34 341.36	3 018	178.32	
L471	-34 463.46	3 018	393.35		R471	-34 294.40	3 018	151.99	
L472	-34 451.40	3 018	361.58		R472	-34 256.07	3 018	135.93	
L473	-34 435.69	3 018	331.50		R473	-34 203.26	3 018	117.17	
L474	-34 395.29	3 018	271.76		R474	-33 857.79	3 018	003.36	
L475	-34 336.91	3 018	221.92		R475	-33 731.23	3 017	962.55	
L476	-34 243.82	3 018	174.58		R476	-33 568.82	3 017	883.83	
L477	-34 038.63	3 018	105.93		R477	-33 457.89	3 017	802.90	
L478	-33 842.38	3 018	034.43		R478	-33 376.84	3 017	730.83	
L479	-33 723.04	3 017	993.31		R479	-33 297.60	3 017	652.80	
L480	-33 621.70	3 017	950.18		R480	-33 202.38	3 017	573.87	
L481	-33 525.86	3 017	897.13		R481	-33 145.57	3 017	527.64	
L482	-33 434.37	3 017	832.49		R482	-33 091.33	3 017	507.86	
L483	-33 352.02	3 017	758.85		R483	-33 021.99	3 017	455.11	
L484	-33 202.95	3 017	621.19		R484	-32 472.67	3 017	142.51	
L485	-33 119.83	3 017	569.76		R485	-32 371.74	3 017	090.60	
L486	-33 088.27	3 017	550.39		R486	-32 249.02	3 017	054.04	
L487	-33 025.02	3 017	512.22		R487	-32 119.72	3 017	023.96	
L488	-32 737.56	3 017	349.10		R488	-32 015.23	3 016	994.34	
L489	-32 691.48	3 017	326.11		R489	-31 915.51	3 016	954.22	
L490	-32 650.65	3 017	290.40		R490	-31 819.67	3 016	903.17	
L491	-32 572.80	3 017	244.97		R491	-31 729.82	3 016	842.23	
L492	-32 453.95	3 017	175.05		R492	-31 437.59	3 016	628.77	
L493	-32 361.24	3 017	128.54		R493	-31 426.19	3 016	620.43	
L494	-32 308.27	3 017	109.04		R494	-31 164.09	3 016	438.66	
L495	-32 240.67	3 017	090.47		R495	-31 062.00	3 016	395.81	
L496	-32 112.56	3 017	060.87		R496	-30 953.42	3 016	371.98	
L497	-32 002.38	3 017	029.71		R497	-30 861.36	3 016	366.76	
L498	-31 899.20	3 016	988.19		R498	-30 840.76	3 016	367.19	
L499	-31 800.99	3 016	935.76		R499	-30 563.82	3 016	388.87	
L500	-31 709.68	3 016	874.22		R500	-30 267.30	3 016	412.07	
L501	-31 415.71	3 016	659.57		R501	-30 210.30	3 016	414.45	
L502	-31 411.87	3 016	656.76		R502	-30 195.39	3 016	415.08	
L503	-31 237.50	3 016	529.14		R503	-30 125.81	3 016	412.06	
L504	-31 148.41	3 016	472.82		R504	-30 054.00	3 016	402.82	
L505	-31 050.87	3 016	431.81		R505	-29 987.67	3 016	388.56	
L506	-30 946.46	3 016	408.93		R506	-29 871.43	3 016	357.55	
L507	-30 869.93	3 016	403.94		R507	-29 806.80	3 016	340.32	
L508	-30 844.20	3 016	404.36		R508	-29 743.05	3 016	323.65	
L509	-30 662.60	3 016	418.62		R509	-28 356.93	3 015	956.19	
L510	-30 535.38	3 016	428.58		R510	-27 518.93	3 015	734.36	
					<div> <div>Vel</div> <div>Sheet</div> </div> <div>25</div> <div>Van</div> <div>of</div> <div>26</div> <div>P1175/19</div>				

This gazette is also available free online at www.gpwonline.co.za