

---

**GOVERNMENT NOTICES • GOEWERMENTSKENNISGEWINGS**

---

**DEPARTMENT OF TRANSPORT**

NO. 5678

13 December 2024

**THE SOUTH AFRICAN NATIONAL ROADS  
AGENCY SOC LIMITED**Registration No: 1998/009584/30

---

**DECLARATION AMENDMENT OF NATIONAL ROAD R48 SECTION 3**

AMENDMENT OF DECLARATION No. 2670 OF 2022.

By virtue of section 40(1)(b) of the South African National Roads Agency Limited and the National Roads Act 1998 (Act No. 7 of 1998), I hereby amend Declaration No. 2670 of 2022 by substituting paragraph M of the Schedule, being the descriptive declaration of the route from Philipstown up to Petrusville, with the accompanying sheets 1 to 10 of Plan No. P1247/24 and by changing the route's number from National Road R48 Section 1 to National Road R48 Section 3.

The R48 Section 3 starts at the intersection with the street known as Church Street, at time of declaration, from there it proceeds along the street known as Green Street, at time of declaration, in the town of Philipstown.

The R48 Section 3 enters the town of Petrusville from the south and follows the street known as Commissie Street, at time of declaration up to the interaction with the street known as Visagie Street, at time of declaration.

**(National Road R48 Section 3: Philipstown – Petrusville)**  
**MINISTER OF TRANSPORT**

## DEPARTEMENT VAN VERVOER

NO. 5678

13 Desember 2024

**DIE SUID-AFRIKAANSE NASIONALE  
PADAGENTSKAP MSB BEPERK**

Registrasie No: 1998/009584/30

**VERKLARING WYSIGING VAN NASIONALE PAD R48 SEKSIE 3**

WYSIGING VAN VERKLARING No. 2670 VAN 2022.

Kragtens Artikel 40(1)(b) van die Suid-Afrikaanse Nasionale Padagentskap Beperk en Nasionale Paaie Wet 1998 (Wet No. 7 van 1998), wysig ek hiermee Verklaring No. 2670 van 2022 deur paragraaf M van die Skedule te vervang, synde die gedeelte van die beskrywende verklaring van die pad vanaf Philipstown tot by Petrusville, met bygaande velle 1 tot 10 van Plan No. P1247/24 en deur die roete nommer te verander vanaf Nasionale Pad R48 Seksie 1 na Nasionale Pad R48 Seksie 3.

Die R48 Seksie 3 begin by die interseksie met die straat bekend as Kerkstraat, tydens datum van verklaring, daarvandaan volg dit die straat bekend as Groenstraat, tydens datum van verklaring in die dorp van Philipstown.

Die R48 Seksie 3 kom die dorp van Petrusville binne vanuit die suide langs die straat bekend as Commissiestraat, tydens datum van verklaring tot by die interseksie met die straat bekend as Visagiestraat, tydens datum van verklaring.

**(Nasionale Pad R48 Seksie 3: Philipstown – Petrusville)**  
**MINISTER VAN VERVOER**

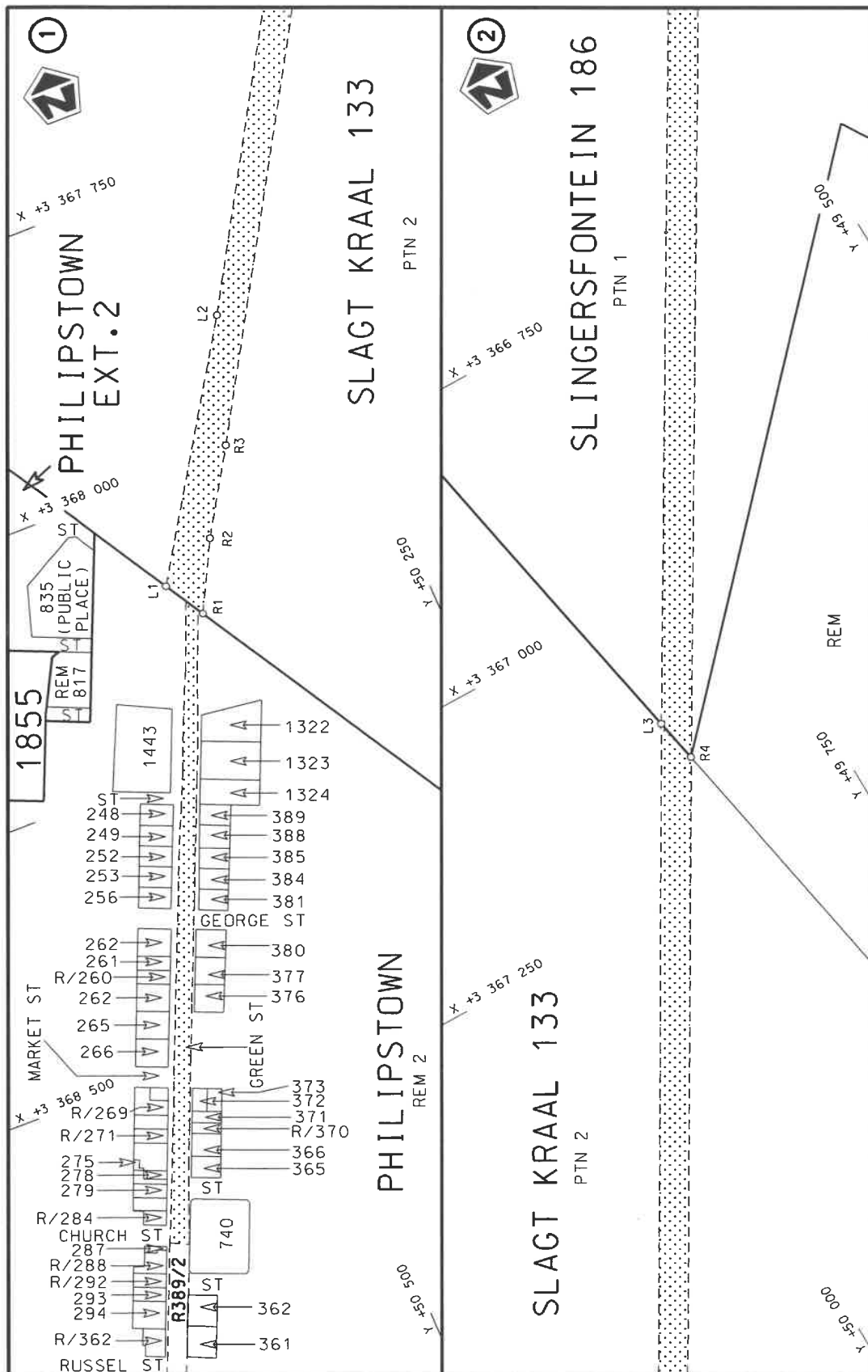

Die Suid Afrikaanse Nasionale Padagentskap MSB Bpk The South African National Roads Agency SOC Ltd	Die figuur getoon The figure shown		steldie padreserwe voor van 'n gedeelte represents the road reserve of a portion van Nasionale Roete R48 of National Route Section	Val Sheet 1 of 10 Plan P1247/24
---	---------------------------------------	--	---	---------------------------------------

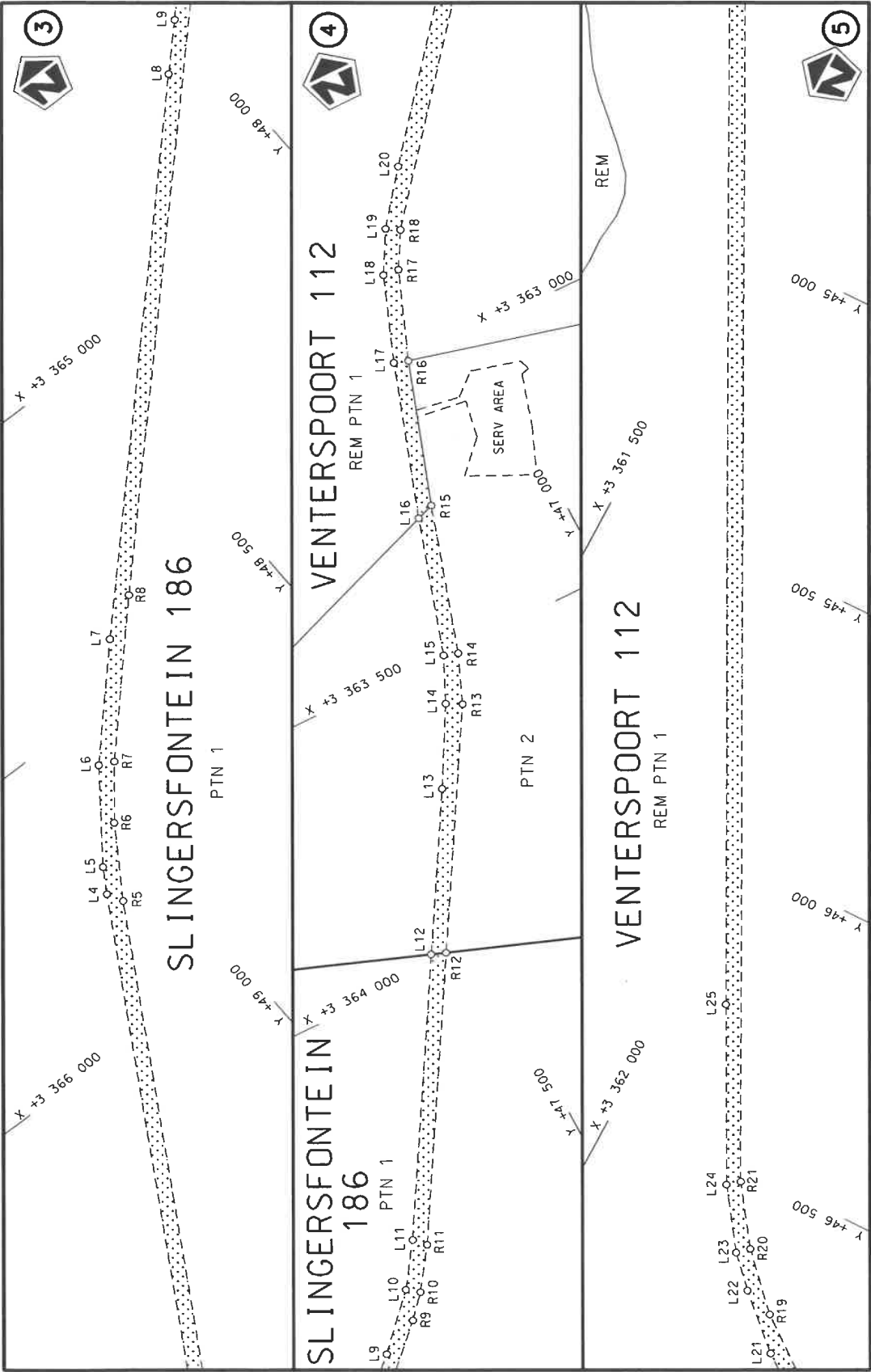

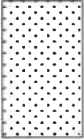
Die Suid Afrikaanse Nasionale Podogentskap MSB Bpk The South African National Roads Agency SOC Ltd	Die figuur getoon The figure shown		steldie padreserwe voor van 'n gedeelte represents the road reserve of a portion van Nasionale Roete R48 of National Route	Vel Sheet	2 of	10
				Plan	P1247/24	

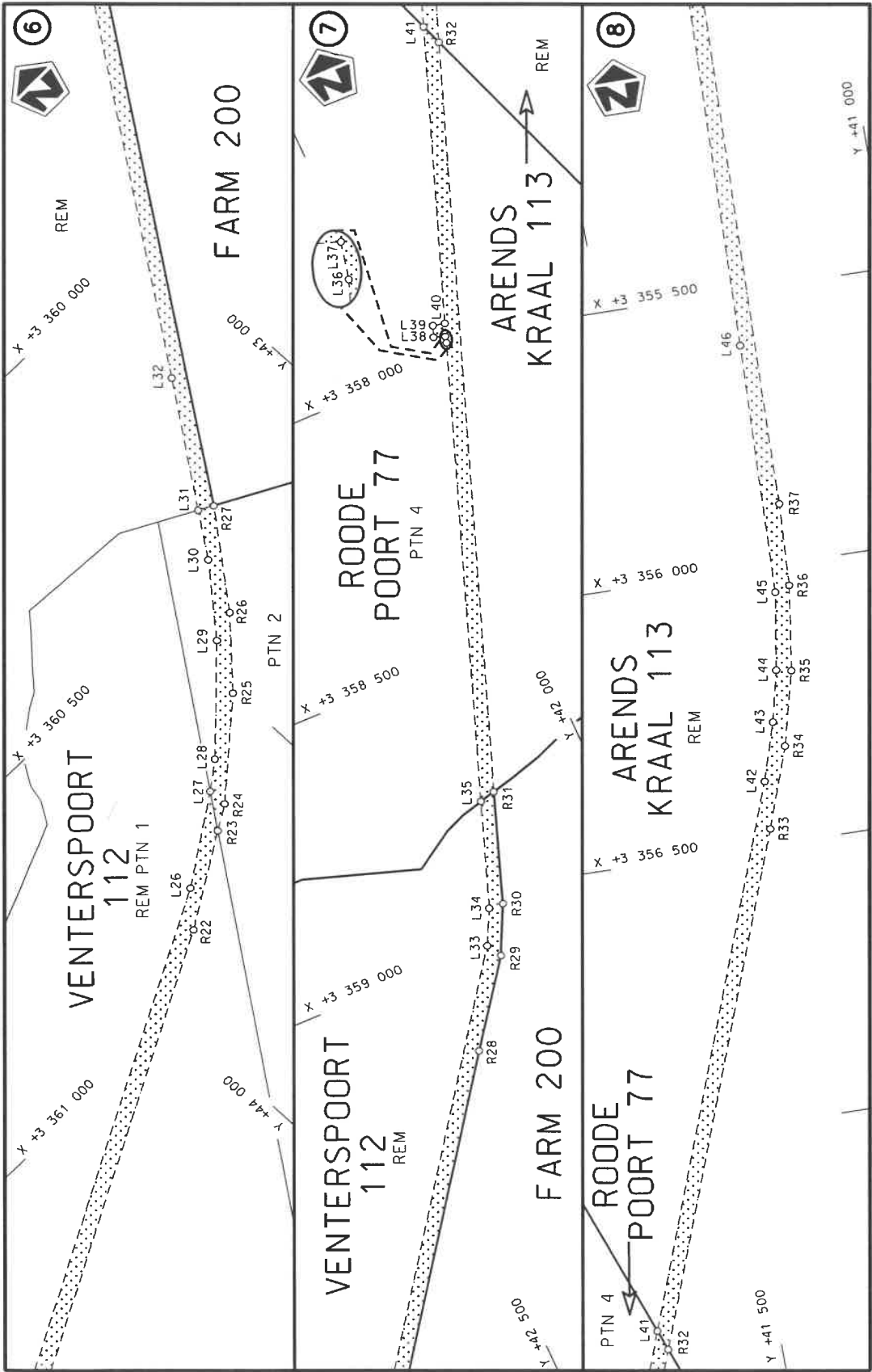

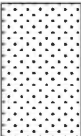
Die Suid Afrikaanse Nasionale Padagentskap MSB Bpk The South African National Roads Agency SOC Ltd	Die figuur getoon The figure shown		stel die padreserwe voor van 'n gedeelte represents the road reserve of a portion van Nasionale Roete R48 of National Route	Vel Sheet	3	van of	10
				Plan	P1247/24	Seksie Section	

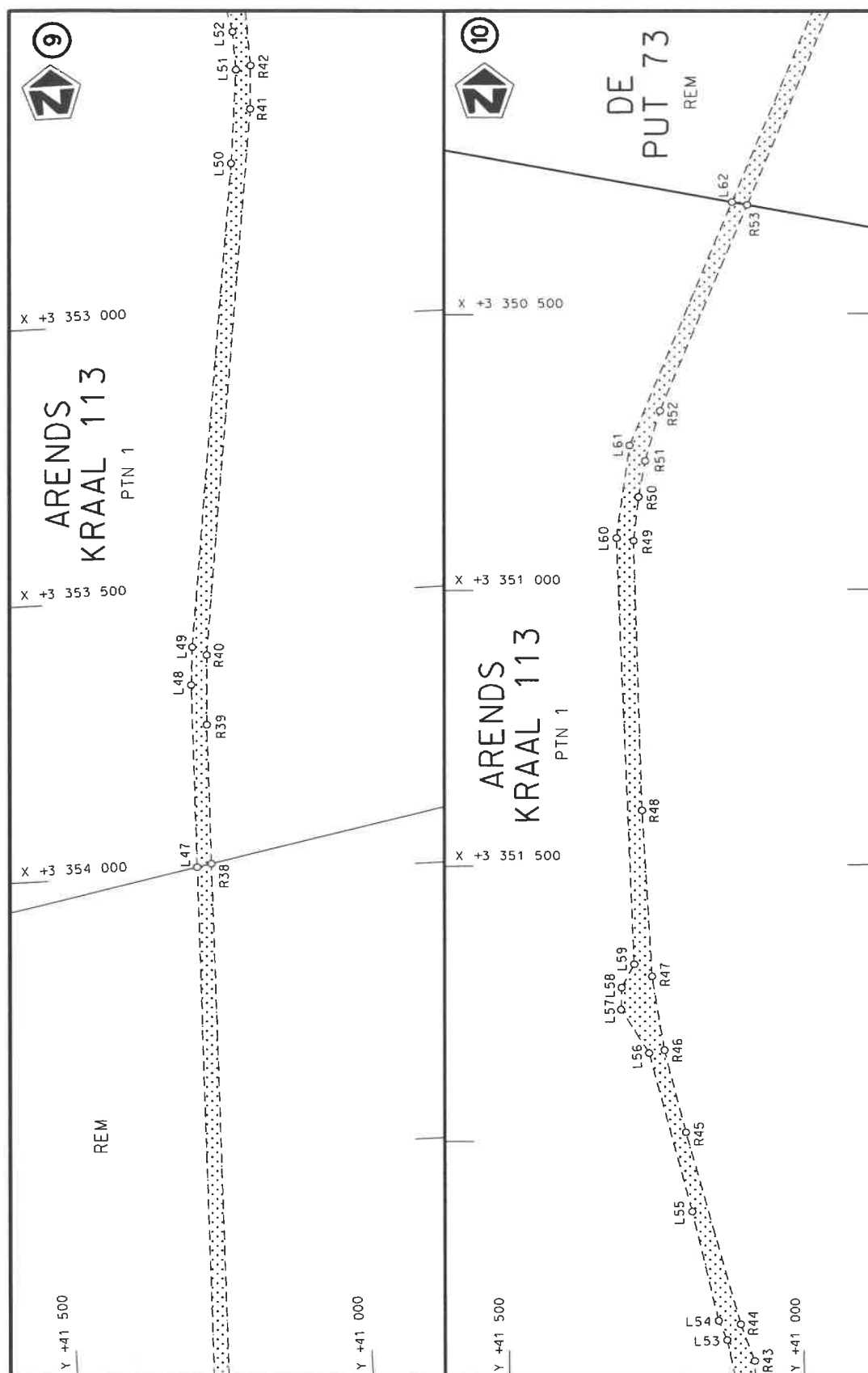

Die Suid Afrikaanse Nasionale Padagentskap MSB Bpk	Die figuur getoon		stel die padreserwe voor van 'n gedeelte represents the road reserve of a portion van Nasionale Roete R48 of National Route	3	Vel Sheet	4 of	10
The South African National Roads Agency SOC Ltd	The figure shown				Plan	P1247/24	

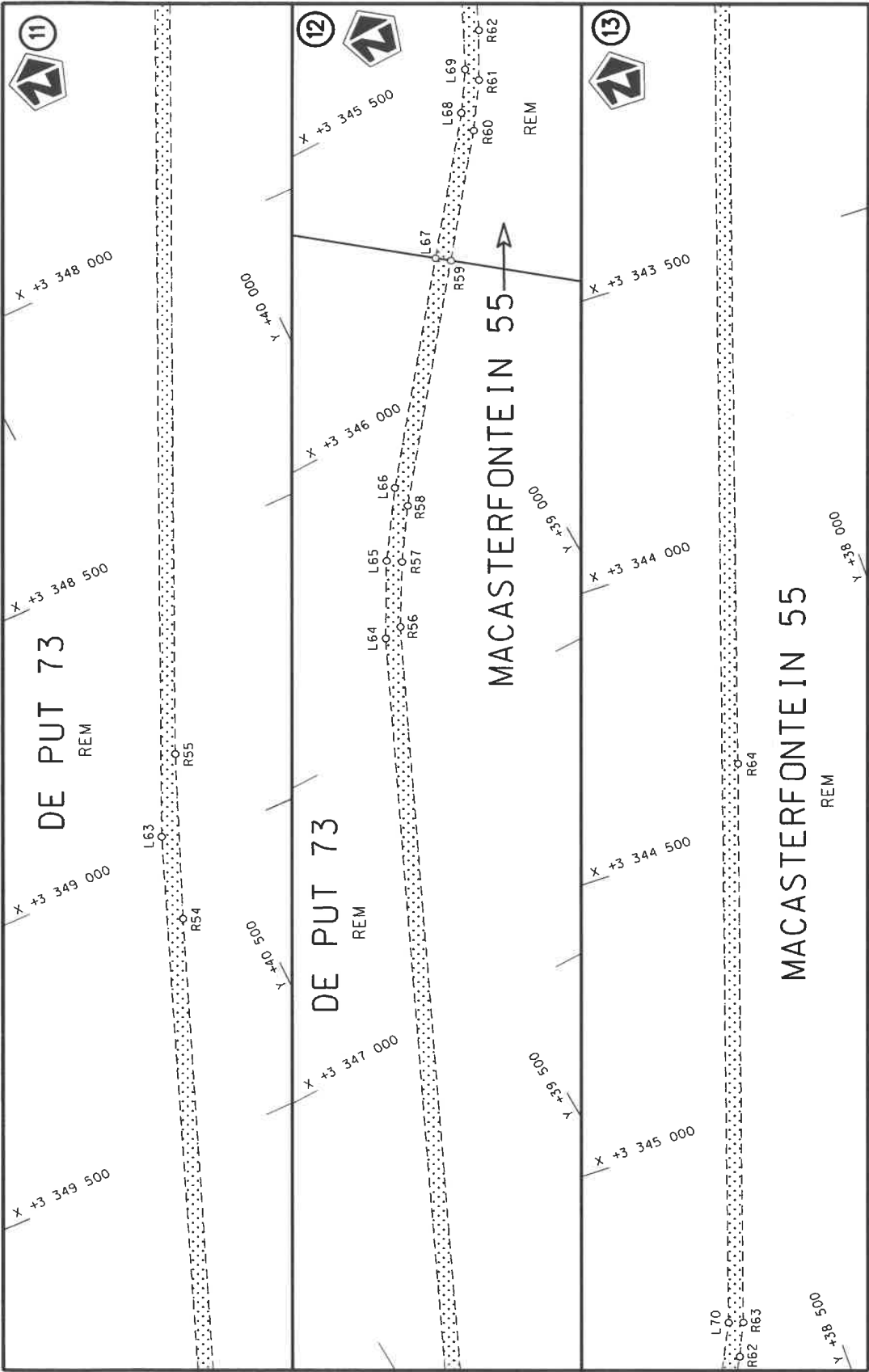

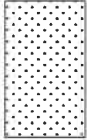
Die Suid Afrikaanse Nasionale Padagentskap MSB Bpk The South African National Roads Agency SOC Ltd	Die figuur getoon The figure shown		stel die padreserwe voor van 'n gedeelte represents the road reserve of a portion van Nasionale Roete R48 of National Route	Vel Sheet	5 of	10
				Plan	P1247/24	

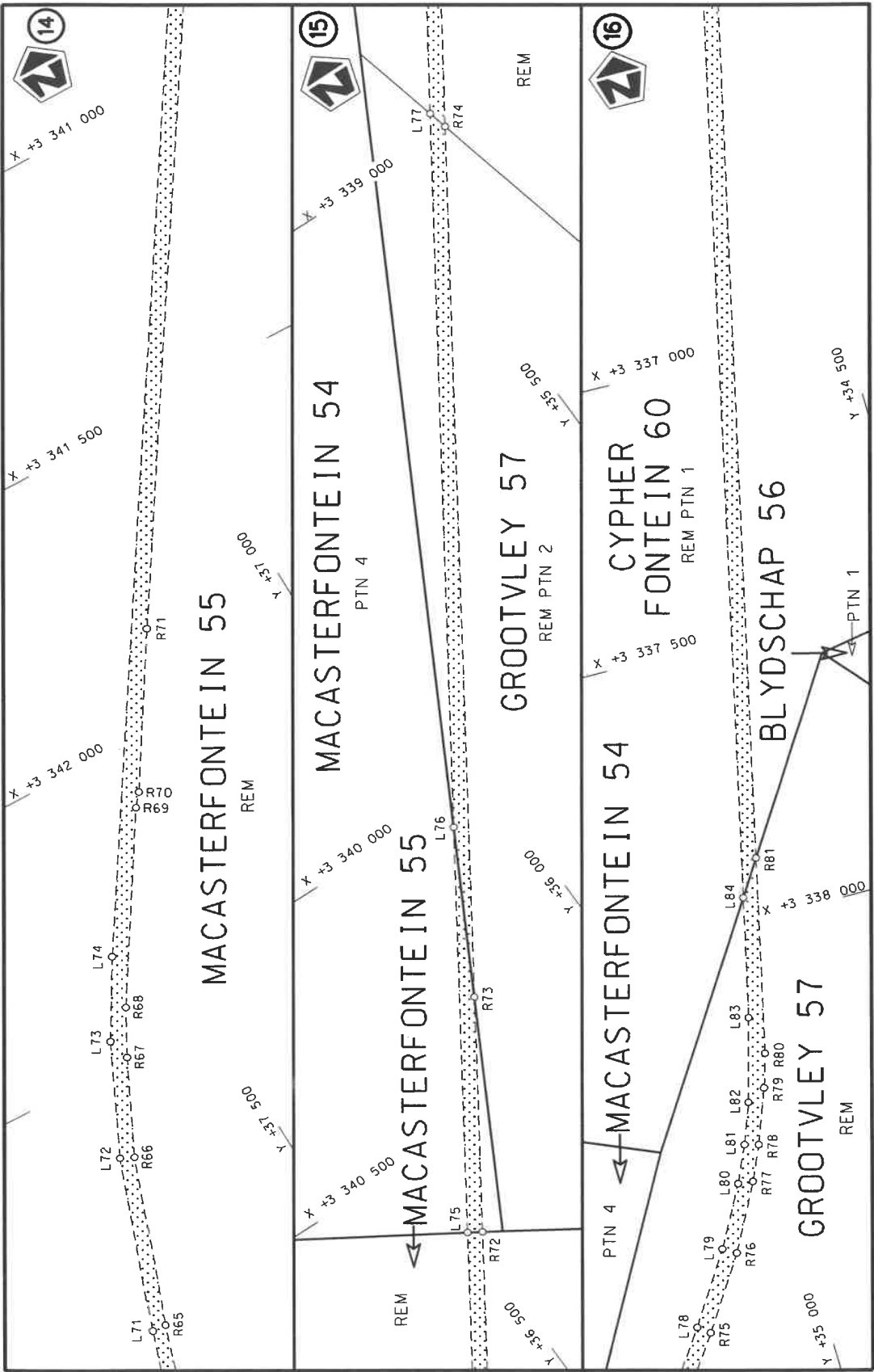

Die Suid Afrikaanse Nasionale Padagentskap WSB Bpk The South African National Roads Agency SOC Ltd	Die figuur getoon The figure shown	stel die padreserwe voor van 'n gedeelte represents the road reserve of a portion van Nasionale Roete of National Route	R48 Seksie Section	3	Vel Sheet 6 of 10	Plan P1247/24
---	---------------------------------------	--	--------------------------	---	-------------------------	------------------



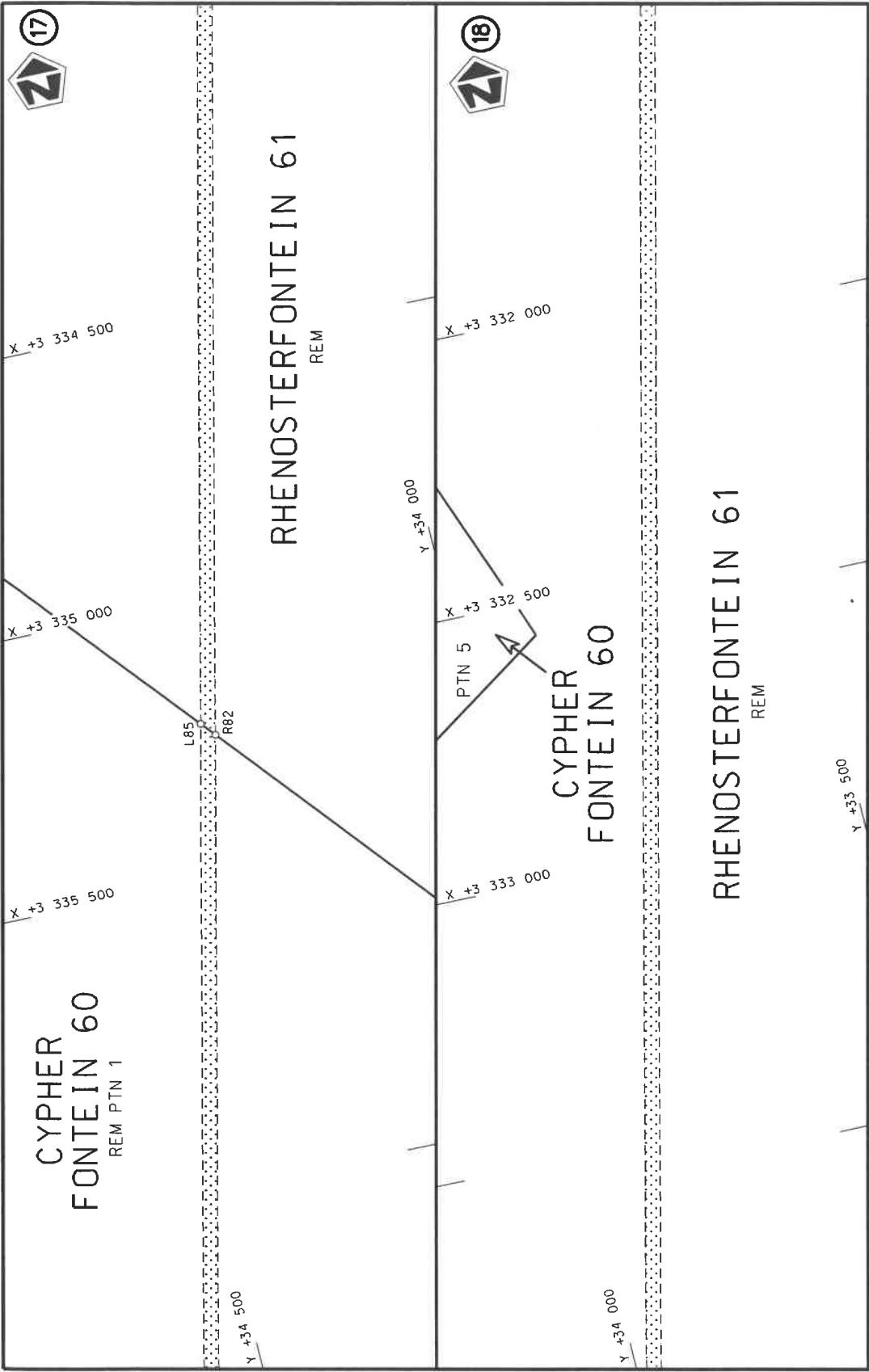

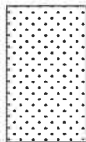
Die Suid Afrikaanse Nasionale Padagentskap MSB Bpk The South African National Roads Agency SOC Ltd	Die figuur getoon The figure shown		steldie padreserwe voor van 'n gedeelte represents the road reserve of a portion van Nasionale Roete R48 of National Route	3	Vel Sheet	7 of	10
					Plan	P1247/24	

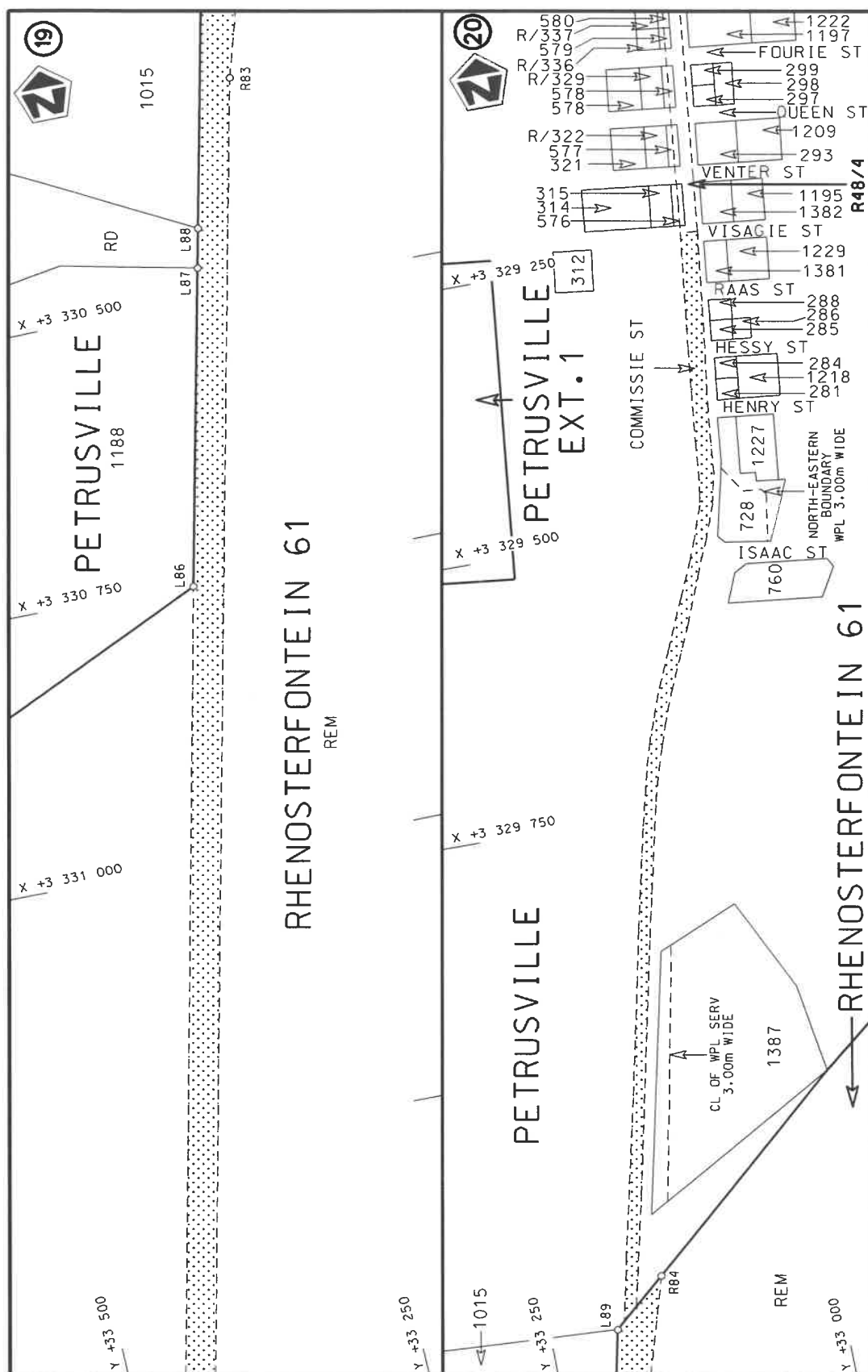

Die Suid-Afrikaanse Nasionale Padagentskap MSB Bpk The South African National Roads Agency SOC Ltd	Die figuur getoon The figure shown	ste die padreserwe voor van 'n gedeelte represents the road reserve of a portion van Nasionale Roete R48 of National Route	Vel Sheet 8 of 10
		Seksie Section 3	Plan P1247/24

PADRESERVE KOÖRDINATE / ROAD RESERVE CO-ORDINATES									
LINKERKANT/LEFT HAND SIDE					REGTERKANT/RIGHT HAND SIDE				
	Y	X	WG 25°			Y	X		
L1	50 457.12	3 368 093.60		R1	50 437.56	3 368 128.42			
L2	50 324.24	3 367 882.76		R2	50 406.34	3 368 067.49			
L3	49 871.68	3 367 105.90		R3	50 361.79	3 367 994.70			
L4	49 068.28	3 365 737.32		R4	49 865.02	3 367 144.68			
L5	49 042.28	3 365 695.01		R5	49 054.90	3 365 764.10			
L6	48 930.79	3 365 547.67		R6	48 976.85	3 365 644.80			
L7	48 771.09	3 365 382.96		R7	48 906.00	3 365 559.04			
L8	48 046.28	3 364 653.88		R8	48 695.72	3 365 341.37			
L9	47 976.31	3 364 584.53		R9	47 908.93	3 364 550.10			
L10	47 893.92	3 364 495.11		R10	47 873.84	3 364 510.30			
L11	47 842.04	3 364 420.09		R11	47 824.27	3 364 439.21			
L12	47 576.21	3 363 973.67		R12	47 552.34	3 363 982.53			
L13	47 422.10	3 363 714.87		R13	47 321.13	3 363 594.23			
L14	47 346.14	3 363 580.42		R14	47 285.43	3 363 508.64			
L15	47 309.20	3 363 500.92		R15	47 202.88	3 363 249.86			
L16	47 232.65	3 363 260.97		R16	47 117.65	3 362 999.19			
L17	47 141.42	3 362 991.49		R17	47 057.50	3 362 844.92			
L18	47 084.45	3 362 842.28		R18	47 021.47	3 362 782.15			
L19	47 042.94	3 362 769.30		R19	46 712.08	3 362 403.57			
L20	46 972.71	3 362 678.63		R20	46 620.66	3 362 320.49			
L21	46 774.52	3 362 436.67		R21	46 518.78	3 362 250.89			
L22	46 690.49	3 362 350.05		R22	43 859.91	3 360 921.49			
L23	46 637.51	3 362 301.92		R23	43 700.34	3 360 827.44			
L24	46 534.60	3 362 231.64		R24	43 657.53	3 360 802.21			
L25	46 242.80	3 362 083.72		R25	43 501.95	3 360 674.45			
L26	43 808.39	3 360 865.71		R26	43 399.66	3 360 570.21			
L27	43 657.36	3 360 769.05		R27	43 276.82	3 360 417.16			
L28	43 609.55	3 360 734.74		R28	42 386.14	3 359 168.72			
L29	43 451.10	3 360 589.11		R29	42 281.72	3 359 025.44			
L30	43 354.83	3 360 477.78		R30	42 240.44	3 358 940.52			
L31	43 300.98	3 360 403.80		R31	42 172.63	3 358 748.35			
L32	43 157.30	3 360 206.41		R32	41 708.25	3 357 468.18			
L33	42 296.69	3 358 999.91		R33	41 380.11	3 356 563.58			
L34	42 265.81	3 358 938.95		R34	41 330.87	3 356 419.30			
L35	42 199.57	3 358 755.80		R35	41 297.69	3 356 286.03			
L36	41 916.33	3 357 971.74		R36	41 275.91	3 356 132.90			
L37	41 913.77	3 357 960.47		R37	41 268.20	3 355 984.21			
L38	41 932.76	3 357 953.66		R38	41 222.52	3 353 982.27			
L39	41 925.29	3 357 933.95		R39	41 216.76	3 353 730.06			
L40	41 904.93	3 357 938.43		R40	41 210.16	3 353 603.86			
L41	41 720.87	3 357 432.12		R41	41 083.56	3 352 620.18			
L42	41 375.46	3 356 477.04		R42	41 078.99	3 352 542.14			
L43	41 343.82	3 356 373.02		R43	41 084.17	3 352 399.74			
L44	41 322.93	3 356 281.04		R44	41 107.48	3 352 332.93			
L45	41 301.26	3 356 141.15		R45	41 198.08	3 351 984.06			
L46	41 286.69	3 355 689.88		R46	41 234.00	3 351 834.59			
L47	41 247.09	3 353 987.36		R47	41 254.24	3 351 700.56			
L48	41 239.41	3 353 656.82		R48	41 270.02	3 351 399.35			
L49	41 233.85	3 353 588.05		R49	41 282.09	3 350 910.43			
L50	41 121.19	3 352 717.10		R50	41 273.53	3 350 830.99			
L51	41 103.99	3 352 548.27		R51	41 261.50	3 350 765.69			
					Vel Sheet	9	Van of	10	P1247/24

PADRESERVE KOÖRDINATE / ROAD RESERVE CO-ORDINATES									
LINKERKANT/LEFT HAND SIDE					REGTERKANT/RIGHT HAND SIDE				
	Y		X	WG 25°		Y		X	
L52	41 106.39	3	352	479.46	R52	41 236.08	3	350	675.12
L53	41 130.17	3	352	361.17	R53	41 087.24	3	350	302.43
L54	41 144.56	3	352	326.21	R54	40 613.94	3	349	117.35
L55	41 188.14	3	352	127.81	R55	40 497.86	3	348	841.82
L56	41 260.03	3	351	839.86	R56	39 333.19	3	346	333.33
L57	41 307.24	3	351	760.67	R57	39 273.54	3	346	231.86
L58	41 306.06	3	351	720.87	R58	39 215.50	3	346	147.71
L59	41 284.45	3	351	678.52	R59	38 935.74	3	345	795.15
L60	41 311.02	3	350	905.45	R60	38 787.59	3	345	608.44
L61	41 287.98	3	350	737.24	R61	38 735.17	3	345	532.78
L62	41 112.80	3	350	297.43	R62	38 691.79	3	345	454.13
L63	40 583.15	3	348	967.70	R63	38 665.39	3	345	397.54
L64	39 365.33	3	346	339.50	R64	38 339.54	3	344	436.49
L65	39 295.24	3	346	217.37	R65	37 846.64	3	342	966.27
L66	39 218.71	3	346	108.57	R66	37 740.05	3	342	675.91
L67	38 956.19	3	345	778.74	R67	37 660.37	3	342	512.64
L68	38 790.28	3	345	570.29	R68	37 616.90	3	342	432.89
L69	38 746.38	3	345	504.61	R69	37 420.85	3	342	126.88
L70	38 689.13	3	345	389.56	R70	37 402.28	3	342	104.93
L71	37 871.79	3	342	964.67	R71	37 243.32	3	341	854.58
L72	37 762.15	3	342	665.11	R72	36 475.58	3	340	674.29
L73	37 670.45	3	342	473.56	R73	36 242.51	3	340	315.98
L74	37 591.06	3	342	341.38	R74	35 380.58	3	338	990.87
L75	36 497.14	3	340	660.71	R75	35 194.04	3	338	704.09
L76	36 094.92	3	340	042.77	R76	35 113.35	3	338	575.19
L77	35 388.29	3	338	957.12	R77	35 053.05	3	338	456.92
L78	35 213.51	3	338	688.59	R78	35 026.17	3	338	395.03
L79	35 135.07	3	338	561.99	R79	34 990.46	3	338	297.73
L80	35 078.44	3	338	454.37	R80	34 972.41	3	338	237.44
L81	35 049.51	3	338	388.61	R81	34 894.59	3	337	892.12
L82	35 022.84	3	338	316.31	R82	34 292.33	3	335	218.15
L83	34 982.44	3	338	167.64	R83	33 188.27	3	330	303.91
L84	34 934.38	3	337	956.18	R84	33 146.72	3	330	165.60
L85	34 312.26	3	335	193.40					
L86	33 314.52	3	330	749.50					
L87	33 250.74	3	330	467.46					
L88	33 242.86	3	330	432.32					
L89	33 192.34	3	330	207.00					