

DEPARTMENT OF TRANSPORT

NO. 896

21 September 2021

**THE SOUTH AFRICAN NATIONAL ROADS
AGENCY SOC LIMITED**

Registration No: 1998/009584/30

DECLARATION AMENDMENT OF NATIONAL ROAD N11 SECTION 9

AMENDMENT OF DECLARATION No. 264 OF 2008.

By virtue of Section 40 (1)(b) of The South African National Roads Agency Limited and National Roads Act, 1998 (Act No. 7 of 1998), I hereby amend Declaration No. 264 of 2008 by substituting it in its entirety, with the accompanying sheets 1 to 11 of Plan No. P1030/18.

In the town of Hendrina the N11 Section 9 starts at the junction with the streets known as Beukes Street and Church Street at the time of declaration, therefrom it follows the street known as Church Street at the time of declaration in a general northerly direction at the time of declaration.

(National Road N11 Section 9: Hendrina – Middelburg)**MINISTER OF TRANSPORT**

DEPARTEMENT VAN VERVOER

NO. 896

21 September 2021

**DIE SUID-AFRIKAANSE NASIONALE
PADAGENTSKAP MSB BEPERK**

Registrasie No: 1998/009584/30

VERKLARING WYSIGING VAN NASIONALE PAD N11 SEKSIE 9

WYSIGING VAN VERKLARING No. 264 VAN 2008.

Kragtens Artikel 40(1)(b) van die Wet op die Suid-Afrikaanse Nasionale Padagentskap Beperk en op Nasionale Paaie, 1998 (Wet No. 7 van 1998), wysig ek hiermee Verklaring No. 264 van 2008 deur dit in sy geheel te vervang, met bygaande velle 1 tot 11 van Plan No. P1030/18.

In die dorp van Hendrina begin die N11 Seksie 9 by die interseksie met die strate bekend as Beukesstraat en Kerkstraat tydens datum van verklaring, daarvandaan volg dit die straat bekend as Kerkstraat tydens datum van verklaring in 'n algemene noordelike rigting tydens datum van verklaring.

(Nasionale Pad N11 Seksie 9: Hendrina – Middelburg)



MINISTER VAN VERVOER

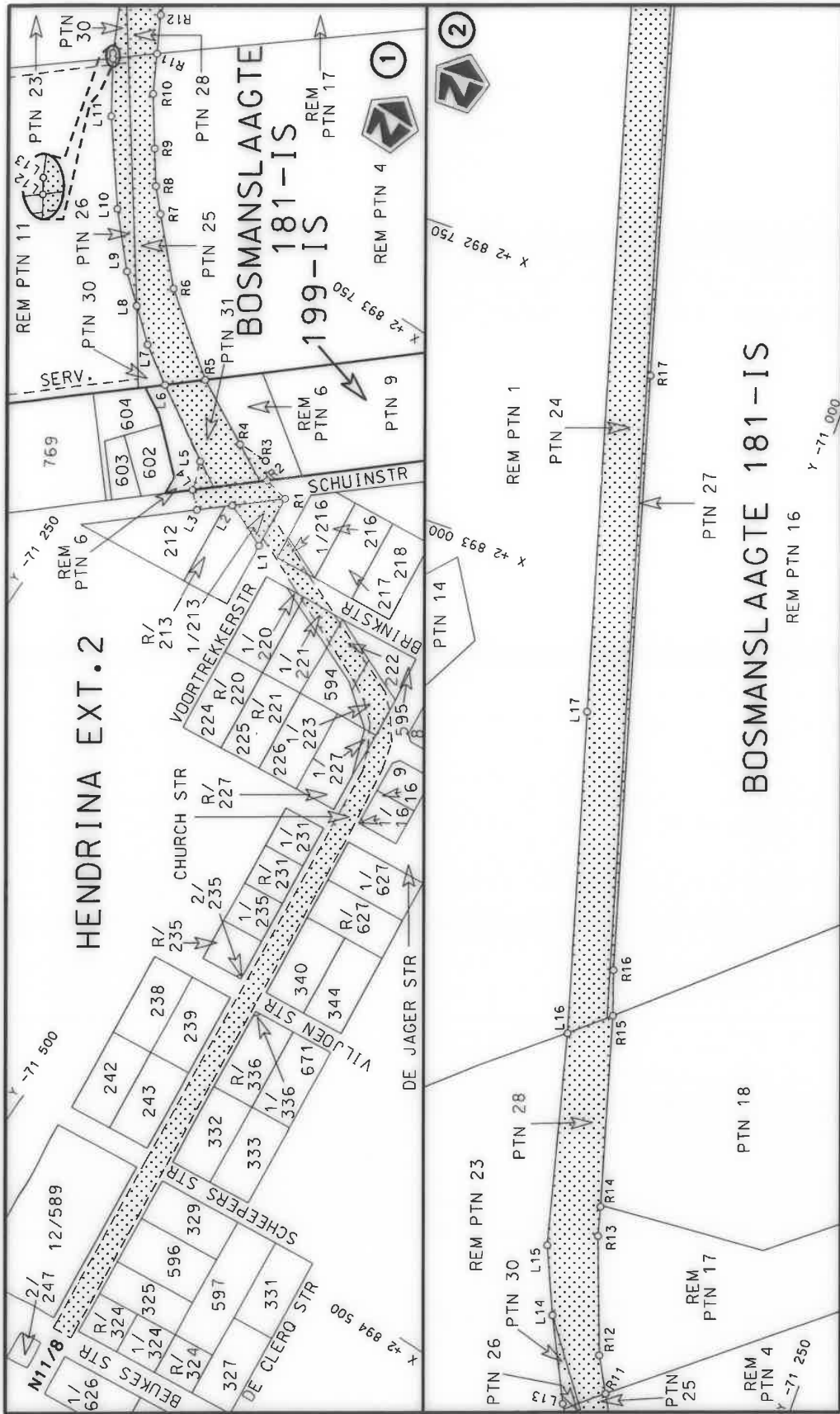

<p>Die Suid Afrikaanse Nasionale Padagentskap MSB Bpk The South African National Roads Agency SOC Ltd</p>	<p>Die figuur getoon The figure shown</p>	<p>ste die padreserwe voor van 'n gedeelte represents the road reserve of a portion van Nasionale Roete N11 of National Route</p>	<p>Vel Sheet 1 of 11 Plan P1030/18</p>
---	---	---	--

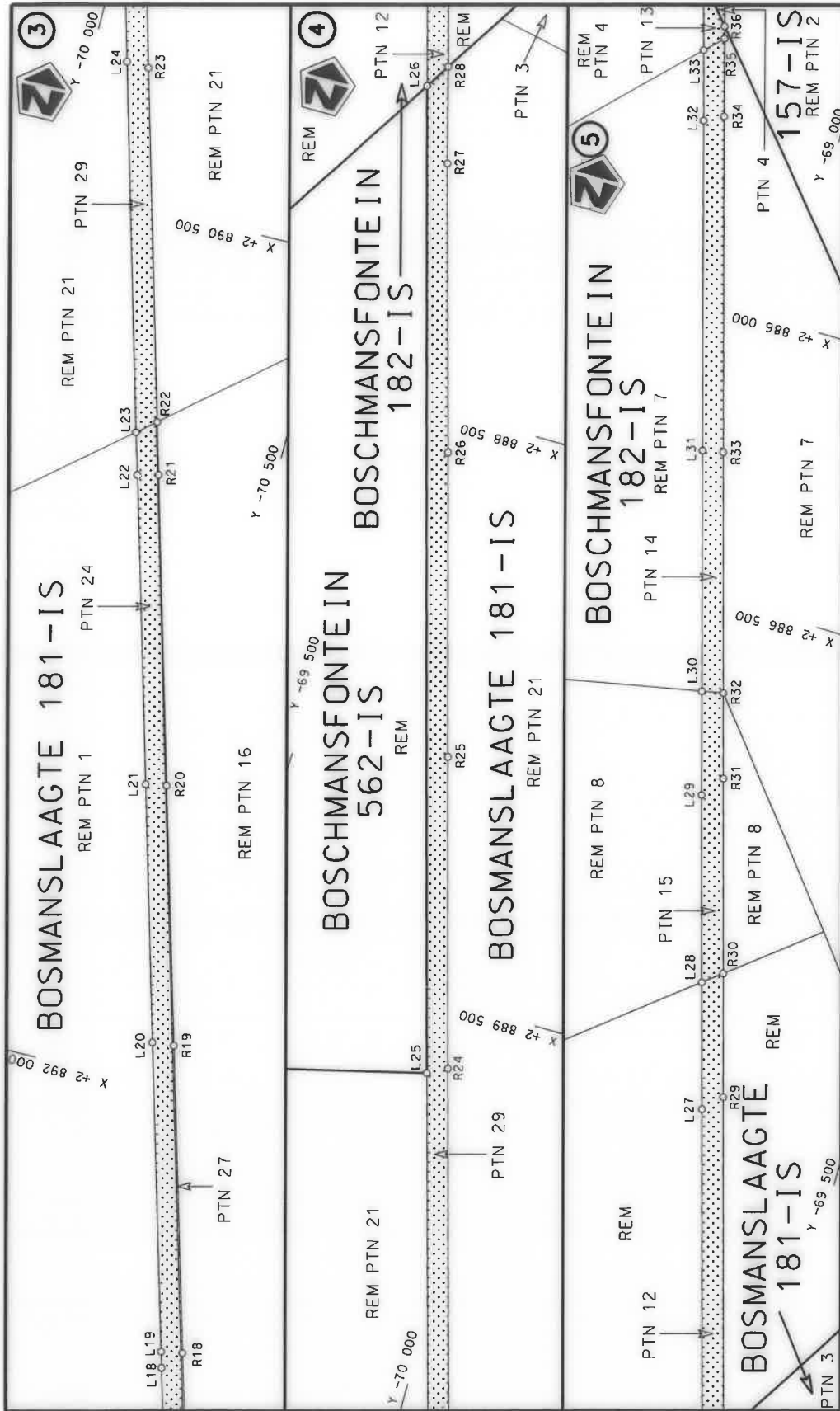

<p>Die Suid Afrikaanse Nasionale Padagentskap MSB Bpk The South African National Roads Agency SOC Ltd</p>	<p>Die figuur getoon The figure shown</p>	<p>steil die padreserwe voor van 'n gedeelte represents the road reserve of a portion van Nasionale Roete N11 Sektie of National Route N11 Section</p>	<p>Vel Sheet 2 of 11 Plan P1030/18</p>
---	---	--	--

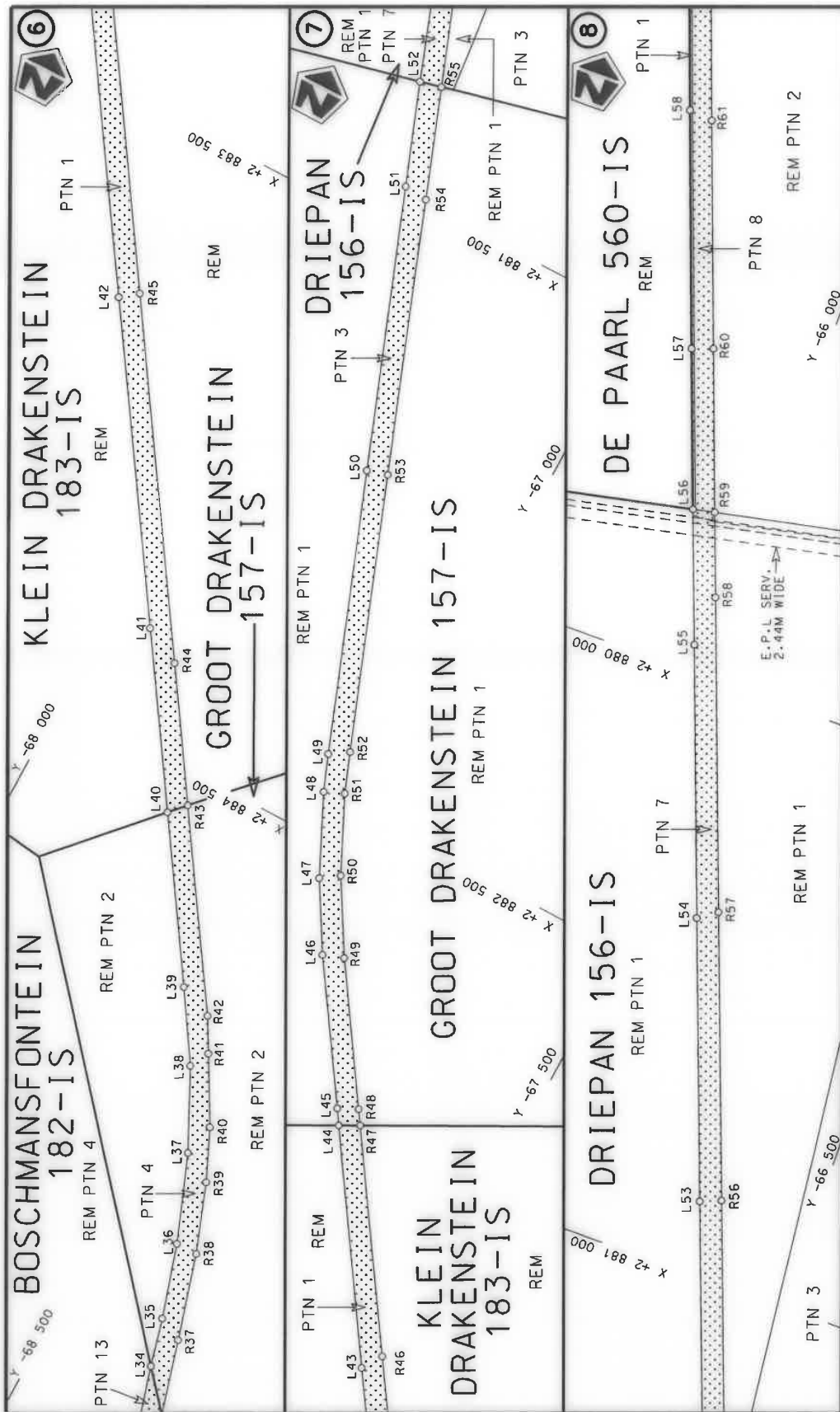

Die Suid Afrikaanse Nasionale Padagentskap MSB Bpk The South African National Roads Agency SOC Ltd	Die figuur getoon The figure shown		steldie padreserwe voor van 'n gedeelte represents the road reserve of a portion van Nasionale Roete N11 of National Route	
			Seksie Section	9
		Vel Sheet	van of	11
		Plan	P1030/18	

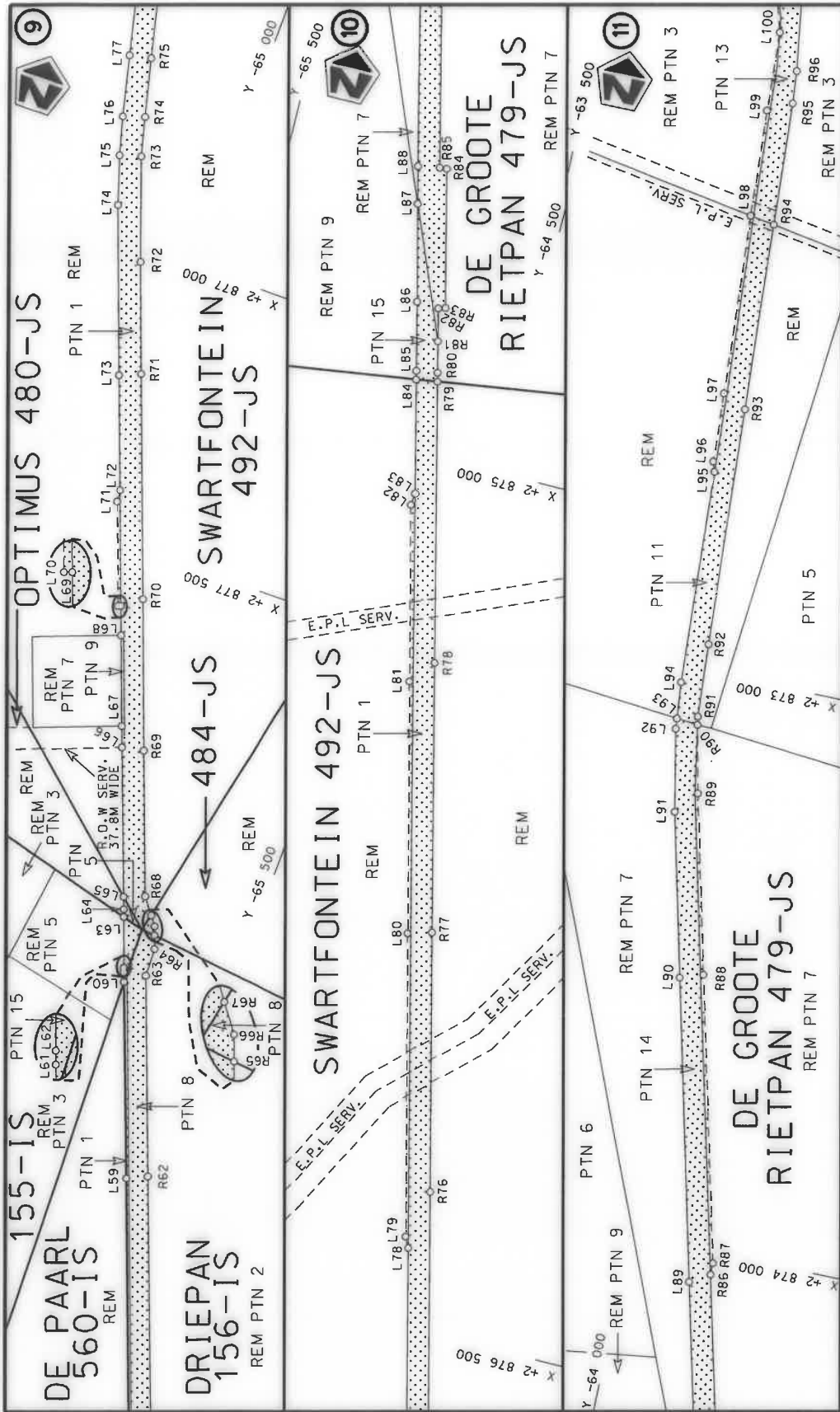

<p>Die Suid-Afrikaanse Nasionale Padagentskap MSB Bpk The South African National Roads Agency SOC Ltd</p>	<p>Die figuur getoon The figure shown</p>	<p>stelt die padreserwe voor van 'n gedeelte represents the road reserve of a portion van Nasionale Roete N11 of National Route</p>	<p>Vel Sheet 4 of 11 Plan P1030/18</p>
---	---	---	--

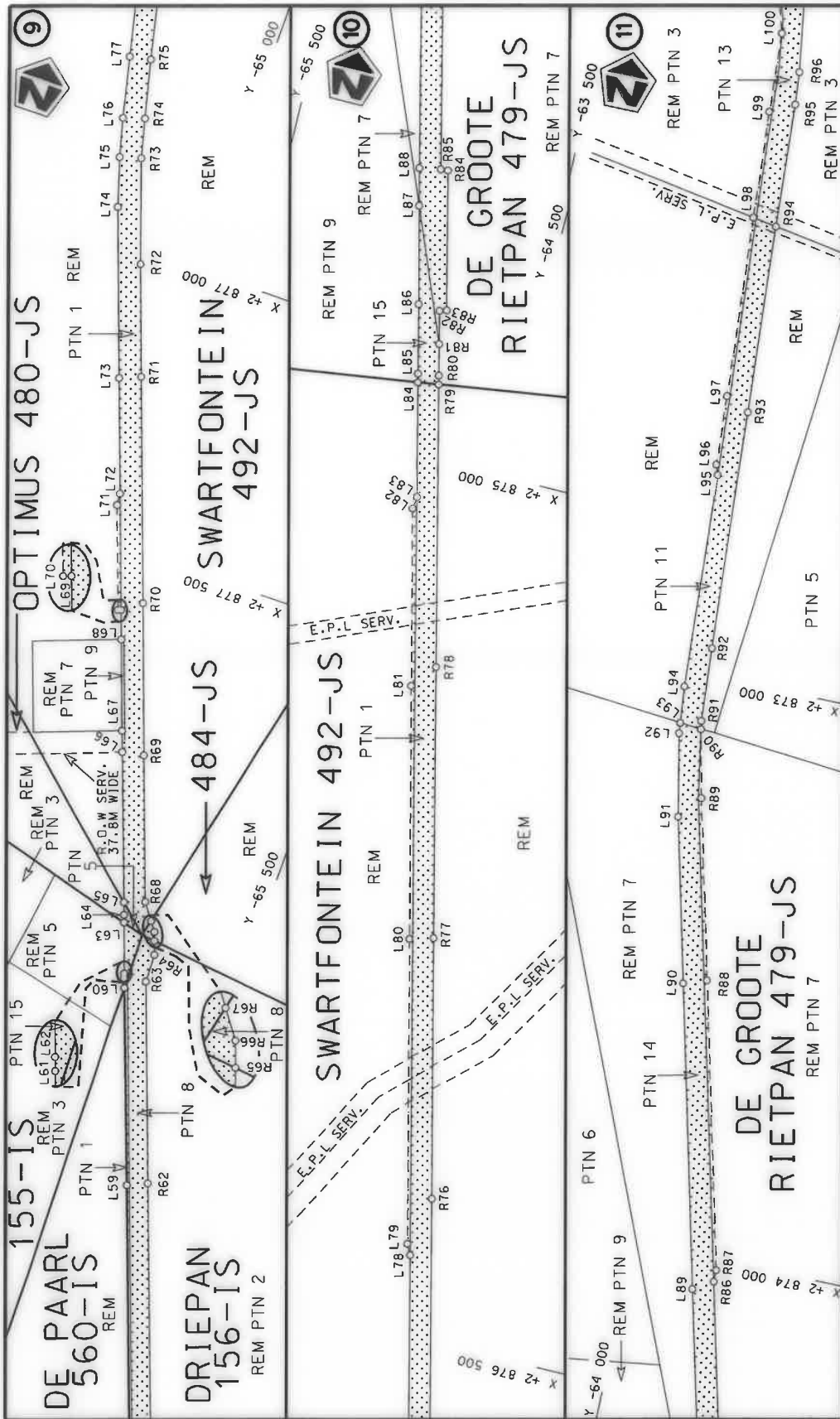

<p>Die Suid Afrikaanse Nasionale Padagentskap MSB Bpk The South African National Roads Agency SOC Ltd</p>	<p>Die figuur getoon The figure shown</p>	<p>stelt die padreserwe voor van 'n gedeelte represents the road reserve of a portion van Nasionale Roete N11 of National Route N11</p>	<p>9</p>	<p>Vel Sheet 4 of 11 Plan P1030/18</p>
---	---	---	----------	--

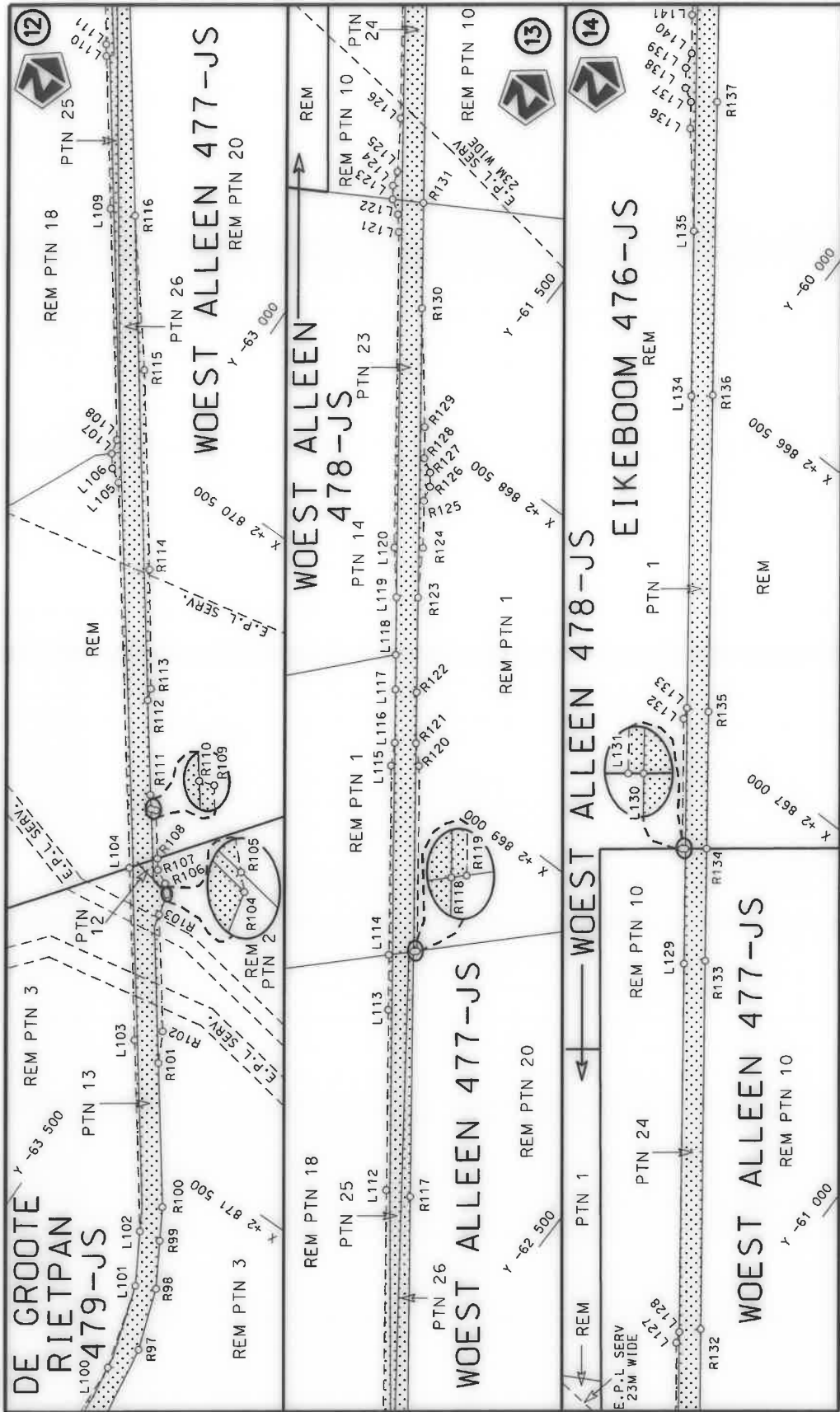

Die Suid-Afrikaanse Nasionale Padagentskap MSB Bpk The South African National Roads Agency SOC Ltd	Die figuur getoon The figure shown		steldie padreserwe voor 'n gedeelte represents the road reserve of a portion van Nasionale Roete N11 of National Route N11 Seksie Section	
			9	Plan P1030/18
		Vel Sheet 5 of 11		

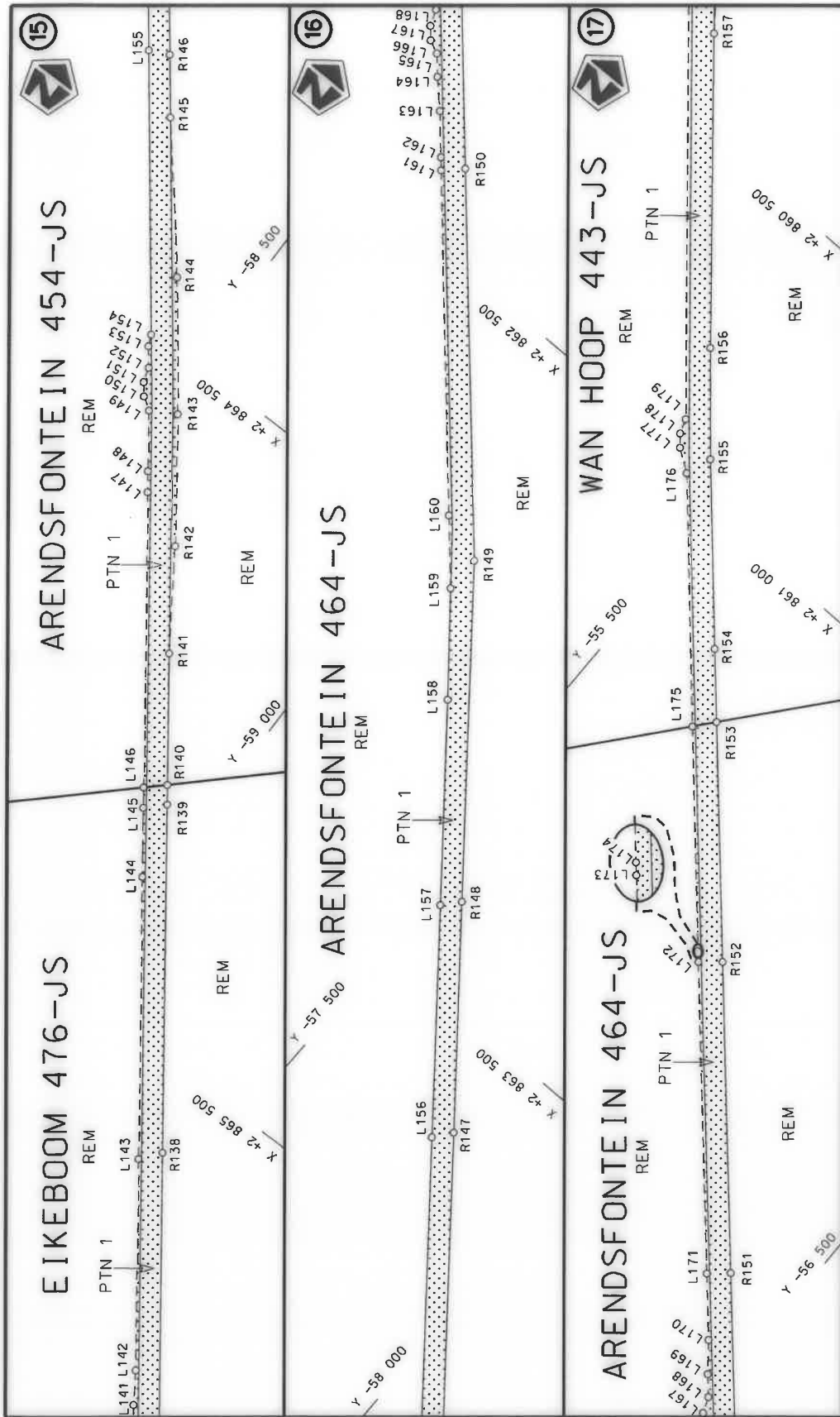

Die Suid Afrikaanse Nasionale Padagentenskap MSB Bpk The South African National Roads Agency SOC Ltd	Die figuur getoon The figure shown		stel die padreserwe voor van 'n gedeelte represents the road reserve of a portion van Nasionale Roete N11 of National Route Section	
			9	Vel Sheet 6 of 11 Plan P1030/18

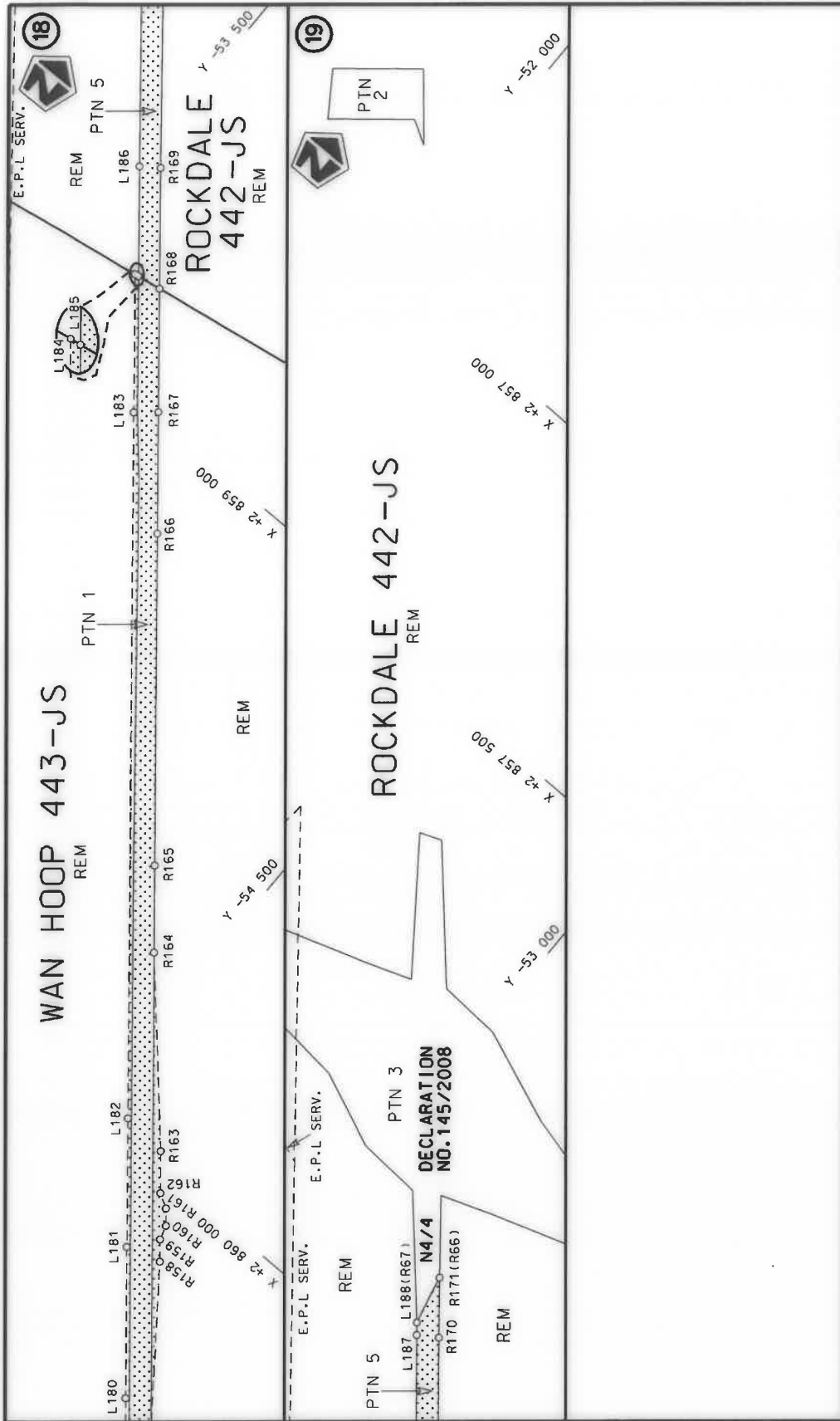

<p>Die Suid-Afrikaanse Nasionale Padogentskap MSB Bpk The South African National Roads Agency SOC Ltd</p>	<p>Die figuur getoon The figure shown</p>	<p>stei die padreserwe voor van 'n gedeelte represents the road reserve of a portion van Nasionale Roete N11 of National Route Section</p>	<p>Vel Sheet 7 of 11 Plan P1030/18</p>
---	---	--	--

PADRESERWE KOÖRDINATE / ROAD RESERVE CO-ORDINATES					
LINKERKANT/LEFT HAND SIDE			REGTERKANT/RIGHT HAND SIDE		
	Y	X	WG 29°	Y	X
L1	-71 405.46	2 893 986.21		R1	-71 401.63 2 893 939.28
L2	-71 366.29	2 893 969.52		R2	-71 379.65 2 893 934.59
L3	-71 342.76	2 893 989.66		R3	-71 368.83 2 893 920.99
L4	-71 329.75	2 893 977.11		R4	-71 342.20 2 893 920.99
L5	-71 321.55	2 893 952.44		R5	-71 285.55 2 893 890.28
L6	-71 258.20	2 893 913.58		R6	-71 217.59 2 893 838.95
L7	-71 226.11	2 893 892.27		R7	-71 171.83 2 893 790.57
L8	-71 199.21	2 893 869.09		R8	-71 155.04 2 893 772.25
L9	-71 175.43	2 893 848.60		R9	-71 135.81 2 893 745.33
L10	-71 137.94	2 893 807.22		R10	-71 107.98 2 893 705.95
L11	-71 088.37	2 893 742.51		R11	-71 091.23 2 893 674.92
L12	-71 061.44	2 893 699.73		R12	-71 074.91 2 893 644.71
L13	-71 058.82	2 893 695.58		R13	-71 039.06 2 893 545.71
L14	-71 024.53	2 893 624.84		R14	-71 032.55 2 893 520.61
L15	-70 999.72	2 893 567.94		R15	-70 986.84 2 893 358.25
L16	-70 954.64	2 893 385.76		R16	-70 973.88 2 893 320.16
L17	-70 876.89	2 893 112.84		R17	-70 830.27 2 892 815.60
L18	-70 694.94	2 892 477.31		R18	-70 724.43 2 892 443.12
L19	-70 687.41	2 892 449.63		R19	-70 575.41 2 891 920.93
L20	-70 537.23	2 891 924.53		R20	-70 449.13 2 891 479.42
L21	-70 412.73	2 891 486.22		R21	-70 299.10 2 890 952.56
L22	-70 262.83	2 890 961.63		R22	-70 273.51 2 890 863.09
L23	-70 241.80	2 890 889.77		R23	-70 102.27 2 890 263.27
L24	-70 063.34	2 890 261.91		R24	-69 916.72 2 889 613.55
L25	-69 882.85	2 889 631.48		R25	-69 766.16 2 889 084.58
L26	-69 405.31	2 887 958.38		R26	-69 619.14 2 888 568.41
L27	-69 238.53	2 887 372.54		R27	-69 478.04 2 888 079.80
L28	-69 176.90	2 887 157.33		R28	-69 432.24 2 887 915.68
L29	-69 085.90	2 886 839.57		R29	-69 268.51 2 887 341.96
L30	-69 035.86	2 886 663.31		R30	-69 208.58 2 887 132.04
L31	-68 920.03	2 886 255.28		R31	-69 114.16 2 886 801.37
L32	-68 760.90	2 885 696.33		R32	-69 072.85 2 886 656.32
L33	-68 726.42	2 885 577.14		R33	-68 955.46 2 886 248.03
L34	-68 692.54	2 885 459.96		R34	-68 792.96 2 885 679.58
L35	-68 670.41	2 885 376.26		R35	-68 755.50 2 885 547.73
L36	-68 631.16	2 885 248.07		R36	-68 749.59 2 885 526.91
L37	-68 573.18	2 885 097.26		R37	-68 713.02 2 885 397.10
L38	-68 504.61	2 884 959.56		R38	-68 670.45 2 885 247.02
L39	-68 428.61	2 884 842.73		R39	-68 626.61 2 885 127.56
L40	-68 257.63	2 884 584.45		R40	-68 586.51 2 885 038.76
L41	-68 077.68	2 884 312.60		R41	-68 522.93 2 884 925.50
L42	-67 753.21	2 883 824.99		R42	-68 490.22 2 884 867.35
L43	-67 445.70	2 883 362.76		R43	-68 283.90 2 884 556.76
L44	-67 208.08	2 883 004.20		R44	-68 144.39 2 884 346.76
L45	-67 191.60	2 882 978.84		R45	-67 782.55 2 883 801.76
L46	-67 041.01	2 882 752.07		R46	-67 468.08 2 883 327.78
L47	-66 972.35	2 882 635.46		R47	-67 241.79 2 882 986.50
L48	-66 907.44	2 882 497.74		R48	-67 225.58 2 882 962.41
L49	-66 882.89	2 882 435.25		R49	-67 077.53 2 882 739.22
L50	-66 707.32	2 881 963.22		R50	-67 003.44 2 882 613.88
L51	-66 531.22	2 881 490.55		R51	-66 941.55 2 882 482.88

Vel Sheet	8	Van of	11	P1030/18
-----------	---	--------	----	----------

PADRESERWE KOÖRDINATE / ROAD RESERVE CO-ORDINATES					
LINKERKANT/LEFT HAND SIDE			REGTERKANT/RIGHT HAND SIDE		
	Y	X	WG 29°	Y	X
L52	-66 465.71	2 881	316.70	R52	-66 915.25 2 882 413.90
L53	-66 301.08	2 880	874.18	R53	-66 743.39 2 881 952.49
L54	-66 126.21	2 880	405.74	R54	-66 572.81 2 881 494.80
L55	-65 958.29	2 879	954.07	R55	-66 503.26 2 881 307.55
L56	-65 874.66	2 879	730.46	R56	-66 336.23 2 880 859.95
L57	-65 775.73	2 879	465.24	R57	-66 158.22 2 880 383.36
L58	-65 629.75	2 879	072.08	R58	-65 964.19 2 879 863.44
L59	-65 436.83	2 878	552.49	R59	-65 911.85 2 879 722.87
L60	-65 315.12	2 878	228.08	R60	-65 811.22 2 879 452.58
L61	-65 309.07	2 878	211.98	R61	-65 671.25 2 879 076.44
L62	-65 306.26	2 878	204.29	R62	-65 470.39 2 878 537.00
L63	-65 275.72	2 878	120.30	R63	-65 346.85 2 878 204.82
L64	-65 271.13	2 878	107.69	R64	-65 344.62 2 878 155.91
L65	-65 263.42	2 878	087.06	R65	-65 336.41 2 878 133.06
L66	-65 171.15	2 877	840.23	R66	-65 331.06 2 878 118.15
L67	-65 158.11	2 877	805.16	R67	-65 319.17 2 878 102.00
L68	-65 102.31	2 877	655.18	R68	-65 298.29 2 878 073.64
L69	-65 084.21	2 877	606.54	R69	-65 208.69 2 877 833.02
L70	-65 079.53	2 877	608.28	R70	-65 116.23 2 877 582.62
L71	-65 015.40	2 877	435.96	R71	-64 977.94 2 877 210.73
L72	-65 013.11	2 877	415.48	R72	-64 909.61 2 877 025.63
L73	-64 942.49	2 877	225.70	R73	-64 847.32 2 876 850.90
L74	-64 838.25	2 876	944.87	R74	-64 829.68 2 876 783.60
L75	-64 811.10	2 876	861.72	R75	-64 803.80 2 876 683.10
L76	-64 792.95	2 876	795.51	R76	-64 699.32 2 876 257.18
L77	-64 767.33	2 876	690.68	R77	-64 589.38 2 875 812.90
L78	-64 686.80	2 876	362.34	R78	-64 476.14 2 875 351.38
L79	-64 677.18	2 876	344.11	R79	-64 358.06 2 874 870.41
L80	-64 548.64	2 875	824.74	R80	-64 354.34 2 874 855.25
L81	-64 441.92	2 875	393.64	R81	-64 341.18 2 874 801.60
L82	-64 367.22	2 875	091.91	R82	-64 327.36 2 874 745.21
L83	-64 369.25	2 875	070.82	R83	-64 339.29 2 874 741.41
L84	-64 321.33	2 874	875.75	R84	-64 280.47 2 874 503.63
L85	-64 317.68	2 874	860.90	R85	-64 267.98 2 874 504.78
L86	-64 288.65	2 874	742.89	R86	-64 153.15 2 874 038.92
L87	-64 246.67	2 874	575.75	R87	-64 153.21 2 874 018.31
L88	-64 230.58	2 874	511.68	R88	-64 030.93 2 873 524.00
L89	-64 119.18	2 874	059.34	R89	-63 954.73 2 873 213.34
L90	-63 991.12	2 873	537.56	R90	-63 928.92 2 873 095.22
L91	-63 921.50	2 873	253.60	R91	-63 926.39 2 873 080.83
L92	-63 892.81	2 873	110.03	R92	-63 918.08 2 872 952.41
L93	-63 891.03	2 873	091.83	R93	-63 893.33 2 872 534.78
L94	-63 884.78	2 873	027.85	R94	-63 873.68 2 872 206.62
L95	-63 864.32	2 872	653.17	R95	-63 861.34 2 871 991.00
L96	-63 858.37	2 872	635.90	R96	-63 856.50 2 871 934.01
L97	-63 851.75	2 872	514.62	R97	-63 839.11 2 871 816.96
L98	-63 831.26	2 872	199.31	R98	-63 802.68 2 871 711.50
L99	-63 819.94	2 872	012.48	R99	-63 759.18 2 871 638.24
L100	-63 812.27	2 871	873.94	R100	-63 728.89 2 871 586.95
L101	-63 769.63	2 871	727.86	R101	-63 577.34 2 871 382.73
L102	-63 721.12	2 871	644.36	R102	-63 551.50 2 871 332.60

Vel 9 Van
Sheet of 11

P1030/18

PADRESERWE KOÖRDINATE / ROAD RESERVE CO-ORDINATES					
LINKERKANT/LEFT HAND SIDE			REGTERKANT/RIGHT HAND SIDE		
	Y	X	WG 29°	Y	X
L103	-63 519.68	2 871 373.60		R103	-63 428.36 2 871 167.37
L104	-63 338.11	2 871 129.94		R104	-63 419.48 2 871 130.84
L105	-62 932.00	2 870 585.01		R105	-63 415.80 2 871 127.07
L106	-62 909.01	2 870 570.94		R106	-63 405.42 2 871 116.47
L107	-62 893.35	2 870 549.99		R107	-63 381.32 2 871 104.25
L108	-62 887.13	2 870 524.91		R108	-63 369.30 2 871 088.12
L109	-62 643.44	2 870 198.59		R109	-63 318.60 2 871 020.09
L110	-62 482.80	2 869 983.67		R110	-63 310.00 2 871 022.99
L111	-62 470.51	2 869 967.09		R111	-63 295.03 2 871 003.17
L112	-62 223.43	2 869 633.71		R112	-63 195.37 2 870 869.26
L113	-62 033.31	2 869 379.00		R113	-63 188.23 2 870 849.59
L114	-61 975.21	2 869 301.16		R114	-63 065.57 2 870 679.06
L115	-61 775.84	2 869 033.69		R115	-62 856.35 2 870 396.91
L116	-61 756.60	2 868 997.74		R116	-62 685.87 2 870 184.21
L117	-61 700.39	2 868 922.31		R117	-62 264.75 2 869 617.22
L118	-61 663.52	2 868 873.74		R118	-62 006.72 2 869 269.92
L119	-61 603.10	2 868 792.48		R119	-62 011.07 2 869 265.62
L120	-61 546.73	2 868 725.04		R120	-61 815.94 2 869 003.83
L121	-61 215.25	2 868 279.20		R121	-61 787.33 2 868 975.42
L122	-61 195.23	2 868 255.52		R122	-61 733.81 2 868 903.49
L123	-61 171.50	2 868 240.39		R123	-61 634.14 2 868 769.33
L124	-61 157.01	2 868 220.92		R124	-61 587.90 2 868 694.39
L125	-61 148.80	2 868 196.50		R125	-61 538.48 2 868 628.00
L126	-61 095.93	2 868 118.63		R126	-61 531.70 2 868 602.15
L127	-60 928.94	2 867 893.88		R127	-61 516.77 2 868 582.09
L128	-60 921.62	2 867 875.65		R128	-61 493.68 2 868 567.82
L129	-60 533.76	2 867 354.07		R129	-61 461.00 2 868 523.93
L130	-60 412.57	2 867 191.47		R130	-61 330.07 2 868 360.63
L131	-60 407.81	2 867 195.12		R131	-61 219.35 2 868 211.98
L132	-60 270.95	2 867 011.37		R132	-60 948.53 2 867 848.65
L133	-60 264.25	2 866 992.43		R133	-60 560.27 2 867 327.24
L134	-59 936.24	2 866 551.66		R134	-60 442.37 2 867 168.59
L135	-59 762.79	2 866 318.53		R135	-60 298.47 2 866 974.96
L136	-59 648.12	2 866 179.50		R136	-59 965.28 2 866 527.65
L137	-59 620.46	2 866 142.32		R137	-59 657.05 2 866 113.31
L138	-59 597.91	2 866 128.76		R138	-59 301.24 2 865 636.04
L139	-59 576.95	2 866 100.61		R139	-58 935.75 2 865 145.16
L140	-59 569.57	2 866 073.95		R140	-58 915.08 2 865 117.46
L141	-59 528.70	2 866 019.06		R141	-58 777.06 2 864 932.46
L142	-59 496.08	2 865 968.54		R142	-58 670.41 2 864 776.71
L143	-59 274.09	2 865 670.35		R143	-58 532.91 2 864 590.47
L144	-58 977.94	2 865 272.67		R144	-58 385.51 2 864 400.83
L145	-58 905.41	2 865 175.28		R145	-58 205.41 2 864 185.61
L146	-58 883.98	2 865 146.54		R146	-58 137.56 2 864 099.30
L147	-58 574.06	2 864 730.90		R147	-57 798.19 2 863 668.38
L148	-58 552.14	2 864 701.51		R148	-57 546.40 2 863 349.65
L149	-58 488.61	2 864 616.21		R149	-57 174.69 2 862 878.88
L150	-58 465.48	2 864 602.33		R150	-56 716.54 2 862 365.75
L151	-58 450.04	2 864 582.66		R151	-56 385.52 2 861 995.07
L152	-58 442.58	2 864 556.98		R152	-56 020.41 2 861 587.27
L153	-58 419.07	2 864 527.04		R153	-55 739.38 2 861 273.27

Vel 10 Van
Sheet of 11

P1030/18

PADRESERWE KOÖRDINATE / ROAD RESERVE CO-ORDINATES					
LINKERKANT/LEFT HAND SIDE			REGTERKANT/RIGHT HAND SIDE		
	Y	X	WG 29°	Y	X
L154	-58 410.64	2 864	508.22	R154	-55 653.54 2 861 177.37
L155	-58 103.09	2 864	115.83	R155	-55 432.04 2 860 928.76
L156	-57 774.24	2 863	699.07	R156	-55 305.39 2 860 780.00
L157	-57 521.44	2 863	378.34	R157	-54 952.10 2 860 356.39
L158	-57 297.57	2 863	094.95	R158	-54 774.61 2 860 123.45
L159	-57 174.59	2 862	942.45	R159	-54 749.55 2 860 093.43
L160	-57 089.61	2 862	847.11	R160	-54 742.01 2 860 068.78
L161	-56 686.72	2 862	395.14	R161	-54 722.55 2 860 045.48
L162	-56 671.31	2 862	377.92	R162	-54 697.68 2 860 031.29
L163	-56 617.25	2 862	317.54	R163	-54 650.60 2 859 974.88
L164	-56 574.99	2 862	274.83	R164	-54 418.25 2 859 717.40
L165	-56 547.57	2 862	244.20	R165	-54 320.48 2 859 600.53
L166	-56 524.50	2 862	233.42	R166	-53 948.35 2 859 154.93
L167	-56 507.44	2 862	214.37	R167	-53 812.34 2 858 991.86
L168	-56 496.41	2 862	187.05	R168	-53 674.10 2 858 826.35
L169	-56 469.44	2 862	156.93	R169	-53 538.99 2 858 664.58
L170	-56 431.66	2 862	110.22	R170	-53 289.93 2 858 364.69
L171	-56 353.64	2 862	023.10	R171	-53 223.11 2 858 283.57
L172	-55 987.94	2 861	614.74		
L173	-55 977.96	2 861	603.67		
L174	-55 975.14	2 861	600.52		
L175	-55 711.96	2 861	306.19		
L176	-55 415.99	2 860	974.08		
L177	-55 377.69	2 860	947.18		
L178	-55 361.57	2 860	928.06		
L179	-55 353.23	2 860	902.65		
L180	-54 884.74	2 860	345.20		
L181	-54 715.06	2 860	141.44		
L182	-54 570.98	2 859	968.50		
L183	-53 779.22	2 859	020.27		
L184	-53 624.54	2 858	834.89		
L185	-53 631.37	2 858	833.71		
L186	-53 508.54	2 858	686.68		
L187	-53 257.44	2 858	385.56		
L188	-53 243.60	2 858	368.88		

Vel Sheet	11	Van of	11	P1030/18
--------------	----	-----------	----	----------