



# Government Gazette Staatskoerant

REPUBLIC OF SOUTH AFRICA  
REPUBLIEK VAN SUID AFRIKA

Vol. 663

10 September  
September 2020

No. 43699

N.B. The Government Printing Works will  
not be held responsible for the quality of  
“Hard Copies” or “Electronic Files”  
submitted for publication purposes

ISSN 1682-5843



9 771682 584003

43699



**AIDS HELPLINE: 0800-0123-22 Prevention is the cure**

**IMPORTANT NOTICE:**

**THE GOVERNMENT PRINTING WORKS WILL NOT BE HELD RESPONSIBLE FOR ANY ERRORS THAT MIGHT OCCUR DUE TO THE SUBMISSION OF INCOMPLETE / INCORRECT / ILLEGIBLE COPY.**

**No FUTURE QUERIES WILL BE HANDLED IN CONNECTION WITH THE ABOVE.**

**Contents**

<i>No.</i>	<i>Gazette No.</i> <i>Page No.</i>
<b>GOVERNMENT NOTICES • GOEWERMENTSKENNISGEWINGS</b>	
<b>Environment, Forestry and Fisheries, Department of/ Omgewingsake, Bosbou en Visserye, Departement van</b>	
972	National Forest Act (84/1998): Consultation on the intention to declare the Grey Dell and Fort Grey Forests Areas a controlled forest area under section 17(2) of the Act..... 43699      3

---

**GOVERNMENT NOTICES • GOEWERMENTSKENNISGEWINGS**

---

**DEPARTMENT OF ENVIRONMENT, FORESTRY AND FISHERIES**

NO. 972

10 SEPTEMBER 2020

**NATIONAL FOREST ACT, 1998  
(ACT NO. 84 OF 1998)****CONSULTATION ON THE INTENTION TO DECLARE THE GREY DELL AND FORT GREY FORESTS AREAS AS A CONTROLLED FOREST AREA UNDER SECTION 17(2) OF THE NATIONAL FORESTS ACT, 1998 (ACT NO. 84 OF 1998)**

I, Barbara Dallas Creecy, Minister of Forestry, Fisheries and the Environment, hereby consult on my intention to declare, under section 17(2) of the National Forests Act, 1998 (Act No. 84 of 1998), the Grey Dell and Fort Grey forest areas and associated land as a controlled forest area for the purposes of preventing deforestation and for rehabilitation of natural forest and associated habitat that was damaged and degraded. The background, effective period, description of the area, location, local municipality, prohibitions and steps to be taken by the owner of the land, as well as the properties that form part of the controlled forest area, is set out in the Schedule hereto.

Members of the public are invited to submit written comments or inputs, within 14 days after publication of this Notice in the *Government Gazette*, to the following address:

By post to:     The Acting Director-General  
                  Department of Environment, Forestry and Fisheries  
                  Branch: Forestry Management  
                  Attention: Mr A R Madula  
                  Private Bag X447  
                  PRETORIA  
                  0001

By hand at:     110 Hamilton Street  
                  ARCADIA  
                  0083

Please note that anyone entering the Department's building will be subjected to COVID-19 procedures.

Due to the COVID-19 pandemic delivering comments by hand at the Department is being discouraged.

By Email: [Sdzivhani@environment.gov.za](mailto:Sdzivhani@environment.gov.za)

Any enquiries in connection with the draft Notice can be directed to Mrs S Dzivhani at Tel: 012 309 5765 or Mr J J Bester at Tel: 012 309 5767.

Comments or inputs received after the closing date may not be considered.



**BARBARA DALLAS CREECY**  
**MINISTER OF FORESTRY, FISHERIES AND THE ENVIRONMENT**

**SCHEDULE****PART A: BACKGROUND, EFFECTIVE PERIOD, DESCRIPTION OF THE AREA, LOCATION, LOCAL MUNICIPALITY, LAND OWNERSHIP, PROHIBITIONS AND STEPS TO BE TAKEN BY THE OWNER**

- Background:** The locality forms the principal part of the global distribution of an endemic tree species: *Umtiza listeriana*. A number of rare forest fauna species also occur within this landscape of diverse types of forest cover. The conservation value of this area has long been recognized. The first portion of Fort Grey State forest was proclaimed prior to the Union of South Africa and subsequently expanded. Umtiza Nature Reserve was declared within the Fort Grey State forest on 5 July 1985 (Government Notice No. 1453 of in Government Gazette No. 9830 of 5 July 1985). In recent years an illegal settlement has sprung up in the proximity of this forest and has gradually encroached into the natural forest areas during the last decade. This encroaching informal settlement results in illegal harvesting of forest produce within the forest, degradation of the forest and in some parts have led to deforestation. This invasion of the forest threatens the future existence of the forest and priority species.
- Effective time period:** The declaration will be valid for a period of 5 (five) years with effect from the date of publication of this Notice.
- Description:** The description of the area to be declared is as follows:  
The controlled forest area covers 1 846.272 ha. It consists of natural forest that incorporates lesser areas of planted forest and open land. The natural vegetation consists of Scarp Forest (forest type: FOz 5); Buffels Thicket (type AT 12) and incorporate embedded portions of Albany Coastal Belt Thicket (type AT 9) as well as Southern Afrotemperate Forest (type FOz 1). This vegetation mosaic functions as an integrated ecosystem with the natural forest.
- Location:** Eastern Cape Province.
- Local Municipality:** Buffalo City Metropolitan Municipality
- Properties:** The controlled forest area includes the properties listed in Part B of this Schedule to this Notice (also depicted in a map below):
- Landownership:** State and Private
- Prohibitions:** No person may-
- (i) access the land to which this Notice applies except for:
    - (a) owners of enclosed private properties (farms), their legal tenants, authorized visitors and workers;

- (b) legitimate functionaries performing authorized work in relation to the steps to be taken outlined below;
  - (c) legitimate functionaries performing normal activities associated with the management of the forest;
  - (d) persons authorized to access the forest for recreation in terms of section 20(3) of the National Forest Act, 1998 (Act No. 84 of 1998) (NFA), subject to the condition that such persons must be accompanied by somebody in the employ of the land owner / manager; and
  - (e) persons authorized to conduct legitimate research with provision for licenses to be issued in terms of section 7(4) of the NFA for research purposes only;
- (ii) cut, disturb, damage or destroy any indigenous trees;
  - (iii) collect and remove any forest produce, including wood and any other plant material, as well as forest wildlife;
  - (iv) construct any building, structure or road, including the opening up of informal access pathways;
  - (v) destroy or damage any official fence, beacon, signposting or warning signs established and/or maintained by the Department of Environment, Forestry and Fisheries or any agency authorized to manage and secure the area;
  - (vi) ignite fire in the open air and cause fire to spread within the area;
  - (vii) dispose of waste, other than owners of the affected properties, in designated areas; and
  - (viii) conduct any activities which may cause deforestation of indigenous trees or prevent authorized rehabilitation works;

**Steps that must be taken by the owner of the land:**

- (i) Control access to the land covered by this declaration to prevent entry of unauthorized persons and vehicles;
- (ii) Removal of unauthorized structures, dwellings and artefacts associated with informal/illegal settlement;
- (iii) Fire protection;
- (iv) Collection and removal of refuse and other waste illegally dumped in the area;
- (v) Rehabilitation of designated degraded areas, including soil remediation, fencing, transplanting of vegetation and control of invasive species; and
- (vi) Drafting of a sustainable management plan for the area.

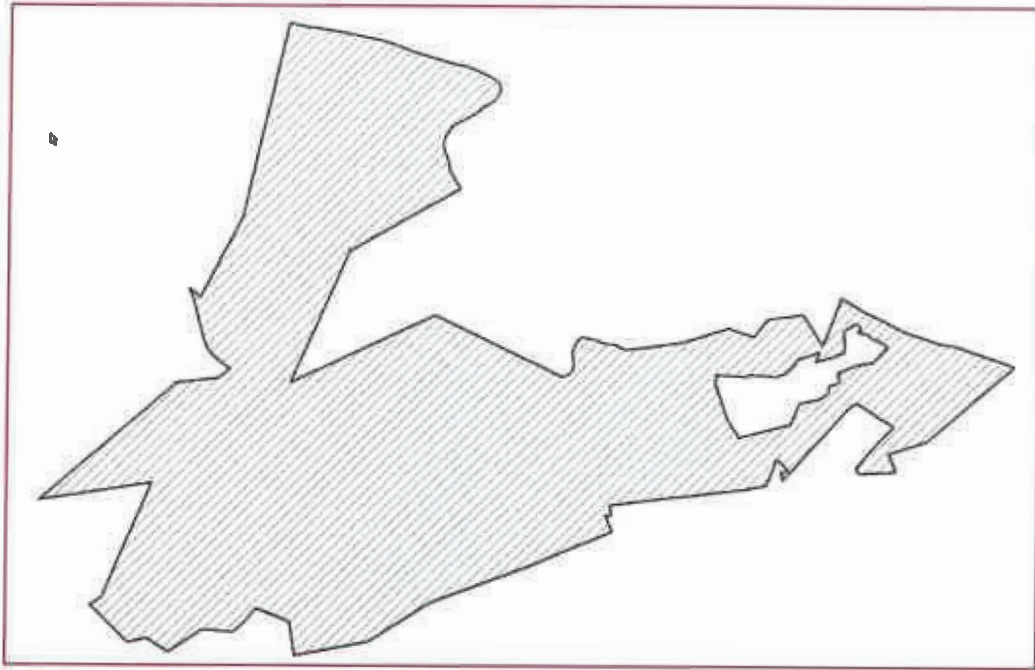
**PART B: MAPS AND PROPERTIES THAT FORM PART OF THE CONTROLLED FOREST AREA**

**Map of the area declared as controlled forest area (2020-2025)**

**Properties Included in the Fort Grey / Grey Dell Controlled Forest Area declared in terms of section 17(2) of the National Forests Act, 1998 (Act No. 84 of 1998)**

- Farm 853: Portions 3; 4; 5; 6; and 9
- Farm 856: Remainder (a western and eastern portion)
- Farm 857: Portion 0
- Farm 870: Portions 4; 8; and 9
- Farm 871: Remainder and Portion RE/1
- Farm 871: Portions 2; 3; 5; 6; 7; 9; 11; and 12
- Farm 872 : Remainder
- Farm 875: Portions 3; 8; 10; 13; and 15
- Farm 875: Remainder
- Farm 1304
- Farm 1345: Portions 0 and 1
- Farm 1504

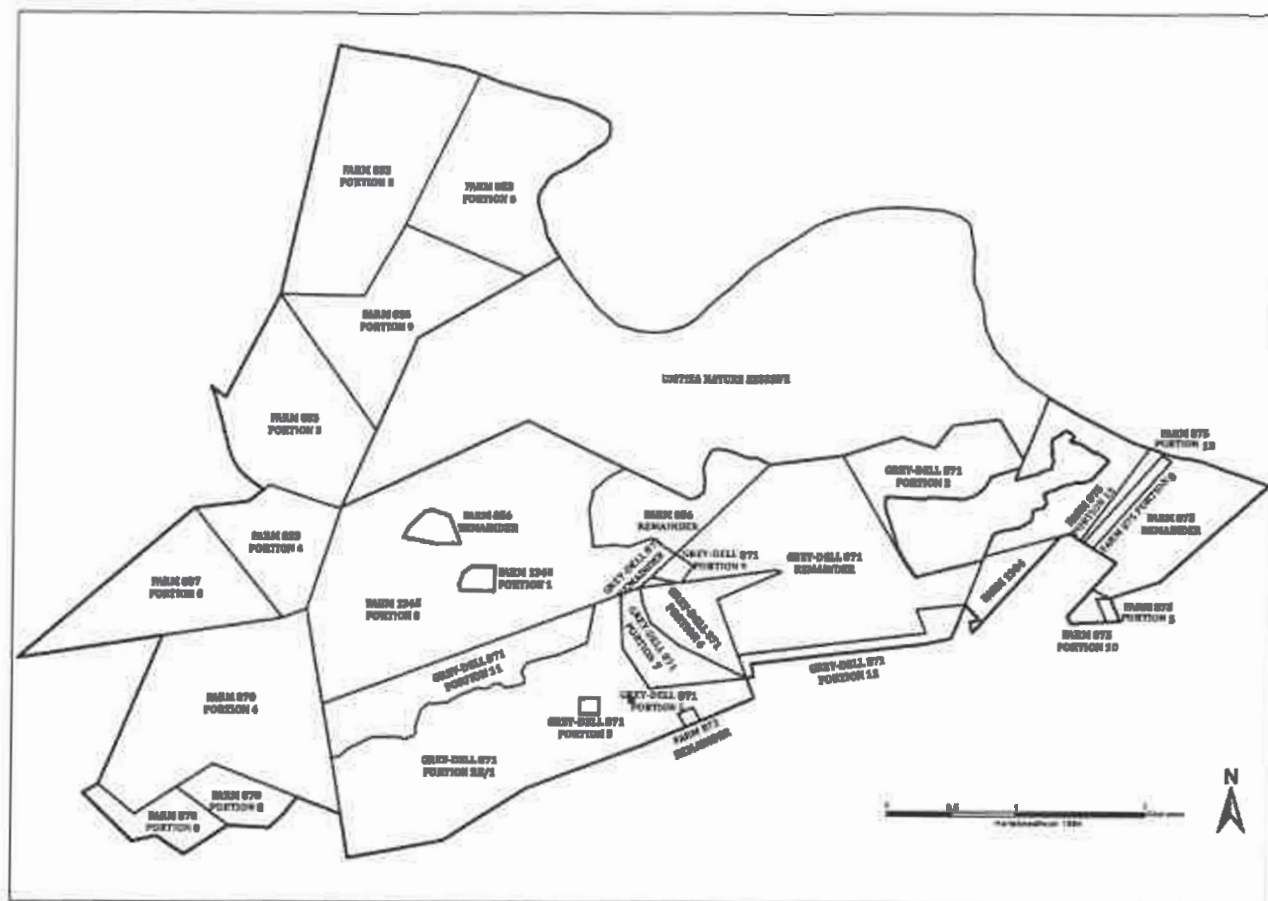

Figure: Map of the properties covered by natural forest and the controlled forest area, also showing Umtiza Nature Reserve









Printed by and obtainable from the Government Printer, Bosman Street, Private Bag X85, Pretoria, 0001  
Contact Centre Tel: 012-748 6200. eMail: [info.egazette@gpw.gov.za](mailto:info.egazette@gpw.gov.za)  
Publications: Tel: (012) 748 6053, 748 6061, 748 6065