

---

**GOVERNMENT NOTICES • GOEWERMENTSKENNISGEWINGS**

---

**DEPARTMENT OF TRANSPORT**

NO. 643

05 JUNE 2020

**THE SOUTH AFRICAN NATIONAL ROADS  
AGENCY SOC LIMITED**Registration No: 1998/009584/30

---

**DECLARATION OF EXISTING PROVINCIAL ROADS – (I) PROVINCIAL ROAD D1386 SECTION 1,  
(II) PROVINCIAL ROAD P207 SECTION 1 AS NATIONAL ROAD R573 SECTION 1 - DISTRICTS  
OF WONDERBOOM AND CULLINAN, IN THE GAUTENG PROVINCE.**

By virtue of Section 40(1)(a) of The South African National Roads Agency Limited and National Roads Act, 1998 (Act No. 7 of 1998), I hereby declare:

- I) The Section of Route R573 Section 1, also known as Provincial Road D1386 Section 1, as declared by Administrator's Notice No's. 37 of 1949, 1046 of 1966, 2865 of 1985, 645 of 1989 and all other Administrator's Notices which might be relevant to this section of road, commencing from Stormvoël Road, also known as M8, up to Sefako Makgatho drive, also known as R513, as depicted on the accompanying sheets 1 to 4 of Plan No. P1190/19, from there onwards it proceeds in a general north easterly direction along the existing Provincial Road D1386 Section 1, up to its junction with Provincial Road P207 Section 1;
- II) The Section of Route R573 Section 1, a section of Provincial Road P207 Section 1, as declared by Administrator's Notice No. 1728 of 1977 and all other Administrator's Notices which might be relevant to this section of road, commencing from its junction with Provincial Road D1386 Section 1, from where it proceeds in a general north easterly direction along the existing Provincial Road P207 Section 1 up to the current Gauteng / Mpumalanga Provincial Border, also known as the common boundary between the farms Jakkalsdans 243 – JR and Hartebeestspuit 235 – JR, as National Road.

**[National Road R573 Section 1: Stormvoël Road – Gauteng / Mpumalanga Provincial  
Border, a distance of approximately 45.8km]**



---

**MINISTER OF TRANSPORT**

## DEPARTEMENT VAN VERVOER

NO. 643

05 JUNIE 2020

**DIE SUID-AFRIKAANSE NASIONALE  
PADAGENTSKAP MSB BEPERK**

Registrasie No: 1998/009584/30

**VERKLARING VAN BESTAANDE PROVINSIALE PAAIE – (I) PROVINSIALE PAD D1386 SEKSIE 1, (II) PROVINSIALE PAD P207 SEKSIE 1 AS NASIONALE PAD R573 SEKSIE 1 – DISTRIKTE VAN WONDERBOOM EN CULLINAN, IN DIE GAUTENG PROVINSIE**

Kragtens Artikel 40(1)(a) van die Wet op die Suid-Afrikaanse Nasionale Padagentskap Beperk en op Nasionale Paaie, Wet 1998 (Wet No. 7 van 1998), verklaar ek hiermee:

- I) Die gedeelte van Roete R573 Seksie 1, ook bekend as Provinsiale Pad D1386 Seksie 1, soos verklaar deur Administrateurskennisgewing No's. 37 van 1949, 1046 van 1966, 2865 van 1985, 645 van 1989 en alle ander Administrateurskennisgewings wat betrekking op hierdie gedeelte van die pad mag hê, vanaf Stormvoël Pad, ook bekend as M8, tot by Sefako Makgatho Rylaan, ook bekend as R513, soos uitgewys op die bygaande velle 1 tot 4 van Plan No. P1190/19, daarvandaan verder volg dit die bestaande Provinsiale Pad D1386 Seksie 1, in 'n algemene noordoostelike rigting tot by die aansluiting van Provinsiale Pad P207 Seksie 1;
- II) Die Gedeelte van Roete R573 Seksie 1, 'n gedeelte van Provinsiale Pad P207 Seksie 1, soos verklaar deur Administrateurskennisgewing No's. 1728 van 1977 en alle ander Administrateurskennisgewings wat betrekking op hierdie gedeelte van die pad mag hê, vanaf die aansluiting met Provinsiale Pad D1386 Seksie 1 en daarvandaan verder met die bestaande Provinsiale Pad P207 Seksie 1, in 'n algemene noordoostelike rigting tot by die huidige Gauteng / Mpumalanga Provinsiale Grens, ook bekend as die gemeenskaplike grens tussen die plase Jakkalsdans 243 – JR en Hartebeestspruit 235 – JR, as Nasionale Pad.

**[Nasionale Pad R573 Seksie 1: Stormvoël Pad – Gauteng/ Mpumalanga Provinsiale Grens, 'n afstand van ongeveer 45.8km]**

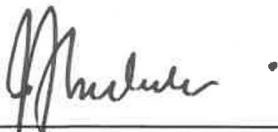

MINISTER VAN VERVOER

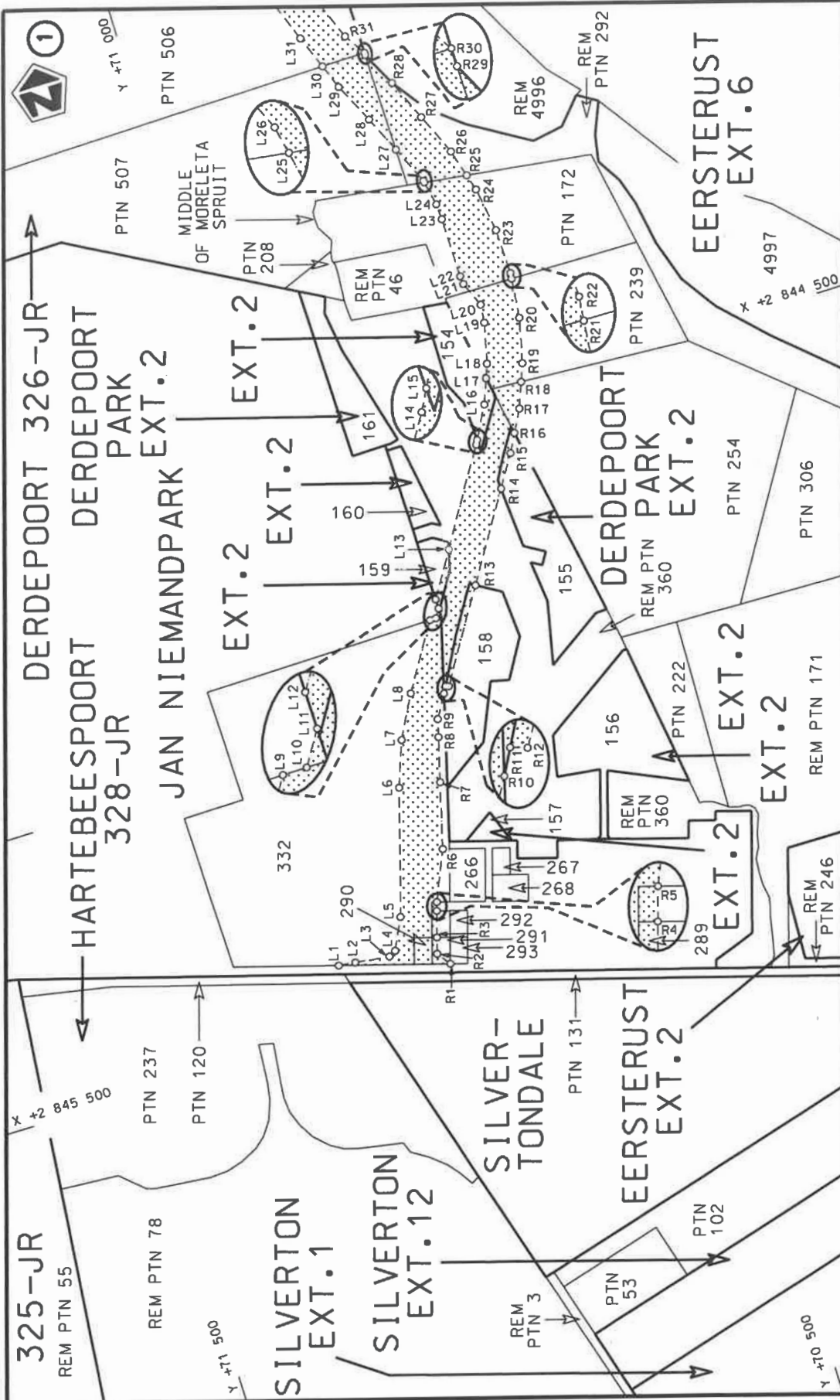

<p>Die Suid Afrikaanse Nasionale Padagentskap MSB Bpk The South African National Roads Agency SOC Ltd</p>	<p>Die figuur getoon The figure shown</p>	<p>steldie padreserwe voor van 'n gedeelte represents the road reserve of a portion van Nasionale Roete R573 Seksie of National Route Section</p>	<p>Vel Sheet 1 of 4 Plan P1190/19</p>
---	---	---	---

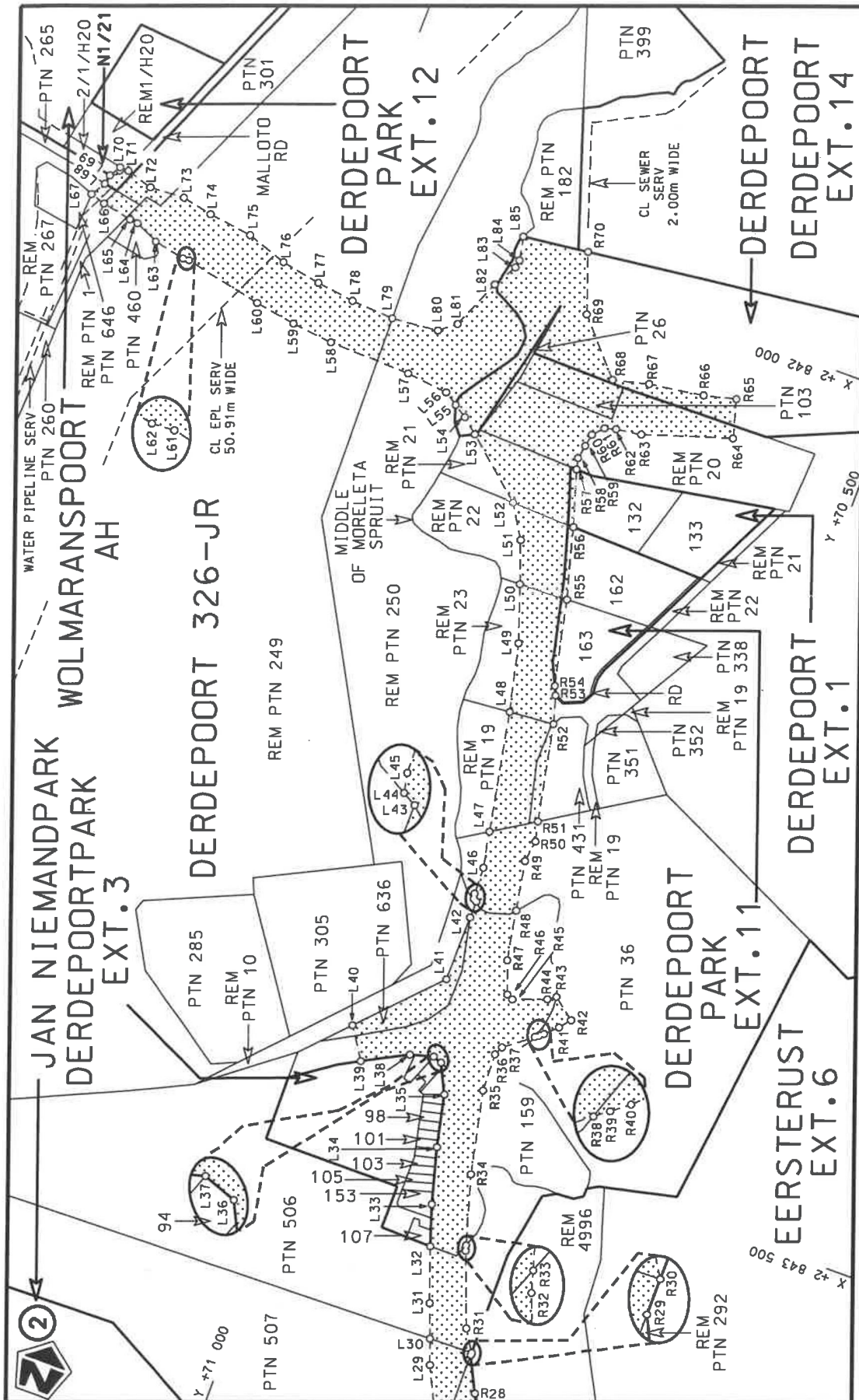

<p>Die Suid Afrikaanse Nasionale Podogentskop MSB Bpk The South African National Roads Agency SOC Ltd</p>	<p>Die figuur getoon The figure shown</p>	<p>steil die podreserwe voor van 'n gedeelte represents the rood reserve of a portion van Nasionale Roete R573 of National Route</p>	<p>Vel Sheet 2 of 4 Plan P1190/19</p>
		<p>1</p>	<p>Section</p>



PADRESERWE KOÖRDINATE / ROAD RESERVE CO-ORDINATES					
LINKERKANT/LEFT HAND SIDE			REGTERKANT/RIGHT HAND SIDE		
	Y	X	WG 29°	Y	X
L1	71 118.41	2 845 388.70		R1	70 931.13 2 845 445.21
L2	71 089.23	2 845 392.28		R2	70 947.75 2 845 421.31
L3	71 028.94	2 845 400.03		R3	70 939.59 2 845 393.33
L4	71 016.52	2 845 393.33		R4	70 925.89 2 845 348.15
L5	70 989.95	2 845 338.82		R5	70 921.19 2 845 333.14
L6	70 924.34	2 845 117.66		R6	70 883.50 2 845 245.85
L7	70 894.99	2 845 038.55		R7	70 852.81 2 845 131.03
L8	70 855.34	2 844 964.06		R8	70 831.86 2 845 053.22
L9	70 784.53	2 844 850.11		R9	70 823.50 2 845 022.20
L10	70 773.73	2 844 850.05		R10	70 799.75 2 844 982.10
L11	70 764.30	2 844 834.86		R11	70 793.48 2 844 970.68
L12	70 764.48	2 844 817.85		R12	70 787.64 2 844 972.59
L13	70 715.92	2 844 739.70		R13	70 689.85 2 844 815.22
L14	70 614.63	2 844 576.71		R14	70 596.37 2 844 664.64
L15	70 610.72	2 844 569.32		R15	70 561.97 2 844 609.43
L16	70 580.18	2 844 512.41		R16	70 544.83 2 844 577.19
L17	70 563.58	2 844 469.01		R17	70 523.76 2 844 538.13
L18	70 554.24	2 844 444.24		R18	70 506.95 2 844 493.96
L19	70 537.23	2 844 373.32		R19	70 494.99 2 844 462.54
L20	70 533.75	2 844 341.00		R20	70 476.13 2 844 383.88
L21	70 551.98	2 844 296.95		R21	70 468.60 2 844 313.79
L22	70 553.14	2 844 282.07		R22	70 467.49 2 844 303.46
L23	70 554.36	2 844 174.80		R23	70 469.21 2 844 222.59
L24	70 556.02	2 844 146.53		R24	70 481.25 2 844 142.60
L25	70 564.42	2 844 103.29		R25	70 489.42 2 844 113.95
L26	70 565.04	2 844 100.12		R26	70 503.43 2 844 064.82
L27	70 594.87	2 844 032.13		R27	70 535.38 2 843 990.51
L28	70 623.64	2 843 966.56		R28	70 566.50 2 843 917.10
L29	70 657.37	2 843 895.05		R29	70 596.66 2 843 855.19
L30	70 673.52	2 843 851.99		R30	70 596.69 2 843 851.00
L31	70 695.97	2 843 792.13		R31	70 620.38 2 843 812.70
L32	70 730.25	2 843 698.09		R32	70 669.40 2 843 684.72
L33	70 753.68	2 843 627.06		R33	70 672.13 2 843 675.13
L34	70 780.64	2 843 529.17		R34	70 708.48 2 843 553.34
L35	70 801.37	2 843 437.02		R35	70 740.55 2 843 406.79
L36	70 826.65	2 843 385.85		R36	70 743.44 2 843 339.44
L37	70 841.86	2 843 380.05		R37	70 736.27 2 843 323.88
L38	70 881.71	2 843 390.62		R38	70 689.24 2 843 287.12
L39	70 957.98	2 843 430.40		R39	70 683.22 2 843 282.28
L40	70 993.88	2 843 375.69		R40	70 675.85 2 843 276.42
L41	70 869.38	2 843 243.88		R41	70 655.01 2 843 256.65
L42	70 868.66	2 843 126.60		R42	70 639.91 2 843 237.82
L43	70 868.48	2 843 097.07		R43	70 678.24 2 843 207.07
L44	70 874.57	2 843 093.58		R44	70 692.03 2 843 216.72
L45	70 876.37	2 843 084.52		R45	70 749.10 2 843 237.60
L46	70 877.92	2 843 035.76		R46	70 760.29 2 843 232.45
L47	70 890.22	2 842 972.48		R47	70 781.52 2 843 175.51
L48	70 931.19	2 842 761.25		R48	70 797.79 2 843 088.34
L49	70 959.50	2 842 641.10		R49	70 814.30 2 842 999.94
L50	70 993.97	2 842 542.75		R50	70 809.21 2 842 961.06
L51	71 020.08	2 842 468.27		R51	70 817.30 2 842 926.96

Vel 3 Van 4  
Sheet of

P1190/19

PADRESERWE KOÖRDINATE / ROAD RESERVE CO-ORDINATES					
LINKERKANT/LEFT HAND SIDE			REGTERKANT/RIGHT HAND SIDE		
	Y	X	WG 29°		
				Y	X
L52	71 055.70	2 842	410.54	R52	70 851.94 2 842 755.45
L53	71 160.23	2 842	320.05	R53	70 866.30 2 842 706.58
L54	71 187.08	2 842	297.22	R54	70 873.27 2 842 691.99
L55	71 209.66	2 842	282.24	R55	70 906.91 2 842 540.34
L56	71 233.14	2 842	266.67	R56	70 941.47 2 842 416.00
L57	71 306.41	2 842	257.22	R57	70 972.28 2 842 318.20
L58	71 452.09	2 842	251.15	R58	70 976.80 2 842 298.46
L59	71 524.46	2 842	242.16	R59	70 972.64 2 842 273.85
L60	71 596.24	2 842	229.23	R60	70 968.61 2 842 251.42
L61	71 735.28	2 842	198.81	R61	70 952.11 2 842 233.32
L62	71 746.38	2 842	199.28	R62	70 932.70 2 842 228.04
L63	71 801.42	2 842	187.68	R63	70 888.47 2 842 221.56
L64	71 842.31	2 842	168.00	R64	70 736.50 2 842 173.74
L65	71 856.95	2 842	165.91	R65	70 755.29 2 842 106.81
L66	71 909.51	2 842	154.98	R66	70 811.14 2 842 119.81
L67	71 935.62	2 842	146.74	R67	70 906.78 2 842 133.01
L68	71 920.65	2 842	121.41	R68	70 968.92 2 842 147.92
L69	71 917.28	2 842	104.60	R69	71 051.50 2 842 053.80
L70	71 905.38	2 842	085.10	R70	71 087.95 2 841 949.58
L71	71 889.63	2 842	086.09		
L72	71 843.50	2 842	100.17		
L73	71 782.54	2 842	097.83		
L74	71 727.71	2 842	109.19		
L75	71 649.99	2 842	120.74		
L76	71 578.87	2 842	145.88		
L77	71 509.39	2 842	159.57		
L78	71 442.35	2 842	169.48		
L79	71 366.94	2 842	175.85		
L80	71 284.76	2 842	168.49		
L81	71 256.52	2 842	146.01		
L82	71 220.72	2 842	059.11		
L83	71 197.50	2 842	018.38		
L84	71 195.15	2 842	004.36		
L85	71 203.90	2 841	962.45		

Vel Sheet	4	Van of	4	P1190/19
-----------	---	--------	---	----------