

DEPARTMENT OF TRANSPORT

NO. 413

15 MARCH 2019

**THE SOUTH AFRICAN NATIONAL ROADS
AGENCY SOC LIMITED**

Registration No: 1998/009584/30

DECLARATION AMENDMENT OF NATIONAL ROAD R532 SECTION 3

AMENDMENT OF DECLARATION No. 538 OF 2014.

By virtue of section 40(1)(b) of the South African National Roads Agency Limited and the National Roads Act 1998 (Act No. 7 of 1998), I hereby amend Declaration No. 538 of 2014 by substituting paragraph Q of the Schedule, being the descriptive declaration of the route from its junction with National Road R36 Section 4 up to the Limpopo / Mpumalanga Provincial Border, with the accompanying sheets 1 to 5 of Plan No. P1068/18.

(National Road R532 Section 3: Limpopo / Mpumalanga Provincial Border - R36 Junction)



MINISTER OF TRANSPORT

DEPARTEMENT VAN VERVOER

NO. 413

15 MAART 2019

**DIE SUID-AFRIKAANSE NASIONALE
PADAGENTSKAP MSB BEPERK**

Registrasie No: 1998/009584/30

VERKLARING WYSIGING VAN NASIONALE PAD R532 SEKSIE 3

WYSIGING VAN VERKLARING No. 538 VAN 2014.

Kragtens Artikel 40(1)(b) van die Suid-Afrikaanse Nasionale Padagentskap Beperk en Nasionale Paaie Wet 1998 (Wet No. 7 van 1998), wysig ek hiermee Verklaring No. 538 van 2014 deur paragraaf Q van die Skedule te vervang, synde die gedeelte van die beskrywende verklaring van die pad vanaf die aansluiting met Nasionale Pad R36 Seksie 4 tot by die Limpopo / Mpumalanga Provinsiale Grens, met bygaande velle 1 tot 5 van Plan No. P1068/18.

(Nasionale Pad R532 Seksie 3: Limpopo / Mpumalanga Provinsiale Grens - R36 Aansluiting)**MINISTER VAN VERVOER**

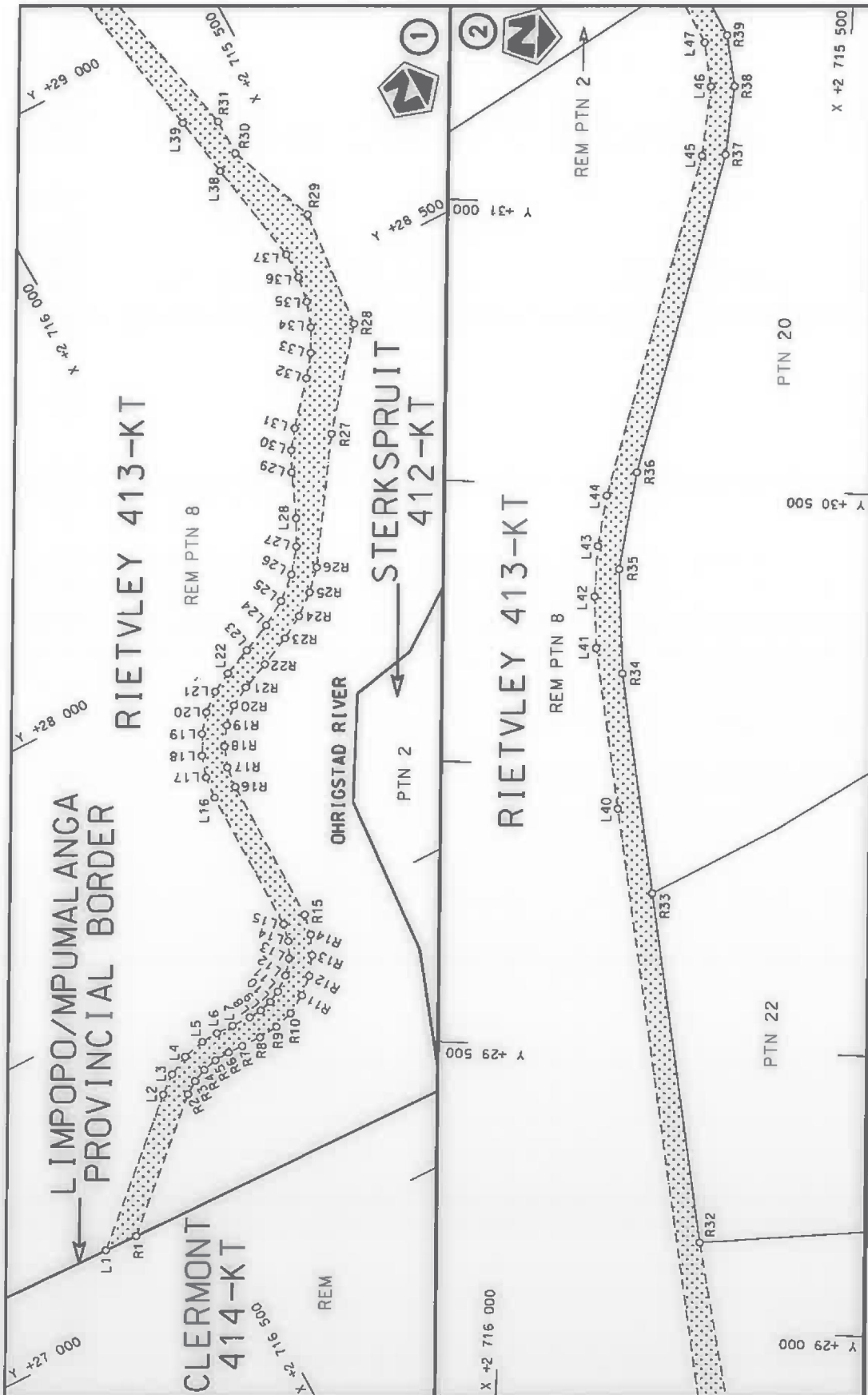

<p>Die Suid Afrikaanse Nasionale Padagentskap MSB Bpk The South African National Roads Agency SOC Ltd</p>	<p>Die figuur getoon The figure shown</p>	<p>steldie padreserwe voor van 'n gedeelte represents the road reserve of a portion van Nasionale Roete R532 Sektie of National Route Section</p>	<p>Vel Sheet 1 of 5 Plan P1068/18</p>
---	---	---	---

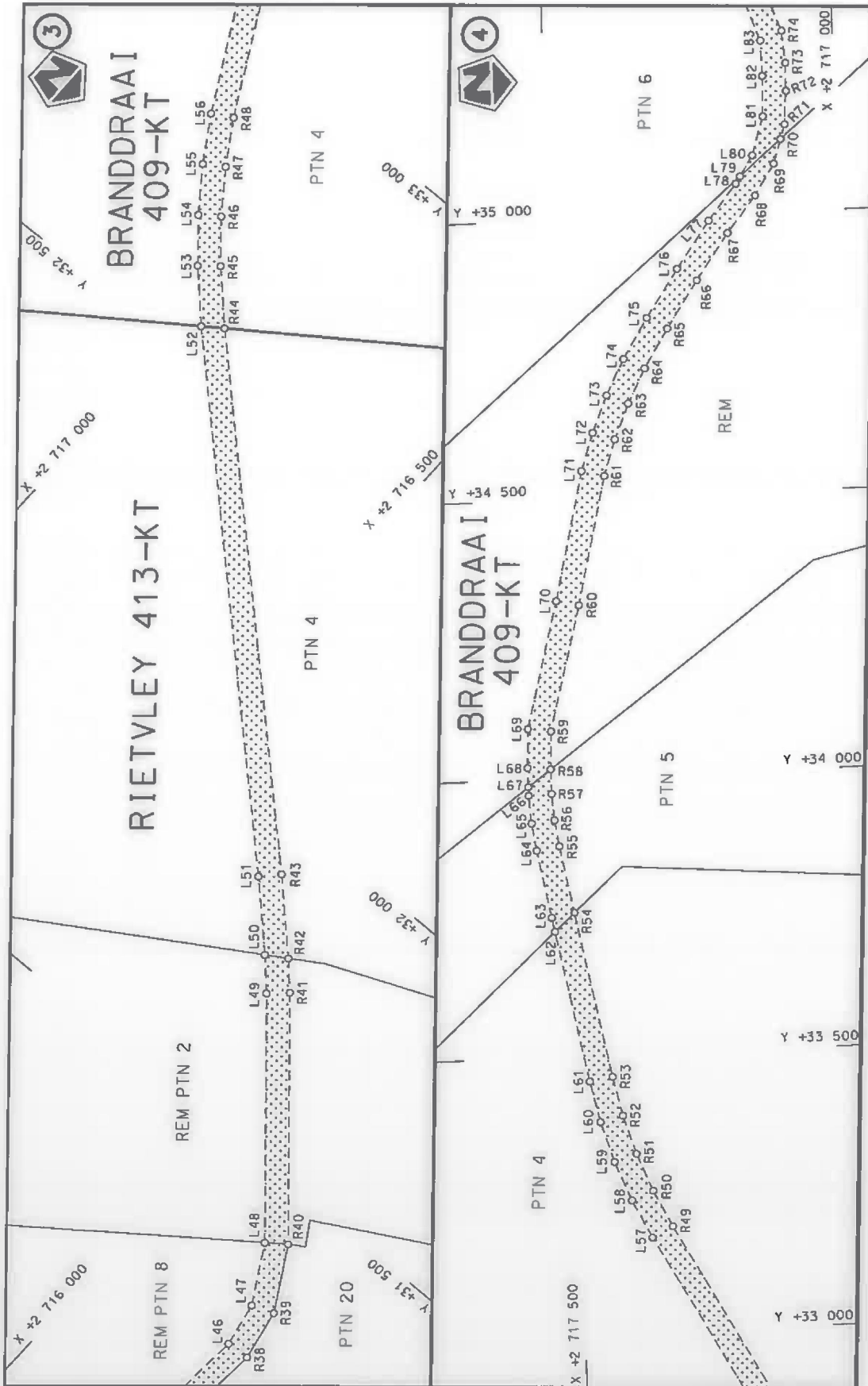

<p>Die Suid Afrikaanse Nasionale Padagentskap MSB Bpk The South African National Roads Agency SOC Ltd</p>	<p>Die figuur getoon The figure shown</p>	<p>steldie padreserwe voor van 'n gedeelte represents the road reserve of a portion van Nasionale Roete R532 of National Route</p> <p>3</p>	<p>Vel Sheet 2 of 5 Plan P1068/18</p>
---	---	---	---

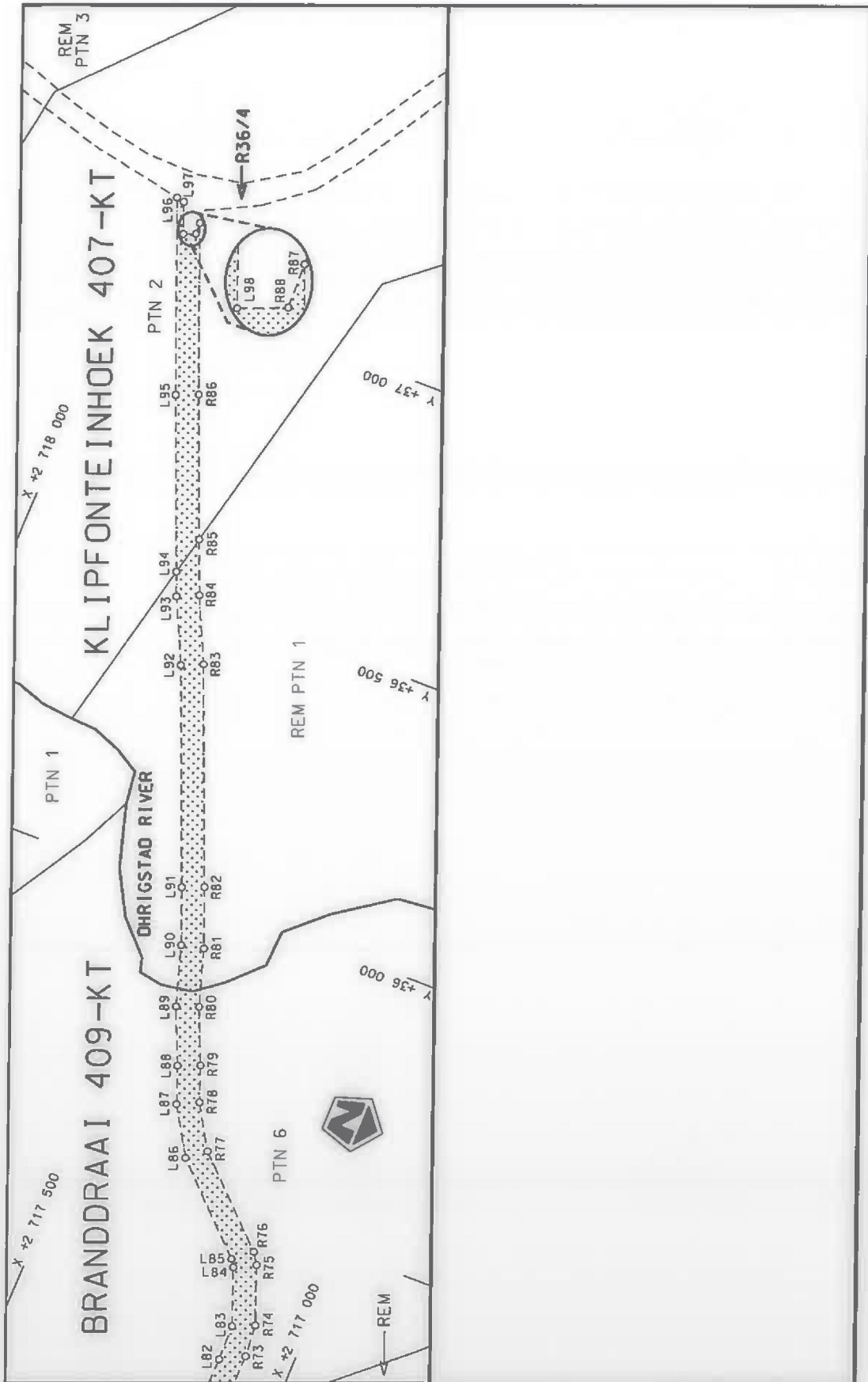

<p>Die Suid Afrikaanse Nasionale Padagentskap MSB Bpk The South African National Roads Agency SOC Ltd</p>	<p>Die figuur getoon The figure shown</p> 	<p>steldie podreserwe voor van 'n gedeelte represents the road reserve of a portion van Nasionale Roete R532 Seksie 3 of National Route Section</p>	<p>Vel Sheet 3 of 5 Plan P1068/18</p>
---	---	---	---

PADRESERWE KOÖRDINATE / ROAD RESERVE CO-ORDINATES						
LINKERKANT/LEFT HAND SIDE				REGTERKANT/RIGHT HAND SIDE		
	Y	X	WG 31°		Y	X
L1	27 136.14	2 716 693.75		R1	27 134.61	2 716 636.86
L2	27 336.82	2 716 479.47		R2	27 317.15	2 716 441.96
L3	27 361.33	2 716 449.45		R3	27 331.91	2 716 420.87
L4	27 378.70	2 716 414.81		R4	27 342.45	2 716 397.38
L5	27 388.10	2 716 377.21		R5	27 348.39	2 716 372.33
L6	27 389.96	2 716 347.59		R6	27 349.97	2 716 346.05
L7	27 389.07	2 716 317.92		R7	27 349.09	2 716 319.74
L8	27 388.65	2 716 285.05		R8	27 348.66	2 716 285.84
L9	27 390.22	2 716 262.55		R9	27 351.50	2 716 251.94
L10	27 396.13	2 716 240.79		R10	27 361.65	2 716 219.47
L11	27 406.16	2 716 220.58		R11	27 380.30	2 716 187.37
L12	27 425.29	2 716 196.05		R12	27 405.28	2 716 159.91
L13	27 449.50	2 716 176.52		R13	27 435.48	2 716 138.31
L14	27 477.52	2 716 163.02		R14	27 469.53	2 716 123.54
L15	27 507.88	2 716 156.26		R15	27 505.94	2 716 116.25
L16	27 763.95	2 716 156.35		R16	27 764.02	2 716 116.35
L17	27 802.99	2 716 152.64		R17	27 801.51	2 716 112.05
L18	27 840.56	2 716 141.41		R18	27 836.96	2 716 099.12
L19	27 875.23	2 716 123.08		R19	27 868.41	2 716 078.29
L20	27 905.67	2 716 098.37		R20	27 894.14	2 716 050.69
L21	27 930.73	2 716 068.20		R21	27 912.72	2 716 017.85
L22	27 949.44	2 716 033.74		R22	27 933.91	2 715 970.17
L23	27 970.67	2 715 985.95		R23	27 958.47	2 715 918.00
L24	27 994.08	2 715 936.24		R24	27 981.89	2 715 878.32
L25	28 020.40	2 715 893.27		R25	28 010.80	2 715 842.45
L26	28 054.07	2 715 855.76		R26	28 044.61	2 715 811.14
L27	28 093.96	2 715 824.97		R27	28 243.20	2 715 678.47
L28	28 138.77	2 715 801.90		R28	28 398.41	2 715 553.79
L29	28 214.80	2 715 771.16		R29	28 608.36	2 715 534.30
L30	28 250.18	2 715 753.40		R30	28 764.31	2 715 594.37
L31	28 282.12	2 715 730.03		R31	28 828.16	2 715 594.62
L32	28 351.05	2 715 671.12		R32	29 157.45	2 715 662.96
L33	28 387.66	2 715 643.53		R33	29 777.36	2 715 771.84
L34	28 428.23	2 715 622.17		R34	30 166.84	2 715 840.23
L35	28 471.69	2 715 607.58		R35	30 352.41	2 715 854.05
L36	28 516.93	2 715 600.14		R36	30 525.61	2 715 832.09
L37	28 562.77	2 715 600.05		R37	31 095.74	2 715 706.52
L38	28 748.15	2 715 631.87		R38	31 217.76	2 715 696.64
L39	28 854.81	2 715 648.94		R39	31 307.60	2 715 713.99
L40	29 925.92	2 715 837.01		R40	31 417.11	2 715 776.40
L41	30 210.37	2 715 887.07		R41	31 759.89	2 716 071.05
L42	30 302.29	2 715 894.07		R42	31 804.73	2 716 113.49
L43	30 392.24	2 715 892.47		R43	31 911.08	2 716 221.42
L44	30 482.43	2 715 881.27		R44	32 584.81	2 716 940.14
L45	31 092.35	2 715 746.92		R45	32 664.19	2 717 018.68
L46	31 215.54	2 715 736.95		R46	32 731.86	2 717 076.43
L47	31 293.53	2 715 752.01		R47	32 803.50	2 717 129.16
L48	31 393.30	2 715 808.68		R48	32 878.75	2 717 176.62
L49	31 733.01	2 716 100.69		R49	33 188.22	2 717 343.19
L50	31 783.10	2 716 148.54		R50	33 253.45	2 717 374.79
L51	31 882.24	2 716 249.14		R51	33 320.98	2 717 401.10

Vel Sheet	4	Van of	5	P1068/18
-----------	---	--------	---	----------

PADRESERWE KOÖRDINATE / ROAD RESERVE CO-ORDINATES					
LINKERKANT/LEFT HAND SIDE			REGTERKANT/RIGHT HAND SIDE		
	Y	X	WG 31°	Y	X
L52	32 561.26	2 716 973.50		R52	33 390.39 2 717 421.95
L53	32 638.71	2 717 049.58		R53	33 461.20 2 717 437.19
L54	32 708.19	2 717 108.71		R54	33 758.24 2 717 492.97
L55	32 781.72	2 717 162.73		R55	33 878.75 2 717 514.94
L56	32 858.92	2 717 211.35		R56	33 925.70 2 717 521.87
L57	33 169.31	2 717 378.44		R57	33 973.04 2 717 525.33
L58	33 237.42	2 717 411.44		R58	34 017.38 2 717 525.43
L59	33 307.90	2 717 438.90		R59	34 085.49 2 717 522.84
L60	33 380.35	2 717 460.67		R60	34 309.22 2 717 467.55
L61	33 454.35	2 717 476.60		R61	34 539.46 2 717 416.59
L62	33 725.62	2 717 527.54		R62	34 604.15 2 717 396.40
L63	33 750.96	2 717 532.30		R63	34 667.36 2 717 371.41
L64	33 872.24	2 717 554.42		R64	34 729.04 2 717 341.45
L65	33 921.32	2 717 561.66		R65	34 798.46 2 717 300.83
L66	33 971.59	2 717 565.33		R66	34 882.80 2 717 247.20
L67	33 986.84	2 717 565.33		R67	34 965.24 2 717 191.00
L68	34 021.27	2 717 565.31		R68	35 030.16 2 717 141.27
L69	34 091.10	2 717 562.65		R69	35 085.93 2 717 107.08
L70	34 318.43	2 717 506.48		R70	35 129.53 2 717 093.97
L71	34 549.75	2 717 455.28		R71	35 155.61 2 717 086.12
L72	34 617.48	2 717 434.15		R72	35 215.36 2 717 081.67
L73	34 683.46	2 717 408.06		R73	35 265.39 2 717 081.37
L74	34 747.30	2 717 377.10		R74	35 323.21 2 717 086.66
L75	34 819.30	2 717 334.98		R75	35 425.03 2 717 124.91
L76	34 904.80	2 717 280.61		R76	35 445.22 2 717 138.32
L77	34 988.69	2 717 223.43		R77	35 584.43 2 717 280.09
L78	35 052.84	2 717 174.29		R78	35 661.23 2 717 326.08
L79	35 065.62	2 717 166.45		R79	35 723.41 2 717 349.33
L80	35 102.42	2 717 143.89		R80	35 820.51 2 717 391.18
L81	35 171.39	2 717 123.15		R81	35 921.12 2 717 422.41
L82	35 243.67	2 717 121.70		R82	36 023.96 2 717 462.95
L83	35 307.32	2 717 123.41		R83	36 395.25 2 717 614.58
L84	35 406.70	2 717 160.75		R84	36 507.46 2 717 668.08
L85	35 419.61	2 717 169.33		R85	36 600.25 2 717 706.04
L86	35 559.48	2 717 311.77		R86	36 841.47 2 717 804.75
L87	35 643.81	2 717 362.27		R87	37 127.80 2 717 918.75
L88	35 708.48	2 717 386.46		R88	37 107.25 2 717 918.04
L89	35 806.57	2 717 428.73			
L90	35 912.11	2 717 461.85			
L91	36 009.06	2 717 500.08			
L92	36 379.07	2 717 651.17			
L93	36 491.27	2 717 704.67			
L94	36 532.19	2 717 721.41			
L95	36 826.50	2 717 841.84			
L96	37 155.65	2 717 972.89			
L97	37 152.89	2 717 959.33			
L98	37 098.93	2 717 938.45			

Vel
Sheet

5

Van
of

5

P1068/18