

DEPARTMENT OF TRANSPORT

NO. 411

15 MARCH 2019

**THE SOUTH AFRICAN NATIONAL ROADS  
AGENCY SOC LIMITED**

Registration No: 1998/009584/30

**DECLARATION AMENDMENT OF NATIONAL ROAD N3 SECTION 6X**

AMENDMENT OF DECLARATION No. 256 OF 1980.

By virtue of Section 40 (1)(b) of The South African National Roads Agency Limited and National Roads Act, 1998 (Act No. 7 of 1998), I hereby amend Declaration No. 256 of 1980 by substituting it in its entirety, with the accompanying sheets 1 to 13 of Plan No. P1049/18.

**(National Road N3 Section 6X: Keevers Fontein – Van Reenen)**



MINISTER OF TRANSPORT

## DEPARTEMENT VAN VERVOER

NO. 411

15 MAART 2019

**DIE SUID-AFRIKAANSE NASIONALE  
PADAGENTSKAP MSB BEPERK**

Registrasie No: 1998/009584/30

**VERKLARING WYSIGING VAN NASIONALE PAD N3 SEKSIE 6X**

WYSIGING VAN VERKLARING No. 256 VAN 1980.

Kragtens Artikel 40(1)(b) van die Wet op die Suid-Afrikaanse Nasionale Padagentskap Beperk en op Nasionale Paaie, 1998 (Wet No. 7 van 1998), wysig ek hiermee Verklaring No. 256 van 1980 deur dit in sy geheel te vervang, met bygaande velle 1 tot 13 van Plan No. P1049/18.

**(Nasional Pad N3 Seksie 6X: Keevers Fontein –Van Reenen)****MINISTER VAN VERVOER**

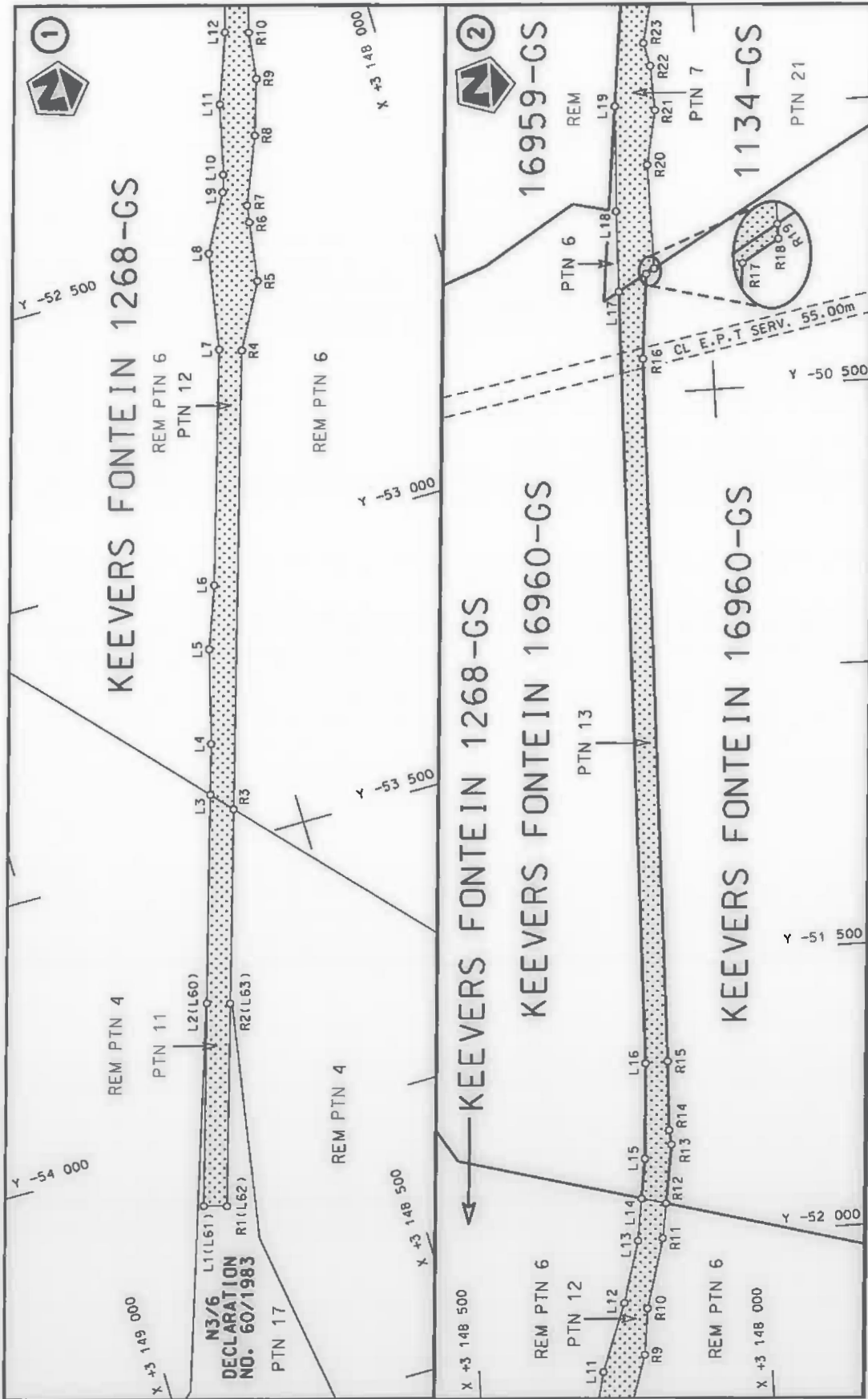

<p>Die Suid Afrikaanse Nasionale Padagentskap MSB Bpk The South African National Roads Agency SOC Ltd</p>	<p>Die figuur getoon The figure shown</p> 	<p>steldie padreserwe voor van 'n gedeelte represents the road reserve of a portion van Nasionale Roete of National Route</p> <p>N3      6X Seksie      Section</p>	<p>Vel Sheet 1 of 13 Plan P1049/18</p>
---	---	---	--

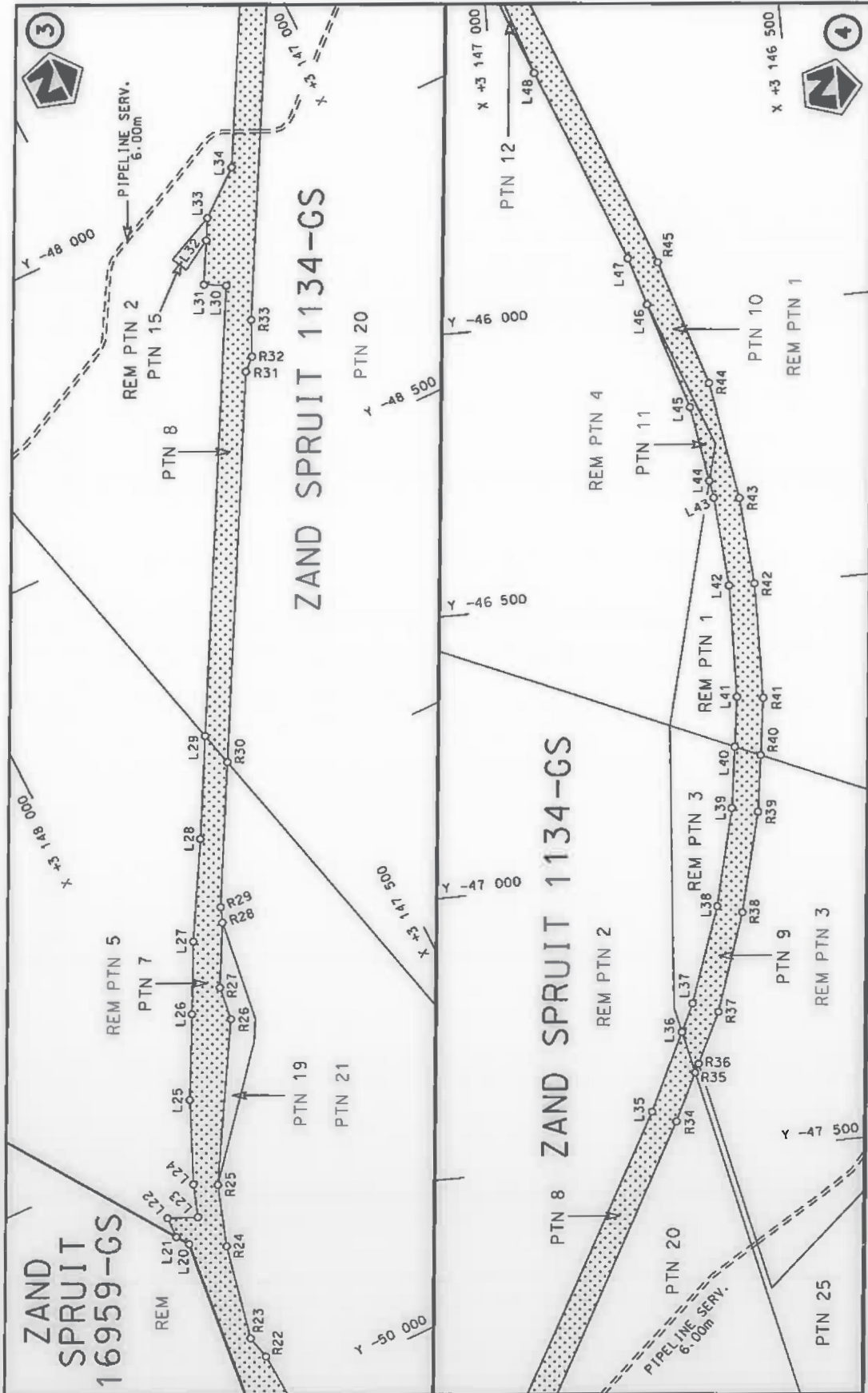

Vel Sheet 2 of 13 Plan P1049/18	steldie padreserwe voor van 'n gedeelte represents the road reserve of a portion van Nasionale Roete N3 of National Route Seksie Section 6X	Die figuur getoon The figure shown  Die Suid-Afrikaanse Nasionale Padagentskap MSB Bpk The South African National Roads Agency SOC Ltd
---------------------------------------	---	--

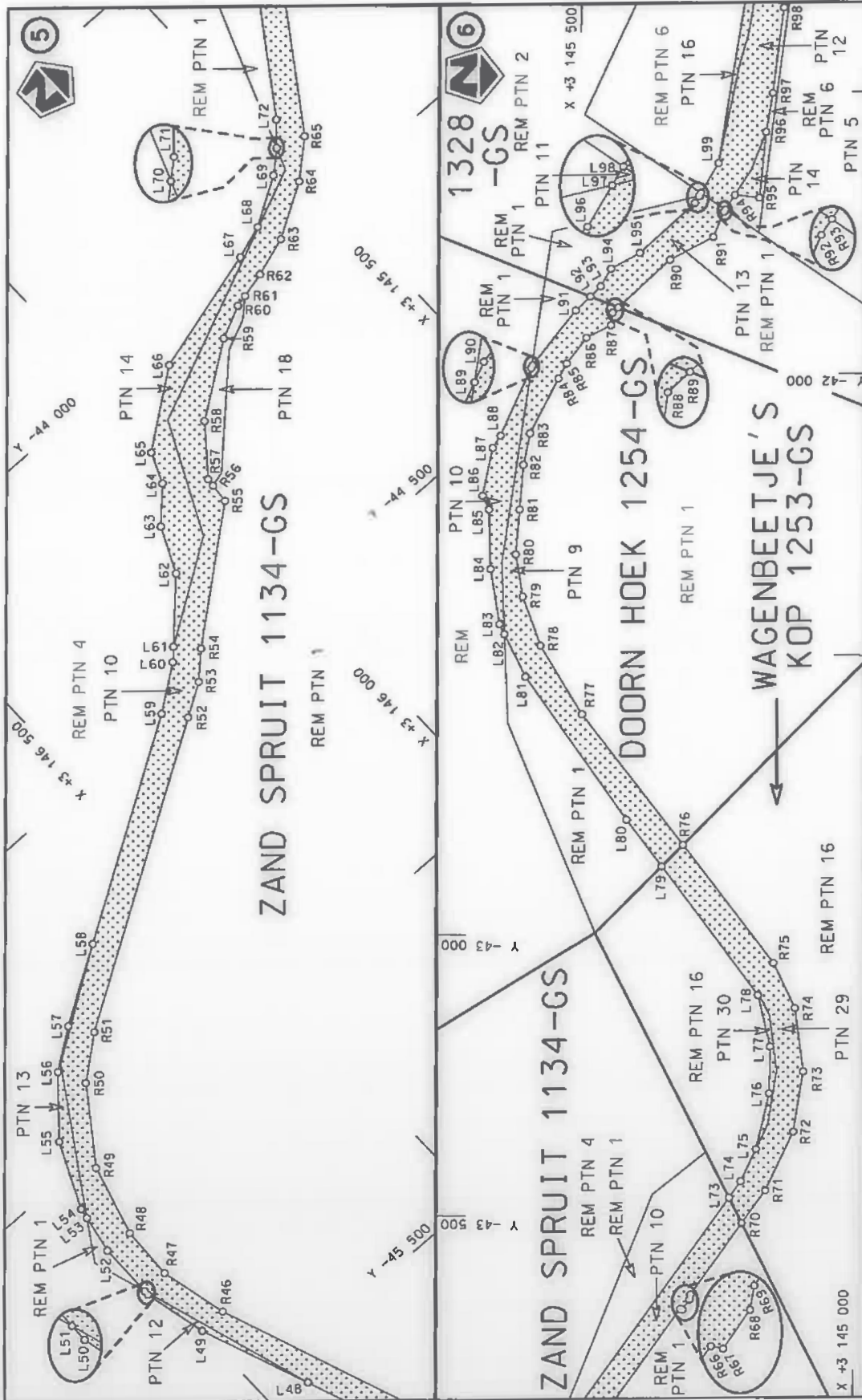

Die Suid Afrikaanse Nasionale Padagentskap MSB Bpk The South African National Roads Agency SOC Ltd	Die figuur getoon The figure shown		steldie padreserwe voor van 'n gedeelte represents the road reserve of a portion van Nasionale Roete N3 of National Route Section	Vel Sheet 3 of 13
				Plan P1049/18



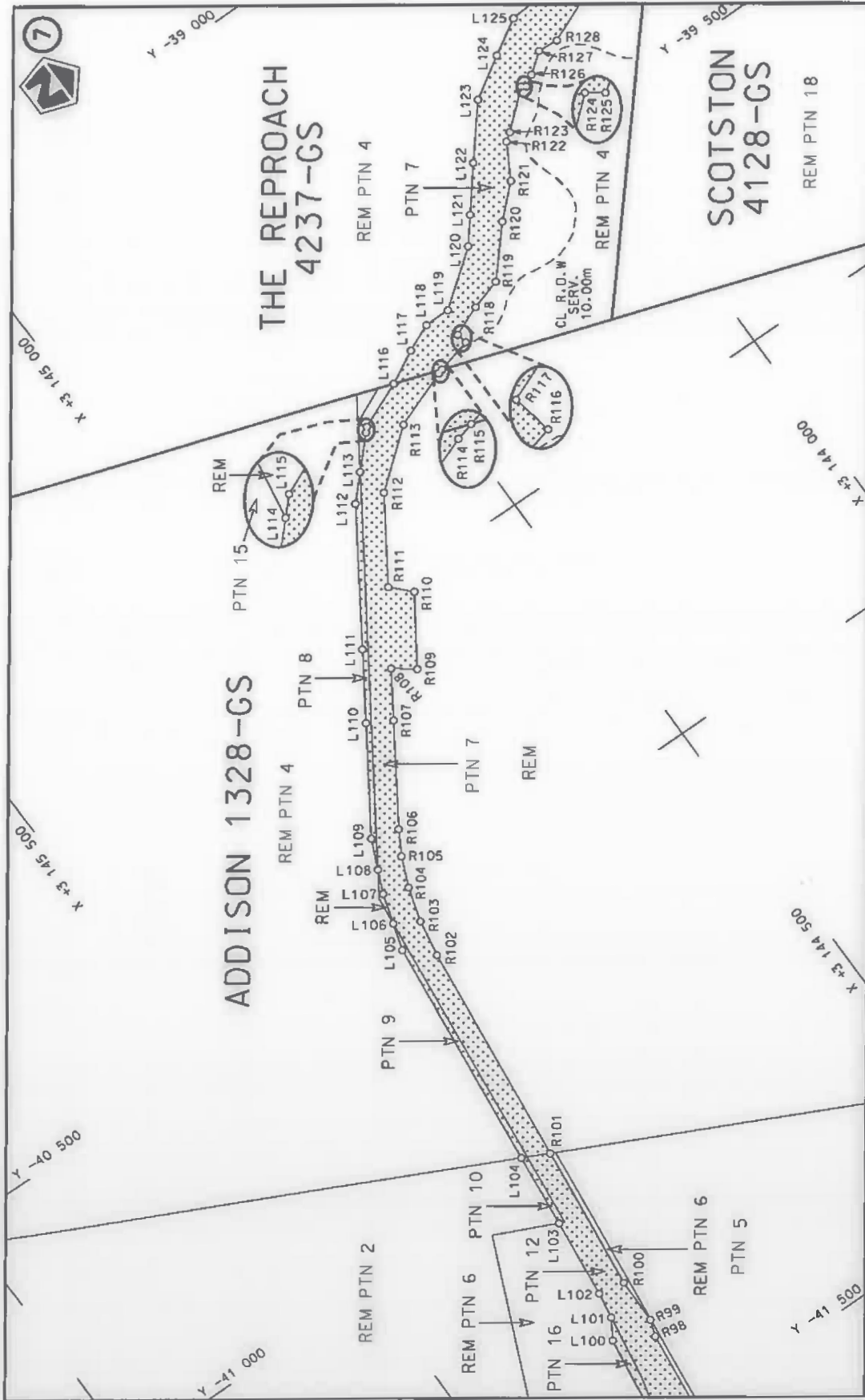

Vel  
Sheet 4 of 13  
Plan P1049/18

stelt die padreserwe voor van 'n gedeelte  
represents the road reserve of a portion  
van Nasionale Roete N3  
of National Route Section 6X



Die figuur getoon  
The figure shown

Die Suid Afrikaanse Nasionale Padagentskap MSB Bpk  
The South African National Roads Agency SOC Ltd

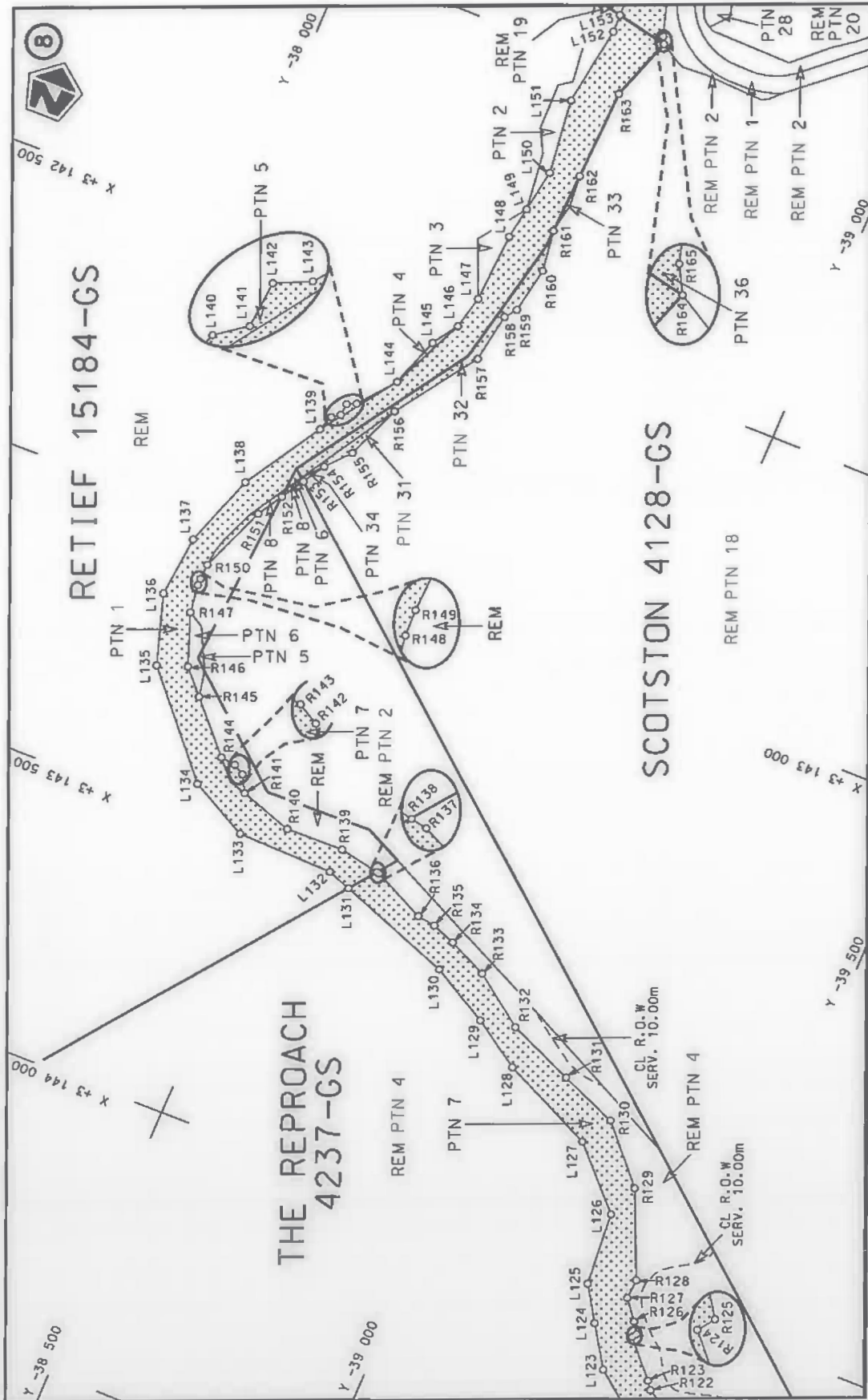

Die Suid Afrikaanse Nasionale Podogentskap MSB Bpk  
The South African National Roads Agency SOC Ltd

Die figuur getoon  
The figure shown

stelt die padreserwe voor van 'n gedeelte  
represents the road reserve of a portion  
van Nasionale Roete N3  
of National Route

Plan P1049/18

Section 6X

Sheet 5 of 13

Van 5 van 13

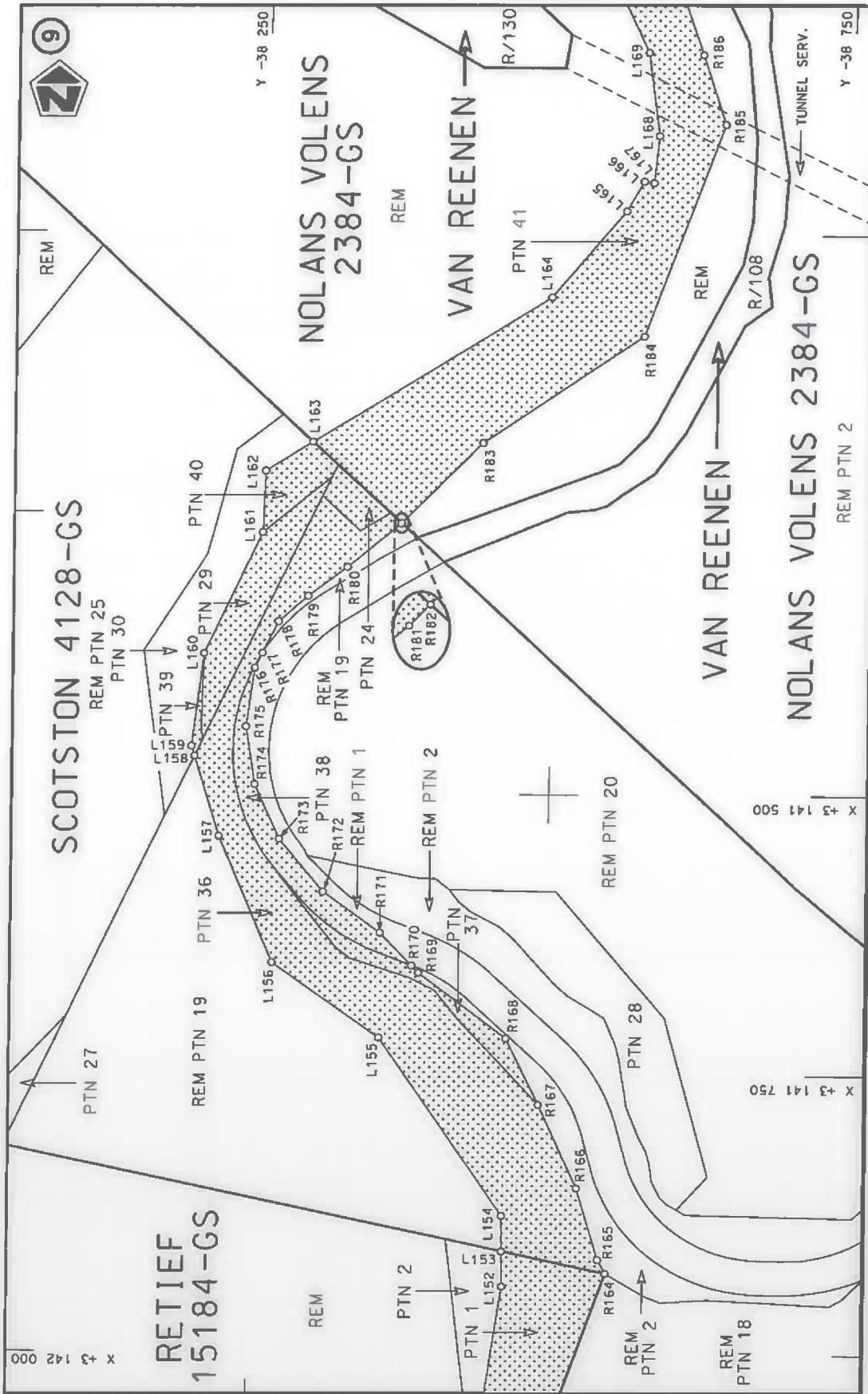

Vel  
Sheet 6 of 13  
Plan P1049/18

steldie padreserwe voor van 'n gedeelte  
represents the road reserve of a portion  
van Nasionale Roete N3 Sektie  
of National Route N3 Section 6X



Die figuur getoon  
The figure shown

Die Suid Afrikaanse Nasionale Padagentskap MSB Bpk  
The South African National Roads Agency SOC Ltd





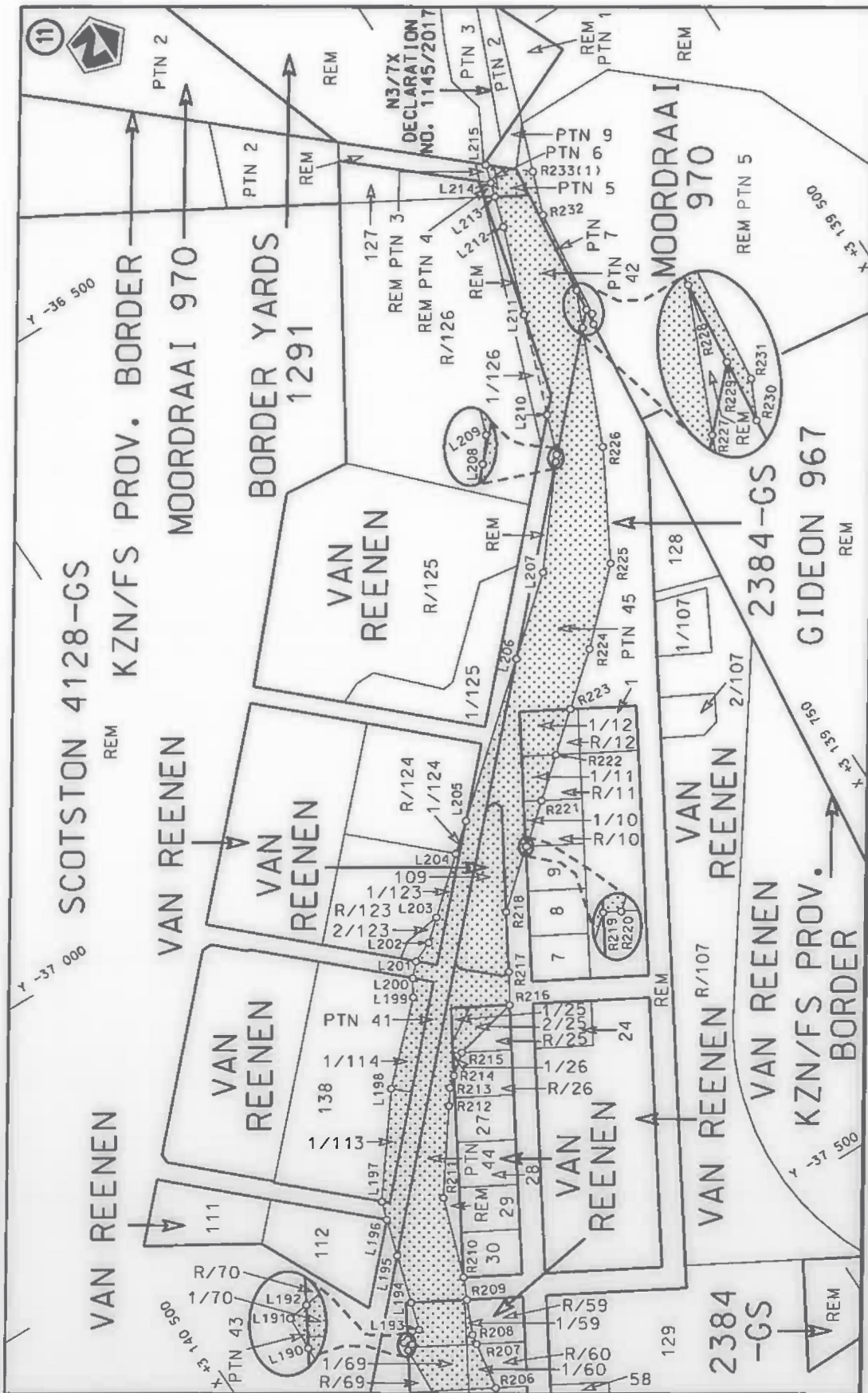

Die Suid Afrikaanse Nasionale Padagentskap MSB Bpk The South African National Roads Agency SOC Ltd	stel die padreserwe voor van 'n gedeelte represents the road reserve of a portion van Nasionale Roete of National Route	Vel Sheet 8 of 13
Die figuur getoon The figure shown	N3 Seksie Section	Plan P1049/18
	6X	

PADRESERWE KOÖRDINATE / ROAD RESERVE CO-ORDINATES									
LINKERKANT/LEFT HAND SIDE				REGTERKANT/RIGHT HAND SIDE					
	Y	X	WG 29°		Y	X			
L1	-54	108.32	3 148	851.74	R1	-54	120.06	3 148	813.32
L2	-53	762.81	3 148	747.10	R2	-53	774.69	3 148	708.50
L3	-53	407.91	3 148	639.43	R3	-53	443.90	3 148	607.93
L4	-53	321.34	3 148	613.19	R4	-52	664.02	3 148	371.07
L5	-53	158.35	3 148	570.25	R5	-52	552.99	3 148	311.90
L6	-53	051.58	3 148	530.81	R6	-52	448.82	3 148	296.58
L7	-52	651.19	3 148	407.91	R7	-52	418.66	3 148	292.14
L8	-52	482.15	3 148	378.87	R8	-52	303.43	3 148	245.78
L9	-52	384.41	3 148	326.17	R9	-52	207.02	3 148	215.80
L10	-52	354.46	3 148	316.71	R10	-52	124.79	3 148	206.10
L11	-52	233.10	3 148	288.21	R11	-52	001.72	3 148	173.23
L12	-52	112.61	3 148	245.20	R12	-51	940.12	3 148	164.12
L13	-52	003.22	3 148	215.48	R13	-51	836.07	3 148	148.74
L14	-51	928.57	3 148	205.05	R14	-51	810.14	3 148	151.51
L15	-51	858.13	3 148	195.21	R15	-51	687.77	3 148	146.76
L16	-51	688.74	3 148	184.20	R16	-50	437.51	3 148	117.83
L17	-50	315.96	3 148	152.19	R17	-50	287.43	3 148	103.96
L18	-50	173.34	3 148	148.87	R18	-50	279.07	3 148	090.25
L19	-49	986.84	3 148	140.74	R19	-50	278.66	3 148	090.25
L20	-49	679.93	3 148	107.32	R20	-50	094.23	3 148	091.61
L21	-49	658.99	3 148	121.14	R21	-49	998.40	3 148	073.08
L22	-49	622.00	3 148	120.20	R22	-49	919.38	3 148	076.89
L23	-49	643.62	3 148	072.47	R23	-49	878.43	3 148	086.07
L24	-49	587.23	3 148	054.11	R24	-49	712.25	3 148	051.14
L25	-49	448.87	3 147	994.08	R25	-49	606.73	3 148	016.77
L26	-49	312.78	3 147	923.94	R26	-49	350.49	3 147	867.67
L27	-49	197.20	3 147	865.24	R27	-49	291.57	3 147	860.13
L28	-49	037.93	3 147	774.75	R28	-49	188.97	3 147	805.76
L29	-48	876.27	3 147	687.50	R29	-49	162.74	3 147	796.38
L30	-48	169.90	3 147	306.27	R30	-48	935.16	3 147	673.44
L31	-48	151.35	3 147	340.02	R31	-48	322.92	3 147	342.69
L32	-48	082.26	3 147	302.27	R32	-48	303.56	3 147	321.66
L33	-48	047.16	3 147	283.09	R33	-48	244.00	3 147	294.70
L34	-47	984.55	3 147	206.90	R34	-47	437.69	3 146	859.29
L35	-47	416.31	3 146	899.41	R35	-47	354.30	3 146	818.99
L36	-47	279.89	3 146	834.92	R36	-47	339.29	3 146	811.74
L37	-47	230.96	3 146	811.79	R37	-47	250.31	3 146	768.74
L38	-47	062.63	3 146	753.41	R38	-47	078.07	3 146	711.15
L39	-46	890.76	3 146	711.76	R39	-46	902.40	3 146	667.49
L40	-46	782.55	3 146	696.84	R40	-46	802.23	3 146	653.67
L41	-46	694.40	3 146	684.68	R41	-46	701.21	3 146	639.73
L42	-46	495.49	3 146	679.88	R42	-46	496.45	3 146	635.91
L43	-46	337.13	3 146	691.79	R43	-46	342.12	3 146	647.61
L44	-46	306.62	3 146	696.50	R44	-46	132.87	3 146	681.11
L45	-46	172.52	3 146	717.24	R45	-45	909.68	3 146	748.68
L46	-45	982.68	3 146	774.06	R46	-45	360.03	3 146	950.81
L47	-45	897.30	3 146	799.61	R47	-45	242.12	3 146	977.72
L48	-45	552.32	3 146	928.53	R48	-45	149.23	3 146	973.82
L49	-45	362.32	3 146	999.55	R49	-45	023.99	3 146	938.68
L50	-45	251.79	3 147	024.19	R50	-44	899.67	3 146	850.77
L51	-45	243.49	3 147	024.06	R51	-44	842.08	3 146	779.66

Vel Sheet	9	Van of	13	P1049/18
-----------	---	--------	----	----------



PADRESERWE KOÖRDINATE / ROAD RESERVE CO-ORDINATES					
LINKERKANT/LEFT HAND SIDE			REGTERKANT/RIGHT HAND SIDE		
	Y	X	WG 29°		X
L52	-45 146.94	3 147 022.54		R52	-44 533.62 3 146 288.71
L53	-45 079.75	3 147 009.80		R53	-44 498.87 3 146 233.39
L54	-45 061.38	3 147 006.32		R54	-44 457.31 3 146 190.88
L55	-44 946.53	3 146 954.08		R55	-44 289.58 3 145 986.12
L56	-44 852.54	3 146 872.79		R56	-44 255.68 3 145 982.98
L57	-44 804.07	3 146 805.38		R57	-44 241.53 3 145 981.66
L58	-44 723.47	3 146 676.73		R58	-44 160.62 3 145 917.43
L59	-44 498.28	3 146 317.30		R59	-44 073.17 3 145 795.53
L60	-44 442.75	3 146 242.35		R60	-44 046.65 3 145 738.92
L61	-44 423.03	3 146 223.43		R61	-44 041.68 3 145 718.91
L62	-44 329.13	3 146 133.36		R62	-44 030.62 3 145 674.41
L63	-44 249.57	3 146 096.67		R63	-44 008.09 3 145 606.38
L64	-44 194.40	3 146 043.56		R64	-43 952.64 3 145 515.12
L65	-44 140.83	3 146 021.26		R65	-43 899.07 3 145 454.86
L66	-44 045.78	3 145 895.16		R66	-43 664.01 3 145 297.52
L67	-43 985.14	3 145 678.68		R67	-43 664.93 3 145 293.22
L68	-43 965.05	3 145 621.36		R68	-43 647.13 3 145 281.63
L69	-43 914.97	3 145 540.51		R69	-43 638.33 3 145 280.29
L70	-43 882.82	3 145 504.35		R70	-43 510.58 3 145 194.00
L71	-43 882.37	3 145 503.84		R71	-43 452.12 3 145 154.51
L72	-43 844.53	3 145 470.98		R72	-43 347.44 3 145 107.27
L73	-43 465.39	3 145 216.59		R73	-43 239.98 3 145 091.82
L74	-43 435.87	3 145 196.79		R74	-43 127.66 3 145 107.38
L75	-43 378.73	3 145 171.42		R75	-43 047.47 3 145 146.31
L76	-43 279.57	3 145 150.18		R76	-42 838.43 3 145 304.09
L77	-43 196.33	3 145 149.62		R77	-42 606.82 3 145 478.99
L78	-43 104.73	3 145 172.12		R78	-42 485.11 3 145 551.34
L79	-42 876.53	3 145 339.79		R79	-42 398.36 3 145 582.91
L80	-42 793.69	3 145 400.73		R80	-42 323.33 3 145 596.05
L81	-42 540.47	3 145 575.99		R81	-42 243.70 3 145 590.68
L82	-42 464.91	3 145 613.28		R82	-42 164.08 3 145 585.31
L83	-42 447.23	3 145 622.00		R83	-42 108.40 3 145 574.73
L84	-42 349.34	3 145 639.08		R84	-42 010.87 3 145 528.17
L85	-42 243.91	3 145 643.08		R85	-41 984.24 3 145 514.61
L86	-42 219.28	3 145 654.65		R86	-41 938.19 3 145 481.69
L87	-42 134.36	3 145 638.53		R87	-41 916.03 3 145 440.40
L88	-42 112.66	3 145 625.40		R88	-41 893.82 3 145 438.07
L89	-41 992.14	3 145 574.42		R89	-41 884.74 3 145 428.80
L90	-41 987.60	3 145 572.51		R90	-41 799.95 3 145 342.29
L91	-41 890.24	3 145 500.78		R91	-41 759.07 3 145 269.30
L92	-41 865.23	3 145 476.51		R92	-41 714.15 3 145 251.19
L93	-41 847.18	3 145 459.00		R93	-41 710.64 3 145 249.05
L94	-41 815.76	3 145 441.98		R94	-41 684.61 3 145 233.20
L95	-41 787.78	3 145 393.43		R95	-41 689.03 3 145 191.00
L96	-41 699.05	3 145 301.26		R96	-41 572.38 3 145 181.13
L97	-41 686.79	3 145 294.53		R97	-41 503.24 3 145 170.50
L98	-41 681.27	3 145 291.49		R98	-41 352.07 3 145 153.94
L99	-41 628.21	3 145 262.31		R99	-41 322.96 3 145 143.78
L100	-41 315.56	3 145 217.55		R100	-41 242.48 3 145 142.92
L101	-41 280.52	3 145 195.99		R101	-40 980.52 3 145 112.78
L102	-41 233.24	3 145 188.36		R102	-40 579.20 3 145 066.62

Vel Sheet	10	Van of	13
--------------	----	-----------	----

P1049/18
----------

PADRESERWE KOÖRDINATE / ROAD RESERVE CO-ORDINATES					
LINKERKANT/LEFT HAND SIDE			REGTERKANT/RIGHT HAND SIDE		
	Y	X	WG 29°	Y	X
L103	-41 091.01	3 145 172.19		R103	-40 513.65 3 145 055.11
L104	-40 958.65	3 145 157.15		R104	-40 452.47 3 145 036.87
L105	-40 537.67	3 145 109.31		R105	-40 399.96 3 145 014.86
L106	-40 489.86	3 145 094.88		R106	-40 357.63 3 144 990.91
L107	-40 436.75	3 145 078.87		R107	-40 194.22 3 144 887.20
L108	-40 396.21	3 145 061.17		R108	-40 116.04 3 144 837.58
L109	-40 344.39	3 145 038.55		R109	-40 142.74 3 144 802.14
L110	-40 170.68	3 144 927.93		R110	-40 027.13 3 144 727.24
L111	-40 059.77	3 144 857.67		R111	-39 994.68 3 144 758.77
L112	-39 840.82	3 144 719.10		R112	-39 852.71 3 144 668.45
L113	-39 799.04	3 144 680.07		R113	-39 772.95 3 144 572.03
L114	-39 747.61	3 144 632.02		R114	-39 733.29 3 144 471.05
L115	-39 739.83	3 144 624.75		R115	-39 731.05 3 144 462.83
L116	-39 703.90	3 144 544.14		R116	-39 714.59 3 144 402.27
L117	-39 672.49	3 144 486.81		R117	-39 695.84 3 144 405.70
L118	-39 650.81	3 144 439.38		R118	-39 673.21 3 144 352.49
L119	-39 650.41	3 144 394.26		R119	-39 656.17 3 144 299.05
L120	-39 577.38	3 144 301.43		R120	-39 574.91 3 144 228.93
L121	-39 533.29	3 144 266.44		R121	-39 524.34 3 144 176.16
L122	-39 461.09	3 144 209.53		R122	-39 462.74 3 144 142.22
L123	-39 373.75	3 144 138.95		R123	-39 452.21 3 144 128.18
L124	-39 327.96	3 144 068.16		R124	-39 397.22 3 144 066.06
L125	-39 290.02	3 144 007.66		R125	-39 402.41 3 144 058.83
L126	-39 279.17	3 143 878.84		R126	-39 389.87 3 144 040.13
L127	-39 183.73	3 143 777.82		R127	-39 362.70 3 144 005.55
L128	-39 022.21	3 143 700.63		R128	-39 365.05 3 143 970.46
L129	-38 939.87	3 143 644.00		R129	-39 299.26 3 143 820.64
L130	-38 840.32	3 143 586.51		R130	-39 213.76 3 143 725.06
L131	-38 640.52	3 143 511.90		R131	-39 113.71 3 143 683.08
L132	-38 600.06	3 143 496.87		R132	-38 999.39 3 143 632.98
L133	-38 431.46	3 143 492.58		R133	-38 910.26 3 143 566.04
L134	-38 329.72	3 143 437.66		R134	-38 842.87 3 143 533.69
L135	-38 184.24	3 143 269.44		R135	-38 802.18 3 143 517.76
L136	-38 145.16	3 143 147.16		R136	-38 770.49 3 143 512.57
L137	-38 154.43	3 143 039.89		R137	-38 678.55 3 143 467.73
L138	-38 197.49	3 142 912.96		R138	-38 674.63 3 143 466.94
L139	-38 279.71	3 142 778.05		R139	-38 604.21 3 143 452.75
L140	-38 289.11	3 142 750.69		R140	-38 503.23 3 143 454.28
L141	-38 302.33	3 142 741.02		R141	-38 410.74 3 143 422.98
L142	-38 304.11	3 142 719.69		R142	-38 394.10 3 143 393.69
L143	-38 319.68	3 142 712.46		R143	-38 375.39 3 143 382.84
L144	-38 368.63	3 142 650.74		R144	-38 349.47 3 143 379.26
L145	-38 398.11	3 142 564.19		R145	-38 272.26 3 143 294.04
L146	-38 426.47	3 142 520.33		R146	-38 233.99 3 143 251.80
L147	-38 439.29	3 142 463.20		R147	-38 200.36 3 143 161.19
L148	-38 444.65	3 142 341.89		R148	-38 193.50 3 143 111.92
L149	-38 452.98	3 142 285.62		R149	-38 193.19 3 143 099.94
L150	-38 463.96	3 142 211.42		R150	-38 194.22 3 143 072.64
L151	-38 447.63	3 142 079.43		R151	-38 239.60 3 142 956.18
L152	-38 467.34	3 141 939.85		R152	-38 265.64 3 142 913.10
L153	-38 466.51	3 141 908.29		R153	-38 289.24 3 142 874.06

Vel Sheet	11	Van of	13
--------------	----	-----------	----

P1049/18
----------



PADRESERWE KOÖRDINATE / ROAD RESERVE CO-ORDINATES							
LINKERKANT/LEFT HAND SIDE				REGTERKANT/RIGHT HAND SIDE			
	Y	X	WG 29°		Y	X	
L154	-38 465.88	3 141	876.48	R154	-38 312.02	3 142	836.34
L155	-38 358.17	3 141	717.96	R155	-38 347.10	3 142	795.69
L156	-38 266.02	3 141	651.60	R156	-38 385.02	3 142	700.53
L157	-38 218.31	3 141	539.09	R157	-38 479.73	3 142	561.41
L158	-38 195.90	3 141	467.54	R158	-38 492.59	3 142	475.85
L159	-38 193.14	3 141	458.71	R159	-38 507.02	3 142	456.47
L160	-38 202.49	3 141	375.94	R160	-38 520.72	3 142	376.16
L161	-38 251.17	3 141	267.61	R161	-38 509.91	3 142	303.73
L162	-38 252.65	3 141	212.70	R162	-38 513.57	3 142	197.56
L163	-38 292.68	3 141	186.70	R163	-38 519.07	3 142	037.65
L164	-38 493.88	3 141	056.03	R164	-38 556.47	3 141	927.68
L165	-38 556.63	3 140	978.86	R165	-38 549.79	3 141	915.39
L166	-38 570.95	3 140	952.31	R166	-38 530.32	3 141	851.44
L167	-38 579.21	3 140	953.40	R167	-38 495.74	3 141	777.02
L168	-38 583.08	3 140	911.50	R168	-38 466.77	3 141	717.99
L169	-38 572.67	3 140	837.45	R169	-38 390.92	3 141	659.83
L170	-38 540.87	3 140	770.65	R170	-38 384.97	3 141	653.49
L171	-38 496.37	3 140	721.15	R171	-38 357.53	3 141	624.24
L172	-38 450.96	3 140	679.11	R172	-38 308.64	3 141	588.14
L173	-38 321.55	3 140	527.12	R173	-38 270.23	3 141	541.35
L174	-38 266.37	3 140	489.23	R174	-38 248.26	3 141	492.69
L175	-38 192.37	3 140	439.08	R175	-38 239.89	3 141	441.03
L176	-38 091.85	3 140	405.44	R176	-38 246.52	3 141	388.67
L177	-37 953.10	3 140	391.72	R177	-38 252.88	3 141	375.27
L178	-37 909.84	3 140	386.24	R178	-38 266.23	3 141	347.10
L179	-37 866.53	3 140	380.91	R179	-38 291.25	3 141	324.18
L180	-37 823.42	3 140	375.43	R180	-38 324.06	3 141	297.99
L181	-37 778.47	3 140	372.82	R181	-38 368.83	3 141	258.84
L182	-37 733.55	3 140	370.21	R182	-38 369.11	3 141	258.54
L183	-37 711.07	3 140	368.90	R183	-38 436.94	3 141	186.49
L184	-37 666.25	3 140	366.30	R184	-38 573.93	3 141	090.30
L185	-37 621.20	3 140	363.96	R185	-38 639.50	3 140	901.05
L186	-37 576.22	3 140	361.63	R186	-38 619.01	3 140	839.24
L187	-37 555.06	3 140	360.54	R187	-38 589.52	3 140	754.99
L188	-37 531.17	3 140	359.31	R188	-38 505.60	3 140	661.42
L189	-37 486.23	3 140	356.98	R189	-38 343.65	3 140	480.83
L190	-37 443.95	3 140	354.79	R190	-38 325.67	3 140	465.79
L191	-37 436.27	3 140	354.40	R191	-38 280.46	3 140	427.98
L192	-37 435.56	3 140	349.94	R192	-38 223.69	3 140	395.65
L193	-37 433.43	3 140	336.92	R193	-38 100.88	3 140	352.05
L194	-37 409.14	3 140	329.70	R194	-38 014.88	3 140	345.16
L195	-37 367.19	3 140	317.26	R195	-37 848.37	3 140	331.84
L196	-37 334.98	3 140	307.69	R196	-37 807.20	3 140	339.47
L197	-37 318.95	3 140	302.63	R197	-37 797.11	3 140	335.36
L198	-37 238.06	3 140	241.68	R198	-37 746.72	3 140	331.39
L199	-37 179.35	3 140	181.89	R199	-37 711.05	3 140	328.59
L200	-37 164.60	3 140	172.99	R200	-37 688.87	3 140	326.85
L201	-37 153.56	3 140	162.62	R201	-37 644.48	3 140	323.36
L202	-37 145.42	3 140	144.37	R202	-37 629.65	3 140	322.19
L203	-37 129.87	3 140	126.76	R203	-37 582.92	3 140	318.52
L204	-37 090.73	3 140	082.43	R204	-37 555.78	3 140	316.39

Vel  
Sheet

12

Van  
of

13

P1049/18

PADRESERWE KOÖRDINATE / ROAD RESERVE CO-ORDINATES						
LINKERKANT/LEFT HAND SIDE				REGTERKANT/RIGHT HAND SIDE		
	Y	X	WG 29°		Y	X
L205	-37 070.61	3 140	059.33	R205	-37 549.33	3 140 315.88
L206	-36 971.71	3 139	945.61	R206	-37 513.27	3 140 309.71
L207	-36 919.11	3 139	885.18	R207	-37 471.08	3 140 302.49
L208	-36 841.45	3 139	823.16	R208	-37 462.02	3 140 300.93
L209	-36 836.36	3 139	819.13	R209	-37 432.96	3 140 288.18
L210	-36 801.87	3 139	806.86	R210	-37 414.56	3 140 279.75
L211	-36 715.27	3 139	776.08	R211	-37 344.98	3 140 256.09
L212	-36 639.47	3 139	749.12	R212	-37 278.10	3 140 207.96
L213	-36 612.93	3 139	741.07	R213	-37 264.97	3 140 198.81
L214	-36 600.51	3 139	737.25	R214	-37 257.57	3 140 189.84
L215	-36 584.59	3 139	732.42	R215	-37 243.80	3 140 173.17
				R216	-37 230.10	3 140 116.09
				R217	-37 204.67	3 140 100.85
				R218	-37 158.15	3 140 074.03
				R219	-37 117.97	3 140 028.47
				R220	-37 118.45	3 140 027.62
				R221	-37 090.66	3 139 995.24
				R222	-37 062.85	3 139 962.85
				R223	-37 035.05	3 139 930.46
				R224	-36 998.58	3 139 887.91
				R225	-36 943.80	3 139 831.90
				R226	-36 852.18	3 139 782.06
				R227	-36 752.83	3 139 739.84
				R228	-36 721.73	3 139 726.30
				R229	-36 740.79	3 139 728.48
				R230	-36 755.25	3 139 730.13
				R231	-36 746.71	3 139 726.15
				R232	-36 649.11	3 139 714.92
				R233	-36 611.74	3 139 701.56

Vel  
Sheet

13

Van  
of

13

P1049/18