

DEPARTMENT OF TRANSPORT

NO. 409

15 MARCH 2019

**THE SOUTH AFRICAN NATIONAL ROADS
AGENCY SOC LIMITED**

Registration No: 1998/009584/30

DECLARATION AMENDMENT OF NATIONAL ROAD N3 SECTION 5

AMENDMENT OF DECLARATION No.'s 78 OF 1979, 166 OF 1993 AND 246 OF 1981.

By virtue of Section 40 (1)(b) of The South African National Roads Agency Limited and National Roads Act, 1998 (Act No. 7 of 1998), I hereby amend (I) Declaration No. 78 of 1979 in its entirety, (II) Declaration No. 166 of 1993 in its entirety, (III) Declaration No. 246 of 1981 from its start up to the Tugela River on sheet 1 of Plan No. P309/81, by substituting all sheets of their respective Plans with the accompanying sheets 1 to 17 of Plan No. P1050/18.

(National Road N3 Section 5: Highland – Tugela River)**MINISTER OF TRANSPORT**

DEPARTEMENT VAN VERVOER

NO. 409

15 MAART 2019

**DIE SUID-AFRIKAANSE NASIONALE
PADAGENTSAP MSB BEPERK**

Registrasie No: 1998/009584/30

VERKLARING WYSIGING VAN NASIONALE PAD N3 SEKSIE 5

WYSIGING VAN VERKLARING No.'s 78 VAN 1979, 166 VAN 1993 EN 246 VAN 1981.

Kragtens Artikel 40(1)(b) van die Wet op die Suid-Afrikaanse Nasionale Padagentskap Beperk en op Nasionale Paaie, 1998 (Wet No. 7 van 1998), wysig ek hiermee (I) Verklaring No. 78 van 1979 deur dit in sy geheel, (II) Verklaring No. 166 van 1993 deur dit in sy geheel, (III) Verklaring No. 246 van 1981 vanaf die begin tot by die Tugela Rivier op vel 1 van Plan No. P309/81, deur alle velle van hulle respektiewelike Planne te vervang met meegaande velle 1 tot 17 van Plan No. P1050/18.

(Nasionale Pad N3 Seksie 5: Highland – Tugela Rivier)**MINISTER VAN VERVOER**

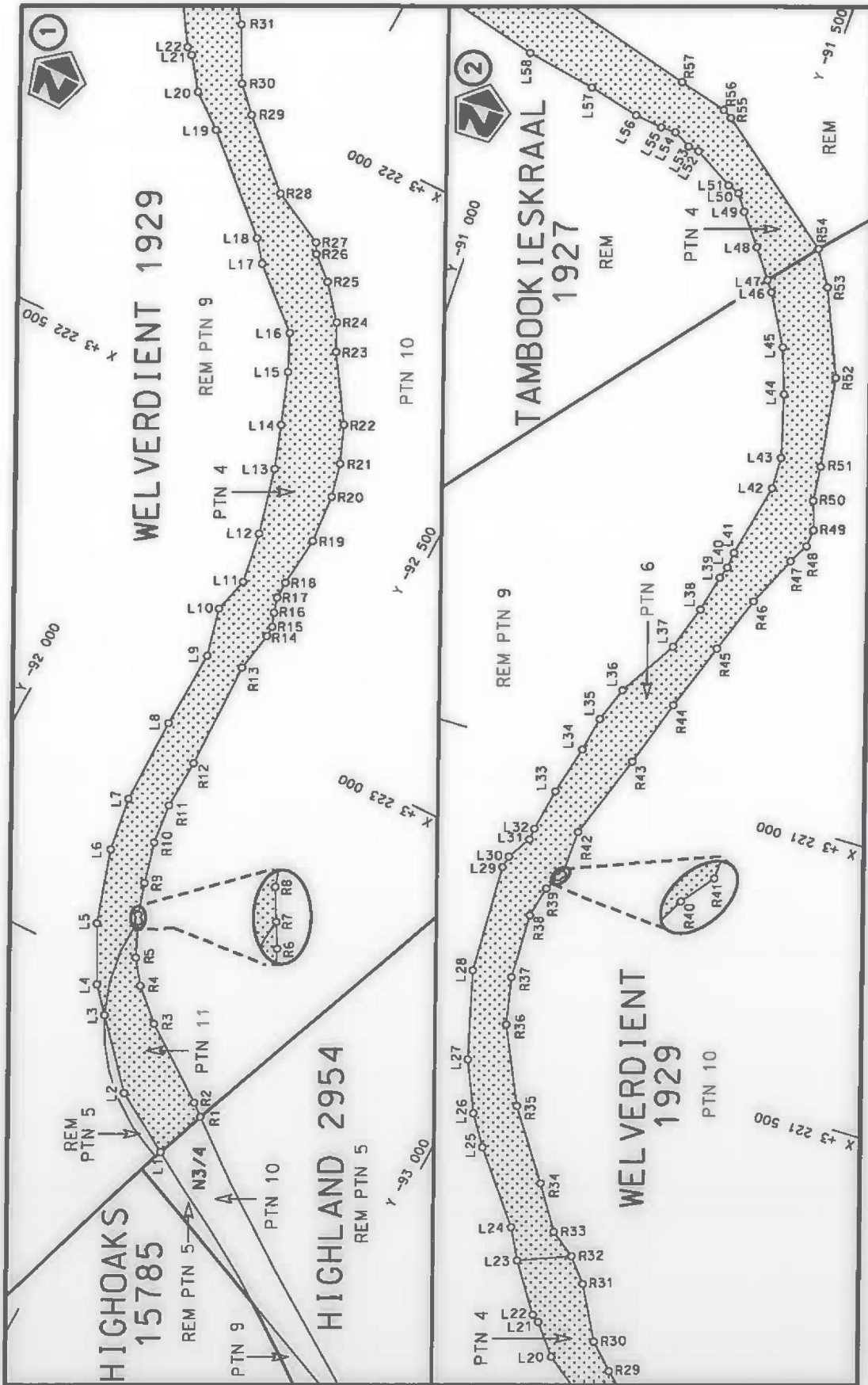

Vel Sheet 1 van of 17
Plan P1050/18

stelt die podreserwe voor van 'n gedeelte
represents the road reserve of a portion
van Nasionale Roete N3 Seksie Section
of National Route N3 Section 5



Die figuur getoon
The figure shown

Die Suid Afrikaanse Nasionale Padagentskap MSB Bpk
The South African National Roads Agency SOC Ltd

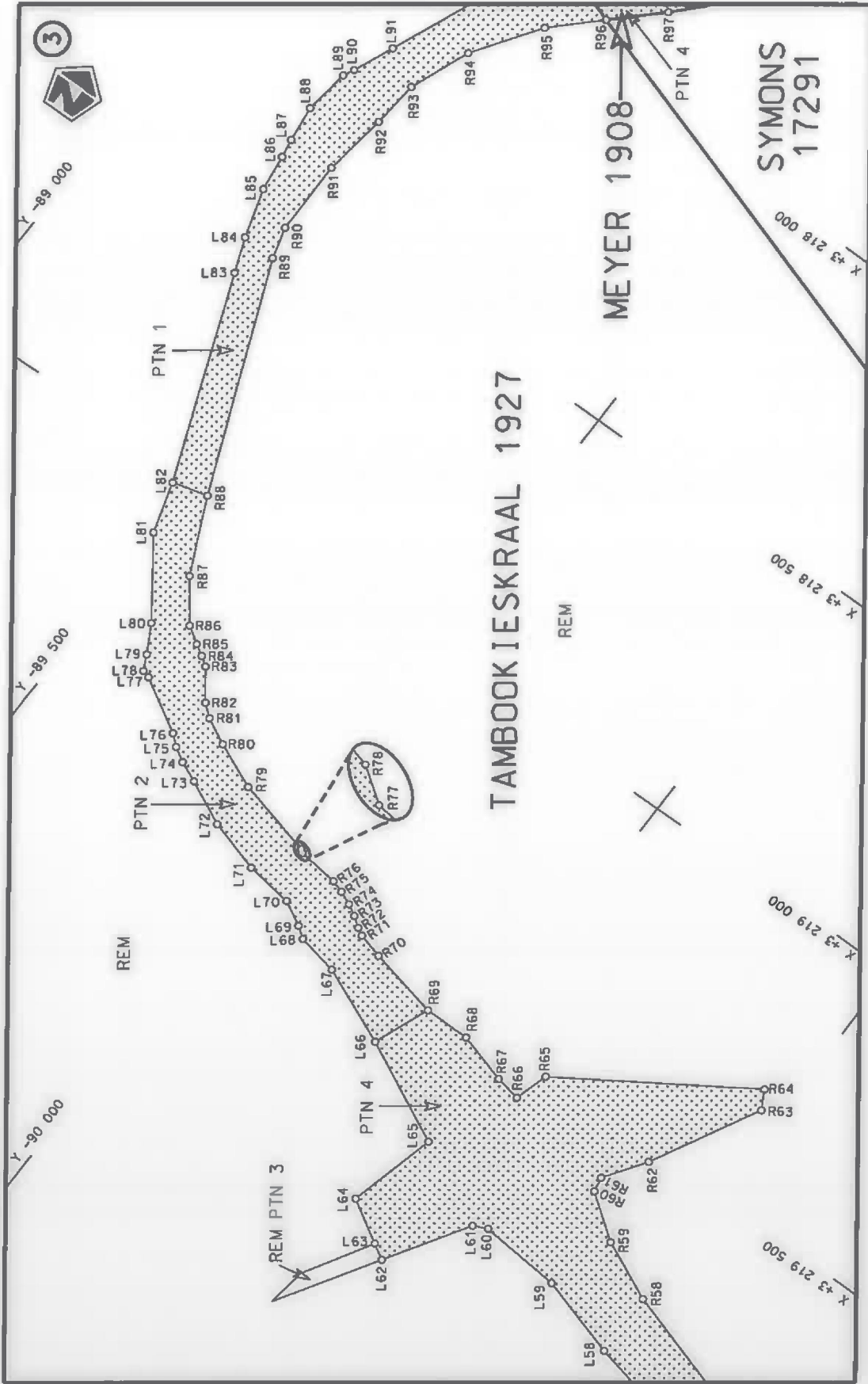

Vel
Sheet 2 of 17
Plan P1050/18

steil die padreserwe voor van 'n gedeelte
represents the road reserve of a portion
van Nasionale Roete N3 Sektie
of National Route N3 Section



Die figuur getoon
The figure shown

Die Suid Afrikaanse Nasionale Padagentskap MSB Bpk
The South African National Roads Agency SOC Ltd

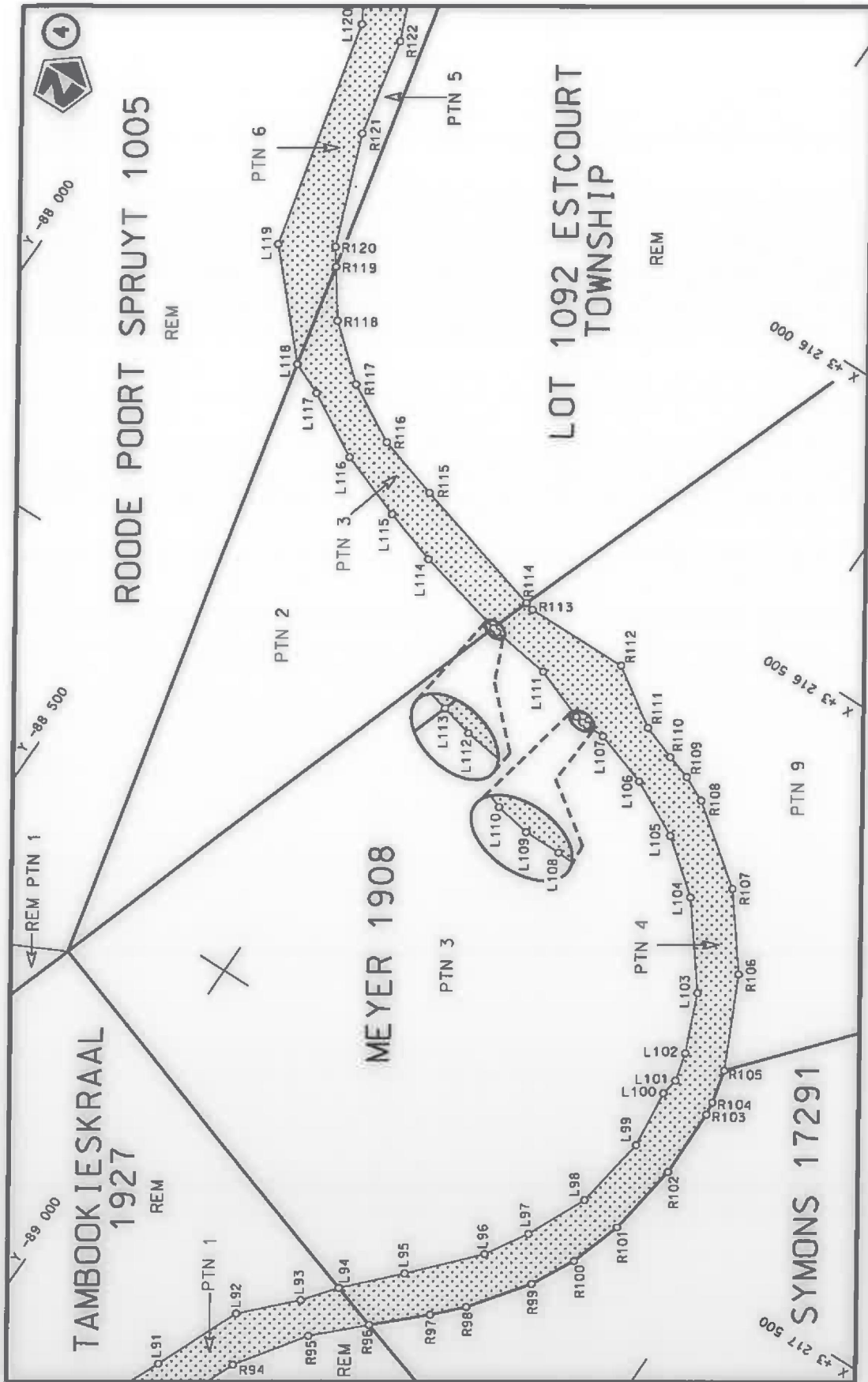

<p>Die Suid Afrikaanse Nasionale Padagentskap MSB Bpk The South African National Roads Agency SOC Ltd</p>	<p>Die figuur getoon The figure shown</p> 	<p>steldie podreserwe voor van 'n gedeelte represents the road reserve of a portion van Nasionale Roete N3 of National Route</p> <p>Seksie 5 Section</p>	<p>Vel Sheet 3 of 17 Plan P1050/18</p>
---	---	--	--

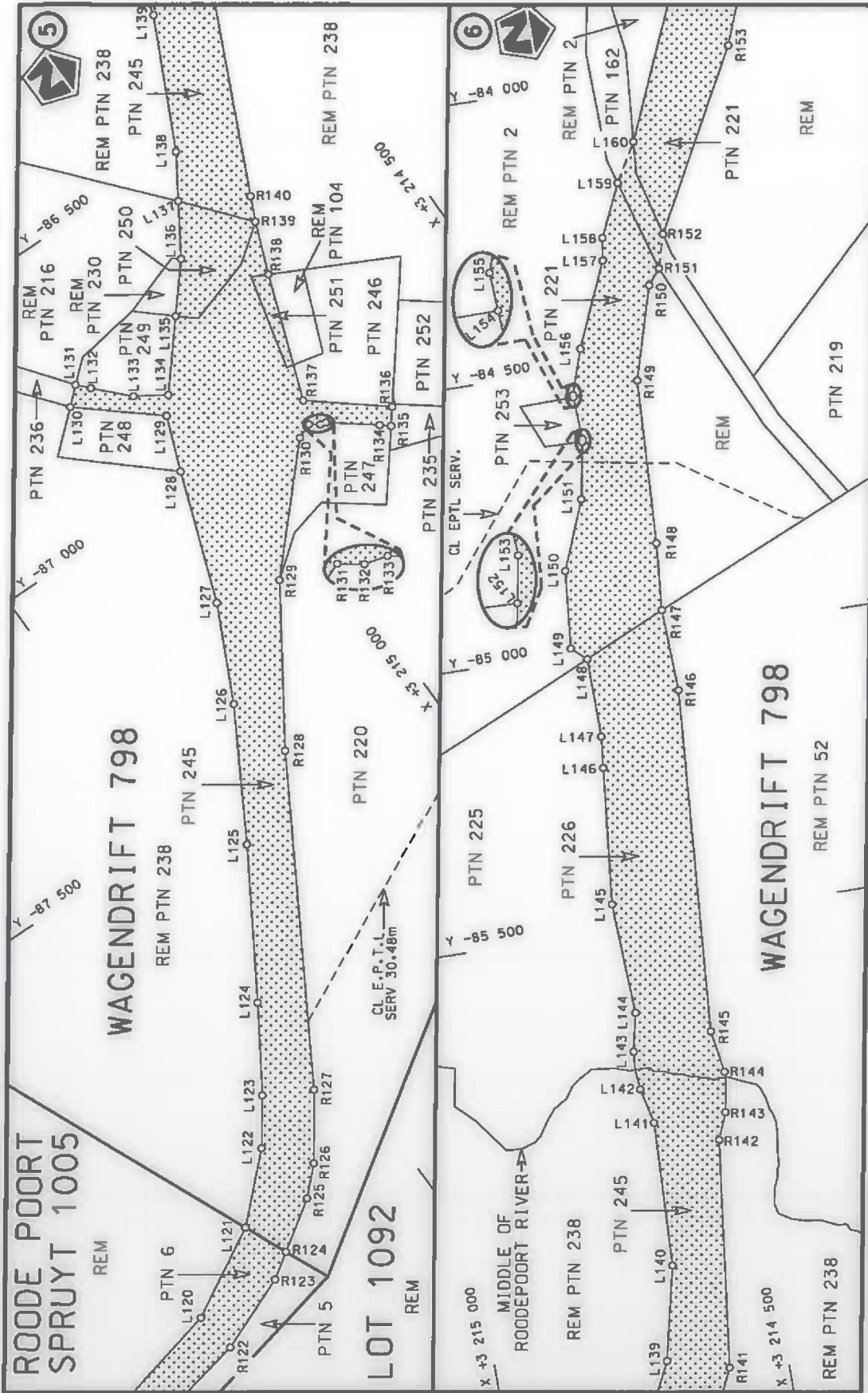

Die Suid Afrikaanse Nasionale Padagentskap MSB Bpk The South African National Roads Agency SOC Ltd	Die figuur getoon The figure shown	stel die padreserwe voor van 'n gedeelte represents the road reserve of a portion van Nasionale Roete N3 of National Route N3	Vel Sheet 4 of 17 Plan P1050/18
---	---------------------------------------	--	------------------------------------

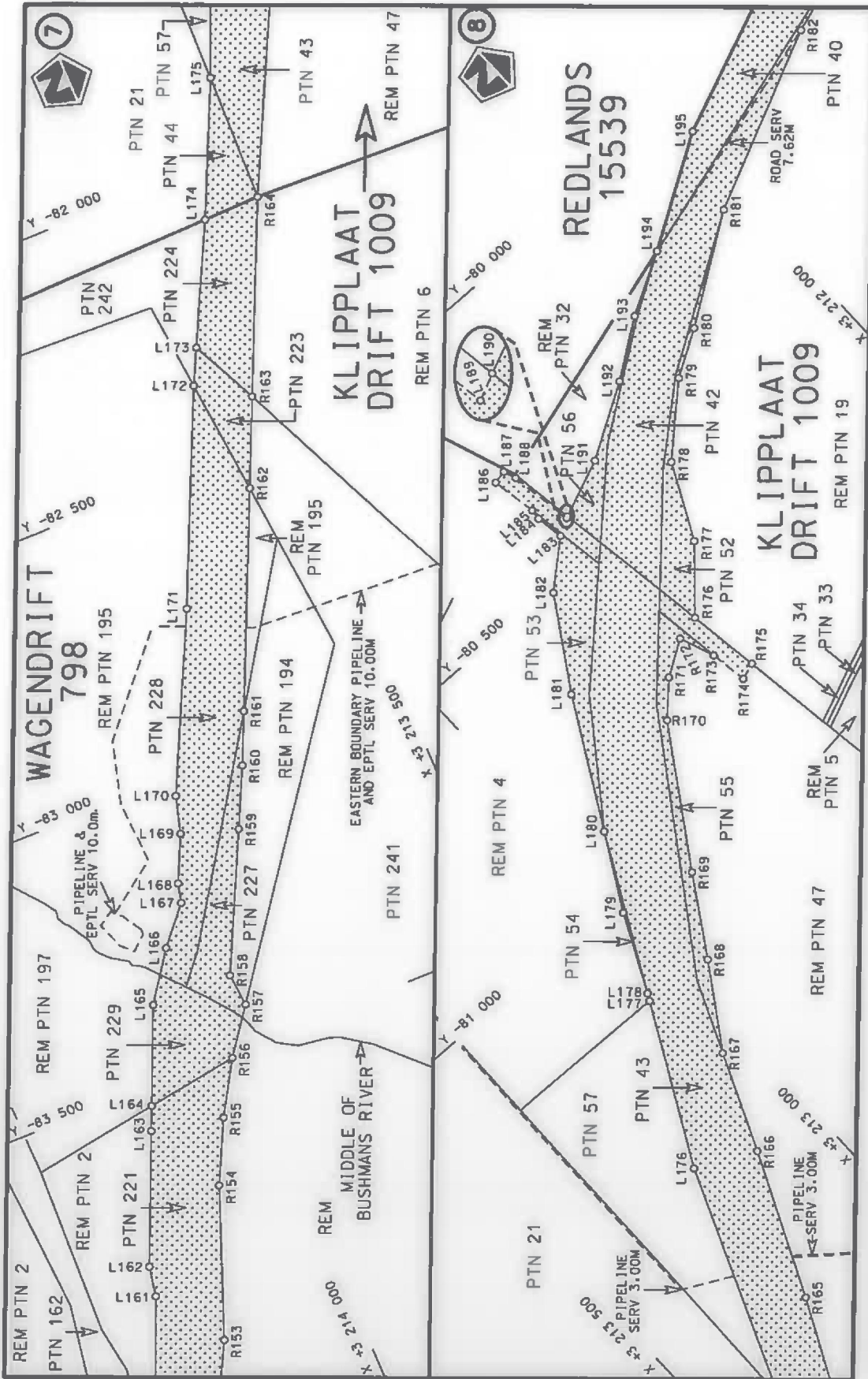

Die Suid Afrikaanse Nasionale Padagentskap MSB Bpk The South African National Roads Agency SOC Ltd	Die figuur getoon The figure shown	steeldie padreserwe voor van 'n gedeelte represents the road reserve of a portion van Nasionale Roete N3 of National Route	Vel Sheet 5 of 17
			Plan P1050/18

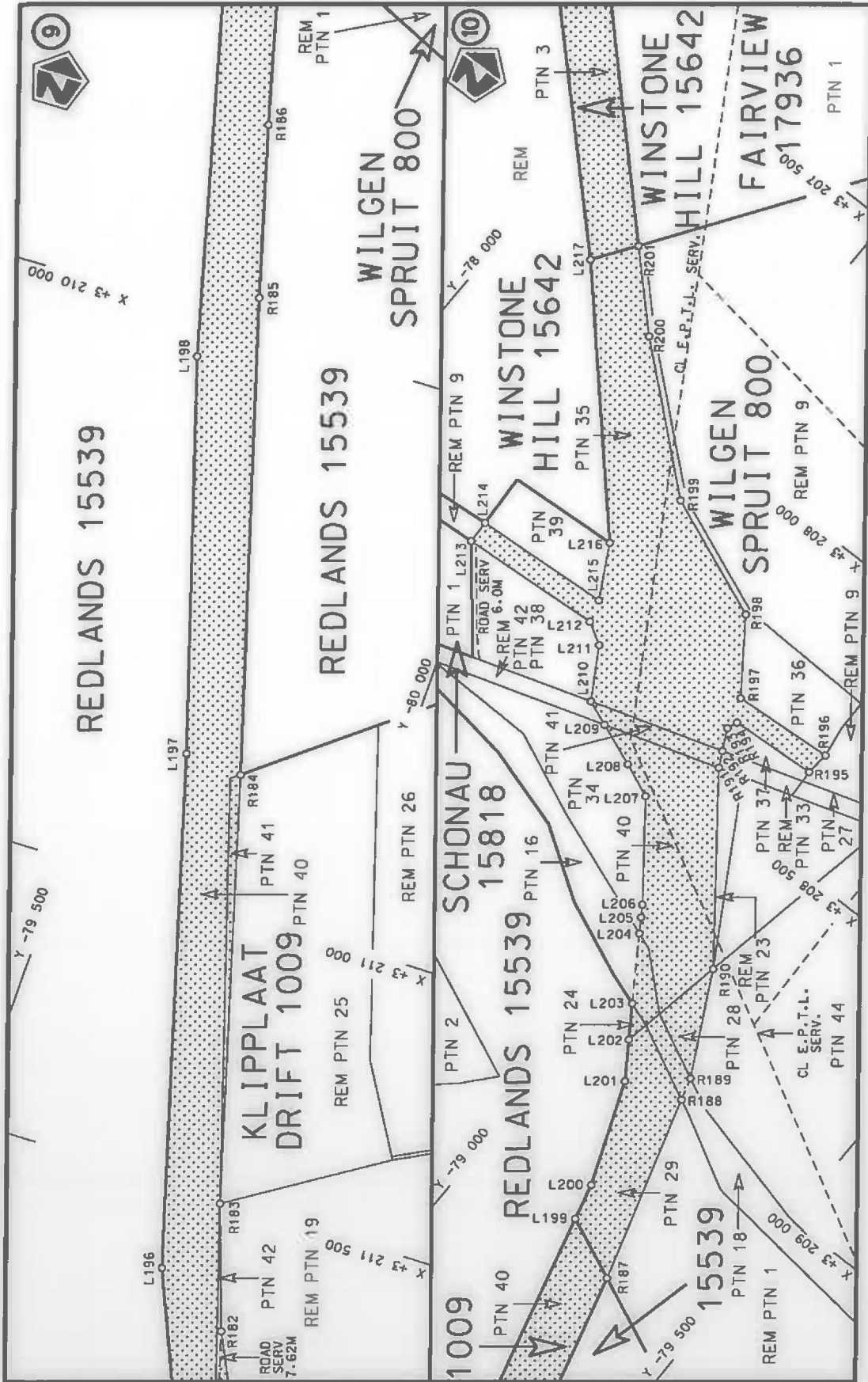

<p>Die Suid Afrikaanse Nasionale Padagentskap MSB Bpk The South African National Roads Agency SOC Ltd</p>	<p>Die figuur getoon The figure shown</p>	<p>stelsel padreserwe voor van 'n gedeelte represents the road reserve of a portion van Nasionale Roete N3 of National Route</p>	<p>5</p>	<p>Vel Sheet 6 of 17</p>	<p>Plan P1050/18</p>
---	---	--	----------	------------------------------	----------------------

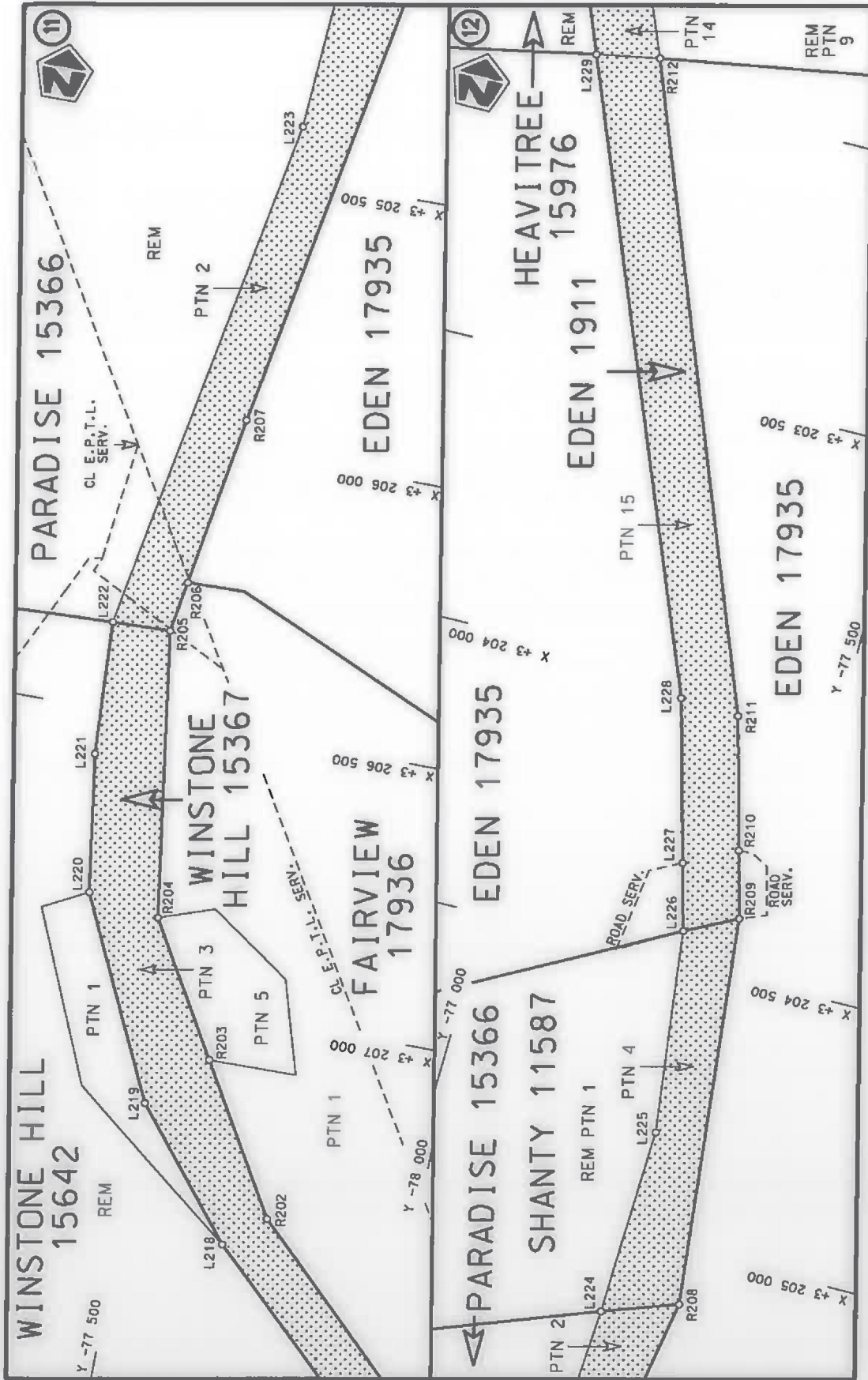

<p>Die Suid Afrikaanse Nasionale Padagentskap MSB Bpk The South African National Roads Agency SOC Ltd</p>	<p>Die figuur getoon The figure shown</p> 	<p>steldie podreserwe voor van 'n gedeelte represents the road reserve of a portion van Nasionale Roete N3 of National Route N3</p> <p>Seksie 5 Section 5</p>	<p>Vel Sheet 7 of 17 Plan P1050/18</p>
---	---	---	--

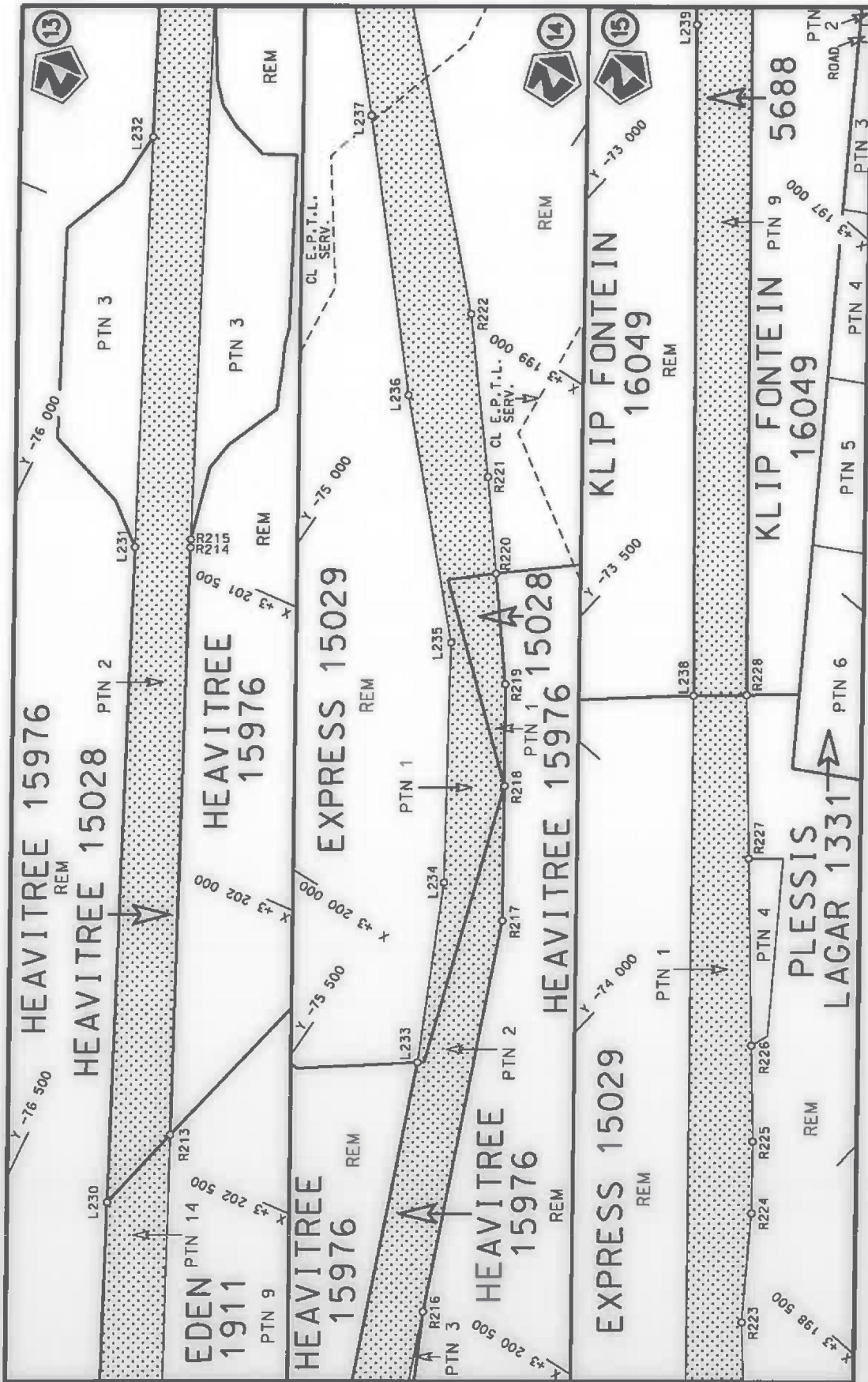

<p>Die Suid Afrikaanse Nasionale Padagentskap MSB Bpk The South African National Roads Agency SOC Ltd</p>	<p>Die figuur getoon The figure shown</p>	<p>steeldie padreserwe voor van 'n gedeelte represents the road reserve of a portion van Nasionale Roete N3 Seksie 5 of National Route</p>	<p>Vel Sheet 8 of 17 Plan P1050/18</p>
---	---	--	--

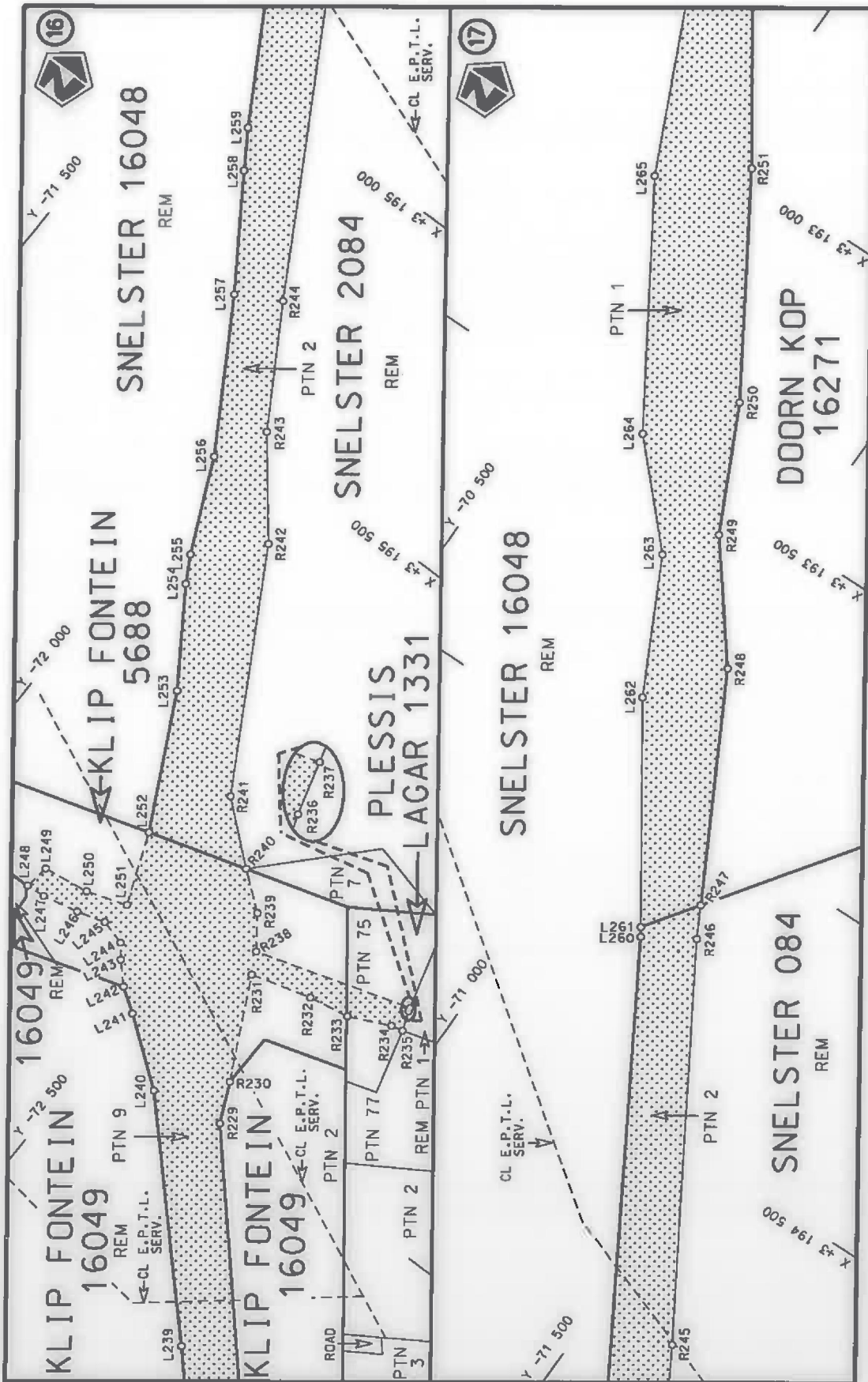

Die Suid Afrikaanse Nasionale Padogentekop MSB Bpk The South African National Roads Agency SOC Ltd	Die figuur getoon The figure shown		stielde padreserwe voor van 'n gedeelte represents the road reserve of a portion van Nasionale Roete N3 of National Route	
			Seksie Section	5
			Vel Sheet	9 of
			Plan	P1050/18

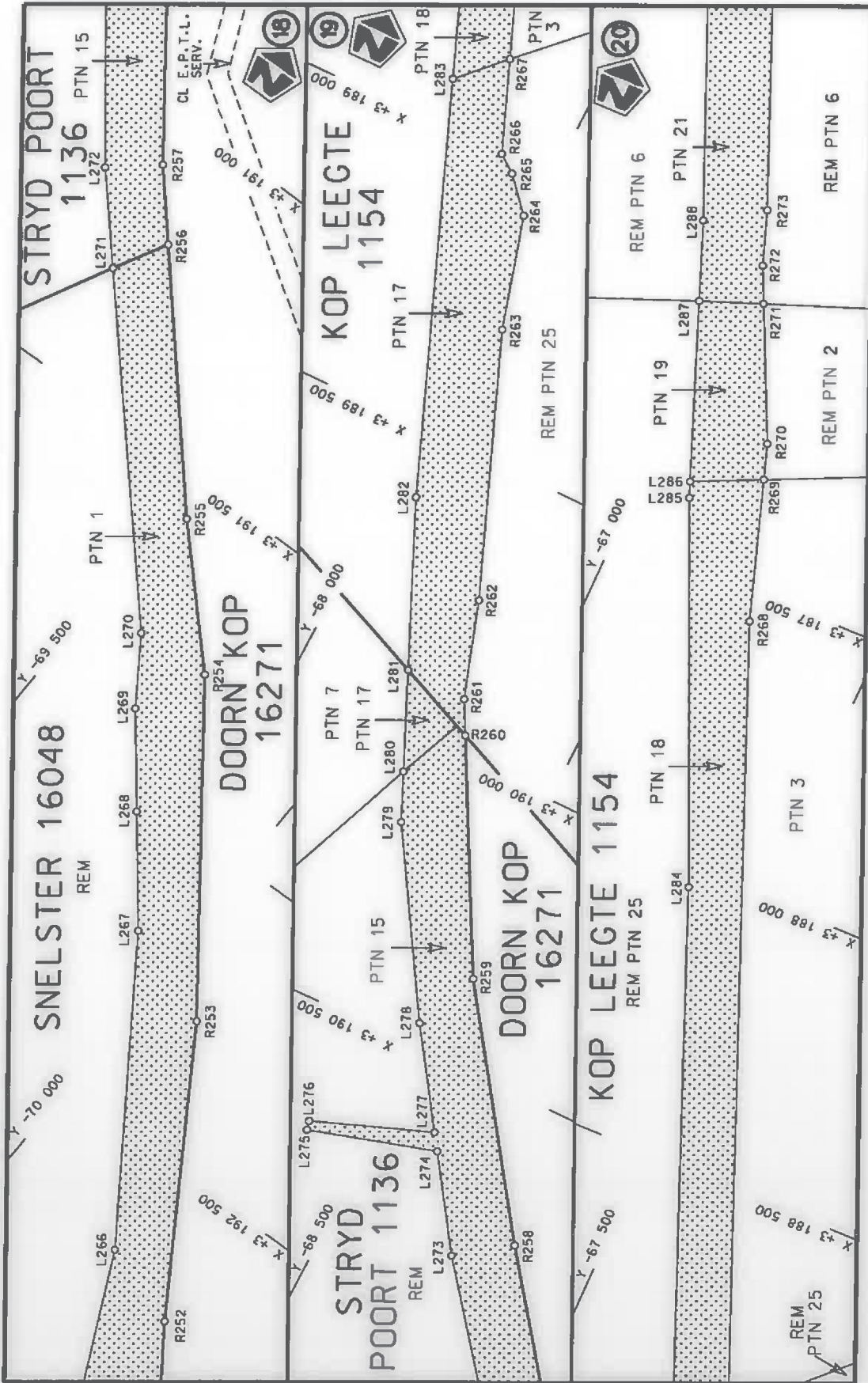

<p>Die Suid Afrikaanse Nasionale Padagentskap MSB Bpk The South African National Roads Agency SOC Ltd</p>	<p>Die figuur getoon The figure shown</p>	<p>stelt die padreserwe voor van 'n gedeelte represents the road reserve of a portion van Nasionale Roete N3 of National Route N3</p> <p>Seksie 5 Section</p>	<p>Vel 10 van 17 Sheet of</p> <p>Plan P1050/18</p>
---	---	---	--

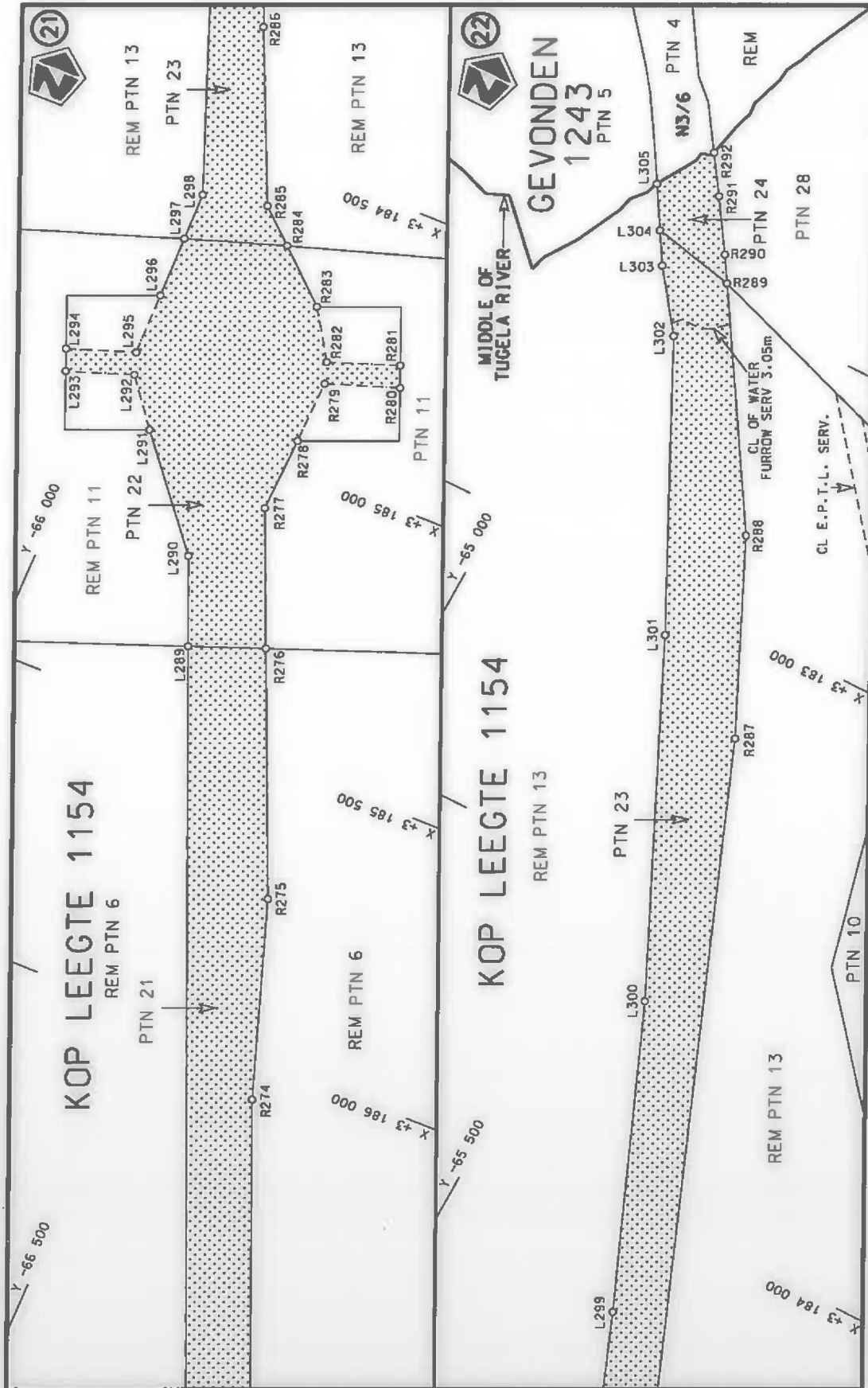

<p>Die Suid Afrikaanse Nasionale Padagentskap MSB Bpk The South African National Roads Agency SOC Ltd</p>	<p>Die figuur getoon The figure shown</p> 	<p>stel die padreserwe voor van 'n gedeelte represents the road reserve of a portion van Nasionale Roete N3 Seksie of National Route N3 Section</p>	<p>Vel Sheet 11 of 17</p> <p>Plan P1050/18</p>
---	---	---	--

PADRESERWE KOÖRDINATE / ROAD RESERVE CO-ORDINATES						
LINKERKANT/LEFT HAND SIDE				REGTERKANT/RIGHT HAND SIDE		
	Y	X	WG 29°		Y	X
L1	-92 586.08	3 223	751.30	R1	-92 617.56	3 223 664.02
L2	-92 481.54	3 223	685.27	R2	-92 595.78	3 223 646.38
L3	-92 386.92	3 223	575.75	R3	-92 468.66	3 223 551.56
L4	-92 349.78	3 223	532.98	R4	-92 416.67	3 223 501.67
L5	-92 298.76	3 223	435.47	R5	-92 386.02	3 223 460.23
L6	-92 258.08	3 223	306.92	R6	-92 359.92	3 223 400.46
L7	-92 242.48	3 223	212.50	R7	-92 358.81	3 223 398.50
L8	-92 239.87	3 223	061.01	R8	-92 353.93	3 223 389.75
L9	-92 242.68	3 222	923.52	R9	-92 336.83	3 223 334.35
L10	-92 221.38	3 222	839.18	R10	-92 317.90	3 223 262.27
L11	-92 236.45	3 222	777.62	R11	-92 309.11	3 223 191.83
L12	-92 220.55	3 222	688.68	R12	-92 311.44	3 223 105.59
L13	-92 190.46	3 222	573.33	R13	-92 306.42	3 222 914.94
L14	-92 163.70	3 222	498.41	R14	-92 318.52	3 222 845.39
L15	-92 129.87	3 222	408.77	R15	-92 318.82	3 222 826.80
L16	-92 100.11	3 222	345.71	R16	-92 309.80	3 222 802.76
L17	-91 999.44	3 222	257.34	R17	-92 301.89	3 222 776.29
L18	-91 970.55	3 222	220.68	R18	-92 302.16	3 222 745.85
L19	-91 816.30	3 222	080.94	R19	-92 309.13	3 222 658.31
L20	-91 756.84	3 222	034.69	R20	-92 300.87	3 222 573.40
L21	-91 716.06	3 221	981.59	R21	-92 286.33	3 222 514.43
L22	-91 703.21	3 221	972.22	R22	-92 259.39	3 222 449.33
L23	-91 647.00	3 221	887.06	R23	-92 186.47	3 222 339.60
L24	-91 618.69	3 221	833.14	R24	-92 162.93	3 222 292.54
L25	-91 526.85	3 221	711.13	R25	-92 114.92	3 222 234.77
L26	-91 493.16	3 221	657.35	R26	-92 074.89	3 222 199.73
L27	-91 453.88	3 221	568.04	R27	-92 064.60	3 222 181.22
L28	-91 412.58	3 221	412.79	R28	-91 969.04	3 222 131.47
L29	-91 404.15	3 221	220.63	R29	-91 858.94	3 222 029.52
L30	-91 408.67	3 221	199.63	R30	-91 817.99	3 221 987.02
L31	-91 432.82	3 221	159.50	R31	-91 767.54	3 221 893.78
L32	-91 435.15	3 221	138.52	R32	-91 733.68	3 221 851.86
L33	-91 448.74	3 221	063.98	R33	-91 691.49	3 221 819.11
L34	-91 469.28	3 220	978.51	R34	-91 642.94	3 221 742.79
L35	-91 480.86	3 220	917.39	R35	-91 560.61	3 221 622.52
L36	-91 502.24	3 220	856.35	R36	-91 498.07	3 221 488.51
L37	-91 560.71	3 220	755.93	R37	-91 480.03	3 221 404.61
L38	-91 584.88	3 220	678.21	R38	-91 476.00	3 221 289.22
L39	-91 599.18	3 220	613.97	R39	-91 488.01	3 221 235.05
L40	-91 606.23	3 220	592.48	R40	-91 501.13	3 221 209.46
L41	-91 608.83	3 220	563.73	R41	-91 506.38	3 221 202.38
L42	-91 635.79	3 220	433.67	R42	-91 508.46	3 221 121.76
L43	-91 633.68	3 220	377.16	R43	-91 558.15	3 220 973.48
L44	-91 602.87	3 220	267.28	R44	-91 594.02	3 220 855.97
L45	-91 574.68	3 220	187.65	R45	-91 634.21	3 220 736.42
L46	-91 525.19	3 220	099.32	R46	-91 668.40	3 220 636.76
L47	-91 511.69	3 220	080.65	R47	-91 707.30	3 220 548.69
L48	-91 475.48	3 220	030.38	R48	-91 725.02	3 220 515.03
L49	-91 435.03	3 219	976.42	R49	-91 727.78	3 220 483.96
L50	-91 415.13	3 219	947.66	R50	-91 710.86	3 220 433.62
L51	-91 394.72	3 219	939.69	R51	-91 703.87	3 220 371.52

Vel Sheet 12 Van of 17

P1050/18

PADRESERWE KOÖRDINATE / ROAD RESERVE CO-ORDINATES							
LINKERKANT/LEFT HAND SIDE				REGTERKANT/RIGHT HAND SIDE			
	Y	X	WG 29°		Y	X	
L52	-91 325.49	3 219 896.98		R52	-91 678.90	3 220 212.47	
L53	-91 306.76	3 219 893.98		R53	-91 614.93	3 220 062.12	
L54	-91 276.90	3 219 876.60		R54	-91 578.77	3 220 001.07	
L55	-91 250.90	3 219 875.31		R55	-91 360.63	3 219 823.32	
L56	-91 202.91	3 219 867.73		R56	-91 344.18	3 219 813.45	
L57	-91 114.81	3 219 843.39		R57	-91 259.92	3 219 787.82	
L58	-90 994.26	3 219 816.53		R58	-90 992.52	3 219 702.19	
L59	-90 848.37	3 219 771.35		R59	-90 886.24	3 219 652.37	
L60	-90 701.46	3 219 757.46		R60	-90 808.93	3 219 595.67	
L61	-90 676.42	3 219 768.74		R61	-90 803.67	3 219 568.94	
L62	-90 586.40	3 219 910.79		R62	-90 852.74	3 219 497.97	
L63	-90 559.08	3 219 894.27		R63	-90 953.78	3 219 308.81	
L64	-90 483.92	3 219 849.10		R64	-90 935.83	3 219 275.36	
L65	-90 524.66	3 219 692.15		R65	-90 617.96	3 219 479.07	
L66	-90 342.51	3 219 602.01		R66	-90 600.57	3 219 538.51	
L67	-90 203.89	3 219 542.41		R67	-90 554.77	3 219 530.04	
L68	-90 130.39	3 219 527.37		R68	-90 464.72	3 219 503.14	
L69	-90 110.23	3 219 512.75		R69	-90 382.36	3 219 502.73	
L70	-90 067.07	3 219 488.80		R70	-90 254.57	3 219 474.34	
L71	-89 982.35	3 219 476.32		R71	-90 209.49	3 219 462.46	
L72	-89 888.71	3 219 447.69		R72	-90 196.01	3 219 455.00	
L73	-89 810.20	3 219 409.47		R73	-90 177.69	3 219 441.86	
L74	-89 773.52	3 219 393.43		R74	-90 157.57	3 219 430.39	
L75	-89 748.09	3 219 377.92		R75	-90 133.50	3 219 419.93	
L76	-89 728.83	3 219 361.48		R76	-90 110.80	3 219 412.97	
L77	-89 634.58	3 219 305.87		R77	-90 037.49	3 219 403.84	
L78	-89 620.59	3 219 302.01		R78	-90 031.19	3 219 399.37	
L79	-89 607.41	3 219 274.75		R79	-89 891.32	3 219 363.03	
L80	-89 580.26	3 219 224.89		R80	-89 810.19	3 219 326.85	
L81	-89 485.71	3 219 091.88		R81	-89 764.00	3 219 302.85	
L82	-89 458.72	3 219 000.65		R82	-89 741.61	3 219 284.42	
L83	-89 319.89	3 218 635.90		R83	-89 702.79	3 219 232.14	
L84	-89 295.98	3 218 574.39		R84	-89 686.54	3 219 220.61	
L85	-89 269.02	3 218 486.76		R85	-89 666.33	3 219 208.59	
L86	-89 260.37	3 218 421.42		R86	-89 636.53	3 219 189.39	
L87	-89 254.72	3 218 388.05		R87	-89 583.03	3 219 118.12	
L88	-89 246.73	3 218 323.36		R88	-89 521.76	3 218 983.88	
L89	-89 257.60	3 218 242.64		R89	-89 356.52	3 218 576.75	
L90	-89 267.23	3 218 223.80		R90	-89 340.71	3 218 520.45	
L91	-89 298.08	3 218 153.25		R91	-89 340.71	3 218 387.48	
L92	-89 361.61	3 218 003.20		R92	-89 357.52	3 218 272.81	
L93	-89 440.91	3 217 922.33		R93	-89 365.86	3 218 189.31	
L94	-89 483.18	3 217 868.21		R94	-89 408.10	3 218 083.34	
L95	-89 563.62	3 217 784.19		R95	-89 487.50	3 217 969.10	
L96	-89 660.00	3 217 679.05		R96	-89 563.77	3 217 895.53	
L97	-89 702.70	3 217 607.06		R97	-89 641.87	3 217 821.75	
L98	-89 749.95	3 217 503.15		R98	-89 686.64	3 217 775.94	
L99	-89 769.23	3 217 371.80		R99	-89 757.58	3 217 679.48	
L100	-89 756.72	3 217 268.02		R100	-89 795.90	3 217 604.47	
L101	-89 761.28	3 217 237.67		R101	-89 824.70	3 217 513.04	
L102	-89 747.84	3 217 187.40		R102	-89 842.47	3 217 381.65	

Vel Sheet	13	Van of	17
--------------	----	-----------	----

P1050/18

PADRESERWE KOÖRDINATE / ROAD RESERVE CO-ORDINATES									
LINKERKANT/LEFT HAND SIDE					REGTERKANT/RIGHT HAND SIDE				
	Y	X	WG 29°		Y	X			
L103	-89 704.74	3 217	085.40	R103	-89 840.02	3 217	259.34		
L104	-89 598.39	3 216	948.76	R104	-89 836.42	3 217	235.55		
L105	-89 507.25	3 216	875.71	R105	-89 821.59	3 217	176.05		
L106	-89 407.88	3 216	823.72	R106	-89 745.82	3 217	018.40		
L107	-89 309.82	3 216	790.81	R107	-89 650.73	3 216	896.30		
L108	-89 275.92	3 216	789.31	R108	-89 516.59	3 216	793.81		
L109	-89 265.96	3 216	789.31	R109	-89 471.85	3 216	772.05		
L110	-89 251.79	3 216	786.72	R110	-89 428.02	3 216	758.07		
L111	-89 158.51	3 216	750.93	R111	-89 366.50	3 216	735.16		
L112	-89 052.41	3 216	734.95	R112	-89 265.05	3 216	667.67		
L113	-89 042.85	3 216	732.54	R113	-89 080.70	3 216	668.27		
L114	-88 879.94	3 216	691.31	R114	-89 065.36	3 216	663.83		
L115	-88 781.99	3 216	658.57	R115	-88 814.51	3 216	591.16		
L116	-88 663.08	3 216	613.65	R116	-88 701.91	3 216	556.23		
L117	-88 551.61	3 216	548.74	R117	-88 599.23	3 216	498.80		
L118	-88 495.12	3 216	523.68	R118	-88 508.95	3 216	421.30		
L119	-88 347.16	3 216	362.42	R119	-88 452.45	3 216	342.10		
L120	-88 245.17	3 215	956.05	R120	-88 431.51	3 216	312.74		
L121	-88 156.23	3 215	801.79	R121	-88 355.80	3 216	118.53		
L122	-88 055.22	3 215	698.86	R122	-88 317.84	3 215	945.15		
L123	-87 977.97	3 215	643.68	R123	-88 262.30	3 215	813.37		
L124	-87 836.89	3 215	556.54	R124	-88 232.28	3 215	769.75		
L125	-87 593.25	3 215	410.96	R125	-88 174.32	3 215	685.58		
L126	-87 373.32	3 215	287.28	R126	-88 129.31	3 215	640.49		
L127	-87 207.50	3 215	208.63	R127	-88 021.09	3 215	565.28		
L128	-86 978.26	3 215	126.57	R128	-87 492.88	3 215	262.42		
L129	-86 882.53	3 215	090.13	R129	-87 235.94	3 215	097.74		
L130	-86 774.01	3 215	217.07	R130	-87 046.77	3 214	925.12		
L131	-86 746.81	3 215	187.04	R131	-87 035.85	3 214	898.80		
L132	-86 766.49	3 215	169.03	R132	-87 047.32	3 214	883.05		
L133	-86 820.93	3 215	116.93	R133	-87 049.81	3 214	873.13		
L134	-86 853.31	3 215	066.76	R134	-87 106.32	3 214	800.31		
L135	-86 744.72	3 214	976.76	R135	-87 119.08	3 214	785.69		
L136	-86 666.10	3 214	911.60	R136	-87 091.54	3 214	764.52		
L137	-86 578.14	3 214	857.14	R137	-86 995.01	3 214	882.88		
L138	-86 503.18	3 214	810.74	R138	-86 775.06	3 214	804.49		
L139	-86 279.64	3 214	705.00	R139	-86 684.51	3 214	770.02		
L140	-86 112.20	3 214	668.26	R140	-86 642.09	3 214	751.19		
L141	-85 854.87	3 214	659.00	R141	-86 309.61	3 214	601.23		
L142	-85 791.47	3 214	672.99	R142	-85 903.85	3 214	553.65		
L143	-85 723.07	3 214	673.39	R143	-85 856.72	3 214	535.11		
L144	-85 654.79	3 214	659.03	R144	-85 784.98	3 214	525.16		
L145	-85 456.70	3 214	668.44	R145	-85 709.58	3 214	536.76		
L146	-85 213.30	3 214	644.59	R146	-85 097.47	3 214	494.87		
L147	-85 157.25	3 214	639.19	R147	-84 951.57	3 214	500.61		
L148	-85 016.37	3 214	640.87	R148	-84 831.85	3 214	490.89		
L149	-84 992.96	3 214	666.19	R149	-84 539.21	3 214	477.66		
L150	-84 854.60	3 214	653.54	R150	-84 375.08	3 214	430.89		
L151	-84 732.65	3 214	606.10	R151	-84 348.24	3 214	409.52		
L152	-84 631.39	3 214	588.21	R152	-84 289.15	3 214	392.78		
L153	-84 626.14	3 214	587.29	R153	-83 975.52	3 214	230.37		

Vel 14 Van 17
Sheet of

P1050/18

PADRESERWE KOÖRDINATE / ROAD RESERVE CO-ORDINATES											
LINKERKANT/LEFT HAND SIDE					REGTERKANT/RIGHT HAND SIDE						
	Y		X	WG 29°		Y		X			
L154	-84	550.64	3	214	591.12	R154	-83	713.16	3	214	132.00
L155	-84	546.33	3	214	591.36	R155	-83	602.32	3	214	078.15
L156	-84	466.96	3	214	565.34	R156	-83	508.47	3	214	023.03
L157	-84	317.95	3	214	502.93	R157	-83	427.95	3	213	965.28
L158	-84	278.19	3	214	497.18	R158	-83	368.92	3	213	970.04
L159	-84	185.76	3	214	455.88	R159	-83	129.76	3	213	855.54
L160	-84	117.67	3	214	417.39	R160	-83	025.91	3	213	805.82
L161	-83	856.23	3	214	308.59	R161	-82	936.22	3	213	766.43
L162	-83	802.56	3	214	298.26	R162	-82	567.18	3	213	604.33
L163	-83	576.65	3	214	201.48	R163	-82	415.61	3	213	537.74
L164	-83	534.92	3	214	183.64	R164	-82	085.78	3	213	392.83
L165	-83	366.83	3	214	111.78	R165	-81	753.53	3	213	233.62
L166	-83	280.20	3	214	052.41	R166	-81	498.63	3	213	120.84
L167	-83	214.85	3	213	997.51	R167	-81	325.52	3	213	048.01
L168	-83	180.03	3	213	989.18	R168	-81	180.62	3	212	955.26
L169	-83	098.72	3	213	951.12	R169	-81	044.42	3	212	871.08
L170	-83	032.14	3	213	932.58	R170	-80	809.18	3	212	721.03
L171	-82	726.52	3	213	786.94	R171	-80	753.57	3	212	667.37
L172	-82	358.24	3	213	623.29	R172	-80	713.59	3	212	606.52
L173	-82	296.32	3	213	593.05	R173	-80	775.29	3	212	583.53
L174	-82	088.62	3	213	491.76	R174	-80	841.87	3	212	573.37
L175	-81	855.18	3	213	386.79	R175	-80	831.41	3	212	544.06
L176	-81	448.45	3	213	223.47	R176	-80	702.55	3	212	562.68
L177	-81	169.87	3	213	079.50	R177	-80	598.28	3	212	471.75
L178	-81	157.59	3	213	073.15	R178	-80	464.35	3	212	406.75
L179	-81	020.23	3	213	007.27	R179	-80	359.10	3	212	297.14
L180	-80	888.15	3	212	933.88	R180	-80	309.21	3	212	217.59
L181	-80	664.81	3	212	811.34	R181	-80	183.34	3	212	038.32
L182	-80	506.10	3	212	713.06	R182	-80	030.36	3	211	724.98
L183	-80	437.38	3	212	636.17	R183	-79	955.11	3	211	507.35
L184	-80	388.64	3	212	643.52	R184	-79	742.73	3	210	764.03
L185	-80	370.14	3	212	641.59	R185	-79	498.62	3	209	940.84
L186	-80	289.75	3	212	655.96	R186	-79	413.90	3	209	641.44
L187	-80	284.70	3	212	632.35	R187	-79	316.98	3	209	279.01
L188	-80	306.71	3	212	624.49	R188	-79	216.85	3	208	948.00
L189	-80	420.37	3	212	606.61	R189	-79	205.03	3	208	908.36
L190	-80	418.96	3	212	603.74	R190	-79	112.25	3	208	730.13
L191	-80	374.74	3	212	502.22	R191	-78	892.37	3	208	442.06
L192	-80	295.90	3	212	376.49	R192	-78	878.33	3	208	414.49
L193	-80	224.35	3	212	279.34	R193	-78	859.31	3	208	377.10
L194	-80	162.32	3	212	173.74	R194	-78	865.82	3	208	359.22
L195	-80	041.19	3	211	984.98	R195	-79	019.47	3	208	351.37
L196	-79	895.83	3	211	648.45	R196	-79	022.62	3	208	310.70
L197	-79	640.66	3	210	756.96	R197	-78	843.26	3	208	321.08
L198	-79	429.49	3	210	073.83	R198	-78	755.20	3	208	198.25
L199	-79	206.85	3	209	229.53	R199	-78	538.01	3	208	108.43
L200	-79	190.50	3	209	165.08	R200	-78	309.41	3	207	913.11
L201	-79	119.19	3	208	983.14	R201	-78	192.63	3	207	797.42
L202	-79	077.16	3	208	920.31	R202	-77	743.29	3	207	352.20
L203	-79	041.00	3	208	866.16	R203	-77	590.91	3	207	088.24
L204	-78	971.47	3	208	759.94	R204	-77	454.44	3	206	851.84

Vel 15 Van 17
Sheet of

P1050/18

PADRESERWE KOÖRDINATE / ROAD RESERVE CO-ORDINATES											
LINKERKANT/LEFT HAND SIDE					REGTERKANT/RIGHT HAND SIDE						
	Y		X	WG 29°		Y		X			
L205	-78	955.56	3	208	735.35	R205	-77	375.23	3	206	340.17
L206	-78	943.06	3	208	716.45	R206	-77	387.90	3	206	249.04
L207	-78	824.86	3	208	560.65	R207	-77	430.40	3	205	943.48
L208	-78	763.92	3	208	534.95	R208	-77	564.41	3	205	081.90
L209	-78	687.91	3	208	504.47	R209	-77	482.14	3	204	382.44
L210	-78	642.83	3	208	486.37	R210	-77	449.21	3	204	264.01
L211	-78	590.63	3	208	398.73	R211	-77	383.82	3	204	029.90
L212	-78	551.42	3	208	375.81	R212	-76	939.93	3	202	920.59
L213	-78	300.12	3	208	389.47	R213	-76	740.67	3	202	448.62
L214	-78	298.02	3	208	349.06	R214	-76	328.75	3	201	471.49
L215	-78	539.50	3	208	336.50	R215	-76	323.32	3	201	458.32
L216	-78	489.21	3	208	244.22	R216	-75	946.33	3	200	544.89
L217	-78	142.72	3	207	868.42	R217	-75	672.25	3	199	880.78
L218	-77	676.67	3	207	411.47	R218	-75	541.30	3	199	676.32
L219	-77	497.18	3	207	184.72	R219	-75	440.95	3	199	522.48
L220	-77	328.45	3	206	828.49	R220	-75	316.90	3	199	364.91
L221	-77	290.12	3	206	581.31	R221	-75	208.64	3	199	227.41
L222	-77	274.73	3	206	342.52	R222	-75	021.73	3	198	999.24
L223	-77	422.74	3	205	407.00	R223	-74	579.38	3	198	540.00
L224	-77	436.33	3	205	128.10	R224	-74	459.39	3	198	383.18
L225	-77	443.77	3	204	792.15	R225	-74	373.50	3	198	286.04
L226	-77	394.42	3	204	428.68	R226	-74	254.74	3	198	159.50
L227	-77	361.22	3	204	310.23	R227	-74	023.54	3	197	913.12
L228	-77	280.57	3	204	023.39	R228	-73	821.63	3	197	697.94
L229	-76	831.28	3	202	941.41	R229	-72	747.50	3	196	507.42
L230	-76	692.27	3	202	603.84	R230	-72	714.75	3	196	437.65
L231	-76	240.93	3	201	509.81	R231	-72	625.66	3	196	262.32
L232	-75	959.24	3	200	827.00	R232	-72	731.77	3	196	232.89
L233	-75	689.94	3	200	174.23	R233	-72	803.26	3	196	220.61
L234	-75	549.10	3	199	878.83	R234	-72	874.60	3	196	187.42
L235	-75	320.30	3	199	511.21	R235	-72	895.01	3	196	182.73
L236	-75	012.14	3	199	179.33	R236	-72	881.88	3	196	148.50
L237	-74	679.96	3	198	794.91	R237	-72	880.12	3	196	142.48
L238	-73	754.58	3	197	759.43	R238	-72	606.01	3	196	224.83
L239	-72	942.36	3	196	864.79	R239	-72	564.57	3	196	168.63
L240	-72	620.61	3	196	529.55	R240	-72	499.91	3	196	117.70
L241	-72	505.82	3	196	442.34	R241	-72	397.80	3	196	031.35
L242	-72	463.69	3	196	413.48	R242	-72	168.67	3	195	633.53
L243	-72	429.89	3	196	377.82	R243	-72	041.68	3	195	476.76
L244	-72	410.43	3	196	353.91	R244	-71	918.38	3	195	274.22
L245	-72	366.24	3	196	341.25	R245	-71	646.18	3	194	808.72
L246	-72	317.08	3	196	355.07	R246	-71	264.57	3	194	181.56
L247	-72	253.69	3	196	368.20	R247	-71	235.50	3	194	127.81
L248	-72	220.23	3	196	370.44	R248	-71	031.04	3	193	750.28
L249	-72	225.74	3	196	327.09	R249	-70	880.69	3	193	560.67
L250	-72	307.32	3	196	316.51	R250	-70	774.74	3	193	344.54
L251	-72	377.37	3	196	293.81	R251	-70	551.50	3	192	986.62
L252	-72	326.27	3	196	167.98	R252	-70	381.63	3	192	740.75
L253	-72	206.88	3	195	937.85	R253	-70	093.31	3	192	280.16
L254	-72	099.24	3	195	777.43	R254	-69	720.00	3	191	779.34
L255	-72	072.88	3	195	730.53	R255	-69	522.08	3	191	577.71

Vel Sheet	16	Van of	17	P1050/18
-----------	----	--------	----	----------

PADRESERWE KOÖRDINATE / ROAD RESERVE CO-ORDINATES							
LINKERKANT/LEFT HAND SIDE				REGTERKANT/RIGHT HAND SIDE			
	Y	X	WG 29°		Y	X	
L256	-71 996.64	3 195	566.76	R256	-69 192.26	3 191	209.20
L257	-71 843.81	3 195	316.23	R257	-69 095.98	3 191	101.64
L258	-71 719.42	3 195	130.74	R258	-68 822.88	3 190	737.50
L259	-71 676.72	3 195	066.24	R259	-68 543.16	3 190	339.06
L260	-71 181.92	3 194	232.42	R260	-68 334.03	3 189	953.23
L261	-71 172.13	3 194	217.88	R261	-68 302.79	3 189	895.58
L262	-70 938.52	3 193	875.48	R262	-68 245.39	3 189	725.15
L263	-70 820.01	3 193	644.47	R263	-68 062.28	3 189	272.89
L264	-70 667.94	3 193	484.90	R264	-68 003.44	3 189	073.64
L265	-70 419.75	3 193	092.02	R265	-67 950.62	3 189	014.93
L266	-70 233.39	3 192	691.41	R266	-67 919.39	3 188	990.98
L267	-69 912.03	3 192	213.25	R267	-67 854.63	3 188	832.91
L268	-69 777.60	3 192	045.81	R268	-67 313.43	3 187	515.77
L269	-69 661.17	3 191	900.82	R269	-67 232.55	3 187	272.89
L270	-69 585.68	3 191	787.49	R270	-67 212.09	3 187	211.47
L271	-69 141.49	3 191	301.12	R271	-67 104.12	3 186	983.84
L272	-69 019.08	3 191	167.08	R272	-67 075.13	3 186	921.96
L273	-68 733.56	3 190	801.75	R273	-67 041.54	3 186	827.57
L274	-68 626.71	3 190	644.44	R274	-66 726.27	3 186	070.43
L275	-68 408.53	3 190	708.19	R275	-66 611.06	3 185	728.84
L276	-68 404.61	3 190	692.27	R276	-66 432.12	3 185	317.31
L277	-68 607.31	3 190	615.84	R277	-66 331.85	3 185	086.72
L278	-68 495.76	3 190	451.06	R278	-66 336.96	3 184	954.83
L279	-68 304.76	3 190	141.50	R279	-66 339.94	3 184	842.71
L280	-68 267.31	3 190	058.22	R280	-66 462.90	3 184	800.07
L281	-68 192.33	3 189	891.44	R281	-66 447.34	3 184	762.84
L282	-68 064.59	3 189	607.37	R282	-66 327.94	3 184	805.71
L283	-67 782.58	3 188	908.00	R283	-66 273.42	3 184	721.45
L284	-67 410.68	3 187	994.81	R284	-66 182.92	3 184	640.79
L285	-67 127.90	3 187	353.35	R285	-66 123.81	3 184	588.28
L286	-67 117.21	3 187	325.78	R286	-65 991.01	3 184	296.98
L287	-66 999.85	3 187	022.86	R287	-65 550.30	3 183	178.59
L288	-66 947.51	3 186	887.90	R288	-65 395.89	3 182	848.75
L289	-66 306.31	3 185	364.67	R289	-65 154.05	3 182	466.26
L290	-66 243.51	3 185	215.76	R290	-65 126.38	3 182	422.50
L291	-66 093.49	3 185	033.18	R291	-65 068.25	3 182	335.18
L292	-66 030.94	3 184	952.71	R292	-65 023.62	3 182	270.25
L293	-65 919.78	3 184	991.75				
L294	-65 904.47	3 184	954.52				
L295	-66 017.94	3 184	914.71				
L296	-66 016.30	3 184	805.46				
L297	-66 014.25	3 184	696.70				
L298	-66 012.54	3 184	612.53				
L299	-65 846.98	3 184	183.13				
L300	-65 634.24	3 183	665.22				
L301	-65 356.47	3 183	070.27				
L302	-65 117.20	3 182	591.29				
L303	-65 040.20	3 182	489.51				
L304	-65 006.92	3 182	435.29				
L305	-64 963.41	3 182	364.40				

Vel Sheet	17	Van of	17
--------------	----	-----------	----

P1050/18