

DEPARTMENT OF TRANSPORT

NO. 406

15 MARCH 2019

**THE SOUTH AFRICAN NATIONAL ROADS
AGENCY SOC LIMITED**

Registration No: 1998/009584/30

DECLARATION AMENDMENT OF NATIONAL ROAD N1 SECTION 24

AMENDMENT OF DECLARATION NO'S. 39 OF 1984, 2029 OF 1990 AND 1738 OF 1994.

By virtue of section 40(1)(b) of The South African National Roads Agency Limited and National Roads Act, 1998 (Act No. 7 of 1998), I hereby amend **(I)** Declaration No. 39 of 1984 the section of the route from its start up to points L16 and R17 on sheet 2 of Plan No. P217/83, **(II)** Declaration No. 2029 of 1990, the section of the route from the common boundary between the farms Tweefontein 463-KR and Cyferfontein 457-KR up to its end, **(III)** Declaration No. 1738 of 1994, in its entirety, by substituting all sheets of their respective Plans with the accompanying sheets 1 to 10 of Plan No. P1057/18.

(National Road N1 Section 24: Cyferfontein – Middelfontein)



MINISTER OF TRANSPORT

DEPARTEMENT VAN VERVOER

NO. 406

15 MAART 2019

**DIE SUID-AFRIKAANSE NASIONALE
PADAGENTSKAP MSB BEPERK**

Registrasie No: 1998/009584/30

VERKLARING WYSIGING VAN NASIONALE PAD N1 SEKSIE 24

WYSIGING VAN VERKLARING NO'S. 39 VAN 1984, 2029 VAN 1990 EN 1738 VAN 1994.

Kragtens Artikel 40(1)(b) van die Wet op die Suid-Afrikaanse Nasionale Padagentskap Beperk en op Nasionale Paaie, 1998 (Wet No.7 van 1998), wysig ek hiermee (I) Verklaring No. 39 van 1984, die gedeelte van die roete vanaf die begin tot by punte L16 en R17 op vel 2 van Plan No. P217/83, (II) Verklaring No. 2029 van 1990, die gedeelte van die roete vanaf die algemene grens tussen die plase Tweefontein 463-KR en Cyferfontein 457-KR op vel 2 van Plan No. P261/90 tot by die einde, (III) Verklaring No. 1738 van 1994 in sy geheel, deur alle velle van hulle respektiewelike Planne te vervang met meegaande velle 1 tot 10 van Plan No. P1057/18.

(Nasionale Pad N1 Seksie 24: Cyferfontein – Middelfontein)



MINISTER VAN VERVOER

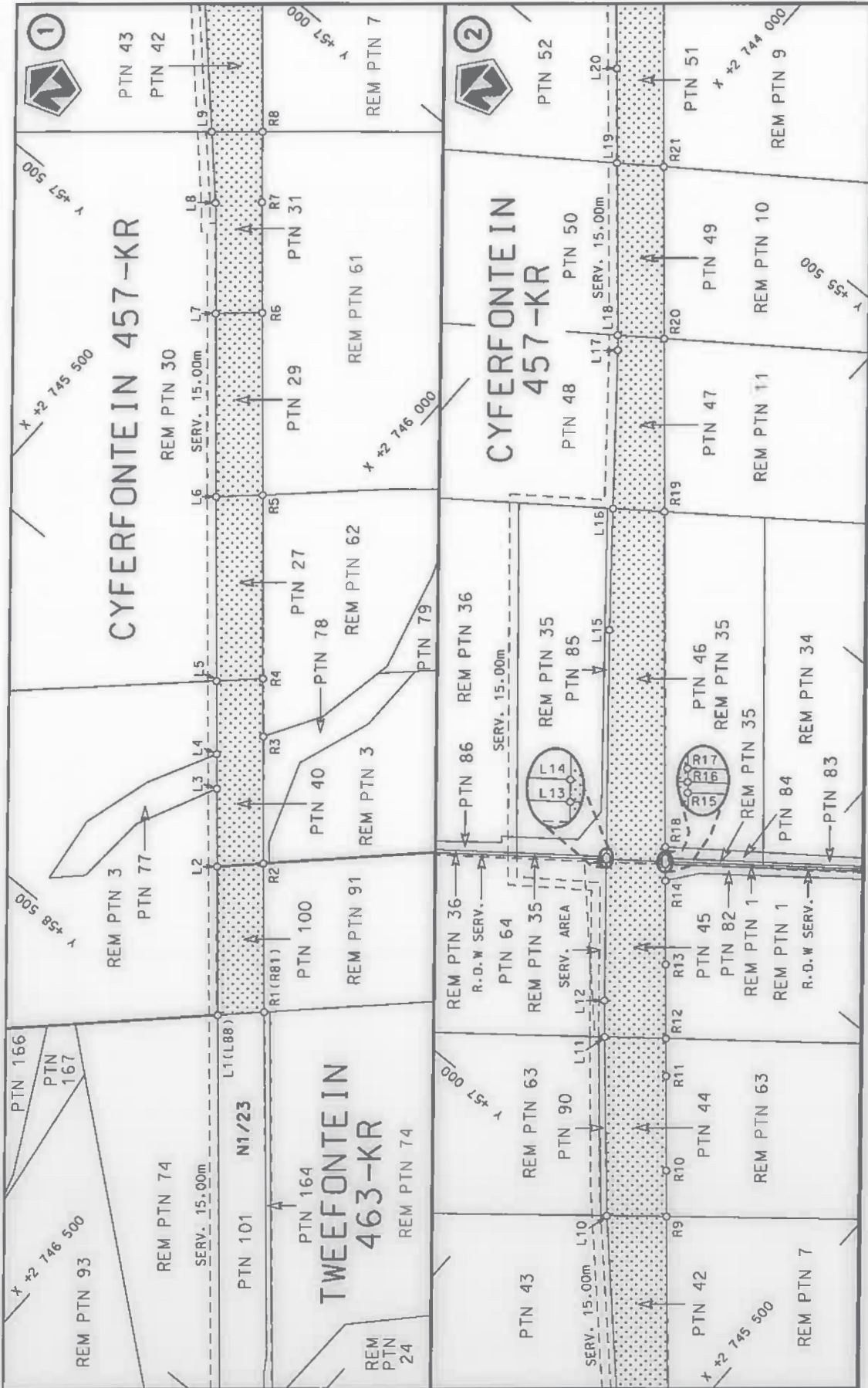

Die Suid Afrikaanse Nasionale Padagentskap MSB Bpk The South African National Roads Agency SOC Ltd	Die figuur getoon The figure shown	steldie podreserwe voor van 'n gedeelte represents the road reserve of a portion van Nasionale Roete N1 of National Route	Vel Sheet 1 of 10
		Seksie Section 24	Plan P1057/18

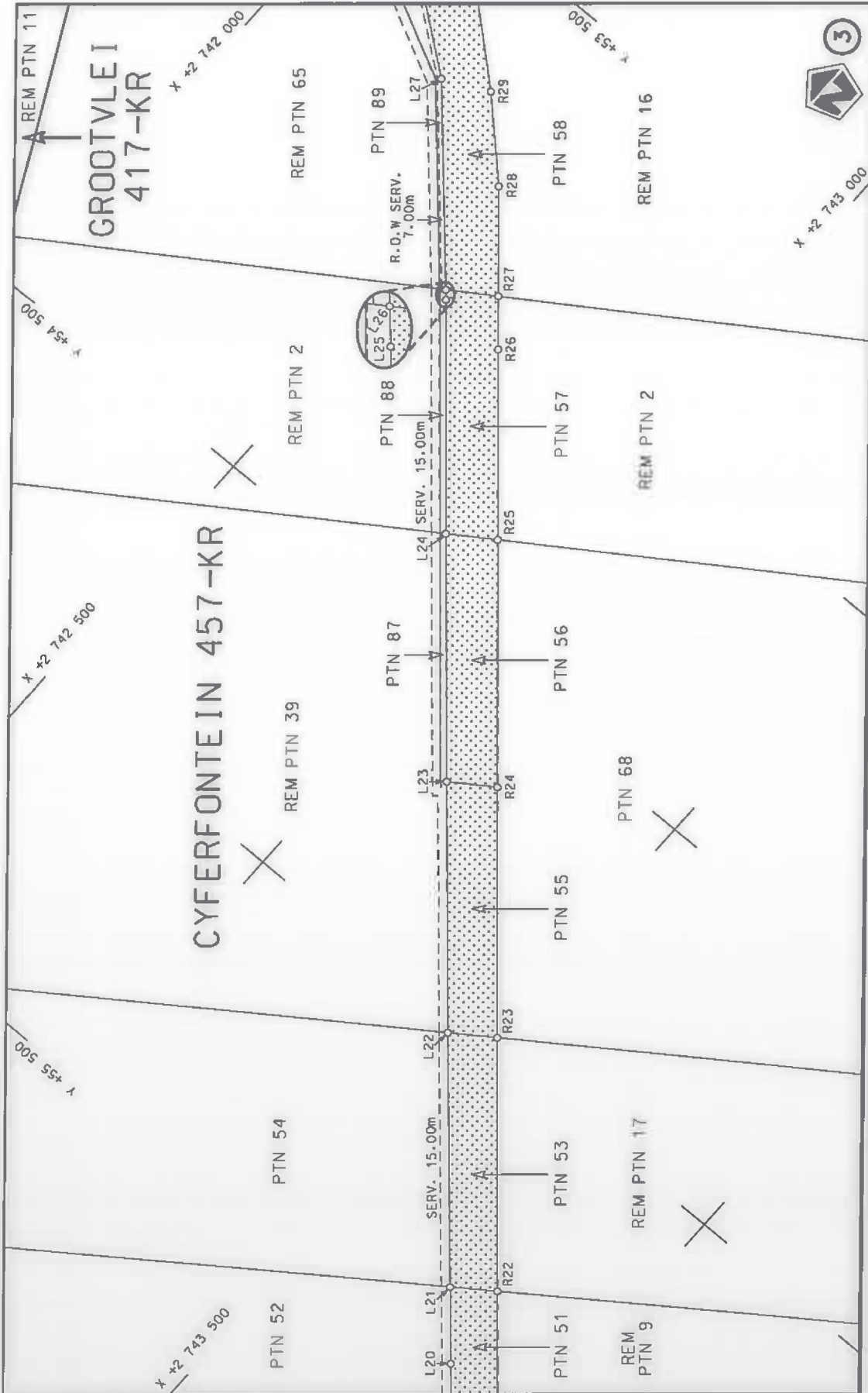

<p>Die Suid Afrikaanse Nasionale Padagentskap MSB Bpk The South African National Roads Agency SOC Ltd</p>	<p>Die figuur getoon The figure shown</p>	<p>stelt die padreserwe voor van 'n gedeelte represents the road reserve of a portion van Nasionale Roete N1 of National Route</p>	<p>Vel Sheet 2 of 10 Plan P1057/18</p>
		<p>Seksie 24</p>	

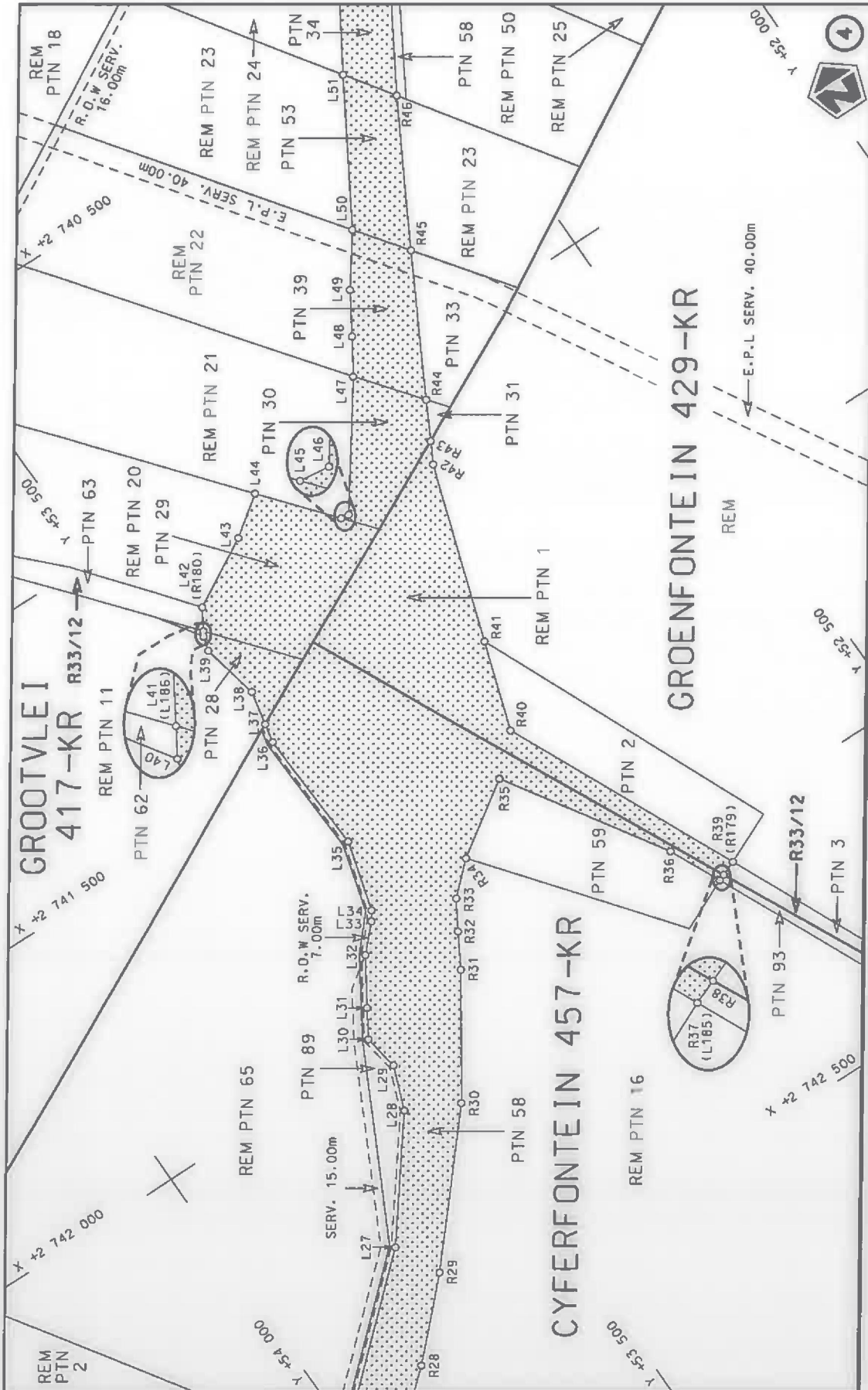

Die Suid Afrikaanse Nasionale Padagentskap MSB Bpk The South African National Roads Agency SOC Ltd	Die figuur getoon The figure shown	 steldie padreserwe voor van 'n gedeelte represents the road reserve of a portion van Nasionale Roete N1 of National Route N1 Section	Vel Sheet 3 of 10 Plan P1057/18
---	---------------------------------------	---	------------------------------------

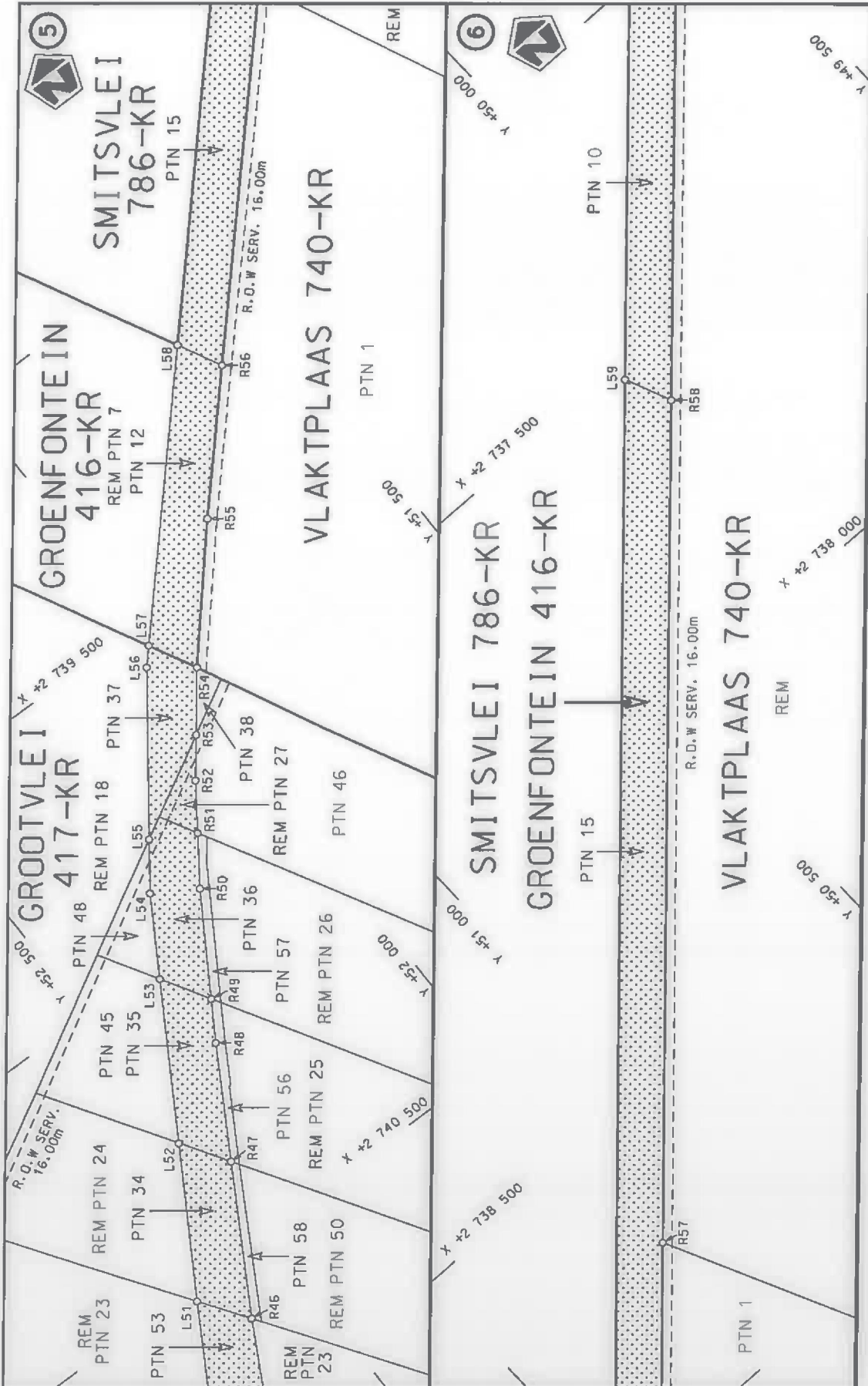

<p>Die Suid-Afrikaanse Nasionale Padagentskap MSB Bpk The South African National Roads Agency SOC Ltd</p>	<p>Die figuur getoon The figure shown</p>		<p>stelt die padreserwe voor van 'n gedeelte represents the road reserve of a portion van Nasionale Roete N1 of National Route</p>	<p>Vel Sheet 4 of 10 Plan P1057/18</p>
		<p>24</p>	<p>Seksie Section</p>	<p>24</p>

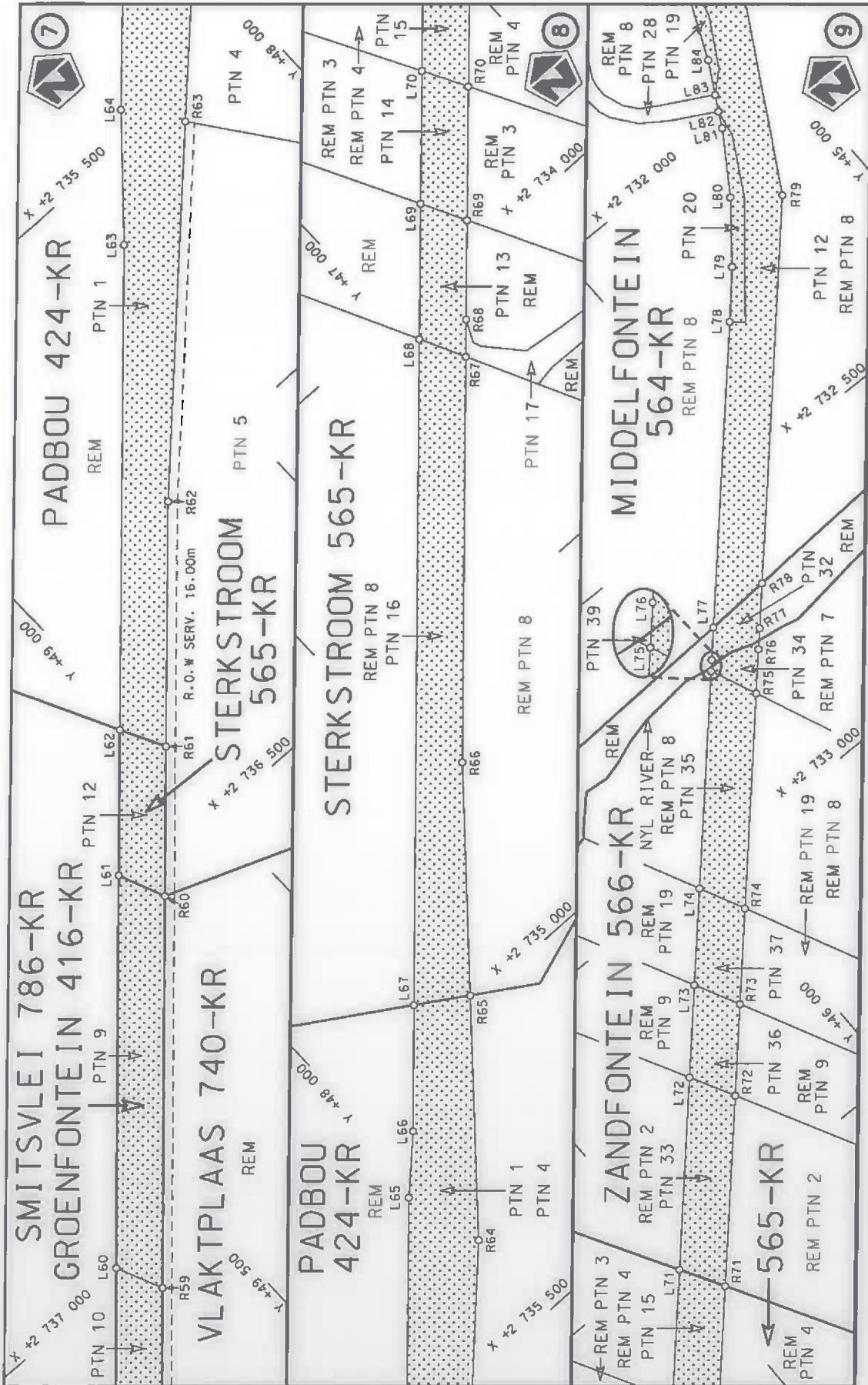

Die Suid Afrikaanse Nasionale Padagentskap MSB Bpk The South African National Roads Agency SOC Ltd	Die figuur getoon The figure shown		steldie podreserwe voor van 'n gedeelte represents the road reserve of a portion van Nasionale Roete N1 of National Route	Vel Sheet 5 of 10 Plan P1057/18
---	---------------------------------------	---	--	------------------------------------

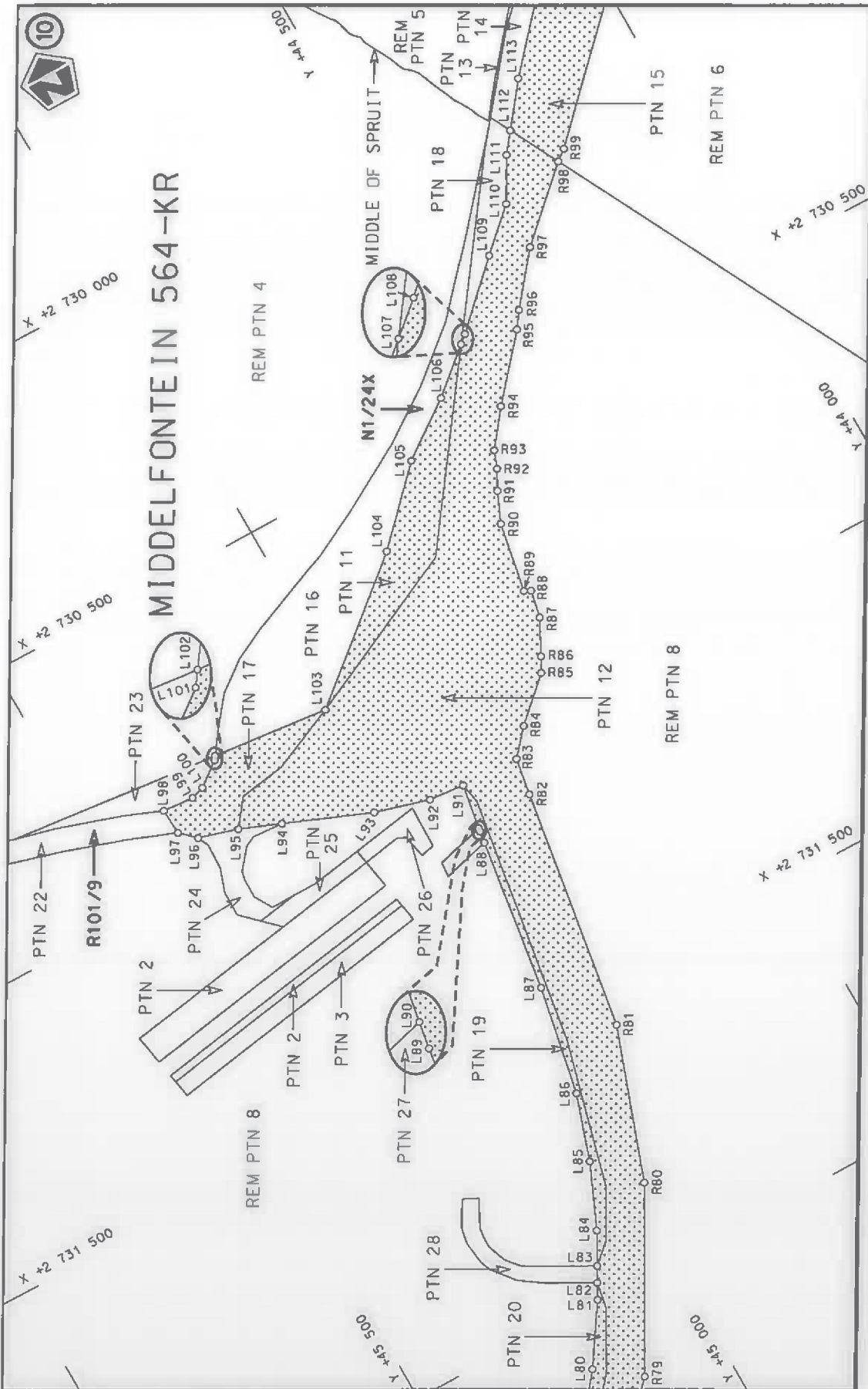

<p>Die Suid Afrikaanse Nasionale Padagentskap MSB Bpk The South African National Roads Agency SOC Ltd</p>	<p>Die figuur getoon The figure shown</p>	<p>steldie padreserwe voor van 'n gedeelte represents the road reserve of a portion van Nasionale Roete N1 of National Route</p>	<p>Vel Sheet 6 of 10 Plan P1057/18</p>
		<p>24</p>	<p>24</p>

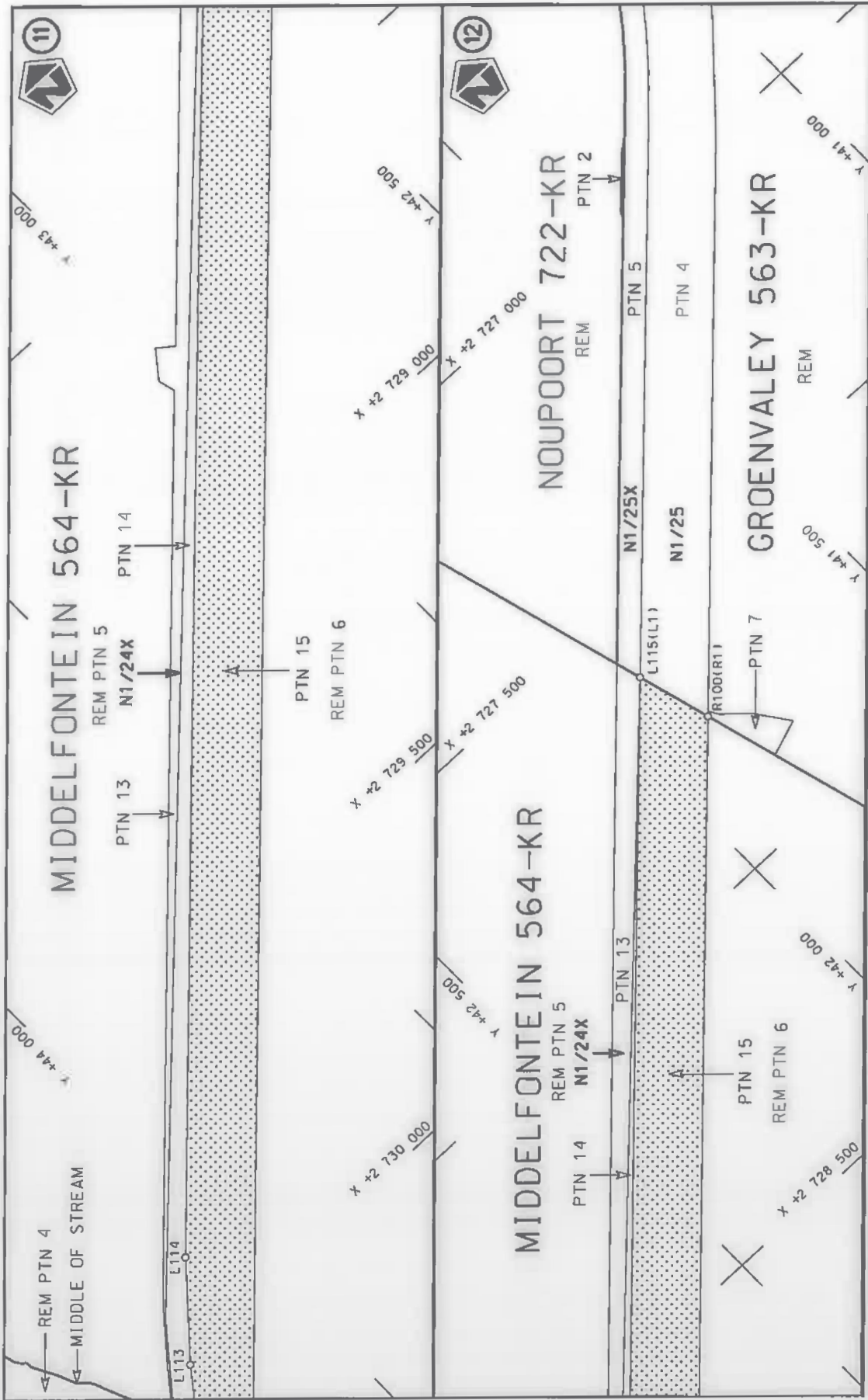

PADRESERWE KOÖRDINATE / ROAD RESERVE CO-ORDINATES					
LINKERKANT/LEFT HAND SIDE			REGTERKANT/RIGHT HAND SIDE		
	Y	X	WG 29°	Y	X
L1	58 459.13	2 746 421.26		R1	58 403.80 2 746 479.04
L2	58 258.15	2 746 247.24		R2	58 202.95 2 746 304.43
L3	58 152.55	2 746 155.83		R3	58 030.45 2 746 156.25
L4	58 105.96	2 746 115.49		R4	57 952.33 2 746 088.28
L5	58 006.83	2 746 029.67		R5	57 704.13 2 745 873.42
L6	57 757.61	2 745 813.89		R6	57 457.73 2 745 660.11
L7	57 510.20	2 745 599.72		R7	57 308.48 2 745 530.90
L8	57 360.85	2 745 470.42		R8	57 212.54 2 745 449.31
L9	57 268.88	2 745 382.41		R9	56 969.68 2 745 237.83
L10	57 034.82	2 745 158.16		R10	56 907.57 2 745 184.02
L11	56 794.18	2 744 946.53		R11	56 779.30 2 745 073.09
L12	56 744.84	2 744 903.78		R12	56 728.48 2 745 029.11
L13	56 551.15	2 744 741.38		R13	56 628.05 2 744 942.20
L14	56 547.33	2 744 738.17		R14	56 514.78 2 744 844.15
L15	56 236.56	2 744 477.59		R15	56 492.52 2 744 824.88
L16	56 068.03	2 744 340.47		R16	56 488.86 2 744 821.70
L17	55 848.18	2 744 161.84		R17	56 484.26 2 744 817.73
L18	55 828.10	2 744 144.39		R18	56 469.14 2 744 804.64
L19	55 595.87	2 743 942.54		R19	56 015.27 2 744 411.73
L20	55 468.39	2 743 831.75		R20	55 781.18 2 744 209.09
L21	55 365.64	2 743 741.26		R21	55 549.15 2 744 008.21
L22	55 024.95	2 743 441.23		R22	55 318.56 2 743 808.61
L23	54 687.71	2 743 146.71		R23	54 976.47 2 743 512.46
L24	54 355.09	2 742 856.20		R24	54 638.64 2 743 220.03
L25	54 040.60	2 742 583.29		R25	54 305.44 2 742 931.58
L26	54 027.33	2 742 571.27		R26	54 049.21 2 742 709.76
L27	53 749.04	2 742 319.41		R27	53 977.53 2 742 647.94
L28	53 600.44	2 742 124.79		R28	53 829.45 2 742 520.24
L29	53 571.19	2 742 046.98		R29	53 711.07 2 742 399.39
L30	53 580.62	2 741 983.88		R30	53 511.89 2 742 168.70
L31	53 551.17	2 741 936.04		R31	53 380.19 2 741 969.90
L32	53 501.26	2 741 855.46		R32	53 346.49 2 741 910.21
L33	53 459.26	2 741 811.16		R33	53 316.05 2 741 859.44
L34	53 448.40	2 741 795.28		R34	53 262.61 2 741 809.17
L35	53 412.94	2 741 670.37		R35	53 136.67 2 741 723.40
L36	53 420.64	2 741 450.02		R36	52 965.84 2 741 996.40
L37	53 413.53	2 741 416.28		R37	52 924.61 2 742 087.23
L38	53 400.65	2 741 355.24		R38	52 913.58 2 742 082.81
L39	53 422.08	2 741 251.53		R39	52 887.86 2 742 072.52
L40	53 414.92	2 741 225.60		R40	53 073.15 2 741 662.02
L41	53 409.82	2 741 217.22		R41	53 021.69 2 741 504.59
L42	53 388.00	2 741 181.11		R42	52 919.91 2 741 191.84
L43	53 267.67	2 741 113.08		R43	52 900.35 2 741 154.91
L44	53 199.95	2 741 063.57		R44	52 865.45 2 741 089.10
L45	53 102.69	2 741 183.48		R45	52 739.96 2 740 852.58
L46	53 089.01	2 741 185.25		R46	52 607.88 2 740 608.94
L47	52 946.11	2 740 984.33		R47	52 464.56 2 740 363.45
L48	52 908.09	2 740 923.73		R48	52 356.48 2 740 178.32
L49	52 864.96	2 740 852.69		R49	52 314.52 2 740 110.45
L50	52 802.49	2 740 765.65		R50	52 209.96 2 739 941.35
L51	52 662.90	2 740 526.82		R51	52 152.84 2 739 859.84

Vel 8 Van 10
Sheet of

P1057/18

PADRESERWE KOÖRDINATE / ROAD RESERVE CO-ORDINATES											
LINKERKANT/LEFT HAND SIDE					REGTERKANT/RIGHT HAND SIDE						
	Y		X	WG 29°		Y		X			
L52	52	515.51	2	740	281.86	R52	52	098.68	2	739	782.54
L53	52	362.57	2	740	027.66	R53	52	048.44	2	739	718.15
L54	52	282.89	2	739	895.29	R54	51	974.02	2	739	622.84
L55	52	225.35	2	739	817.46	R55	51	798.48	2	739	421.89
L56	52	042.17	2	739	569.71	R56	51	612.84	2	739	218.97
L57	52	015.81	2	739	540.70	R57	51	153.10	2	738	717.44
L58	51	651.44	2	739	143.01	R58	50	132.87	2	737	604.45
L59	50	167.01	2	737	522.82	R59	49	639.83	2	737	066.10
L60	49	674.55	2	736	985.27	R60	49	164.35	2	736	546.92
L61	49	198.35	2	736	465.46	R61	48	983.13	2	736	349.13
L62	49	021.77	2	736	272.70	R62	48	686.59	2	736	025.39
L63	48	434.68	2	735	632.03	R63	48	209.48	2	735	539.40
L64	48	276.99	2	735	448.66	R64	47	997.11	2	735	323.09
L65	48	033.95	2	735	184.72	R65	47	712.85	2	734	987.09
L66	47	948.60	2	735	101.32	R66	47	442.45	2	734	667.17
L67	47	795.88	2	734	934.23	R67	46	951.17	2	734	130.92
L68	46	988.83	2	734	053.68	R68	46	906.14	2	734	081.80
L69	46	825.02	2	733	874.88	R69	46	786.12	2	733	950.81
L70	46	664.50	2	733	699.67	R70	46	624.42	2	733	774.32
L71	46	507.19	2	733	527.97	R71	46	465.93	2	733	601.33
L72	46	273.70	2	733	273.11	R72	46	234.66	2	733	348.90
L73	46	161.34	2	733	150.46	R73	46	123.52	2	733	227.58
L74	46	044.25	2	733	022.66	R74	46	007.39	2	733	100.81
L75	45	780.60	2	732	734.88	R75	45	746.44	2	732	816.03
L76	45	766.94	2	732	719.99	R76	45	692.80	2	732	757.46
L77	45	727.54	2	732	676.97	R77	45	667.37	2	732	729.76
L78	45	357.29	2	732	272.83	R78	45	613.06	2	732	670.45
L79	45	291.61	2	732	199.45	R79	45	142.79	2	732	157.15
L80	45	214.65	2	732	101.54	R80	44	974.88	2	731	852.51
L81	45	146.35	2	731	997.10	R81	44	879.77	2	731	581.33
L82	45	132.30	2	731	969.86	R82	44	809.83	2	731	146.43
L83	45	117.61	2	731	943.38	R83	44	798.88	2	731	079.96
L84	45	087.40	2	731	887.46	R84	44	759.28	2	731	034.24
L85	45	038.15	2	731	773.19	R85	44	686.99	2	730	965.98
L86	44	998.87	2	731	655.10	R86	44	673.41	2	730	939.77
L87	44	959.99	2	731	459.69	R87	44	641.60	2	730	877.55
L88	44	918.89	2	731	184.17	R88	44	631.41	2	730	828.36
L89	44	915.67	2	731	163.03	R89	44	642.39	2	730	822.77
L90	44	914.60	2	731	156.86	R90	44	618.69	2	730	698.29
L91	44	900.65	2	731	076.59	R91	44	595.28	2	730	643.60
L92	44	962.60	2	731	071.04	R92	44	576.78	2	730	608.54
L93	45	057.53	2	731	043.37	R93	44	565.10	2	730	577.20
L94	45	205.71	2	730	982.56	R94	44	516.95	2	730	513.72
L95	45	275.67	2	730	953.99	R95	44	427.27	2	730	406.95
L96	45	344.39	2	730	933.35	R96	44	407.31	2	730	378.40
L97	45	370.33	2	730	907.73	R97	44	336.38	2	730	289.28
L98	45	372.17	2	730	861.48	R98	44	221.13	2	730	178.66
L99	45	318.15	2	730	865.54	R99	44	201.61	2	730	163.43
L100	45	294.23	2	730	858.26	R100	41	872.46	2	727	746.64
L101	45	252.09	2	730	825.87						
L102	45	247.47	2	730	819.24						

Vel
Sheet

9

Van
of

10

P1057/18

PADRESERWE KOÖRDINATE / ROAD RESERVE CO-ORDINATES					
LINKERKANT/LEFT HAND SIDE			REGTERKANT/RIGHT HAND SIDE		
	Y	X	WG 29°	Y	X
L103	45 042.47	2 730 840.79			
L104	44 812.99	2 730 644.55			
L105	44 697.79	2 730 523.87			
L106	44 599.16	2 730 450.70			
L107	44 522.74	2 730 383.35			
L108	44 508.21	2 730 370.54			
L109	44 404.78	2 730 267.81			
L110	44 335.10	2 730 201.69			
L111	44 292.13	2 730 125.15			
L112	44 265.66	2 730 089.95			
L113	44 209.20	2 730 014.93			
L114	44 083.79	2 729 869.98			
L115	41 908.60	2 727 615.58			

Vel Sheet	10	Van of	10	P1057/18
--------------	----	-----------	----	----------