

DEPARTMENT OF TRANSPORT

NO. 1313

26 OCTOBER 2016

**THE SOUTH AFRICAN NATIONAL ROADS
AGENCY SOC LIMITED**

Registration No: 1998/009584/30

DECLARATION AMENDMENT OF NATIONAL ROAD N3 SECTION 9

AMENDMENT OF DECLARATION No's. 938 OF 1989, 2016 OF 1988, 180 OF 1975 AND
2369 OF 1988.

By virtue of section 40(1)(b) of The South African National Roads Agency Limited and National Roads Act, 1998 (Act No. 7 of 1998), I hereby amend (I) Declaration No. 938 of 1989 by substituting the section of the route from the common boundary between the farms Nooitgedacht 1761 and Pramkop 183 on sheet 3 of Plan No. P234/88 up to its end, (II) Declaration No. 2016 of 1988 by substituting it in its entirety, (III) Declaration No. 180 of 1975 by substituting it in its entirety, (IV) Declaration No. 2369 of 1988 by substituting the section of the route from its start up to the common boundary between the farms Malanskraal 407 - IR and Modderfontein 410 - IR on sheet 6 of Plan No. P381/90, with the accompanying sheets 1 to 18 of Plan No. P833/14.

(National Road N3 Section 9: Nooitgedacht – Vaal River)

A handwritten signature in black ink, appearing to read 'D. Steyn', is written over a horizontal line.

MINISTER OF TRANSPORT

DEPARTEMENT VAN VERVOER

NO. 1313

26 OKTOBER 2016

**DIE SUID-AFRIKAANSE NASIONALE
PADAGENTSKAP MSB BEPERK**

Registrasie No: 1998/009584/30

VERKLARING WYSIGING VAN NASIONALE PAD N3 SEKSIE 9

WYSIGING VAN VERKLARING No's. 938 VAN 1989, 2016 VAN 1988, 180 VAN 1975 EN
2369 VAN 1988.

Kragtens Artikel 40(1)(b) van die Wet op die Suid-Afrikaanse Nasionale Padagentskap Beperk en op Nasionale Paaie, 1998 (Wet No.7 van 1998), wysig ek hiermee (I) Verklaring No. 938 van 1989 deur die gedeelte van die roete te vervang vanaf die gemeenskaplike grens tussen die plase Nooitgedacht 1761 en Pramkop 183 op vel 3 van Plan No. P234/88 tot die einde, (II) Verklaring No. 2016 van 1988 deur dit in sy geheel te vervang, (III) Verklaring No. 180 van 1975 deur dit in sy geheel te vervang, (IV) Verklaring No. 236 van 1988 deur die gedeelte van die roete te vervang vanaf die begin tot by die gemeenskaplike grens tussen die plase Malanskraal 407 - IR en Modderfontein 410 - IR op vel 6 van Plan No. P381/90, met bygaande velle 1 tot 18 van Plan No. P833/14.

(Nasionale Pad N3 Seksie 9: Nooitgedacht – Vaal Rivier)



MINISTER VAN VERVOER

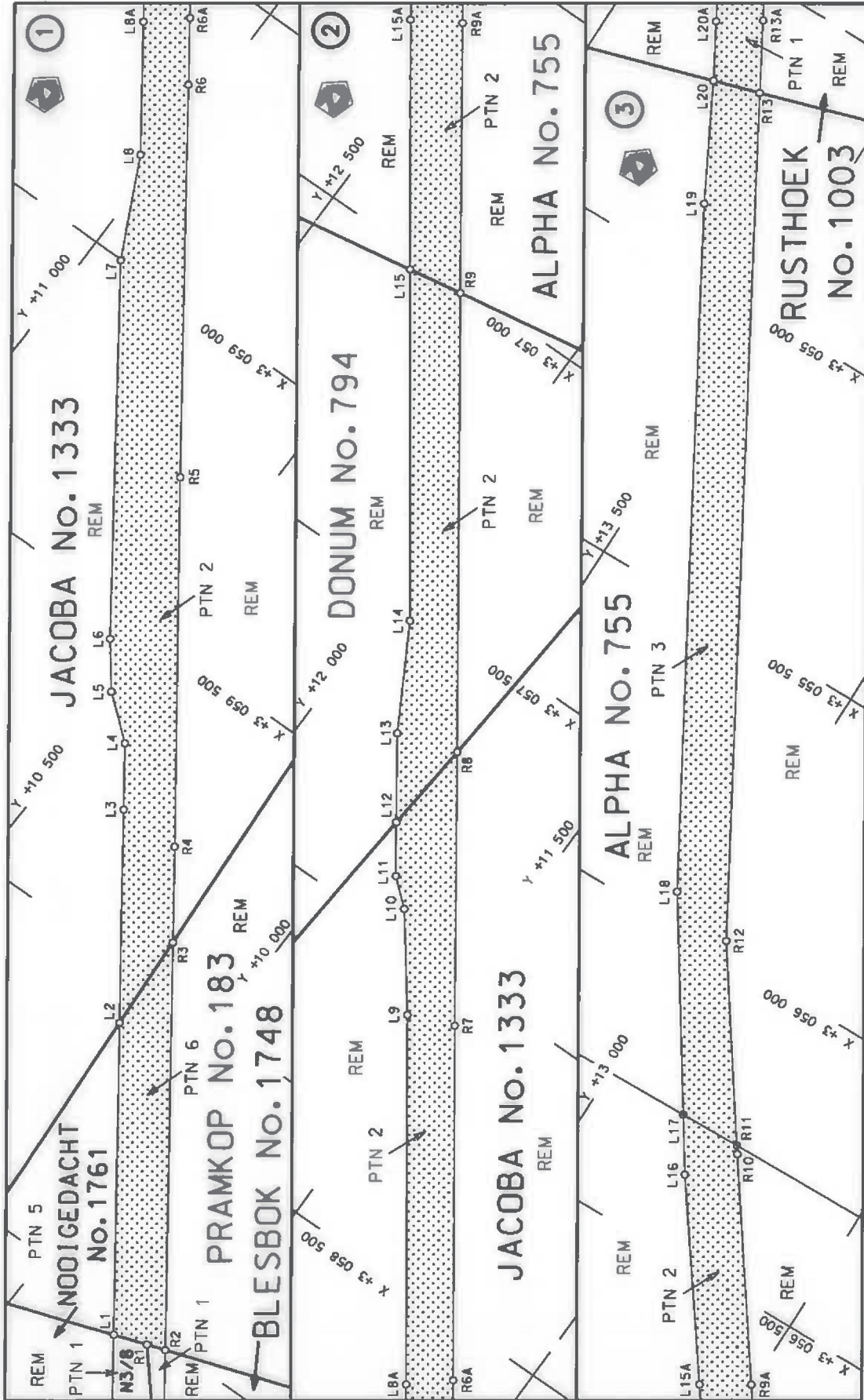

Die Suid Afrikaanse Nasionale Padagentskap Beperk The South African National Roads Agency Limited	Die figuur getoon The figure shown		steldie podreserwe voor van 'n gedeelte represents the road reserve of a portion van Nasionale Roete N3 Sektie 9 of National Route Section	
			Val Sheet 1 of 18	Plan P833/14

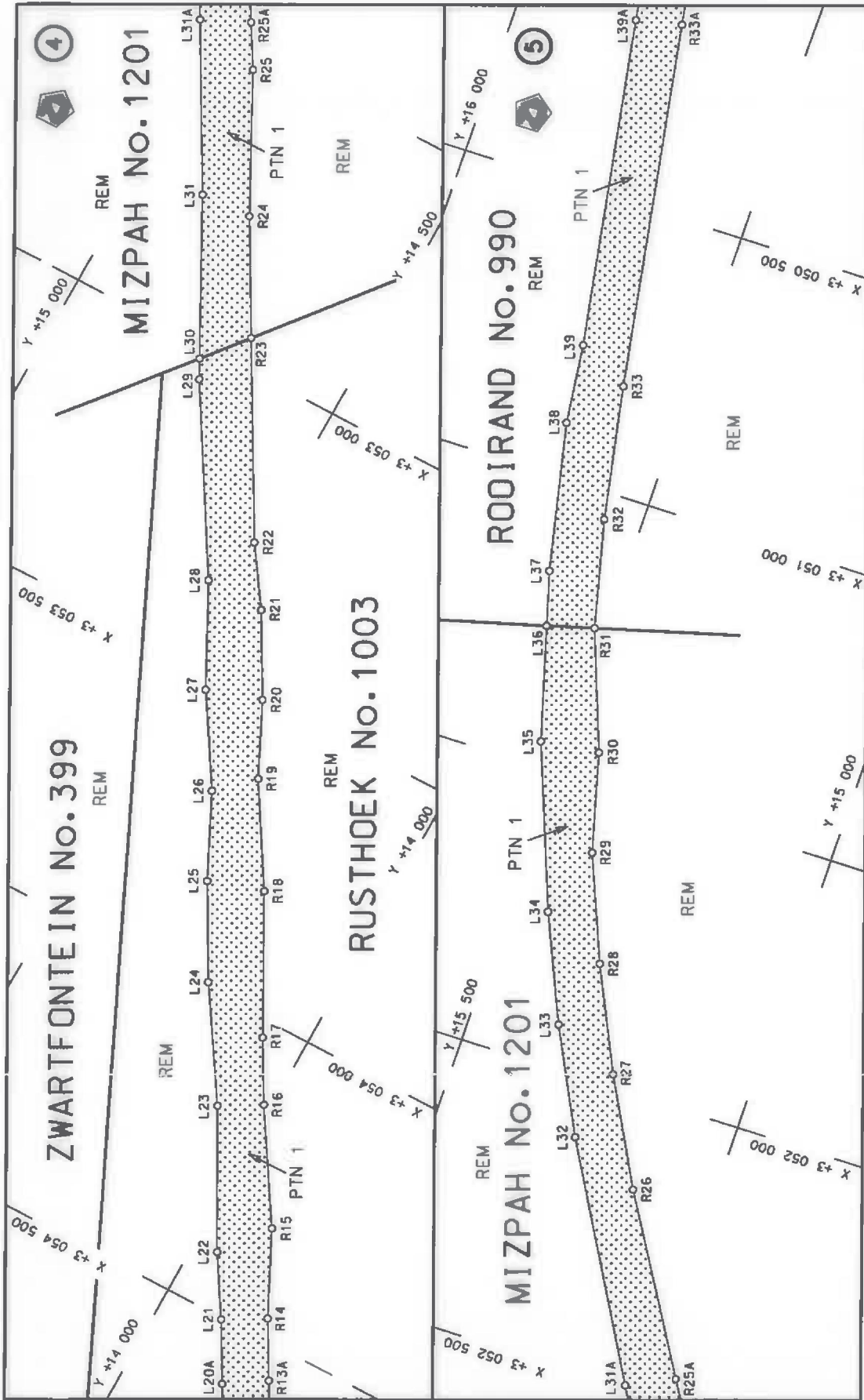

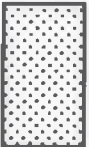
Die Suid Afrikaanse Nasionale Padagentskap Beperk The South African National Roads Agency Limited	Die figuur getoon The figure shown		steldie padreserwe voor van 'n gedeelte represents the road reserve of a portion van Nasionale Roete N3 Seksie 9 of National Route Section	Vel Sheet 2 of 18
				Plan P833/14

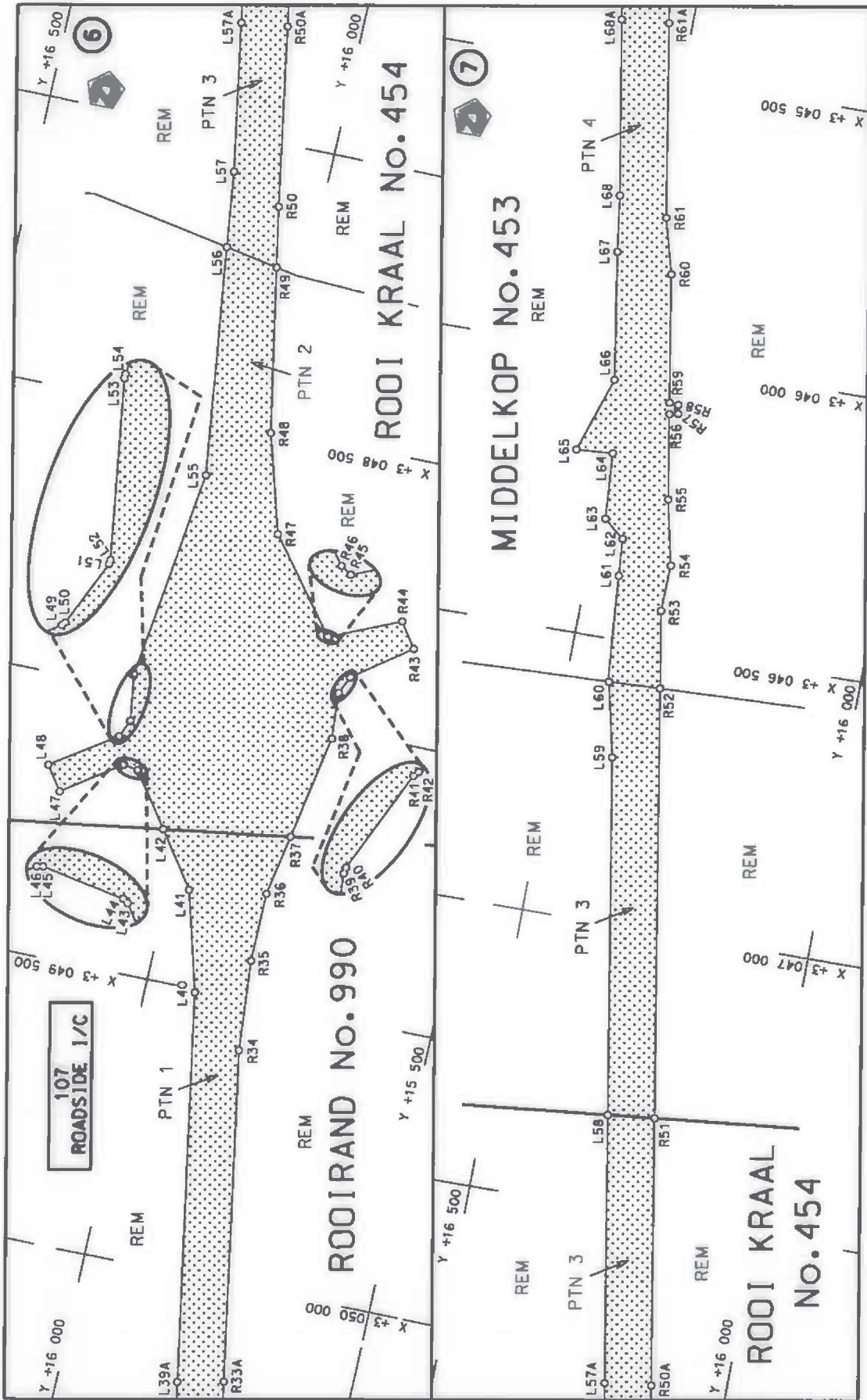

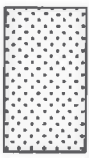
<p>Die Suid Afrikaanse Nasionale Padagentskop Beperk The South African National Roads Agency Limited</p>	<p>Die figuur getoon The figure shown</p>  <p>stelt die podreserwe voor van 'n gedeelte represents the road reserve of a portion van Nasionale Roete N3 of National Route N3</p> <p>Seksie 9 Section</p>	<p>Vel Sheet 3 van 18 Plan P833/14</p>
--	---	--

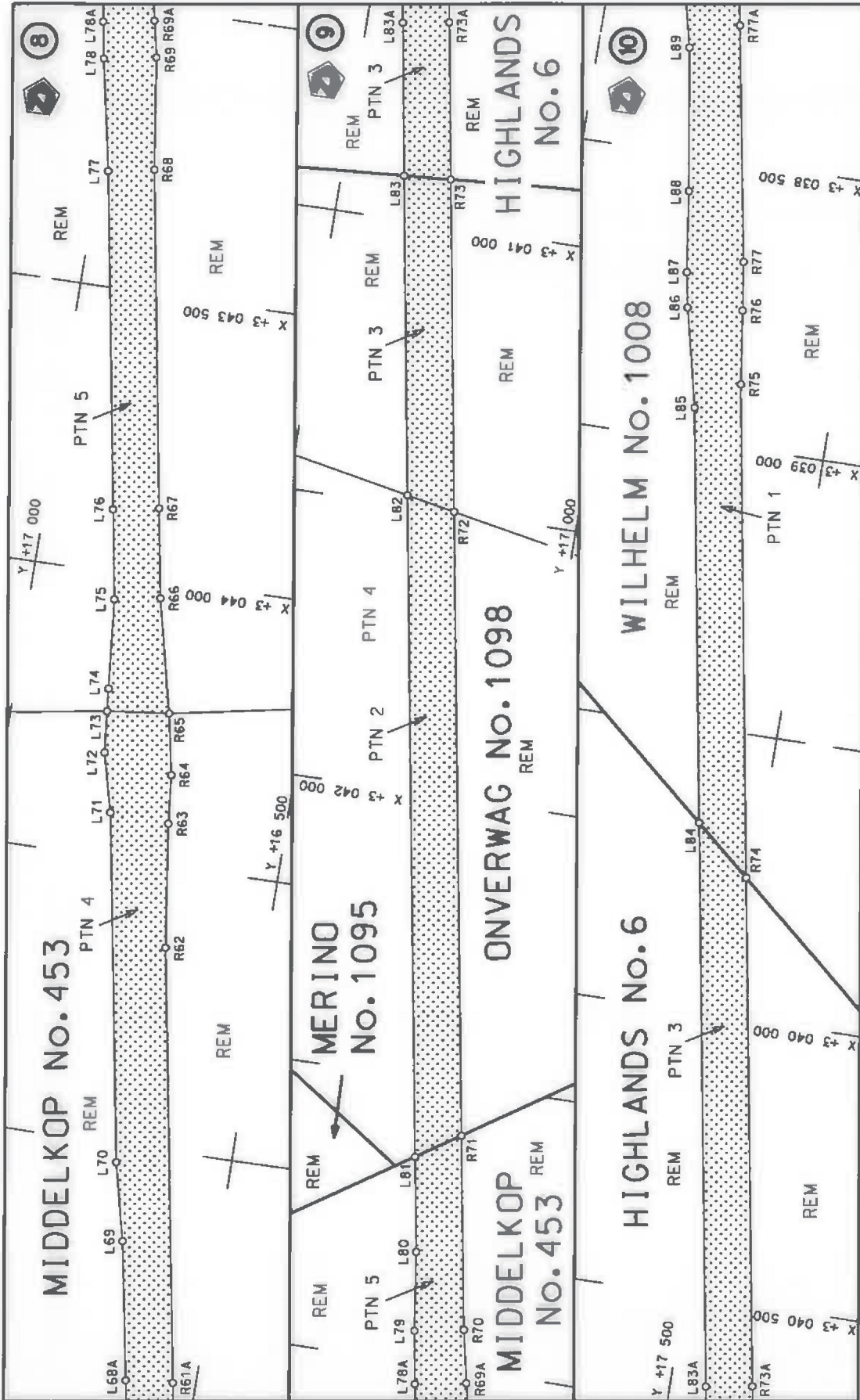

<p>Die Suid-Afrikaanse Nasionale Padagentskap Beperk The South African National Roads Agency Limited</p>	<p>Die figuur getoon The figure shown</p> 	<p>stelt die padreserwe voor van 'n gedeelte represents the road reserve of a portion van Nasionale Roete N3 of National Route</p>	<p>Vel Sheet 4 of 18</p> <p>Plan P833/14</p>
--	---	--	--

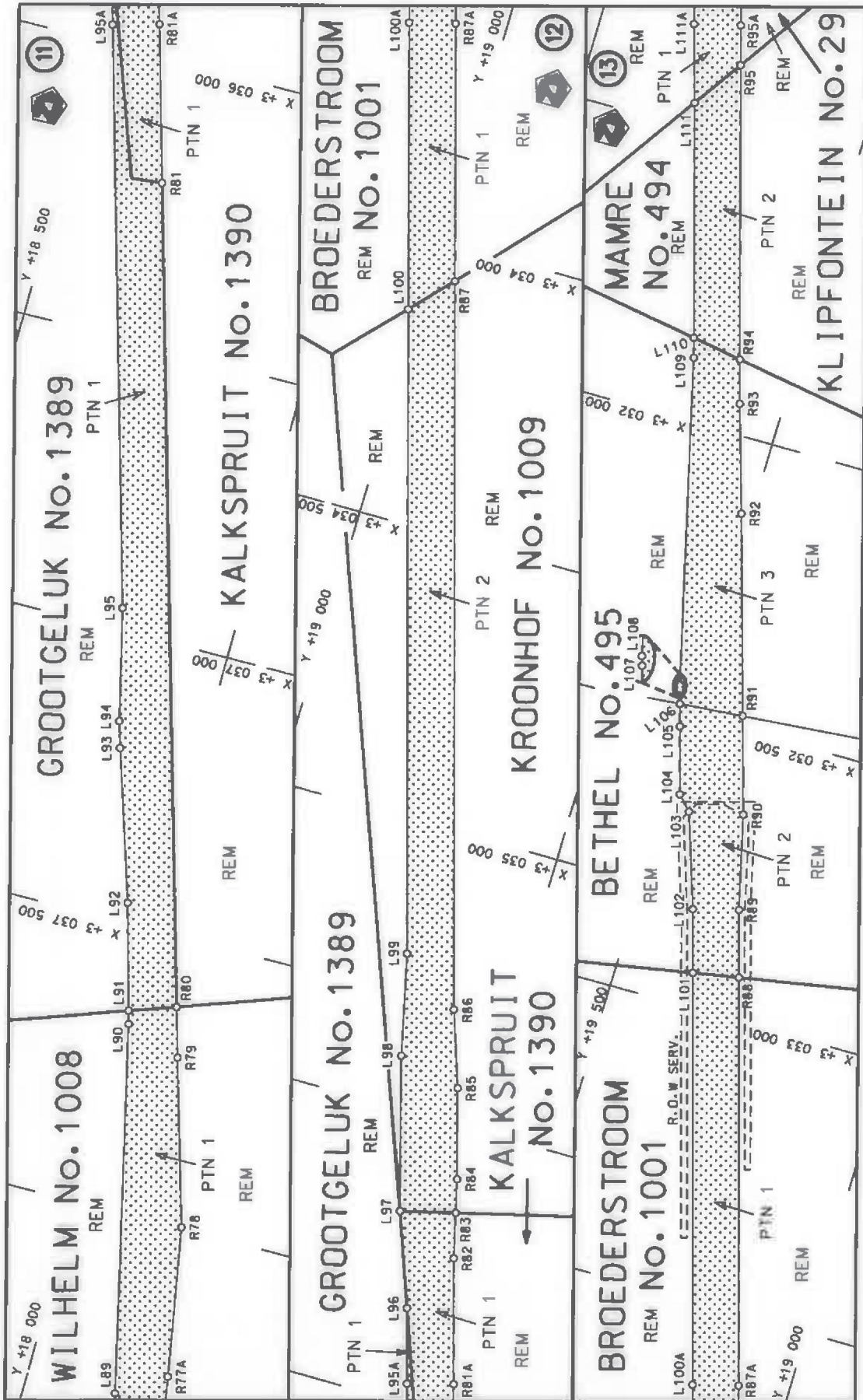

Die Suid Afrikaanse Nasionale Padagentskap Beperk The South African National Roads Agency Limited	Die figuur getoon The figure shown	steldie padreserwe voor van 'n gedeelte represents the road reserve of a portion van Nasionale Roete N3 of National Route N3 Section	9
		Vel Sheet 5 of 18 Plan P833/14	

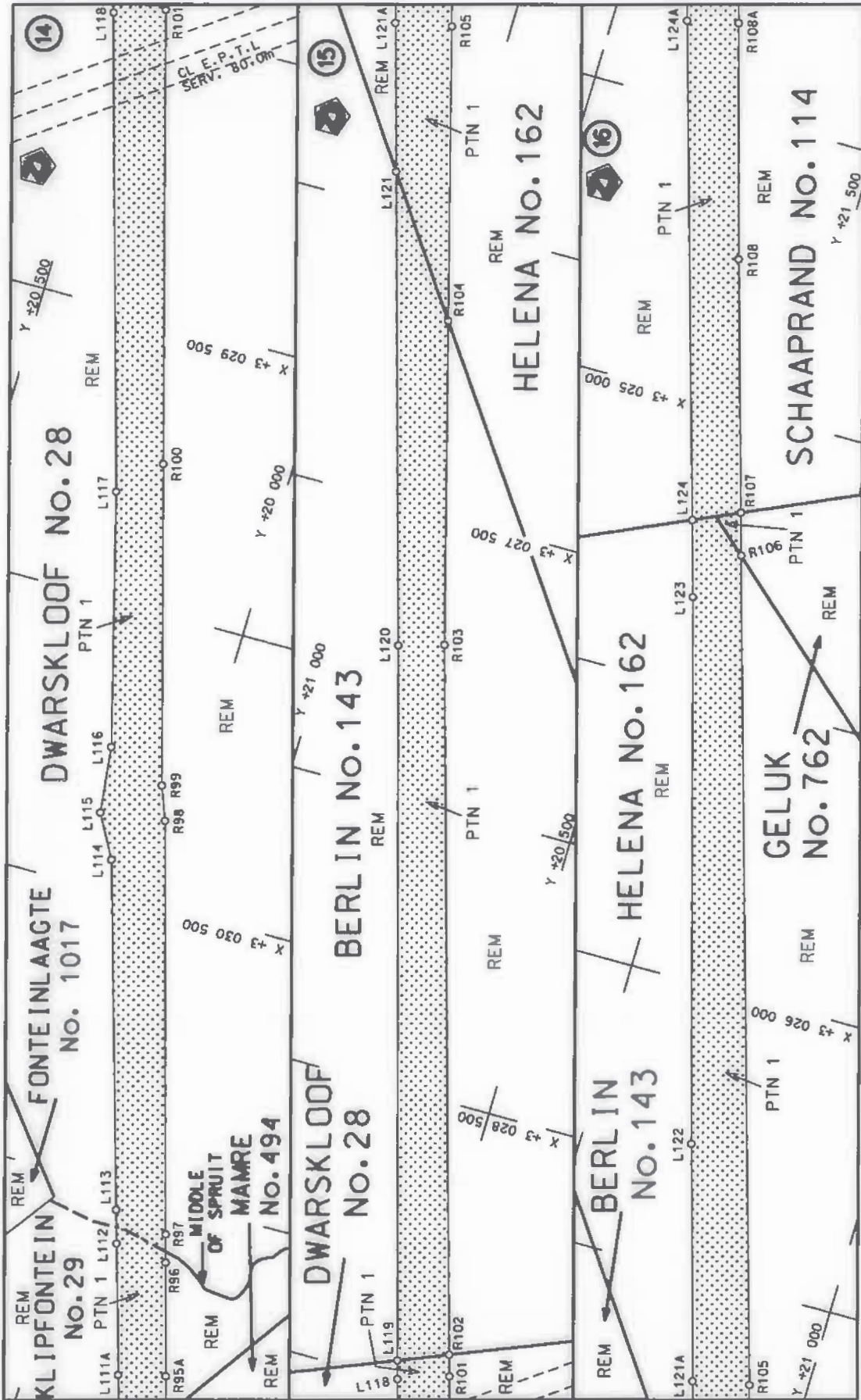

<p>Die Suid Afrikaanse Nasionale Padagentskop Beperk The South African National Roads Agency Limited</p>	<p>Die figuur getoon The figure shown</p>	<p>steldie padreserwe voor van 'n gedeelte represents the road reserve of a portion van Nasionale Roete N3 of National Route</p>	<p>Vel Sheet 6 of 18 Plan P833/14</p>
<p>9</p>		<p>Seksie Section</p>	<p>N3</p>

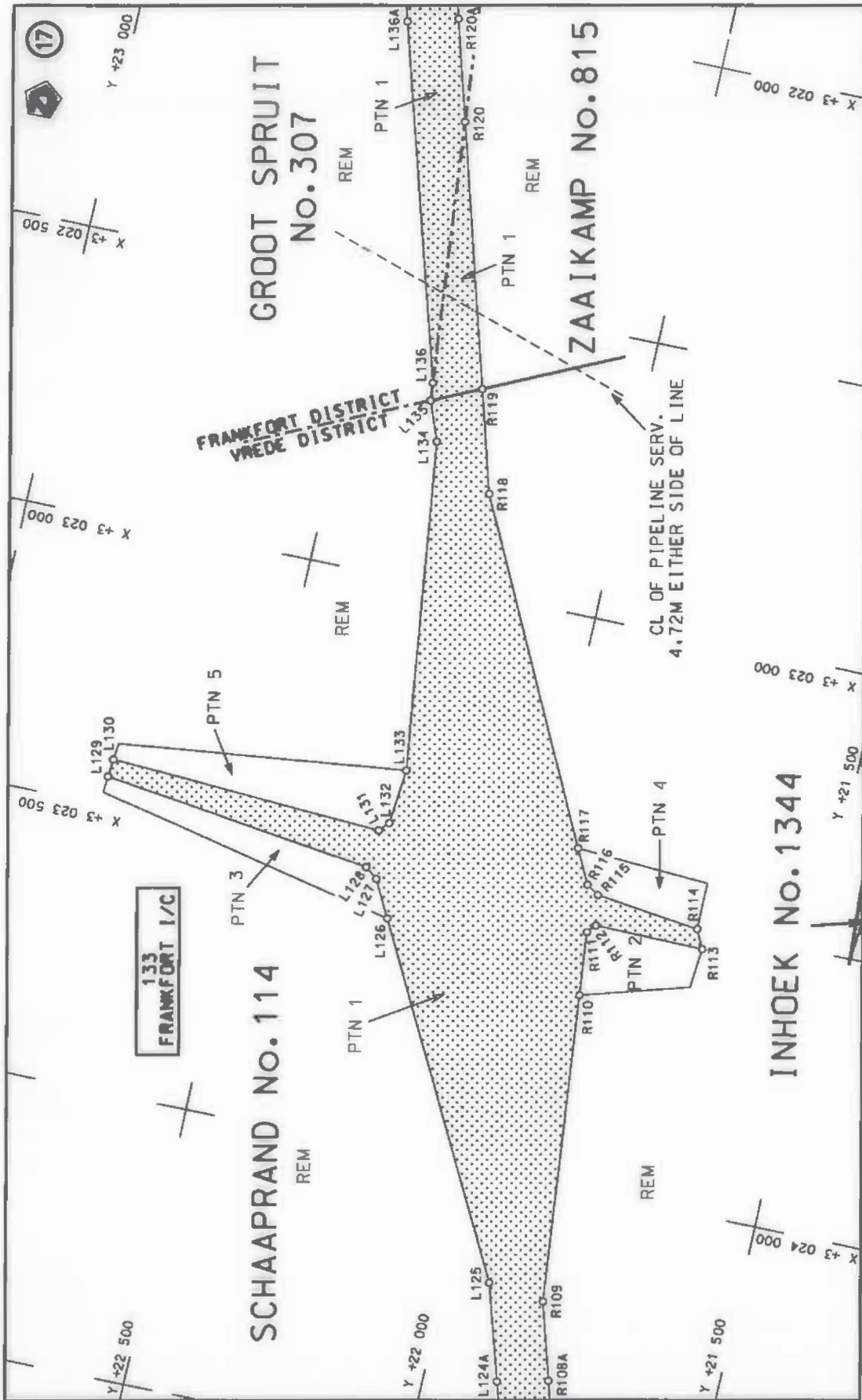

Die Suid Afrikaanse Nasionale Padagentskap Beperk
The South African National Roads Agency Limited

Die figuur getoon
The figure shown

steeldie padreserwe voor van 'n gedeelte
represents the road reserve of a portion
van Nasionale Roete N3 Seksie 9
of National Route Section



Vel Sheet 7 van 18
Plan P833/14

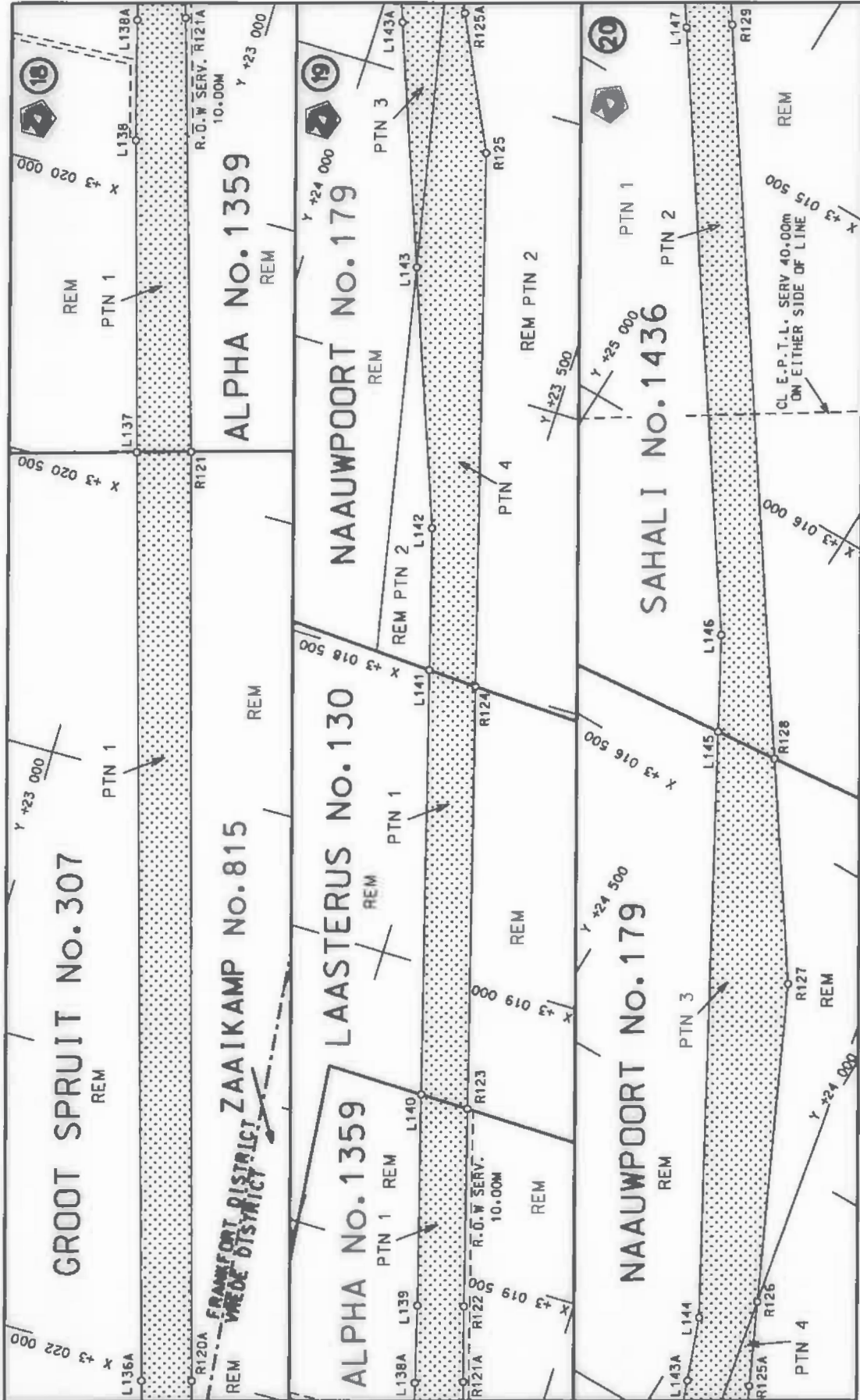

<p>Die Suid Afrikaanse Nasionale Padagentskap Beperk The South African National Roads Agency Limited</p>	<p>Die figuur getoon The figure shown</p>	<p>steldie padreserwe voor van 'n gedeelte represents the road reserve of a portion van Nasionale Roete N3 of National Route</p>	<p>Vel Sheet 8 van 18 Plan P833/14</p>
<p>9</p>		<p>Seksie Section</p>	

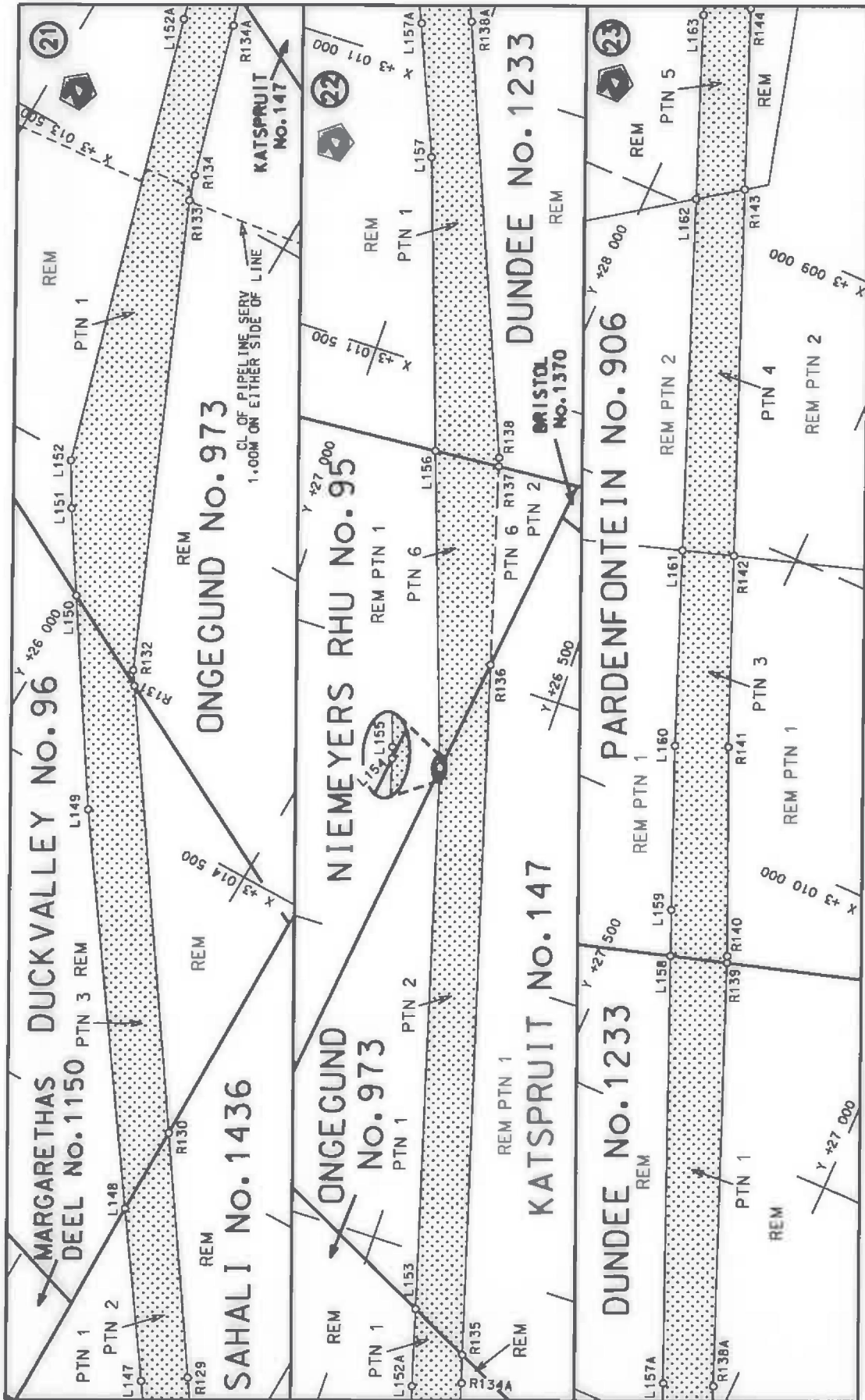

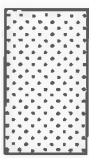
<p>Die Suid Afrikaanse Nasionale Padagentskap Beperk The South African National Roads Agency Limited</p>	<p>Die figuur getoon The figure shown</p> 	<p>stedlike podreserwe voor van 'n gedeelte represents the road reserve of a portion van Nasionale Roete N3 Sektie 9 of National Route Section</p>	<p>Vel Sheet 9 van of 18 Plan P833/14</p>
--	---	--	---

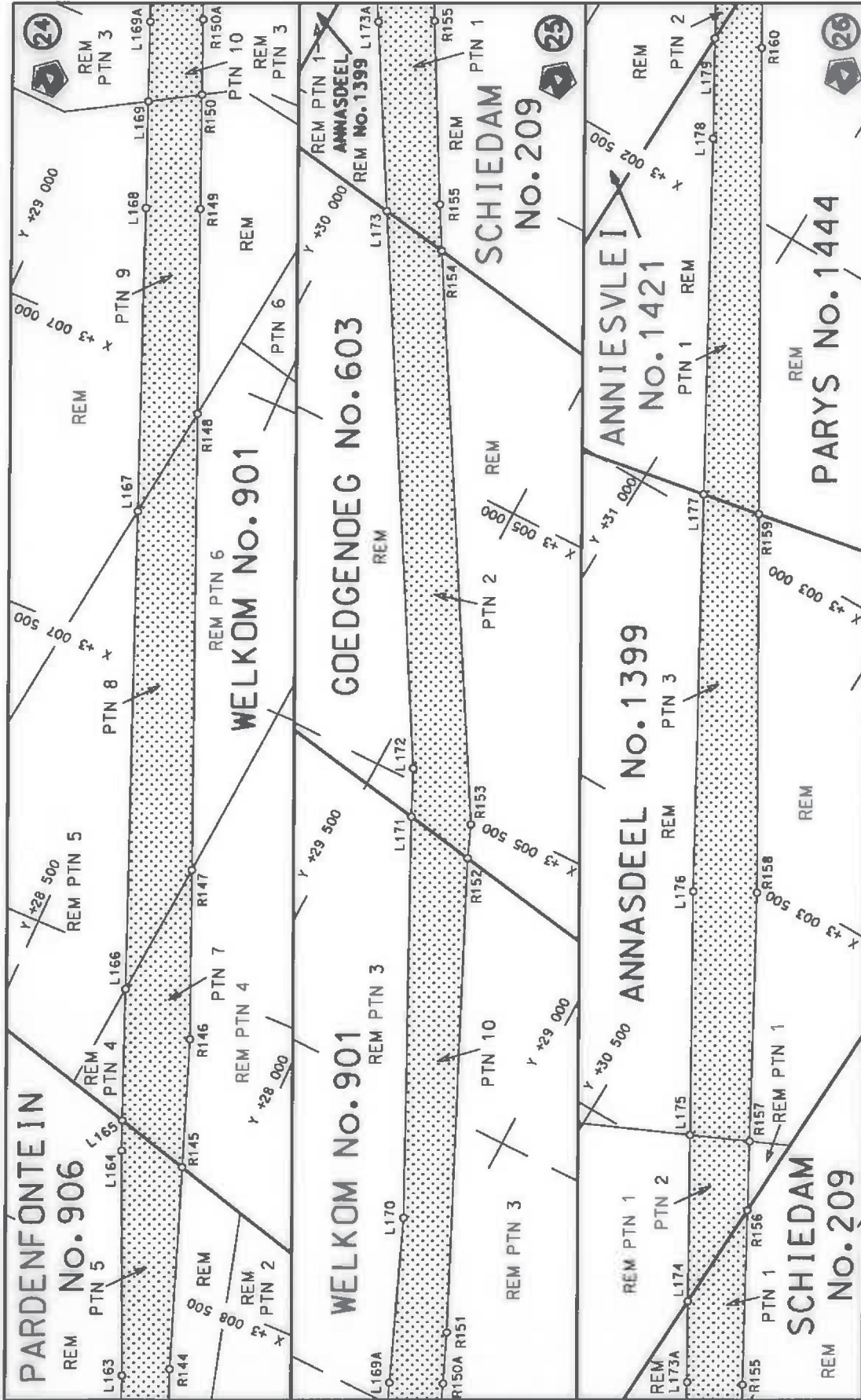

<p>Die Suid Afrikaanse Nasionale Padagentskap Beperk The South African National Roads Agency Limited</p>	<p>Die figuur getoon The figure shown</p> 	<p>stelt die padreserwe voor van 'n gedeelte represents the road reserve of a portion van Nasionale Roete N3 of National Route N3</p> <p>Sekasie Section</p> <p>9</p>
<p>Vel Sheet</p> <p>10 van of</p> <p>18</p>		<p>Plan P833/14</p>

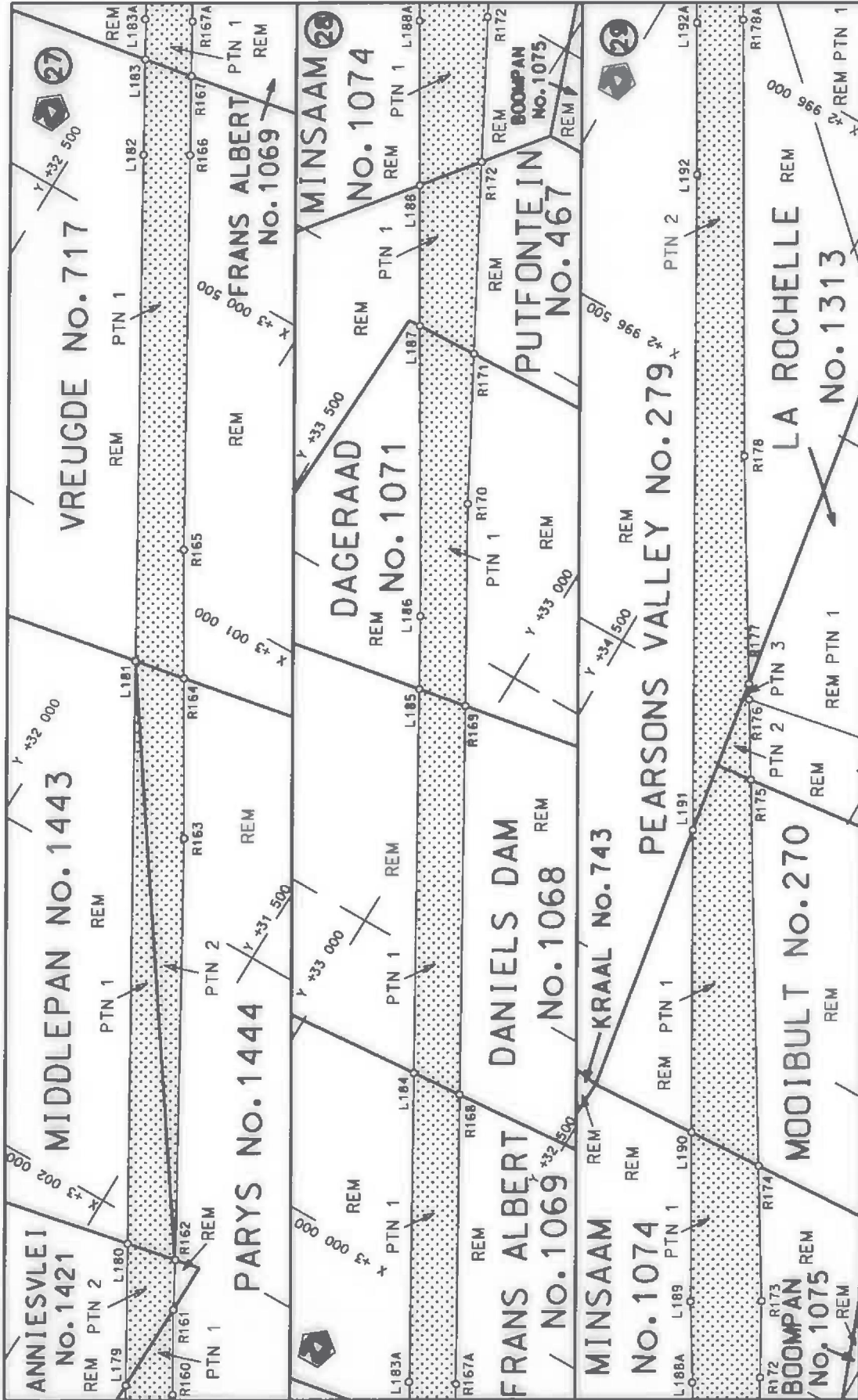

<p>Die Suid Afrikaanse Nasionale Padagentskap Beperk The South African National Roads Agency Limited</p>	<p>Die figuur getoon The figure shown</p> 	<p>stel die padreserwe voor van 'n gedeelte represents the road reserve of a portion van Nasionale Roete N3 of National Route</p>	<p>Vel Sheet 11 van of 18</p> <p>Plan P833/14</p>
<p>9</p>		<p>Seksie Section</p>	

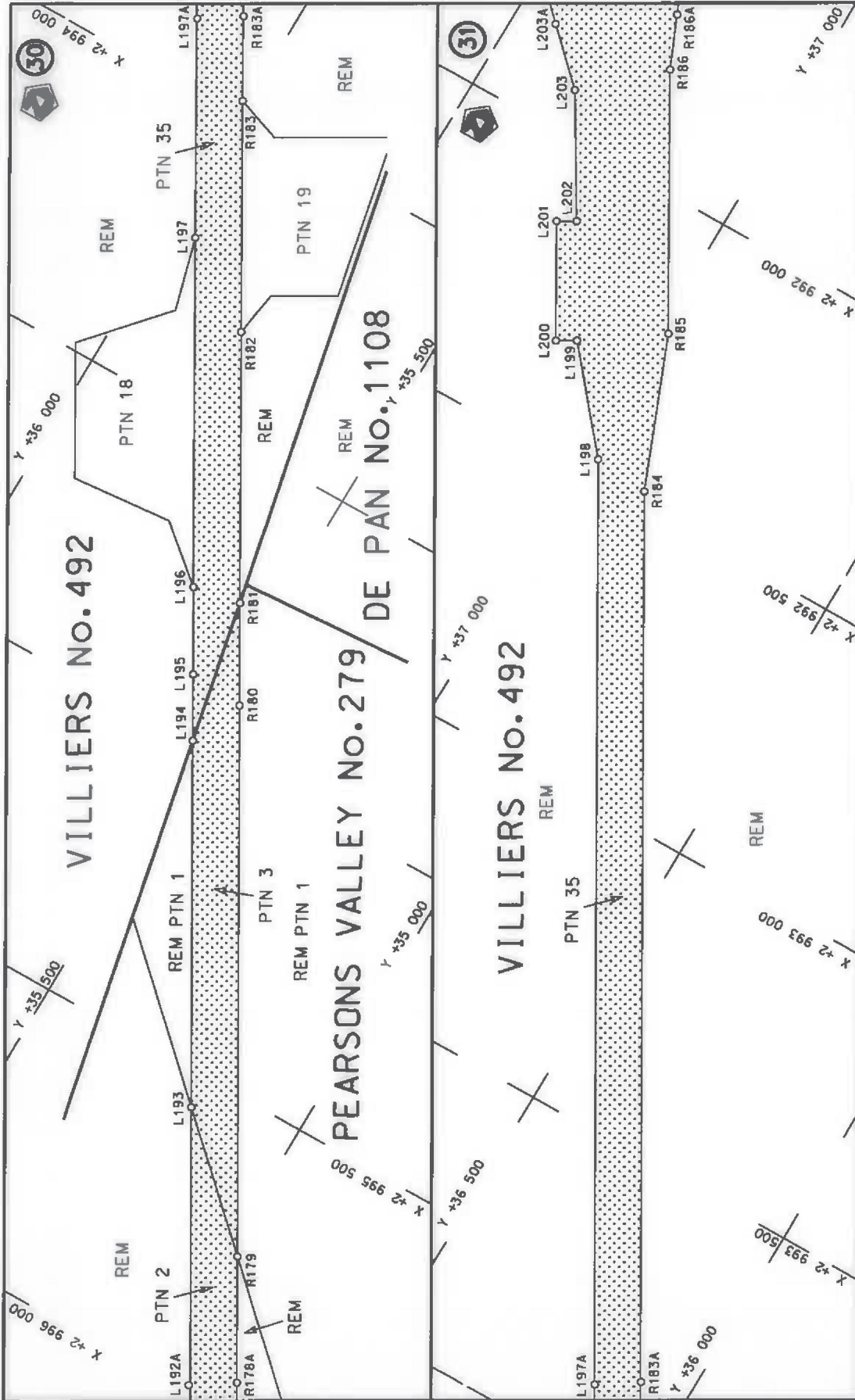

<p>Die Suid Afrikaanse Nasionale Padagentskap Beperk The South African National Roads Agency Limited</p>	<p>Die figuur getoon The figure shown</p> 	<p>stel die padreserwe voor van 'n gedeelte represents the road reserve of a portion van Nasionale Roete N3 Sektie 9 of National Route Section</p>	<p>Vel Sheet 12 of 18 Plan P833/14</p>
--	---	--	--

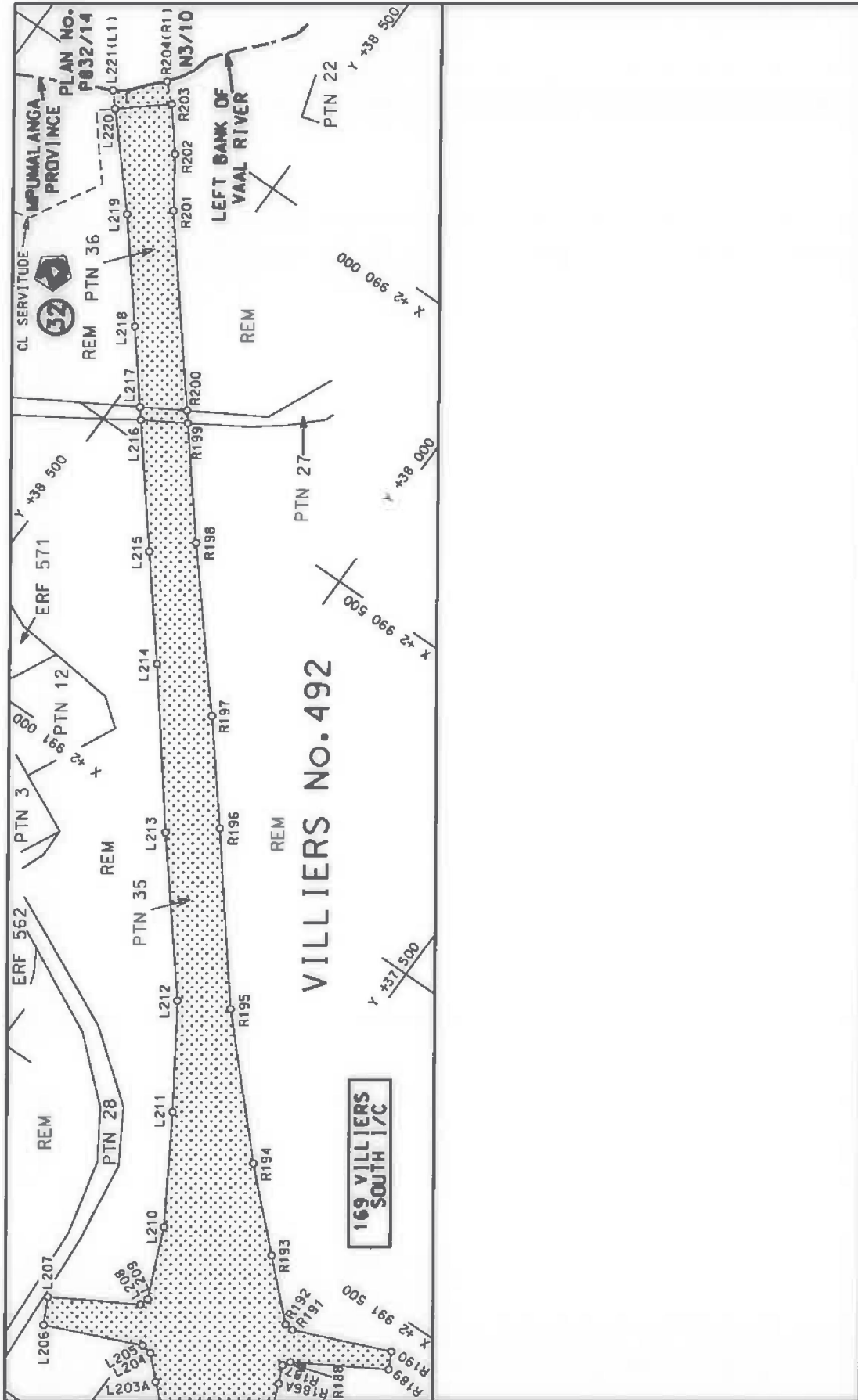

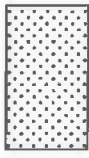
Die Suid Afrikaanse Nasionale Padagentskap Beperk The South African National Roads Agency Limited	Die figuur getoon The figure shown		steldie padreserwe voor van 'n gedeelte represents the road reserve of a portion van Nasionale Roete N3 of National Route N3 Section	Vel Sheet 13 of 18
				Plan P833/14

PADRESERWE KOÖRDINATE / ROAD RESERVE CO-ORDINATES									
LINKERKANT/LEFT HAND SIDE				REGTERKANT/RIGHT HAND SIDE					
				WG 29°	Y	X			
L1	9	820.44	3 060	541.02	R1	9	763.94	3 060	521.29
L2	10	141.83	3 060	089.57	R2	9	732.75	3 060	510.53
L3	10	361.29	3 059	781.30	R3	10	152.70	3 059	921.20
L4	10	429.54	3 059	685.47	R4	10	251.45	3 059	782.63
L5	10	502.90	3 059	625.55	R5	10	634.32	3 059	250.39
L6	10	560.29	3 059	551.50	R6	11	038.53	3 058	683.12
L7	10	946.45	3 059	001.53	R7	11	472.06	3 058	073.61
L8	11	030.77	3 058	831.18	R8	11	751.76	3 057	676.65
L9	11	548.66	3 058	104.76	R9	12	223.90	3 057	012.13
L10	11	662.75	3 057	954.84	R10	12	738.74	3 056	287.50
L11	11	708.10	3 057	915.58	R11	12	747.66	3 056	274.69
L12	11	763.24	3 057	837.77	R12	12	955.24	3 055	976.54
L13	11	854.28	3 057	708.58	R13	13	706.43	3 054	671.18
L14	11	953.39	3 057	533.89	R14	13	824.68	3 054	463.50
L15	12	317.88	3 057	027.79	R15	13	895.17	3 054	319.66
L16	12	795.09	3 056	365.17	R16	14	012.67	3 054	133.27
L17	12	854.09	3 056	276.15	R17	14	072.05	3 054	029.14
L18	13	072.88	3 055	946.03	R18	14	194.69	3 053	799.69
L19	13	682.22	3 054	887.31	R19	14	299.80	3 053	629.32
L20	13	785.16	3 054	694.27	R20	14	360.63	3 053	503.10
L21	13	894.07	3 054	503.13	R21	14	439.51	3 053	363.82
L22	13	957.85	3 054	401.35	R22	14	507.68	3 053	264.39
L23	14	082.36	3 054	172.96	R23	14	687.64	3 052	948.47
L24	14	201.55	3 053	987.68	R24	14	794.81	3 052	760.35
L25	14	289.86	3 053	830.88	R25	14	914.90	3 052	529.65
L26	14	359.68	3 053	686.34	R26	15	136.20	3 052	160.92
L27	14	455.48	3 053	533.85	R27	15	234.50	3 051	977.61
L28	14	545.18	3 053	360.74	R28	15	318.91	3 051	798.48
L29	14	730.98	3 053	055.53	R29	15	394.10	3 051	615.44
L30	14	748.17	3 053	022.96	R30	15	440.33	3 051	443.17
L31	14	884.16	3 052	765.27	R31	15	517.98	3 051	235.76
L32	15	260.90	3 052	103.83	R32	15	564.33	3 051	046.92
L33	15	351.40	3 051	923.21	R33	15	608.76	3 050	812.75
L34	15	432.91	3 051	738.38	R34	15	819.06	3 049	590.76
L35	15	541.15	3 051	455.19	R35	15	832.52	3 049	430.70
L36	15	597.63	3 051	257.52	R36	15	832.23	3 049	308.82
L37	15	624.45	3 051	163.62	R37	15	813.21	3 049	201.14
L38	15	681.04	3 050	904.66	R38	15	780.51	3 049	015.94
L39	15	698.08	3 050	765.24	R39	15	786.75	3 048	935.77
L40	15	914.96	3 049	505.89	R40	15	786.42	3 048	933.94
L41	15	963.97	3 049	329.67	R41	15	773.25	3 048	903.33
L42	16	030.33	3 049	233.35	R42	15	772.03	3 048	901.87
L43	16	094.01	3 049	140.93	R43	15	676.28	3 048	830.48
L44	16	095.58	3 049	139.87	R44	15	706.47	3 048	786.89
L45	16	120.04	3 049	135.23	R45	15	825.48	3 048	840.27
L46	16	121.80	3 049	135.61	R46	15	827.07	3 048	839.25
L47	16	217.84	3 049	203.96	R47	15	949.97	3 048	679.71
L48	16	247.28	3 049	161.77	R48	16	000.64	3 048	505.91
L49	16	140.51	3 049	088.80	R49	16	054.22	3 048	216.77
L50	16	139.32	3 049	087.35	R50	16	073.90	3 048	110.57
L51	16	126.53	3 049	058.05	R51	16	208.90	3 047	325.56

Vel Sheet	14	Van of	18	P833/14
--------------	----	-----------	----	---------

PADRESERWE KOÖRDINATE / ROAD RESERVE CO-ORDINATES					
LINKERKANT/LEFT HAND SIDE			REGTERKANT/RIGHT HAND SIDE		
	Y	X	WG 29°		
L52	16 126.29	3 049	056.21	R52	16 338.52 3 046 571.85
L53	16 137.89	3 048	976.00	R53	16 361.96 3 046 435.57
L54	16 137.89	3 048	973.98	R54	16 360.17 3 046 353.72
L55	16 093.85	3 048	603.16	R55	16 386.11 3 046 238.73
L56	16 145.69	3 048	199.23	R56	16 411.84 3 046 088.84
L57	16 162.83	3 048	065.62	R57	16 397.07 3 046 085.97
L58	16 288.82	3 047	333.94	R58	16 399.91 3 046 070.43
L59	16 396.74	3 046	707.18	R59	16 415.34 3 046 068.97
L60	16 426.79	3 046	575.37	R60	16 453.96 3 045 843.95
L61	16 444.47	3 046	386.79	R61	16 480.84 3 045 746.53
L62	16 450.05	3 046	321.47	R62	16 670.98 3 044 643.88
L63	16 485.61	3 046	291.16	R63	16 700.28 3 044 425.54
L64	16 494.71	3 046	174.50	R64	16 708.45 3 044 339.46
L65	16 557.35	3 046	178.97	R65	16 729.19 3 044 232.27
L66	16 515.57	3 046	045.53	R66	16 775.90 3 044 032.55
L67	16 552.38	3 045	820.57	R67	16 803.09 3 043 874.94
L68	16 566.41	3 045	721.38	R68	16 905.00 3 043 282.69
L69	16 664.28	3 045	169.63	R69	16 932.88 3 043 085.40
L70	16 696.83	3 045	032.67	R70	16 965.67 3 042 928.83
L71	16 802.53	3 044	420.82	R71	17 024.30 3 042 588.84
L72	16 828.71	3 044	317.01	R72	17 212.23 3 041 497.54
L73	16 835.85	3 044	244.16	R73	17 312.25 3 040 916.15
L74	16 839.76	3 044	204.27	R74	17 512.61 3 039 751.59
L75	16 854.81	3 044	046.16	R75	17 661.15 3 038 888.21
L76	16 881.93	3 043	888.46	R76	17 679.12 3 038 758.55
L77	16 983.61	3 043	297.17	R77	17 691.22 3 038 673.20
L78	17 022.51	3 043	100.87	R78	17 811.75 3 037 997.70
L79	17 049.68	3 042	943.25	R79	17 897.25 3 037 708.28
L80	17 068.51	3 042	804.48	R80	17 922.44 3 037 621.65
L81	17 097.17	3 042	637.95	R81	18 331.74 3 036 215.32
L82	17 296.31	3 041	480.57	R82	18 473.34 3 035 729.17
L83	17 392.47	3 040	921.66	R83	18 492.62 3 035 651.08
L84	17 607.98	3 039	667.84	R84	18 507.07 3 035 592.56
L85	17 733.22	3 038	941.31	R85	18 551.35 3 035 437.18
L86	17 773.41	3 038	767.79	R86	18 596.91 3 035 304.85
L87	17 784.66	3 038	706.46	R87	18 958.81 3 034 061.43
L88	17 804.39	3 038	563.51	R88	19 289.51 3 032 925.25
L89	17 844.51	3 038	311.79	R89	19 323.05 3 032 810.03
L90	17 993.67	3 037	671.71	R90	19 363.46 3 032 645.17
L91	18 000.01	3 037	649.08	R91	19 413.70 3 032 477.35
L92	18 051.66	3 037	464.59	R92	19 516.90 3 032 132.66
L93	18 136.64	3 037	202.34	R93	19 574.58 3 031 946.00
L94	18 150.54	3 037	156.40	R94	19 596.61 3 031 870.40
L95	18 198.04	3 036	961.40	R95	19 742.90 3 031 368.53
L96	18 525.65	3 035	836.62	R96	19 818.67 3 031 106.43
L97	18 585.36	3 035	674.29	R97	19 832.55 3 031 058.39
L98	18 660.47	3 035	408.59	R98	20 036.72 3 030 352.14
L99	18 701.73	3 035	231.23	R99	20 059.37 3 030 293.35
L100	19 021.85	3 034	131.50	R100	20 215.66 3 029 743.81
L101	19 368.92	3 032	939.23	R101	20 436.60 3 028 967.66
L102	19 400.52	3 032	830.66	R102	20 447.51 3 028 930.71

Vel Sheet	15	Van of	18	P833/14
-----------	----	--------	----	---------

PADRESERWE KOÖRDINATE / ROAD RESERVE CO-ORDINATES						
LINKERKANT/LEFT HAND SIDE				REGTERKANT/RIGHT HAND SIDE		
	Y	X	WG 29°		Y	X
L103	19 455.64	3 032	666.30	R103	20 804.76	3 027 720.50
L104	19 479.14	3 032	640.84	R104	20 958.80	3 027 165.19
L105	19 513.14	3 032	524.88	R105	21 098.54	3 026 661.40
L106	19 524.39	3 032	486.49	R106	21 520.36	3 025 248.81
L107	19 531.43	3 032	462.50	R107	21 542.17	3 025 175.77
L108	19 533.81	3 032	454.36	R108	21 671.08	3 024 744.06
L109	19 674.32	3 031	889.78	R109	21 827.59	3 024 205.73
L110	19 684.35	3 031	855.35	R110	21 882.55	3 023 659.99
L111	19 800.78	3 031	454.56	R111	21 893.94	3 023 548.19
L112	19 909.02	3 031	096.90	R112	21 881.60	3 023 533.12
L113	19 926.35	3 031	039.45	R113	21 694.35	3 023 536.27
L114	20 106.21	3 030	443.60	R114	21 710.35	3 023 503.11
L115	20 147.75	3 030	368.22	R115	21 889.80	3 023 479.47
L116	20 161.95	3 030	251.20	R116	21 911.06	3 023 465.51
L117	20 279.99	3 029	812.85	R117	21 940.94	3 023 405.58
L118	20 521.86	3 028	996.68	R118	22 227.29	3 022 822.35
L119	20 530.98	3 028	964.85	R119	22 279.42	3 022 642.82
L120	20 881.39	3 027	742.84	R120	22 410.74	3 022 185.22
L121	21 119.42	3 026	934.95	R121	22 918.10	3 020 424.39
L122	21 313.38	3 026	276.64	R122	23 180.17	3 019 559.41
L123	21 580.25	3 025	342.08	R123	23 278.18	3 019 222.86
L124	21 619.24	3 025	210.81	R124	23 487.74	3 018 503.25
L125	21 926.00	3 024	192.13	R125	23 752.33	3 017 594.70
L126	22 234.62	3 023	595.76	R126	23 927.36	3 017 232.80
L127	22 268.07	3 023	531.07	R127	24 173.88	3 016 723.06
L128	22 289.42	3 023	513.88	R128	24 400.74	3 016 393.47
L129	22 757.30	3 023	449.25	R129	25 140.47	3 015 318.74
L130	22 755.05	3 023	417.65	R130	25 385.72	3 014 957.53
L131	22 282.70	3 023	446.00	R131	25 833.49	3 014 298.11
L132	22 267.77	3 023	429.52	R132	25 849.17	3 014 275.02
L133	22 259.25	3 023	331.91	R133	26 182.97	3 013 504.29
L134	22 334.83	3 022	750.07	R134	26 197.27	3 013 461.15
L135	22 361.11	3 022	681.19	R135	26 288.18	3 013 150.34
L136	22 364.23	3 022	649.52	R136	26 632.77	3 011 972.30
L137	23 008.24	3 020	450.28	R137	26 731.94	3 011 633.26
L138	23 163.74	3 019	919.22	R138	26 736.28	3 011 618.43
L139	23 257.23	3 019	581.75	R139	27 315.80	3 010 202.73
L140	23 362.03	3 019	221.63	R140	27 320.47	3 010 191.30
L141	23 572.43	3 018	498.66	R141	27 470.04	3 009 851.42
L142	23 642.78	3 018	256.96	R142	27 600.56	3 009 537.16
L143	23 806.28	3 017	822.80	R143	27 850.39	3 008 935.77
L144	23 999.71	3 017	309.18	R144	27 972.99	3 008 638.46
L145	24 509.90	3 016	402.93	R145	28 098.34	3 008 301.82
L146	24 594.00	3 016	253.55	R146	28 178.16	3 008 088.36
L147	25 206.58	3 015	363.68	R147	28 296.72	3 007 812.53
L148	25 383.69	3 015	111.30	R148	28 616.74	3 007 068.17
L149	25 793.38	3 014	527.51	R149	28 760.19	3 006 734.23
L150	26 001.13	3 014	208.50	R150	28 840.26	3 006 547.78
L151	26 086.00	3 014	078.17	R151	28 929.11	3 006 341.73
L152	26 129.48	3 014	005.11	R152	29 286.38	3 005 578.44
L153	26 390.81	3 013	098.09	R153	29 309.03	3 005 522.67

Vel Sheet	16	Van of	18	P833/14
--------------	----	-----------	----	---------

PADRESERWE KOÖRDINATE / ROAD RESERVE CO-ORDINATES									
LINKERKANT/LEFT HAND SIDE				REGTERKANT/RIGHT HAND SIDE					
				WG 29°	Y	X			
L154	26	656.61	3 012	175.48	R154	29	825.85	3 004	642.78
L155	26	658.04	3 012	170.51	R155	29	866.65	3 004	571.51
L156	26	844.72	3 011	641.05	R156	30	177.51	3 004	017.16
L157	27	018.20	3 011	149.06	R157	30	237.69	3 003	910.00
L158	27	409.55	3 010	230.28	R158	30	453.57	3 003	524.84
L159	27	441.67	3 010	154.88	R159	30	796.84	3 002	946.93
L160	27	554.99	3 009	885.92	R160	31	219.45	3 002	235.43
L161	27	685.26	3 009	563.84	R161	31	295.65	3 002	104.80
L162	27	919.56	3 008	984.59	R162	31	338.17	3 002	027.26
L163	28	042.19	3 008	681.50	R163	31	709.02	3 001	376.97
L164	28	204.74	3 008	315.91	R164	31	855.23	3 001	133.41
L165	28	225.27	3 008	266.47	R165	31	972.81	3 000	937.55
L166	28	314.70	3 008	051.00	R166	32	323.75	3 000	331.97
L167	28	639.93	3 007	267.47	R167	32	394.11	3 000	210.76
L168	28	846.35	3 006	770.15	R168	32	700.90	2 999	682.28
L169	28	919.74	3 006	595.75	R169	33	046.67	2 999	085.10
L170	29	088.53	3 006	194.63	R170	33	227.38	2 998	775.31
L171	29	405.67	3 005	556.84	R171	33	355.34	2 998	541.68
L172	29	442.68	3 005	479.35	R172	33	518.88	2 998	243.09
L173	29	941.07	3 004	623.04	R173	33	707.93	2 997	897.93
L174	30	182.68	3 004	207.92	R174	33	831.71	2 997	692.31
L175	30	331.34	3 003	952.49	R175	34	183.99	2 997	104.67
L176	30	548.79	3 003	578.88	R176	34	257.62	2 996	982.41
L177	30	896.81	3 002	965.17	R177	34	271.68	2 996	958.56
L178	31	208.36	3 002	415.77	R178	34	479.85	2 996	611.68
L179	31	297.44	3 002	262.08	R179	34	980.38	2 995	747.71
L180	31	423.77	3 002	044.11	R180	35	470.98	2 994	901.46
L181	31	942.71	3 001	149.38	R181	35	562.07	2 994	744.20
L182	32	392.93	3 000	371.94	R182	35	803.35	2 994	328.23
L183	32	477.66	3 000	225.76	R183	36	008.94	2 993	973.50
L184	32	788.69	2 999	689.16	R184	36	876.92	2 992	476.00
L185	33	130.34	2 999	099.73	R185	36	982.88	2 992	213.80
L186	33	195.20	2 998	987.84	R186	37	217.72	2 991	808.40
L187	33	461.03	2 998	546.40	R187	37	269.84	2 991	687.96
L188	33	589.38	2 998	332.73	R188	37	262.42	2 991	675.73
L189	33	814.39	2 997	959.60	R189	37	116.11	2 991	588.19
L190	33	962.21	2 997	697.82	R190	37	130.47	2 991	559.68
L191	34	226.68	2 997	231.44	R191	37	292.57	2 991	627.13
L192	34	799.83	2 996	219.17	R192	37	307.86	2 991	625.65
L193	35	182.64	2 995	558.41	R193	37	398.45	2 991	540.05
L194	35	508.70	2 994	995.57	R194	37	519.07	2 991	425.42
L195	35	567.79	2 994	893.58	R195	37	710.20	2 991	224.99
L196	35	645.70	2 994	759.83	R196	37	911.61	2 990	974.61
L197	35	956.60	2 994	223.39	R197	38	039.15	2 990	820.52
L198	36	974.82	2 992	466.36	R198	38	240.00	2 990	586.33
L199	37	113.37	2 992	302.83	R199	38	375.95	2 990	422.09
L200	37	144.89	2 992	321.06	R200	38	390.23	2 990	404.79
L201	37	251.17	2 992	138.05	R201	38	616.58	2 990	130.44
L202	37	221.16	2 992	120.63	R202	38	672.69	2 990	047.13
L203	37	341.54	2 991	921.69	R203	38	729.21	2 989	978.49
L204	37	467.05	2 991	801.14	R204	38	759.32	2 989	950.84

Vel
Sheet17 Van
of 18

P833/14

PADRESERWE KOÖRDINATE / ROAD RESERVE CO-ORDINATES					
LINKERKANT/LEFT HAND SIDE			REGTERKANT/RIGHT HAND SIDE		
			WG 29°	Y	X
L205	37	486.22	2 991	798.05	
L206	37	646.96	2 991	866.74	
L207	37	670.17	2 991	822.31	
L208	37	531.46	2 991	741.17	
L209	37	526.64	2 991	726.20	
L210	37	578.60	2 991	605.59	
L211	37	685.13	2 991	430.81	
L212	37	793.39	2 991	265.50	
L213	37	984.20	2 991	034.55	
L214	38	170.42	2 990	799.58	
L215	38	297.50	2 990	645.56	
L216	38	445.59	2 990	464.43	
L217	38	460.13	2 990	446.76	
L218	38	551.04	2 990	335.73	
L219	38	677.97	2 990	181.73	
L220	38	804.07	2 990	041.99	
L221	38	826.21	2 990	017.51	

Vel	18	Van	18	P833/14
Sheet		of		

WARNING!!!

To all suppliers and potential suppliers of goods to the Government Printing Works

The Government Printing Works would like to warn members of the public against an organised syndicate(s) scamming unsuspecting members of the public and claiming to act on behalf of the Government Printing Works.

One of the ways in which the syndicate operates is by requesting quotations for various goods and services on a quotation form with the logo of the Government Printing Works. Once the official order is placed the syndicate requesting upfront payment before delivery will take place. Once the upfront payment is done the syndicate do not deliver the goods and service provider then expect payment from Government Printing Works.

Government Printing Works condemns such illegal activities and encourages service providers to confirm the legitimacy of purchase orders with GPW SCM, prior to processing and delivery of goods.

To confirm the legitimacy of purchase orders, please contact:

Renny Chetty (012) 748-6375 (Renny.Chetty@gpw.gov.za),

Anna-Marie du Toit (012) 748-6292 (Anna-Marie.DuToit@gpw.gov.za) and

Siraj Rizvi (012) 748-6380 (Siraj.Rizvi@gpw.gov.za)

Printed by and obtainable from the Government Printer, Bosman Street, Private Bag X85, Pretoria, 0001
Contact Centre Tel: 012-748 6200. eMail: info.egazette@gpw.gov.za
Publications: Tel: (012) 748 6053, 748 6061, 748 6065