GOVERNMENT NOTICE

DEPARTMENT OF TRANSPORT

No. 1041

11 December 2012

THE SOUTH AFRICAN NATIONAL ROADS AGENCY LIMITED

Registration No: 98/09584/06

DECLARATION AMENDMENT OF NATIONAL ROAD N11 SECTION 10

AMENDMENT OF DECLARATION NO. 1137 OF 2005.

By virtue of section 40(1)(b) of the South African National Roads Agency Limited and the National Roads Act, 1998 (Act No. 7 of 1998), I hereby amend Declaration No. 1137 of 2005 Annexure paragraph 3 by substituting it, with the subjoined sheets 1 to 20 of Plan No. P712/08.

(National Road N11 Section 10: Middelburg - Groblersdal)



MINISTER OF TRANSPORT

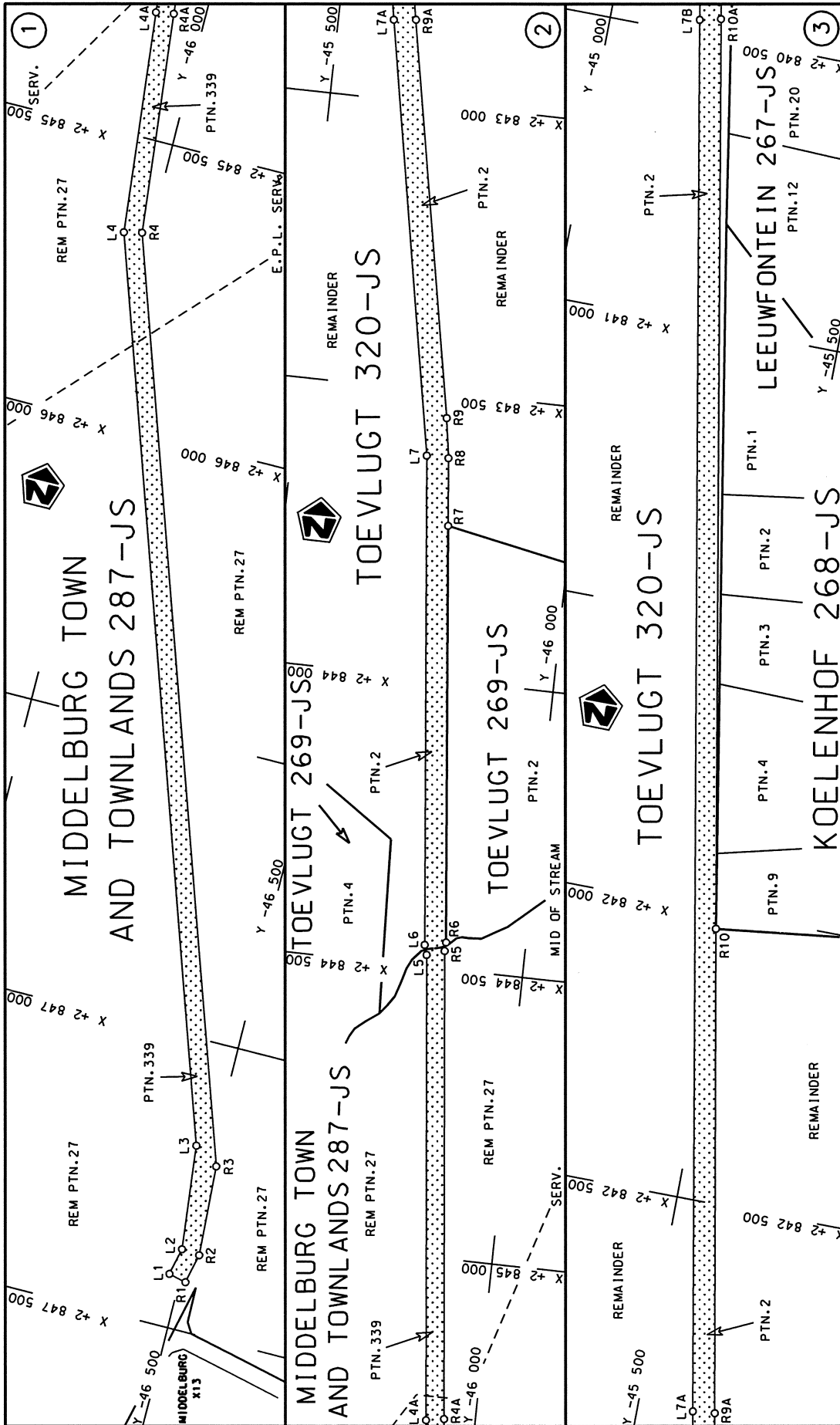

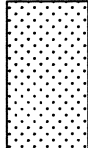
| | | |
|--|---|---|
| <p>Die Suid Afrikaanse Nasionale Padagentskap Beperk The South African National Roads Agency Limited</p> | <p>Die figuur getoon The figure shown</p>  | <p>steldie padreserwe voor van 'n gedeelte represents the road reserve of a portion van Nasionale Roete N11 of National Route</p> |
| <p>Vel Sheet 1 of 20</p> | <p>Seksie 10</p> | <p>Plan P712/08</p> |

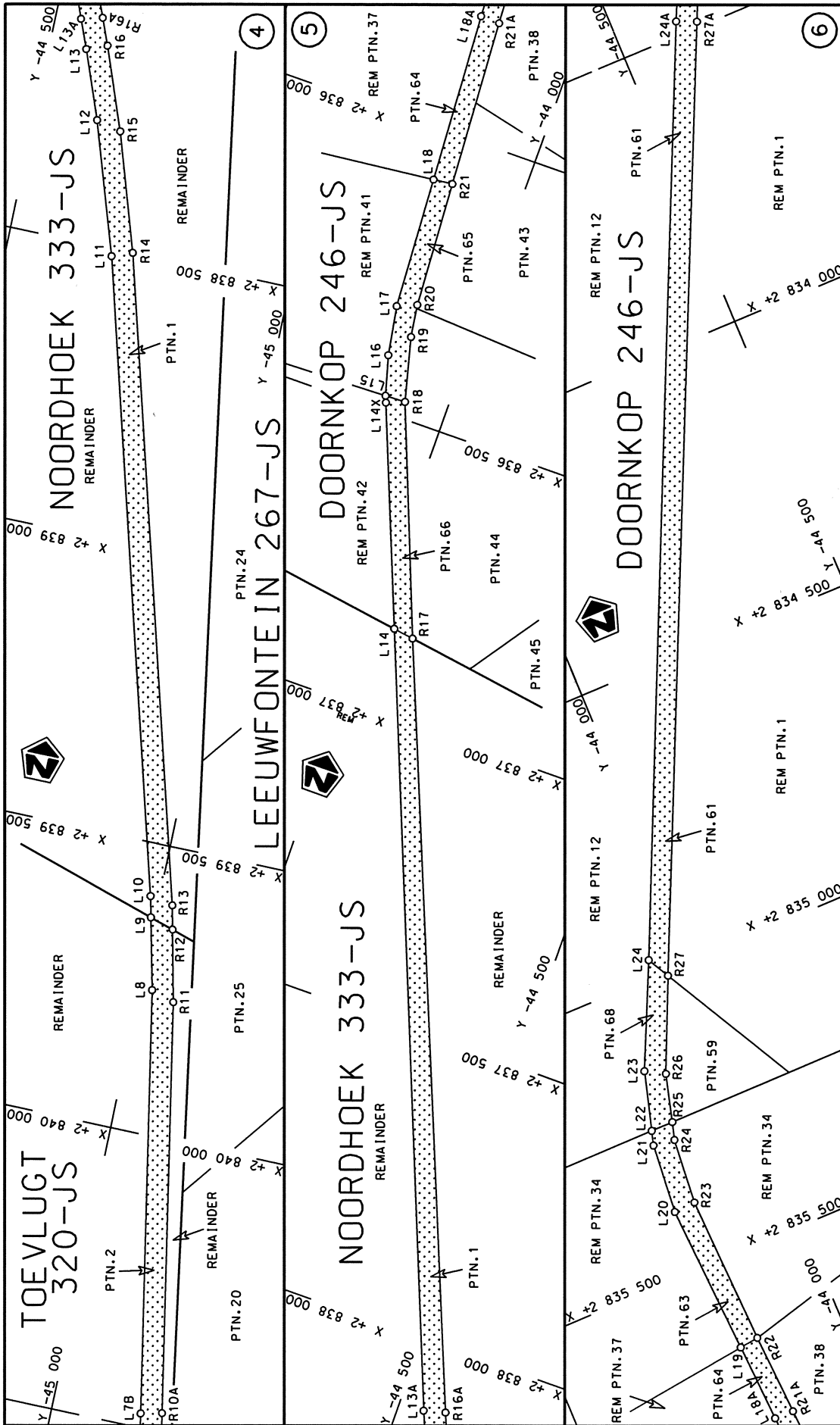

| | | | |
|--|---|--|------------------------------|
| <p>Die Suid Afrikaanse Nasionale Padagentskap Beperk The South African National Roads Agency Limited</p> | <p>Die figuur getoon The figure shown</p> | <p>steeldie padreserwe voor van 'n gedeelte represents the road reserve of a portion van Nasionale Roete N11 of National Route</p> | <p>Vel Sheet 2 of 20</p> |
| <p>10 Seksie Section</p> | | <p>Plan P712/08</p> | |

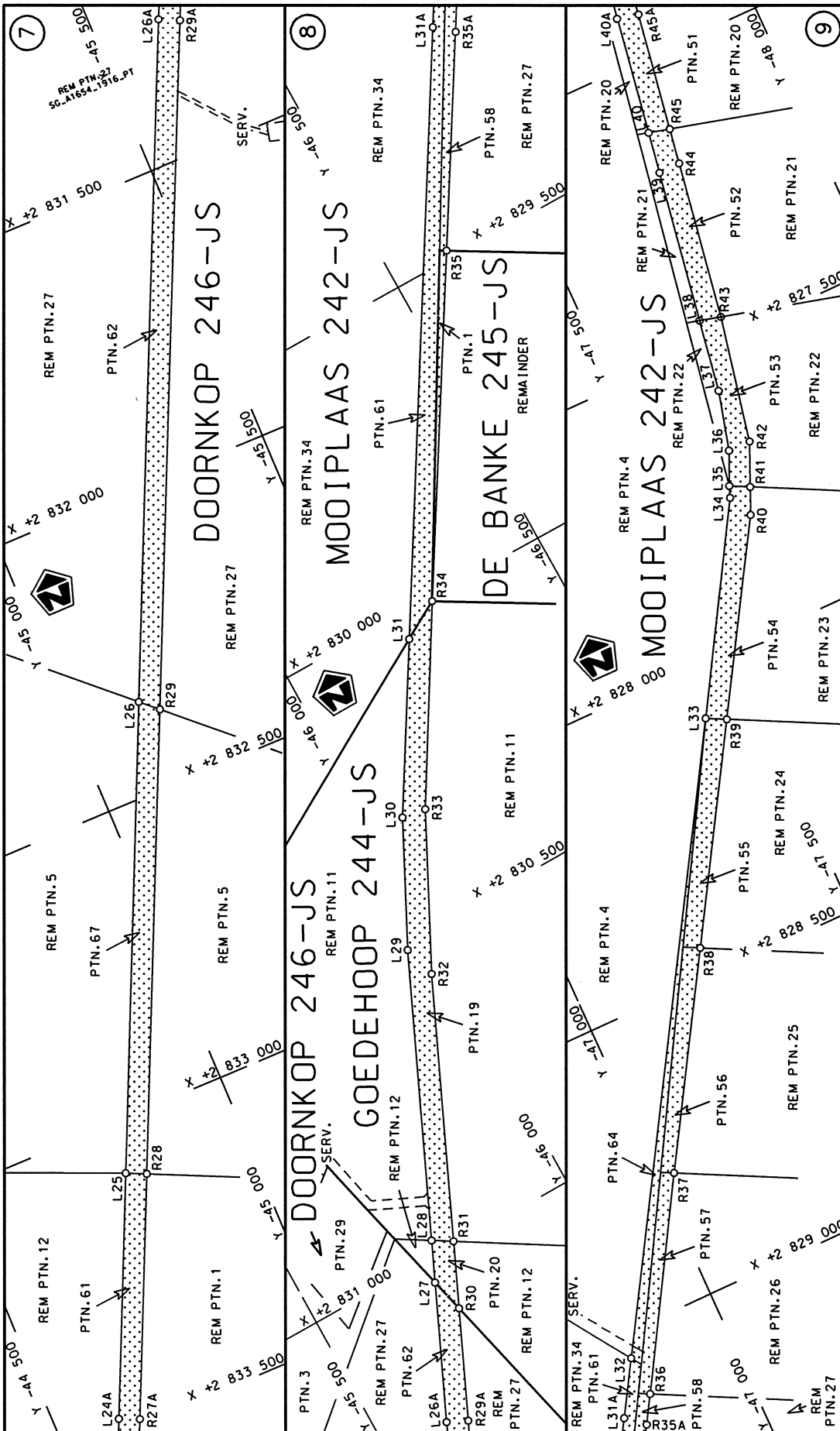

| | | | |
|--|---|---|---|
| <p>Die Suid Afrikaanse Nasionale Padagentskap Beperk The South African National Roads Agency Limited</p> | <p>Die figuur getoon The figure shown</p> | <p>steeldie padreserwe voor van 'n gedeelte represents the road reserve of a portion van Nasionale Roete N11 Seksie of National Route N11 Section</p> | <p>Vel Sheet 3 of 20 Plan P712/08</p> |
|--|---|---|---|

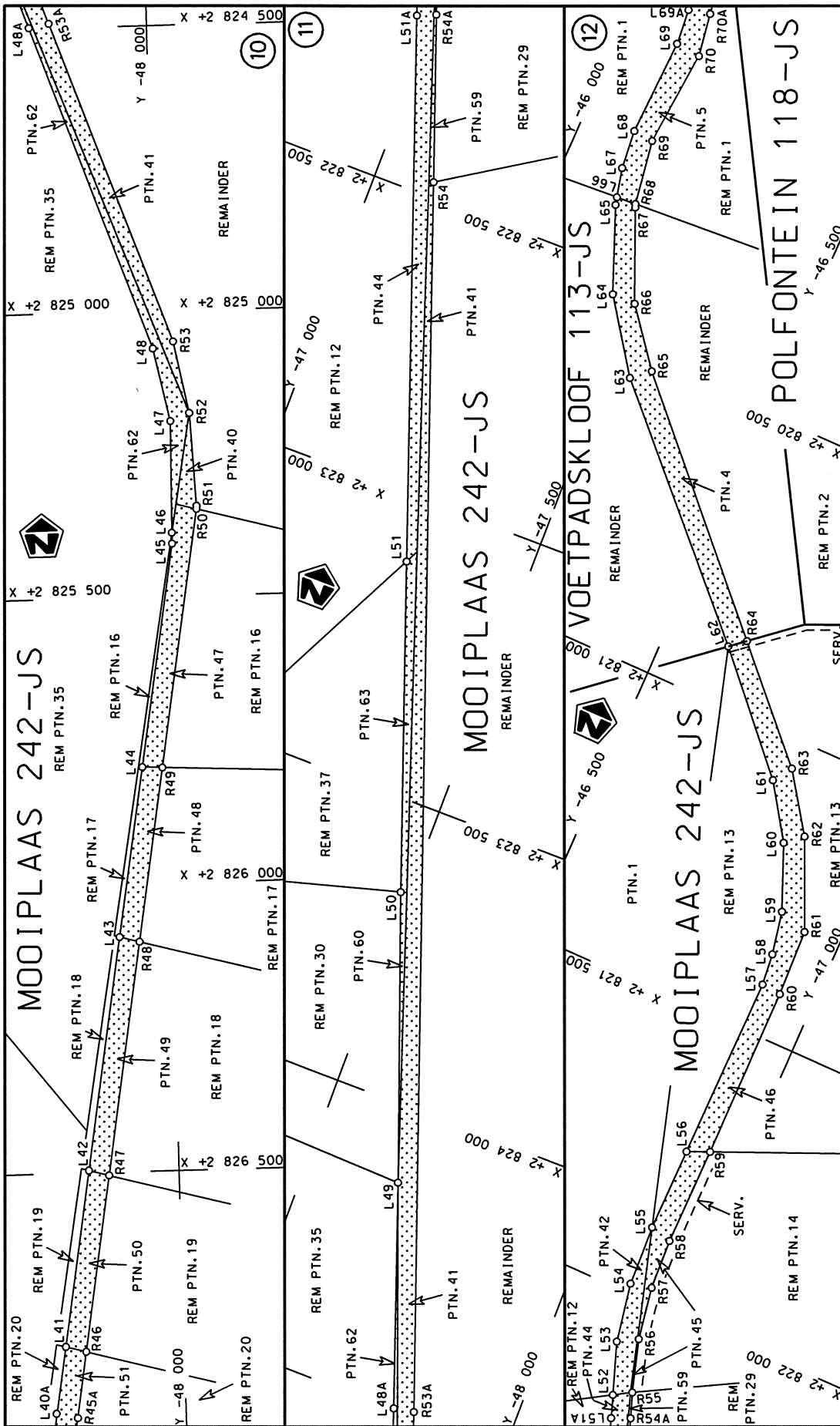

| | | | |
|--|---|---|------------------------------|
| <p>Die Suid Afrikaanse Nasionale Padagentskap Beperk The South African National Roads Agency Limited</p> | <p>Die figuur getoon The figure shown</p> | <p>steldie podreserwe voor van 'n gedeelte represents the road reserve of a portion van Nasionale Roete N11 of National Route</p> | <p>Vel Sheet 4 of 20</p> |
| | <p>10</p> | <p>Seksie Section</p> | <p>Plan P712/08</p> |

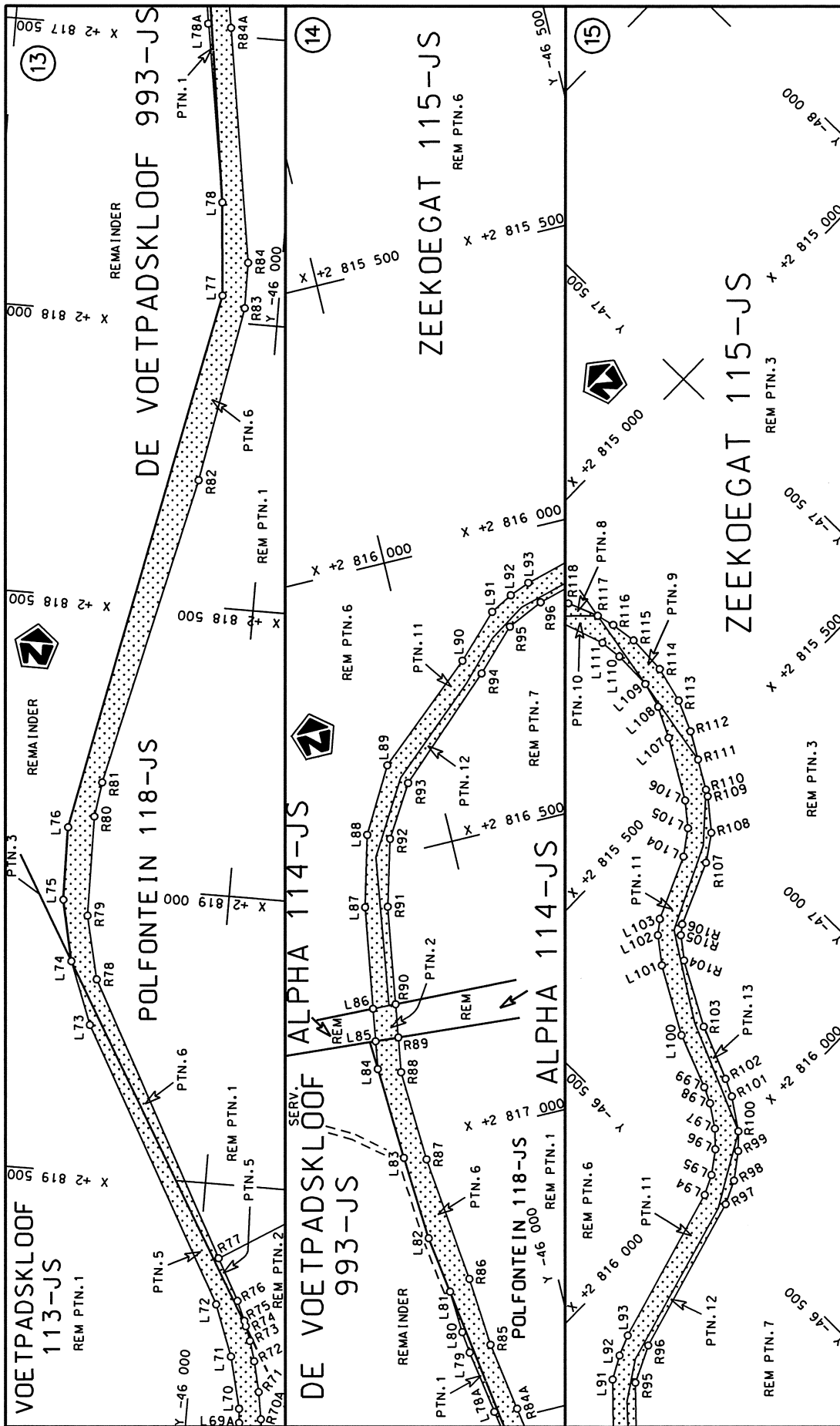

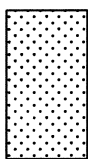
| | | |
|--|---|--|
| <p>Die Suid Afrikaanse Nasionale Padagentskap Beperk The South African National Roads Agency Limited</p> | <p>Die figuur getoon The figure shown</p>  | <p>stel die padreserwe voor van 'n gedeelte represents the road reserve of a portion van Nasionale Roete N11 of National Route</p> <p>10</p> <p>Seksie Section</p> |
| <p>Vel Sheet</p> <p>5 van 20</p> | <p>Plan</p> <p>P712/08</p> | <p>10</p> <p>Seksie Section</p> |

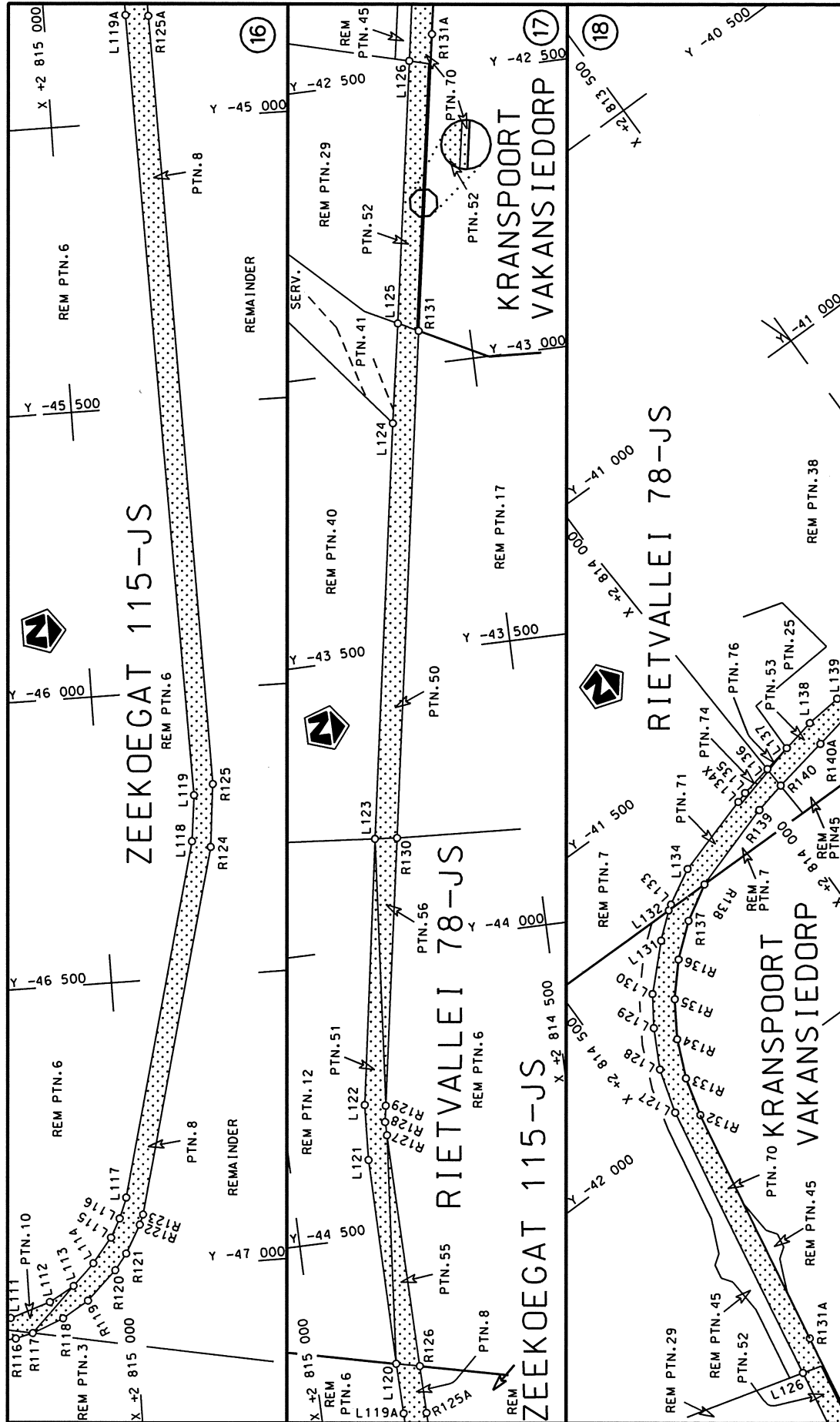

| | | |
|--|---|---|
| <p>Die Suid Afrikaanse Nasionale Padagentskap Beperk The South African National Roads Agency Limited</p> | <p>Die figuur getoon The figure shown</p> | <p>steldie padreserwe voor van 'n gedeelte represents the road reserve of a portion van Nasionale Roete N11 of National Route Section</p> |
| <p>Vel Sheet 6 of 20 Plan P712/08</p> | <p>10</p> | <p>Section</p> |

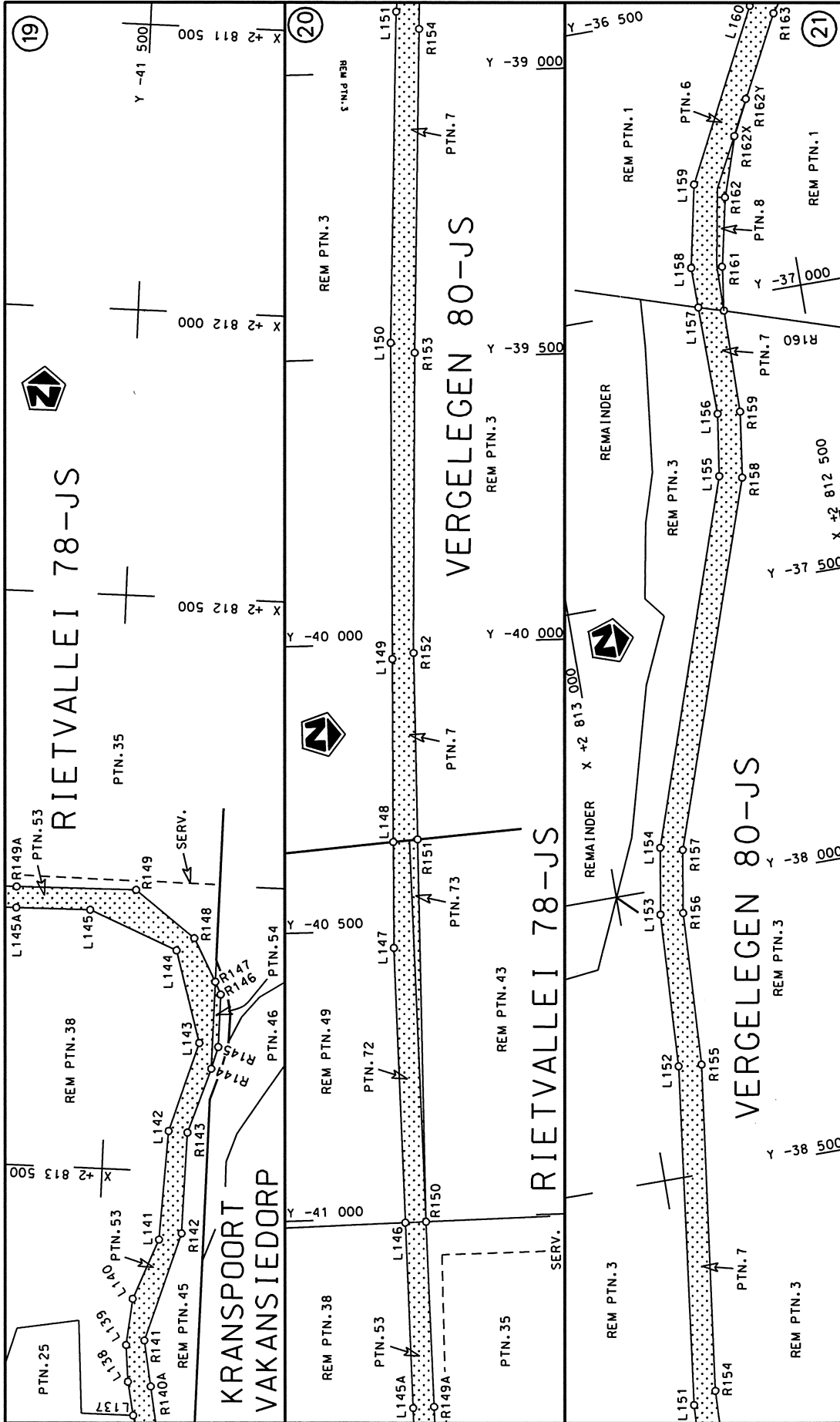

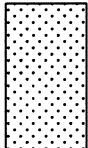
| | | | |
|--|---|--|---|
| <p>Die Suid Afrikaanse Nasionale Padagentskap Beperk The South African National Roads Agency Limited</p> | <p>Die figuur getoon The figure shown</p>  | <p>steldie padreserwe voor van 'n gedeelte represents the road reserve of a portion van Nasionale Roete N11 of National Route</p> <p>Seksie 10 Section</p> | <p>Vel 7 van 20 Sheet of Plan P712/08</p> |
|--|---|--|---|

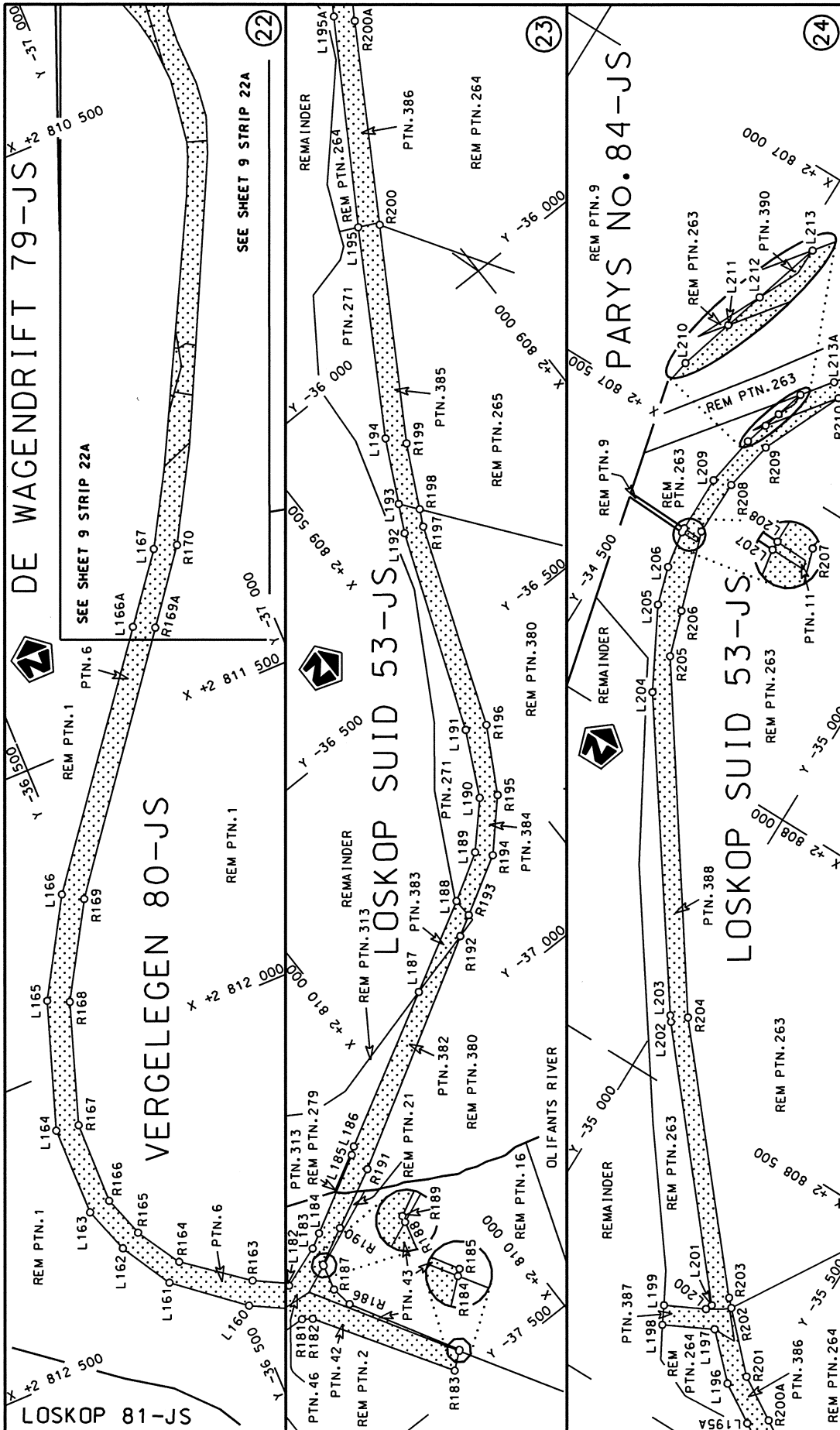

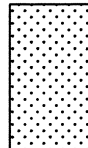
| | | |
|--|---|---|
| <p>Die Suid Afrikaanse Nasionale Padagentskap Beperk The South African National Roads Agency Limited</p> | <p>Die figuur getoon The figure shown</p>  | <p>steldie padreserwe voor van 'n gedeelte represents the road reserve of a portion van Nasionale Roete N11 Seksie 10 of National Route Section</p> |
| <p>Vel Sheet 8 of 20</p> | <p>Plan P712/08</p> | <p>Section 10</p> |

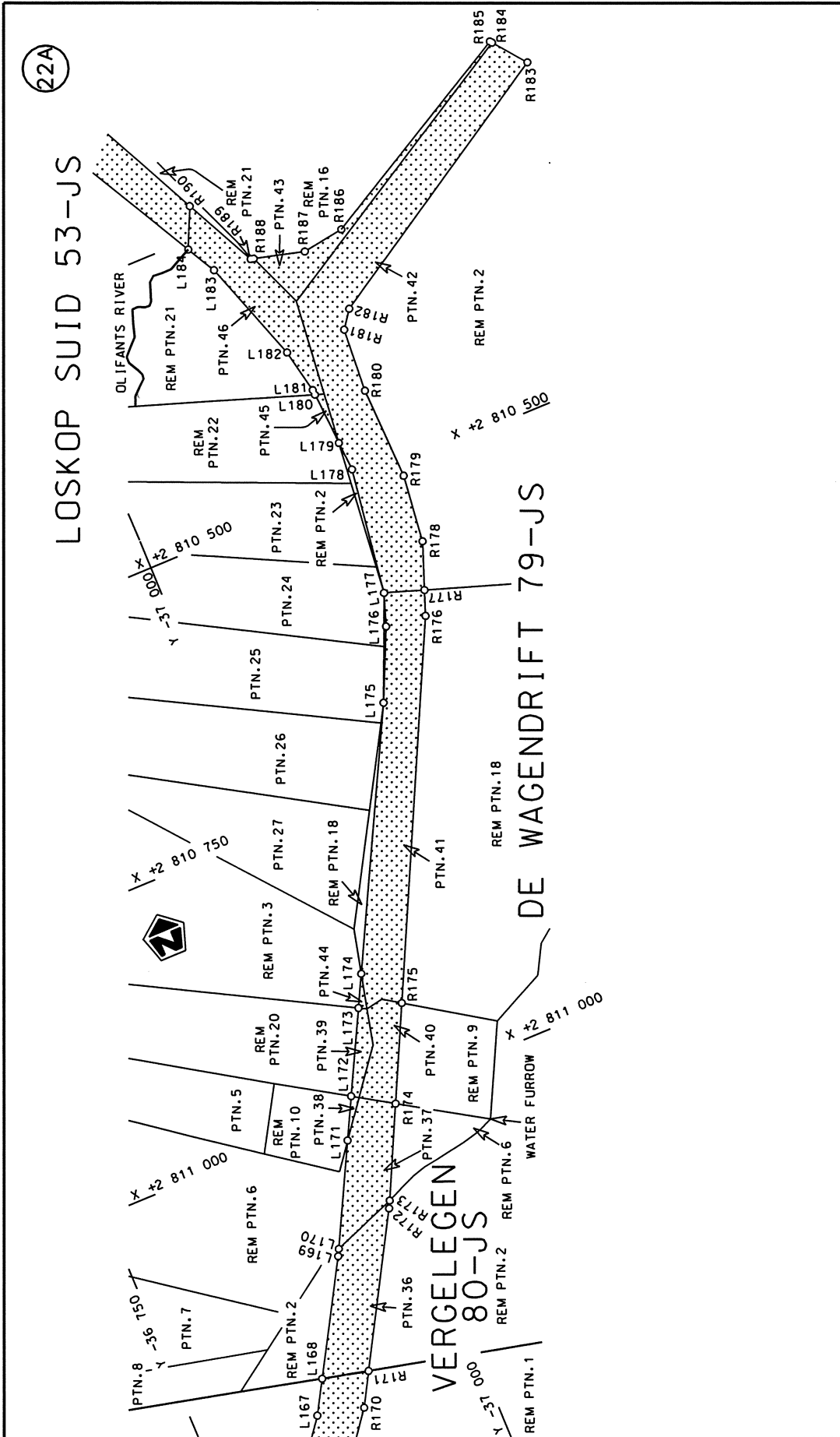

22A

LOS KOP SUID 53-JS

VERGELEGEN 80-JS

DE WAGENDRIFT 79-JS

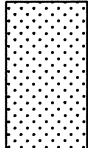
| | | |
|--|---|--|
| <p>Die Suid Afrikaanse Nasionale Padagentskap Beperk The South African National Roads Agency Limited</p> | <p>Die figuur getoon The figure shown</p>  <p>steldie padreserwe voor van 'n gedeelte represents the road reserve of a portion van Nasionale Roete N11 of National Route</p> | <p>Vel van Sheet 9 of 20</p> <p>Plan P712/08</p> |
|--|---|--|

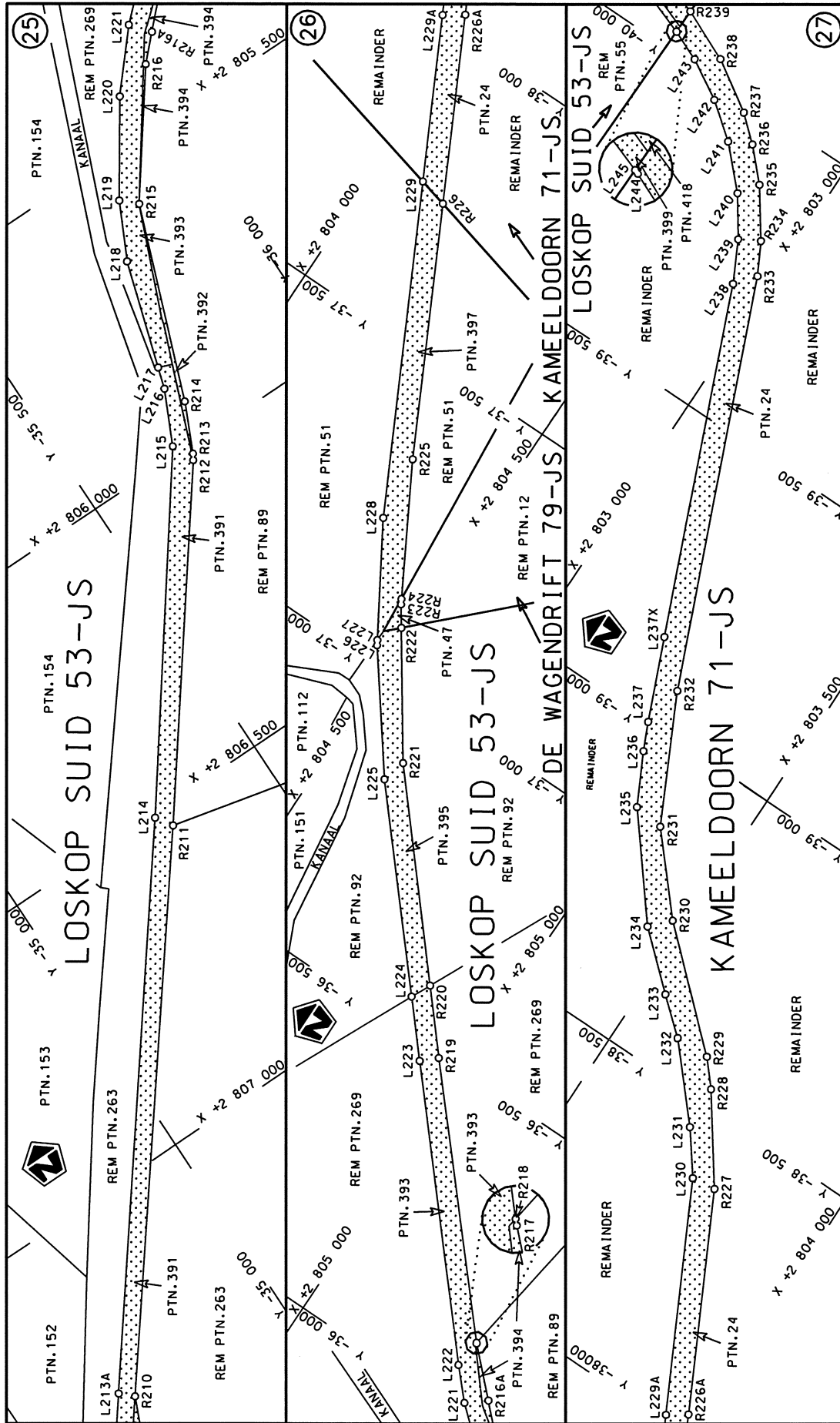

| | | |
|--|---|--|
| <p>Die Suid Afrikaanse Nasionale Padagentskap Beperk The South African National Roads Agency Limited</p> | <p>Die figuur getoon The figure shown</p> | <p>stel die padreserwe voor van 'n gedeelte represents the road reserve of a portion van Nasionale Roete N11 of National Route Section</p> |
| <p>Vel Sheet 10 of 20</p> | <p>10</p> | <p>Plan P712/08</p> |

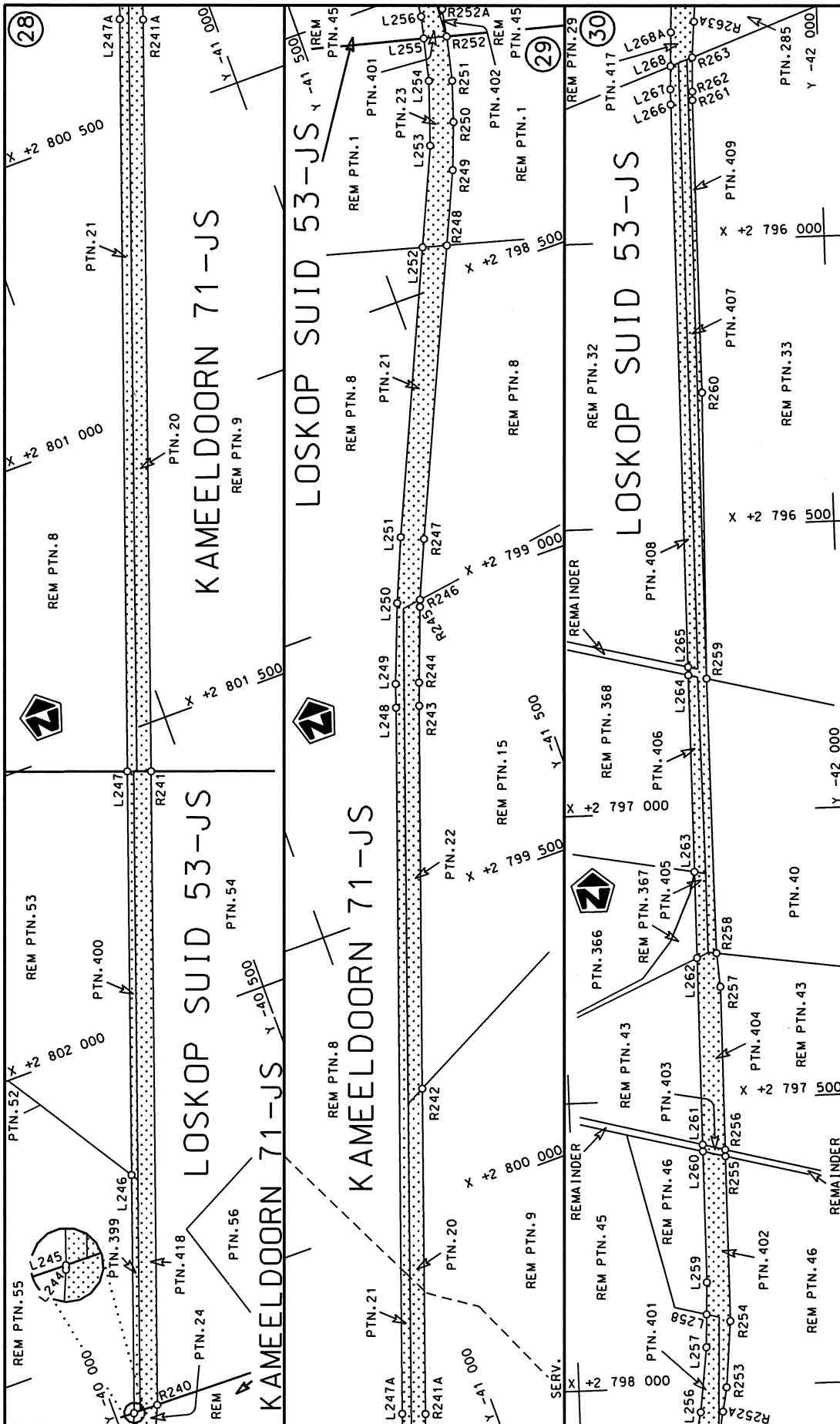

| | | | |
|--|---|---|-------------------------------|
| <p>Die Suid Afrikaanse Nasionale Padagentskap Beperk The South African National Roads Agency Limited</p> | <p>Die figuur getoon The figure shown</p> | <p>steldie podreserwe voor van 'n gedeelte represents the road reserve of a portion van Nasionale Roete N11 of National Route</p> | <p>Vel Sheet 11 of 20</p> |
| <p>Die figuur getoon The figure shown</p> | | <p>steldie podreserwe voor van 'n gedeelte represents the road reserve of a portion van Nasionale Roete N11 of National Route</p> | <p>Plan P712/08</p> |
| <p>Die figuur getoon The figure shown</p> | | <p>Section 10</p> | <p>Section 10</p> |

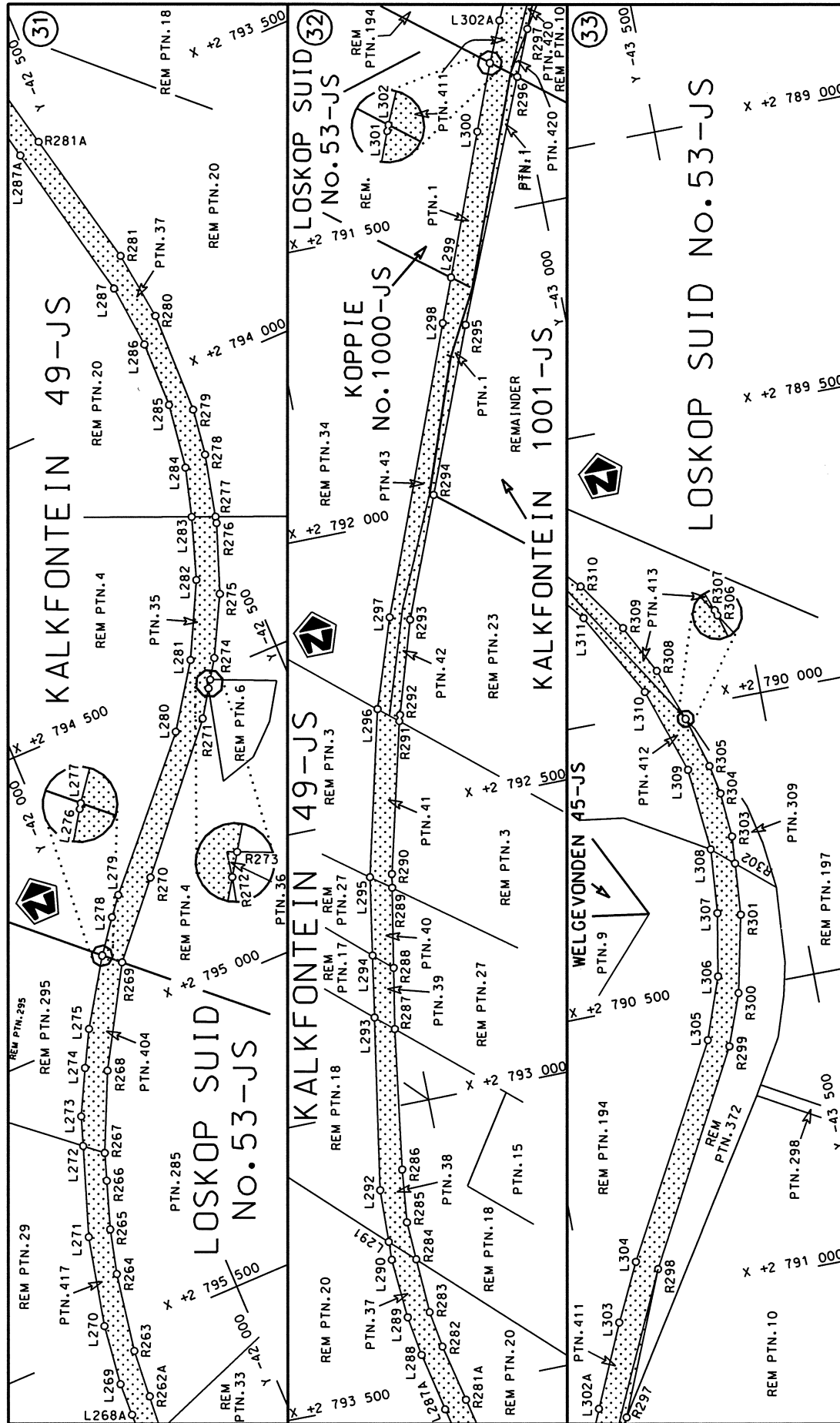

| | | |
|--|---|--|
| <p>Die Suid Afrikaanse Nasionale Padogentskap Beperk The South African National Roads Agency Limited</p> | <p>Die figuur getoon The figure shown</p> | <p>stel die padreserwe voor van 'n gedeelte represents the road reserve of a portion van Nasionale Roete N11 of National Route</p> |
| <p>Vel Sheet 12 of 20</p> | <p>Plan 10</p> | <p>Seksie Section</p> |
| <p>P712/08</p> | <p></p> | <p></p> |

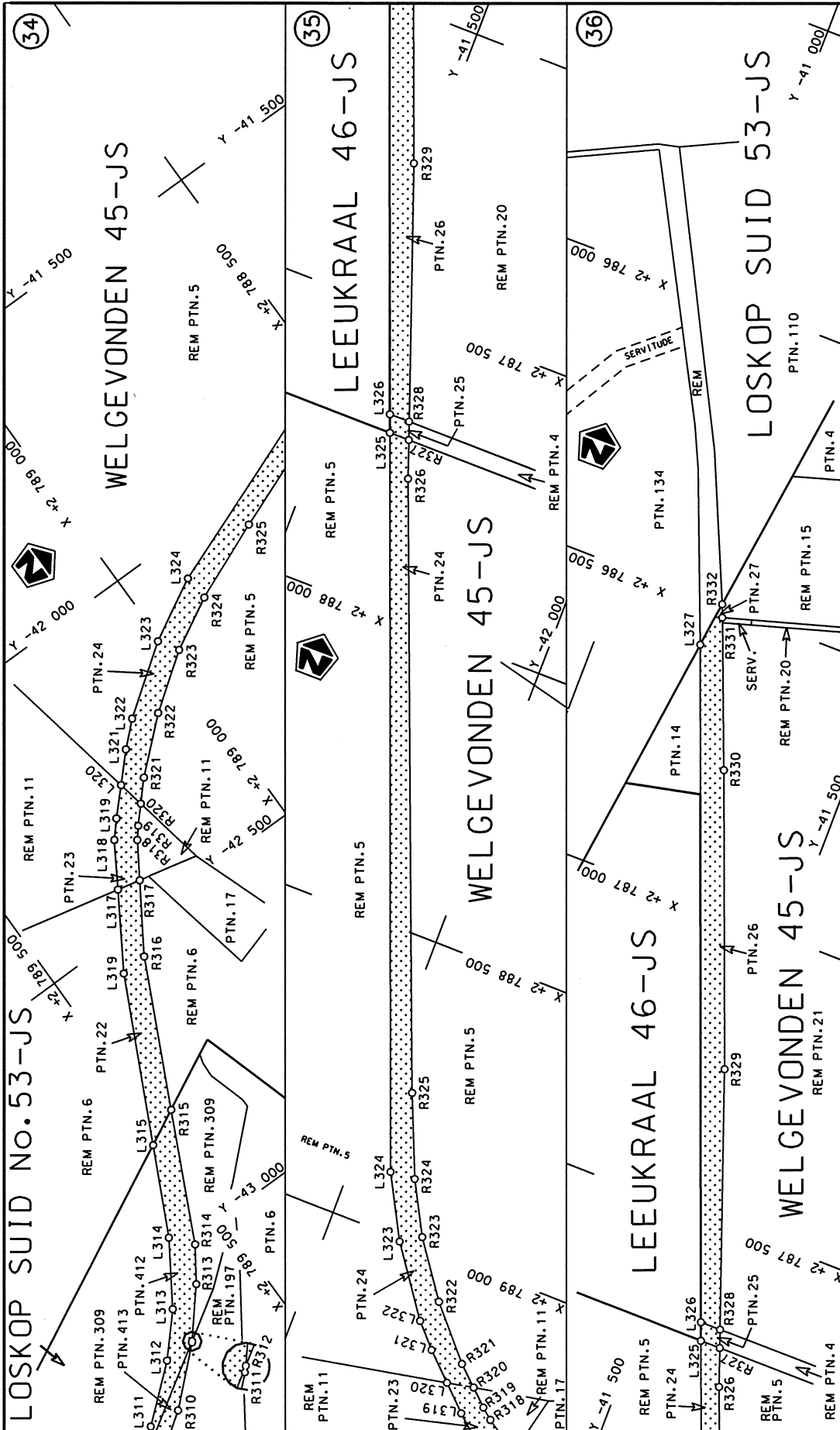

| | | | |
|--|---|---|--|
| <p>Die Suid Afrikaanse Nasionale Padagentskap Beperk The South African National Roads Agency Limited</p> | <p>Die figuur getoon The figure shown</p>  | <p>steldie padreserwe voor van 'n gedeelte represents the road reserve of a portion van Nasionale Roete N11 of National Route</p> | <p>Vel Sheet 13 of 20 Plan P712/08</p> |
|--|---|---|--|

10

| PADRESERWE KOÖRDINATE / ROAD RESERVE CO-ORDINATES | | | | | | |
|---|-------------|-------|---------|----------------------------|-------------|---------------|
| LINKERKANT/LEFT HAND SIDE | | | | REGTERKANT/RIGHT HAND SIDE | | |
| | Y | X | WG 29° | | Y | X |
| L1 | -46 480.310 | 2 847 | 408.430 | R1 | -46 510.930 | 2 847 415.500 |
| L2 | -46 490.930 | 2 847 | 361.700 | R2 | -46 522.570 | 2 847 364.260 |
| L3 | -46 471.100 | 2 847 | 181.290 | R3 | -46 513.290 | 2 847 207.490 |
| L4 | -45 955.250 | 2 845 | 668.820 | R4 | -45 986.200 | 2 845 661.980 |
| L5 | -45 829.030 | 2 844 | 478.980 | R5 | -45 859.630 | 2 844 468.740 |
| L6 | -45 823.840 | 2 844 | 462.040 | R6 | -45 860.530 | 2 844 453.700 |
| L7 | -45 735.820 | 2 843 | 612.710 | R7 | -45 786.144 | 2 843 730.893 |
| L8 | -45 021.020 | 2 839 | 751.470 | R8 | -45 774.010 | 2 843 612.990 |
| L9 | -44 992.590 | 2 839 | 628.020 | R9 | -45 763.280 | 2 843 543.680 |
| L10 | -44 984.280 | 2 839 | 591.940 | R10 | -45 480.220 | 2 842 029.980 |
| L11 | -44 683.980 | 2 838 | 512.500 | R11 | -45 061.730 | 2 839 764.280 |
| L12 | -44 609.260 | 2 838 | 284.840 | R12 | -45 034.190 | 2 839 640.950 |
| L13 | -44 564.380 | 2 838 | 167.180 | R13 | -45 024.970 | 2 839 599.690 |
| L14 | -44 041.850 | 2 836 | 851.870 | R14 | -44 719.030 | 2 838 498.960 |
| L14X | -43 891.170 | 2 836 | 472.570 | R15 | -44 653.150 | 2 838 295.810 |
| L15 | -43 891.070 | 2 836 | 472.240 | R16 | -44 599.890 | 2 838 153.670 |
| L16 | -43 872.050 | 2 836 | 403.860 | R17 | -44 077.720 | 2 836 857.260 |
| L17 | -43 856.850 | 2 836 | 318.050 | R18 | -43 926.630 | 2 836 471.130 |
| L18 | -43 843.390 | 2 836 | 087.740 | R19 | -43 898.610 | 2 836 360.620 |
| L19 | -43 818.020 | 2 835 | 653.720 | R20 | -43 890.110 | 2 836 304.060 |
| L20 | -43 802.720 | 2 835 | 392.040 | R21 | -43 876.980 | 2 836 084.110 |
| L21 | -43 812.890 | 2 835 | 271.300 | R22 | -43 851.070 | 2 835 649.560 |
| L22 | -43 819.850 | 2 835 | 246.590 | R23 | -43 840.610 | 2 835 390.030 |
| L23 | -43 848.160 | 2 835 | 146.120 | R24 | -43 850.340 | 2 835 276.450 |
| L24 | -43 929.610 | 2 834 | 970.960 | R25 | -43 858.980 | 2 835 246.540 |
| L25 | -44 783.850 | 2 833 | 088.350 | R26 | -43 880.960 | 2 835 165.060 |
| L26 | -45 121.700 | 2 832 | 344.730 | R27 | -43 950.500 | 2 835 008.900 |
| L27 | -45 714.300 | 2 831 | 040.390 | R28 | -44 817.260 | 2 833 103.610 |
| L28 | -45 744.480 | 2 830 | 973.960 | R29 | -45 150.650 | 2 832 370.750 |
| L29 | -45 952.900 | 2 830 | 515.230 | R30 | -45 728.970 | 2 831 099.500 |
| L30 | -46 057.160 | 2 830 | 309.960 | R31 | -45 777.080 | 2 830 993.740 |
| L31 | -46 218.340 | 2 830 | 044.980 | R32 | -45 969.030 | 2 830 571.780 |
| L32 | -46 827.370 | 2 829 | 043.650 | R33 | -46 098.680 | 2 830 316.560 |
| L33 | -47 407.210 | 2 828 | 090.310 | R34 | -46 285.310 | 2 830 006.550 |
| L34 | -47 605.640 | 2 827 | 758.700 | R35 | -46 604.540 | 2 829 485.010 |
| L35 | -47 612.960 | 2 827 | 739.220 | R36 | -46 831.760 | 2 829 113.770 |
| L36 | -47 638.200 | 2 827 | 682.940 | R37 | -47 029.090 | 2 828 783.520 |
| L37 | -47 664.970 | 2 827 | 580.520 | R38 | -47 232.830 | 2 828 448.630 |
| L38 | -47 685.410 | 2 827 | 455.410 | R39 | -47 439.940 | 2 828 106.990 |
| L39 | -47 728.480 | 2 827 | 191.860 | R40 | -47 625.650 | 2 827 800.650 |
| L40 | -47 740.160 | 2 827 | 120.290 | R41 | -47 645.420 | 2 827 755.760 |
| L41 | -47 792.230 | 2 826 | 801.010 | R42 | -47 677.310 | 2 827 683.350 |
| L42 | -47 842.030 | 2 826 | 495.730 | R43 | -47 722.210 | 2 827 465.140 |
| L43 | -47 907.950 | 2 826 | 091.550 | R44 | -47 766.680 | 2 827 191.390 |
| L44 | -47 956.080 | 2 825 | 796.510 | R45 | -47 776.580 | 2 827 129.920 |
| L45 | -48 019.500 | 2 825 | 407.660 | R46 | -47 828.050 | 2 826 810.490 |
| L46 | -48 019.780 | 2 825 | 388.520 | R47 | -47 877.270 | 2 826 505.050 |
| L47 | -48 022.630 | 2 825 | 192.910 | R48 | -47 942.430 | 2 826 100.670 |
| L48 | -47 995.490 | 2 825 | 065.170 | R49 | -47 991.180 | 2 825 798.130 |
| L49 | -47 661.630 | 2 824 | 128.690 | R50 | -48 063.660 | 2 825 348.300 |
| L50 | -47 486.970 | 2 823 | 654.450 | R51 | -48 063.960 | 2 825 346.440 |

Vel 14 Van 20
Sheet of

P712/08

| PADRESERWE KOÖRDINATE / ROAD RESERVE CO-ORDINATES | | | | | | | | | | | |
|---|-----|---------|---|--------|----------------------------|------|-----|---------|---|-----|---------|
| LINKERKANT/LEFT HAND SIDE | | | | | REGTERKANT/RIGHT HAND SIDE | | | | | | |
| | Y | | X | WG 29° | | Y | | X | | | |
| L51 | -47 | 292.040 | 2 | 823 | 111.120 | R52 | -48 | 055.930 | 2 | 825 | 179.640 |
| L52 | -46 | 955.510 | 2 | 822 | 172.880 | R53 | -48 | 031.320 | 2 | 825 | 053.800 |
| L53 | -46 | 924.010 | 2 | 822 | 085.050 | R54 | -47 | 100.140 | 2 | 822 | 473.440 |
| L54 | -46 | 905.010 | 2 | 821 | 983.150 | R55 | -46 | 985.150 | 2 | 822 | 155.020 |
| L55 | -46 | 899.970 | 2 | 821 | 878.670 | R56 | -46 | 957.600 | 2 | 822 | 065.630 |
| L56 | -46 | 901.850 | 2 | 821 | 733.620 | R57 | -46 | 941.940 | 2 | 821 | 974.780 |
| L57 | -46 | 905.320 | 2 | 821 | 414.630 | R58 | -46 | 937.690 | 2 | 821 | 887.560 |
| L58 | -46 | 899.430 | 2 | 821 | 359.470 | R59 | -46 | 939.850 | 2 | 821 | 717.290 |
| L59 | -46 | 884.620 | 2 | 821 | 285.030 | R60 | -46 | 939.860 | 2 | 821 | 417.420 |
| L60 | -46 | 838.340 | 2 | 821 | 173.730 | R61 | -46 | 935.510 | 2 | 821 | 301.030 |
| L61 | -46 | 776.840 | 2 | 821 | 081.710 | R62 | -46 | 867.710 | 2 | 821 | 148.830 |
| L62 | -46 | 610.670 | 2 | 820 | 900.210 | R63 | -46 | 799.090 | 2 | 821 | 049.680 |
| L63 | -46 | 261.290 | 2 | 820 | 541.100 | R64 | -46 | 636.620 | 2 | 820 | 878.530 |
| L64 | -46 | 174.200 | 2 | 820 | 419.600 | R65 | -46 | 291.410 | 2 | 820 | 514.870 |
| L65 | -46 | 114.800 | 2 | 820 | 274.820 | R66 | -46 | 215.870 | 2 | 820 | 419.160 |
| L66 | -46 | 111.520 | 2 | 820 | 261.640 | R67 | -46 | 146.140 | 2 | 820 | 260.070 |
| L67 | -46 | 098.940 | 2 | 820 | 211.110 | R68 | -46 | 146.010 | 2 | 820 | 259.270 |
| L68 | -46 | 091.840 | 2 | 820 | 143.180 | R69 | -46 | 127.660 | 2 | 820 | 146.310 |
| L69 | -46 | 098.040 | 2 | 819 | 973.110 | R70 | -46 | 142.050 | 2 | 819 | 977.350 |
| L70 | -46 | 090.200 | 2 | 819 | 886.730 | R71 | -46 | 122.380 | 2 | 819 | 854.650 |
| L71 | -46 | 068.900 | 2 | 819 | 797.030 | R72 | -46 | 110.020 | 2 | 819 | 802.030 |
| L72 | -46 | 035.950 | 2 | 819 | 708.580 | R73 | -46 | 099.670 | 2 | 819 | 767.130 |
| L73 | -45 | 776.110 | 2 | 819 | 243.040 | R74 | -46 | 090.480 | 2 | 819 | 742.300 |
| L74 | -45 | 734.480 | 2 | 819 | 135.420 | R75 | -46 | 087.020 | 2 | 819 | 732.950 |
| L75 | -45 | 711.570 | 2 | 819 | 029.770 | R76 | -46 | 072.210 | 2 | 819 | 699.620 |
| L76 | -45 | 709.500 | 2 | 818 | 903.040 | R77 | -46 | 033.560 | 2 | 819 | 628.280 |
| L77 | -45 | 901.290 | 2 | 817 | 954.020 | R78 | -45 | 781.610 | 2 | 819 | 163.290 |
| L78 | -45 | 887.410 | 2 | 817 | 791.630 | R79 | -45 | 756.350 | 2 | 819 | 053.830 |
| L79 | -45 | 819.180 | 2 | 817 | 371.130 | R80 | -45 | 754.270 | 2 | 818 | 880.580 |
| L80 | -45 | 815.110 | 2 | 817 | 333.600 | R81 | -45 | 762.760 | 2 | 818 | 820.170 |
| L81 | -45 | 810.950 | 2 | 817 | 259.870 | R82 | -45 | 886.960 | 2 | 818 | 279.770 |
| L82 | -45 | 796.710 | 2 | 817 | 160.900 | R83 | -45 | 941.490 | 2 | 817 | 972.820 |
| L83 | -45 | 787.690 | 2 | 817 | 015.280 | R84 | -45 | 940.760 | 2 | 817 | 893.130 |
| L84 | -45 | 779.890 | 2 | 816 | 854.600 | R85 | -45 | 857.920 | 2 | 817 | 366.580 |
| L85 | -45 | 787.650 | 2 | 816 | 806.770 | R86 | -45 | 849.060 | 2 | 817 | 246.380 |
| L86 | -45 | 796.710 | 2 | 816 | 750.940 | R87 | -45 | 825.590 | 2 | 817 | 027.160 |
| L87 | -45 | 825.110 | 2 | 816 | 576.010 | R88 | -45 | 818.210 | 2 | 816 | 869.770 |
| L88 | -45 | 858.720 | 2 | 816 | 454.210 | R89 | -45 | 827.780 | 2 | 816 | 809.910 |
| L89 | -45 | 921.310 | 2 | 816 | 344.530 | R90 | -45 | 836.950 | 2 | 816 | 752.570 |
| L90 | -46 | 092.400 | 2 | 816 | 198.320 | R91 | -45 | 863.850 | 2 | 816 | 584.310 |
| L91 | -46 | 163.080 | 2 | 816 | 127.500 | R92 | -45 | 895.800 | 2 | 816 | 470.280 |
| L92 | -46 | 201.570 | 2 | 816 | 106.870 | R93 | -45 | 949.530 | 2 | 816 | 383.100 |
| L93 | -46 | 236.590 | 2 | 816 | 093.000 | R94 | -46 | 119.590 | 2 | 816 | 227.690 |
| L94 | -46 | 505.910 | 2 | 816 | 019.380 | R95 | -46 | 187.210 | 2 | 816 | 159.950 |
| L95 | -46 | 538.810 | 2 | 816 | 003.810 | R96 | -46 | 249.260 | 2 | 816 | 130.990 |
| L96 | -46 | 575.660 | 2 | 815 | 977.440 | R97 | -46 | 519.840 | 2 | 816 | 056.930 |
| L97 | -46 | 600.840 | 2 | 815 | 951.970 | R98 | -46 | 559.530 | 2 | 816 | 038.790 |
| L98 | -46 | 626.250 | 2 | 815 | 915.190 | R99 | -46 | 601.270 | 2 | 816 | 008.370 |
| L99 | -46 | 639.300 | 2 | 815 | 888.360 | R100 | -46 | 626.050 | 2 | 815 | 984.780 |
| L100 | -46 | 678.190 | 2 | 815 | 797.190 | R101 | -46 | 661.560 | 2 | 815 | 934.100 |
| L101 | -46 | 739.320 | 2 | 815 | 687.560 | R102 | -46 | 675.660 | 2 | 815 | 905.050 |

| | | | | |
|-------|----|-----|----|---------|
| Vel | 15 | Van | 20 | P712/08 |
| Sheet | | of | | |

| PADRESERWE KOÖRDINATE / ROAD RESERVE CO-ORDINATES | | | | | | | | | | | |
|---|-----|---------|---|--------|----------------------------|------|-----|---------|---|-----|---------|
| LINKERKANT/LEFT HAND SIDE | | | | | REGTERKANT/RIGHT HAND SIDE | | | | | | |
| | Y | | X | WG 29° | | Y | | X | | | |
| L102 | -46 | 771.960 | 2 | 815 | 645.910 | R103 | -46 | 714.090 | 2 | 815 | 814.740 |
| L103 | -46 | 795.060 | 2 | 815 | 628.520 | R104 | -46 | 772.530 | 2 | 815 | 709.560 |
| L104 | -46 | 901.790 | 2 | 815 | 582.320 | R105 | -46 | 800.200 | 2 | 815 | 674.650 |
| L105 | -46 | 942.780 | 2 | 815 | 553.510 | R106 | -46 | 815.380 | 2 | 815 | 663.210 |
| L106 | -46 | 974.060 | 2 | 815 | 516.190 | R107 | -46 | 921.680 | 2 | 815 | 618.190 |
| L107 | -47 | 032.010 | 2 | 815 | 419.440 | R108 | -46 | 965.610 | 2 | 815 | 588.450 |
| L108 | -47 | 058.120 | 2 | 815 | 368.250 | R109 | -47 | 006.710 | 2 | 815 | 539.560 |
| L109 | -47 | 070.930 | 2 | 815 | 324.390 | R110 | -47 | 012.830 | 2 | 815 | 529.350 |
| L110 | -47 | 073.640 | 2 | 815 | 258.330 | R111 | -47 | 040.930 | 2 | 815 | 482.420 |
| L111 | -47 | 069.950 | 2 | 815 | 220.350 | R112 | -47 | 067.030 | 2 | 815 | 438.820 |
| L112 | -47 | 045.990 | 2 | 815 | 147.770 | R113 | -47 | 090.930 | 2 | 815 | 386.700 |
| L113 | -47 | 021.240 | 2 | 815 | 103.890 | R114 | -47 | 107.170 | 2 | 815 | 324.420 |
| L114 | -46 | 984.100 | 2 | 815 | 066.360 | R115 | -47 | 111.200 | 2 | 815 | 256.630 |
| L115 | -46 | 941.290 | 2 | 815 | 033.480 | R116 | -47 | 105.590 | 2 | 815 | 212.090 |
| L116 | -46 | 909.800 | 2 | 815 | 016.450 | R117 | -47 | 098.050 | 2 | 815 | 181.530 |
| L117 | -46 | 876.520 | 2 | 815 | 003.100 | R118 | -47 | 076.260 | 2 | 815 | 126.500 |
| L118 | -46 | 263.300 | 2 | 814 | 843.080 | R119 | -47 | 048.480 | 2 | 815 | 080.530 |
| L119 | -46 | 183.130 | 2 | 814 | 833.660 | R120 | -46 | 998.910 | 2 | 815 | 028.790 |
| L120 | -44 | 724.220 | 2 | 814 | 857.730 | R121 | -46 | 971.260 | 2 | 815 | 007.770 |
| L121 | -44 | 366.410 | 2 | 814 | 860.510 | R122 | -46 | 922.900 | 2 | 814 | 980.440 |
| L122 | -44 | 270.690 | 2 | 814 | 854.820 | R123 | -46 | 905.710 | 2 | 814 | 973.420 |
| L123 | -43 | 812.980 | 2 | 814 | 777.740 | R124 | -46 | 275.660 | 2 | 814 | 809.680 |
| L124 | -43 | 095.360 | 2 | 814 | 653.880 | R125 | -46 | 166.350 | 2 | 814 | 798.150 |
| L125 | -42 | 922.730 | 2 | 814 | 622.990 | R126 | -44 | 733.540 | 2 | 814 | 817.460 |
| L126 | -42 | 468.900 | 2 | 814 | 544.870 | R127 | -44 | 327.760 | 2 | 814 | 822.930 |
| L127 | -41 | 970.800 | 2 | 814 | 459.100 | R128 | -44 | 304.560 | 2 | 814 | 823.240 |
| L128 | -41 | 894.400 | 2 | 814 | 436.830 | R129 | -44 | 276.690 | 2 | 814 | 818.440 |
| L129 | -41 | 829.860 | 2 | 814 | 403.100 | R130 | -43 | 816.300 | 2 | 814 | 739.220 |
| L130 | -41 | 780.450 | 2 | 814 | 369.830 | R131 | -42 | 940.460 | 2 | 814 | 588.510 |
| L131 | -41 | 714.250 | 2 | 814 | 302.910 | R132 | -42 | 000.510 | 2 | 814 | 425.790 |
| L132 | -41 | 679.660 | 2 | 814 | 261.030 | R133 | -41 | 933.720 | 2 | 814 | 408.710 |
| L133 | -41 | 676.550 | 2 | 814 | 257.250 | R134 | -41 | 869.790 | 2 | 814 | 381.040 |
| L134 | -41 | 640.640 | 2 | 814 | 191.430 | R135 | -41 | 811.000 | 2 | 814 | 343.560 |
| L134X | -41 | 598.630 | 2 | 814 | 050.170 | R136 | -41 | 758.950 | 2 | 814 | 297.280 |
| L135 | -41 | 593.050 | 2 | 814 | 031.400 | R137 | -41 | 714.860 | 2 | 814 | 243.330 |
| L136 | -41 | 582.140 | 2 | 813 | 975.200 | R138 | -41 | 680.020 | 2 | 814 | 183.000 |
| L137 | -41 | 572.650 | 2 | 813 | 926.290 | R139 | -41 | 631.760 | 2 | 814 | 028.760 |
| L138 | -41 | 561.040 | 2 | 813 | 868.120 | R140 | -41 | 619.310 | 2 | 813 | 973.310 |
| L139 | -41 | 555.100 | 2 | 813 | 804.330 | R141 | -41 | 586.910 | 2 | 813 | 795.050 |
| L140 | -41 | 563.320 | 2 | 813 | 723.500 | R142 | -41 | 644.320 | 2 | 813 | 606.360 |
| L141 | -41 | 605.220 | 2 | 813 | 618.740 | R143 | -41 | 647.130 | 2 | 813 | 431.010 |
| L142 | -41 | 614.340 | 2 | 813 | 429.720 | R144 | -41 | 683.770 | 2 | 813 | 318.480 |
| L143 | -41 | 661.110 | 2 | 813 | 274.720 | R145 | -41 | 694.180 | 2 | 813 | 280.250 |
| L144 | -41 | 614.800 | 2 | 813 | 115.440 | R146 | -41 | 694.500 | 2 | 813 | 188.980 |
| L145 | -41 | 460.110 | 2 | 813 | 051.170 | R147 | -41 | 684.420 | 2 | 813 | 167.350 |
| L146 | -41 | 007.860 | 2 | 813 | 057.410 | R148 | -41 | 644.750 | 2 | 813 | 092.820 |
| L147 | -40 | 530.290 | 2 | 813 | 064.010 | R149 | -41 | 539.350 | 2 | 813 | 012.940 |
| L148 | -40 | 345.470 | 2 | 813 | 059.910 | R150 | -41 | 007.240 | 2 | 813 | 021.230 |
| L149 | -40 | 026.530 | 2 | 813 | 052.710 | R151 | -40 | 342.220 | 2 | 813 | 017.280 |
| L150 | -39 | 472.850 | 2 | 813 | 040.520 | R152 | -40 | 016.700 | 2 | 813 | 015.340 |
| L151 | -38 | 893.370 | 2 | 813 | 015.300 | R153 | -39 | 491.230 | 2 | 812 | 998.880 |

| | | | | |
|-------|----|-----|----|---------|
| Vel | 16 | Van | 20 | P712/08 |
| Sheet | | of | | |

| PADRESERWE KOÖRDINATE / ROAD RESERVE CO-ORDINATES | | | | | | | | | | | |
|---|-----|---------|---|--------|---------|----------------------------|-----|---------|---|-----|---------|
| LINKERKANT/LEFT HAND SIDE | | | | | | REGTERKANT/RIGHT HAND SIDE | | | | | |
| | Y | | X | WG 29° | | Y | | X | | | |
| L152 | -38 | 308.640 | 2 | 812 | 941.910 | R154 | -38 | 875.300 | 2 | 812 | 974.250 |
| L153 | -38 | 043.010 | 2 | 812 | 928.590 | R155 | -38 | 312.510 | 2 | 812 | 901.640 |
| L154 | -37 | 927.900 | 2 | 812 | 909.100 | R156 | -38 | 046.950 | 2 | 812 | 888.630 |
| L155 | -37 | 305.620 | 2 | 812 | 696.680 | R157 | -37 | 938.360 | 2 | 812 | 870.470 |
| L156 | -37 | 197.240 | 2 | 812 | 681.040 | R158 | -37 | 314.760 | 2 | 812 | 657.740 |
| L157 | -37 | 008.180 | 2 | 812 | 682.880 | R159 | -37 | 200.150 | 2 | 812 | 641.790 |
| L158 | -36 | 937.910 | 2 | 812 | 683.560 | R160 | -37 | 021.120 | 2 | 812 | 639.620 |
| L159 | -36 | 794.790 | 2 | 812 | 653.940 | R161 | -36 | 944.490 | 2 | 812 | 629.200 |
| L160 | -36 | 500.180 | 2 | 812 | 504.080 | R162 | -36 | 825.700 | 2 | 812 | 603.620 |
| L161 | -36 | 387.310 | 2 | 812 | 414.150 | R162X | -36 | 722.620 | 2 | 812 | 569.390 |
| L162 | -36 | 335.360 | 2 | 812 | 328.000 | R162Y | -36 | 661.840 | 2 | 812 | 538.770 |
| L163 | -36 | 306.820 | 2 | 812 | 248.760 | R163 | -36 | 522.500 | 2 | 812 | 466.410 |
| L164 | -36 | 306.320 | 2 | 812 | 095.640 | R164 | -36 | 417.040 | 2 | 812 | 387.390 |
| L165 | -36 | 378.220 | 2 | 811 | 882.300 | R165 | -36 | 370.140 | 2 | 812 | 313.250 |
| L166 | -36 | 473.070 | 2 | 811 | 721.990 | R166 | -36 | 345.100 | 2 | 812 | 243.180 |
| L167 | -36 | 852.220 | 2 | 811 | 229.690 | R167 | -36 | 346.210 | 2 | 812 | 102.000 |
| L168 | -36 | 868.310 | 2 | 811 | 201.880 | R168 | -36 | 414.090 | 2 | 811 | 899.310 |
| L169 | -36 | 923.310 | 2 | 811 | 106.820 | R169 | -36 | 506.170 | 2 | 811 | 744.170 |
| L170 | -36 | 924.640 | 2 | 811 | 104.230 | R170 | -36 | 892.270 | 2 | 811 | 238.950 |
| L171 | -36 | 967.510 | 2 | 811 | 021.260 | R171 | -36 | 908.100 | 2 | 811 | 211.230 |
| L172 | -36 | 985.030 | 2 | 810 | 987.350 | R172 | -36 | 980.190 | 2 | 811 | 085.050 |
| L173 | -37 | 019.970 | 2 | 810 | 919.730 | R173 | -36 | 981.260 | 2 | 811 | 082.860 |
| L174 | -37 | 033.560 | 2 | 810 | 893.420 | R174 | -37 | 018.000 | 2 | 811 | 007.950 |
| L175 | -37 | 141.270 | 2 | 810 | 684.950 | R175 | -37 | 056.180 | 2 | 810 | 930.120 |
| L176 | -37 | 168.650 | 2 | 810 | 624.830 | R176 | -37 | 203.640 | 2 | 810 | 629.470 |
| L177 | -37 | 178.180 | 2 | 810 | 597.380 | R177 | -37 | 211.430 | 2 | 810 | 608.490 |
| L178 | -37 | 193.720 | 2 | 810 | 487.880 | R178 | -37 | 226.140 | 2 | 810 | 568.860 |
| L179 | -37 | 192.020 | 2 | 810 | 462.270 | R179 | -37 | 232.910 | 2 | 810 | 510.070 |
| L180 | -37 | 188.940 | 2 | 810 | 415.750 | R180 | -37 | 230.270 | 2 | 810 | 429.130 |
| L181 | -37 | 188.640 | 2 | 810 | 411.260 | R181 | -37 | 233.940 | 2 | 810 | 373.430 |
| L182 | -37 | 180.610 | 2 | 810 | 372.710 | R182 | -37 | 244.950 | 2 | 810 | 358.360 |
| L183 | -37 | 149.720 | 2 | 810 | 282.730 | R183 | -37 | 469.150 | 2 | 810 | 220.200 |
| L184 | -37 | 136.000 | 2 | 810 | 257.640 | R184 | -37 | 447.400 | 2 | 810 | 192.750 |
| L185 | -37 | 065.570 | 2 | 810 | 128.850 | R185 | -37 | 446.130 | 2 | 810 | 191.150 |
| L186 | -37 | 056.350 | 2 | 810 | 116.800 | R186 | -37 | 265.030 | 2 | 810 | 292.200 |
| L187 | -36 | 917.760 | 2 | 809 | 861.640 | R187 | -37 | 228.330 | 2 | 810 | 297.840 |
| L188 | -36 | 835.190 | 2 | 809 | 711.940 | R188 | -37 | 185.140 | 2 | 810 | 286.590 |
| L189 | -36 | 789.100 | 2 | 809 | 634.010 | R189 | -37 | 182.520 | 2 | 810 | 285.910 |
| L190 | -36 | 720.070 | 2 | 809 | 568.960 | R190 | -37 | 151.650 | 2 | 810 | 223.450 |
| L191 | -36 | 612.540 | 2 | 809 | 514.500 | R191 | -37 | 101.790 | 2 | 810 | 122.570 |
| L192 | -36 | 278.260 | 2 | 809 | 385.140 | R192 | -36 | 886.920 | 2 | 809 | 744.640 |
| L193 | -36 | 231.910 | 2 | 809 | 361.420 | R193 | -36 | 867.500 | 2 | 809 | 710.480 |
| L194 | -36 | 128.120 | 2 | 809 | 308.320 | R194 | -36 | 812.110 | 2 | 809 | 613.050 |
| L195 | -35 | 810.380 | 2 | 809 | 117.010 | R195 | -36 | 735.520 | 2 | 809 | 541.380 |
| L196 | -35 | 430.190 | 2 | 808 | 881.460 | R196 | -36 | 628.100 | 2 | 809 | 480.950 |
| L197 | -35 | 361.900 | 2 | 808 | 813.070 | R197 | -36 | 289.380 | 2 | 809 | 352.640 |
| L198 | -35 | 279.670 | 2 | 808 | 854.600 | R198 | -36 | 261.860 | 2 | 809 | 338.560 |
| L199 | -35 | 264.440 | 2 | 808 | 824.370 | R199 | -36 | 157.690 | 2 | 809 | 285.260 |
| L200 | -35 | 330.350 | 2 | 808 | 791.180 | R200 | -35 | 830.210 | 2 | 809 | 085.050 |
| L201 | -35 | 335.730 | 2 | 808 | 780.270 | R201 | -35 | 452.190 | 2 | 808 | 853.960 |
| L202 | -35 | 017.640 | 2 | 808 | 400.860 | R202 | -35 | 367.120 | 2 | 808 | 766.440 |

| | | | | |
|-------|----|-----|----|---------|
| Vel | 17 | Van | 20 | P712/08 |
| Sheet | | of | | |

| PADRESERWE KOÖRDINATE / ROAD RESERVE CO-ORDINATES | | | | | | | | | | | |
|---|-----|---------|---|--------|----------------------------|------|-----|---------|---|-----|---------|
| LINKERKANT/LEFT HAND SIDE | | | | | REGTERKANT/RIGHT HAND SIDE | | | | | | |
| | Y | | X | WG 29° | | | | X | | | |
| L203 | -35 | 010.790 | 2 | 808 | 391.770 | R203 | -35 | 354.590 | 2 | 808 | 753.550 |
| L204 | -34 | 689.720 | 2 | 807 | 930.880 | R204 | -35 | 039.100 | 2 | 808 | 378.720 |
| L205 | -34 | 618.100 | 2 | 807 | 796.040 | R205 | -34 | 683.460 | 2 | 807 | 861.580 |
| L206 | -34 | 598.720 | 2 | 807 | 730.960 | R206 | -34 | 658.850 | 2 | 807 | 783.820 |
| L207 | -34 | 587.690 | 2 | 807 | 666.510 | R207 | -34 | 615.920 | 2 | 807 | 647.960 |
| L208 | -34 | 587.650 | 2 | 807 | 658.610 | R208 | -34 | 617.670 | 2 | 807 | 551.310 |
| L209 | -34 | 587.190 | 2 | 807 | 560.510 | R209 | -34 | 634.540 | 2 | 807 | 464.280 |
| L210 | -34 | 602.320 | 2 | 807 | 471.300 | R210 | -34 | 697.090 | 2 | 807 | 324.450 |
| L211 | -34 | 614.280 | 2 | 807 | 431.830 | R211 | -35 | 305.280 | 2 | 806 | 535.810 |
| L212 | -34 | 623.040 | 2 | 807 | 402.910 | R212 | -35 | 690.020 | 2 | 806 | 024.100 |
| L213 | -34 | 637.780 | 2 | 807 | 354.270 | R213 | -35 | 696.120 | 2 | 806 | 014.390 |
| L214 | -35 | 286.460 | 2 | 806 | 506.860 | R214 | -35 | 734.940 | 2 | 805 | 930.340 |
| L215 | -35 | 673.570 | 2 | 805 | 984.070 | R215 | -35 | 860.170 | 2 | 805 | 598.040 |
| L216 | -35 | 717.300 | 2 | 805 | 891.800 | R216 | -36 | 005.960 | 2 | 805 | 400.520 |
| L217 | -35 | 728.910 | 2 | 805 | 854.780 | R217 | -36 | 117.630 | 2 | 805 | 287.010 |
| L218 | -35 | 786.920 | 2 | 805 | 669.910 | R218 | -36 | 118.530 | 2 | 805 | 286.220 |
| L219 | -35 | 834.750 | 2 | 805 | 573.880 | R219 | -36 | 493.070 | 2 | 804 | 955.960 |
| L220 | -35 | 936.810 | 2 | 805 | 422.620 | R220 | -36 | 589.240 | 2 | 804 | 873.150 |
| L221 | -36 | 019.650 | 2 | 805 | 326.820 | R221 | -36 | 885.600 | 2 | 804 | 617.970 |
| L222 | -36 | 068.660 | 2 | 805 | 281.310 | R222 | -37 | 080.180 | 2 | 804 | 484.010 |
| L223 | -36 | 470.130 | 2 | 804 | 930.910 | R223 | -37 | 113.950 | 2 | 804 | 460.760 |
| L224 | -36 | 555.240 | 2 | 804 | 857.080 | R224 | -37 | 122.380 | 2 | 804 | 456.040 |
| L225 | -36 | 843.880 | 2 | 804 | 606.680 | R225 | -37 | 336.650 | 2 | 804 | 336.060 |
| L226 | -37 | 031.210 | 2 | 804 | 465.840 | R226 | -37 | 738.210 | 2 | 804 | 130.520 |
| L227 | -37 | 039.210 | 2 | 804 | 461.020 | R227 | -38 | 386.920 | 2 | 803 | 798.480 |
| L228 | -37 | 222.630 | 2 | 804 | 350.380 | R228 | -38 | 527.770 | 2 | 803 | 697.300 |
| L229 | -37 | 751.060 | 2 | 804 | 079.530 | R229 | -38 | 570.490 | 2 | 803 | 659.850 |
| L230 | -38 | 381.430 | 2 | 803 | 756.310 | R230 | -38 | 734.620 | 2 | 803 | 478.250 |
| L231 | -38 | 452.350 | 2 | 803 | 703.030 | R231 | -38 | 858.740 | 2 | 803 | 368.870 |
| L232 | -38 | 568.990 | 2 | 803 | 599.100 | R232 | -39 | 072.590 | 2 | 803 | 262.310 |
| L233 | -38 | 620.320 | 2 | 803 | 538.880 | R233 | -39 | 754.500 | 2 | 802 | 975.210 |
| L234 | -38 | 701.230 | 2 | 803 | 446.930 | R234 | -39 | 808.990 | 2 | 802 | 945.940 |
| L235 | -38 | 864.330 | 2 | 803 | 315.850 | R235 | -39 | 889.520 | 2 | 802 | 888.760 |
| L236 | -38 | 951.750 | 2 | 803 | 270.930 | R236 | -39 | 941.460 | 2 | 802 | 839.340 |
| L237 | -39 | 998.970 | 2 | 802 | 249.570 | R237 | -39 | 979.550 | 2 | 802 | 795.820 |
| L237X | -39 | 138.130 | 2 | 803 | 190.850 | R238 | -40 | 034.990 | 2 | 802 | 709.670 |
| L238 | -39 | 719.710 | 2 | 802 | 947.000 | R239 | -40 | 075.080 | 2 | 802 | 619.290 |
| L239 | -39 | 789.380 | 2 | 802 | 911.140 | R240 | -40 | 444.670 | 2 | 801 | 580.160 |
| L240 | -39 | 855.900 | 2 | 802 | 865.200 | R241 | -41 | 072.570 | 2 | 799 | 805.890 |
| L241 | -39 | 922.110 | 2 | 802 | 801.290 | R242 | -41 | 296.190 | 2 | 799 | 177.430 |
| L242 | -39 | 969.640 | 2 | 802 | 740.710 | R243 | -41 | 309.860 | 2 | 799 | 139.150 |
| L243 | -40 | 009.530 | 2 | 802 | 672.020 | R244 | -41 | 356.700 | 2 | 799 | 015.230 |
| L244 | -40 | 031.970 | 2 | 802 | 619.190 | R245 | -41 | 361.060 | 2 | 799 | 003.400 |
| L245 | -40 | 032.240 | 2 | 802 | 618.430 | R246 | -41 | 404.060 | 2 | 798 | 905.920 |
| L246 | -40 | 170.710 | 2 | 802 | 228.160 | R247 | -41 | 617.390 | 2 | 798 | 436.210 |
| L247 | -40 | 405.660 | 2 | 801 | 565.950 | R248 | -41 | 672.080 | 2 | 798 | 315.800 |
| L248 | -41 | 256.930 | 2 | 799 | 166.690 | R249 | -41 | 702.220 | 2 | 798 | 237.100 |
| L249 | -41 | 270.660 | 2 | 799 | 127.440 | R250 | -41 | 724.790 | 2 | 798 | 168.140 |
| L250 | -41 | 321.500 | 2 | 798 | 995.640 | R251 | -41 | 742.270 | 2 | 798 | 091.740 |
| L251 | -41 | 366.900 | 2 | 798 | 889.080 | R252 | -41 | 759.120 | 2 | 798 | 001.980 |
| L252 | -41 | 576.400 | 2 | 798 | 424.900 | R253 | -41 | 769.730 | 2 | 797 | 887.000 |

| | | | | |
|-------|----|-----|----|---------|
| Vel | 18 | Van | 20 | P712/08 |
| Sheet | | of | | |

| PADRESERWE KOÖRDINATE / ROAD RESERVE CO-ORDINATES | | | | | | | | | | | |
|---|-----|---------|---|--------|----------------------------|------|-----|---------|---|-----|---------|
| LINKERKANT/LEFT HAND SIDE | | | | | REGTERKANT/RIGHT HAND SIDE | | | | | | |
| | Y | | X | WG 29° | | X | | | | | |
| L253 | -41 | 649.910 | 2 | 798 | 262.040 | R254 | -41 | 771.200 | 2 | 797 | 600.340 |
| L254 | -41 | 686.510 | 2 | 798 | 154.540 | R255 | -41 | 771.260 | 2 | 797 | 588.900 |
| L255 | -41 | 703.470 | 2 | 798 | 081.610 | R256 | -41 | 772.720 | 2 | 797 | 305.810 |
| L256 | -41 | 712.220 | 2 | 798 | 043.940 | R257 | -41 | 767.940 | 2 | 797 | 247.090 |
| L257 | -41 | 726.190 | 2 | 797 | 931.230 | R258 | -41 | 767.310 | 2 | 796 | 767.810 |
| L258 | -41 | 728.620 | 2 | 797 | 873.820 | R259 | -41 | 776.580 | 2 | 796 | 266.630 |
| L259 | -41 | 730.980 | 2 | 797 | 818.250 | R260 | -41 | 777.140 | 2 | 795 | 754.280 |
| L260 | -41 | 732.010 | 2 | 797 | 590.520 | R261 | -41 | 777.560 | 2 | 795 | 738.990 |
| L261 | -41 | 732.060 | 2 | 797 | 578.890 | R262 | -41 | 779.330 | 2 | 795 | 679.280 |
| L262 | -41 | 733.530 | 2 | 797 | 254.260 | R263 | -41 | 790.640 | 2 | 795 | 533.120 |
| L263 | -41 | 734.210 | 2 | 797 | 103.740 | R264 | -41 | 814.990 | 2 | 795 | 397.860 |
| L264 | -41 | 735.450 | 2 | 796 | 760.820 | R265 | -41 | 834.780 | 2 | 795 | 322.110 |
| L265 | -41 | 735.510 | 2 | 796 | 746.240 | R266 | -41 | 862.360 | 2 | 795 | 241.840 |
| L266 | -41 | 739.080 | 2 | 795 | 760.360 | R267 | -41 | 878.160 | 2 | 795 | 196.190 |
| L267 | -41 | 739.290 | 2 | 795 | 733.860 | R268 | -41 | 938.400 | 2 | 795 | 066.360 |
| L268 | -41 | 740.950 | 2 | 795 | 693.410 | R269 | -42 | 035.680 | 2 | 794 | 902.950 |
| L269 | -41 | 745.710 | 2 | 795 | 577.200 | R270 | -42 | 139.430 | 2 | 794 | 786.360 |
| L270 | -41 | 759.730 | 2 | 795 | 473.240 | R271 | -42 | 332.310 | 2 | 794 | 566.880 |
| L271 | -41 | 794.840 | 2 | 795 | 319.600 | R272 | -42 | 362.180 | 2 | 794 | 522.310 |
| L272 | -41 | 847.630 | 2 | 795 | 170.310 | R273 | -42 | 370.900 | 2 | 794 | 509.300 |
| L273 | -41 | 864.840 | 2 | 795 | 121.630 | R274 | -42 | 392.270 | 2 | 794 | 477.370 |
| L274 | -41 | 903.930 | 2 | 795 | 046.870 | R275 | -42 | 445.020 | 2 | 794 | 377.850 |
| L275 | -41 | 936.870 | 2 | 794 | 987.120 | R276 | -42 | 488.290 | 2 | 794 | 261.400 |
| L276 | -42 | 008.070 | 2 | 794 | 879.110 | R277 | -42 | 490.930 | 2 | 794 | 250.500 |
| L277 | -42 | 008.640 | 2 | 794 | 878.360 | R278 | -42 | 516.930 | 2 | 794 | 143.170 |
| L278 | -42 | 050.220 | 2 | 794 | 823.530 | R279 | -42 | 528.660 | 2 | 794 | 062.450 |
| L279 | -42 | 075.460 | 2 | 794 | 792.200 | R280 | -42 | 531.810 | 2 | 793 | 885.400 |
| L280 | -42 | 280.160 | 2 | 794 | 569.690 | R281 | -42 | 516.540 | 2 | 793 | 764.920 |
| L281 | -42 | 352.830 | 2 | 794 | 464.490 | R282 | -42 | 440.010 | 2 | 793 | 425.940 |
| L282 | -42 | 416.880 | 2 | 794 | 339.560 | R283 | -42 | 429.680 | 2 | 793 | 362.520 |
| L283 | -42 | 452.720 | 2 | 794 | 234.460 | R284 | -42 | 424.650 | 2 | 793 | 267.840 |
| L284 | -42 | 476.530 | 2 | 794 | 150.890 | R285 | -42 | 421.140 | 2 | 793 | 201.710 |
| L285 | -42 | 492.820 | 2 | 794 | 038.380 | R286 | -42 | 430.820 | 2 | 793 | 110.190 |
| L286 | -42 | 494.310 | 2 | 793 | 923.940 | R287 | -42 | 465.760 | 2 | 792 | 868.170 |
| L287 | -42 | 483.710 | 2 | 793 | 812.980 | R288 | -42 | 484.350 | 2 | 792 | 763.260 |
| L288 | -42 | 401.390 | 2 | 793 | 433.060 | R289 | -42 | 509.470 | 2 | 792 | 623.270 |
| L289 | -42 | 390.290 | 2 | 793 | 364.100 | R290 | -42 | 513.280 | 2 | 792 | 602.050 |
| L290 | -42 | 382.540 | 2 | 793 | 260.290 | R291 | -42 | 577.820 | 2 | 792 | 342.740 |
| L291 | -42 | 383.490 | 2 | 793 | 228.710 | R292 | -42 | 578.310 | 2 | 792 | 340.740 |
| L292 | -42 | 386.210 | 2 | 793 | 137.960 | R293 | -42 | 630.900 | 2 | 792 | 172.270 |
| L293 | -42 | 434.920 | 2 | 792 | 841.640 | R294 | -42 | 713.450 | 2 | 791 | 965.820 |
| L294 | -42 | 452.470 | 2 | 792 | 734.930 | R295 | -42 | 826.020 | 2 | 791 | 684.310 |
| L295 | -42 | 475.060 | 2 | 792 | 597.540 | R296 | -42 | 998.920 | 2 | 791 | 275.120 |
| L296 | -42 | 544.620 | 2 | 792 | 314.910 | R297 | -43 | 032.320 | 2 | 791 | 196.080 |
| L297 | -42 | 596.680 | 2 | 792 | 161.580 | R298 | -43 | 135.230 | 2 | 790 | 952.530 |
| L298 | -42 | 787.400 | 2 | 791 | 673.490 | R299 | -43 | 331.100 | 2 | 790 | 596.090 |
| L299 | -42 | 817.090 | 2 | 791 | 597.610 | R300 | -43 | 364.150 | 2 | 790 | 507.780 |
| L300 | -42 | 911.580 | 2 | 791 | 356.120 | R301 | -43 | 393.680 | 2 | 790 | 370.830 |
| L301 | -42 | 956.310 | 2 | 791 | 242.360 | R302 | -43 | 400.630 | 2 | 790 | 284.830 |
| L302 | -42 | 956.720 | 2 | 791 | 241.440 | R303 | -43 | 404.020 | 2 | 790 | 237.450 |
| L303 | -43 | 049.850 | 2 | 791 | 033.070 | R304 | -43 | 398.100 | 2 | 790 | 159.840 |

| | | | | |
|-------|----|-----|----|---------|
| Vel | 19 | Van | 20 | P712/08 |
| Sheet | | of | | |

| PADRESERWE KOÖRDINATE / ROAD RESERVE CO-ORDINATES | | | | | |
|---|-------------|-------|----------------------------|------|---------------------------|
| LINKERKANT/LEFT HAND SIDE | | | REGTERKANT/RIGHT HAND SIDE | | |
| | Y | X | WG 29° | Y | X |
| L304 | -43 099.450 | 2 790 | 931.980 | R305 | -43 388.110 2 790 109.260 |
| L305 | -43 295.320 | 2 790 | 578.170 | R306 | -43 362.260 2 790 021.100 |
| L306 | -43 333.740 | 2 790 | 472.530 | R307 | -43 361.960 2 790 020.100 |
| L307 | -43 353.370 | 2 790 | 363.840 | R308 | -43 327.820 2 789 928.550 |
| L308 | -43 363.030 | 2 790 | 252.460 | R309 | -43 283.480 2 789 843.940 |
| L309 | -43 349.560 | 2 790 | 108.670 | R310 | -43 224.270 2 789 758.520 |
| L310 | -43 300.310 | 2 789 | 960.870 | R311 | -43 143.300 2 789 669.920 |
| L311 | -43 218.830 | 2 789 | 813.850 | R312 | -43 141.390 2 789 668.310 |
| L312 | -43 143.240 | 2 789 | 723.560 | R313 | -43 065.930 2 789 604.500 |
| L313 | -43 077.020 | 2 789 | 662.910 | R314 | -43 009.240 2 789 565.800 |
| L314 | -42 972.960 | 2 789 | 595.940 | R315 | -42 796.800 2 789 462.870 |
| L315 | -42 827.450 | 2 789 | 524.360 | R316 | -42 554.700 2 789 345.580 |
| L316 | -42 557.590 | 2 789 | 391.620 | R317 | -42 443.070 2 789 274.190 |
| L317 | -42 433.890 | 2 789 | 314.570 | R318 | -42 384.080 2 789 236.460 |
| L318 | -42 360.500 | 2 789 | 268.870 | R319 | -42 365.030 2 789 220.770 |
| L319 | -42 332.560 | 2 789 | 244.090 | R320 | -42 336.790 2 789 194.680 |
| L320 | -42 290.470 | 2 789 | 203.700 | R321 | -42 303.240 2 789 163.670 |
| L321 | -42 245.220 | 2 789 | 160.280 | R322 | -42 227.280 2 789 077.580 |
| L322 | -42 208.460 | 2 789 | 120.330 | R323 | -42 160.170 2 788 983.720 |
| L323 | -42 126.180 | 2 789 | 004.950 | R324 | -42 112.010 2 788 894.700 |
| L324 | -42 068.490 | 2 788 | 898.330 | R325 | -42 054.600 2 788 757.600 |
| L325 | -41 608.060 | 2 787 | 701.690 | R326 | -41 666.150 2 787 765.040 |
| L326 | -41 596.520 | 2 787 | 671.630 | R327 | -41 643.170 2 787 701.730 |
| L327 | -41 183.240 | 2 786 | 522.680 | R328 | -41 632.260 2 787 671.680 |
| | | | | R329 | -41 478.860 2 787 249.040 |
| | | | | R330 | -41 292.300 2 786 765.660 |
| | | | | R331 | -41 195.100 2 786 519.210 |
| | | | | R332 | -41 186.620 2 786 497.700 |

| | | | | |
|-------|----|-----|----|---------|
| Vel | 20 | Van | 20 | P712/08 |
| Sheet | | of | | |

Printed by and obtainable from the Government Printer, Bosman Street, Private Bag X85, Pretoria, 0001
Publications: Tel: (012) 334-4508, 334-4509, 334-4510
Advertisements: Tel: (012) 334-4673, 334-4674, 334-4504
Subscriptions: Tel: (012) 334-4735, 334-4736, 334-4737
Cape Town Branch: Tel: (021) 465-7531