

---

## GOVERNMENT NOTICE

---

### DEPARTMENT OF TRANSPORT

No. 565

22 May 2009

## THE SOUTH AFRICAN NATIONAL ROADS AGENCY LIMITED

Registration No: 98/09584/06

---

### DECLARATION AMENDMENT OF NATIONAL ROAD N2 SECTION 33

#### AMENDMENT OF DECLARATION No. 726 OF 2005

By virtue of section 40(1)(b) of the South African National Roads Agency Limited and the National Roads Act, 1998 (Act No. 7 of 1998), I hereby amend Declaration No. 726 of 2005, by substituting paragraph (II) of the annexure thereof, with the subjoined sheets 1 to 13 of Plan No. P708/08.

**(National Road N2 Section 33: KwaZulu Natal/Mpumalanga Provincial Border – Piet Retief)**

  
\_\_\_\_\_  
MINISTER OF TRANSPORT

## GOEWERMENSKENNISGEWING

---

### DEPARTEMENT VAN VERVOER

No. 565

22 Mei 2009

## DIE SUID-AFRIKAANSE NASIONALE PADAGENTSKAP BEPERK

Registrasie No: 98/09584/06

---

### VERKLARING WYSIGING VAN NASIONALE PAD N2 SEKSIE 33.

WYSIGING VAN VERKLARING NO. 726 VAN 2005

Kragtens Artikel 40(1)(b) van die Suid-Afrikaanse Nasionale Padagentskap Beperk en die Nasionale Paaie Wet, 1998 (Wet no.7 van 1998), wysig ek hiermee Verklaring no. 726 van 2005, deur paragraaf (II) van die skedule daarvan, te vervang met meegaande velle 1 tot 13 van Plan no. P708/08.

**(Nasionale Pad N2 Seksie 33: KwaZulu Natal/Mpumalanga Provinsiale Grens – Piet Retief)**



**MINISTER VAN VERVOER**

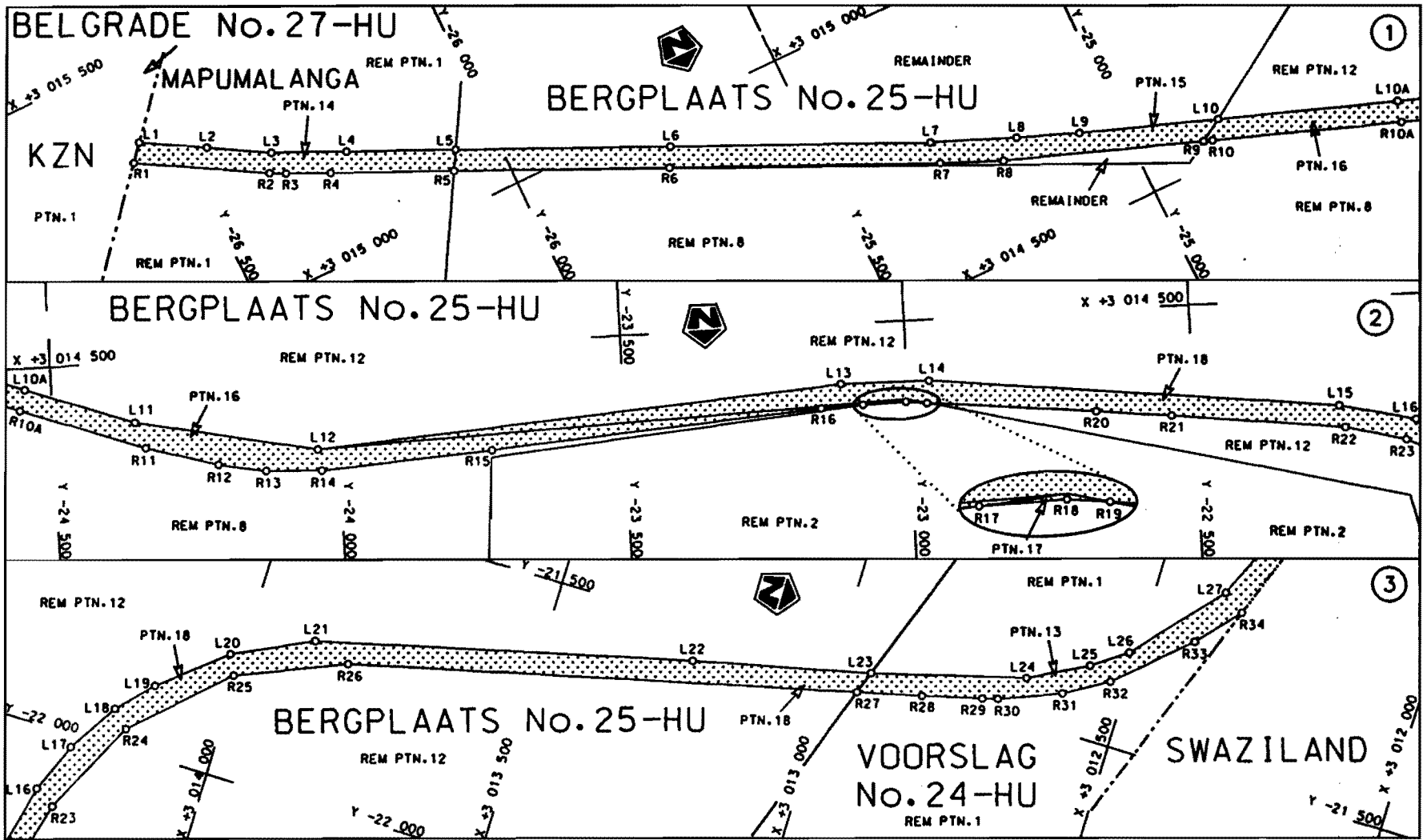

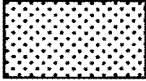
Die Suid Afrikaanse Nasionale Padagentskap Beperk The South African National Roads Agency Limited	Die figuur getoon The figure shown	 steldie padreserwe voor van 'n gedeelte represents the road reserve of a portion van Nasionale Roete of National Route N2 Seksie Section 33	Vel Sheet 1 van of 13 Plan P708/08
--	---------------------------------------	--	---------------------------------------

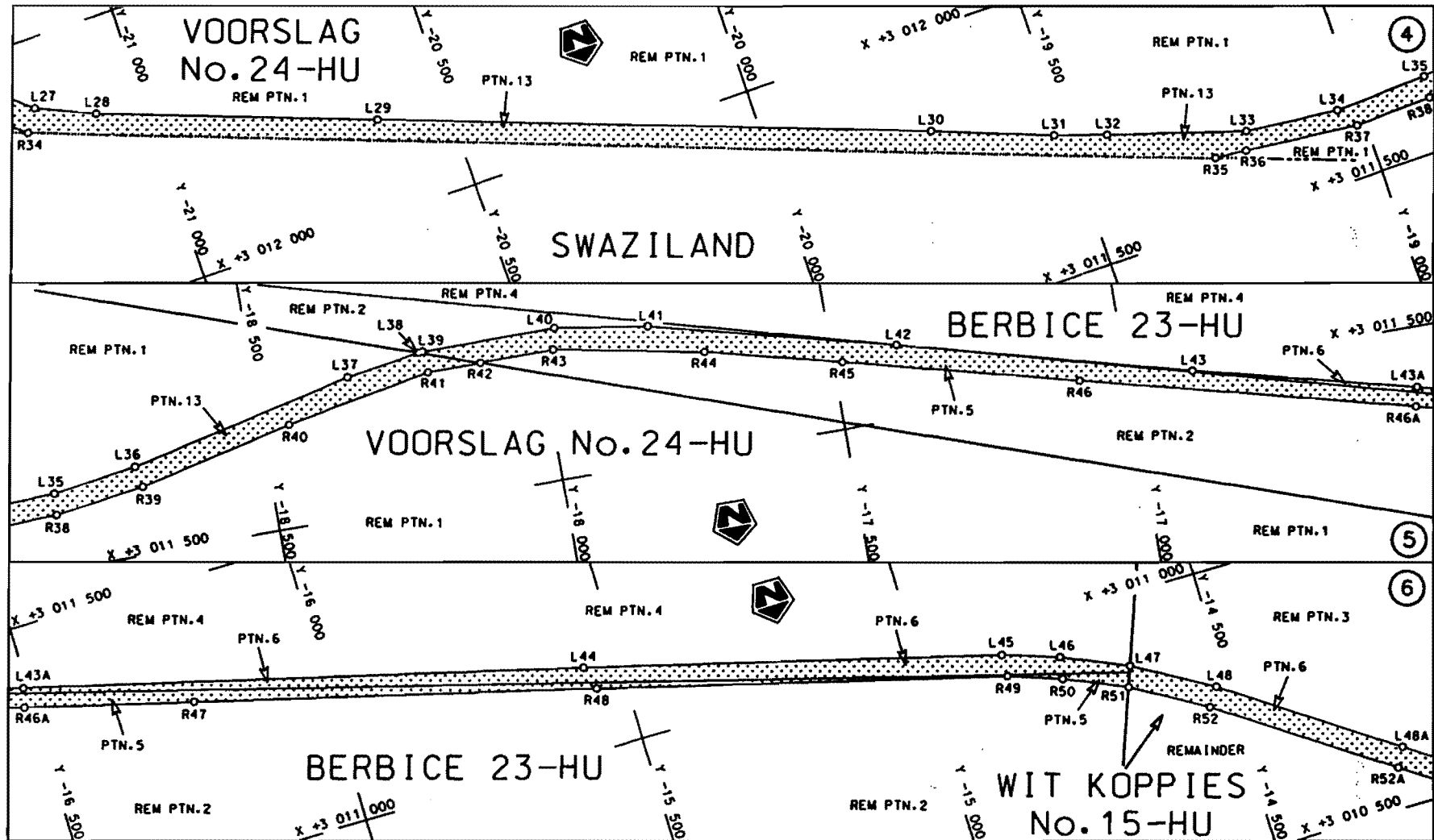

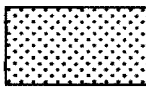
<p>Die Suid Afrikaanse Nasionale Padogentskap Beperk The South African National Roads Agency Limited</p>	<p>Die figuur getoon The figure shown</p> 	<p>steldie padreserwe voor van 'n gedeelte represents the road reserve of a portion van Nasionale Roete of National Route</p> <p>N2      Seksie             Section</p> <p>33</p>	<p>Vel Sheet 2 von of 13</p> <p>Plan P708/08</p>
--	---	---	--

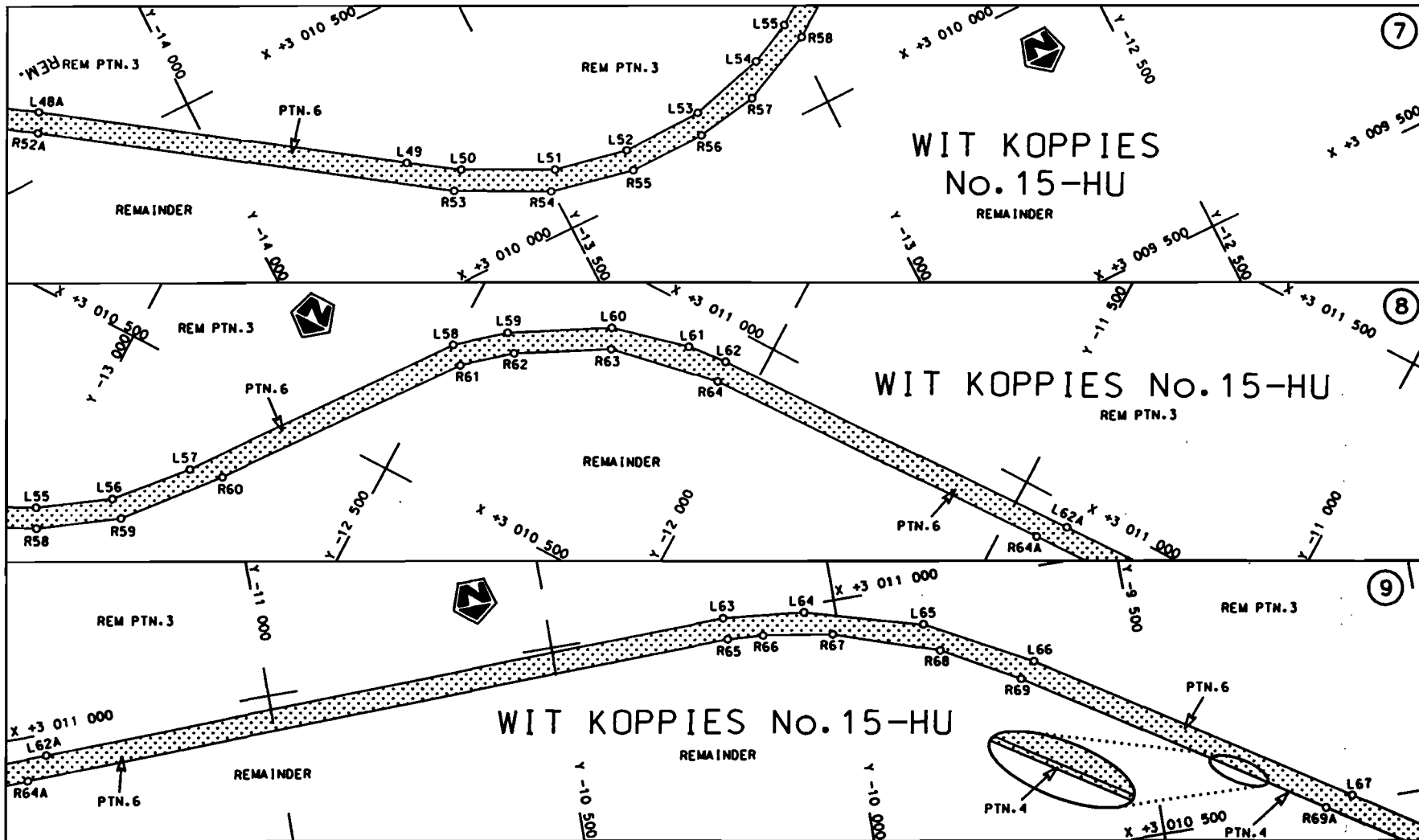

Die Suid Afrikaanse Nasionale Padogenskop Beperk  
 The South African National Roads Agency Limited

Die figuur getoon  
 The figure shown

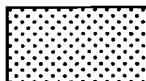

stiedie padreserwe voor van 'n gedeelte  
 represents the road reserve of a portion  
 van Nasionale Roete  
 of National Route

N2

Seksie  
 Section

33

Vel  
 Sheet

3 van  
 of 13

Plan  
 P708/08

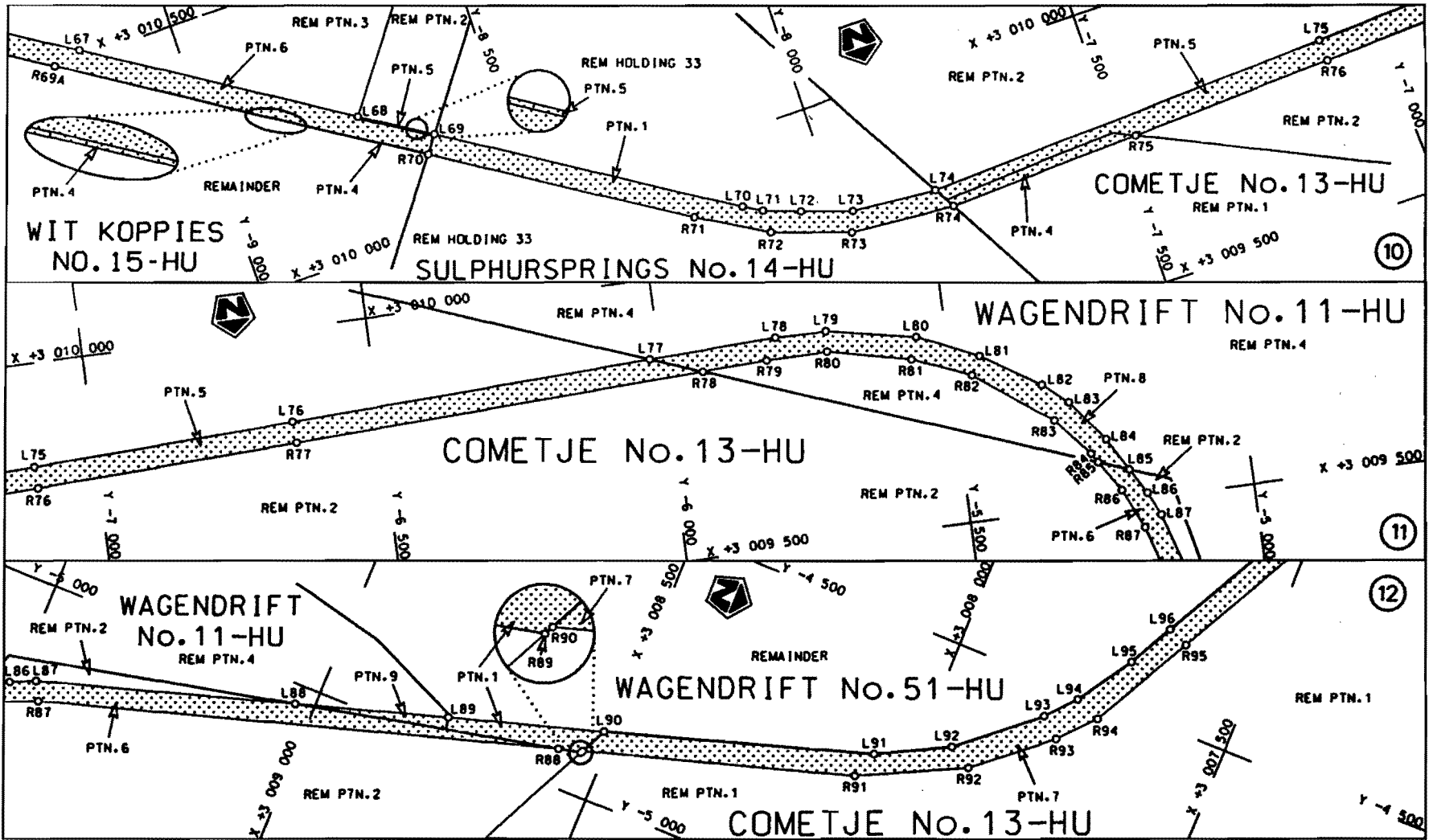

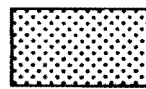
<p>Die Suid Afrikaanse Nasionale Padagentskap Beperk The South African National Roads Agency Limited</p>	<p>Die figuur getoon The figure shown</p> 	<p>steldie padreserwe voor van 'n gedeelte represents the road reserve of a portion van Nasionale Roete of National Route</p> <p>N2</p> <p>Seksie Section</p> <p>33</p>	<p>Vel Sheet</p> <p>4 van of 13</p> <p>Plan P708/08</p>
--	---	---	---

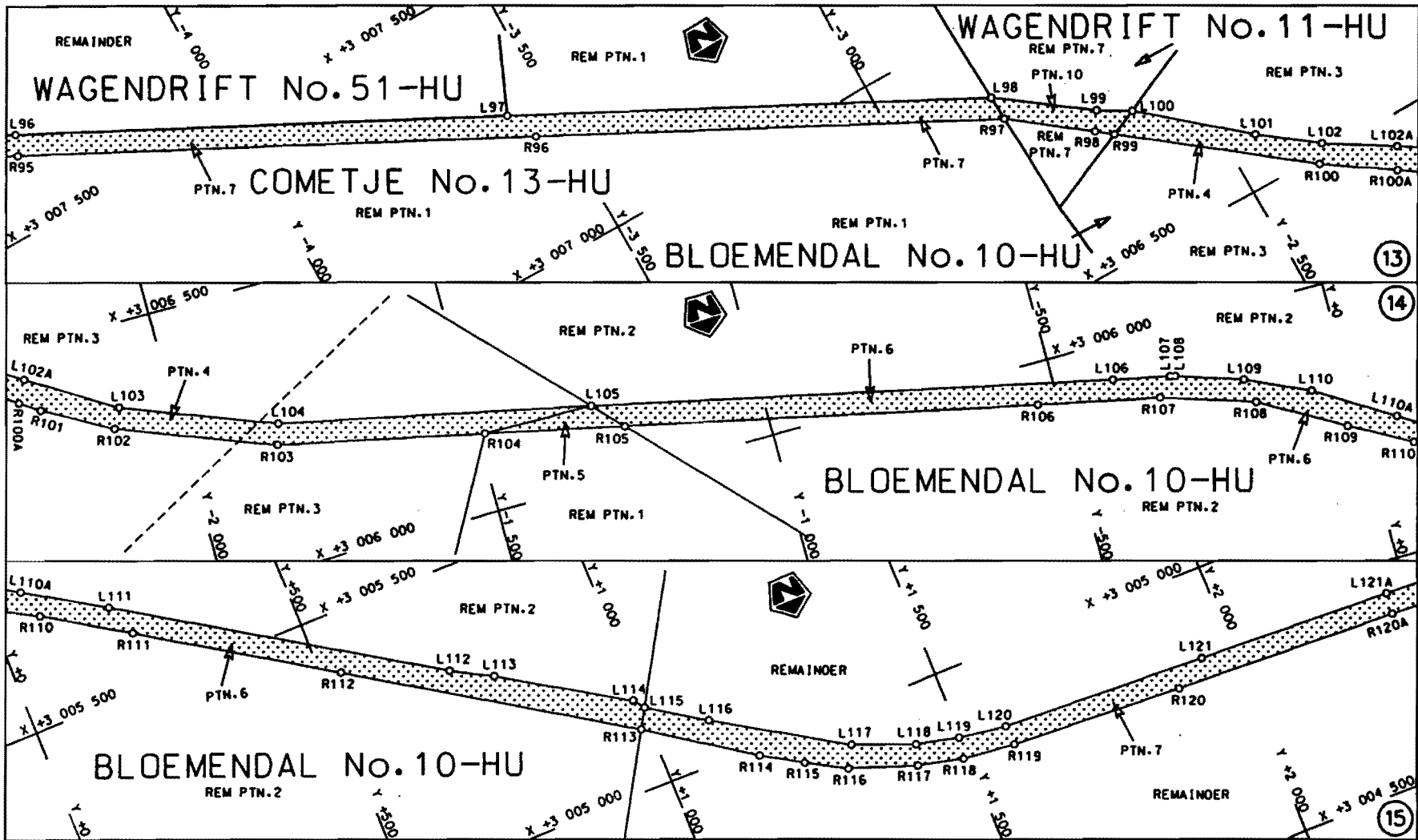

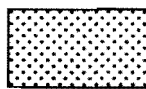
<p>Die Suid Afrikaanse Nasionale Padogenskop Beprek The South African National Roads Agency Limited</p>	<p>Die figuur getoon The figure shown</p> 	<p>steldie padreserwe voor van 'n gedeelte represents the road reserve of a portion van Nasionale Roete N2 Seksie 33 of National Route N2 Section 33</p>	<p>Vel 5 van Sheet 5 of 13 Plan P708/08</p>
---	---	--	---

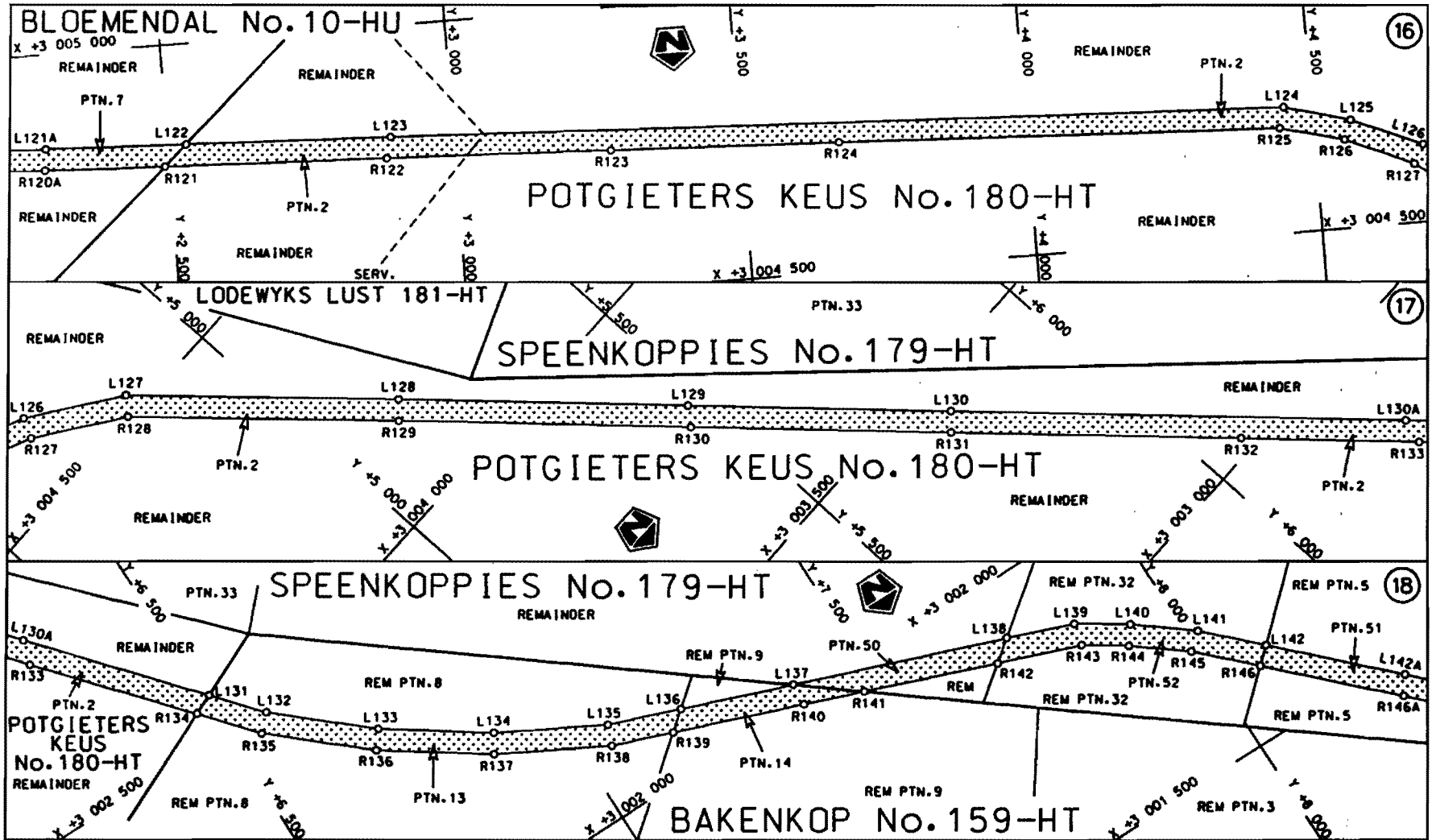

<p>Die Suid Afrikaanse Nasionale Padogentskap Beperk The South African National Roads Agency Limited</p>	<p>Die figuur getoon The figure shown</p>		<p>steldie padreserwe voor van 'n gedeelte represents the road reserve of a portion van Nasionale Roete N2 Sektie 33 of National Route Section</p>	<p>Vel Sheet 6 van 13 Plan P708/08</p>
--	---	--	--	--



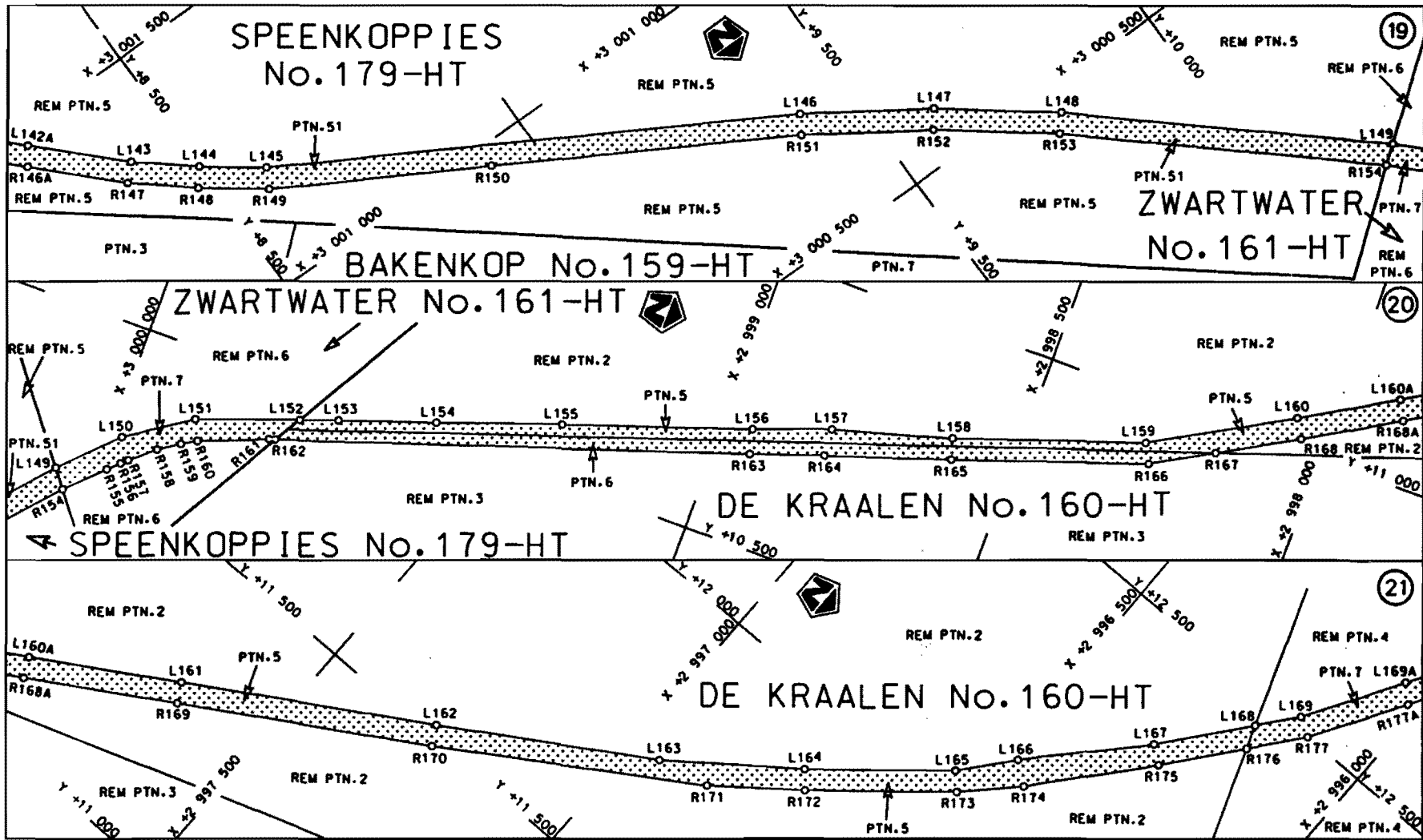

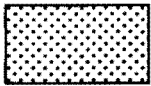
Die Suid Afrikaanse Nasionale Padagentskap Beperk The South African National Roads Agency Limited	Die figuur getoon The figure shown	 steldie padreserwe voor van 'n gedeelte represents the road reserve of a portion van Nasionale Roete of National Route N2 Seksie Section 33	Vel Sheet 7 of 13 Plan P708/08
--	---------------------------------------	--	-----------------------------------

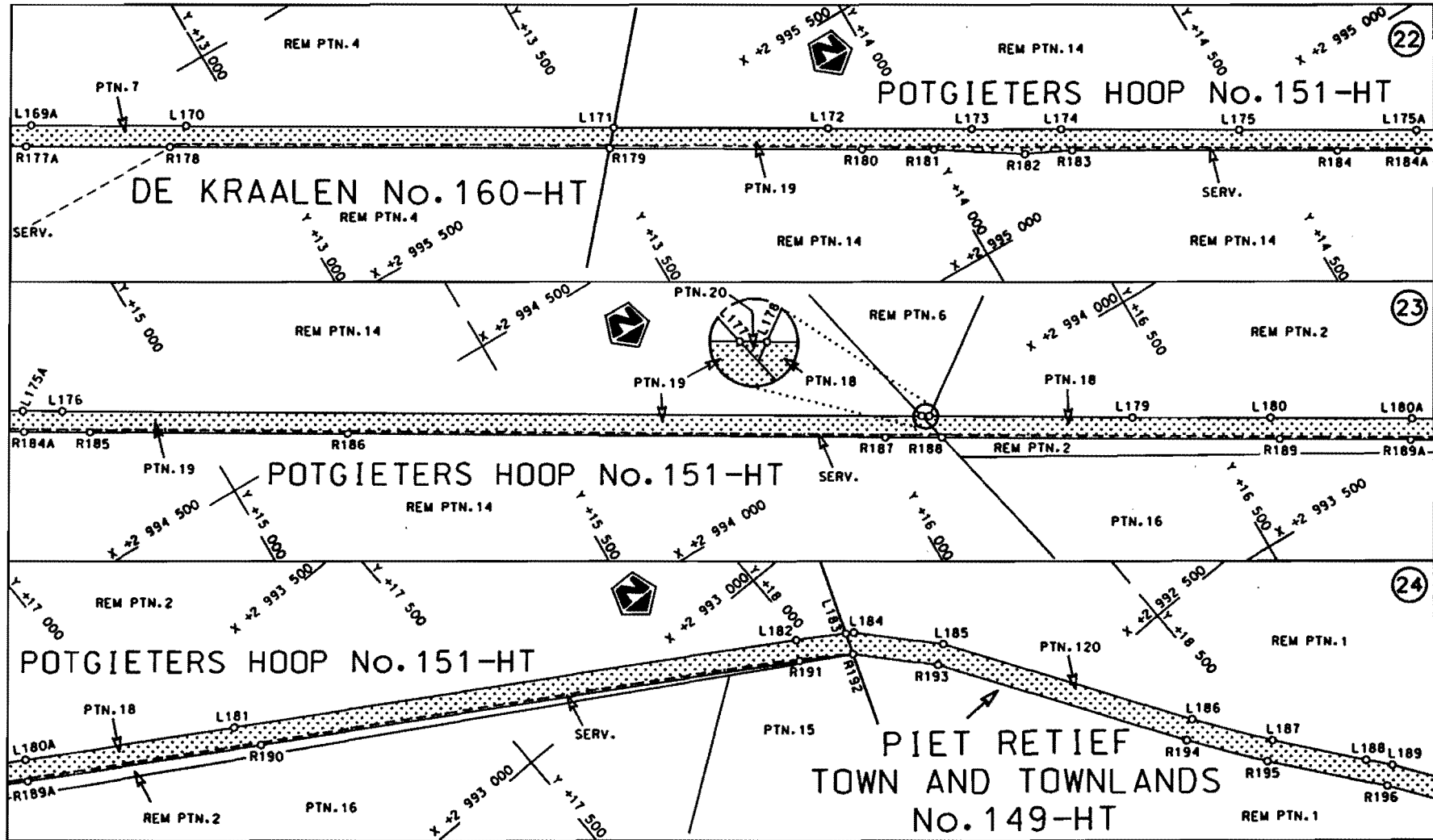

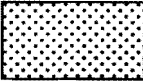
<p>Die Suid Afrikaanse Nasionale Padagentskop Beperk The South African National Roads Agency Limited</p>	<p>Die figuur getoon The figure shown</p> 	<p>stetige padreserwe voor van 'n gedeelte represents the road reserve of a portion van Nasionale Roete N2 of National Route</p> <p>Seksie 33 Section</p>	<p>Vel Sheet 8 van 13 of Plan P708/08</p>
--	---	---	---

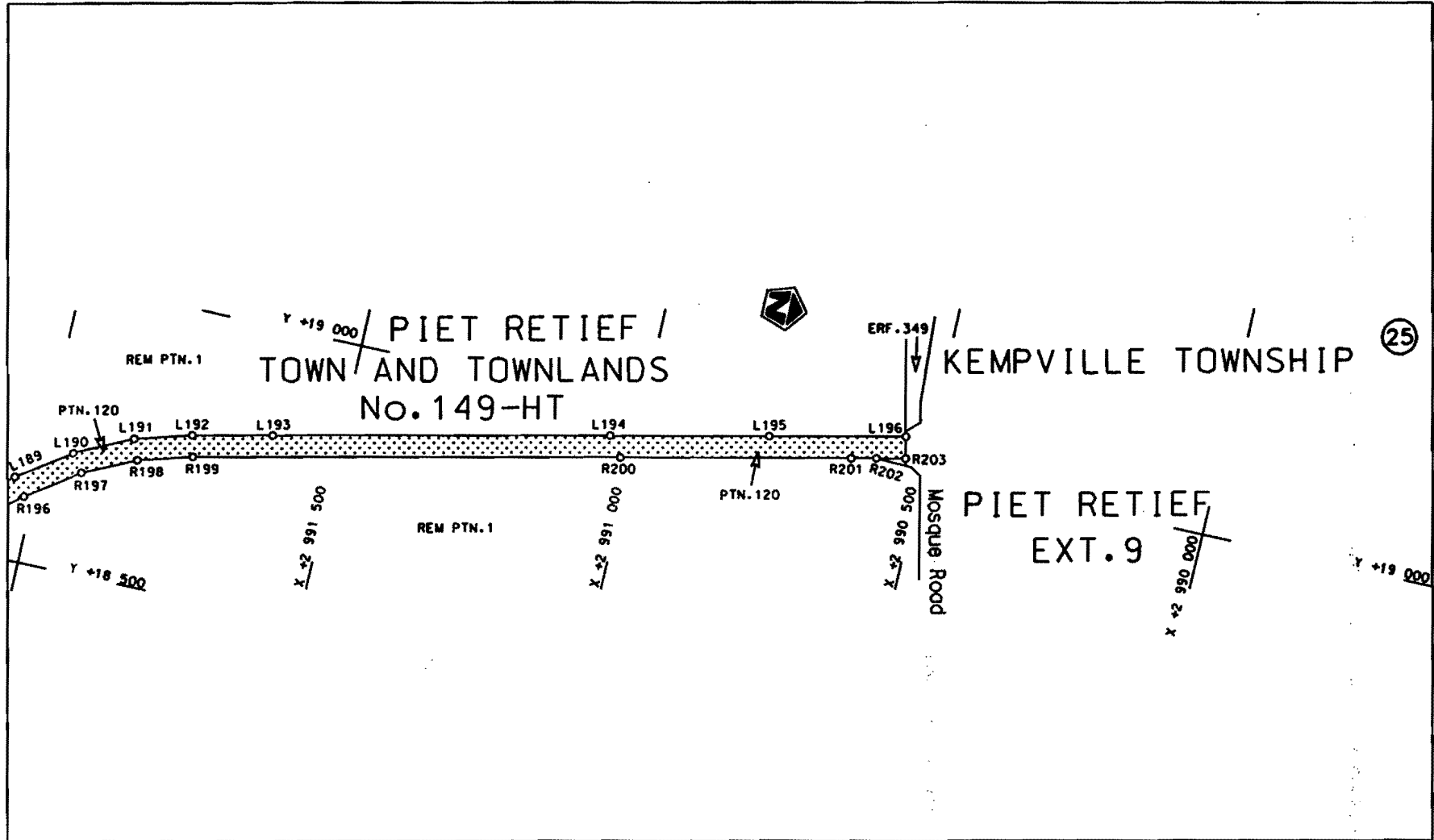

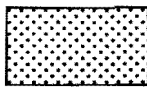
Die Suid Afrikaanse Nasionale Padogentskap Beperk The South African National Roads Agency Limited	Die figuur getoon The figure shown		steldie padreserwe voor van 'n gedeelte represents the road reserve of a portion van Nasionale Roete of National Route N2 Seksie Section 33	Vel Sheet 9 van of 13 Plan P708/08
--	---------------------------------------	---	---	---------------------------------------

PADRESERWE KOÖRDINATE / ROAD RESERVE CO-ORDINATES									
LINKERKANT/LEFT HAND SIDE				REGTERKANT/RIGHT HAND SIDE					
				WG 31°	Y	X			
L1	-26	567.06	3 015	354.57	R1	-26	591.62	3 015	325.60
L2	-26	463.34	3 015	293.84	R2	-26	382.75	3 015	204.80
L3	-26	363.97	3 015	236.06	R3	-26	357.43	3 015	190.92
L4	-26	245.09	3 015	180.57	R4	-26	286.86	3 015	158.14
L5	-26	072.69	3 015	100.53	R5	-26	091.53	3 015	067.90
L6	-25	731.53	3 014	942.10	R6	-25	749.13	3 014	908.89
L7	-25	316.71	3 014	750.35	R7	-25	317.66	3 014	709.70
L8	-25	176.53	3 014	692.69	R8	-25	215.08	3 014	665.60
L9	-25	073.58	3 014	652.12	R9	-24	884.04	3 014	544.30
L10	-24	844.28	3 014	569.55	R10	-24	869.52	3 014	538.98
L11	-24	357.13	3 014	393.66	R11	-24	340.99	3 014	347.70
L12	-24	037.82	3 014	328.22	R12	-24	213.12	3 014	310.97
L13	-23	116.00	3 014	393.37	R13	-24	129.45	3 014	295.87
L14	-22	962.50	3 014	391.62	R14	-24	032.40	3 014	290.60
L15	-22	245.77	3 014	309.47	R15	-23	734.42	3 014	310.21
L16	-22	109.14	3 014	277.46	R16	-23	152.85	3 014	353.06
L17	-22	023.29	3 014	241.65	R17	-23	078.60	3 014	354.66
L18	-21	936.85	3 014	187.43	R18	-23	003.70	3 014	356.28
L19	-21	877.28	3 014	132.53	R19	-22	967.65	3 014	352.51
L20	-21	785.89	3 014	019.78	R20	-22	671.42	3 014	321.53
L21	-21	721.28	3 013	883.96	R21	-22	539.90	3 014	306.49
L22	-21	564.84	3 013	241.89	R22	-22	237.36	3 014	270.44
L23	-21	495.00	3 012	934.00	R23	-22	130.93	3 014	242.79
L24	-21	425.00	3 012	671.95	R24	-21	965.09	3 014	159.10
L25	-21	372.46	3 012	570.91	R25	-21	820.23	3 014	003.25
L26	-21	330.71	3 012	512.66	R26	-21	743.41	3 013	817.32
L27	-21	181.28	3 012	380.78	R27	-21	534.28	3 012	947.96
L28	-21	083.47	3 012	337.21	R28	-21	507.83	3 012	838.00
L29	-20	622.59	3 012	164.40	R29	-21	482.62	3 012	735.94
L30	-19	719.41	3 011	827.92	R30	-21	475.22	3 012	709.45
L31	-19	518.66	3 011	750.08	R31	-21	433.55	3 012	602.98
L32	-19	431.53	3 011	720.47	R32	-21	389.03	3 012	528.86
L33	-19	201.42	3 011	646.31	R33	-21	279.72	3 012	407.91
L34	-19	038.06	3 011	628.64	R34	-21	206.87	3 012	343.60
L35	-18	875.54	3 011	633.95	R35	-19	266.97	3 011	619.05
L36	-18	730.53	3 011	655.82	R36	-19	213.07	3 011	613.22
L37	-18	336.50	3 011	744.25	R37	-19	014.46	3 011	592.15
L38	-18	209.14	3 011	764.95	R38	-18	878.53	3 011	596.21
L39	-18	205.99	3 011	765.47	R39	-18	723.12	3 011	618.84
L40	-17	968.16	3 011	765.65	R40	-18	452.24	3 011	680.22
L41	-17	807.94	3 011	739.68	R41	-18	199.03	3 011	728.02
L42	-17	386.39	3 011	630.41	R42	-18	106.23	3 011	728.32
L43	-16	887.46	3 011	493.13	R43	-17	976.78	3 011	728.74
L44	-15	562.95	3 011	147.64	R44	-17	719.38	3 011	678.07
L45	-14	859.72	3 010	960.27	R45	-17	484.19	3 011	617.79
L46	-14	763.36	3 010	927.01	R46	-17	083.42	3 011	511.27
L47	-14	651.15	3 010	877.10	R47	-16	230.66	3 011	285.49
L48	-14	518.59	3 010	798.99	R48	-15	551.63	3 011	106.15
L49	-13	705.45	3 010	234.03	R49	-14	860.57	3 010	921.05
L50	-13	625.92	3 010	180.74	R50	-14	769.52	3 010	889.02
L51	-13	479.65	3 010	106.45	R51	-14	664.22	3 010	842.07

Vel  
Sheet

10

Van  
of

13

P708/08

PADRESERWE KOÖRDINATE / ROAD RESERVE CO-ORDINATES							
LINKERKANT/LEFT HAND SIDE				REGTERKANT/RIGHT HAND SIDE			
				WG 31°	Y	X	
L52	-13	353.24	3 010 081.02	R52	-14	539.27	3 010 767.87
L53	-13	212.71	3 010 084.48	R53	-13	653.33	3 010 152.60
L54	-13	081.11	3 010 119.58	R54	-13	502.52	3 010 075.07
L55	-13	008.09	3 010 154.90	R55	-13	358.45	3 010 044.33
L56	-12	898.15	3 010 230.32	R56	-13	225.09	3 010 045.70
L57	-12	802.30	3 010 339.52	R57	-13	116.12	3 010 064.92
L58	-12	497.87	3 010 747.15	R58	-12	990.19	3 010 122.59
L59	-12	423.12	3 010 809.71	R59	-12	868.75	3 010 207.04
L60	-12	267.11	3 010 902.23	R60	-12	744.61	3 010 354.72
L61	-12	133.09	3 010 935.63	R61	-12	470.55	3 010 721.10
L62	-12	063.95	3 010 941.66	R62	-12	396.34	3 010 783.07
L63	-10	197.19	3 011 001.07	R63	-12	250.65	3 010 868.50
L64	-10	055.26	3 010 987.73	R64	-12	059.90	3 010 904.66
L65	-9	854.06	3 010 932.16	R65	-10	195.07	3 010 963.16
L66	-9	674.16	3 010 836.05	R66	-10	132.70	3 010 959.76
L67	-9	164.22	3 010 512.07	R67	-10	011.42	3 010 941.66
L68	-8	740.69	3 010 242.31	R68	-9	832.82	3 010 882.17
L69	-8	624.99	3 010 168.77	R69	-9	701.33	3 010 809.37
L70	-8	156.88	3 009 870.59	R70	-8	647.36	3 010 138.24
L71	-8	125.86	3 009 852.29	R71	-8	243.02	3 009 880.69
L72	-8	063.28	3 009 829.50	R72	-8	125.10	3 009 811.10
L73	-7	976.87	3 009 800.16	R73	-7	990.63	3 009 764.05
L74	-7	829.66	3 009 788.69	R74	-7	808.87	3 009 751.35
L75	-7	107.19	3 009 817.68	R75	-7	465.64	3 009 765.20
L76	-6	650.56	3 009 835.81	R76	-7	105.60	3 009 779.73
L77	-6	017.61	3 009 860.92	R77	-6	647.78	3 009 798.20
L78	-5	795.40	3 009 869.74	R78	-5	928.80	3 009 827.23
L79	-5	705.98	3 009 868.68	R79	-5	815.77	3 009 831.80
L80	-5	551.73	3 009 838.04	R80	-5	708.25	3 009 832.52
L81	-5	446.19	3 009 789.47	R81	-5	564.69	3 009 799.53
L82	-5	344.09	3 009 723.80	R82	-5	463.70	3 009 757.39
L83	-5	300.83	3 009 686.81	R83	-5	330.65	3 009 658.24
L84	-5	245.44	3 009 613.35	R84	-5	274.66	3 009 591.89
L85	-5	212.13	3 009 555.38	R85	-5	264.18	3 009 575.12
L86	-5	186.15	3 009 510.17	R86	-5	230.11	3 009 520.65
L87	-5	166.91	3 009 468.14	R87	-5	198.41	3 009 451.05
L88	-5	034.22	3 009 033.97	R88	-4	933.86	3 008 577.90
L89	-4	955.99	3 008 777.98	R89	-4	925.35	3 008 539.23
L90	-4	876.45	3 008 515.63	R90	-4	921.59	3 008 537.42
L91	-4	735.03	3 008 064.93	R91	-4	783.29	3 008 081.13
L92	-4	672.81	3 007 944.68	R92	-4	695.72	3 007 903.97
L93	-4	561.95	3 007 814.25	R93	-4	590.72	3 007 779.66
L94	-4	512.50	3 007 771.08	R94	-4	531.28	3 007 726.28
L95	-4	415.47	3 007 709.19	R95	-4	352.66	3 007 632.51
L96	-4	337.23	3 007 667.45	R96	-3	545.49	3 007 210.83
L97	-3	571.40	3 007 268.46	R97	-2	815.20	3 006 830.64
L98	-2	816.84	3 006 873.95	R98	-2	687.36	3 006 731.56
L99	-2	666.66	3 006 763.20	R99	-2	660.28	3 006 710.11
L100	-2	612.01	3 006 731.33	R100	-2	375.06	3 006 486.32
L101	-2	446.17	3 006 588.08	R101	-2	227.07	3 006 386.19
L102	-2	353.26	3 006 516.99	R102	-2	110.84	3 006 320.31

Vel	11	Van	13	P708/08
Sheet		of		

PADRESERWE KOÖRDINATE / ROAD RESERVE CO-ORDINATES									
LINKERKANT/LEFT HAND SIDE				REGTERKANT/RIGHT HAND SIDE					
				WG 31°	Y	X			
L103	-2	093.76	3 006	354.22	R103	-1 843.32	3 006	215.87	
L104	-1	831.67	3 006	251.99	R104	-1 487.09	3 006	137.60	
L105	-1	293.89	3 006	134.59	R105	-1 246.43	3 006	084.23	
L106	-	397.55	3 005	934.17	R106	-	536.84	3 005	926.85
L107	-	298.86	3 005	913.24	R107	-	325.85	3 005	881.53
L108	-	290.63	3 005	911.09	R108	-	165.90	3 005	829.18
L109	-	176.14	3 005	873.11	R109	-	22.56	3 005	746.06
L110	-	66.75	3 005	822.44	R110		81.96	3 005	687.82
L111		199.23	3 005	656.23	R111		221.17	3 005	598.43
L112		711.75	3 005	327.47	R112		534.55	3 005	395.78
L113		780.53	3 005	288.81	R113		984.94	3 005	104.53
L114		990.64	3 005	156.90	R114	1	160.08	3 004	984.29
L115	1	004.81	3 005	137.97	R115	1	228.55	3 004	942.54
L116	1	100.61	3 005	074.63	R116	1	296.95	3 004	904.04
L117	1	317.60	3 004	940.85	R117	1	411.98	3 004	863.17
L118	1	423.18	3 004	899.28	R118	1	491.25	3 004	843.79
L119	1	497.88	3 004	881.06	R119	1	582.63	3 004	833.48
L120	1	580.75	3 004	868.42	R120	1	887.50	3 004	815.57
L121	1	944.29	3 004	850.14	R121	2	492.42	3 004	785.87
L122	2	532.21	3 004	821.86	R122	2	881.95	3 004	766.75
L123	2	891.46	3 004	804.04	R123	3	272.34	3 004	747.80
L124	4	449.62	3 004	724.41	R124	3	670.78	3 004	728.50
L125	4	565.23	3 004	692.57	R125	4	439.85	3 004	687.94
L126	4	688.34	3 004	637.38	R126	4	551.88	3 004	657.38
L127	4	836.81	3 004	531.08	R127	4	670.62	3 004	604.10
L128	5	148.75	3 004	169.82	R128	4	811.14	3 004	503.01
L129	5	475.90	3 003	785.60	R129	5	121.18	3 004	144.11
L130	5	774.27	3 003	435.06	R130	5	451.27	3 003	756.25
L131	6	508.66	3 002	572.60	R131	5	746.57	3 003	409.50
L132	6	576.53	3 002	492.79	R132	6	074.24	3 003	024.70
L133	6	726.65	3 002	361.32	R133	6	275.86	3 002	787.54
L134	6	890.53	3 002	246.64	R134	6	473.09	3 002	556.28
L135	7	065.73	3 002	150.26	R135	6	550.03	3 002	466.06
L136	7	187.61	3 002	104.56	R136	6	703.59	3 002	331.49
L137	7	375.06	3 002	034.26	R137	6	870.92	3 002	214.40
L138	7	732.20	3 001	900.79	R138	7	051.66	3 002	115.38
L139	7	844.55	3 001	857.99	R139	7	153.84	3 002	077.02
L140	7	926.21	3 001	803.82	R140	7	371.96	3 001	995.14
L141	8	018.83	3 001	729.63	R141	7	473.51	3 001	956.52
L142	8	104.35	3 001	644.29	R142	7	695.04	3 001	872.29
L143	8	409.60	3 001	339.70	R143	7	835.03	3 001	819.06
L144	8	500.80	3 001	262.38	R144	7	903.91	3 001	773.13
L145	8	594.81	3 001	191.21	R145	7	990.04	3 001	705.17
L146	9	405.83	3 000	722.01	R146	8	076.35	3 001	619.00
L147	9	602.01	3 000	591.70	R147	8	382.91	3 001	312.96
L148	9	778.29	3 000	454.85	R148	8	477.15	3 001	232.90
L149	10	216.17	3 000	069.46	R149	8	576.25	3 001	157.87
L150	10	307.09	2 999	979.74	R150	8	914.92	3 000	962.37
L151	10	380.69	2 999	870.17	R151	9	385.90	3 000	689.89
L152	10	443.09	2 999	698.12	R152	9	579.98	3 000	560.98
L153	10	466.26	2 999	634.23	R153	9	754.18	3 000	425.75

Vel  
Sheet12 Van  
of 13

P708/08

PADRESERWE KOÖRDINATE / ROAD RESERVE CO-ORDINATES							
LINKERKANT/LEFT HAND SIDE			REGTERKANT/RIGHT HAND SIDE				
	Y	X	WG 31°		Y	X	
L154	10	521.29	2 999 472.34	R154	10	184.93	3 000 045.13
L155	10	594.86	2 999 265.04	R155	10	244.79	2 999 984.89
L156	10	702.47	2 998 949.90	R156	10	263.08	2 999 965.77
L157	10	750.87	2 998 819.07	R157	10	272.78	2 999 954.97
L158	10	809.65	2 998 614.81	R158	10	307.17	2 999 913.80
L159	10	920.55	2 998 295.01	R159	10	330.94	2 999 878.33
L160	11	052.67	2 998 062.31	R160	10	345.97	2 999 852.82
L161	11	287.35	2 997 672.16	R161	10	392.63	2 999 733.51
L162	11	520.90	2 997 284.11	R162	10	395.26	2 999 725.67
L163	11	728.57	2 996 947.90	R163	10	659.60	2 998 939.07
L164	11	881.40	2 996 745.32	R164	10	702.61	2 998 815.28
L165	12	052.45	2 996 542.41	R165	10	773.67	2 998 603.80
L166	12	138.14	2 996 472.42	R166	10	886.99	2 998 277.62
L167	12	314.18	2 996 309.07	R167	10	945.66	2 998 174.15
L168	12	454.88	2 996 196.50	R168	11	020.05	2 998 043.24
L169	12	518.10	2 996 145.91	R169	11	254.43	2 997 653.60
L170	12	914.76	2 995 908.55	R170	11	487.55	2 997 265.91
L171	13	554.16	2 995 525.80	R171	11	748.06	2 996 855.44
L172	13	874.27	2 995 334.34	R172	11	853.47	2 996 720.60
L173	14	089.18	2 995 205.69	R173	12	025.66	2 996 515.94
L174	14	222.83	2 995 125.72	R174	12	109.17	2 996 434.06
L175	14	488.07	2 994 966.91	R175	12	291.55	2 996 278.87
L176	14	812.84	2 994 772.60	R176	12	413.93	2 996 181.40
L177	16	096.76	2 994 005.31	R177	12	498.75	2 996 113.83
L178	16	108.04	2 993 998.55	R178	12	871.68	2 995 890.41
L179	16	410.92	2 993 816.92	R179	13	529.28	2 995 497.24
L180	16	616.75	2 993 693.82	R180	13	906.79	2 995 271.53
L181	17	142.72	2 993 379.07	R181	14	013.69	2 995 207.17
L182	17	990.42	2 992 871.90	R182	14	145.93	2 995 120.14
L183	18	064.82	2 992 824.43	R183	14	220.39	2 995 083.31
L184	18	076.68	2 992 816.87	R184	14	616.23	2 994 846.80
L185	18	182.73	2 992 701.55	R185	14	835.76	2 994 716.00
L186	18	429.83	2 992 322.41	R186	15	221.76	2 994 484.92
L187	18	512.00	2 992 204.65	R187	16	023.15	2 994 005.21
L188	18	615.39	2 992 074.50	R188	16	107.81	2 993 954.51
L189	18	644.59	2 992 037.85	R189	16	611.47	2 993 652.90
L190	18	707.11	2 991 948.15	R190	17	158.65	2 993 325.72
L191	18	754.48	2 991 850.88	R191	17	971.61	2 992 839.46
L192	18	782.94	2 991 753.85	R192	18	051.49	2 992 788.46
L193	18	813.77	2 991 616.02	R193	18	152.31	2 992 678.82
L194	18	941.65	2 991 044.39	R194	18	398.97	2 992 300.63
L195	19	001.54	2 990 774.35	R195	18	481.69	2 992 182.07
L196	19	053.90	2 990 541.22	R196	18	614.29	2 992 015.25
				R197	18	676.12	2 991 926.55
				R198	18	719.10	2 991 837.28
				R199	18	746.34	2 991 744.40
				R200	18	908.43	2 991 018.55
				R201	18	995.92	2 990 625.16
				R202	19	005.63	2 990 582.39
				R203	19	016.63	2 990 532.93

Vel	13	Van	13	P708/08
Sheet		of		