

---

**GOVERNMENT NOTICE  
GOEWERMENSKENNISGEWING**

---

**DEPARTMENT OF TRANSPORT  
DEPARTEMENT VAN VERVOER**

**No. 1099**

**14 October 2008**

**THE SOUTH AFRICAN NATIONAL ROADS  
AGENCY LIMITED**

Registration No: 98/09584/06

**DECLARATION AMENDMENT OF NATIONAL ROAD N2 SECTION 26**

AMENDMENT OF DECLARATION NO. 202 OF 1991

By virtue of section 40 (1)(b) of the South African National Roads Agency Limited and the National Roads Act, 1998 (Act No. 7 of 1998), I hereby amend Declaration No. 202 of 1991 by substituting sheets 1 and 6 thereof, with the subjoined sheets 1A and 6A of Plan No. P356/90.

**(National Road N2 Section 26: Mt Edgecombe - Tongaat)**

  
\_\_\_\_\_  
**MINISTER OF TRANSPORT**

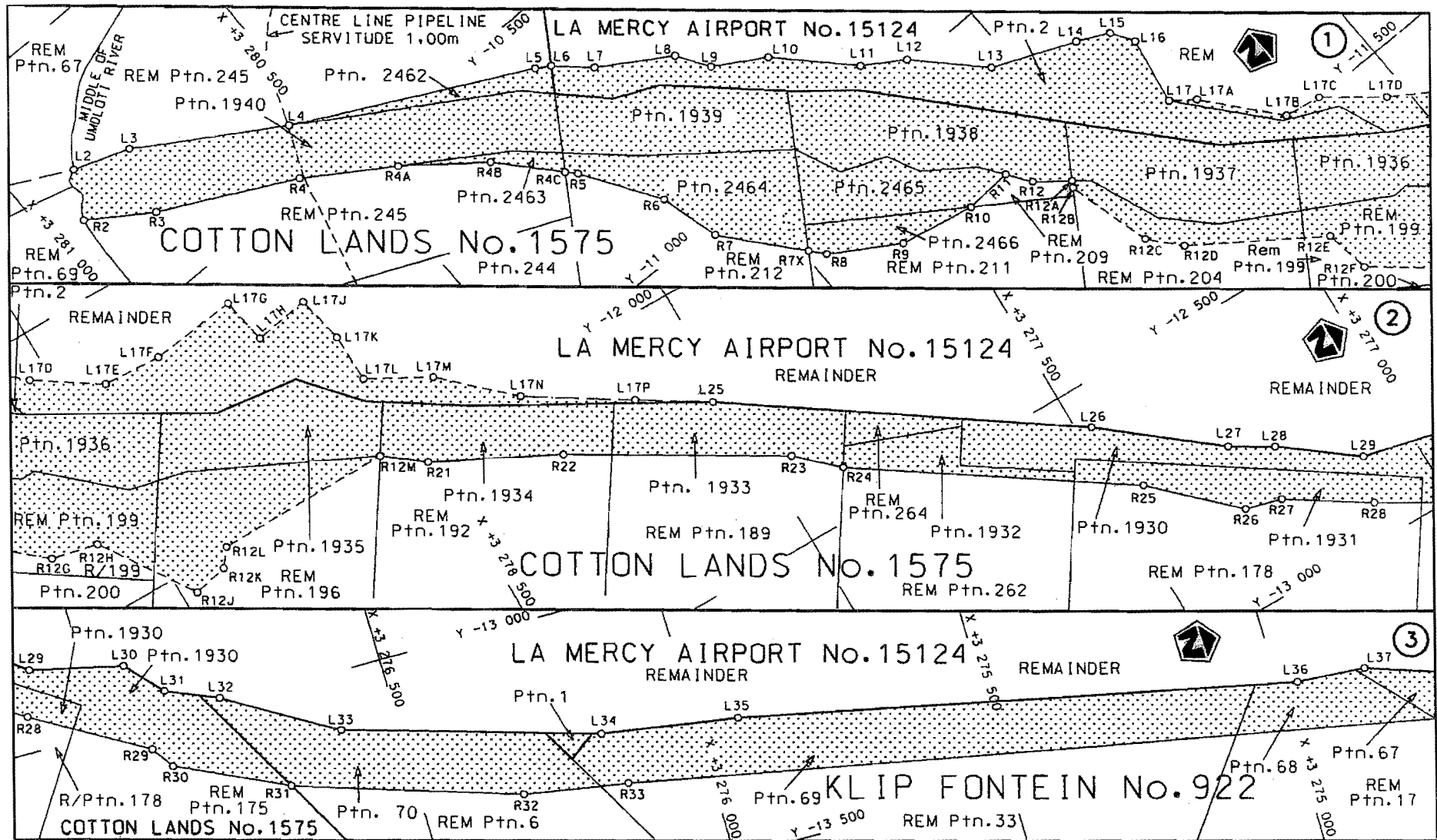

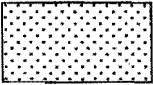
Die Suid Afrikaanse Nasionale Padagentskap Beperk The South African National Roads Agency Limited	Die figuur getoon The figure shown	 steldie padreserwe voor van 'n gedeelte represents the road reserve of a portion van Nasionale Roete N2 Seksie of National Route Section 26	Vel Sheet 1A van of 8
			Plan P356/90

PADRESERWE KOÖRDINATE				ROAD RESERVE CO-ORDINATES			
LINKERKANT/LEFT HAND SIDE				REGTERKANT/RIGHT HAND SIDE			
Lo 31°				Y X			
L2	-10	221.76	3 280 888.27	R2	-10	301.63	3 280 932.42
L3	-10	254.46	3 280 790.33	R3	-10	369.55	3 280 826.57
L4	-10	397.82	3 280 548.33	R4	-10	481.72	3 280 594.66
L5	-10	591.55	3 280 152.08	R4A	-10	572.32	3 280 448.14
L6	-10	606.74	3 280 127.62	R4B	-10	668.67	3 280 318.98
L7	-10	656.14	3 280 070.69	R4C	-10	765.78	3 280 228.86
L8	-10	729.42	3 279 948.77	R5	-10	782.35	3 280 213.47
L9	-10	783.49	3 279 912.88	R6	-10	912.47	3 280 126.77
L10	-10	834.20	3 279 824.45	R7	-11	016.72	3 280 098.57
L11	-10	947.93	3 279 708.52	R7X	-11	141.98	3 279 990.49
L12	-11	011.88	3 279 639.07	R8	-11	166.65	3 279 969.24
L13	-11	094.59	3 279 534.62	R9	-11	141.98	3 279 990.49
L14	-11	154.97	3 279 589.90	R10	-11	102.69	3 279 965.07
L15	-11	181.10	3 279 333.74	R11	-11	255.58	3 279 636.80
L16	-11	220.12	3 279 309.84	R12	-11	295.96	3 279 608.04
L17	-11	338.38	3 279 331.08	R12A	-11	338.65	3 279 553.66
L17A	-11	367.61	3 279 292.32	R12B	-11	349.07	3 279 560.42
L17B	-11	453.43	3 279 213.23	R12C	-11	499.51	3 279 520.75
L17C	-11	497.20	3 279 116.98	R12D	-11	552.55	3 279 475.70
L17D	-11	553.81	3 279 044.65	R12E	-11	705.44	3 279 277.50
L17E	-11	624.61	3 278 917.30	R12F	-11	785.53	3 279 267.44
L17F	-11	652.86	3 278 846.82	R12G	-11	879.01	3 279 156.38
L17G	-11	631.67	3 278 667.15	R12H	-11	886.44	3 279 082.02
L17H	-11	712.13	3 278 650.20	R12J	-12	040.93	3 278 974.04
L17J	-11	694.39	3 278 552.17	R12K	-12	027.29	3 278 912.07
L17K	-11	777.07	3 278 533.92	R12L	-11	982.06	3 278 876.23
L17L	-11	853.96	3 278 531.77	R12M	-11	992.64	3 278 575.79
L17M	-11	920.30	3 278 425.56	R21	-12	043.17	3 278 509.60
L17N	-12	025.39	3 278 309.67	R22	-12	150.82	3 278 296.90
L17P	-12	131.49	3 278 139.95	R23	-12	352.35	3 277 954.29
L25	-12	202.20	3 278 024.94	R24	-12	415.99	3 277 886.58
L26	-12	572.86	3 277 474.39	R25	-12	707.03	3 277 448.93
L27	-12	722.41	3 277 286.32	R26	-12	833.16	3 277 317.45
L28	-12	763.71	3 277 216.30	R27	-12	849.65	3 277 254.50
L29	-12	856.76	3 277 091.48	R28	-12	936.98	3 277 117.72
L30	-12	892.89	3 276 931.47	R29	-13	049.32	3 276 924.91
L31	-12	955.10	3 276 876.43	R30	-13	087.37	3 276 898.50
L32	-12	992.95	3 276 786.17	R31	-13	174.86	3 276 709.14
L33	-13	103.20	3 276 598.65	R32	-13	296.66	3 276 323.48
L34	-13	230.12	3 276 163.74	R33	-13	326.32	3 276 142.66
L35	-13	265.11	3 275 926.50	R34	-13	601.34	3 274 708.56
L36	-13	464.71	3 274 966.99	R35	-13	630.62	3 274 653.18
L37	-13	472.25	3 274 846.16	R36	-13	674.80	3 274 540.74
L38	-13	517.02	3 274 712.30	R37	-13	667.99	3 274 418.19
L39	-13	531.73	3 274 531.11	R38	-13	729.64	3 274 292.17
L40	-13	592.75	3 274 357.95	R39	-13	779.29	3 274 144.84
L41	-13	601.85	3 274 255.30	R40	-13	780.92	3 274 118.56
L42	-13	550.96	3 274 239.06	R41	-13	802.78	3 273 987.38
L43	-13	614.12	3 274 041.06				

Vel 6A Van 8  
Sheet of

P356/90