**GOVERNMENT NOTICE
GOEWERMENSKENNISGEWING**

**DEPARTMENT OF TRANSPORT
DEPARTEMENT VAN VERVOER**

No. 318

25 March 2008

**THE SOUTH AFRICAN NATIONAL ROADS
AGENCY LIMITED**

Registration No: 98/09584/06

DECLARATION AMENDMENT OF NATIONAL ROAD N2 SECTION 4

AMENDMENT OF DECLARATION NO. 543 OF 2003

By virtue of section 40 (1)(b) of the South African National Roads Agency Limited and the National Roads Act, 1998 (Act No. 7 of 1998), I hereby amend Declaration No. 543 of 2003 by substituting the section of the descriptive declaration from Riviersonderend up to Swellendam, with the subjoined sheets 1 to 27 of Plan No. P638/08.

(National Road N2 Section 4: Riviersonderend – Swellendam)



MINISTER OF TRANSPORT

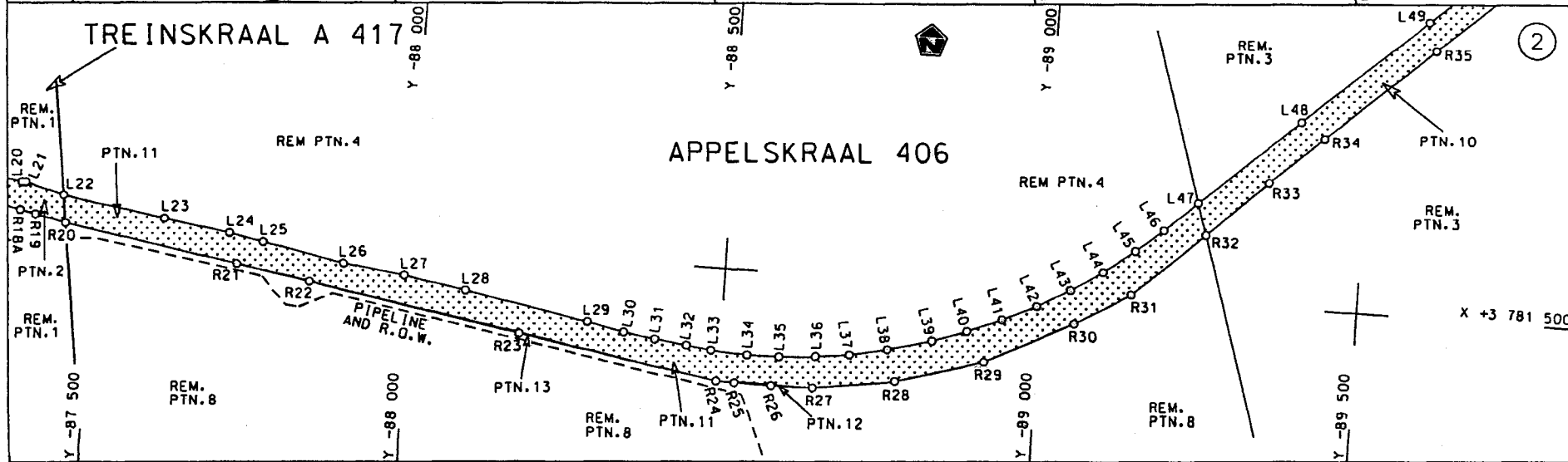
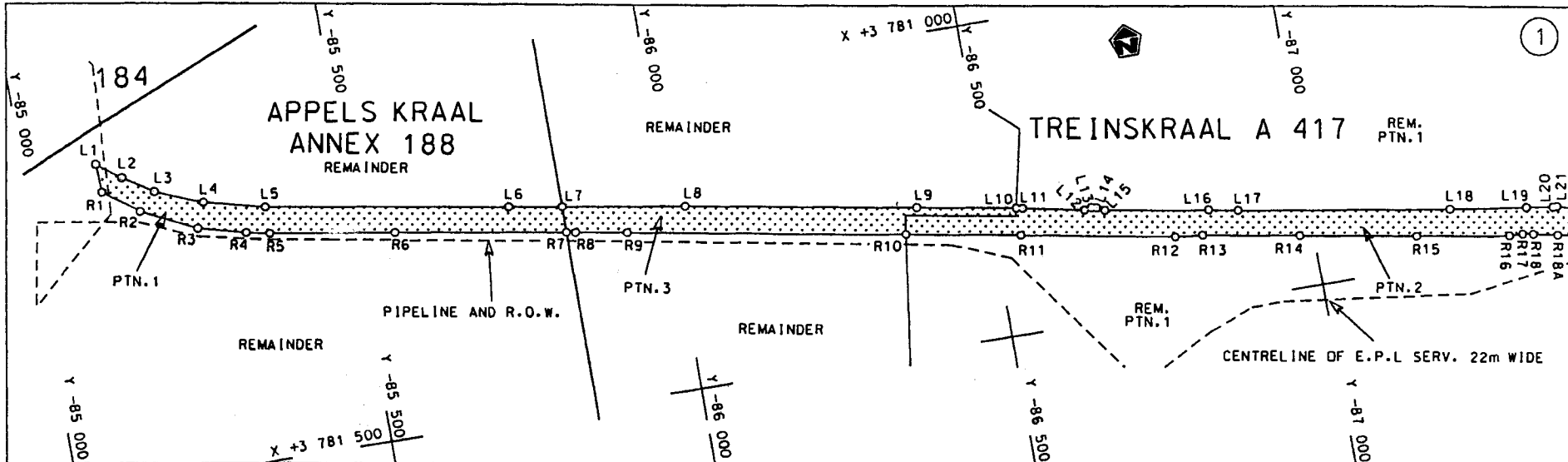

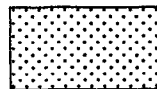
<p>Die Suid Afrikaanse Nasionale Padogenskap Beperk The South African National Roads Agency Limited</p>	<p>Die figuur getoon The figure shown</p> 	<p>steldie padreserwe voor van 'n gedeelte represents the road reserve of a portion van Nasionale Roete N2 Seksie of National Route 4</p>	<p>Vel Sheet 1 van 27 Plan P638/08</p>
---	--	---	--

D.O.9.A

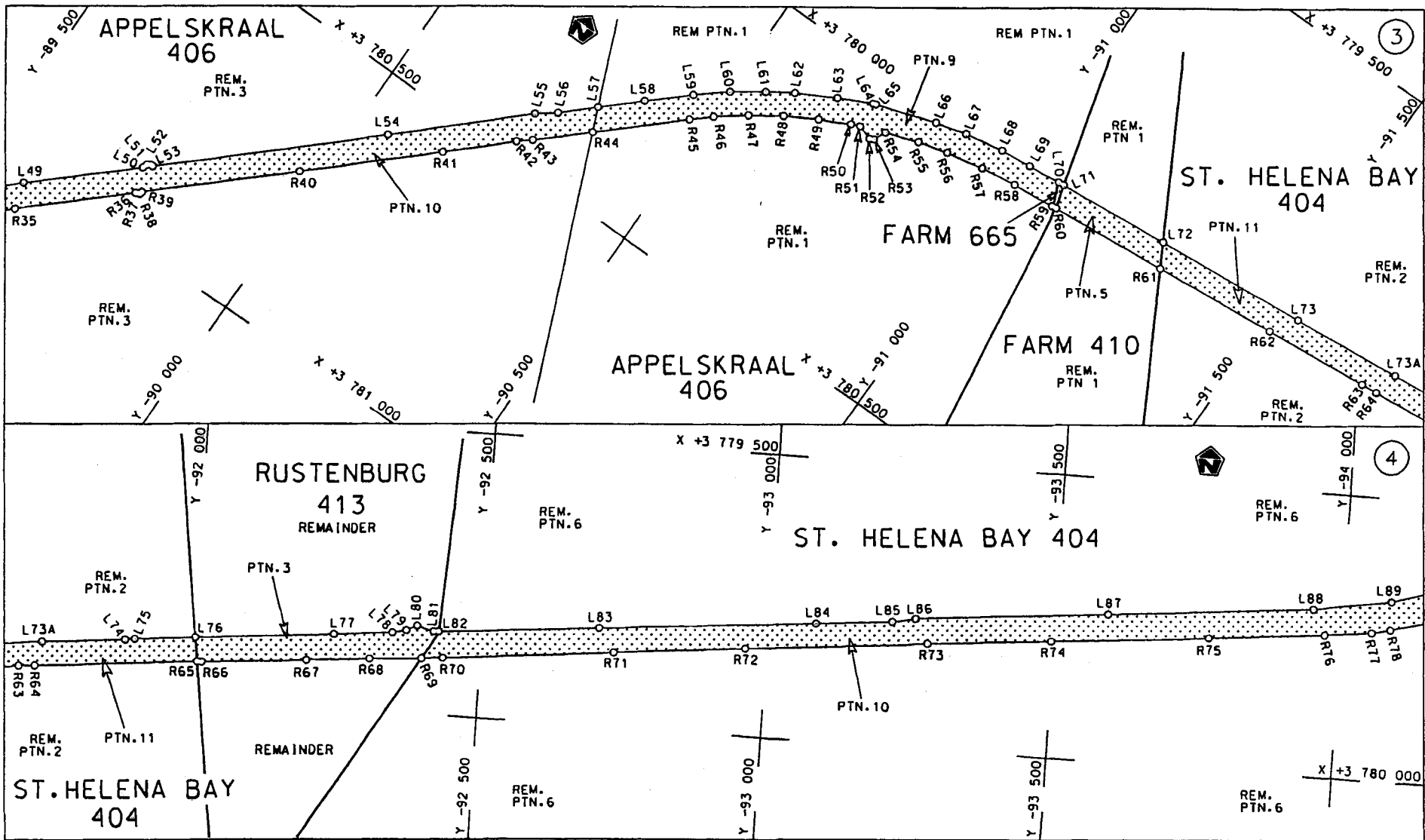

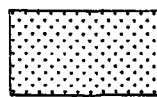
<p>Die Suid Afrikaanse Nasionale Padagentskap Beperk The South African National Roads Agency Limited</p>	<p>Die figuur getoon The figure shown</p> 	<p>steldie padreserwe voor van 'n gedeelte represents the road reserve of a portion van Nasionale Roete N2 Seksie of National Route N2 Section 4</p>	<p>Vel Sheet 2 van of 27 Plan P638/08</p>
--	--	--	---

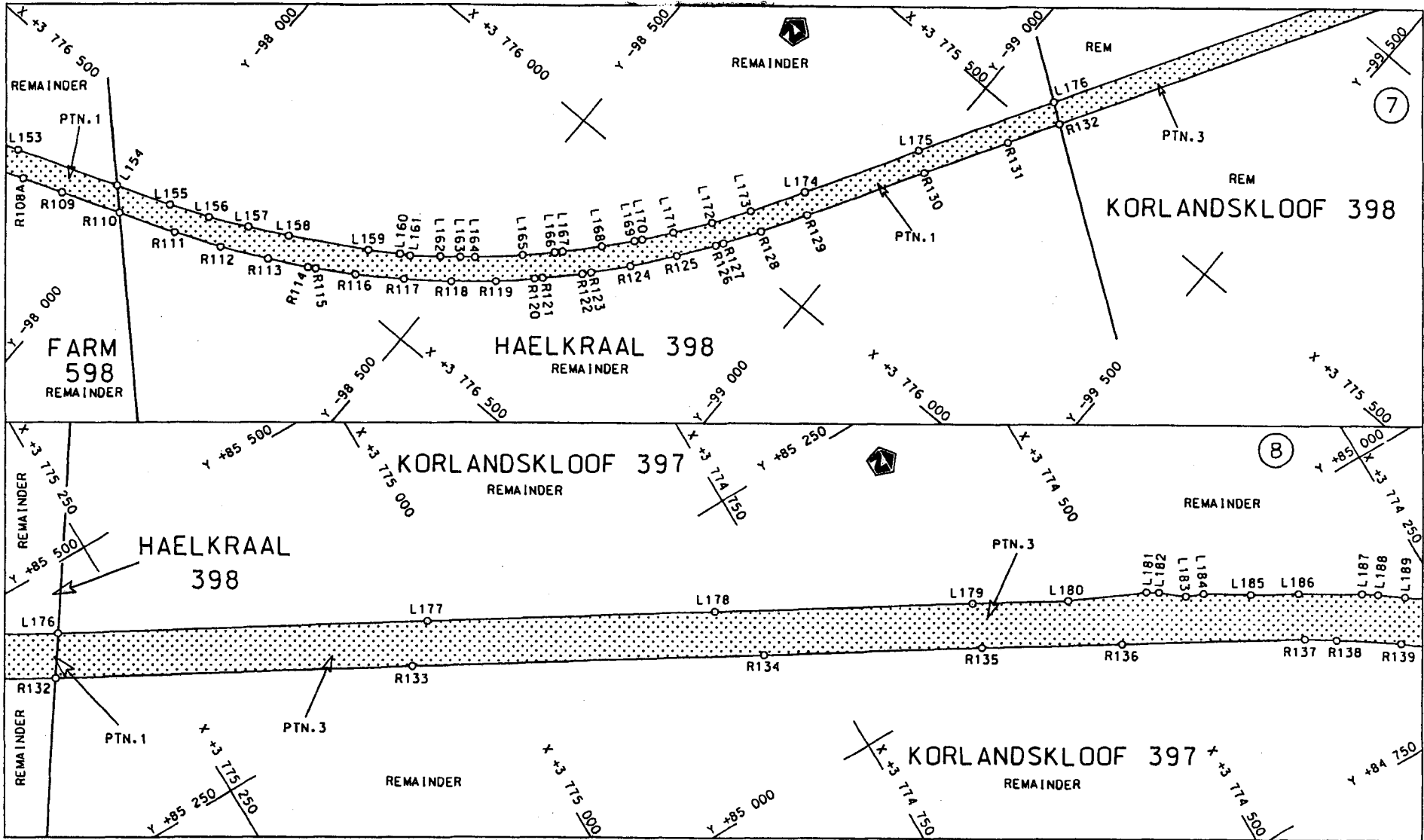

<p>Die Suid Afrikaanse Nasionale Padagentskap Beperk The South African National Roads Agency Limited</p>	<p>Die figuur getoon The figure shown</p>	<p>steldie padreserwe voor van 'n gedeelte represents the road reserve of a portion van Nasionale Roete N2 of National Route N2</p>	<p>Vel Sheet 4 van of 27 Plan P638/08</p>
--	---	---	---

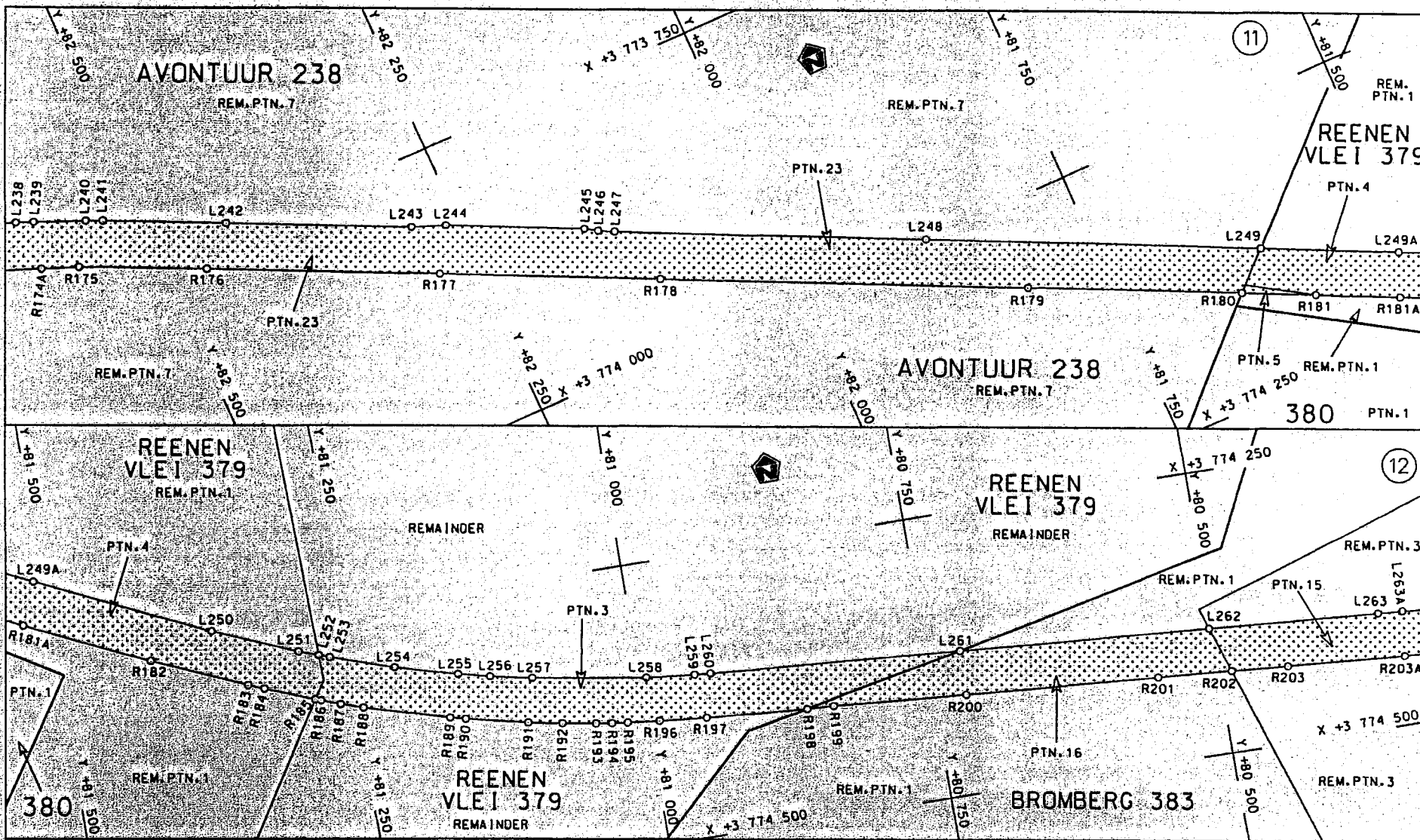

Die Suid-Afrikaanse Nasionale Padagentskap Beperk
The South African National Roads Agency Limited

Die figuur getoon
The figure shown



steldie padreserwe voor van 'n gedeelte
represents the road reserve of a portion
van Nasionale Roete N2
of National Route N2

Seksie 4
Section 4

Vel Sheet 6 van of 27
Plan P638/08

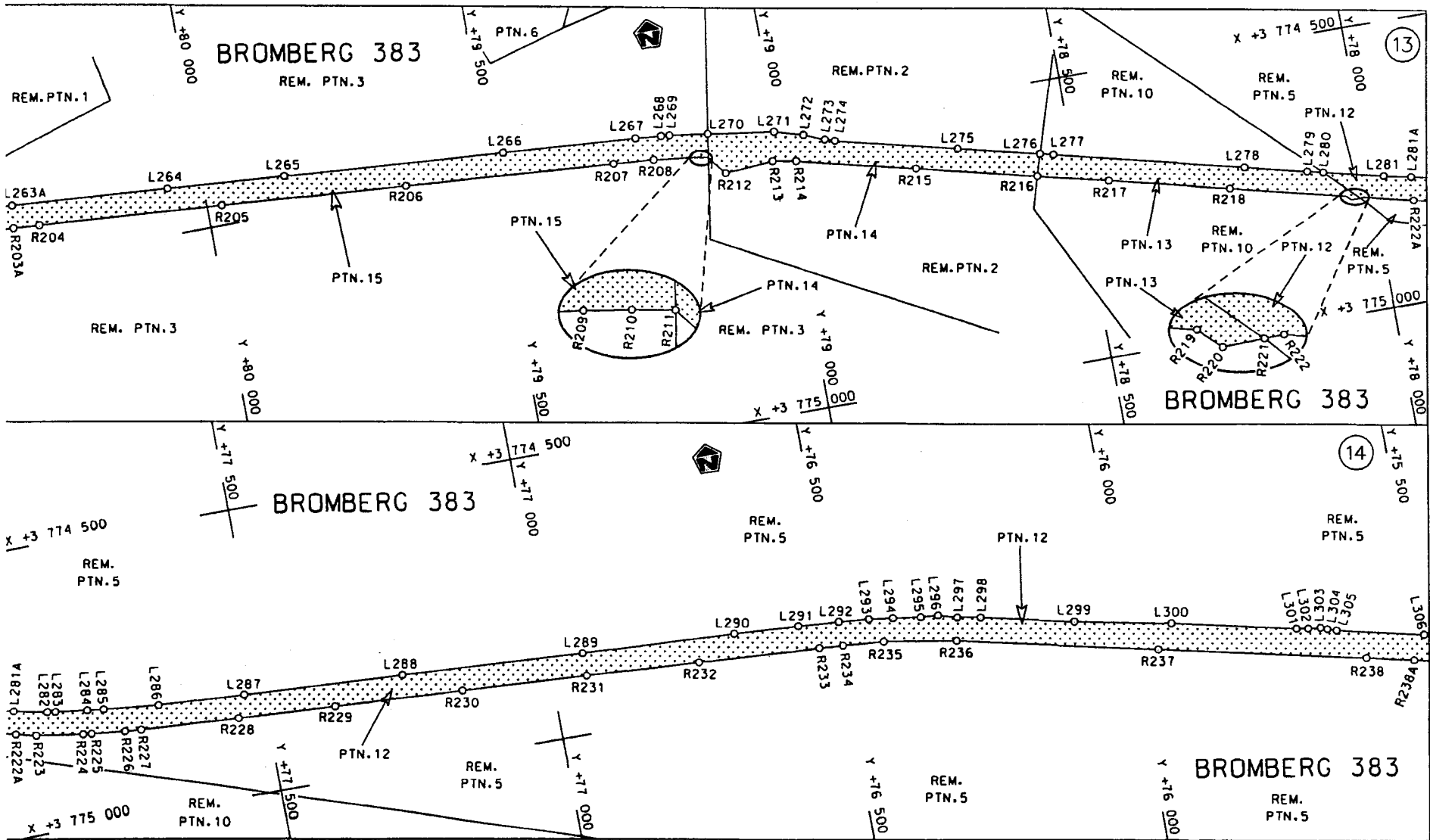

Die Suid Afrikaanse Nasionale Padagentskap Beperk
The South African National Roads Agency Limited

Die figuur getoon
The figure shown

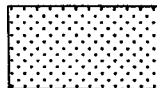

steldie podreserve voor van 'n gedeelte
represents the road reserve of a portion
van Nasionale Roete N2 Seksie
of National Route N2 Section

Vel 7 van
Sheet of 27

Plan P638/08

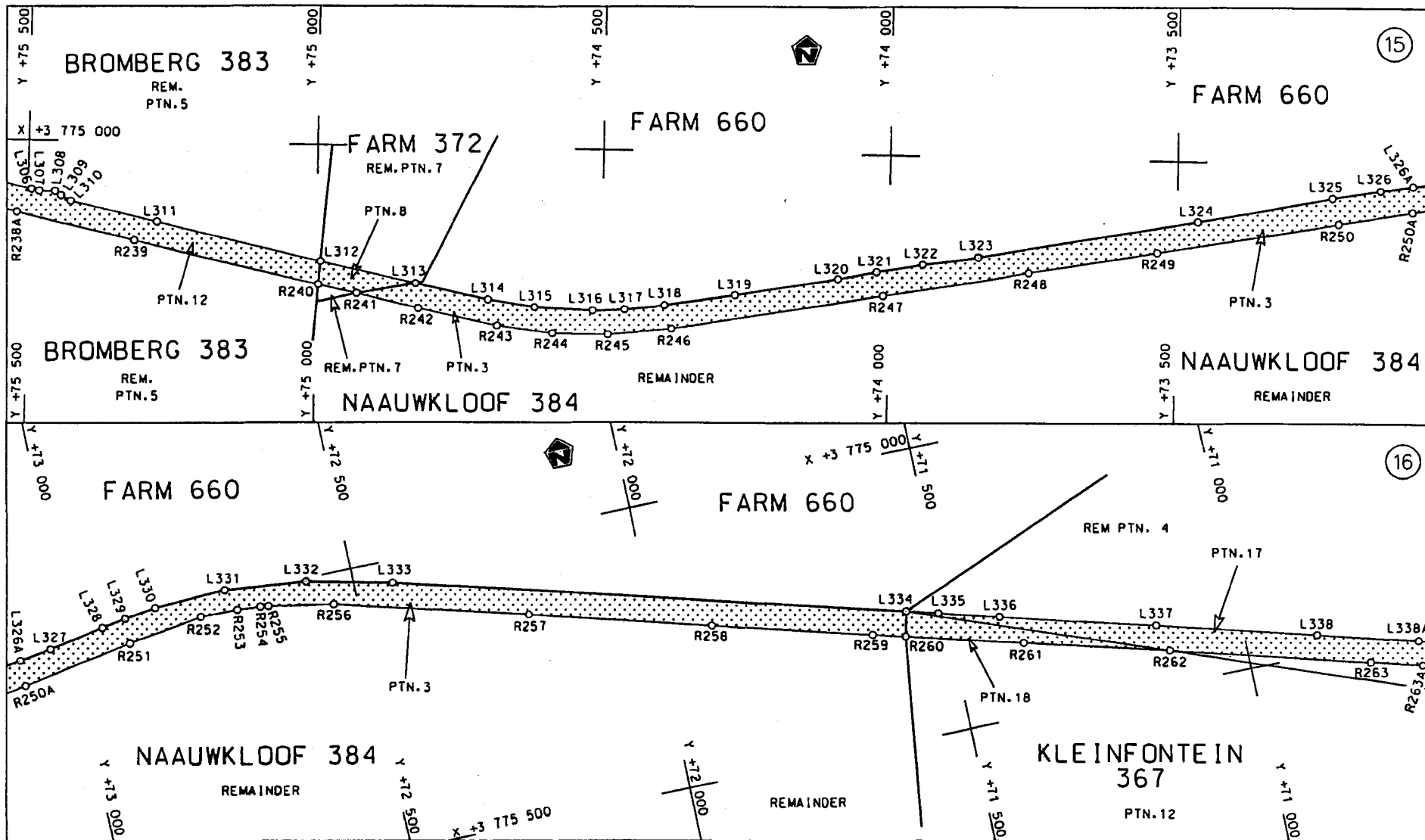

<p>Die Suid Afrikaanse Nasionale Padagentskap Beperk</p>	<p>Die figuur getoon</p>		<p>steldie padreserwe voor van 'n gedeelte</p>	<p>Vel Sheet 8 van 27</p>
<p>The South African National Roads Agency Limited</p>	<p>The figure shown</p>		<p>represents the road reserve of a portion of Nasionale Roete N2 Seksie Section 4</p>	<p>Plan P638/08</p>

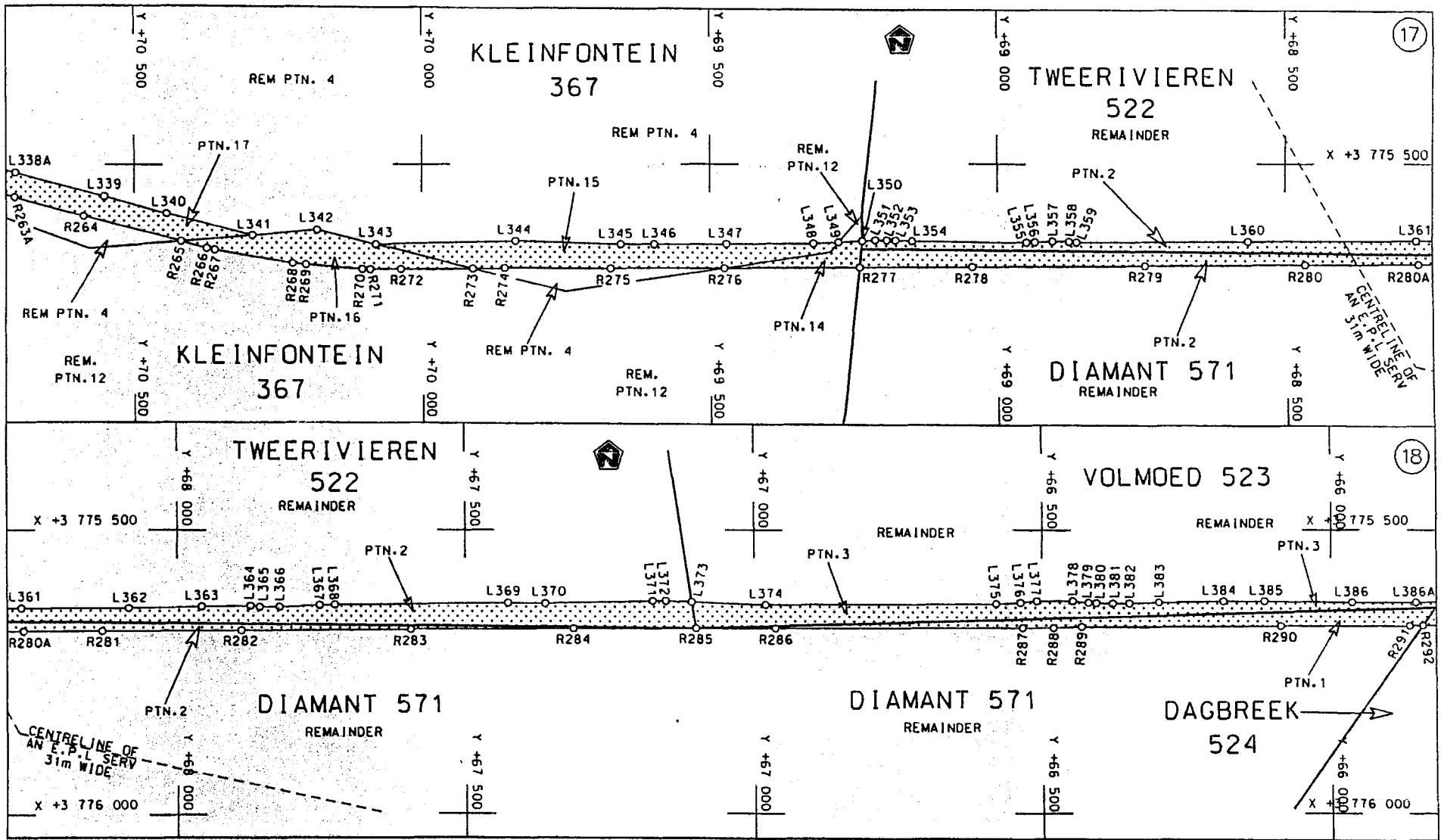

Die Suid Afrikaanse Nasionale Padagentskap Beperk
The South African National Roads Agency Limited

Die figuur getoon
The figure shown

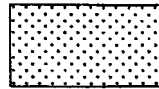

steldie padreserwe voor van 'n gedeelte
represents the road reserve of a portion
van Nasionale Roete N2 Seksie Section
of National Route 4

Vel Sheet 9 van of 27
Plan P638/08

D.O.9.A

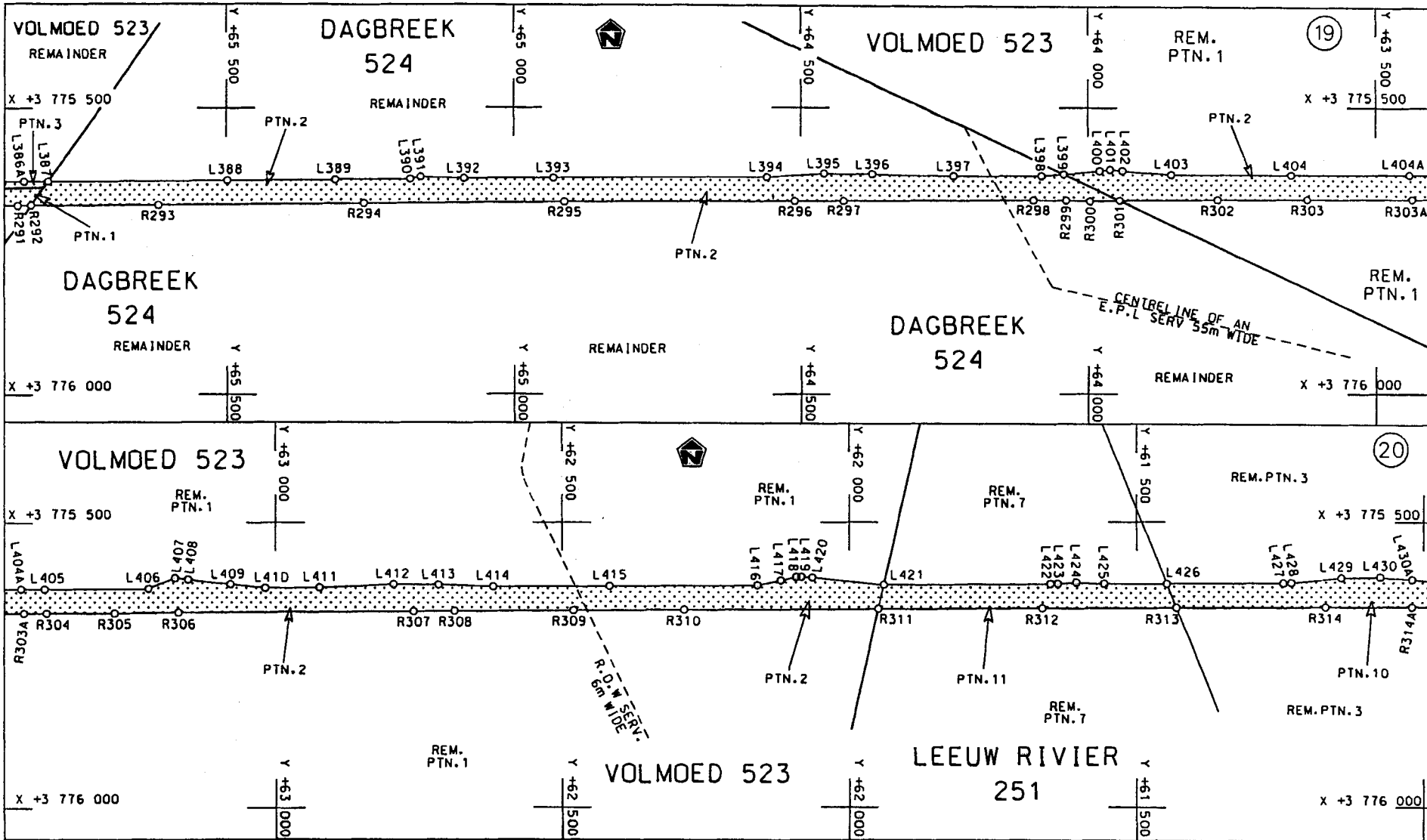

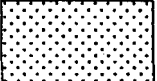
<p>Die Suid Afrikaanse Nasionale Padagentskap Beperk The South African National Roads Agency Limited</p>	<p>Die figuur getoon The figure shown</p> 	<p>steldie padreserwe voor van 'n gedeelte represents the road reserve of a portion van Nasionale Roete of National Route</p> <p>N2</p> <p>Seksie Section</p> <p>4</p>	<p>Vel Sheet 10 van of 27 Plan P638/08</p>
--	--	--	--

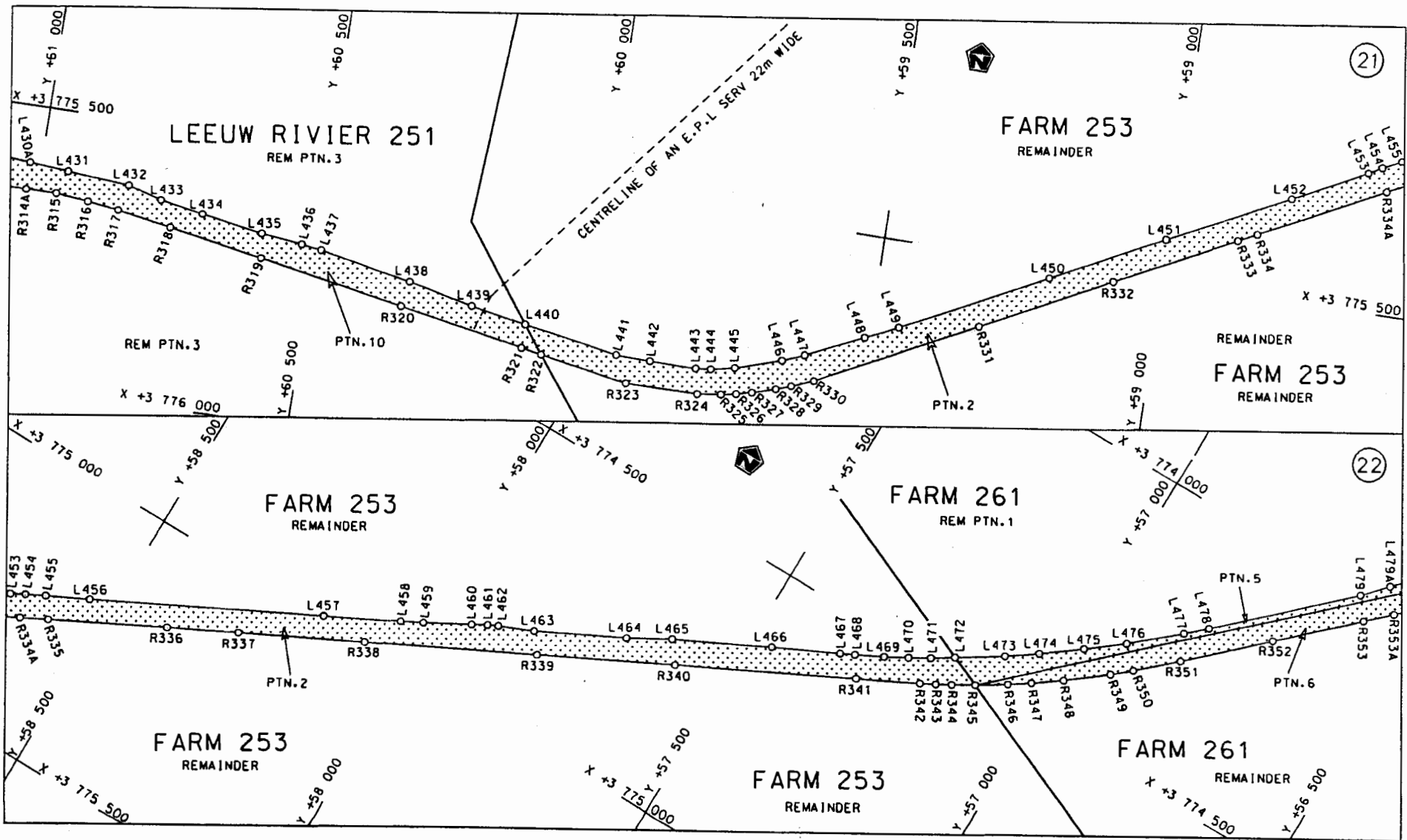

Die Suid Afrikaanse Nasionale Padagentskap Beperk
The South African National Roads Agency Limited

Die figuur getoon
The figure shown

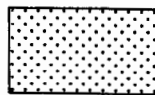

steldie padreserwe voor van 'n gedeelte
represents the road reserve of a portion
van Nasionale Roete of National Route N2

Seksie 4

Vel 11 van 27
Sheet of

Plan P638/08

D.O.9.A

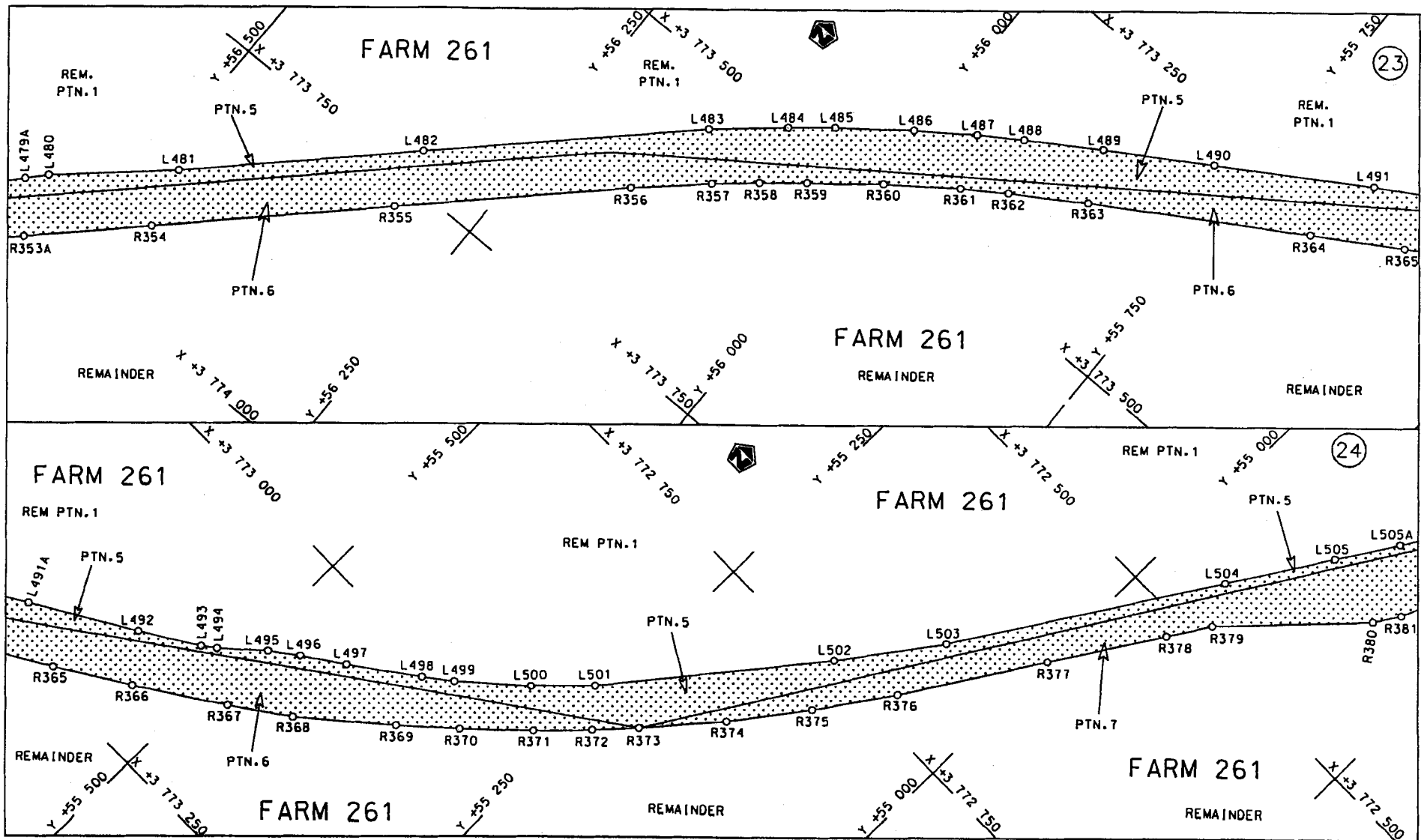

<p>Die Suid Afrikaanse Nasionale Padagentskap Beperk The South African National Roads Agency Limited</p>	<p>Die figuur getoon The figure shown</p>		<p>steldie padreserwe voor van 'n gedeelte represents the road reserve of a portion van Nasionale Raete N2 of National Route N2</p> <p>Seksie 4 Section 4</p>	<p>Vel Sheet 12 of 27 Plan P638/08</p>
--	---	--	---	--

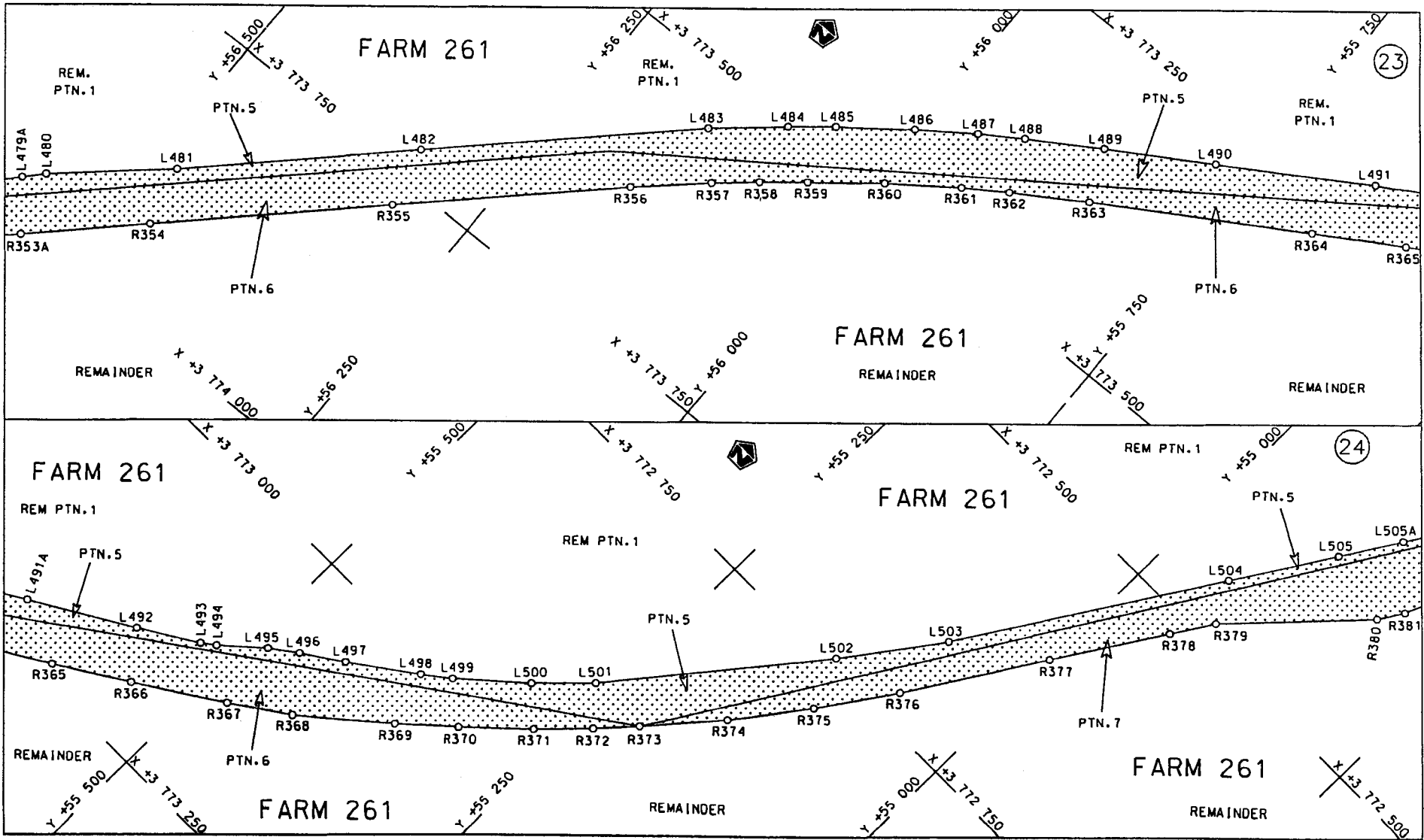

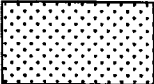
Die Suid Afrikaanse Nasionale Padagentskap Beperk The South African National Roads Agency Limited	Die figuur getoon The figure shown		steldie padreserwe voor van 'n gedeelte represents the road reserve of a portion van Nasionale Roete N2 of National Route N2	Seksie Section 4	Vel Sheet 12 van of 27
					Plan P638/08

D.O.9.A

STAATSKOERANT, 25 MAART 2008

No. 30897 17

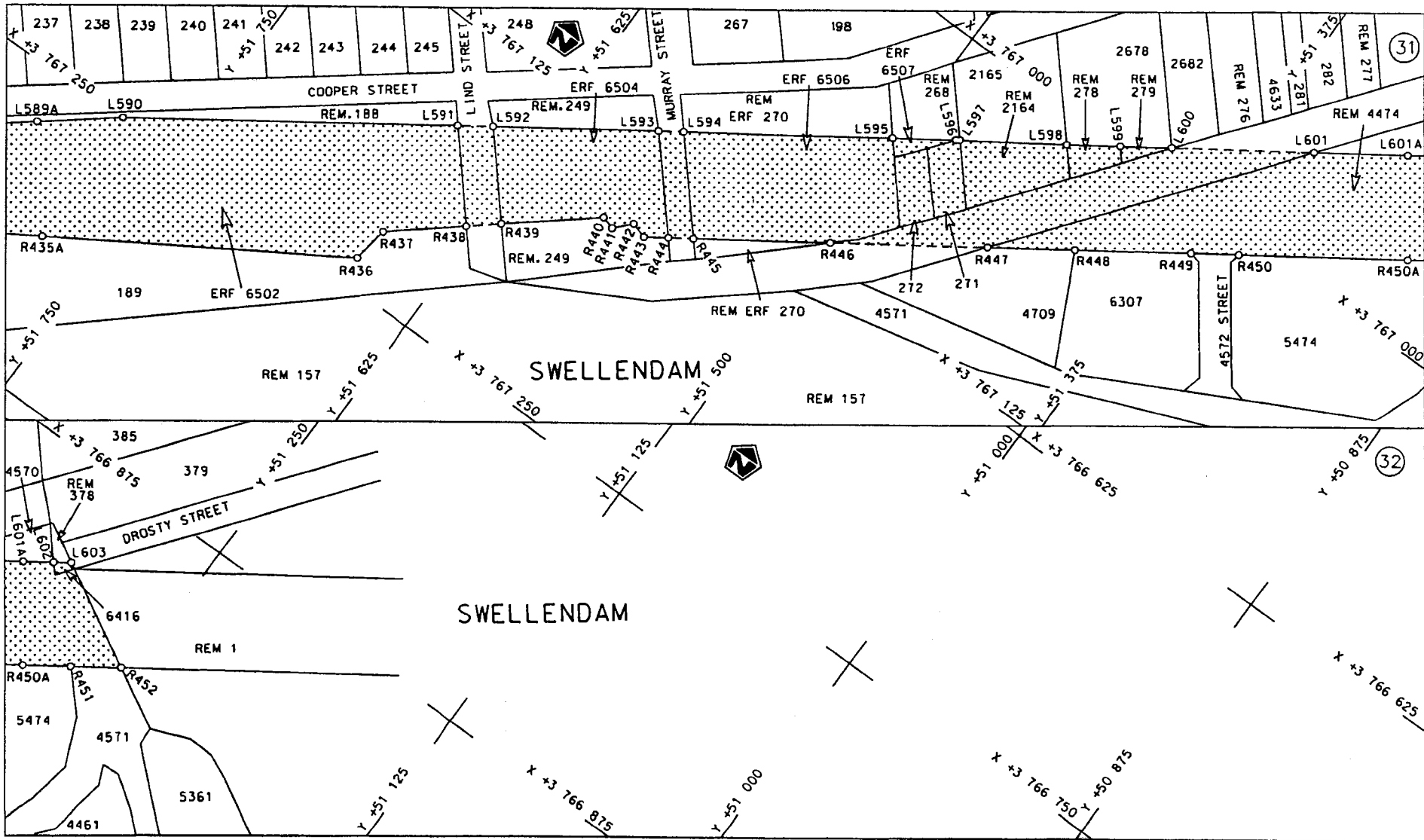

Die Suid Afrikaanse Nasionale Padagentskap Beperk
The South African National Roads Agency Limited

Die figuur getoon
The figure shown

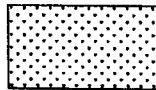

stel die padreserve voor van 'n gedeelte
represents the road reserve of a portion
van Nasionale Roete
of National Route

N2 Sektie
Section 4

Vel
Sheet 16 van
of 27

Plan
P638/08

D.O.9.A

PADRESERWE KOÖRDINATE				/ ROAD RESERVE CO-ORDINATES			
LINKERKANT/LEFT HAND SIDE				REGTERKANT/RIGHT HAND SIDE			
	Y	X	WG 19°		Y	X	
L1	-85 116.877	3 780	986.561	R1	-85 119.070	3 781	031.351
L2	-85 152.886	3 781	015.001	R2	-85 171.788	3 781	072.171
L3	-85 199.352	3 781	044.637	R3	-85 256.262	3 781	114.013
L4	-85 271.642	3 781	074.838	R4	-85 330.016	3 781	133.772
L5	-85 366.683	3 781	098.535	R5	-85 366.634	3 781	141.320
L6	-85 747.991	3 781	164.568	R6	-85 562.548	3 781	173.885
L7	-85 831.442	3 781	178.466	R7	-85 831.405	3 781	219.612
L8	-86 024.359	3 781	210.332	R8	-85 845.810	3 781	222.535
L9	-86 385.665	3 781	272.763	R9	-85 927.722	3 781	236.922
L10	-86 541.791	3 781	299.807	R10	-86 361.532	3 781	312.497
L11	-86 551.898	3 781	301.576	R11	-86 541.653	3 781	343.582
L12	-86 646.942	3 781	320.532	R12	-86 781.987	3 781	386.730
L13	-86 658.253	3 781	318.553	R13	-86 825.720	3 781	392.058
L14	-86 666.517	3 781	319.945	R14	-86 977.640	3 781	418.339
L15	-86 678.969	3 781	326.070	R15	-87 158.791	3 781	449.985
L16	-86 841.807	3 781	353.586	R16	-87 303.991	3 781	474.675
L17	-86 888.150	3 781	361.976	R17	-87 325.721	3 781	475.401
L18	-87 217.843	3 781	416.697	R18	-87 342.793	3 781	478.496
L19	-87 338.897	3 781	434.392	R19	-87 406.213	3 781	490.771
L20	-87 381.369	3 781	440.756	R20	-87 455.441	3 781	501.548
L21	-87 387.883	3 781	440.644	R21	-87 726.433	3 781	548.157
L22	-87 449.546	3 781	457.835	R22	-87 842.753	3 781	568.601
L23	-87 609.126	3 781	483.707	R23	-88 180.123	3 781	627.663
L24	-87 711.941	3 781	499.695	R24	-88 496.531	3 781	680.594
L25	-87 766.087	3 781	510.038	R25	-88 525.416	3 781	681.110
L26	-87 895.135	3 781	535.282	R26	-88 583.054	3 781	681.750
L27	-87 992.303	3 781	547.468	R27	-88 648.109	3 781	680.005
L28	-88 090.767	3 781	564.451	R28	-88 778.055	3 781	660.978
L29	-88 287.097	3 781	601.375	R29	-88 917.876	3 781	619.352
L30	-88 346.871	3 781	613.449	R30	-89 055.807	3 781	548.572
L31	-88 396.089	3 781	620.645	R31	-89 142.264	3 781	495.586
L32	-88 446.200	3 781	627.168	R32	-89 254.841	3 781	391.525
L33	-88 485.277	3 781	631.725	R33	-89 349.917	3 781	300.762
L34	-88 542.732	3 781	635.562	R34	-89 433.075	3 781	224.048
L35	-88 592.525	3 781	634.297	R35	-89 598.942	3 781	071.102
L36	-88 649.494	3 781	629.763	R36	-89 756.454	3 780	926.002
L37	-88 703.653	3 781	623.174	R37	-89 758.024	3 780	925.503
L38	-88 763.274	3 781	610.390	R38	-89 764.168	3 780	922.313
L39	-88 832.999	3 781	591.903	R39	-89 765.389	3 780	917.686
L40	-88 888.351	3 781	572.905	R40	-89 966.645	3 780	732.436
L41	-88 942.338	3 781	550.089	R41	-90 152.047	3 780	561.098
L42	-88 995.376	3 781	524.134	R42	-90 247.467	3 780	471.111
L43	-89 046.494	3 781	495.070	R43	-90 270.206	3 780	451.973
L44	-89 095.604	3 781	462.387	R44	-90 347.616	3 780	380.757
L45	-89 144.586	3 781	424.940	R45	-90 473.733	3 780	264.696
L46	-89 187.452	3 781	388.324	R46	-90 506.075	3 780	236.305
L47	-89 239.628	3 781	341.548	R47	-90 554.040	3 780	198.748
L48	-89 394.458	3 781	200.057	R48	-90 604.340	3 780	164.517
L49	-89 585.513	3 781	025.540	R49	-90 657.265	3 780	133.618
L50	-89 742.133	3 780	882.574	R50	-90 709.090	3 780	107.839
L51	-89 745.220	3 780	874.083	R51	-90 724.145	3 780	101.603

Vel	17	Van	27	P638/08
Sheet		of		

PADRESERWE KOÖRDINATE				/	ROAD RESERVE CO-ORDINATES				
LINKERKANT/LEFT HAND SIDE					REGTERKANT/RIGHT HAND SIDE				
	Y	X	WG	19°		Y	X		
L52	-89 751.476	3 780	870.725	R52	-90 749.721	3 780	110.185		
L53	-89 754.963	3 780	870.933	R53	-90 756.843	3 780	106.084		
L54	-90 055.658	3 780	592.275	R54	-90 765.739	3 780	084.424		
L55	-90 247.054	3 780	412.592	R55	-90 822.888	3 780	064.620		
L56	-90 278.501	3 780	388.004	R56	-90 874.439	3 780	050.768		
L57	-90 330.274	3 780	339.879	R57	-90 940.072	3 780	037.421		
L58	-90 390.573	3 780	283.811	R58	-91 003.457	3 780	028.611		
L59	-90 454.342	3 780	225.269	R59	-91 081.904	3 780	021.327		
L60	-90 504.231	3 780	183.429	R60	-91 083.688	3 780	021.162		
L61	-90 554.355	3 780	146.944	R61	-91 294.717	3 780	001.263		
L62	-90 597.149	3 780	119.578	R62	-91 514.784	3 779	980.590		
L63	-90 663.344	3 780	083.208	R63	-91 699.240	3 779	963.171		
L64	-90 719.822	3 780	055.779	R64	-91 727.566	3 779	960.595		
L65	-90 724.644	3 780	054.164	R65	-92 009.209	3 779	934.068		
L66	-90 828.426	3 780	018.810	R66	-92 017.361	3 779	934.018		
L67	-90 882.569	3 780	004.889	R67	-92 196.400	3 779	919.013		
L68	-90 951.347	3 779	992.384	R68	-92 306.057	3 779	909.529		
L69	-91 005.759	3 779	986.149	R69	-92 397.251	3 779	902.054		
L70	-91 067.736	3 779	980.262	R70	-92 434.318	3 779	898.960		
L71	-91 072.446	3 779	979.814	R71	-92 733.418	3 779	868.244		
L72	-91 272.361	3 779	961.057	R72	-92 964.033	3 779	844.747		
L73	-91 543.196	3 779	935.799	R73	-93 280.366	3 779	814.069		
L74	-91 881.911	3 779	904.149	R74	-93 495.518	3 779	794.180		
L75	-91 898.503	3 779	901.633	R75	-93 770.891	3 779	769.170		
L76	-92 003.504	3 779	891.908	R76	-93 972.218	3 779	749.010		
L77	-92 240.589	3 779	869.989	R77	-94 053.727	3 779	739.144		
L78	-92 343.759	3 779	860.268	R78	-94 085.825	3 779	731.422		
L79	-92 367.869	3 779	854.360	R79	-94 160.010	3 779	711.511		
L80	-92 386.111	3 779	844.755	R80	-94 218.528	3 779	691.293		
L81	-92 415.530	3 779	853.773	R81	-94 301.293	3 779	654.127		
L82	-92 424.498	3 779	852.919	R82	-94 308.599	3 779	650.840		
L83	-92 705.618	3 779	826.641	R83	-94 356.349	3 779	624.250		
L84	-93 083.496	3 779	791.197	R84	-94 392.768	3 779	601.719		
L85	-93 216.308	3 779	778.647	R85	-94 482.181	3 779	535.617		
L86	-93 256.671	3 779	770.696	R86	-94 549.940	3 779	473.062		
L87	-93 591.362	3 779	739.317	R87	-94 611.237	3 779	403.378		
L88	-93 949.633	3 779	705.138	R88	-94 840.466	3 779	089.795		
L89	-94 084.486	3 779	681.335	R89	-94 844.381	3 779	084.490		
L90	-94 178.437	3 779	652.150	R90	-94 849.590	3 779	077.441		
L91	-94 268.437	3 779	613.746	R91	-95 128.622	3 778	694.268		
L92	-94 284.131	3 779	606.542	R92	-95 221.808	3 778	565.767		
L93	-94 292.862	3 779	602.532	R93	-95 297.118	3 778	462.410		
L94	-94 321.270	3 779	588.595	R94	-95 313.576	3 778	439.708		
L95	-94 361.171	3 779	562.922	R95	-95 335.068	3 778	410.213		
L96	-94 420.124	3 779	520.498	R96	-95 345.775	3 778	395.159		
L97	-94 479.693	3 779	471.665	R97	-95 356.291	3 778	380.672		
L98	-94 536.495	3 779	416.527	R98	-95 501.448	3 778	181.684		
L99	-94 588.050	3 779	357.585	R99	-95 975.096	3 777	531.564		
L100	-94 635.961	3 779	293.680	R100	-96 024.590	3 777	475.751		
L101	-94 817.704	3 779	043.730	R101	-96 087.023	3 777	416.501		
L102	-94 824.073	3 779	035.673	R102	-96 150.528	3 777	365.814		
					Vel	18	Van	27	P638/08
					Sheet		of		

PADRESERWE KOÖRDINATE				/	ROAD RESERVE CO-ORDINATES						
LINKERKANT/LEFT HAND SIDE					REGTERKANT/RIGHT HAND SIDE						
	Y	X	WG	19°		Y	X				
L103	-94	832.176	3	779	025.419	R103	-96	199.372	3	777	332.954
L104	-94	919.754	3	778	904.920	R104	-96	252.313	3	777	302.304
L105	-94	998.276	3	778	796.356	R105	-96	306.833	3	777	274.795
L106	-95	127.529	3	778	614.260	R106	-96	367.940	3	777	251.097
L107	-95	157.098	3	778	576.331	R107	-97	303.894	3	776	900.446
L108	-95	164.544	3	778	566.395	R108	-97	601.799	3	776	789.035
L109	-95	159.756	3	778	512.120	R109	-97	883.676	3	776	683.010
L110	-95	166.118	3	778	483.479	R110	-97	983.612	3	776	646.018
L111	-95	207.098	3	778	428.260	R111	-98	079.868	3	776	609.984
L112	-95	230.854	3	778	412.872	R112	-98	157.405	3	776	577.805
L113	-95	287.173	3	778	405.354	R113	-98	233.500	3	776	541.117
L114	-95	292.941	3	778	397.335	R114	-98	294.880	3	776	508.091
L115	-95	295.048	3	778	394.456	R115	-98	306.867	3	776	501.204
L116	-95	299.917	3	778	392.511	R116	-98	365.773	3	776	464.809
L117	-95	304.185	3	778	383.993	R117	-98	436.116	3	776	416.366
L118	-95	303.163	3	778	383.042	R118	-98	502.792	3	776	365.230
L119	-95	308.003	3	778	375.446	R119	-98	562.309	3	776	314.453
L120	-95	308.557	3	778	369.665	R120	-98	612.744	3	776	266.250
L121	-95	313.303	3	778	363.247	R121	-98	622.534	3	776	256.620
L122	-95	322.601	3	778	359.873	R122	-98	670.605	3	776	206.039
L123	-95	479.273	3	778	140.851	R123	-98	680.770	3	776	194.666
L124	-95	548.956	3	778	040.835	R124	-98	725.914	3	776	141.848
L125	-95	563.427	3	778	019.494	R125	-98	776.954	3	776	075.472
L126	-95	629.559	3	777	920.989	R126	-98	817.508	3	776	016.953
L127	-95	676.299	3	777	857.151	R127	-98	825.229	3	776	005.272
L128	-95	738.356	3	777	780.850	R128	-98	861.733	3	775	946.183
L129	-95	754.025	3	777	761.173	R129	-98	903.883	3	775	872.091
L130	-95	809.083	3	777	685.205	R130	-99	013.403	3	775	682.763
L131	-95	855.375	3	777	615.657	R131	-99	091.585	3	775	547.643
L132	-95	866.592	3	777	601.644	R132	-99	139.468	3	775	464.232
L133	-95	921.091	3	777	534.317						
L134	-95	955.916	3	777	489.490						
L135	-95	996.298	3	777	443.841						
L136	-96	040.490	3	777	400.317						
L137	-96	086.434	3	777	360.758						
L138	-96	163.921	3	777	305.544						
L139	-96	213.616	3	777	275.180						
L140	-96	263.252	3	777	249.377						
L141	-96	336.352	3	777	217.961						
L142	-96	510.243	3	777	152.862						
L143	-96	622.995	3	777	108.540						
L144	-96	887.417	3	777	009.636						
L145	-97	113.906	3	776	924.852						
L146	-97	240.317	3	776	877.627						
L147	-97	268.623	3	776	866.919						
L148	-97	307.167	3	776	852.330						
L149	-97	319.187	3	776	846.824						
L150	-97	368.118	3	776	824.828						
L151	-97	421.194	3	776	809.803						
L152	-97	568.073	3	776	754.747						
L153	-97	777.098	3	776	676.602						

Vel	19	Van	27	P638/08
Sheet		of		

PADRESERWE KOÖRDINATE					ROAD RESERVE CO-ORDINATES						
LINKERKANT/LEFT HAND SIDE					REGTERKANT/RIGHT HAND SIDE						
	Y	X	WG	19°		Y	X				
L154	-97	949.429	3	776	612.051						
L155	-98	041.765	3	776	577.551						
L156	-98	108.198	3	776	551.066						
L157	-98	171.343	3	776	520.356						
L158	-98	234.640	3	776	487.998						
L159	-98	355.949	3	776	417.857						
L160	-98	403.016	3	776	387.381						
L161	-98	418.677	3	776	378.498						
L162	-98	460.143	3	776	344.760						
L163	-98	487.878	3	776	322.848						
L164	-98	507.525	3	776	306.349						
L165	-98	569.643	3	776	249.463						
L166	-98	610.353	3	776	209.011						
L167	-98	619.889	3	776	199.105						
L168	-98	666.326	3	776	148.193						
L169	-98	703.616	3	776	103.683						
L170	-98	712.228	3	776	092.949						
L171	-98	746.266	3	776	048.476						
L172	-98	786.793	3	775	990.806						
L173	-98	824.949	3	775	930.670						
L174	-98	875.258	3	775	843.905						
L175	-98	981.142	3	775	659.927						
L176	-99	107.056	3	775	441.472						
				WG	21°						
L176	85	446.020	3	775	307.780	R132	85	413.170	3	775	329.900
L177	85	291.560	3	775	026.710	R133	85	263.820	3	775	058.520
L178	85	169.880	3	774	805.580	R134	85	114.830	3	774	787.760
L179	85	060.620	3	774	607.130	R135	85	022.990	3	774	619.990
L180	85	020.130	3	774	533.780	R136	84	963.720	3	774	512.910
L181	84	991.970	3	774	471.460	R137	84	886.030	3	774	373.050
L182	84	986.190	3	774	462.220	R138	84	871.160	3	774	349.210
L183	84	971.350	3	774	443.520	R139	84	840.100	3	774	302.170
L184	84	965.430	3	774	428.880	R140	84	796.330	3	774	246.670
L185	84	943.580	3	774	393.920	R141	84	787.160	3	774	235.810
L186	84	923.050	3	774	357.440	R142	84	739.460	3	774	185.180
L187	84	894.790	3	774	309.410	R143	84	729.430	3	774	175.547
L188	84	887.150	3	774	297.780	R144	84	708.530	3	774	156.530
L189	84	854.280	3	774	251.600	R145	84	676.080	3	774	128.030
L190	84	836.920	3	774	229.950	R146	84	664.900	3	774	119.480
L191	84	810.310	3	774	197.970	R147	84	608.110	3	774	078.210
L192	84	800.180	3	774	186.570	R148	84	572.960	3	774	056.340
L193	84	787.470	3	774	172.910	R149	84	536.930	3	774	035.460
L194	84	762.060	3	774	147.590	R150	84	511.120	3	774	022.130
L195	84	741.990	3	774	128.890	R151	84	498.510	3	774	016.020
L196	84	721.970	3	774	110.820	R152	84	444.830	3	773	991.920
L197	84	710.450	3	774	101.270	R153	84	431.670	3	773	986.590
L198	84	699.770	3	774	092.680	R154	84	389.110	3	773	971.100
L199	84	654.970	3	774	058.800	R155	84	122.190	3	773	889.630
L200	84	632.190	3	774	043.350	R156	83	898.820	3	773	821.710
L201	84	596.430	3	774	020.740	R157	83	690.040	3	773	758.030
							Vel	20	Van	27	P638/08
							Sheet		of		

PADRESERWE KOÖRDINATE				ROAD RESERVE CO-ORDINATES			
LINKERKANT/LEFT HAND SIDE				REGTERKANT/RIGHT HAND SIDE			
	Y	X	WG 21°		Y	X	
L202	84 584.780	3 774 013.850		R158	83 473.760	3 773 692.080	
L203	84 535.090	3 773 987.020		R159	83 441.800	3 773 682.320	
L204	84 471.690	3 773 958.100		R160	83 407.220	3 773 673.040	
L205	84 457.470	3 773 952.750		R161	83 353.490	3 773 659.210	
L206	84 431.180	3 773 943.440		R162	83 277.600	3 773 641.960	
L207	84 403.990	3 773 934.440		R163	83 208.760	3 773 630.470	
L208	84 307.720	3 773 904.820		R164	83 181.350	3 773 627.130	
L209	84 159.930	3 773 859.800		R165	83 126.300	3 773 621.960	
L210	83 959.630	3 773 798.730		R166	83 112.730	3 773 621.070	
L211	83 947.650	3 773 790.130		R167	83 042.320	3 773 619.730	
L212	83 936.770	3 773 781.430		R168	83 028.680	3 773 619.990	
L213	83 922.440	3 773 787.280		R169	82 959.010	3 773 622.800	
L214	83 800.660	3 773 750.100		R170	82 874.550	3 773 632.200	
L215	83 787.410	3 773 745.320		R171	82 807.310	3 773 644.610	
L216	83 773.730	3 773 742.230		R172	82 725.830	3 773 665.420	
L217	83 767.030	3 773 739.260		R173	82 712.440	3 773 669.250	
L218	83 643.570	3 773 702.110		R174	82 644.490	3 773 690.490	
L219	83 479.520	3 773 652.350		R175	82 566.630	3 773 720.970	
L220	83 465.170	3 773 647.850		R176	82 465.720	3 773 768.320	
L221	83 343.770	3 773 566.560		R177	82 283.160	3 773 855.040	
L222	83 320.080	3 773 560.080		R178	82 107.640	3 773 938.150	
L223	83 239.690	3 773 576.010		R179	81 817.320	3 774 075.760	
L224	83 184.800	3 773 586.640		R180	81 648.400	3 774 155.420	
L225	83 163.640	3 773 584.310		R181	81 589.940	3 774 183.310	
L226	83 149.780	3 773 583.070		R182	81 418.820	3 774 265.010	
L227	83 076.530	3 773 579.780		R183	81 339.410	3 774 300.600	
L228	83 016.590	3 773 580.220		R184	81 326.420	3 774 306.010	
L229	83 001.410	3 773 580.710		R185	81 284.500	3 774 322.340	
L230	82 941.340	3 773 584.620		R186	81 279.830	3 774 324.160	
L231	82 895.070	3 773 589.690		R187	81 263.530	3 774 330.130	
L232	82 865.730	3 773 593.460		R188	81 244.380	3 774 336.450	
L233	82 806.740	3 773 603.860		R189	81 171.520	3 774 358.220	
L234	82 792.080	3 773 606.880		R190	81 158.020	3 774 361.590	
L235	82 731.420	3 773 621.130		R191	81 103.280	3 774 374.010	
L236	82 672.150	3 773 638.480		R192	81 074.380	3 774 379.380	
L237	82 658.440	3 773 642.840		R193	81 045.330	3 774 384.330	
L238	82 601.150	3 773 663.180		R194	81 031.450	3 774 386.410	
L239	82 586.370	3 773 669.110		R195	81 017.540	3 774 388.170	
L240	82 544.410	3 773 686.570		R196	80 989.940	3 774 391.000	
L241	82 530.730	3 773 692.550		R197	80 948.680	3 774 394.830	
L242	82 434.070	3 773 738.750		R198	80 860.800	3 774 401.380	
L243	82 288.770	3 773 807.690		R199	80 837.330	3 774 402.540	
L244	82 261.010	3 773 818.700		R200	80 721.690	3 774 411.640	
L245	82 150.550	3 773 871.390		R201	80 553.430	3 774 423.780	
L246	82 140.130	3 773 877.950		R202	80 489.050	3 774 428.270	
L247	82 127.050	3 773 884.590		R203	80 440.290	3 774 431.670	
L248	81 881.200	3 774 001.280		R204	80 291.500	3 774 442.250	
L249	81 617.620	3 774 126.440		R205	79 974.760	3 774 464.670	
L250	81 362.520	3 774 247.450		R206	79 652.800	3 774 487.500	
L251	81 291.880	3 774 277.790		R207	79 290.000	3 774 513.440	
L252	81 275.230	3 774 283.860		R208	79 220.460	3 774 518.770	

PADRESERWE KOÖRDINATE				/	ROAD RESERVE CO-ORDINATES			
LINKERKANT/LEFT HAND SIDE					REGTERKANT/RIGHT HAND SIDE			
	Y	X	WG	21°		Y	X	
L253	81 266.100	3 774 287.190			R209	79 151.490	3 774 526.980	
L254	81 211.730	3 774 305.880			R210	79 138.030	3 774 529.170	
L255	81 157.920	3 774 321.160			R211	79 125.980	3 774 531.400	
L256	81 130.590	3 774 328.020			R212	79 100.980	3 774 563.140	
L257	81 093.170	3 774 335.700			R213	79 016.880	3 774 556.200	
L258	80 994.730	3 774 351.450			R214	78 976.890	3 774 563.290	
L259	80 952.810	3 774 355.430			R215	78 774.070	3 774 613.060	
L260	80 938.790	3 774 356.610			R216	78 567.450	3 774 663.720	
L261	80 720.640	3 774 371.850			R217	78 447.050	3 774 693.190	
L262	80 502.290	3 774 387.560			R218	78 243.090	3 774 743.500	
L263	80 353.740	3 774 397.880			R219	78 046.150	3 774 792.450	
L264	80 062.180	3 774 418.420			R220	78 038.140	3 774 800.400	
L265	79 859.740	3 774 432.970			R221	78 022.590	3 774 799.980	
L266	79 474.940	3 774 460.260			R222	78 015.450	3 774 799.780	
L267	79 244.950	3 774 476.510			R223	77 896.670	3 774 829.090	
L268	79 200.760	3 774 480.070			R224	77 816.670	3 774 841.880	
L269	79 186.330	3 774 481.540			R225	77 802.440	3 774 843.610	
L270	79 119.380	3 774 490.500			R226	77 745.120	3 774 849.960	
L271	79 005.540	3 774 506.360			R227	77 717.390	3 774 852.170	
L272	78 956.750	3 774 520.610			R228	77 548.600	3 774 862.210	
L273	78 921.580	3 774 535.100			R229	77 380.830	3 774 871.510	
L274	78 904.440	3 774 540.340			R230	77 156.900	3 774 884.510	
L275	78 696.140	3 774 591.660			R231	76 939.550	3 774 897.160	
L276	78 555.660	3 774 626.230			R232	76 743.180	3 774 908.620	
L277	78 533.330	3 774 631.660			R233	76 533.530	3 774 920.640	
L278	78 211.250	3 774 711.110			R234	76 491.560	3 774 923.680	
L279	78 106.150	3 774 737.450			R235	76 420.440	3 774 929.600	
L280	78 078.520	3 774 744.100			R236	76 295.640	3 774 950.540	
L281	77 975.410	3 774 769.180			R237	75 953.930	3 775 027.860	
L282	77 871.120	3 774 791.600			R238	75 601.450	3 775 107.460	
L283	77 857.140	3 774 794.020			R239	75 315.010	3 775 172.360	
L284	77 802.940	3 774 801.140			R240	74 995.860	3 775 244.600	
L285	77 775.030	3 774 804.490			R241	74 929.720	3 775 259.590	
L286	77 680.830	3 774 814.440			R242	74 821.560	3 775 284.110	
L287	77 531.580	3 774 822.880			R243	74 682.710	3 775 312.170	
L288	77 255.450	3 774 839.240			R244	74 584.330	3 775 323.890	
L289	76 939.440	3 774 857.610			R245	74 488.120	3 775 323.450	
L290	76 673.920	3 774 869.710			R246	74 377.300	3 775 311.660	
L291	76 562.290	3 774 876.210			R247	74 009.800	3 775 245.850	
L292	76 491.390	3 774 881.550			R248	73 756.110	3 775 200.290	
L293	76 439.010	3 774 886.320			R249	73 533.830	3 775 160.310	
L294	76 397.800	3 774 891.770			R250	73 218.710	3 775 103.830	
L295	76 349.390	3 774 898.660			R251	72 899.100	3 775 046.650	
L296	76 319.680	3 774 900.670			R252	72 767.500	3 775 028.330	
L297	76 287.160	3 774 910.430			R253	72 703.490	3 775 029.400	
L298	76 246.970	3 774 917.940			R254	72 664.000	3 775 032.240	
L299	76 088.190	3 774 953.840			R255	72 650.340	3 775 034.160	
L300	75 923.120	3 774 987.080			R256	72 540.430	3 775 054.340	
L301	75 712.390	3 775 035.400			R257	72 209.690	3 775 144.610	
L302	75 692.450	3 775 038.800			R258	71 902.040	3 775 229.760	
L303	75 670.920	3 775 041.630			R259	71 631.890	3 775 304.610	

Vel	22	Van	27	P638/08
Sheet		of		

PADRESERWE KOÖRDINATE				ROAD RESERVE CO-ORDINATES			
LINKERKANT/LEFT HAND SIDE				REGTERKANT/RIGHT HAND SIDE			
	Y	X	WG 21°		Y	X	
L304	75 659.140	3 775 046.160		R260	71 576.910	3 775 319.510	
L305	75 643.600	3 775 051.360		R261	71 377.520	3 775 373.580	
L306	75 494.730	3 775 085.960		R262	71 131.570	3 775 440.800	
L307	75 481.110	3 775 088.830		R263	70 793.970	3 775 533.200	
L308	75 453.590	3 775 088.710		R264	70 587.320	3 775 589.970	
L309	75 442.780	3 775 096.080		R265	70 418.810	3 775 635.750	
L310	75 425.990	3 775 105.490		R266	70 374.390	3 775 647.780	
L311	75 275.210	3 775 139.690		R267	70 360.500	3 775 650.570	
L312	74 992.540	3 775 203.610		R268	70 227.500	3 775 674.210	
L313	74 827.080	3 775 240.410		R269	70 204.060	3 775 676.400	
L314	74 699.190	3 775 266.680		R270	70 105.440	3 775 684.600	
L315	74 615.790	3 775 278.540		R271	70 091.690	3 775 685.170	
L316	74 515.100	3 775 281.880		R272	70 038.750	3 775 685.590	
L317	74 459.720	3 775 278.900		R273	69 911.450	3 775 684.140	
L318	74 390.360	3 775 270.320		R274	69 856.300	3 775 683.510	
L319	74 266.800	3 775 250.170		R275	69 673.070	3 775 683.780	
L320	74 088.080	3 775 217.690		R276	69 475.730	3 775 683.220	
L321	74 021.430	3 775 203.880		R277	69 239.950	3 775 681.730	
L322	73 941.760	3 775 189.000		R278	69 044.260	3 775 681.310	
L323	73 845.120	3 775 173.990		R279	68 745.610	3 775 680.070	
L324	73 463.700	3 775 105.270		R280	68 466.330	3 775 678.470	
L325	73 230.020	3 775 059.210		R281	68 129.970	3 775 677.130	
L326	73 147.270	3 775 044.380		R282	67 890.520	3 775 676.570	
L327	73 035.140	3 775 027.380		R283	67 597.080	3 775 674.800	
L328	72 939.700	3 775 010.240		R284	67 313.400	3 775 673.930	
L329	72 898.280	3 775 003.120		R285	67 101.850	3 775 673.020	
L330	72 842.950	3 774 995.800		R286	66 963.210	3 775 673.090	
L331	72 717.430	3 774 991.610		R287	66 534.330	3 775 671.780	
L332	72 578.940	3 775 005.590		R288	66 481.130	3 775 672.590	
L333	72 433.140	3 775 039.130		R289	66 432.500	3 775 670.460	
L334	71 566.650	3 775 276.780		R290	66 088.360	3 775 669.070	
L335	71 512.780	3 775 291.550		R291	65 862.430	3 775 668.500	
L336	71 409.500	3 775 320.420		R292	65 838.940	3 775 668.290	
L337	71 146.090	3 775 392.830		R293	65 617.960	3 775 667.350	
L338	70 875.900	3 775 467.270		R294	65 264.300	3 775 666.070	
L339	70 551.570	3 775 556.230		R295	64 911.070	3 775 664.830	
L340	70 443.930	3 775 585.930		R296	64 510.160	3 775 663.250	
L341	70 296.080	3 775 625.650		R297	64 424.600	3 775 663.120	
L342	70 183.570	3 775 616.390		R298	64 094.400	3 775 661.510	
L343	70 081.610	3 775 641.770		R299	64 037.630	3 775 661.530	
L344	69 836.880	3 775 636.310		R300	63 996.490	3 775 662.850	
L345	69 555.570	3 775 641.820		R301	63 945.260	3 775 661.780	
L346	69 597.420	3 775 642.300		R302	63 776.010	3 775 660.720	
L347	69 471.600	3 775 641.470		R303	63 620.970	3 775 660.140	
L348	69 320.100	3 775 640.540		R304	63 396.350	3 775 658.750	
L349	69 276.270	3 775 638.500		R305	63 279.870	3 775 658.580	
L350	69 235.200	3 775 636.140		R306	63 168.290	3 775 657.590	
L351	69 212.650	3 775 634.720		R307	62 762.000	3 775 656.270	
L352	69 192.980	3 775 635.010		R308	62 690.790	3 775 656.160	
L353	69 178.060	3 775 635.580		R309	62 480.360	3 775 654.960	
L354	69 148.760	3 775 636.360		R310	62 289.350	3 775 654.310	

Vel	23	Van	27	P638/08
Sheet		of		

PADRESERWE KOÖRDINATE				/	ROAD RESERVE CO-ORDINATES			
LINKERKANT/LEFT HAND SIDE					REGTERKANT/RIGHT HAND SIDE			
	Y	X	WG	21°	Y	X		
L355	68 949.400	3 775 639.210		R311	61 949.010	3 775 652.900		
L356	68 935.010	3 775 638.630		R312	61 663.690	3 775 651.750		
L357	68 904.500	3 775 636.990		R313	61 430.720	3 775 650.910		
L358	68 875.710	3 775 637.640		R314	61 172.430	3 775 649.900		
L359	68 862.740	3 775 639.100		R315	60 966.490	3 775 649.070		
L360	68 565.580	3 775 637.750		R316	60 909.200	3 775 655.060		
L361	68 270.370	3 775 636.680		R317	60 854.380	3 775 662.860		
L362	68 084.630	3 775 636.620		R318	60 758.450	3 775 679.700		
L363	67 958.200	3 775 633.990		R319	60 592.520	3 775 709.330		
L364	67 874.650	3 775 632.990		R320	60 332.230	3 775 755.470		
L365	67 858.880	3 775 634.990		R321	60 108.480	3 775 795.260		
L366	67 824.940	3 775 634.720		R322	60 071.700	3 775 801.700		
L367	67 755.210	3 775 631.970		R323	59 916.350	3 775 828.860		
L368	67 728.830	3 775 631.230		R324	59 787.850	3 775 828.120		
L369	67 426.360	3 775 628.250		R325	59 746.220	3 775 822.180		
L370	67 361.540	3 775 628.730		R326	59 719.210	3 775 817.040		
L371	67 176.750	3 775 624.810		R327	59 691.620	3 775 809.920		
L372	67 154.090	3 775 624.540		R328	59 650.780	3 775 797.150		
L373	67 108.720	3 775 626.530		R329	59 624.420	3 775 787.700		
L374	66 980.270	3 775 631.260		R330	59 585.600	3 775 771.700		
L375	66 580.110	3 775 629.860		R331	59 310.800	3 775 630.730		
L376	66 538.060	3 775 627.370		R332	59 085.590	3 775 514.380		
L377	66 509.760	3 775 624.480		R333	58 878.890	3 775 408.400		
L378	66 447.150	3 775 624.480		R334	58 846.110	3 775 391.890		
L379	66 420.010	3 775 627.420		R335	58 583.410	3 775 256.260		
L380	66 406.490	3 775 628.230		R336	58 397.060	3 775 159.890		
L381	66 378.570	3 775 629.070		R337	58 284.720	3 775 102.550		
L382	66 350.370	3 775 628.690		R338	58 084.590	3 774 999.560		
L383	66 299.300	3 775 626.510		R339	57 809.540	3 774 858.360		
L384	66 188.030	3 775 625.060		R340	57 592.040	3 774 746.080		
L385	66 116.850	3 775 624.750		R341	57 304.020	3 774 598.170		
L386	65 963.120	3 775 626.980		R342	57 203.600	3 774 546.510		
L387	65 809.270	3 775 626.460		R343	57 178.890	3 774 533.180		
L388	65 498.400	3 775 625.160		R344	57 154.630	3 774 519.320		
L389	65 313.580	3 775 624.310		R345	57 118.620	3 774 497.960		
L390	65 182.910	3 775 623.890		R346	57 069.490	3 774 466.250		
L391	65 165.040	3 775 620.460		R347	57 034.980	3 774 442.400		
L392	65 089.150	3 775 623.020		R348	56 988.330	3 774 408.480		
L393	64 930.050	3 775 622.800		R349	56 922.970	3 774 356.020		
L394	64 558.920	3 775 621.230		R350	56 891.780	3 774 328.860		
L395	64 459.060	3 775 614.980		R351	56 829.690	3 774 270.980		
L396	64 374.670	3 775 616.330		R352	56 709.170	3 774 154.760		
L397	64 233.850	3 775 619.650		R353	56 589.120	3 774 038.700		
L398	64 081.120	3 775 619.240		R354	56 468.060	3 773 921.780		
L399	64 042.020	3 775 615.820		R355	56 315.440	3 773 774.520		
L400	63 980.060	3 775 610.390		R356	56 164.460	3 773 629.030		
L401	63 962.080	3 775 608.050		R357	56 111.880	3 773 580.710		
L402	63 940.960	3 775 609.980		R358	56 080.340	3 773 553.240		
L403	63 855.630	3 775 617.060		R359	56 047.730	3 773 526.460		
L404	63 649.110	3 775 617.680		R360	55 995.050	3 773 484.330		
L405	63 399.830	3 775 616.460		R361	55 940.500	3 773 444.260		

Vel	24	Van	27	P638/08
Sheet		of		

PADRESERWE KOÖRDINATE				/	ROAD RESERVE CO-ORDINATES			
LINKERKANT/LEFT HAND SIDE					REGTERKANT/RIGHT HAND SIDE			
	Y	X	WG 21°		Y	X		
L406	63 220.710	3 775 615.670		R362	55 905.310	3 773 420.430		
L407	63 174.700	3 775 597.850		R363	55 845.900	3 773 382.230		
L408	63 151.640	3 775 600.120		R364	55 678.160	3 773 279.410		
L409	63 078.140	3 775 608.450		R365	55 606.770	3 773 235.660		
L410	63 018.010	3 775 614.920		R366	55 547.050	3 773 198.260		
L411	62 925.600	3 775 614.480		R367	55 475.670	3 773 151.240		
L412	62 797.020	3 775 609.220		R368	55 428.570	3 773 118.300		
L413	62 718.830	3 775 609.770		R369	55 360.430	3 773 059.640		
L414	62 622.130	3 775 612.970		R370	55 318.620	3 773 021.530		
L415	62 418.070	3 775 612.350		R371	55 271.090	3 772 975.280		
L416	62 160.850	3 775 611.340		R372	55 235.570	3 772 937.890		
L417	62 119.290	3 775 602.990		R373	55 208.440	3 772 907.360		
L418	62 092.670	3 775 596.860		R374	55 159.070	3 772 848.140		
L419	62 083.760	3 775 596.400		R375	55 113.670	3 772 786.690		
L420	62 064.930	3 775 597.930		R376	55 071.050	3 772 723.350		
L421	61 939.500	3 775 610.520		R377	54 999.870	3 772 608.720		
L422	61 649.710	3 775 609.300		R378	54 943.160	3 772 517.550		
L423	61 636.790	3 775 608.800		R379	54 921.640	3 772 482.720		
L424	61 604.700	3 775 606.280		R380	54 825.980	3 772 378.750		
L425	61 556.670	3 775 608.690		R381	54 812.380	3 772 356.970		
L426	61 447.640	3 775 608.420		R382	54 762.330	3 772 226.960		
L427	61 246.430	3 775 607.560		R383	54 665.750	3 772 070.850		
L428	61 232.890	3 775 606.780		R384	54 624.720	3 772 005.390		
L429	61 144.250	3 775 598.490		R385	54 512.490	3 771 825.320		
L430	61 076.120	3 775 596.660		R386	54 421.000	3 771 678.090		
L431	60 951.520	3 775 607.140		R387	54 374.610	3 771 612.800		
L432	60 842.320	3 775 615.740		R388	54 327.740	3 771 552.990		
L433	60 782.300	3 775 633.170		R389	54 178.760	3 771 380.170		
L434	60 705.400	3 775 647.150		R390	53 949.060	3 771 115.880		
L435	60 598.090	3 775 665.920		R391	53 878.000	3 771 034.120		
L436	60 524.480	3 775 673.900		R392	53 813.270	3 770 958.347		
L437	60 488.760	3 775 678.510		R393	53 749.860	3 770 881.680		
L438	60 323.580	3 775 710.160		R394	53 690.550	3 770 801.520		
L439	60 207.580	3 775 735.460		R395	53 633.670	3 770 721.750		
L440	60 107.590	3 775 753.790		R396	53 520.840	3 770 561.450		
L441	59 940.770	3 775 781.460		R397	53 488.250	3 770 515.140		
L442	59 879.830	3 775 782.950		R398	53 463.590	3 770 480.110		
L443	59 797.610	3 775 782.950		R399	53 292.340	3 770 236.430		
L444	59 770.970	3 775 779.980		R400	53 240.330	3 770 162.690		
L445	59 728.810	3 775 770.800		R401	53 235.130	3 770 155.320		
L446	59 647.730	3 775 744.680		R402	53 170.380	3 770 061.120		
L447	59 608.700	3 775 729.160		R403	53 143.070	3 770 025.570		
L448	59 507.680	3 775 681.910		R404	53 057.920	3 769 959.480		
L449	59 450.570	3 775 654.630		R405	52 990.070	3 769 878.760		
L450	59 199.250	3 775 525.590		R406	52 915.860	3 769 775.170		
L451	59 004.410	3 775 425.420		R407	52 852.740	3 769 661.060		
L452	58 794.800	3 775 318.600		R408	52 836.020	3 769 620.200		
L453	58 665.070	3 775 251.450		R409	52 851.670	3 769 587.060		
L454	58 641.530	3 775 238.220		R410	52 814.030	3 769 515.850		
L455	58 609.380	3 775 221.710		R411	52 784.570	3 769 448.810		
L456	58 539.690	3 775 187.100		R412	52 762.370	3 769 398.170		

PADRESERWE KOÖRDINATE				/	ROAD RESERVE CO-ORDINATES				
LINKERKANT/LEFT HAND SIDE					LINKERKANT/LEFT HAND SIDE				
				WG 21°	Y	X			
L517	54	446.290	3 771	649.660	L568	52	230.230	3 767	860.170
L518	54	359.500	3 771	535.600	L569	52	224.280	3 767	849.880
L519	54	353.250	3 771	527.380	L570	52	214.900	3 767	833.660
L520	54	241.490	3 771	389.900	L571	52	208.070	3 767	819.120
L521	54	010.160	3 771	138.680	L572	52	186.170	3 767	773.680
L522	53	868.220	3 770	974.480	L573	52	169.880	3 767	747.380
L523	53	787.520	3 770	877.080	L574	52	162.450	3 767	736.620
L524	53	760.590	3 770	842.080	L575	52	152.760	3 767	720.740
L525	53	747.330	3 770	817.280	L576	52	143.080	3 767	704.860
L526	53	726.030	3 770	783.200	L577	52	133.510	3 767	689.160
L527	53	727.720	3 770	781.160	L578	52	102.360	3 767	643.270
L528	53	688.100	3 770	725.970	L579	52	071.200	3 767	597.370
L529	53	637.810	3 770	672.590	L580	52	040.050	3 767	551.470
L530	53	567.580	3 770	572.280	L581	52	028.720	3 767	534.830
L531	53	262.320	3 770	138.350	L582	52	010.032	3 767	504.658
L532	53	230.080	3 770	088.140	L583	52	004.991	3 767	496.535
L533	53	225.870	3 770	058.640	L584	51	979.466	3 767	455.433
L534	53	206.670	3 770	031.230	L585	51	973.650	3 767	446.560
L535	53	116.540	3 769	903.340	L586	51	945.810	3 767	399.530
L536	53	019.470	3 769	765.290	L587	51	940.790	3 767	391.050
L537	52	981.910	3 769	711.780	L588	51	913.030	3 767	356.980
L538	52	950.540	3 769	664.600	L589	51	905.580	3 767	350.980
L539	52	930.060	3 769	631.230	L590	51	778.640	3 767	248.480
L540	52	910.500	3 769	598.080	L591	51	658.560	3 767	164.820
L541	52	890.360	3 769	562.160	L592	51	645.810	3 767	155.920
L542	52	832.130	3 769	443.190	L593	51	586.610	3 767	114.660
L543	52	814.140	3 769	399.360	L594	51	577.640	3 767	108.440
L544	52	796.260	3 769	355.770	L595	51	502.280	3 767	056.110
L545	52	770.060	3 769	281.410	L596	51	479.590	3 767	040.350
L546	52	746.990	3 769	206.130	L597	51	478.068	3 767	039.330
L547	52	737.120	3 769	172.940	L598	51	439.344	3 767	013.187
L548	52	727.260	3 769	139.750	L599	51	420.068	3 766	999.862
L549	52	707.480	3 769	073.390	L600	51	401.569	3 766	987.072
L550	52	669.740	3 768	946.900	L601	51	350.130	3 766	951.992
L551	52	606.950	3 768	735.980	L602	51	305.331	3 766	920.941
L552	52	582.670	3 768	654.650	L603	51	299.039	3 766	916.552
L553	52	563.140	3 768	589.210					
L554	52	550.150	3 768	545.610					
L555	52	530.060	3 768	475.490					
L556	52	526.530	3 768	463.170					
L557	52	514.110	3 768	426.170					
L558	52	477.260	3 768	309.660					
L559	52	461.060	3 768	266.640					
L560	52	440.950	3 768	223.960					
L561	52	409.940	3 768	162.430					
L562	52	404.230	3 768	151.200					
L563	52	358.540	3 768	062.490					
L564	52	331.740	3 768	020.260					
L565	52	305.710	3 767	980.370					
L566	52	280.410	3 767	940.630					
L567	52	255.396	3 767	900.490					

Vel	27	Van	27	P638/08
Sheet		of		