

---

GOVERNMENT NOTICE  
GOEWERMENTSKENNISGEWING

---

DEPARTMENT OF TRANSPORT  
DEPARTEMENT VAN VERVOER

No. 264

7 March 2008

THE SOUTH AFRICAN NATIONAL ROADS  
AGENCY LIMITED

Registration No: 98/09584/06

DECLARATION AMENDMENT OF NATIONAL ROAD N11 SECTION 9

AMENDMENT OF DECLARATION NO. 1322 OF 1989

By virtue of Section 40(1)(b) of The South African National Roads Agency Limited and National Roads Act, 1998 (Act No. 7 of 1998) I hereby amend declaration No. 1322 of 1989 Schedule paragraph 14, by substituting the section of the descriptive declaration from Hendrina up the intersection with National Road N4 Section 4 at the Rockdale interchange south east of Middelburg, with the subjoined sheets 1 to 9 of Plan No. P631/07.

**(National Road N11 Section 9: Hendrina – Middelburg)**

  
\_\_\_\_\_  
MINISTER OF TRANSPORT

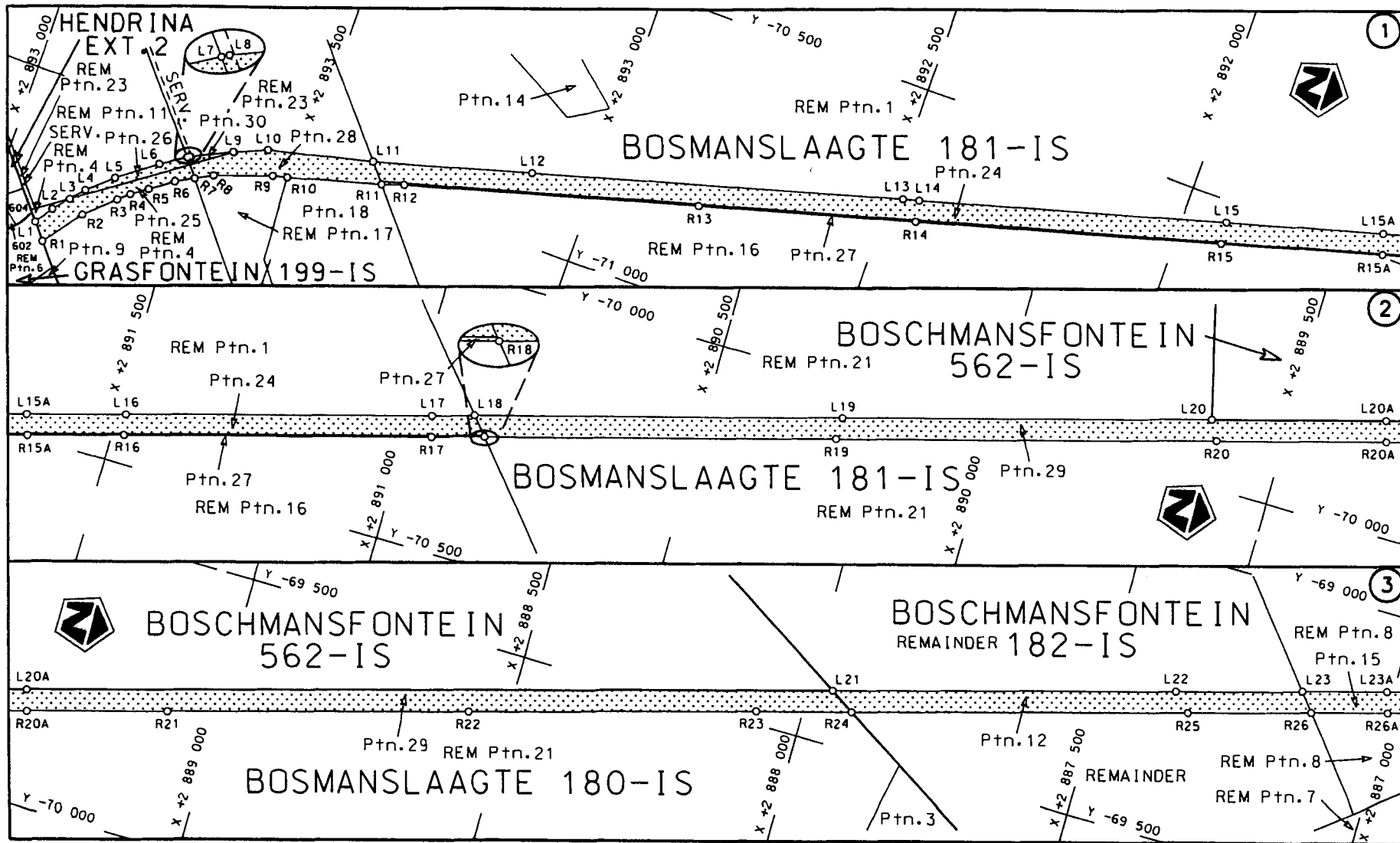

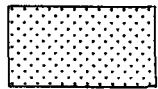
Die Suid Afrikaanse Nasionale Padagentskap Beperk The South African National Roads Agency Limited	Die figuur getoon The figure shown	 steldie podreserwe voor van 'n gedeelte represents the road reserve of a portion van Nasionale Roete N11 Seksie of National Route Section	Vel Sheet 1 van 9 Plan P631/07
9			9

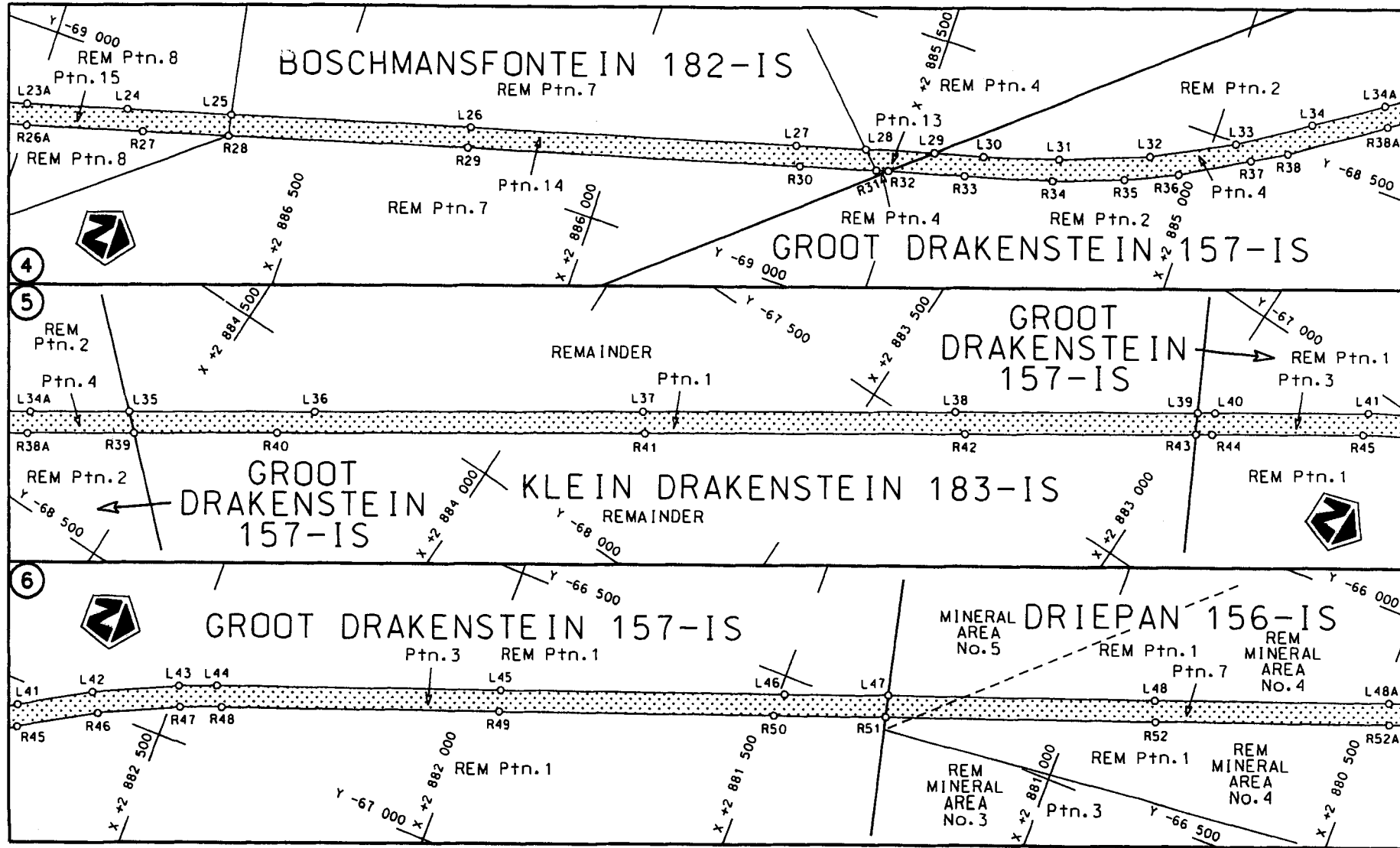

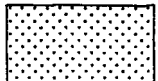
<p>Die Suid Afrikaanse Nasionale Padagentskop Beperk</p>	<p>Die figuur getoon</p>		<p>steldie podreserwe voor van 'n gedeelte represents the road reserve of a portion</p>	<p>Vel Sheet 2 van 9</p>
<p>The South African National Roads Agency Limited</p>	<p>The figure shown</p>		<p>van Nasionale Roete N11 Seksie Section 9</p>	<p>Plan P631/07</p>

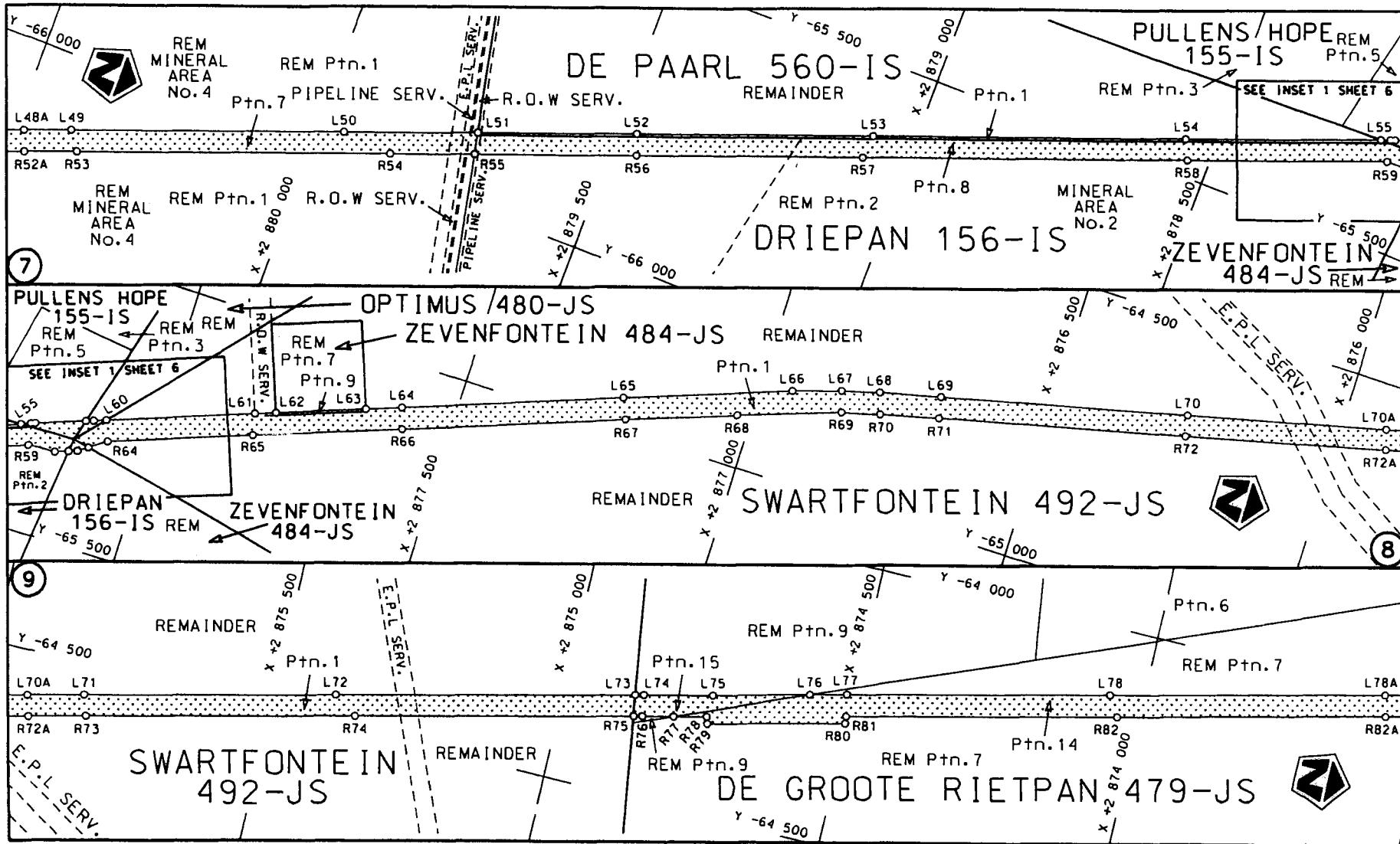

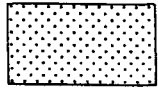
Die Suid Afrikaanse Nasionale Padagentskap Beperk The South African National Roads Agency Limited	Die figuur getoon The figure shown	 steldie padreserwe voor van 'n gedeelte represents the road reserve of a portion von Nasionale Roete N11 Seksie of National Route Section	Vel Sheet 3 van 9 Plan P631/07
--	---------------------------------------	---	-----------------------------------

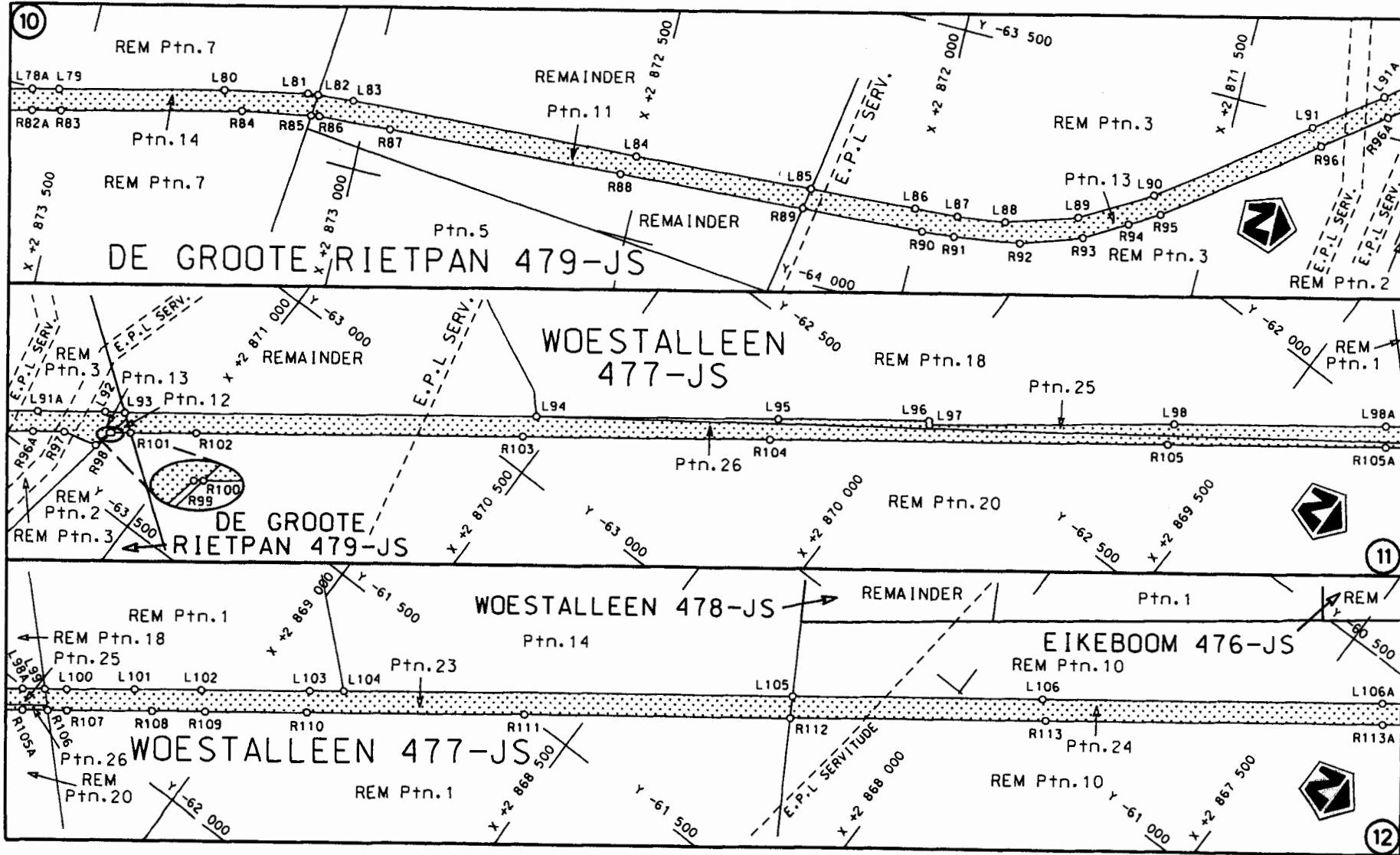

<p>Die Suid Afrikaanse Nasionale Padagentskop Beperk The South African National Roads Agency Limited</p>	<p>Die figuur getoon The figure shown</p>		<p>steldie padreserwe voor van 'n gedeelte represents the road reserve of a portion van Nasionale Roete N11 Seksie 9 of National Route N11 Section 9</p>	<p>Vel Sheet 4 van 9 of</p>	<p>Plan P631/07</p>
--	---	--	--	---------------------------------	---------------------

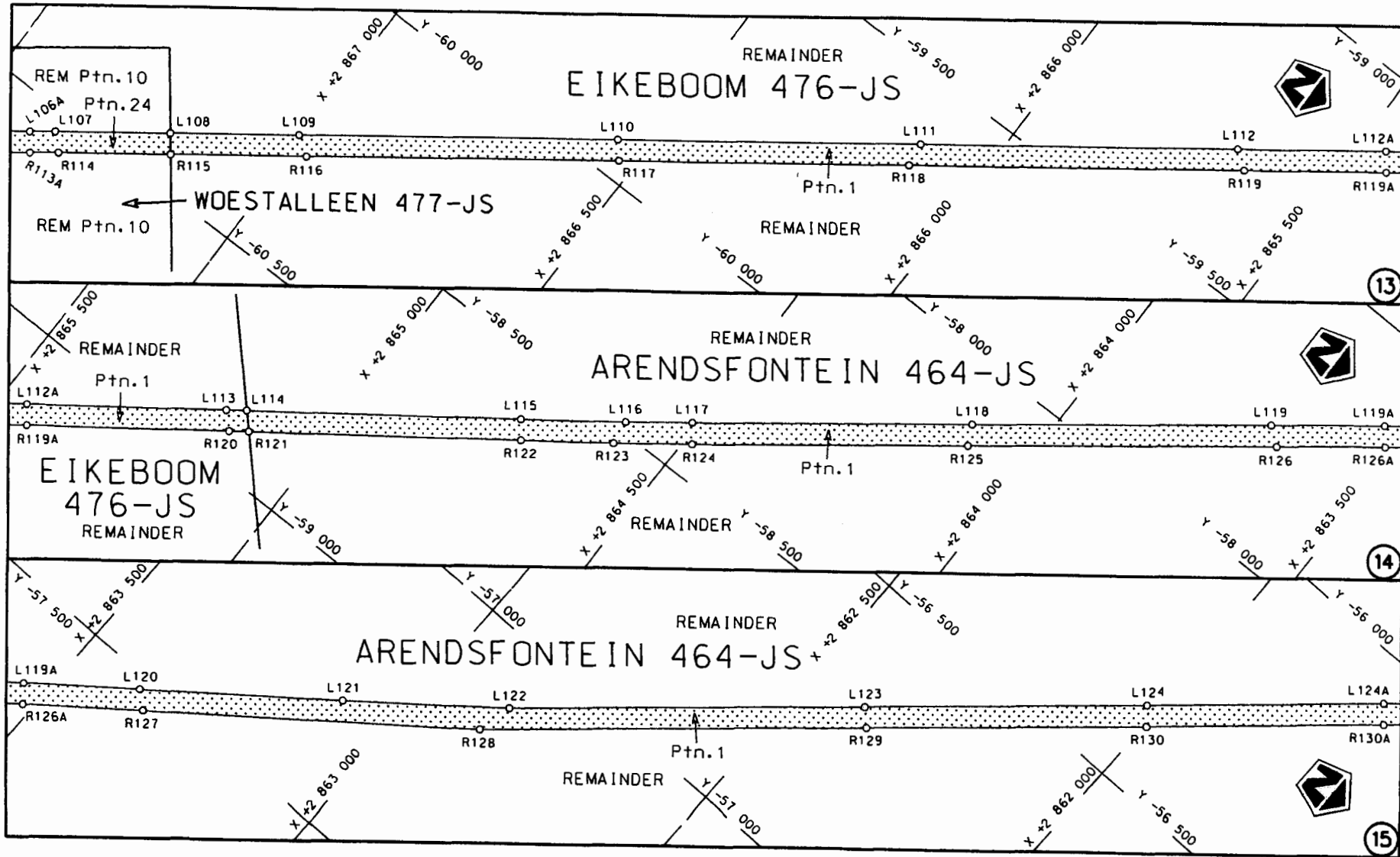

Die Suid Afrikaanse Nasionale Padogentskap Beperk The South African National Roads Agency Limited	Die figuur getoon The figure shown		steldie padreserwe voor van 'n gedeelte represents the road reserve of a portion van Nasionale Roete N11 Seksie 9 of National Route Section	Vel Sheet 5 van 9 of Plan P631/07
--	---------------------------------------	--	--	--------------------------------------

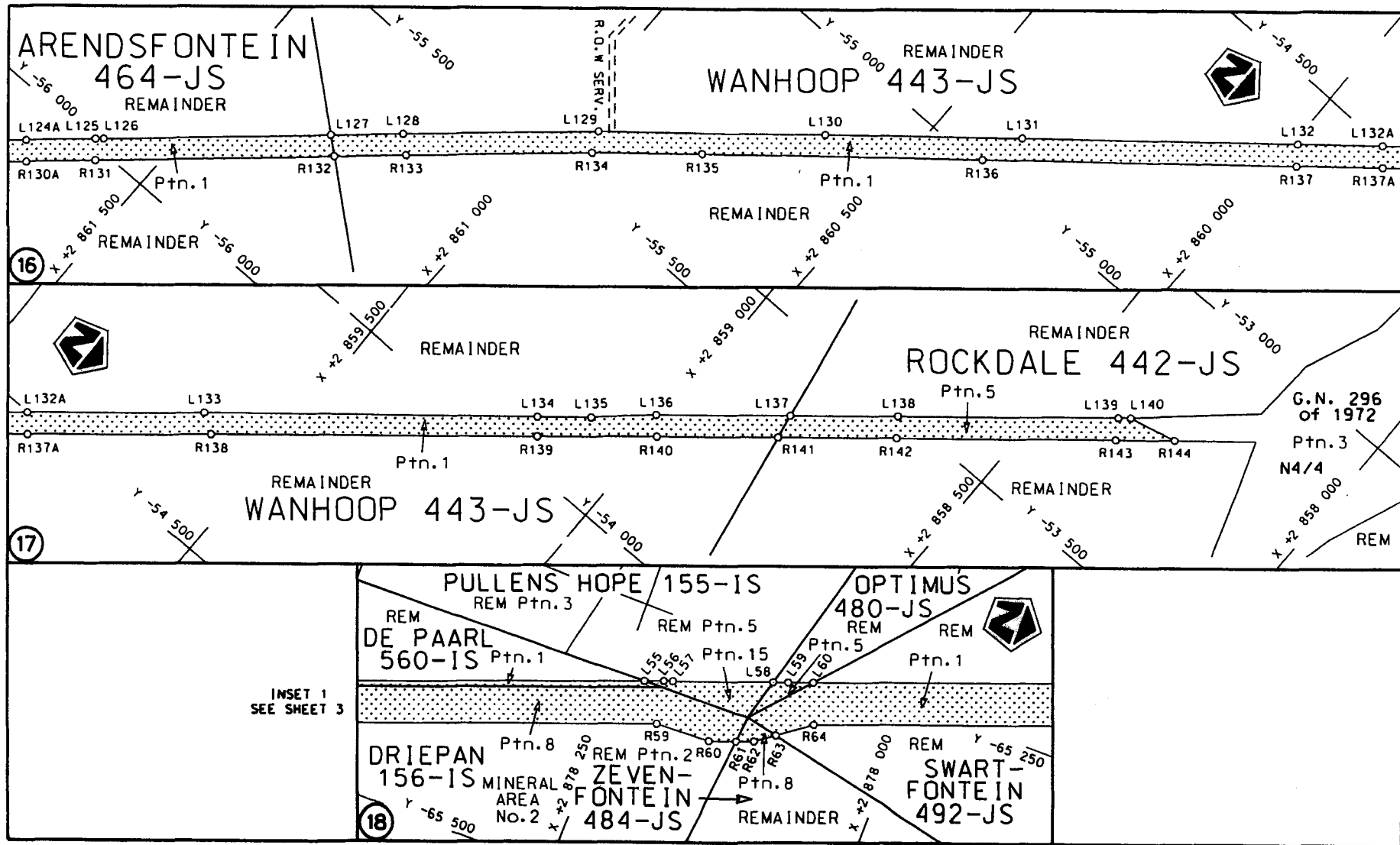

<p>Die Suid Afrikaanse Nasionale Padagentskap Beperk The South African National Roads Agency Limited</p>	<p>Die figuur getoon The figure shown</p>	<p>steldie padreserwe voar van 'n gedeelte represents the road reserve of a portion van Nasionale Roete N1 Seksie Section of National Route 9</p>	<p>Vel Sheet 6 van of 9 Plan P631/07</p>
--	---	---	--

PADRESERWE KOÖRDINATE				/	ROAD RESERVE CO-ORDINATES			
LINKERKANT/LEFT HAND SIDE					REGTERKANT/RIGHT HAND SIDE			
	Y	X	WG 29°		Y	X		
L1	-71 258.200	2 893 913.580		R1	-71 285.550	2 893 890.280		
L2	-71 226.110	2 893 892.270		R2	-71 217.590	2 893 838.950		
L3	-71 199.210	2 893 869.090		R3	-71 171.830	2 893 790.570		
L4	-71 175.430	2 893 848.600		R4	-71 155.040	2 893 772.250		
L5	-71 137.940	2 893 807.220		R5	-71 135.810	2 893 745.330		
L6	-71 088.370	2 893 742.510		R6	-71 107.980	2 893 705.950		
L7	-71 061.440	2 893 699.730		R7	-71 091.230	2 893 674.920		
L8	-71 058.820	2 893 695.580		R8	-71 074.910	2 893 644.710		
L9	-71 024.530	2 893 624.840		R9	-71 039.060	2 893 545.710		
L10	-70 999.720	2 893 567.940		R10	-71 032.550	2 893 520.610		
L11	-70 954.640	2 893 385.760		R11	-70 986.840	2 893 358.250		
L12	-70 876.890	2 893 112.840		R12	-70 973.880	2 893 320.160		
L13	-70 694.940	2 892 477.310		R13	-70 830.270	2 892 815.600		
L14	-70 687.410	2 892 449.630		R14	-70 724.430	2 892 443.120		
L15	-70 537.230	2 891 924.530		R15	-70 575.410	2 891 920.930		
L16	-70 412.730	2 891 486.220		R16	-70 449.130	2 891 479.420		
L17	-70 262.830	2 890 961.630		R17	-70 299.100	2 890 952.560		
L18	-70 241.800	2 890 889.770		R18	-70 273.510	2 890 863.090		
L19	-70 063.340	2 890 261.910		R19	-70 102.270	2 890 263.270		
L20	-69 882.850	2 889 631.480		R20	-69 916.720	2 889 613.550		
L21	-69 405.310	2 887 958.380		R21	-69 766.160	2 889 084.580		
L22	-69 238.530	2 887 372.540		R22	-69 619.140	2 888 568.410		
L23	-69 176.900	2 887 157.330		R23	-69 478.040	2 888 079.800		
L24	-69 085.900	2 886 839.570		R24	-69 432.240	2 887 915.680		
L25	-69 035.860	2 886 663.310		R25	-69 268.510	2 887 341.960		
L26	-68 920.030	2 886 255.280		R26	-69 208.580	2 887 132.040		
L27	-68 760.900	2 885 696.330		R27	-69 114.160	2 886 801.370		
L28	-68 726.420	2 885 577.140		R28	-69 072.850	2 886 656.320		
L29	-68 692.540	2 885 459.960		R29	-68 955.460	2 886 248.030		
L30	-68 670.410	2 885 376.260		R30	-68 792.960	2 885 679.580		
L31	-68 631.160	2 885 248.070		R31	-68 755.500	2 885 547.730		
L32	-68 573.180	2 885 097.260		R32	-68 749.590	2 885 526.910		
L33	-68 504.610	2 884 959.560		R33	-68 713.020	2 885 397.100		
L34	-68 428.610	2 884 842.730		R34	-68 670.450	2 885 247.020		
L35	-68 257.630	2 884 584.450		R35	-68 626.610	2 885 127.560		
L36	-68 077.680	2 884 312.600		R36	-68 586.510	2 885 038.760		
L37	-67 753.210	2 883 824.990		R37	-68 522.930	2 884 925.500		
L38	-67 445.700	2 883 362.760		R38	-68 490.220	2 884 867.350		
L39	-67 208.080	2 883 004.200		R39	-68 283.900	2 884 556.760		
L40	-67 191.600	2 882 978.840		R40	-68 144.390	2 884 346.760		
L41	-67 041.010	2 882 752.070		R41	-67 782.550	2 883 801.760		
L42	-66 972.350	2 882 635.460		R42	-67 468.080	2 883 327.780		
L43	-66 907.440	2 882 497.740		R43	-67 241.790	2 882 986.500		
L44	-66 882.890	2 882 435.250		R44	-67 225.580	2 882 962.410		
L45	-66 707.320	2 881 963.220		R45	-67 077.530	2 882 739.220		
L46	-66 531.220	2 881 490.550		R46	-67 003.440	2 882 613.880		
L47	-66 465.710	2 881 316.700		R47	-66 941.550	2 882 482.880		
L48	-66 301.080	2 880 874.180		R48	-66 915.250	2 882 413.900		
L49	-66 126.210	2 880 405.740		R49	-66 743.390	2 881 952.490		
L50	-65 958.290	2 879 954.070		R50	-66 572.810	2 881 494.800		
L51	-65 874.660	2 879 730.460		R51	-66 503.260	2 881 307.550		

Vel	7	Van	9	P631/07
Sheet		of		



PADRESERWE KOÖRDINATE				ROAD RESERVE CO-ORDINATES			
LINKERKANT/LEFT HAND SIDE				REGTERKANT/RIGHT HAND SIDE			
	Y	X	WG 29°		Y	X	
L52	-65 775.730	2 879 465.240		R52	-66 336.230	2 880 859.950	
L53	-65 629.750	2 879 072.080		R53	-66 158.220	2 880 383.360	
L54	-65 436.830	2 878 552.490		R54	-65 964.190	2 879 863.440	
L55	-65 315.120	2 878 228.080		R55	-65 911.850	2 879 722.870	
L56	-65 309.070	2 878 211.980		R56	-65 811.220	2 879 452.580	
L57	-65 306.260	2 878 204.290		R57	-65 671.250	2 879 076.440	
L58	-65 275.720	2 878 120.300		R58	-65 470.390	2 878 537.000	
L59	-65 271.130	2 878 107.690		R59	-65 346.850	2 878 204.820	
L60	-65 263.420	2 878 087.060		R60	-65 344.620	2 878 155.910	
L61	-65 171.150	2 877 840.230		R61	-65 336.410	2 878 133.060	
L62	-65 158.110	2 877 805.160		R62	-65 331.060	2 878 118.150	
L63	-65 102.310	2 877 655.180		R63	-65 319.170	2 878 102.000	
L64	-65 079.740	2 877 594.520		R64	-65 298.290	2 878 073.640	
L65	-64 942.490	2 877 225.700		R65	-65 208.690	2 877 833.020	
L66	-64 838.250	2 876 944.870		R66	-65 116.230	2 877 582.620	
L67	-64 811.100	2 876 861.720		R67	-64 977.940	2 877 210.730	
L68	-64 792.950	2 876 795.510		R68	-64 909.610	2 877 025.630	
L69	-64 767.330	2 876 690.680		R69	-64 847.320	2 876 850.900	
L70	-64 662.830	2 876 264.610		R70	-64 829.680	2 876 783.600	
L71	-64 554.310	2 875 824.080		R71	-64 803.800	2 876 683.100	
L72	-64 448.250	2 875 392.430		R72	-64 699.320	2 876 257.180	
L73	-64 321.330	2 874 875.750		R73	-64 589.380	2 875 812.900	
L74	-64 317.680	2 874 860.900		R74	-64 476.140	2 875 351.380	
L75	-64 288.650	2 874 742.890		R75	-64 358.060	2 874 870.410	
L76	-64 246.670	2 874 575.750		R76	-64 354.340	2 874 855.250	
L77	-64 230.580	2 874 511.680		R77	-64 341.180	2 874 801.600	
L78	-64 119.180	2 874 059.340		R78	-64 327.360	2 874 745.210	
L79	-63 991.120	2 873 537.560		R79	-64 339.290	2 874 741.410	
L80	-63 921.500	2 873 253.600		R80	-64 280.470	2 874 503.630	
L81	-63 892.810	2 873 110.030		R81	-64 267.980	2 874 504.780	
L82	-63 891.030	2 873 091.830		R82	-64 153.150	2 874 038.920	
L83	-63 884.780	2 873 027.850		R83	-64 026.070	2 873 525.190	
L84	-63 856.740	2 872 514.330		R84	-63 949.870	2 873 214.480	
L85	-63 836.330	2 872 200.180		R85	-63 928.920	2 873 095.220	
L86	-63 824.960	2 872 012.180		R86	-63 926.390	2 873 080.830	
L87	-63 820.760	2 871 936.360		R87	-63 918.080	2 872 952.410	
L88	-63 809.170	2 871 851.170		R88	-63 893.330	2 872 534.780	
L89	-63 769.630	2 871 727.860		R89	-63 873.680	2 872 206.620	
L90	-63 698.740	2 871 605.830		R90	-63 861.340	2 871 991.000	
L91	-63 516.320	2 871 360.660		R91	-63 856.500	2 871 934.010	
L92	-63 361.970	2 871 153.550		R92	-63 839.110	2 871 816.960	
L93	-63 341.950	2 871 124.720		R93	-63 802.680	2 871 711.500	
L94	-62 904.870	2 870 539.560		R94	-63 759.180	2 871 638.240	
L95	-62 647.920	2 870 195.000		R95	-63 728.890	2 871 586.950	
L96	-62 487.620	2 869 980.050		R96	-63 544.190	2 871 338.040	
L97	-62 493.170	2 869 974.740		R97	-63 433.750	2 871 189.550	
L98	-62 228.260	2 869 630.110		R98	-63 419.480	2 871 130.840	
L99	-61 979.810	2 869 296.560		R99	-63 386.920	2 871 124.830	
L100	-61 956.110	2 869 264.740		R100	-63 384.670	2 871 121.850	
L101	-61 883.500	2 869 169.180		R101	-63 364.270	2 871 094.850	
L102	-61 813.990	2 869 074.770		R102	-63 295.030	2 871 003.170	

Vel  
Sheet

8 Van  
of

9 P631/07

PADRESERWE KOÖRDINATE				/ ROAD RESERVE CO-ORDINATES			
LINKERKANT/LEFT HAND SIDE				REGTERKANT/RIGHT HAND SIDE			
	Y	X	WG 29°		Y	X	
L103	-61 700.390	2 868 922.310		R103	-62 947.940	2 870 536.790	
L104	-61 663.520	2 868 873.740		R104	-62 685.870	2 870 184.210	
L105	-61 186.150	2 868 231.680		R105	-62 264.750	2 869 617.220	
L106	-60 921.620	2 867 875.650		R106	-62 006.720	2 869 269.920	
L107	-60 533.760	2 867 354.070		R107	-61 986.020	2 869 242.070	
L108	-60 412.570	2 867 191.470		R108	-61 896.320	2 869 121.810	
L109	-60 275.840	2 867 008.010		R109	-61 840.260	2 869 046.570	
L110	-59 936.240	2 866 551.660		R110	-61 733.810	2 868 903.490	
L111	-59 614.780	2 866 119.610		R111	-61 501.320	2 868 590.550	
L112	-59 278.100	2 865 667.360		R112	-61 219.350	2 868 211.980	
L113	-58 909.420	2 865 172.290		R113	-60 948.530	2 867 848.650	
L114	-58 887.770	2 865 143.260		R114	-60 560.270	2 867 327.240	
L115	-58 594.940	2 864 750.620		R115	-60 442.370	2 867 168.590	
L116	-58 483.560	2 864 601.060		R116	-60 298.470	2 866 974.960	
L117	-58 410.640	2 864 508.220		R117	-59 965.280	2 866 527.650	
L118	-58 103.090	2 864 115.830		R118	-59 657.050	2 866 113.310	
L119	-57 774.240	2 863 699.070		R119	-59 301.240	2 865 636.040	
L120	-57 521.440	2 863 378.340		R120	-58 935.750	2 865 145.160	
L121	-57 297.570	2 863 094.950		R121	-58 915.080	2 865 117.460	
L122	-57 111.050	2 862 863.650		R122	-58 624.500	2 864 727.960	
L123	-56 690.450	2 862 391.810		R123	-58 526.570	2 864 595.380	
L124	-56 356.320	2 862 018.570		R124	-58 441.090	2 864 485.400	
L125	-55 991.660	2 861 611.400		R125	-58 137.560	2 864 099.300	
L126	-55 981.670	2 861 600.320		R126	-57 798.190	2 863 668.380	
L127	-55 715.190	2 861 302.310		R127	-57 546.400	2 863 349.650	
L128	-55 628.770	2 861 205.660		R128	-57 174.690	2 862 878.880	
L129	-55 396.140	2 860 944.250		R129	-56 716.540	2 862 365.750	
L130	-55 136.740	2 860 636.510		R130	-56 385.520	2 861 995.070	
L131	-54 911.260	2 860 367.670		R131	-56 020.410	2 861 587.270	
L132	-54 597.950	2 859 991.440		R132	-55 739.380	2 861 273.270	
L133	-54 299.350	2 859 633.850		R133	-55 653.540	2 861 177.370	
L134	-53 922.050	2 859 176.540		R134	-55 432.040	2 860 928.760	
L135	-53 860.950	2 859 102.840		R135	-55 305.390	2 860 780.000	
L136	-53 784.430	2 859 016.930		R136	-54 986.110	2 860 397.140	
L137	-53 631.370	2 858 833.710		R137	-54 628.580	2 859 968.800	
L138	-53 508.540	2 858 686.680		R138	-54 320.480	2 859 600.530	
L139	-53 257.440	2 858 385.560		R139	-53 948.350	2 859 154.930	
L140	-53 243.600	2 858 368.880		R140	-53 812.340	2 858 991.860	
				R141	-53 674.100	2 858 826.350	
				R142	-53 538.990	2 858 664.580	
				R143	-53 289.930	2 858 364.690	
				R144	-53 223.110	2 858 283.570	