

No. 731

28 July 2006

THE SOUTH AFRICAN NATIONAL ROADS AGENCY LIMITED

DECLARATION AMENDMENT OF NATIONAL ROAD N1 SECTION 7X

AMENDMENT OF DECLARATION NO. 1322 OF 1989

By virtue of Section 40(1)(b) of The South African National Roads Agency Limited and National Roads Act, 1998 (Act No 7 of 1998) I hereby amend declaration No. 1322 of 1989 by replacing the section from Leeu Gamka to Beaufort West in paragraph 1 with the subjoined sheets 1 to 24 of Plan P574/06 .

(National Road N1 Section 7 X Leeu Gamka – Beaufort West)

MINISTER OF TRANSPORT

No. 731

28 Julie 2006

DIE SUID AFRIKAANSE NASIONALE PADAGENTS-KAP BEPERK

VERKLARING WYSIGING VAN NASIONALE PAD N1 SEKSIE 7X

WYSIGING VAN VERKLARING NO. 1322 van 1989

Kragtens artikel 40 (1)(b) van die Suid Afrikaanse Nasionale Padagentskap Beperk en Nasionale Paaie Wet (Wet No. 7 van 1998), wysig ek hiermee verklaring no. 1322 van 1989 deur daarin die gedeelte vanaf Leeu Gamka tot Beaufort Wes in paragraaf 1 te vervang deur bygaande velle 1 tot 24 van Plan P574/06.

(Nasionale Pad N1 Seksie 7X: Leeu Gamka Beaufort Wes)

MINISTER OF TRANSPORT

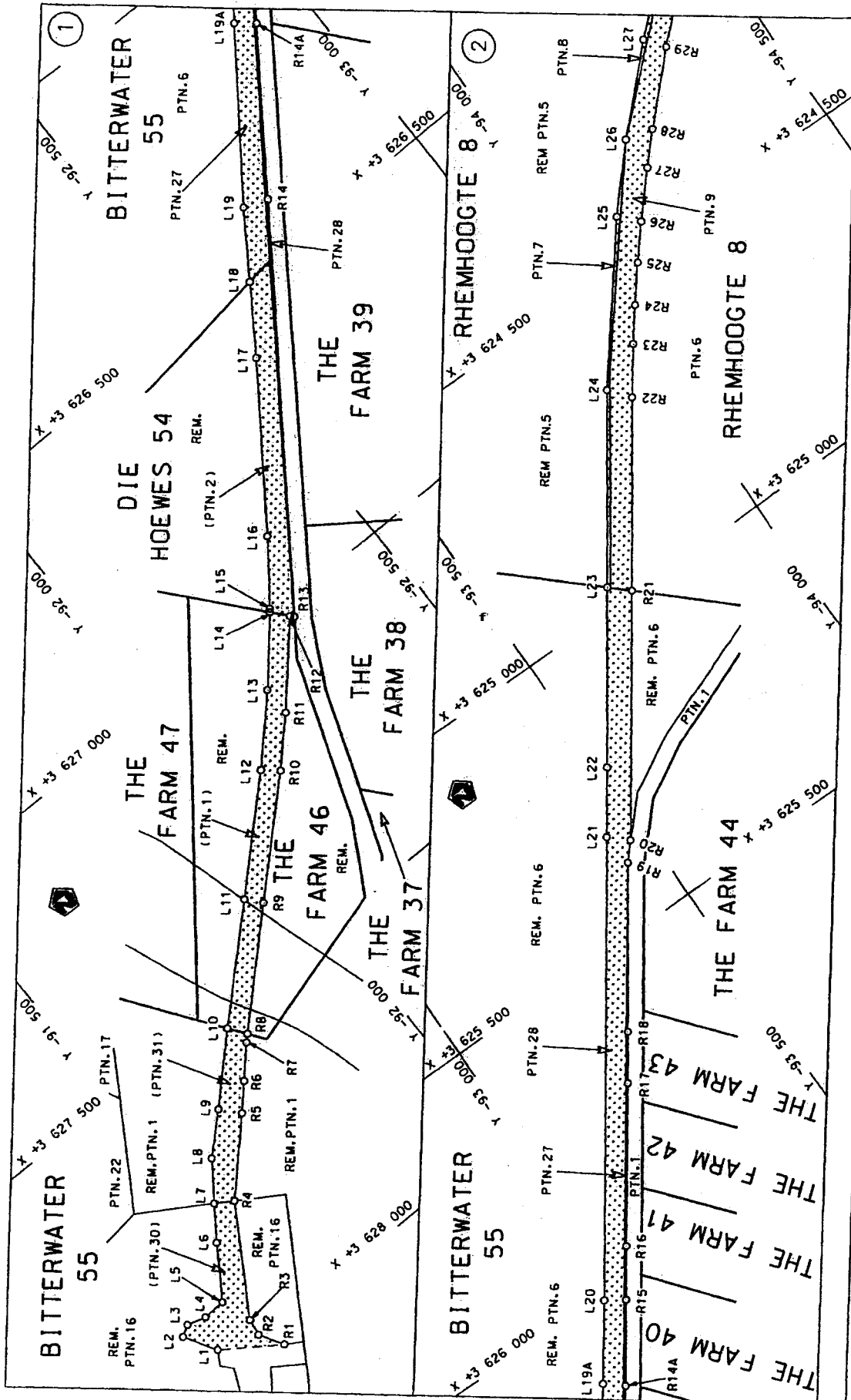

<p>Die Suid Afrikaanse Nasionale Padagentskap Beperk The South African National Roads Agency Limited</p>	<p>Die figuur getoon The figure shown</p>	<p>staldie podagreserwe voor van 'n gedeelte represents the road reserve of a portion van Nasionale Roete of National Route</p> <p>N1</p> <p>7X</p>	<p>Vel Sheet 1 of 24</p> <p>Plan P574/06</p>
--	---	---	--

D.O:9.A

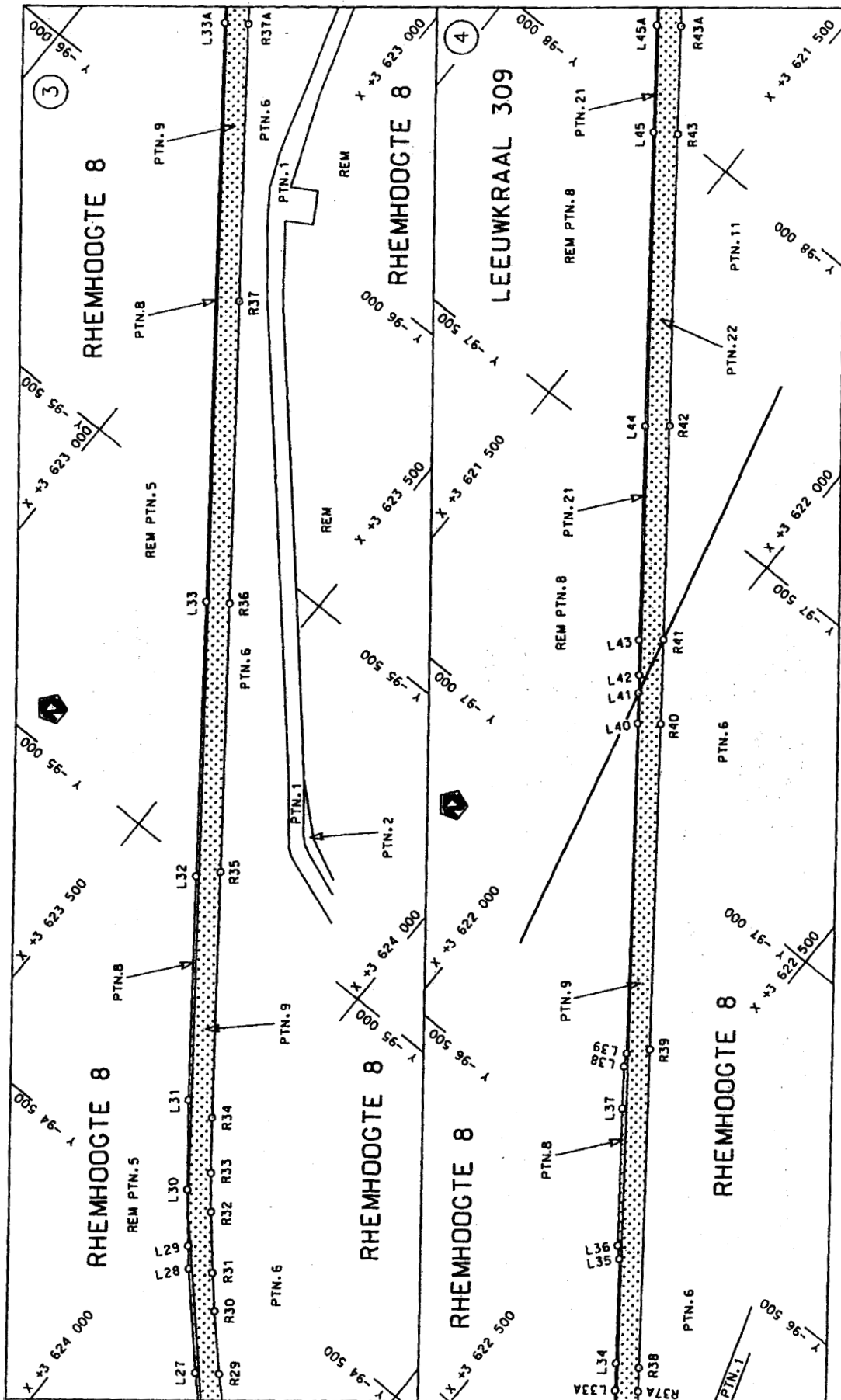

<p>Die Suid Afrikaanse Nasionale Padagentskap Beperk The South African National Roads Agency Limited</p>	<p>Die figuur getoon The figure shown</p>	<p>stel die padreserwe voor van 'n gedeelte represents the road reserve of a portion van Nasionale Roete N1 Seksie of National Route Section</p>	<p>Vel Sheet 2 of 24</p> <p>Plan P574/06</p>
--	---	--	--

0000

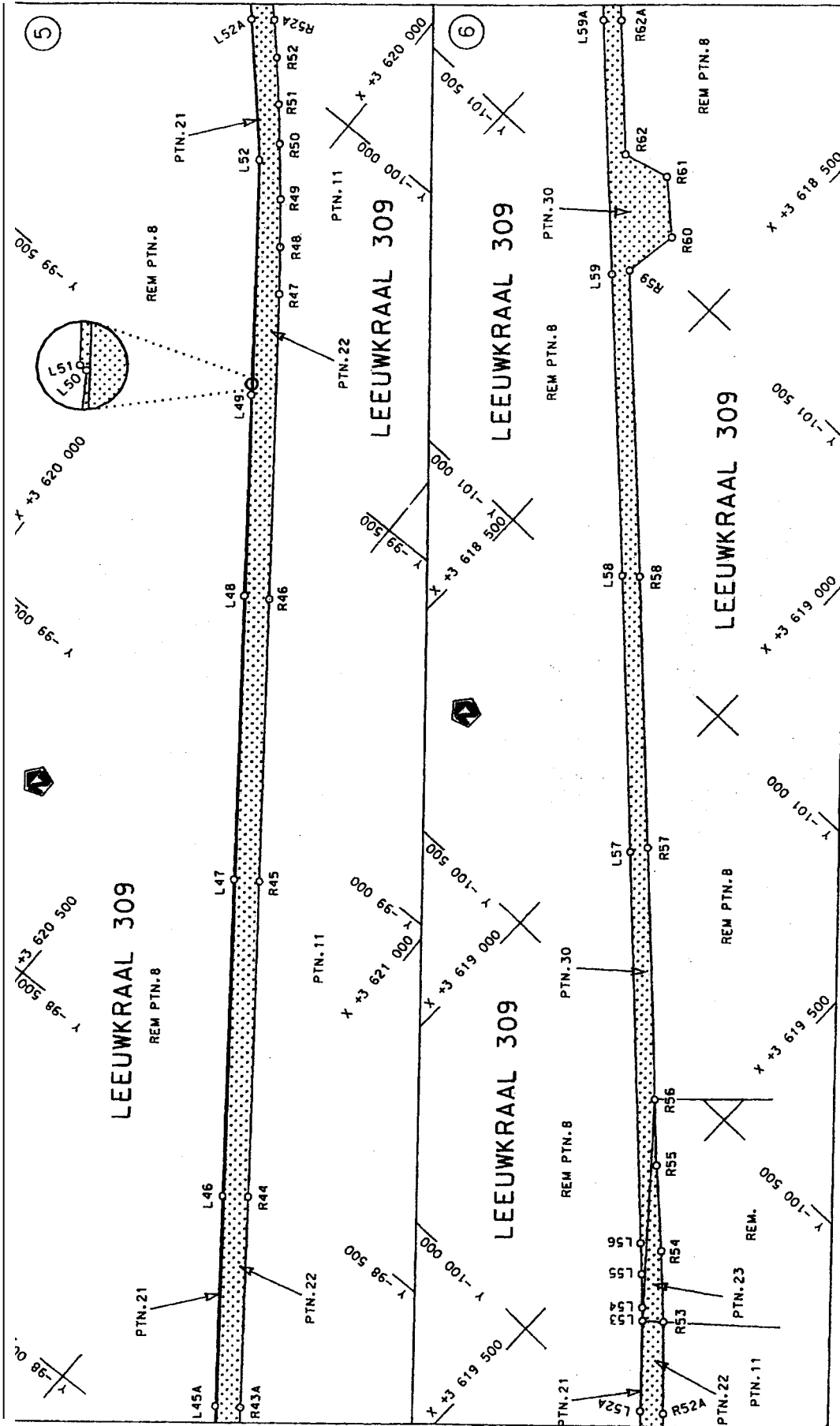

<p>Umsusiso Afrikaanse Nasionale Padouligtskoop Eepek hith South African National Roads Agency, Limited</p>	<p>Die figuur getoon The figure shown</p>	<p>stede padreserve voor van n gede r.resents the road reserve of o por v. Nasionale Rote N1 o National Rout.</p>	<p>Vel Sheet 3 of 24 Plan P574/06</p>
--	--	--	--

D.O.9.A

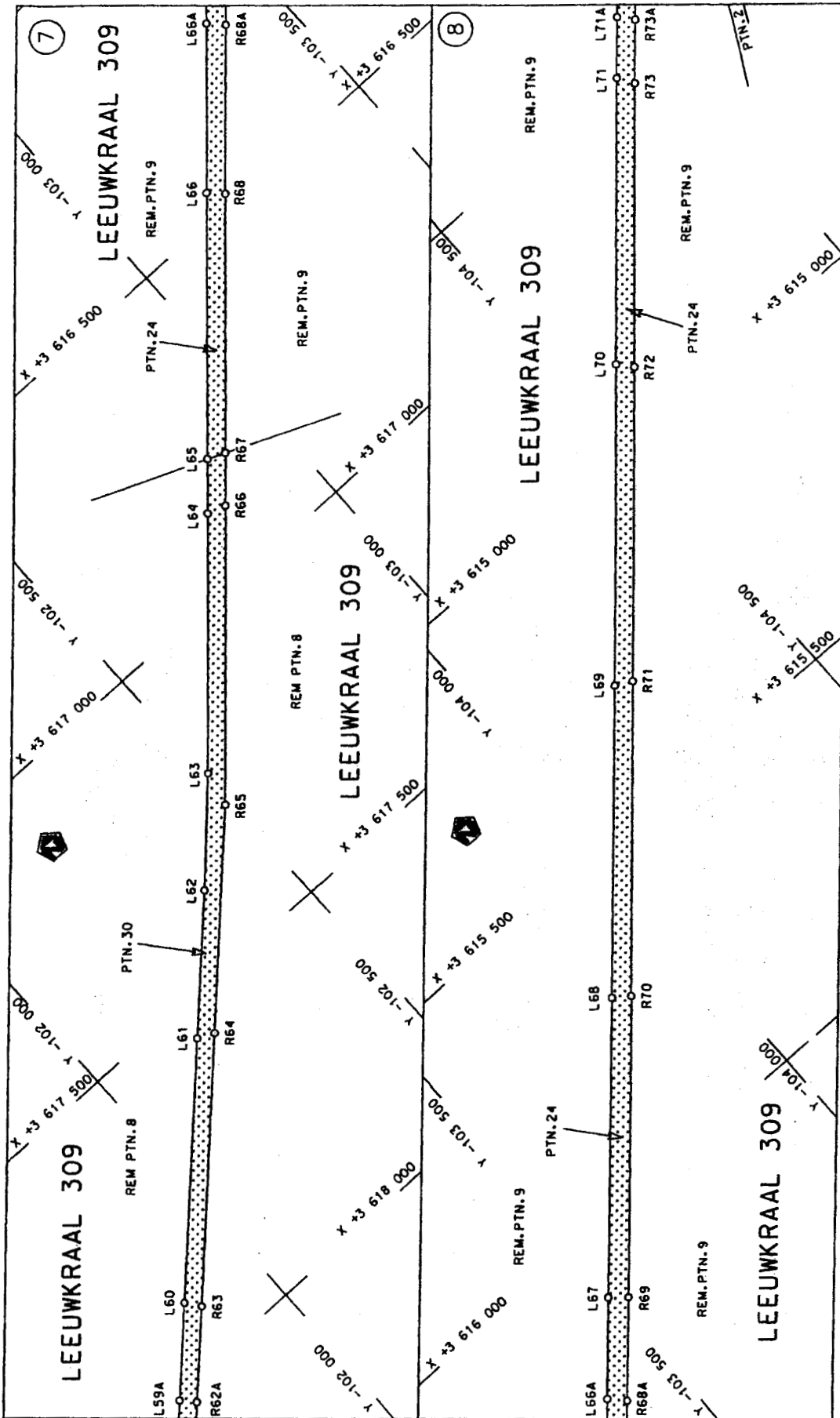

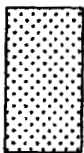
Die Suid Afrikaanse Nasionale Padagentskap Beperk The South African National Roads Agency Limited	Die figuur getoon The figure shown	 stel die padreserwe voor van 'n gedeelte represents the road reserve of a portion van Nasionale Roete N1 of National Route N1	Vel Sheet 4 of 24
			Plan P574/06

D.O.9.A

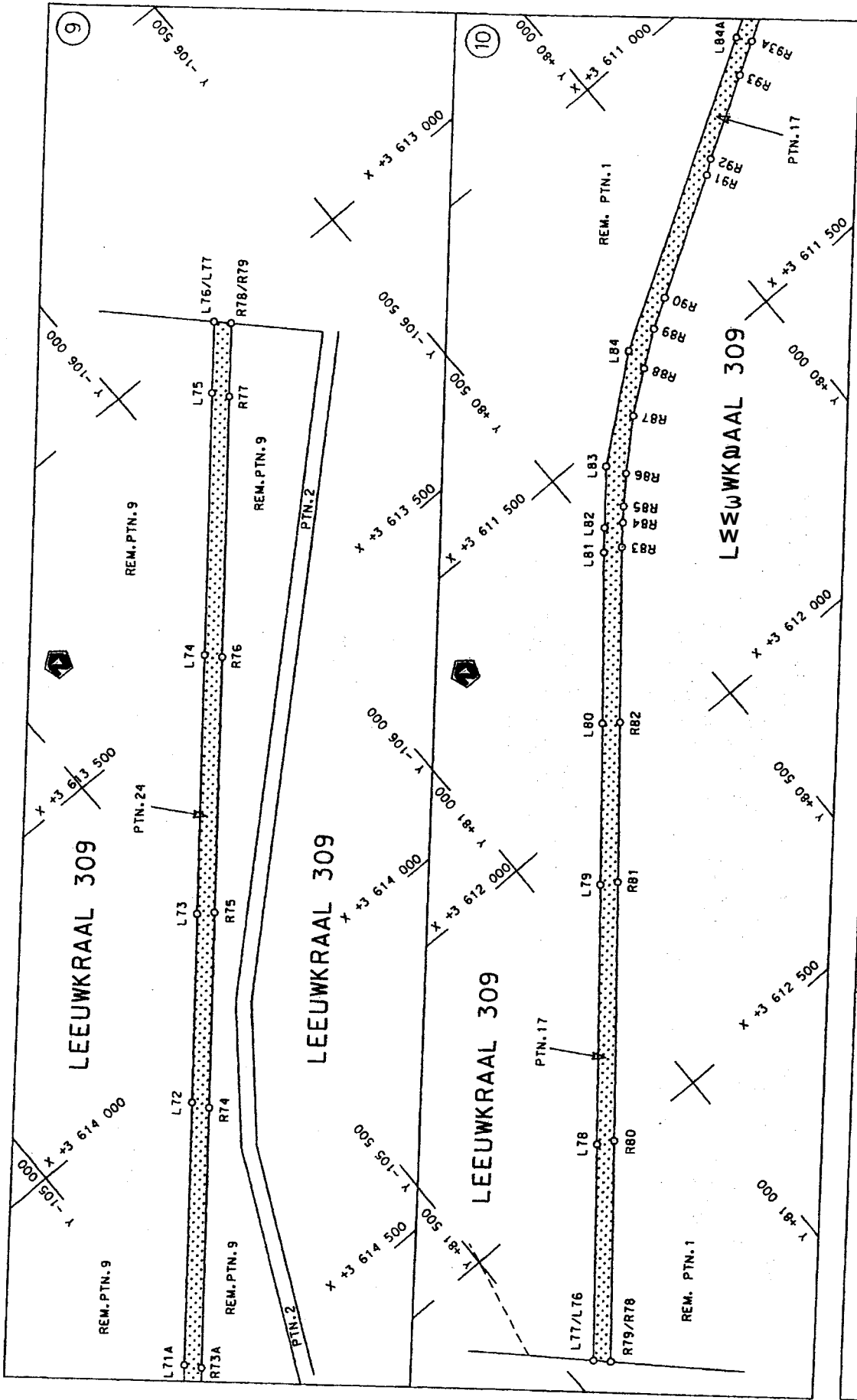

<p>Die Suid Afrikaanse Nasionale Padagentskap Beperk The South African National Roads Agency Limited</p>	<p>Die figuur getoon The figure shown</p>	 <p>stelt die padreserwe oor van 'n gedeelte represents the road reserve of a portion van Nasionale Roete N1 of National Route N1</p>	<p>Vel Sheet 5 of 24 Plan P574/06</p>
		<p>7X</p>	<p>8</p>

D.O.9.A

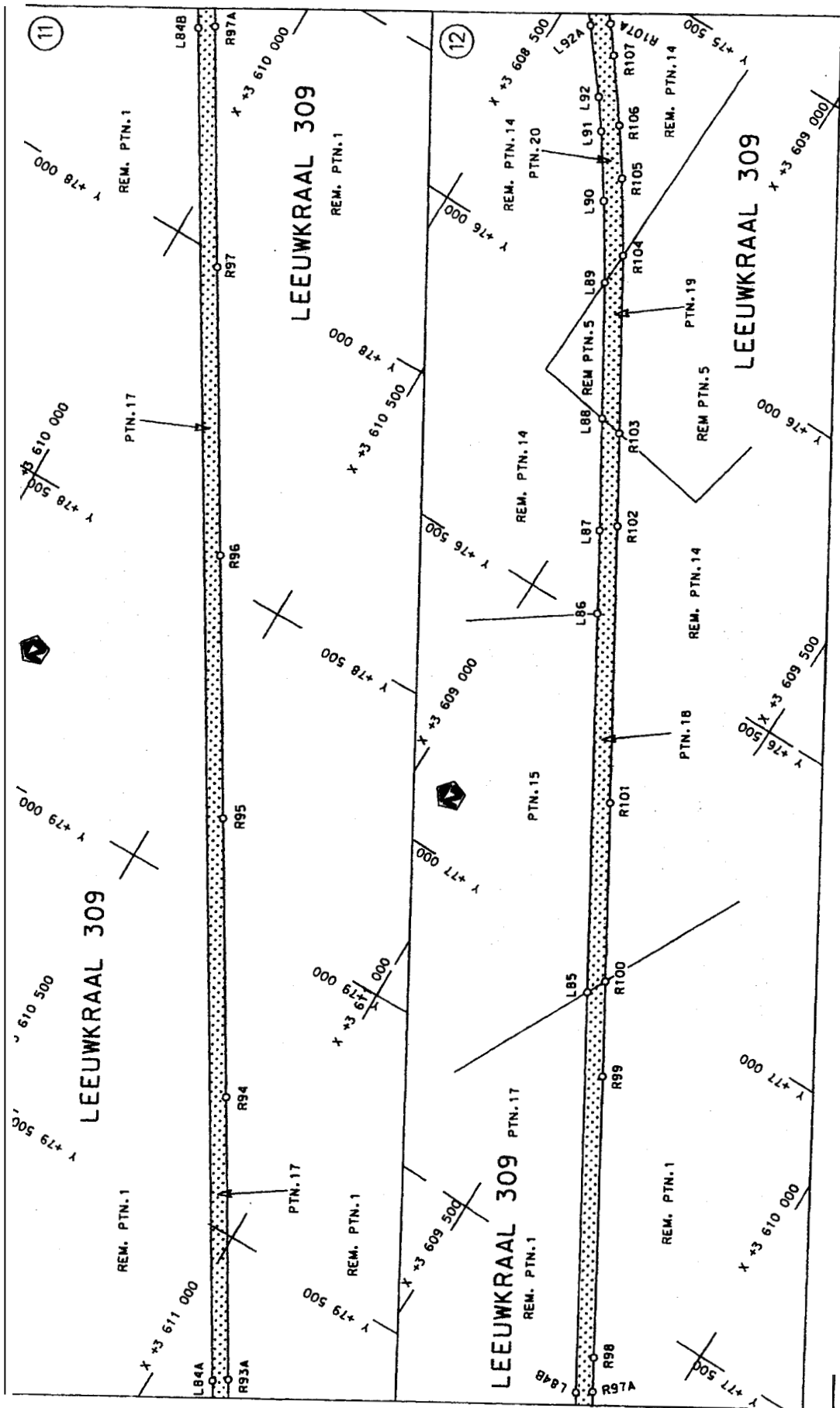

Die Suid-Afrikaanse Nasionale Padagentskap Bepoort
 The South African National Roads Agency Limited

Die figuur getoon
 The figure shown

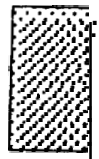

stiel die padreserwe voor van 'n gedeelte
 represents the road reserve of a portion
 van Nasionale Roete N1 Saksie
 of National Route N1

Vel
 Sheet 6
 Plan

7X

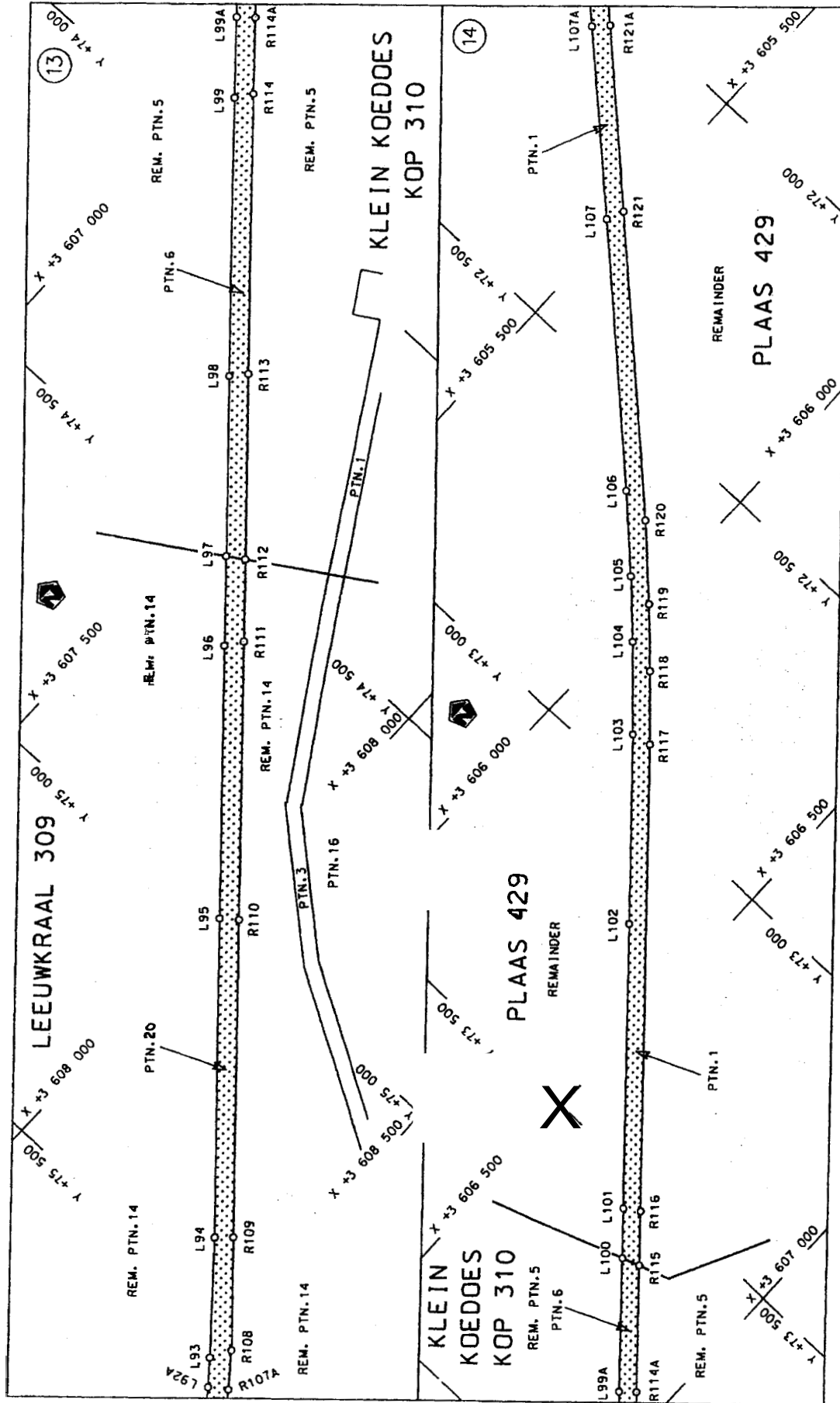

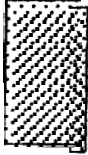
Die Suid Afrikaanse Nasionale Padagentskap Beperk The South African National Roads Agency Limited	Die figuur getoon The figure shown	 stel die padreserwe voor van 'n gedeelte represents the road reserve of a portion van Nasionale Roete N1 of National Route N1	Vel Sheet 7 van 24 Plan P574/06
--	---------------------------------------	---	---------------------------------------

D.O.9.A

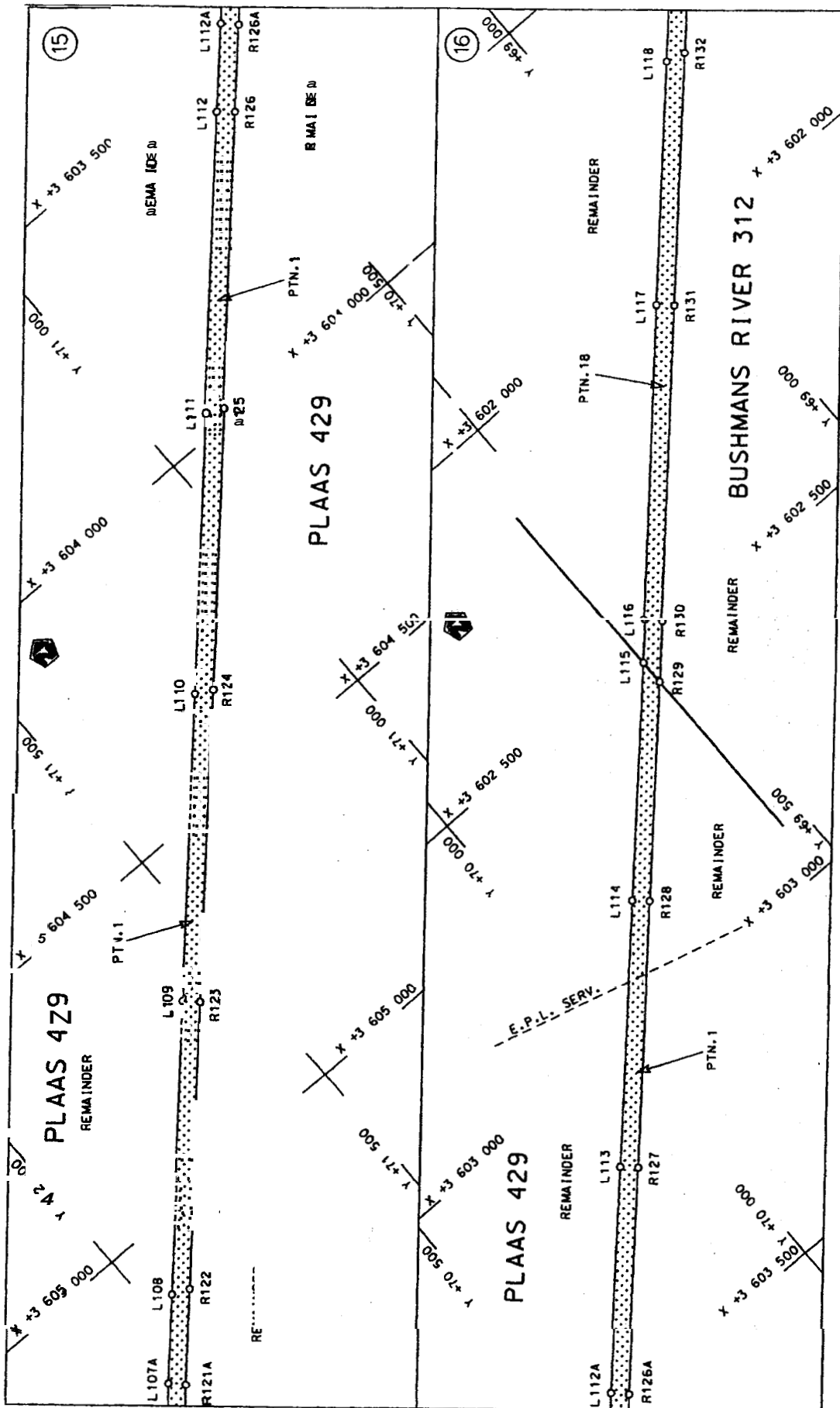

Die Suid-Afrikaanse Nasionale Padagentskap Beperk The South African National Roads Agency Limited	Die figuur toon The figure town	stel die padreserwe voor van 'n gedeelte represents the road reserve of a portion van Nasionale Roete N1 of National Route N1	Val Sheet 8 of 24 Plan P574/06
--	--	--	--------------------------------------

D.O.9.A

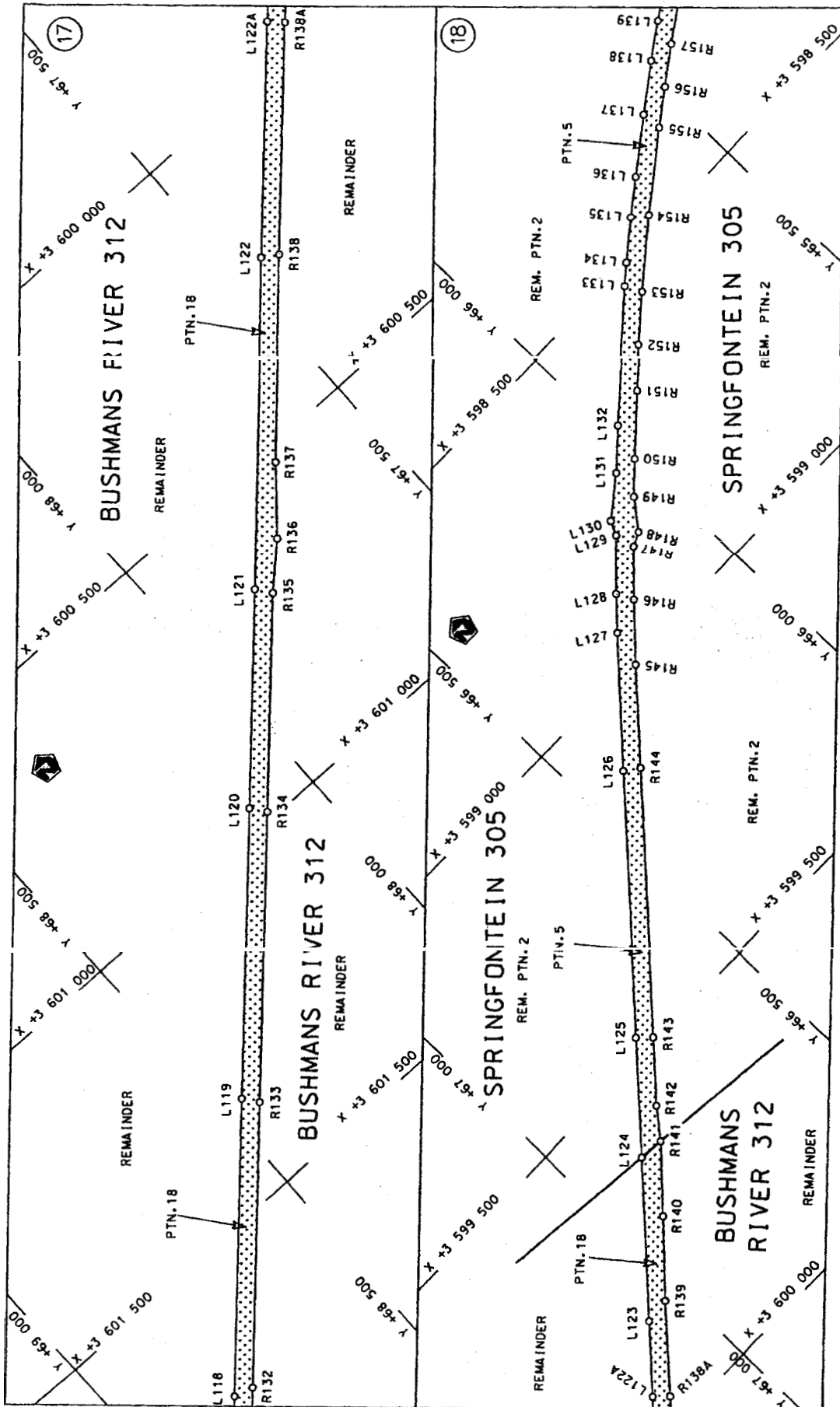

<p>Die Suid Afrikaanse Nasionale Padagentskap Beperk The South African National Roads Agency Limited</p>	<p>Die figuur getoon The figure shown</p>	<p>stel die padreserwe oor van 'n gedeelte represents the road reserve of a portion van Nasionale Roete N1 of National Route N1</p>	<p>7X</p>	<p>Vel Sheet 9 of 24 Plan P574/06</p>
--	---	---	-----------	---

0.0.9.A

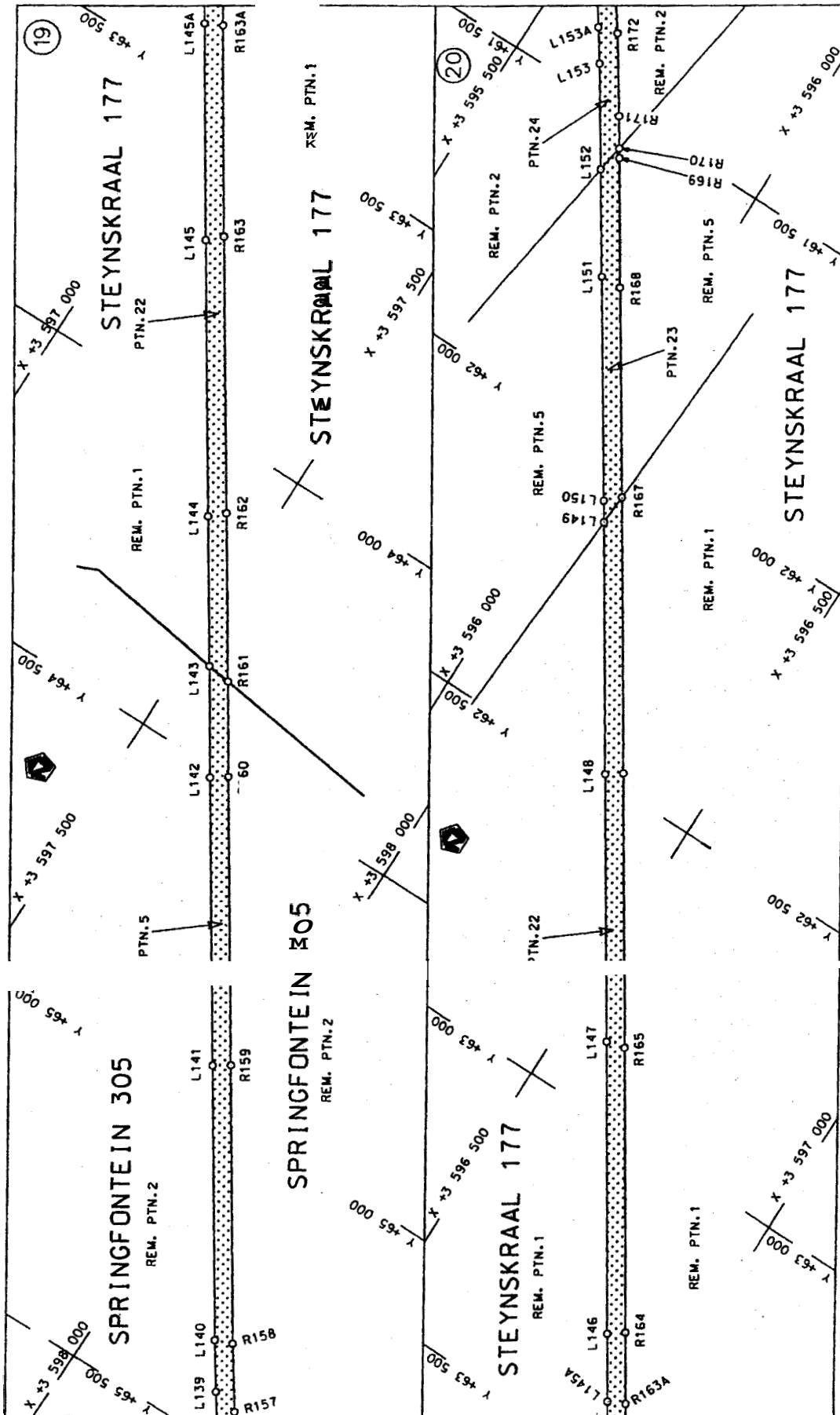

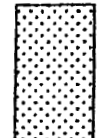
<p>Die Suid Afrikaanse Nasionale Padagentskap Beperk The South African National Roads Agency Limited</p>	<p>Die figuur getoon The figure shown</p>  <p>stel die padreserwe voor van 'n gedeelte represents the road reserve of a portion van Nasionale Roete N1 of National Route</p>	<p>Vel Sheet 10 of 24</p> <p>Plan P574/06</p>
--	---	---

D.O.G.A

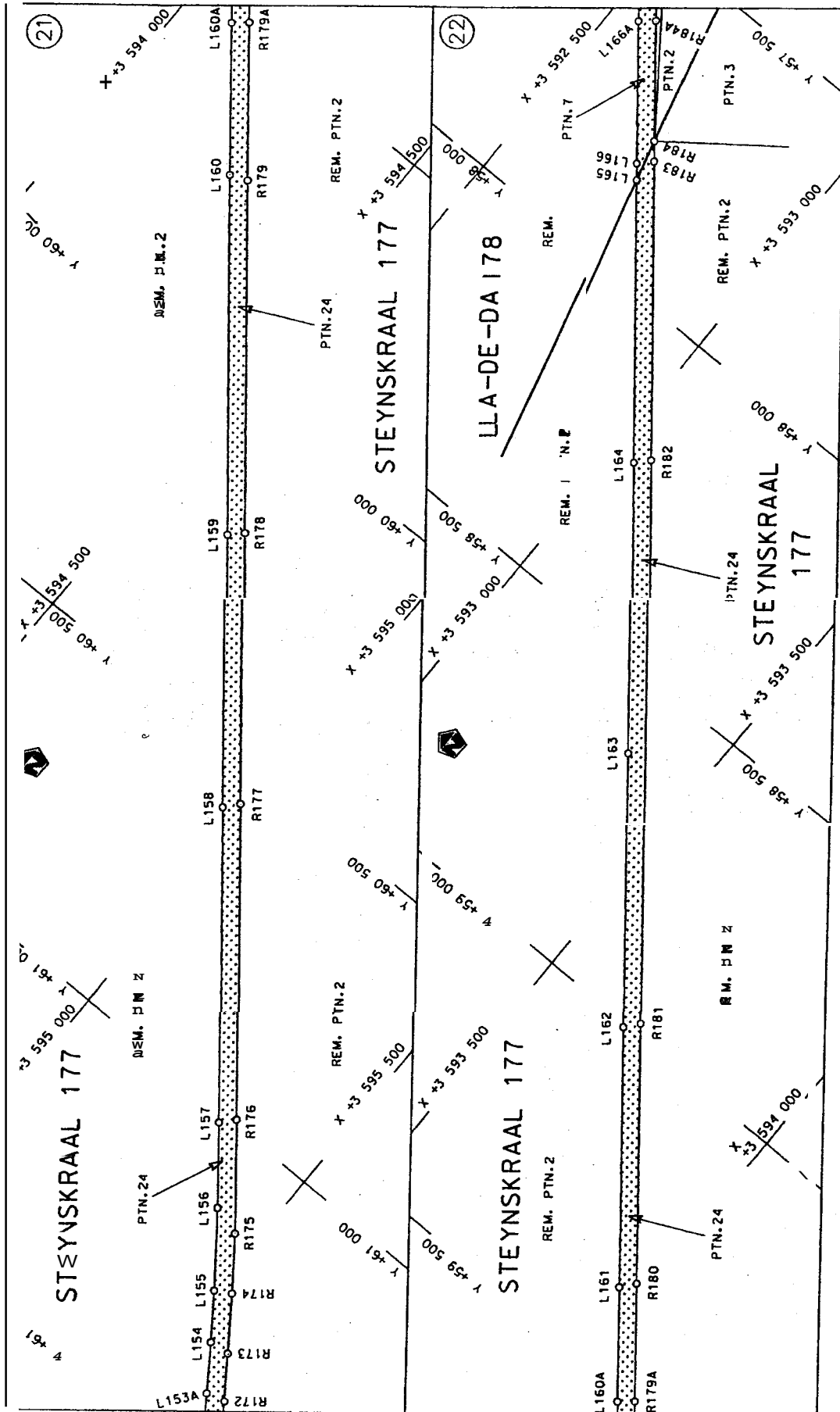

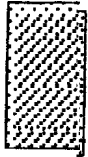
Die Suid Afrikaanse Nasionale Padogentskap Beperk The South African National Roads Agency Limited	Die figuur getoon The figure shown	 stadiese padreserwe voor van 'n gedeelte represents the road reserve of a portion van Nasionale Roete N1 of National Route	Vel Sheet
			Plan
			van of
			24
			7X
			Section
			P574/06

D.O.9A

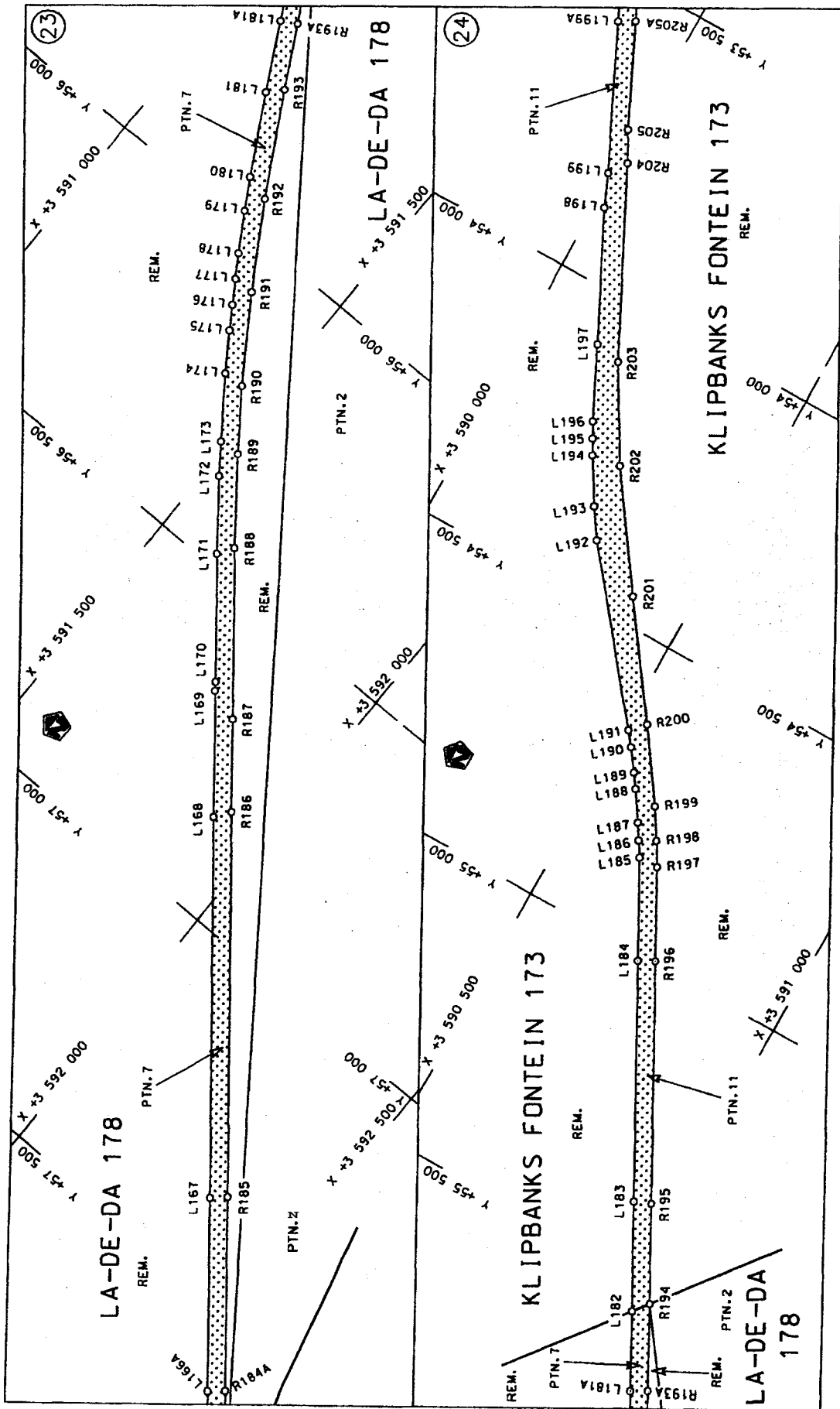

Vel	van	24
Sheet	12 of	24
Plan	P574/06	

stelsie padreserwe voor van 'n gedeelte
represents the road reserve of a portion
van Nasionale Roete N1
of National Route N1

7X
Seksie
Section

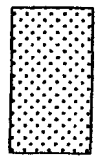

Die figuur getoon
The figure shown

The South African National Roads Agency Limited

D.O.9.A

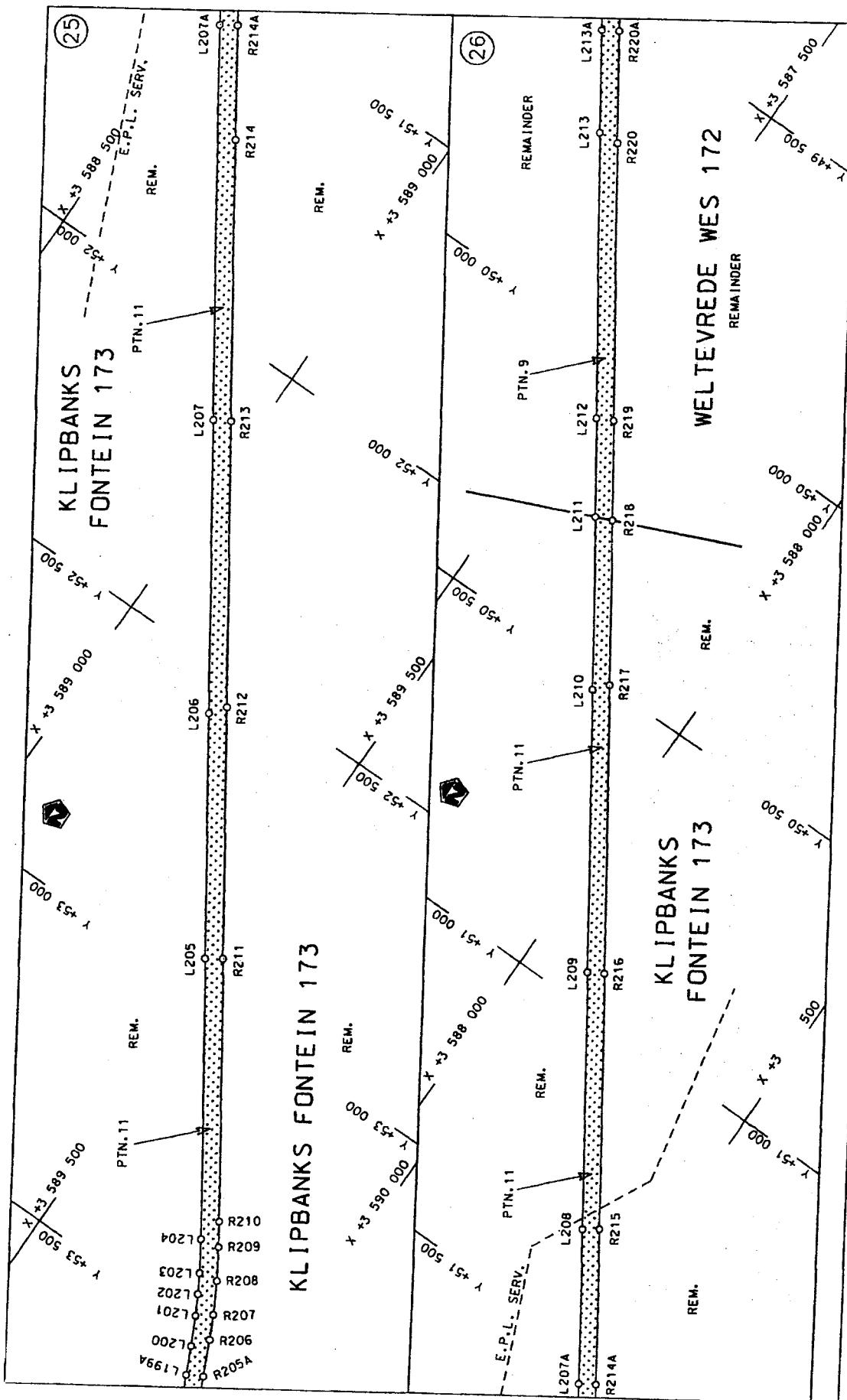

<p>Die Suid Afrikanese Nasionale Padogenskaps Bepaalkommissie The South African National Roads Agency Limited</p>	<p>Die figuur getoon The figure shown</p>	<p>stel die padreserwe voor van 'n gedeelte represents the road reserve of a portion van Nasionale Roete N1 of National Route</p>	<p>Vel Sheet 13 of 24</p> <p>Plan P574/06</p>
		<p>N1</p>	<p>7X</p>
		<p>D.O.9.A</p>	

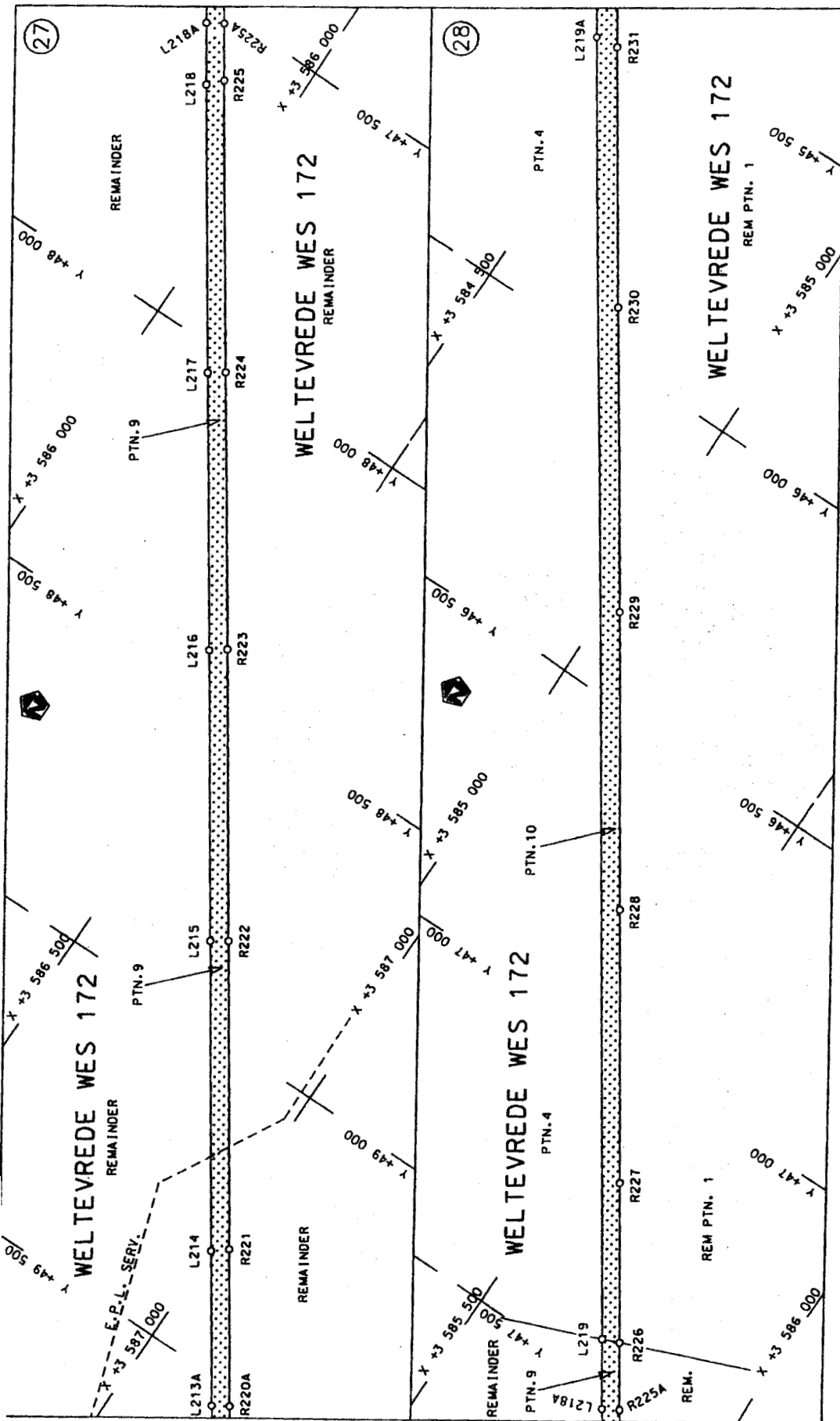

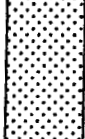
<p>Die Suid Afrikaanse Nasionale Padagentskap Beperk The South African National Roads Agency Limited</p>	<p>Die figuur getoon The figure shown</p>  <p>stelt die padreserwe voor van 'n gedeelte represents the road reserve of a portion van Nasionale Roete N1 of National Route</p>	<p>Vel Sheet 14 of 24</p> <p>Plan P574/06</p>
		<p>7X</p>
		<p>D.O.9.A</p>

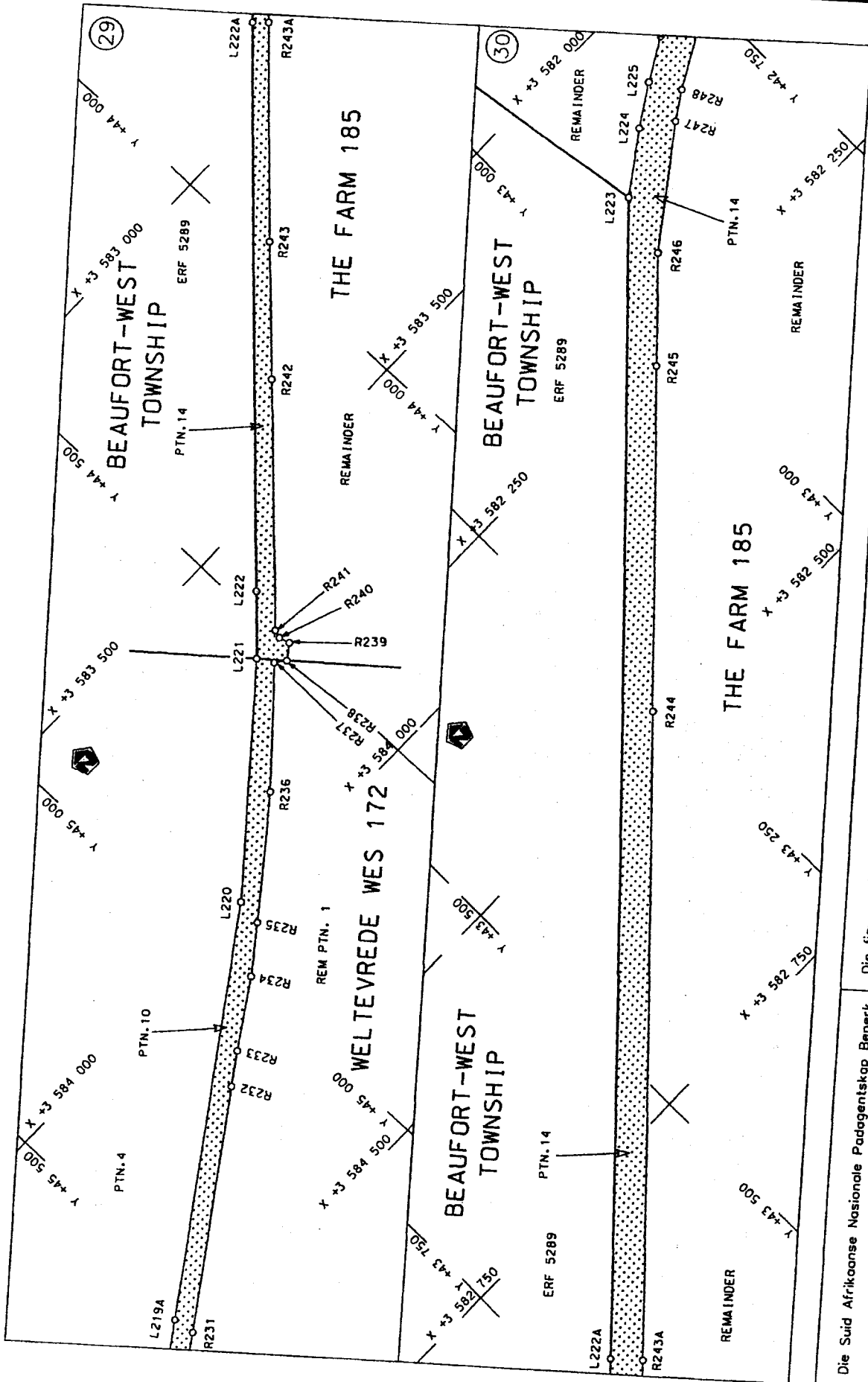

Die Suid Afrikaanse Nasionale Padagentskap Beperk	Die figuur getoon	steldie padreserwe voor van 'n gedeelte represents the road reserve of a portion van Nasionale Roete N1 Seksie of National Route	Vel Sheet 15 van 24
The South African National Roads Agency Limited	The figure shown	7X	Plan P574/06

D.O.9.A

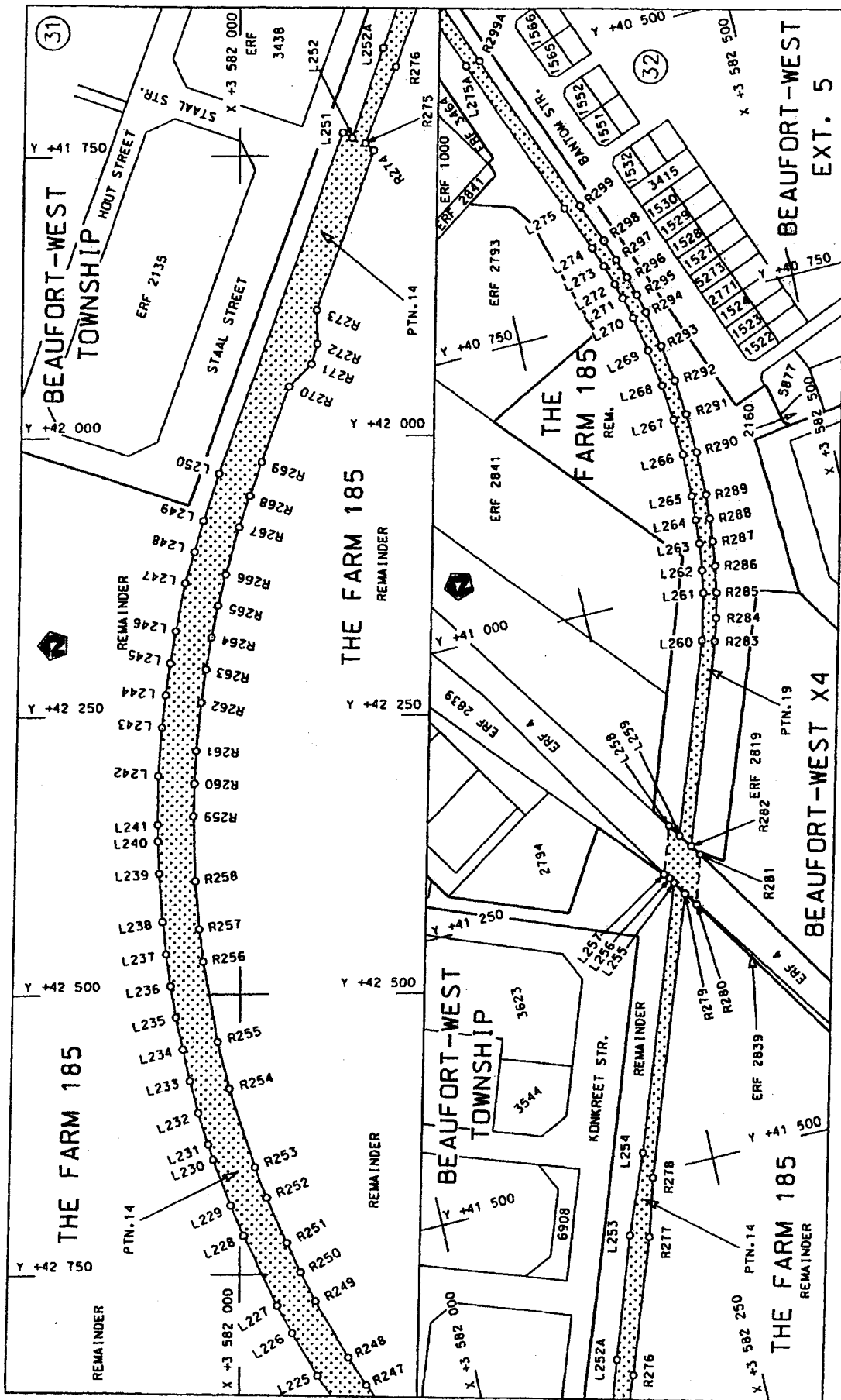

<p>Die Suid Afrikaanse Nasionale Padagentskap Beperk The South African National Roads Agency Limited</p>	<p>Die figuur getoon The figure shown</p>	<p>ste lina po desewse voor van n gede te represents the road reserve of a portion van Nasionale Roete N1 of National Route N1</p> <p>7X Seksie Section</p>	<p>Vel Sheet 16 of 24</p> <p>Plan P574/06</p>
--	---	---	---

D.O.9.A

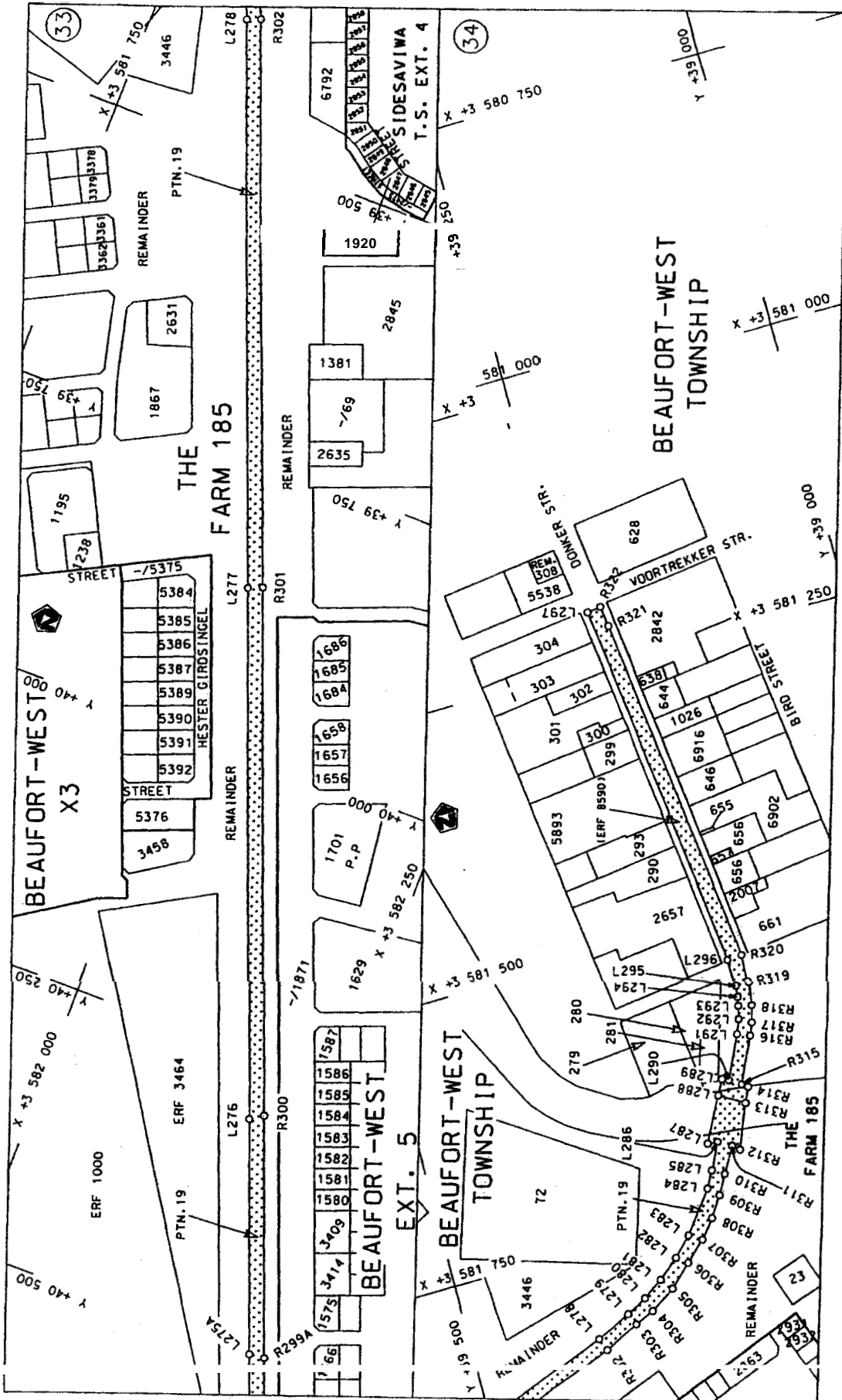

<p>Die Suid-Afrikaanse Nasionale Padogenskops Beperk The South African National</p>	<p>Die figuur getoon figure wn</p>	<p>stel die padreserwe voor van 'n gedeelte represents the road reserve of a portion van Nasionale Roete N1 of National Route</p>	<p>Vel Sheet 17 of 24 Plan P574/06</p>
---	--	---	--

D.O.9.A

PADRESERWE KOORDINATE				/ ROAD RESERVE CO-ORDINATES				
LINKERKANT/LEFT HAND SIDE				REGTERKANT/RIGHT HAND SIDE				
	Y	X	WG 21		Y	X		
L1	-91 365.75	3 627 969.89		R1	-91 464.13	3 628 037.27		
L2	-91 330.80	3 627 911.78		R2	-91 439.01	3 627 994.50		
L3	-91 350.35	3 627 899.88		R3	-91 443.85	3 627 964.49		
L4	-91 384.87	3 627 910.00		R4	-91 555.65	3 627 781.39		
L5	-91 425.88	3 627 908.93		R5	-91 664.17	3 627 668.17		
L6	-91 484.19	3 627 819.39		R6	-91 702.67	3 627 625.69		
L7	-91 524.66	3 627 762.15		R7	-91 748.75	3 627 575.10		
L8	-91 571.93	3 627 696.00		R8	-91 760.13	3 627 563.92		
L9	-91 635.63	3 627 636.30		R9	-91 929.73	3 627 397.32		
L10	-91 738.62	3 627 533.59		R10	-92 101.74	3 627 231.29		
L11	-91 907.90	3 627 371.41		R11	-92 175.04	3 627 154.77		
L12	-92 075.74	3 627 208.25		R12	-92 290.40	3 627 023.22		
L13	-92 175.88	3 627 102.28		R13	-92 295.49	3 627 029.20		
L14	-92 266.71	3 626 995.41		R14	-92 728.50	3 626 416.92		
L15	-92 271.14	3 626 990.19		R15	-92 996.57	3 626 032.57		
L16	-92 349.34	3 626 885.72		R16	-93 051.07	3 625 954.03		
L17	-92 535.30	3 626 625.06		R17	-93 217.46	3 625 716.77		
L18	-92 611.15	3 626 512.24		R18	-93 269.63	3 625 641.30		
L19	-92 685.91	3 626 401.26		R19	-93 442.05	3 625 390.26		
L20	-92 964.60	3 626 011.42		R20	-93 469.01	3 625 359.97		
L21	-93 437.67	3 625 331.44		R21	-93 726.72	3 624 991.97		
L22	-93 509.22	3 625 229.07		R22	-93 925.03	3 624 708.79		
L23	-93 694.92	3 624 962.47		R23	-93 981.66	3 624 631.40		
L24	-93 896.78	3 624 672.65		R24	-94 023.74	3 624 576.85		
L25	-94 088.20	3 624 428.91		R25	-94 071.54	3 624 517.03		
L26	-94 180.12	3 624 326.13		R26	-94 118.91	3 624 460.57		
L27	-94 307.98	3 624 196.23		R27	-94 182.22	3 624 388.14		
L28	-94 442.83	3 624 070.65		R28	-94 228.70	3 624 337.85		
L29	-94 473.95	3 624 044.23		R29	-94 333.22	3 624 230.08		
L30	-94 550.02	3 623 979.67		R30	-94 413.44	3 624 153.88		
L31	-94 673.58	3 623 881.03		R31	-94 463.84	3 624 108.03		
L32	-94 991.28	3 623 638.21		R32	-94 545.90	3 624 036.99		
L33	-95 382.29	3 623 340.62		R33	-94 598.75	3 623 993.49		
L34	-96 237.49	3 622 685.24		R34	-94 675.02	3 623 933.39		
L35	-96 382.68	3 622 573.57		R35	-95 023.88	3 623 666.48		
L36	-96 399.34	3 622 556.06		R36	-95 405.85	3 623 374.36		
L37	-96 590.90	3 622 409.13		R37	-95 832.77	3 623 048.17		
L38	-96 651.32	3 622 363.83		R38	-96 257.40	3 622 722.98		
L39	-96 672.28	3 622 352.47		R39	-96 703.92	3 622 381.17		
L40	-97 140.10	3 621 995.16		R40	-97 165.14	3 622 028.63		
L41	-97 182.91	3 621 962.27		R41	-97 284.67	3 621 937.18		
L42	-97 208.25	3 621 942.81		R42	-97 587.43	3 621 705.55		
L43	-97 256.74	3 621 902.92		R43	-97 997.93	3 621 391.34		
L44	-97 559.38	3 621 671.30		R44	-98 443.27	3 621 050.59		
L45	-97 973.18	3 621 354.79		R45	-98 880.60	3 620 715.85		
L46	-98 416.51	3 621 015.67		R46	-99 275.35	3 620 413.96		
L47	-98 855.79	3 620 679.72		R47	-99 698.57	3 620 090.34		
L48	-99 252.30	3 620 376.52		R48	-99 763.29	3 620 039.51		
L49	-99 531.38	3 620 162.88		R49	-99 827.33	3 619 987.77		
L50	-99 546.68	3 620 152.66		R50	-99 900.49	3 619 926.04		
L51	-99 546.76	3 620 150.88		R51	-99 952.07	3 619 880.75		
				Vel	18	Van	24	P574/06
				Sheet		of		

PADRESERWE KOÖRDINATE				/ ROAD RESERVE CO-ORDINATES		
LINKERKANT/LEFT HAND SIDE				REGTERKANT/RIGHT HAND SIDE		
	Y	X	WG 21		Y	X
.52	-99 855.21	3 619 915.03		R52	-100 013.01	3 619 825.74
.53	-100 152.23	3 619 640.21		R53	-100 176.13	3 619 667.83
.54	-100 168.46	3 619 624.05		R54	-100 261.96	3 619 579.03
.55	-100 209.91	3 619 582.34		R55	-100 362.49	3 619 469.80
.56	-100 247.06	3 619 543.44		R56	-100 442.30	3 619 387.83
.57	-100 723.85	3 619 055.38		R57	-100 750.15	3 619 072.65
.58	-101 062.24	3 618 708.37		R58	-101 082.51	3 618 732.11
.59	-101 428.89	3 618 332.30		R59	-101 455.02	3 618 350.81
.60	-101 859.40	3 617 892.00		R60	-101 547.54	3 618 364.62
.61	-102 181.63	3 617 561.59		R61	-101 616.52	3 618 286.97
.62	-102 364.47	3 617 374.29		R62	-101 594.99	3 618 206.98
.63	-102 505.28	3 617 224.15		R63	-101 877.94	3 617 917.25
.64	-102 809.40	3 616 879.38		R64	-102 210.03	3 617 575.22
.65	-102 871.71	3 616 808.52		R65	-102 491.21	3 617 285.61
.66	-103 178.05	3 616 460.36		R66	-102 841.29	3 616 889.76
.67	-103 492.12	3 616 102.70		R67	-102 901.96	3 616 821.30
.68	-103 837.45	3 615 710.96		R68	-103 201.38	3 616 483.43
.69	-104 201.83	3 615 297.46		R69	-103 518.97	3 616 125.11
.70	-104 573.88	3 614 874.45		R70	-103 864.78	3 615 730.36
.71	-104 903.04	3 614 500.33		R71	-104 229.98	3 615 311.98
.72	-105 286.73	3 614 064.80		R72	-104 594.26	3 614 898.84
.73	-105 511.55	3 613 808.87		R73	-104 920.49	3 614 528.13
.74	-105 822.19	3 613 456.07		R74	-105 304.28	3 614 092.33
.75	-106 135.99	3 613 099.76		R75	-105 537.28	3 613 827.44
.76	-106 220.64	3 613 003.54		R76	-105 843.92	3 613 479.36
				R77	-106 155.39	3 613 124.97
				R78	-106 242.62	3 613 025.79

PADRESERWE KOORDINATE				/	ROAD RESERVE CO-ORDINATES			
LINKERKANT/LEFT HAND SIDE					REGTERKANT/RIGHT HAND SIDE			
	Y	X	WG	23		Y	X	
L77	81 452.63	3 612	770.39	R79	81 430.23	3 612	792.22	
L78	81 202.40	3 612	475.04	R80	81 174.08	3 612	489.75	
L79	80 899.54	3 612	117.39	R81	80 872.67	3 612	133.85	
L80	80 710.82	3 611	894.29	R82	80 685.94	3 611	913.20	
L81	80 510.71	3 611	657.56	R83	80 480.95	3 611	670.86	
L82	80 481.57	3 611	624.67	R84	80 451.30	3 611	638.29	
L83	80 408.32	3 611	542.24	R85	80 431.25	3 611	617.01	
L84	80 244.09	3 611	407.72	R86	80 389.96	3 611	574.85	
L85	77 063.08	3 609	477.73	R87	80 312.88	3 611	502.75	
L86	76 482.67	3 609	126.31	R88	80 243.38	3 611	449.21	
L87	76 355.62	3 609	049.49	R89	80 184.34	3 611	406.45	
L88	76 185.32	3 608	946.63	R90	80 134.47	3 611	376.41	
L89	75 978.32	3 608	820.93	R91	79 936.11	3 611	257.14	
L90	75 857.54	3 608	742.36	R92	79 912.22	3 611	239.53	
L91	75 756.86	3 608	672.82	R93	79 775.70	3 611	156.82	
L92	75 707.42	3 608	636.58	R94	79 291.68	3 610	863.18	
L93	75 565.76	3 608	521.24	R95	78 864.08	3 610	603.76	
L94	75 404.51	3 608	381.03	R96	78 459.94	3 610	358.79	
L95	74 985.67	3 607	999.99	R97	78 019.45	3 610	092.04	
L96	74 624.39	3 607	672.30	R98	77 603.36	3 609	840.41	
L97	74 505.72	3 607	565.03	R99	77 175.66	3 609	582.05	
L98	74 268.47	3 607	349.97	R100	77 030.37	3 609	494.20	
L99	73 903.63	3 607	019.76	R101	76 757.36	3 609	328.75	
L100	73 62d.99	3 606	764.25	R102	76 333.05	3 609	071.81	
L101	73 556.06	3 606	705.18	R103	76 192.02	3 608	986.51	
L102	73 181.76	3 606	365.90	R104	75 921.58	3 608	822.77	
L103	72 931.99	3 606	139.60	R105	75 807.89	3 608	748.04	
L104	72 811.63	3 606	025.71	R106	75 731.53	3 608	694.28	
L105	72 728.13	3 605	943.21	R107	75 631.39	3 608	619.22	
L106	72 623.52	3 605	833.98	R108	75 531.12	3 608	539.67	
L107	72 295.24	3 605	480.26	R109	75 382.49	3 608	404.54	
L108	71 956.10	3 605	113.27	R110	74 965.35	3 608	025.90	
L109	71 602.77	3 604	731.40	R111	74 596.75	3 607	691.34	
L110	71 233.03	3 604	331.24	R112	74 487.90	3 607	592.72	
L111	70 894.43	3 603	965.06	R113	74 243.41	3 607	371.01	
L112	70 530.32	3 603	571.18	R114	73 876.89	3 607	038.54	
L113	70 155.76	3 603	166.22	R115	73 609.66	3 606	796.34	
L114	69 833.45	3 602	818.21	R116	73 538.77	3 606	732.08	
L115	69 544.95	3 602	506.82	R117	72 924.18	3 606	174.87	
L116	69 493.25	3 602	450.23	R118	72 828.25	3 606	085.17	
L117	69 114.72	3 602	040.77	R119	72 742.60	3 606	001.97	
L118	68 820.64	3 601	723.07	R120	72 638.36	3 605	895.71	
L119	68 463.18	3 601	336.70	R121	72 265.03	3 605	493.58	
L120	68 115.26	3 600	960.61	R122	71 925.69	3 605	126.71	
L121	67 849.85	3 600	673.67	R123	71 583.23	3 604	756.42	
L122	67 450.89	3 600	242.06	R124	71 204.23	3 604	346.46	
L123	67 076.05	3 599	836.81	R125	70 864.86	3 603	979.68	
L124	66 880.49	3 599	625.73	R126	70 506.29	3 603	592.05	
L125	66 736.27	3 599	469.69	R127	70 132.65	3 603	188.01	
L126	66 416.41	3 599	123.89	R128	69 810.59	3 602	839.33	
L127	66 247.95	3 598	944.75	R129	69 544.93	3 602	551.90	
				Vel	20	Van	24	P574/06
				Sheet		of		

LINKERKANT/LEFT HAND SIDE				REGTERKANT/RIGHT HAND SIDE				
	Y	X	WG 23		Y	X		
L128	66 199.92	3 598	895.07	R130	69 472.19	3 602	473.23	
L129	66 123.60	3 598	820.17	R131	69 091.27	3 602	062.00	
L130	66 111.47	3 598	795.66	R132	68 786.25	3 601	732.29	
L131	66 043.98	3 598	743.88	R133	68 443.94	3 601	362.18	
L132	65 980.24	3 598	687.14	R134	68 095.98	3 600	986.12	
L133	65 796.74	3 598	528.82	R135	67 830.69	3 600	699.47	
L134	65 764.81	3 598	502.63	R136	67 758.43	3 600	629.66	
L135	65 702.13	3 598	452.85	R137	67 670.71	3 600	526.16	
L136	65 644.90	3 598	409.26	R138	67 423.74	3 600	258.98	
L137	65 556.37	3 598	342.84	R139	67 029.80	3 599	833.00	
L138	65 478.59	3 598	286.64	R140	66 926.60	3 599	725.98	
L139	65 419.53	3 598	245.89	R141	66 835.89	3 599	630.96	
L140	65 343.70	3 598	194.62	R142	66 796.66	3 599	581.35	
L141	64 941.75	3 597	930.27	R143	66 713.99	3 599	491.68	
L142	64 516.63	3 597	651.70	R144	66 391.11	3 599	142.61	
L143	64 351.79	3 597	544.01	R145	66 265.49	3 599	007.62	
L144	64 131.08	3 597	399.11	R146	66 185.30	3 598	925.04	
L145	63 727.60	3 597	134.59	R147	66 116.18	3 598	856.87	
L146	63 310.39	3 596	861.02	R148	66 091.37	3 598	845.01	
L147	62 882.68	3 596	580.72	R149	66 052.70	3 598	795.84	
L148	62 488.49	3 596	322.30	R150'	66 002.87	3 598	749.88	
L149	62 116.61	3 596	078.69	R151	65 912.21	3 598	668.63	
L150	62 085.71	3 596	058.21	R152	65 854.21	3 598	618.34	
L151	61 758.64	3 595	843.87	R153	65 782.52	3 598	558.15	
L152	61 602.17	3 595	740.90	R154	65 677.31	3 598	473.75	
L153	61 447.34	3 595	638.47	R155	65 553.96	3 598	379.69	
L154	61 321.32	3 595	550.24	R156	65 494.59	3 598	336.56	
L155	61 247.44	3 595	496.26	R157	65 432.52	3 598	292.47	
L156	61 '132.99	3 595	408.96	R158	65 332.36	3 598	224.21	
L157	61 016.32	3 595	315.72	R159	64 924.59	3 597	957.00	
L158	60 586.67	3 594	965.02	R160	64 498.81	3 597	677.79	
L159	60 210.48	3 594	657.97	R161	64 357.63	3 597	585.30	
L160	59 719.46	3 594	256.90	R162	64 109.88	3 597	422.63	
L161	59 356.02	3 593	960.33	R163	63 705.62	3 597	157.73	
L162	59 003.63	3 593	672.62	R164	63 291.61	3 596	886.43	
L163	58 628.71	3 593	366.62	R165	62 874.98	3 596	613.16	
L164	58 231.13	3 593	041.97	R166	62 470.45	3 596	348.24	
L165	57 845.75	3 592	727.84	R167	62 064.01	3 596	081.62	
L166	57 823.49	3 592	709.51	R168	61 758.18	3 595	880.96	
L167	57 362.39	3 592	332.99	R169	61 568.39	3 595	757.46	
L168	56 841.19	3 591	906.21	R170	61 554.19	3 595	748.26	
L169	56 666.27	3 591	763.80	R171	61 506.78	3 595	717.22	
L170	56 653.50	3 591	754.30	R172	61 386.01	3 595	635.47	
L171	56 476.62	3 591	609.96	R173	61 317.28	3 595	586.32	
L172	56 368.97	3 591	525.27	R174	61 231.55	3 595	524.65	
L173	56 319.24	3 591	488.11	R175	61 147.80	3 595	461.86	
L174	56 220.81	3 591	417.57	R176	60 992.90	3 595	337.08	
L175	56 157.18	3 591	374.43	R177	60 562.38	3 594	985.71	
L176	56 119.29	3 591	349.38	R178	60 188.62	3 594	680.09	
L177	56 080.73	3 591	324.42	R179	59 707.11	3 594	287.44	
L178	56 041.79	3 591	299.86	R180	59 331.19	3 593	980.62	
				Vel	21	Van	24	P574/06
				Sheet		of		

PADRESERWE KOORDINATE				/	ROAD RESERVE CO-ORDINATES			
LINKERKANT/LEFT HAND SIDE					REGTERKANT/RIGHT HAND SIDE			
	Y	X	WG 23		Y	X		
L179	55 976.85	3 591 260.31		R181	58 979.03	3 593 692.98		
L180	55 924.78	3 591 229.59		R182	58 207.84	3 593 063.77		
L181	55 790.96	3 591 154.76		R183	57 801.10	3 592 731.71		
L182	55 553.38	3 591 025.12		R184	57 773.66	3 592 709.29		
L183	55 383.18	3 590 931.92		R185	57 341.24	3 592 356.27		
L184	55 010.00	3 590 727.67		R186	56 814.21	3 591 925.46		
L185	54 850.11	3 590 639.46		R187	56 685.16	3 591 819.98		
L186	54 824.41	3 590 624.00		R188	56 448.74	3 591 627.83		
L187	54 797.80	3 590 607.25		R189	56 317.26	3 591 525.88		
L188	54 747.43	3 590 573.72		R190	56 218.80	3 591 454.73		
L189	54 722.79	3 590 556.33		R191	56 080.10	3 591 361.54		
L190	54 686.02	3 590 528.98		R192	55 937.94	3 591 274.14		
L191	54 662.08	3 590 509.98		R193	55 767.20	3 591 177.33		
L192	54 395.33	3 590 293.33		R194	55 526.60	3 591 046.53		
L193	54 345.73	3 590 259.56		R195	55 371.08	3 590 961.11		
L194	54 268.49	3 590 212.58		R196	54 995.33	3 590 755.51		
L195	54 241.82	3 590 197.81		R197	54 849.38	3 590 675.15		
L196	54 214.94	3 590 183.51		R198	54 809.56	3 590 652.06		
L197	54 092.24	3 590 123.86		R199	54 758.07	3 590 619.28		
L198	53 875.79	3 590 016.52		R200	54 637.35	3 590 533.85		
L199	53 819.42	3 589 992.38		R201	54 451.50	3 590 399.56		
L200	53 528.72	3 589 852.55		R202	54 260.98	3 590 265.31		
L201	53 479.92	3 589 827.78		R203	54 101.38	3 590 171.86		
L202	53 445.91	3 589 808.92		R204	53 788.04	3 590 014.83		
L203	53 413.57	3 589 789.91		R205	53 735.54	3 589 986.85		
L204	53 361.93	3 589 757.56		R206	53 500.76	3 589 873.62		
L205	52 945.56	3 589 474.05		R207	53 460.40	3 589 852.91		
L206	52 579.01	3 589 224.13		R208	53 407.46	3 589 823.21		
L207	52 140.92	3 588 925.62		R209	53 355.72	3 589 791.30		
L208	51 325.19	3 588 371.04		R210	53 317.82	3 589 766.00		
L209	50 944.48	3 588 111.55		R211	52 928.16	3 589 500.25		
L210	50 522.23	3 587 823.72		R212	52 551.68	3 589 243.66		
L211	50 265.38	3 587 648.93		R213	52 125.15	3 588 952.91		
L212	50 118.51	3 587 548.52		R214	51 708.34	3 588 670.00		
L213	49 696.22	3 587 260.40		R215	51 306.79	3 588 396.39		
L214	49 319.74	3 587 003.39		R216	50 928.51	3 588 138.42		
L215	48 869.07	3 586 696.14		R217	50 497.72	3 587 844.77		
L216	48 444.74	3 586 407.10		R218	50 252.92	3 587 678.00		
L217	48 042.35	3 586 132.76		R219	50 104.24	3 587 576.65		
L218	47 624.35	3 585 848.00		R220	49 693.94	3 587 297.05		
L219	47 434.30	3 585 719.22		R221	49 299.76	3 587 028.39		
L220	44 902.59	3 583 985.57		R222	48 851.76	3 586 723.00		
L221	44 552.98	3 583 694.55		R223	48 425.99	3 586 432.83		
L222	44 462.72	3 583 607.55		R224	48 024.09	3 586 158.93		
L223	42 929.77	3 582 130.50		R225	47 601.28	3 585 870.56		
L224	42 877.24	3 582 092.56		R226	47 422.29	3 585 748.67		
L225	42 840.87	3 582 068.77		R227	47 191.35	3 585 591.31		
L226	42 802.48	3 582 045.86		R228	46 794.71	3 585 320.88		
L227	42 777.93	3 582 032.77		R229	46 361.20	3 585 025.58		
L228	42 715.21	3 582 003.53		R230	45 920.32	3 584 725.02		
L229	42 688.33	3 581 992.19		R231	45 542.91	3 584 468.02		
					Vel 22	Van 24	P574/06	
					Sheet	of		

LINKERKANT/LEFT HAND SIDE				REGTERKANT/RIGHT HAND SIDE			
	Y	X	WG	23	Y	X	
L230	42 647.48	3 581	976.46	R232	45 163.59	3 584	208.86
L231	42 633.74	3 581	971.79	R233	45 108.24	3 584	170.85
L232	42 605.89	3 581	963.03	R234	44 990.90	3 584	094.00
L233	42 577.68	3 581	955.65	R235	44 909.92	3 584	033.76
L234	42 549.20	3 581	949.68	R236	44 716.82	3 583	883.46
L235	42 52.0.54	3 581	943.39	R237	44 536.43	3 583	722.48
L236	42 492.22	3 581	938.61	R238	44 517.85	3 583	736.92
L237	42 463.48	3 581	934.50	R239	44 490.76	3 583	717.36
L238	42 434.37	3 581	931.50	R240	44 496.24	3 583	697.87
L239	42 390.84	3 581	928.37	R241	44 492.42	3 583	682.58
L240	42 361.60	3 581	927.32	R242	44 157.58	3 583	358.00
L241	42 346.87	3 581	927.12	R243	43 975.04	3 583	181.05
L242	42 303.13	3 581	927.52	R244	43 252.56	3 582	481.08
L243	42 259.73	3 581	930.79	R245	43 022.76	3 582	258.52
L244	42 230.53	3 581	934.09	R246	42 947.27	3 582	186.27
L245	42 201.83	3 581	938.19	R247	42 849.18	3 582	112.31
L246	42 173.28	3 581	943.04	R248	42 824.50	3 582	095.91
L247	42 130.02	3 581	951.40	R249	42 774.15	3 582	066.58
L248	42 101.83	3 581	959.36	R250	42 748.09	3 582	053.29
L249	42 074.03	3 581	967.50	R251	42 721.80	3 582	040.98
L250	42 032.38	3 581	981.21	R252	42 681.55	3 582	023.35
L251	41 729.89	3 582	090.06	R253	42 654.35	3 582	013.01
L252	41 734.88	3 582	098.51	R254	42 584.87	3 581	990.88
L253	41 549.35	3 582	162.58	R255	42 542.47	3 581	980.33
L254	41 480.77	3 582	190.33	R256	42 470.41	3 581	967.34
L255	41 252.29	3 582	272.37	R257	42 441.47	3 581	963.73
L256	41 247.53	3 582	269.35	R258	42 397.91	3 581	960.25
L257	41 242.67	3 582	265.14	R259	42 339.48	3 581	958.55
L258	41 201.56	3 582	279.52	R260	42 310.30	3 581	959.44
L259	41 212.42	3 582	286.89	R261	42 281.16	3 581	960.98
L260	41 047.07	3 582	345.93	R262	42 237.55	3 581	965.26
L261	41 005.68	3 582	356.99	R263	42 207.76	3 581	969.45
L262	40 985.31	3 582	360.67	R264	42 179.17	3 581	974.27
L263	40 961.83	3 582	364.09	R265	42 150.69	3 581	980.16
L264	40 940.71	3 582	365.66	R266	42 122.46	3 581	987.03
L265	40 919.21	3 582	367.11	R267	42 080.21	3 581	998.78
L266	40 881.36	3 582	367.95	R268	42 052.50	3 582	008.09
L267	40 849.39	3 582	366.96	R269	42 022.30	3 582	018.57
L268	40 817.14	3 582	364.11	R270	41 955.41	3 582	042.65
L269	40 783.72	3 582	359.18	R271	41 935.24	3 582	062.17
L270	40 752.67	3 582	353.00	R272	41 917.42	3 582	067.37
L271	40 733.47	3 582	348.27	R273	41 887.67	3 582	066.89
L272	40 719.68	3 582	344.26	R274	41 746.08	3 582	117.90
L273	40 701.43	3 582	338.56	R275	41 739.63	3 582	110.10
L274	40 683.68	3 582	332.33	R276	41 671.58	3 582	137.31
L275	40 643.50	3 582	316.96	R277	41 554.87	3 582	179.09
L276	40 303.31	3 582	185.42	R278	41 504.52	3 582	194.00
L277	39 859.74	3 582	013.35	R279	41 264.18	3 582	279.94
L278	39 387.45	3 581	830.10	R280	41 276.00	3 582	287.46
L279	39 356.42	3 581	816.20	R281	41 233.12	3 582	300.64
L280	39 338.42	3 581	806.46	R282	41 223.96	3 582	294.71

Vel	23	Van	24	P574/06
Sheet		of		

LINKERKANT/LEFT HAND SIDE				REGTERKANT/RIGHT HAND SIDE				
	Y	X	WG	23	Y	X		
L281	39 320.19	3 581 794.44		R283	41 050.65	3 582 356.83		
L282	39 301.59	3 581 779.13		R284	41 030.48	3 582 362.85		
L283	39 285.76	3 581 762.99		R285	41 008.15	3 582 368.35		
L284	39 258.03	3 581 727.34		R286	40 984.39	3 582 372.73		
L285	39 250.11	3 581 712.86		R287	40 962.86	3 582 375.81		
L286	39 238.79	3 581 690.02		R288	40 942.20	3 582 377.87		
L287	39 247.75	3 581 689.04		R289	40 920.63	3 582 379.53		
L288	39 227.75	3 581 650.89		R290	40 882.37	3 582 380.30		
L289	39 220.79	3 581 637.55		R291	40 847.39	3 582 379.19		
L290	39 214.85	3 581 640.39		R292	40 815.47	3 582 376.36		
L291	39 196.90	3 581 602.71		R293	40 782.67	3 582 371.60		
L292	39 192.35	3 581 590.07		R294	40 750.56	3 582 365.22		
L293	39 189.42	3 581 578.52		R295	40 733.65	3 582 361.01		
L294	39 187.89	3 581 570.60		R296	40 716.37	3 582 356.08		
L295	39 186.70	3 581 560.58		R297	40 698.54	3 582 350.62		
L296	39 186.94	3 581 537.04		R298	40 679.43	3 582 343.87		
L297	39 226.97	3 581 201.97		R299	40 644.80	3 582 330.89		
				R300	40 296.03	3 582 196.06		
				R301	39 854.65	3 582 024.83		
				R302	39 383.06	3 581 841.57		
				R303	39 351.56	3 581 826.62		
				R304	39 334.07	3 581 819.25		
				R305	39 311.89	3 581 804.85		
				R306	39 292.22	3 581 786.54		
				R307	39 274.30	3 581 770.15		
				R308	39 261.22	3 581 753.87		
				R309	39 249.29	3 581 736.09		
				R310	39 239.71	3 581 719.09		
				R311	39 226.89	3 581 697.06		
				R312	39 220.92	3 581 702.31		
				R313	39 205.30	3 581 664.11		
				R314	39 199.60	3 581 650.67		
				R315	39 204.64	3 581 646.95		
				R316	39 185.66	3 581 607.14		
				R317	39 181.55	3 581 596.19		
				R318	39 177.45	3 581 581.13		
				R319	39 174.42	3 581 560.35		
				R320	39 173.57	3 581 536.20		
				R321	39 212.67	3 581 218.83		
				R322	39 214.83	3 581 200.53		
				Vel	24	Van	24	P574/06
				Sheet		of		