

No. 730

28 July 2006

THE SOUTH AFRICAN NATIONAL ROADS AGENCY LIMITED

DECLARATION AMENDMENT OF NATIONAL ROAD N1 SECTION 6X

AMENDMENT OF DECLARATION NO. 1322 OF 1989

By virtue of Section 40(1)(b) of The South African National Roads Agency Limited and National Roads Act, 1998 (Act No 7 of 1998) I hereby amend declaration No. 1322 of 1989 by replacing the section from Prins Albert Road to Leeu Gamka in paragraph 1 with the subjoined sheets 1 to 14 of Plan P572/06.

(National Road N1 Section 6X: Prins Albert Road – Leeu Gamka)

MINISTER OF TRANSPORT

No. 730

28 Julie 2006

DIE SUID AFRIKAANSE NASIONALE PADAGENTSKAP BEPERK

VERKLARING WYSIGING VAN NASIONALE PAD N1 SEKSIE 6X

WYSIGING VAN VERKLARING NO. 1322 van 1989

Kragtens artikei 40 (1)(b) van die Suid Afrikaanse Nasionale Padagentskap Beperk en Nasionale Paaie Wet (Wet No. 7 van 1998), wysig ek hiermee verklaring no. 1322 van 1989 deur daarin die gedeelte vanaf Prins Albert Weg tot Leeu Gamka in paragraaf 1 te vervang deur bygaande velle 1 tot 14 van Plan P572/06.

(Nasionale Pad N1 Seksie 6X: Prins Albert Weg – Leeu Gamka)

MINISTER OF TRANSPORT

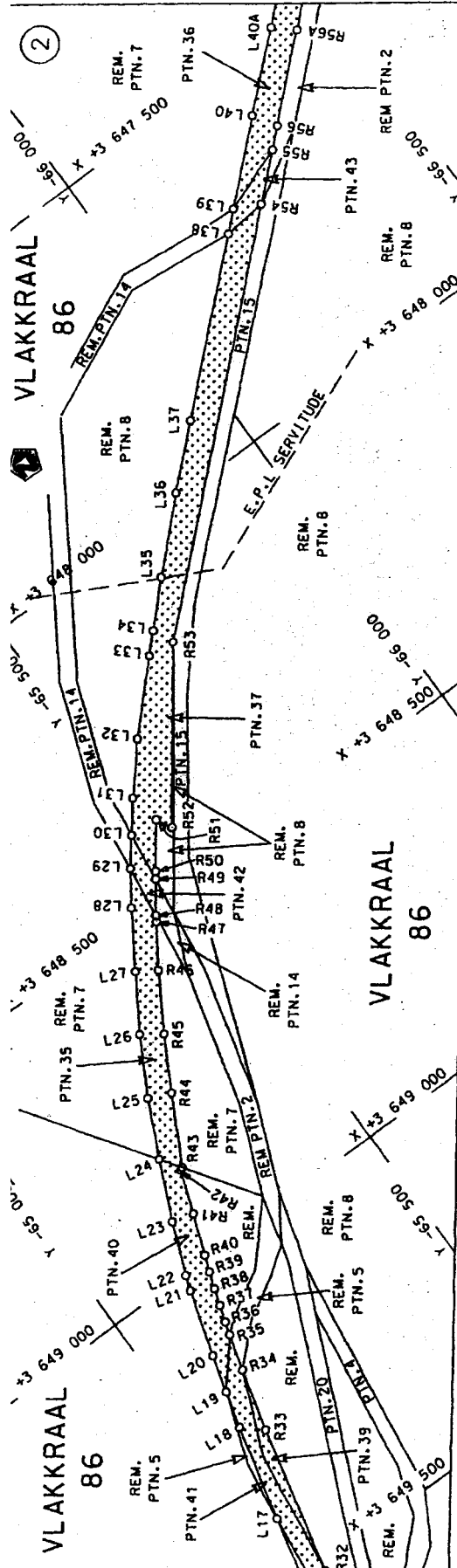
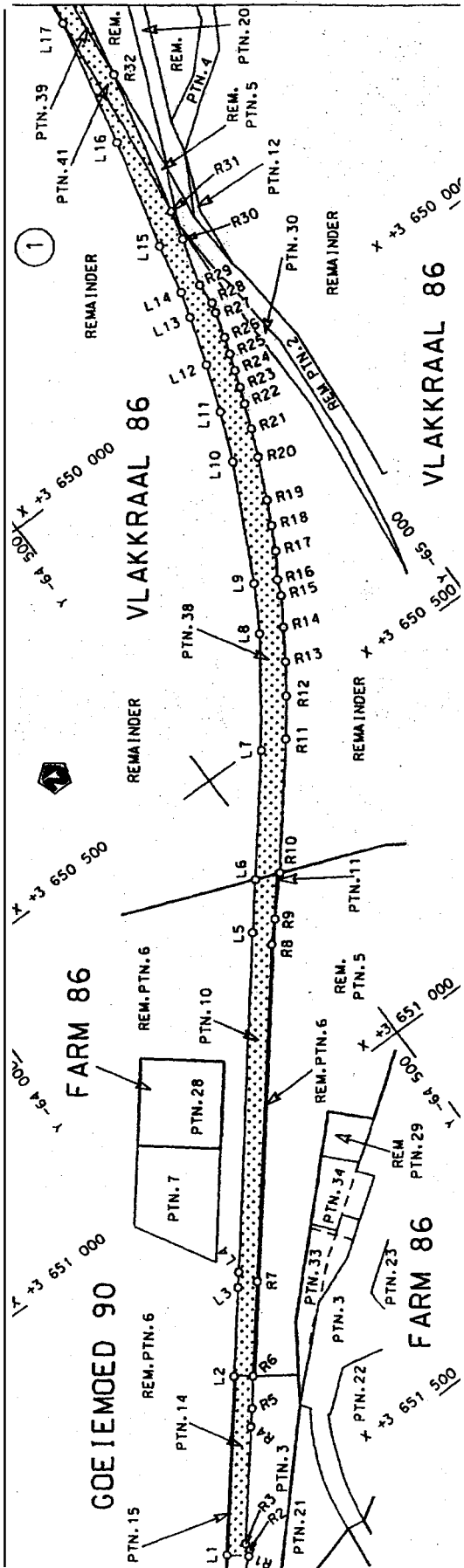

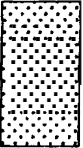
Die Swep Af ikaanse Nasionale Pado rigtaxap Bieperk The Bouth African National Roads Agency Limited	Die figuur getoon Die figure shown		steldie padreser voor van 'n ged lte represents the id. es rve of a portion van Nasionale Ri e N1 of National Road. Sektie Section	
			6X	Vel Sheet 1 of 14 Plan 0577/06

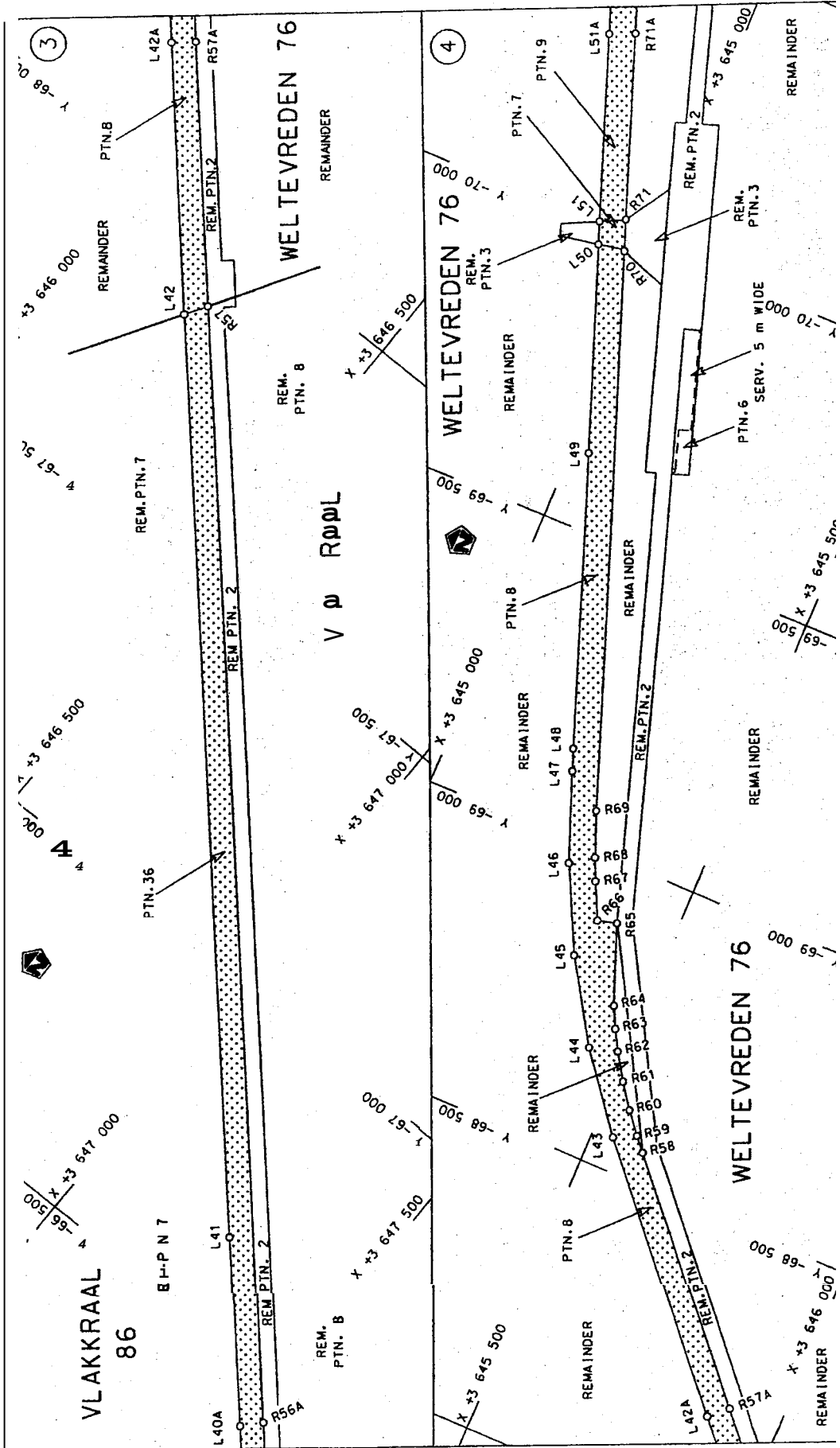

Die Suid-Afrikaanse Nasionale Padtoetsingsagentskap
The South African National Roads Agency

Die figuur getoon
The figure shown

stelt die padreserwe voor van 'n gedeelte
represents the road reserve of a portion

van Nasionale Roete N1
of National Route N1

6X
Section

Sheet
Plan

D.O.9.A

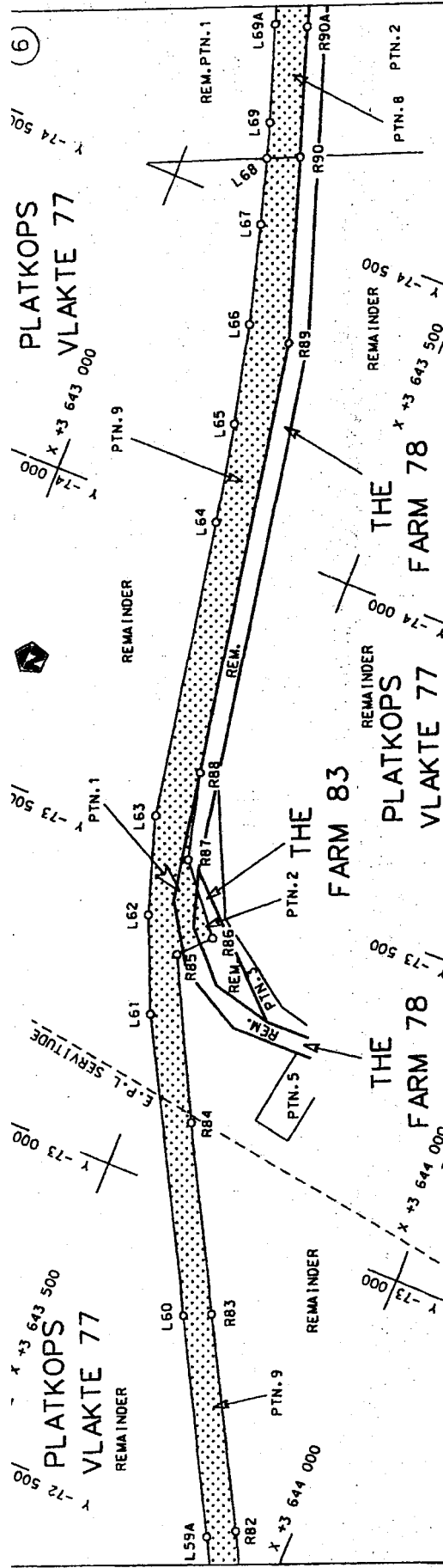
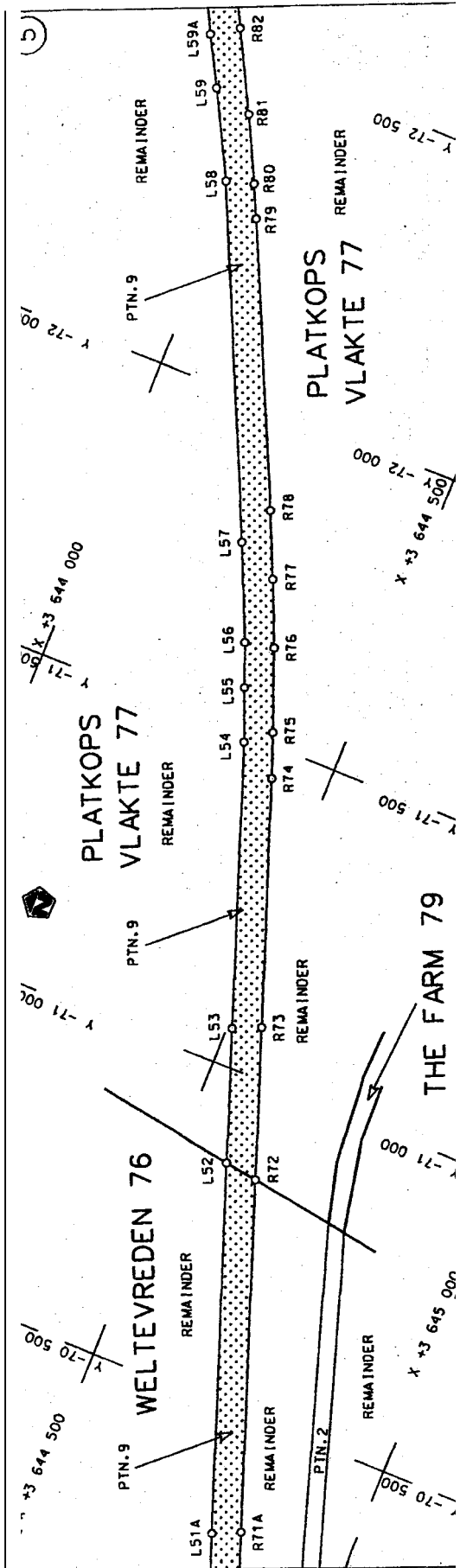

veel
Sheet
Plan

stelt die p adreser oor van 'n gedeelte
represents the road reserve of a portion
van Nasionale Roetj N1
of National Route Section
6X

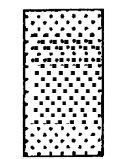

Die figuur getoon
The figure shown

Die Suid Af ikaanse Nasjonaal Padagentskap B epe k
The South African National Roads Agency Limited

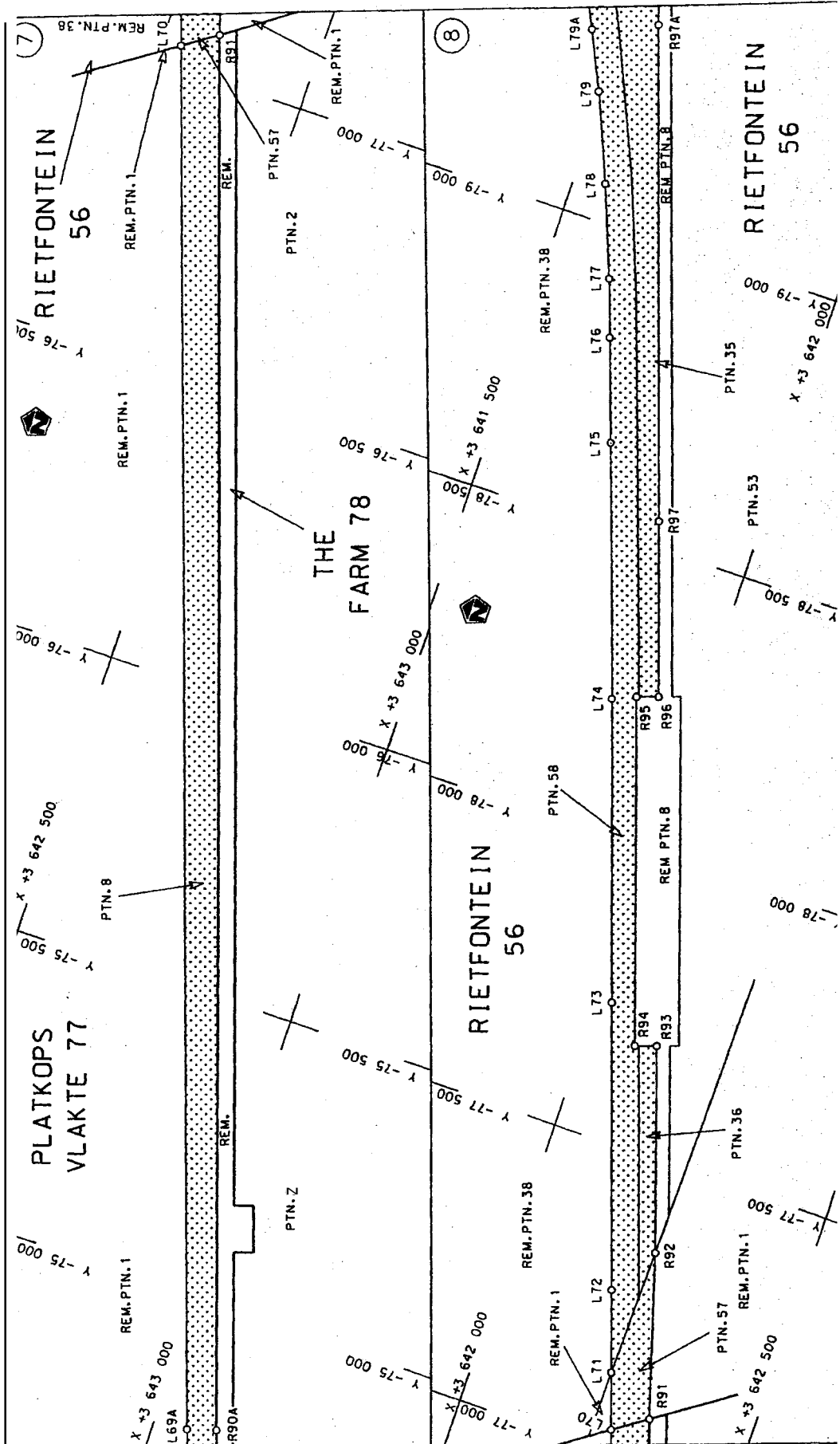

Die Suid Afrikaanse Nasionale Padagentskap Bepark The South African National Roads Agency Limited	Die figuur getoon TFI figure shown	steldie padreserwe voor van 'n gedeelte represents the road reserve of a portion van Nasionale Roete N1 of National Route	6X Section	Plan P572/06	Vel Sheet 4 of 14	D.O.9.A
--	---------------------------------------	--	---------------	--------------	-------------------	---------

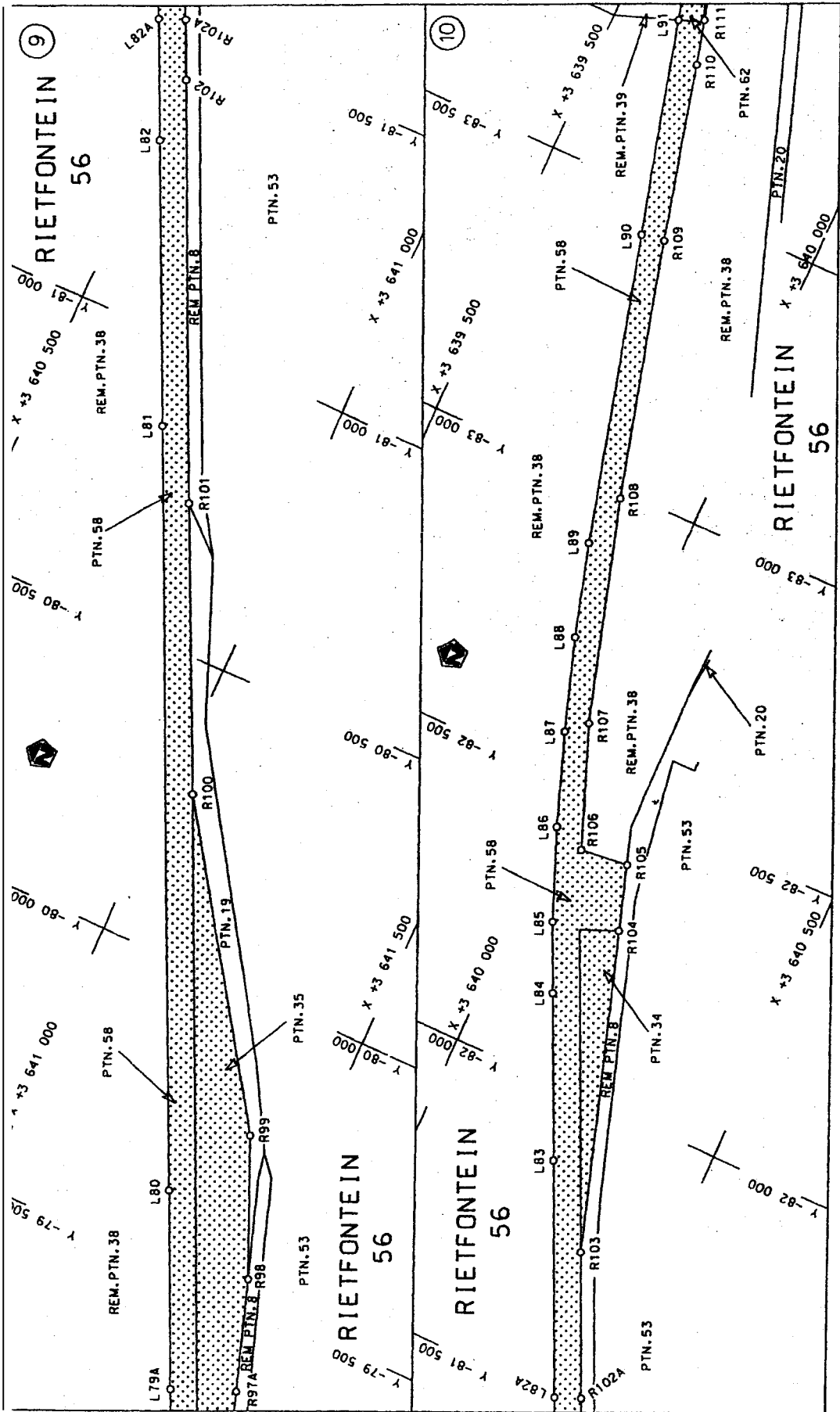

<p>Die Suid Afrikaanse Nasionale Padagentskap Beperk The South African National Roads Agency Limited</p>	<p>Die figuur getoon The figure shown</p>	<p>stede padreserwe voor van 'n gedeelte represents the road reserve of a portion van Nasionale Roete N1 of National Route N1</p>	<p>Vel Sheet</p>
			<p>6X</p>
			<p>D.O.9.A</p>

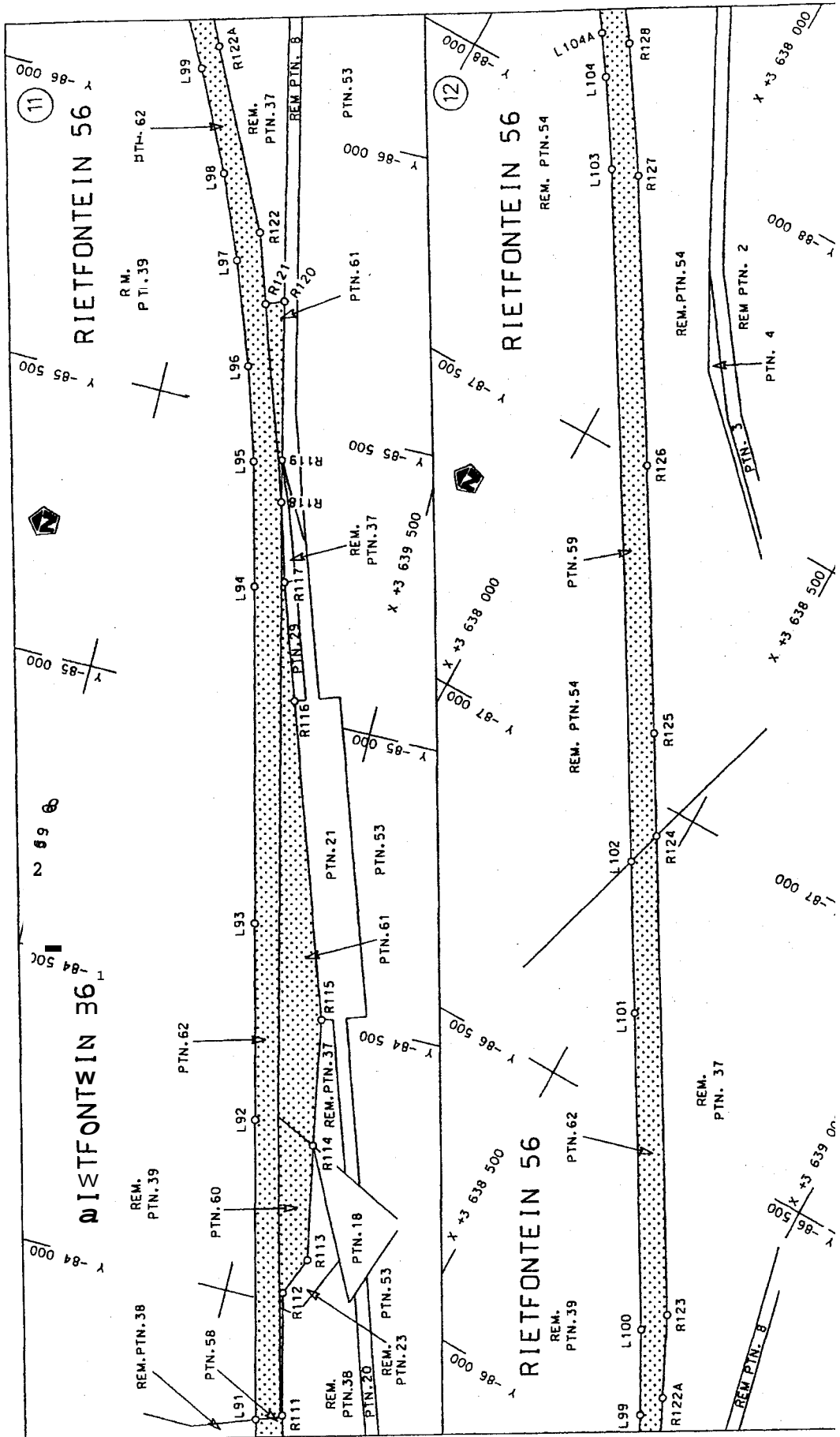

Sheet 6 of 14
Plan P572/06

6X
Section

N1
Section

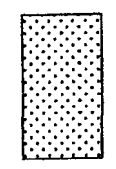

Die figuur getoon
The figure shown

Die Suid Afrikaanse Nasionale Padagentskap Bepark
The South African National Roads Agency Limited

stelsel paasreserwe voor van 'n gelyke
represents the road reserve of a portion
van Nasionale Roete N1
of National Route

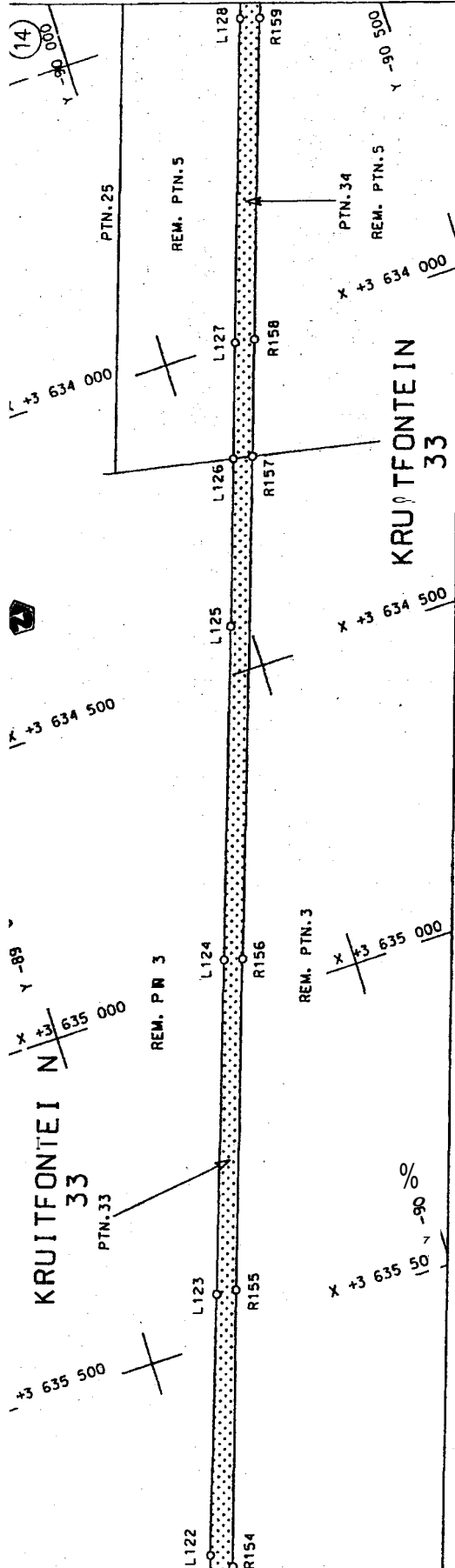
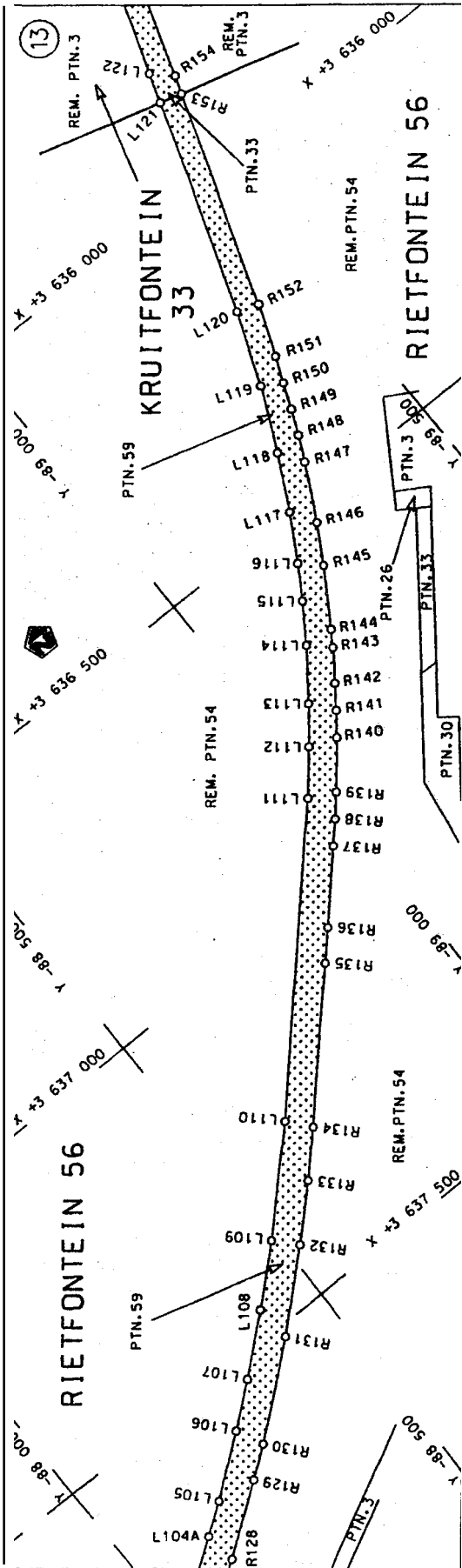

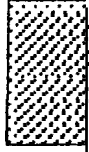
Die Suid Af ikaanse Nasionale Padagentskap Beperk The So th African National Roads Agency Limited	Die figuur getoon The figure shown		steldie padreserwe voor van 'n gedeelte represents the road reserve of a portion van Nasionale Roete N1 Sektie of National Route N1 Section	6X	Plan DE77/06
			Vel Sheet 7 of 14		

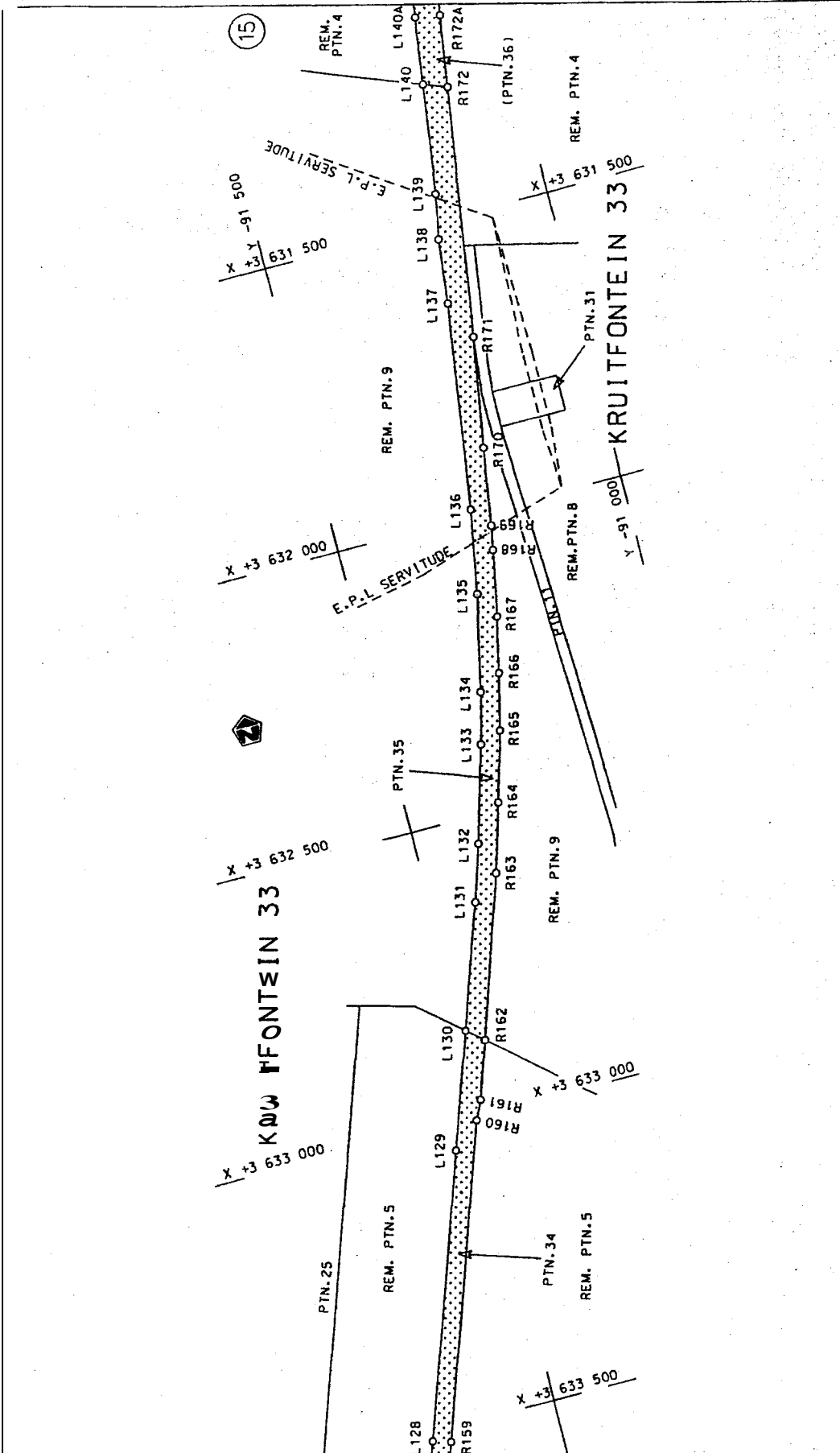

<p>Die Suid Afrikaanse Nasionale Padagentskap Beperk The South African National Roads Agency Limited</p>	<p>Die figuur getoon The figure shown</p>	<p>stelding padreserwe van 'n gedeelte represents the road reserve of a portion van Nasionale Roete N1 of National Route N1</p> <p>Seksie Section</p> <p>N1</p>	<p>Vel Sheet</p> <p>8 of 14</p> <p>Plan P572/06</p>
--	---	---	---

04.9.A

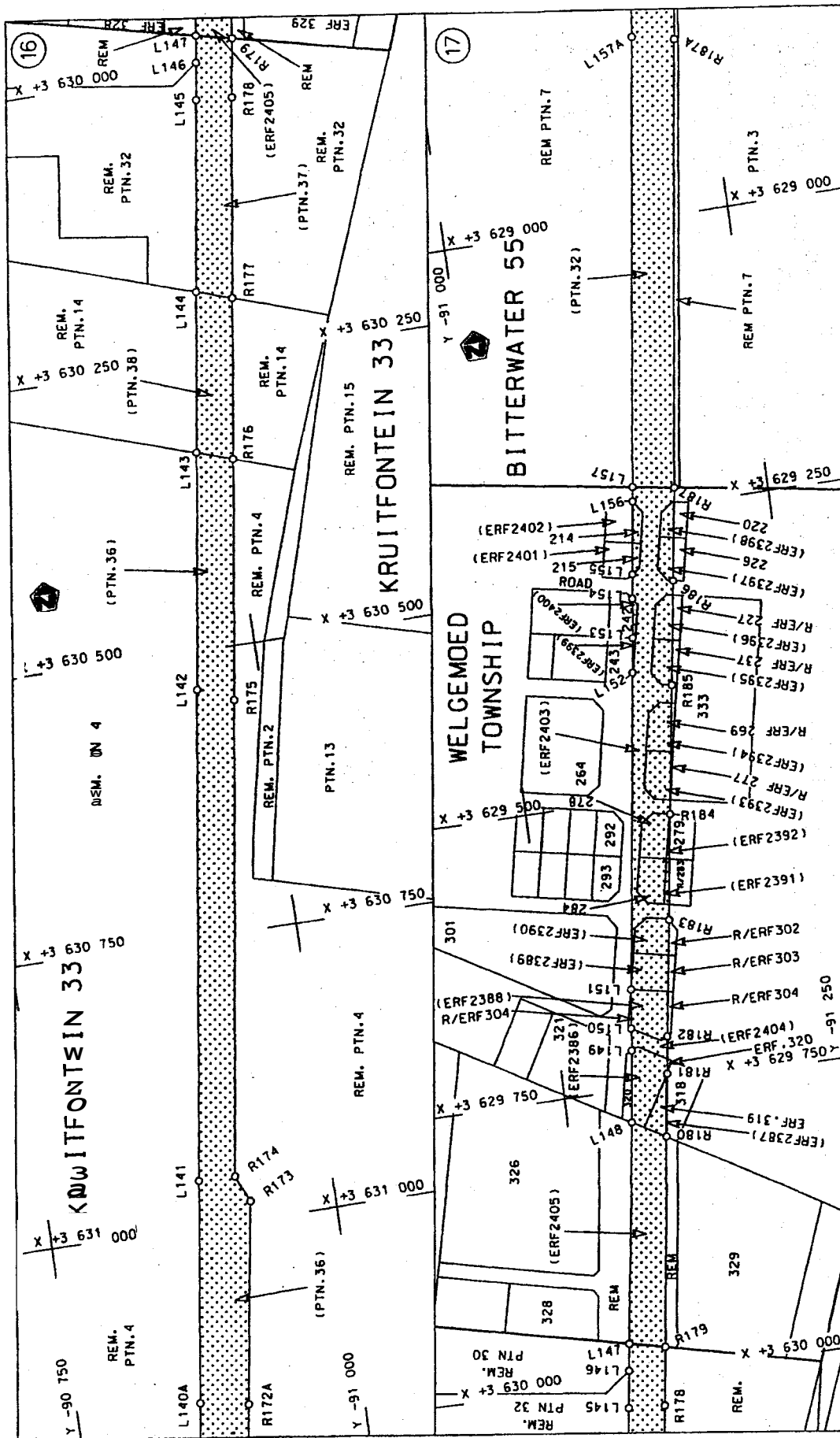

Die Suid Afrikaanse Nasionale Padagentskap Beperk
 The South African National Roads Agency Limited

Die figuur getoon
 The figure shown

stelt die padreserwe voor van 'n gedeelte
 represents the road reserve of a portion
 van Nasionale Roete N1
 of National Route

Section 6X
 Plan 9

Sheet 9
 Plan 9

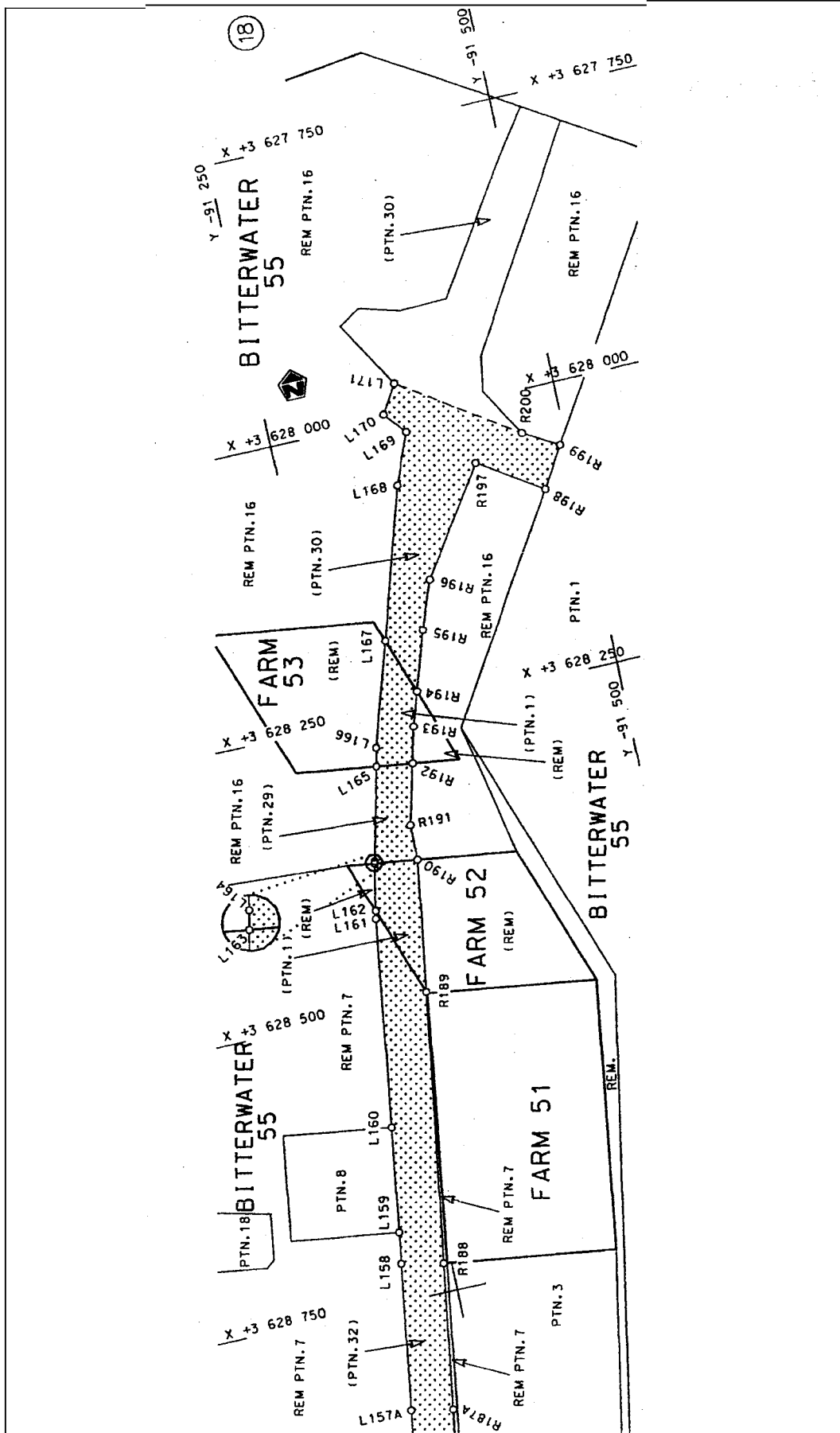

<p>Die Suid Afrikaanse Nasionale Padagentskap Beperk The South African National Roads Agency Limited</p>	<p>Die figuur getoon The figure shown</p>	<p>steëlde padreserwe voor van 'n gedeelte represents the road reserve of a portion van Nasionale Roete N1 Seksie Section</p>	<p>Vel Sheet 10 of 14 Plan P572/06</p>
--	---	---	--

D.O.9.A

PADRESERWE KOÖRDINATE				ROAD RESERVE CO-ORDINATES				
LINKERKANT/LEFT HAND SIDE				REGTERKANT/RIGHT HAND SIDE				
	Y	X	WG 21		Y	X		
L1	-63 796.02	3 651 502.54		R1	-63 823.16	3 651 525.01		
L2	-63 971.93	3 651 282.50		R2	-63 831.04	3 651 518.10		
L3	-64 058.85	3 651 174.51		R3	-63 830.88	3 651 506.63		
L4	-64 074.30	3 651 156.18		R4	-63 946.79	3 651 362.94		
L5	-64 410.97	3 650 735.93		R5	-63 964.92	3 651 340.42		
L6	-64 464.57	3 650 670.23		R6	-63 996.66	3 651 300.50		
L7	-64 594.29	3 650 509.69		R7	-64 089.06	3 651 185.60		
L8	-64 702.84	3 650 358.86		R8	-64 423.98	3 650 769.42		
L9	-64 743.63	3 650 289.60		R9	-64 451.68	3 650 739.38		
L10	-64 831.20	3 650 115.38		R10	-64 501.88	3 650 685.01		
L11	-64 862.78	3 650 040.17		R11	-64 635.68	3 650 518.34		
L12	-64 889.85	3 649 967.47		R12	-64 676.70	3 650 464.01		
L13	-64 913.40	3 649 892.13		R13	-64 708.29	3 650 419.00		
L14	-64 925.37	3 649 852.00		R14	-64 738.56	3 650 372.75		
L15	-64 942.20	3 649 772.38		R15	-64 765.32	3 650 330.01		
L16	-64 985.96	3 649 601.62		R16	-64 776.05	3 650 306.42		
L17	-65 032.79	3 649 399.49		R17	-64 800.73	3 650 268.10		
L18	-65 067.85	3 649 248.16		R18	-64 820.04	3 650 232.14		
L19	-65 083.14	3 649 190.49		R19	-64 838.16	3 650 195.15		
L20	-65 098.68	3 649 131.87		R20	-64 867.61	3 650 133.11		
L21	-65 128.67	3 649 028.06		R21	-64 885.59	3 650 091.20		
L22	-65 136.95	3 649 004.68		R22	-64 901.14	3 650 052.62		
L23	-65 169.14	3 648 923.20		R23	-64 910.99	3 650 027.03		
L24	-65 209.74	3 648 830.28		R24	-64 920.33	3 650 001.52		
L25	-65 251.72	3 648 741.30		R25	-64 929.43	3 649 975.68		
L26	-65 300.30	3 648 651.69		R26	-64 938.09	3 649 949.57		
L27	-65 353.08	3 648 566.31		R27	-64 950.49	3 649 910.41		
L28	-65 407.76	3 648 481.07		R28	-64 954.89	3 649 894.68		
L29	-65 442.73	3 648 429.12		R29	-64 955.91	3 649 860.30		
L30	-65 475.85	3 648 387.13		R30	-64 977.97	3 649 785.10		
L31	-65 512.25	3 648 340.98		R31	-64 989.70	3 649 739.51		
L32	-65 573.37	3 648 268.57		R32	-65 046.18	3 649 511.63		
L33	-65 666.07	3 648 173.12		R33	-65 099.33	3 649 275.59		
L34	-65 694.85	3 648 144.59		R34	-65 124.02	3 649 177.94		
L35	-65 755.22	3 648 083.33		R35	-65 139.55	3 649 121.52		
L36	-65 852.34	3 647 990.45		R36	-65 145.53	3 649 101.00		
L37	-65 938.41	3 647 912.24		R37	-65 153.64	3 649 074.84		
L38	-66 160.89	3 647 710.80		R38	-65 162.05	3 649 048.78		
L39	-66 190.09	3 647 684.35		R39	-65 170.84	3 649 022.75		
L40	-66 301.78	3 647 583.23		R40	-65 179.96	3 648 996.96		
L41	-66 647.58	3 647 269.33		R41	-65 203.25	3 648 932.94		
L42	-67 833.36	3 646 193.83		R42	-65 227.60	3 648 864.82		
L43	-68 557.22	3 645 536.64		R43	-65 232.05	3 648 863.05		
L44	-68 682.50	3 645 436.44		R44	-65 287.04	3 648 757.39		
L45	-68 818.05	3 645 349.56		R45	-65 331.92	3 648 673.92		
L46	-68 961.73	3 645 277.30		R46	-65 383.97	3 648 586.90		
L47	-69 110.86	3 645 219.06		R47	-65 426.02	3 648 522.67		
L48	-69 147.45	3 645 205.33		R48	-65 431.77	3 648 514.55		
L49	-69 628.91	3 645 029.78		R49	-65 465.55	3 648 466.84		
L50	-69 966.70	3 644 906.19		R50	-65 472.57	3 648 456.92		
L51	-70 003.63	3 644 892.67		R51	-65 521.19	3 648 390.74		
				Vel	11	Van	14	P572/06
				Sheet		of		

PADRESERWE KOÖRDINATE				ROAD RESERVE CO-ORDINATES			
LINKERKANT/LEFT HAND SIDE				REGTERKANT/RIGHT HAND SIDE			
	Y	X	WG 21		Y	X	
L52	-70 860.09	3 644	580.07	R52	-65 534.47	3 648	415.72
L53	-71 059.59	3 644	507.28	R53	-65 709.27	3 648	178.48
L54	-71 489.06	3 644	350.79	R54	-66 230.80	3 647	705.06
L55	-71 569.81	3 644	318.33	R55	-66 294.81	3 647	646.56
L56	-71 637.48	3 644	290.96	R56	-66 323.36	3 647	619.45
L57	-71 784.01	3 644	226.19	R57	-67 869.91	3 646	216.31
L58	-72 305.15	3 643	985.64	R58	-68 553.27	3 645	596.18
L59	-72 435.62	3 643	916.51	R59	-68 576.20	3 645	575.21
L60	-72 820.52	3 643	704.87	R60	-68 611.62	3 645	545.12
L61	-73 243.96	3 643	471.65	R61	-68 652.24	3 645	514.91
L62	-73 389.77	3 643	407.48	R62	-68 695.79	3 645	486.04
L63	-73 541.10	3 643	357.31	R63	-68 730.26	3 645	466.20
L64	-74 013.46	3 643	269.61	R64	-68 765.63	3 645	448.01
L65	-74 169.55	3 643	237.37	R65	-68 898.40	3 645	396.79
L66	-74 325.13	3 643	199.48	R66	-68 889.64	3 645	362.98
L67	-74 479.38	3 643	156.31	R67	-68 950.65	3 645	332.59
L68	-74 578.60	3 643	125.78	R68	-68 987.98	3 645	315.91
L69	-74 632.41	3 643	109.31	R69	-69 063.75	3 645	285.32
L70	-77 038.54	3 642	267.99	R70	-69 973.35	3 644	953.12
L71	-77 131.06	3 642	235.73	R71	-70 024.56	3 644	934.42
L72	-77 265.51	3 642	188.86	R72	-70 851.77	3 644	632.21
L73	-77 730.62	3 642	026.60	R73	-71 077.93	3 644	549.66
L74	-78 228.07	3 641	853.25	R74	-71 451.38	3 644	412.92
L75	-78 645.47	3 641	707.47	R75	-71 519.88	3 644	386.86
L76	-78 816.33	3 641	647.86	R76	-71 646.67	3 644	336.67
L77	-78 913.04	3 641	614.06	R77	-71 747.66	3 644	293.26
L78	-79 064.66	3 641	555.05	R78	-71 847.43	3 644	248.57
L79	-79 211.77	3 641	493.59	R79	-72 268.28	3 644	052.38
L80	-79 627.26	3 641	298.67	R80	-72 317.68	3 644	028.48
L81	-80 850.64	3 640	724.05	R81	-72 415.59	3 643	979.20
L82	-81 304.99	3 640	511.69	R82	-72 536.46	3 643	915.19
L83	-81 877.04	3 640	243.06	R83	-72 840.55	3 643	746.84
L84	-82 143.21	3 640	118.62	R84	-73 109.53	3 643	598.31
L85	-82 258.02	3 640	065.04	R85	-73 347.92	3 643	474.04
L86	-82 413.43	3 640	001.54	R86	-73 394.45	3 643	518.18
L87	-82 572.11	3 639	943.06	R87	-73 495.61	3 643	433.67
L88	-82 731.01	3 639	889.73	R88	-73 631.83	3 643	397.73
L89	-82 893.08	3 639	842.19	R89	-74 320.34	3 643	269.11
L90	-83 424.25	3 639	704.17	R90	-74 599.85	3 643	174.33
L91	-83 794.36	3 639	607.71	R91	-77 077.11	3 642	324.29
L92	-84 298.75	3 639	476.44	R92	-77 349.50	3 642	239.10
L93	-84 631.95	3 639	389.84	R93	-77 685.16	3 642	124.33
L94	-85 205.12	3 639	241.20	R94	-77 673.01	3 642	088.31
L95	-85 416.38	3 639	186.20	R95	-78 244.44	3 641	892.59
L96	-85 576.30	3 639	136.61	R96	-78 256.69	3 641	928.53
L97	-85 749.51	3 639	072.36	R97	-78 544.60	3 641	829.96
L98	-85 890.31	3 639	012.68	R98	-79 540.57	3 641	488.96
L99	-86 058.86	3 638	929.39	R99	-79 771.55	3 641	386.45
L100	-86 187.78	3 638	857.38	R100	-80 279.77	3 641	043.55
L101	-86 659.50	3 638	575.23	R101	-80 745.38	3 640	822.52
L102	-86 887.36	3 638	438.82	R102	-81 421.00	3 640	508.56

Vel 12 Van 14
 Sheet of P572/06

PADRESERWE KOÖRDINATE				/ ROAD RESERVE CO-ORDINATES				
LINKERKANT/LEFT HAND SIDE				REGTERKANT/RIGHT HAND SIDE				
	Y	X	WG 21		Y	X		
L103	-87 924.31	3 637 817.89		R103	-81 750.24	3 640 354.10		
L104	-88 059.84	3 637 731.10		R104	-82 290.37	3 640 178.08		
L105	-88 172.06	3 637 653.59		R105	-82 403.17	3 640 141.42		
L106	-88 262.09	3 637 583.95		R106	-82 393.92	3 640 056.75		
L107	-88 326.77	3 637 530.83		R107	-82 602.23	3 639 975.24		
L108	-88 409.87	3 637 459.18		R108	-82 986.61	3 639 859.92		
L109	-88 490.84	3 637 384.92		R109	-83 430.84	3 639 745.66		
L110	-88 625.37	3 637 250.57		R110	-83 735.02	3 639 670.55		
L111	-88 972.90	3 636 870.92		R111	-83 812.56	3 639 649.79		
L112	-89 025.92	3 636 807.50		R112	-84 019.38	3 639 597.17		
L113	-89 068.40	3 636 753.42		R113	-84 084.65	3 639 624.84		
L114	-89 123.94	3 636 677.61		R114	-84 278.99	3 639 583.97		
L115	-89 163.06	3 636 619.11		R115	-84 494.65	3 639 543.55		
L116	-89 194.60	3 636 568.31		R116	-85 025.79	3 639 358.15		
L117	-89 235.73	3 636 496.88		R117	-85 224.45	3 639 289.17		
L118	-89 279.93	3 636 411.57		R118	-85 358.38	3 639 249.81		
L119	-89 325.94	3 636 311.71		R119	-85 429.95	3 639 232.73		
L120	-89 370.81	3 636 196.83		R120	-85 700.47	3 639 169.09		
L121	-89 483.25	3 635 862.93		R121	-85 688.33	3 639 138.78		
L122	-89 498.91	3 635 816.41		R122	-85 806.39	3 639 099.06		
L123	-89 630.03	3 635 428.76		R123	-86 232.11	3 638 885.08		
L124	-89 799.81	3 634 928.29		R124	-86 947.51	3 638 456.82		
L125	-89 971.05	3 634 425.06		R125	-87 101.88	3 638 364.12		
L126	-90 056.17	3 634 174.36		R126	-87 503.61	3 638 123.57		
L127	-90 115.25	3 634 000.36		R127	-87 936.56	3 637 864.65		
L128	-90 279.95	3 633 514.92		R128	-88 130.77	3 637 738.59		
L129	-90 439.13	3 633 046.67		R129	-88 235.59	3 637 662.02		
L130	-90 505.20	3 632 852.18		R130	-88 281.68	3 637 626.62		
L131	-90 575.96	3 632 643.95		R131	-88 415.31	3 637 516.52		
L132	-90 605.95	3 632 547.92		R132	-88 522.02	3 637 418.37		
L133	-90 652.26	3 632 383.27		R133	-88 594.90	3 637 347.34		
L134	-90 674.27	3 632 295.85		R134	-88 653.74	3 637 285.54		
L135	-90 710.39	3 632 131.25		R135	-88 830.59	3 637 094.11		
L136	-90 736.44	3 631 988.68		R136	-88 869.21	3 637 052.56		
L137	-90 786.95	3 631 638.51		R137	-88 957.18	3 636 956.61		
L138	-90 799.79	3 631 529.02		R138	-88 985.99	3 636 924.20		
L139	-90 815.04	3 631 452.42		R139	-89 014.20	3 636 891.53		
L140	-90 841.34	3 631 265.93		R140	-89 069.36	3 636 824.20		
L141	-90 884.38	3 630 959.52		R141	-89 095.78	3 636 789.66		
L142	-90 945.18	3 630 533.74		R142	-89 121.48	3 636 754.48		
L143	-90 975.31	3 630 328.07		R143	-89 154.46	3 636 707.00		
L144	-90 995.64	3 630 189.32		R144	-89 170.58	3 636 682.75		
L145	-91 019.74	3 630 024.81		R145	-89 224.18	3 636 596.57		
L146	-91 024.17	3 629 992.52		R146	-89 258.26	3 636 537.05		
L147	-91 027.51	3 629 969.27		R147	-89 303.68	3 636 449.39		
L148	-91 055.97	3 629 779.05		R148	-89 322.57	3 636 410.16		
L149	-91 064.18	3 629 716.83		R149	-89 340.23	3 636 370.42		
L150	-91 066.70	3 629 697.69		R150	-89 357.22	3 636 330.41		
L151	-91 071.13	3 629 664.13		R151	-89 373.62	3 636 290.12		
L152	-91 110.53	3 629 389.98		R152	-89 403.89	3 636 208.35		
L153	-91 114.86	3 629 359.70		R153	-89 518.15	3 635 872.54		
				Vel	13	Van	14	P572/06
				Sheet		of		

LINKERKANT/LEFT HAND SIDE				REGTERKANT/RIGHT HAND SIDE			
	Y	X	WG 21		Y	X	
1154	-91 119.74	3 629	325.57	3154	-89 527.74	3 635	844.36
1155	-91 122.76	3 629	304.52	3155	-89 661.56	3 635	431.94
1156	-91 131.76	3 629	241.59	2156	-89 829.14	3 634	936.14
1157	-91 133.54	3 629	229.19	2157	-90 086.83	3 634	180.69
1158	-91 207.03	3 628	717.44	3158	-90 146.68	3 634	005.19
1159	-91 211.03	3 628	690.46	1159	-90 310.06	3 633	524.23
1160	-91 223.91	3 628	600.69	1160	-90 486.56	3 633	005.53
1161	-91 249.38	3 628	421.37	R161	-90 502.05	3 632	973.23
1162	-91 250.77	3 628	414.56	2162	-90 533.68	3 632	876.44
1163	-91 259.05	3 628	374.08	3163	-90 622.43	3 632	604.81
1164	-91 259.46	3 628	372.09	3164	-90 656.44	3 632	487.67
1165	-91 278.49	3 628	291.88	3165	-90 689.36	3 632	368.75
1166	-91 282.26	3 628	275.99	1166	-90 712.46	3 632	272.80
1167	-91 309.51	3 628	186.58	3167	-90 733.39	3 632	177.88
1168	-91 349.07	3 628	056.75	7168	-90 755.03	3 632	065.65
1169	-91 366.88	3 628	013.69	3169	-90 762.97	3 632	024.21
1170	-91 350.87	3 627	994.17	R170	-90 783.69	3 631	891.55
1171	-91 365.75	3 627	969.89	R171	-90 815.71	3 631	704.86
				3172	-90 880.66	3 631	281.40
				2173	-90 925.98	3 630	983.71
				2174	-90 916.33	3 630	960.76
				3175	-90 975.85	3 630	547.53
				2176	-91 006.06	3 630	338.39
				2177	-91 026.13	3 630	199.46
				3178	-91 051.01	3 630	027.29
				3179	-91 058.32	3 629	976.54
				3180	-91 084.35	3 629	795.72
				3181	-91 092.22	3 629	741.11
				3182	-91 097.03	3 629	709.08
				1183	-91 112.11	3 629	608.99
				2184	-91 125.85	3 629	517.82
				3185	-91 143.10	3 629	405.63
				R186	-91 157.04	3 629	315.25
				1187	-91 169.40	3 629	235.07
				R188	-91 242.81	3 628	725.42
				1189	-91 278.17	3 628	493.35
				R190	-91 295.56	3 628	379.21
				1191	-91 296.29	3 628	348.54
				1192	-91 309.57	3 628	296.26
				1193	-91 317.53	3 628	264.93
				1194	-91 326.69	3 628	235.95
				R195	-91 342.89	3 628	184.70
				1196	-91 358.47	3 628	143.11
				1197	-91 419.17	3 628	053.47
				1198	-91 472.73	3 628	088.85
				R199	-91 493.93	3 628	054.73
				R200	-91 464.13	3 628	037.27

Vel	14	Van	14	P572/06
Sheet		of		