

---

GOVERNMENT NOTICES  
GOEWERMENSKENNISGEWINGS

---

DEPARTMENT OF TRANSPORT  
DEPARTEMENT VAN VERVOER

No. 1135

23 November 2005

THE SOUTH AFRICAN NATIONAL ROAD AGENCY LIMITED

DECLARATION AMENDMENT OF N2 SECTION 7

AMENDMENT OF DECLARATION NO. 59 OF 1979, A PORTION OF NATIONAL ROUTE 2,  
SECTION 7 (KRAAI BOSCH TO SEDGEFIELD)

By virtue of powers vested in me by Section 40(1)(b) of the South African National Road Agency Limited and National Roads Act 1998 (Act No. 7 of 1998), I hereby amend declaration No. 59 of 1979 by substituting the subjoined sheets 1A, and 4A for sheets 1 and 4 respectively of plan P285/78.

  
\_\_\_\_\_  
MR J RADEBE, MP  
MINISTER OF TRANSPORT

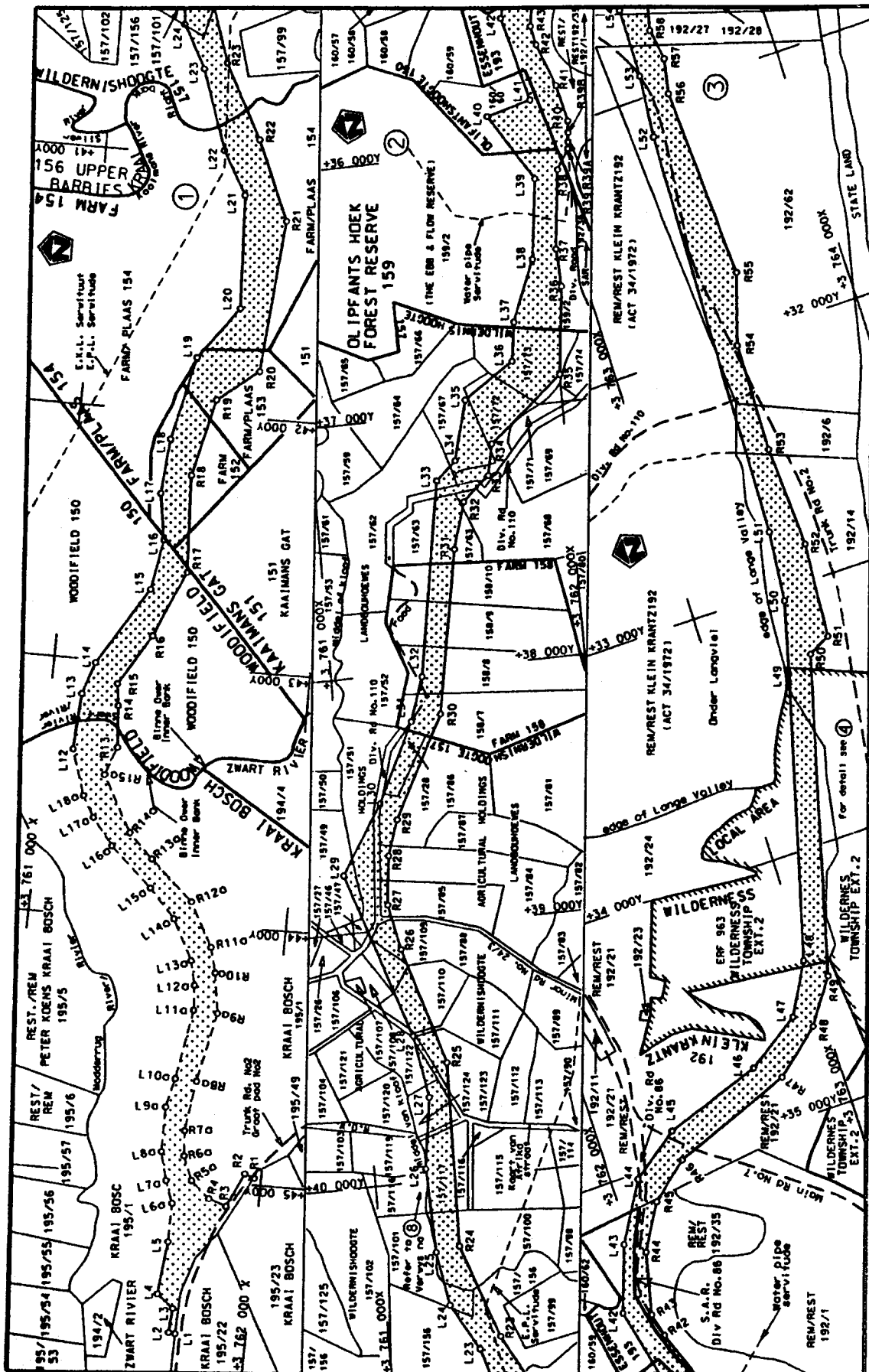

<p>Die Suid Afrikaanse Nasionale Padagentskap Beperk The South African National Roads Agency Limited</p>	<p>Die figuur getoon The figure shown</p> <p>stelt die podreserwe voor van 'n gedeelte represents the road reserve of a portion van Nasionale Roete N2 of National Route</p>	<p>Vel Sheet 1A of 7 Plan P 285/78</p>
--	--	--

D.O.9.A

LINKERKANT/LEFT HAND SIDE				REGTERKANT/RIGHT HAND SIDE		
	Y	X	LO	23°	Y	X
L1	+45 594.00	+3 761	739.00	R1	+44 966.00	+3 761 955.00
L2	+45 593.07	+3 761	724.88	R2	+44 949.77	+3 761 925.81
L3	+45 506.66	+3 761	725.86	R3	+45 084.74	+3 761 868.62
L4	+45 445.37	+3 761	658.20	R4	+45 068.33	+3 761 805.66
L5	+45 235.38	+3 761	670.15	R5a	+45 003.70	+3 761 733.27
L6a	+45 099.82	+3 761	667.92	R6a	+44 910.09	+3 761 695.06
L7a	+45 013.28	+3 761	635.99	R7a	+44 811.45	+3 761 687.03
L8a	+44 900.91	+3 761	607.58	R8a	+44 613.85	+3 761 713.62
L9a	+44 732.94	+3 761	603.96	R9a	+44 339.68	+3 761 765.29
L10a	+44 611.47	+3 761	631.37	R10a	+44 181.87	+3 761 740.56
L11a	+44 334.58	+3 761	674.45	R11a	+44 082.15	+3 761 714.99
L12a	+44 237.21	+3 761	667.31	R12a	+43 907.11	+3 761 622.47
L13a	+44 142.37	+3 761	644.78	R13a	+43 751.85	+3 761 454.37
L14a	+43 981.72	+3 761	562.60	R14a	+43 656.52	+3 761 358.28
L15a	+43 865.87	+3 761	460.05	R15a	+43 436.14	+3 761 237.59
L16a	+43 714.52	+3 761	293.79	R13	+43 336.48	+3 761 281.38
L17a	+43 609.55	+3 761	210.76	R14	+43 165.54	+3 761 261.33
L18a	+43 526.77	+3 761	163.26	R15	+43 085.96	+3 761 246.05
L12	+43 351.74	+3 761	104.04	R16	+42 884.07	+3 761 361.80
L13	+43 132.10	+3 761	113.06	R17	+42 627.56	+3 761 470.49
L14	+43 005.86	+3 761	154.08	R18	+42 236.47	+3 761 448.57
L15	+42 698.85	+3 761	338.85	R19	+41 939.52	+3 761 514.04
L16	+42 512.44	+3 761	374.79	R20	+41 807.28	+3 761 667.36
L17	+42 318.77	+3 761	345.14	R21	+41 219.22	+3 761 718.30
L18	+42 106.30	+3 761	363.13	R22	+40 908.81	+3 761 580.03
L19	+41 775.36	+3 761	426.93	R23	+40 627.64	+3 761 426.19
L20	+41 577.26	+3 761	571.66	R24	+40 265.59	+3 761 306.62
L21	+41 138.76	+3 761	551.06	R25	+39 544.88	+3 761 324.37
L22	+40 970.30	+3 761	450.93	R26	+39 080.02	+3 761 176.51
L23	+40 665.91	+3 761	345.84	R27	+38 892.58	+3 761 146.64
L24	+40 483.92	+3 761	249.36	R28	+38 704.30	+3 761 165.94
L25	+40 276.30	+3 761	212.22	R29	+38 561.70	+3 761 215.82
L26	+39 948.34	+3 761	202.87	R30	+38 170.91	+3 761 422.19
L27	+39 672.12	+3 761	235.89			
L28	+39 445.44	+3 761	205.43			
L29	+38 759.58	+3 760	987.51			
L30	+38 488.44	+3 761	154.26			

Vel 4A Van 7  
Sheet of

P 285/78