



Government Gazette Staatskoerant

REPUBLIC OF SOUTH AFRICA

Vol. 426 Pretoria, 12 December 2000/12 Desember 2000
No. 21889



AIDS HELPLINE: 0800-123-22 Prevention is the cure

G O V E R N M E N T N O T I C E
G O E W E R M E N T S K E N N I S G E W I N G

**DEPARTMENT OF TRANSPORT
DEPARTEMENT VAN VERVOER**

No. 1364

12 December 2000

THE SOUTH AFRICAN NATIONAL ROADS AGENCY LIMITED

**REPEAL OF PROCLAMATION NO 60 OF 1983 AND RE-DECLARATION OF
NATIONAL ROUTE 3 SECTION 6: KEEVERSFontein INTERCHANGE:
DISTRICT OF KLIPRIVER**

By virtue of the powers vested in me by section 40(1)(b) of the South African National Roads Agency Limited and National Roads Act 1998 (Act No **7 of 1998**), I hereby repeal Proclamation No 60 of 1983, and in terms of section 40(1)(a) of the said Act, I hereby declare that the route of which the boundaries have been fixed by survey, as indicated on the attached plan P479/00, shall be a National Road.

(National Route: Vaalkrans - Keeversfontein Interchange, District Klip River)

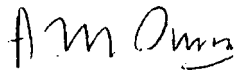

DR ABDULAH M OMAR, MP
MINISTER OF TRANSPORT

NO. 1364

12 Desember 2000

DIE SUID-AFRIKAANSE NASIONALE PADAGENTSKAP BEPERK**INTREKKING VAN PROKLAMASIE NO 60 VAN 1983 EN HERVERKLARING
VAN NASIONALE ROETE 3 SEKSIE 6: KEEVERSFontein WISSELAAR:
DISTRIK KLIPRIVIER**

Kragtens die bevoegdheid my verleen by artikel 40(1)(b) van die Suid-Afrikaanse Nasionale Padagentskap Beperk en Nasionale Paaie Wet, 1998 (Wet No 7 van 1998), trek ek hierby Proklamasie No 60 van 1983 in, en in terme van artikel 40(1)(a) van die genoemde wet, verklaar ek hierby dat die roete waarvan die grense deur opmeting bepaal is, soos aangetoon op die meegaande plan P479/00, 'n Nasionale Pad is.
(Nasionale Roete: Vaalkrans - Keeversfontein Wisselaar, Distrik Kliprivier)

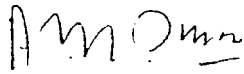

DR ABDULAH M O.MAR, LP
MINISTER VAN VERVOER

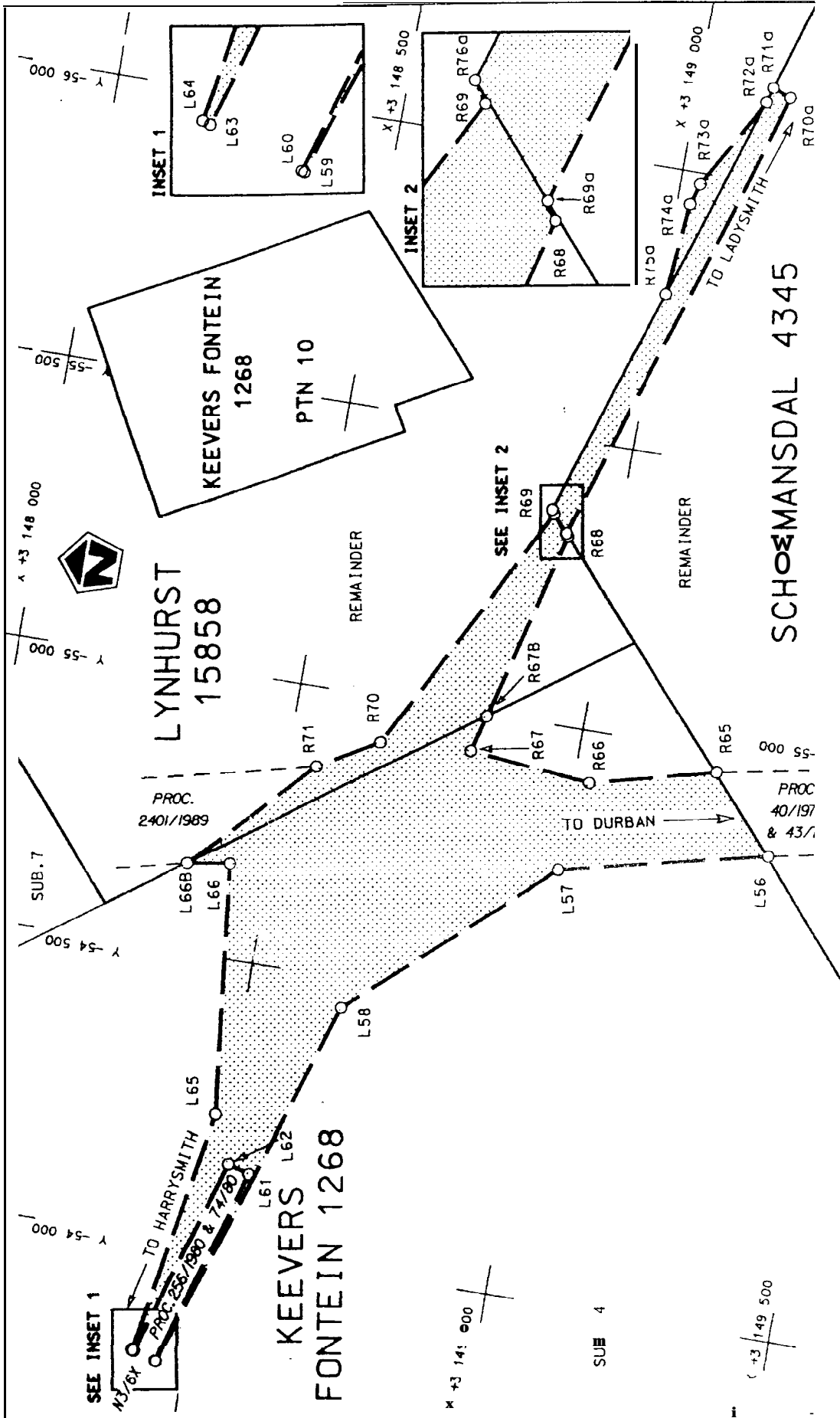

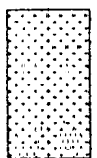
Suid-Afrikaanse Padagentskap Bpk. South African National Roads Agency Ltd.	Die figuur getoon The figure shown		stelsel padreserwe voor van 'n gedeelte represents the road reserve of a portion van Nasionale Roete of National Route	
			Sekste Section	3
			Vol Sheet	1 van of
			P	479/00
D.O.9.A				

PADRESERWE COORDINATE				ROAD RESERVE CO-ORDINATES			
LINKERKANT/LEFT HAND SIDE				REGTERKANT/RIGHT HAND SIDE			
	Y	X	Lo 29°		Y	X	
L56	-54 833.43	3 149	354.72	R65	-54 963.73	3 149	240.67
L57	-54 750.00	3 149	000.00	R66	-54 909.37	3 149	027.59
L58	-54 449.10	3 148	668.72	R67	-54 930.79	3 148	812.13
L59	-53 791.56	3 148	451.76	R67B	-54 995.87	3 148	829.06
L60	-53 791.92	3 148	450.55	R68	-55 330.50	3 148	916.13
L61	-54 137.56	3 148	555.47	R69a	-55 336.81	3 148	912.37
L62	-54 149.18	3 148	517.20	R70a	-56 155.72	3 149	162.87
L63	-53 803.69	3 148	411.88	R71a	-56 168.00	3 149	130.10
L64	-53 804.66	3 148	408.70	R72a	-56 141.16	3 149	122.25
L65	-54 230.00	3 148	481.00	R73a	-55 981.45	3 149	033.32
L66	-54 666.58	3 148	430.78	R74a	-55 944.06	3 149	022.14
L66B	-54 654.41	3 148	357.98	R75a	-55 781.23	3 149	008.46
				R76a	-55 373.44	3 148	880.21
				R69	-55 365.95	3 148	885.11
				R70	-54 920.00	3 148	655.00
				R71	-54 860.00	3 148	552.00