**GOVERNMENT NOTICE
GOEWERMENTSKENNISGEWING**

**DEPARTMENT OF TRANSPORT
DEPARTEMENT VAN VERVOER**

No. 146

8 February 2008

**THE SOUTH AFRICAN NATIONAL ROADS
AGENCY LIMITED**

Registration No: 98/09584/06

DECLARATION AMENDMENT OF NATIONAL ROAD N4 SECTION 3

AMENDMENT OF DECLARATION NO'S. 116 OF 1985 AND 190 OF 1985.

By virtue of section 40 (1)(b) of the South African National Roads Agency Limited and the National Roads Act, 1998 (Act No. 7 of 1998), I hereby amend the following declarations by substituting (I) Declaration No. 116 of 1985 and (II) Declaration No. 190 of 1985, the section from sheet 1 up to the common boundary between farms Rhenosterfontein 318 –JS and Rietfontein 314 –JS on sheet 7 of Plan No. P341/84 and the applicable co-ordinates, with the subjoined sheets 1 to 18 of Plan No. P635/07.

(National Road N4 Section 3: Spitskop – Rhenosterfontein)



MINISTER OF TRANSPORT

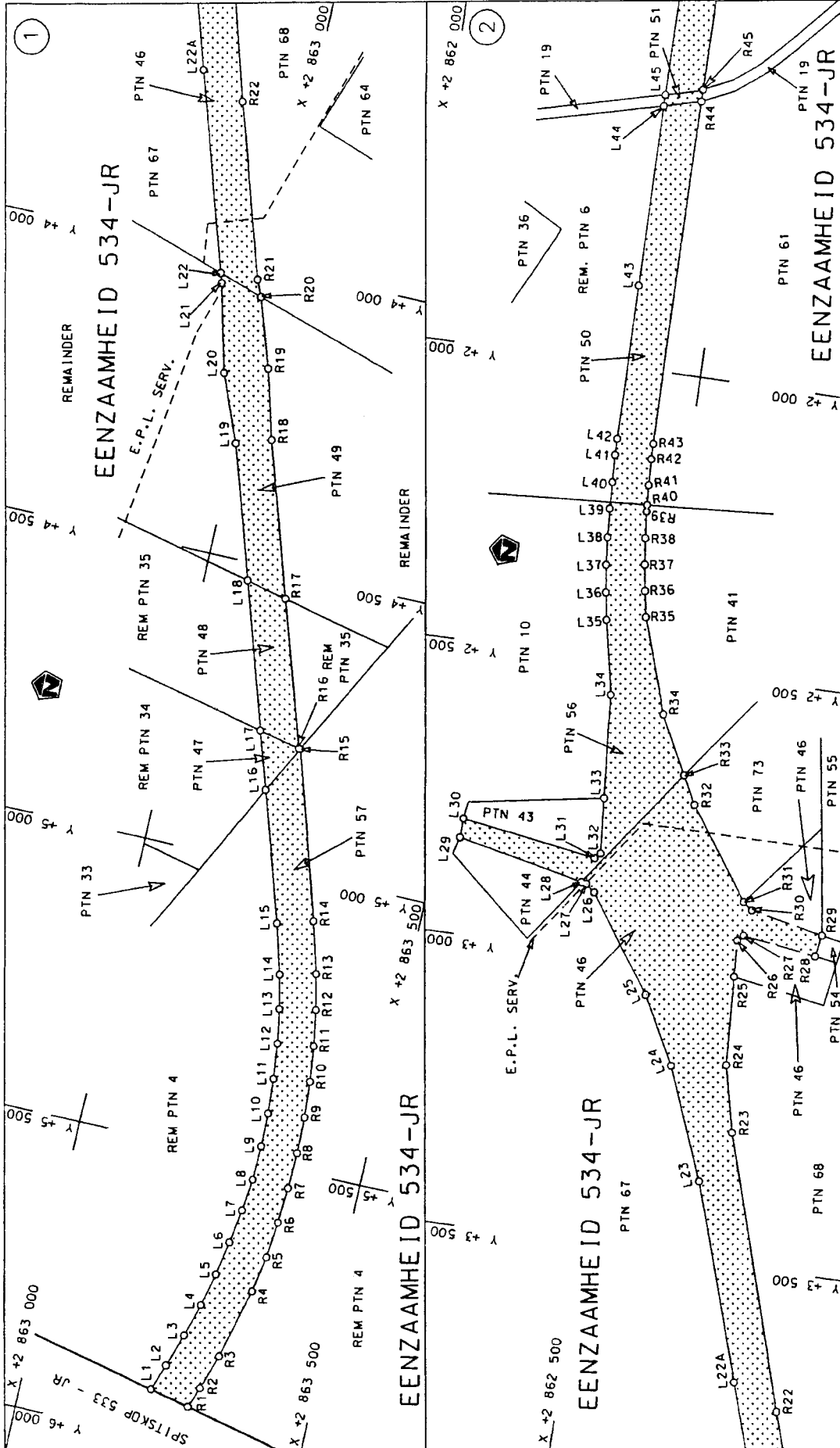

<p>Die Suid Afrikaanse Nasionale Padagentskap Beperk The South African National Roads Agency Limited</p>	<p>Die figuur getoon The figure shown</p>	<p>steldie podreserwe voor van 'n gedeelte represents the road reserve of a portion van Nasionale Roete N4 of National Route</p>	<p>Vel Sheet 1 of 18</p>
		<p>3 Seksie Section</p>	<p>Plan P635/07</p>

D.O.9.A

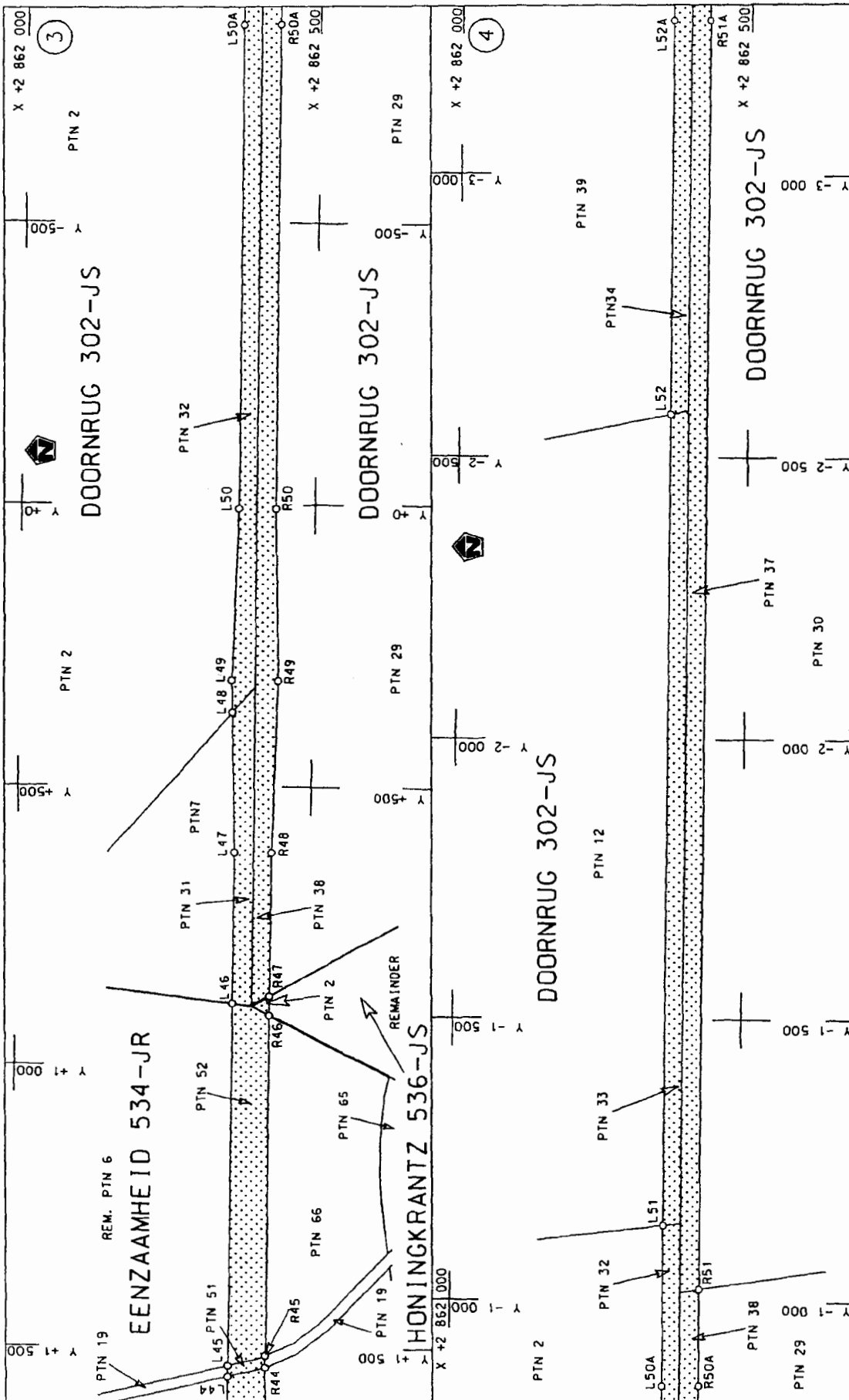

<p>Die Suid Afrikaanse Nasionale Padagentskap Beperk The South African National Roads Agency Limited</p>	<p>Die figuur getoon The figure shown</p>	<p>stel die podreserwe voor van 'n gedeelte represents the road reserve of a portion van Nasionale Roete N4 of National Route</p>	<p>Vel Sheet 2 of 18</p>
<p>Plan P635/07</p>		<p>Seksie N4 Section</p>	<p>3</p>
<p>D.O.9.A</p>			

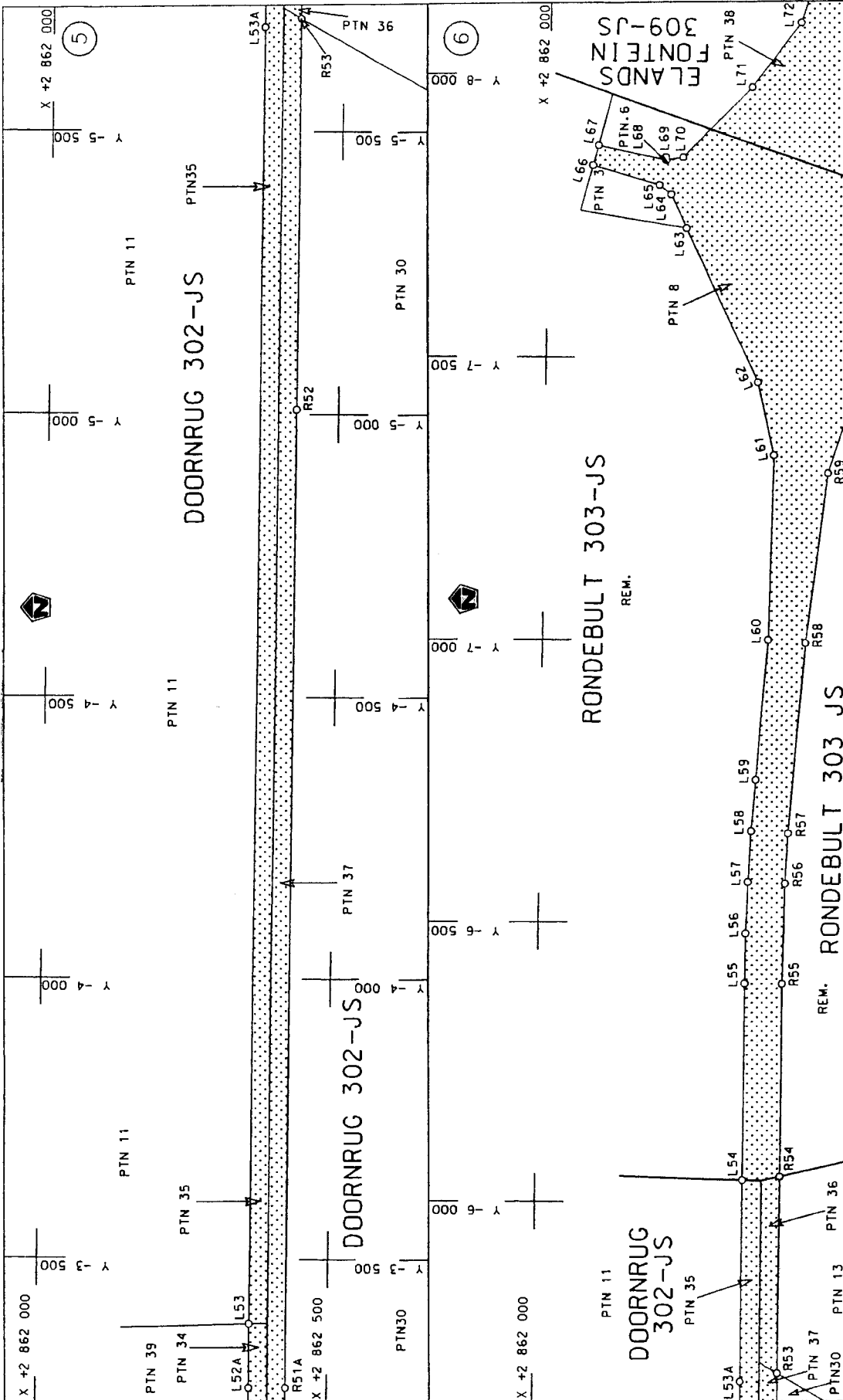

<p>Die Suid Afrikaanse Nasionale Padagentskap Beperk The South African National Roads Agency Limited</p>	<p>Die figuur getoon The figure shown</p>	<p>steldie padreserwe voor van 'n gedeelte represents the road reserve of a portion van Nasionale Roete N4 of National Route</p> <p>3</p>	<p>Vel Sheet 3 of 18 Plan P635/07</p>
--	---	---	---

D.O.9.A

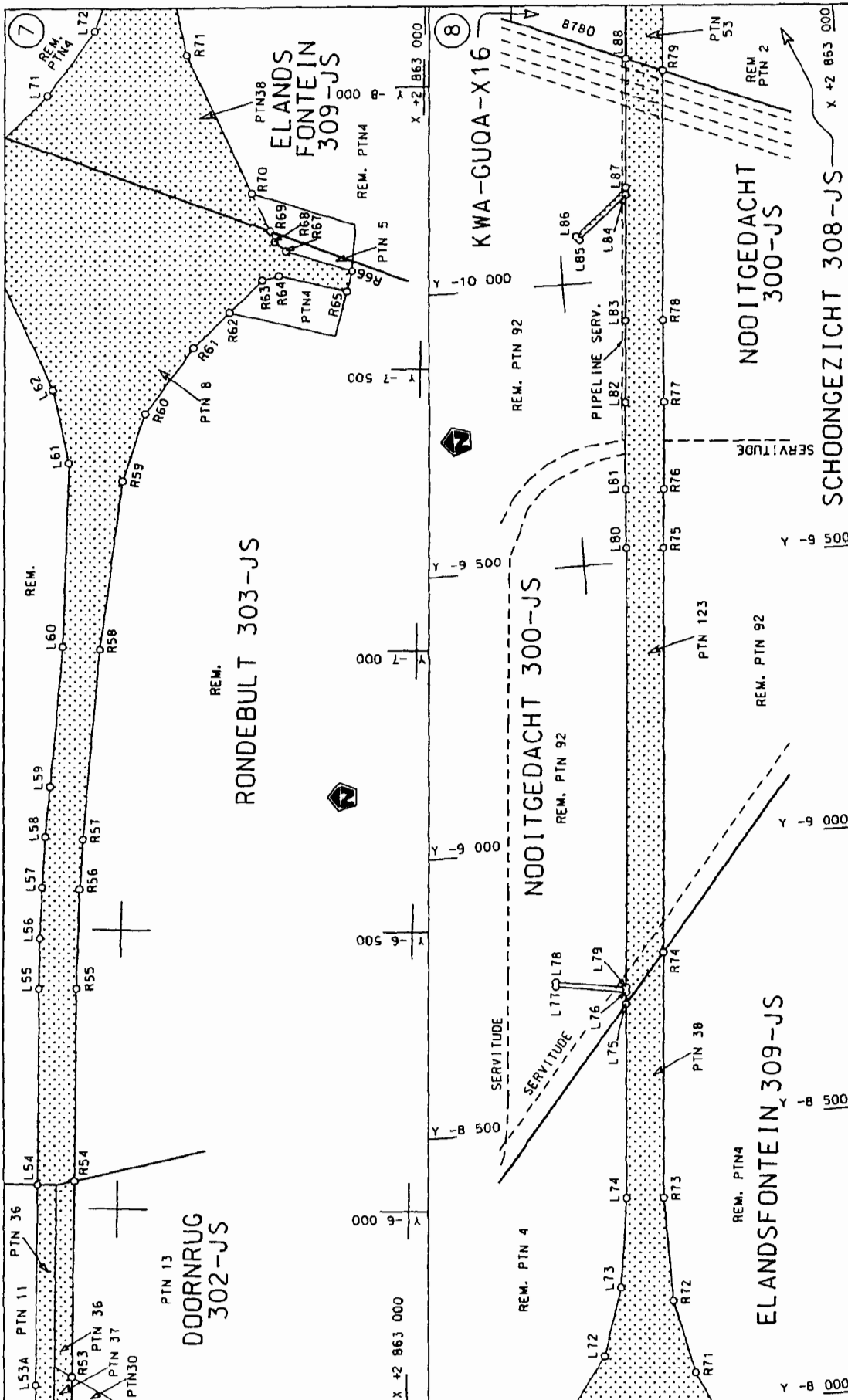

Die Suid-Afrikaanse Nasionale Padagentskap Beperk The South African National Roads Agency Limited	Die figuur getoon The figure shown		stelt die padreserwe voor van 'n gedeelte represents the road reserve of a portion	
			van Nasionale Roete of National Route	N4 Section
			3	Plan P635/07
			Vel Sheet 4 of 18	

D.O.G.A

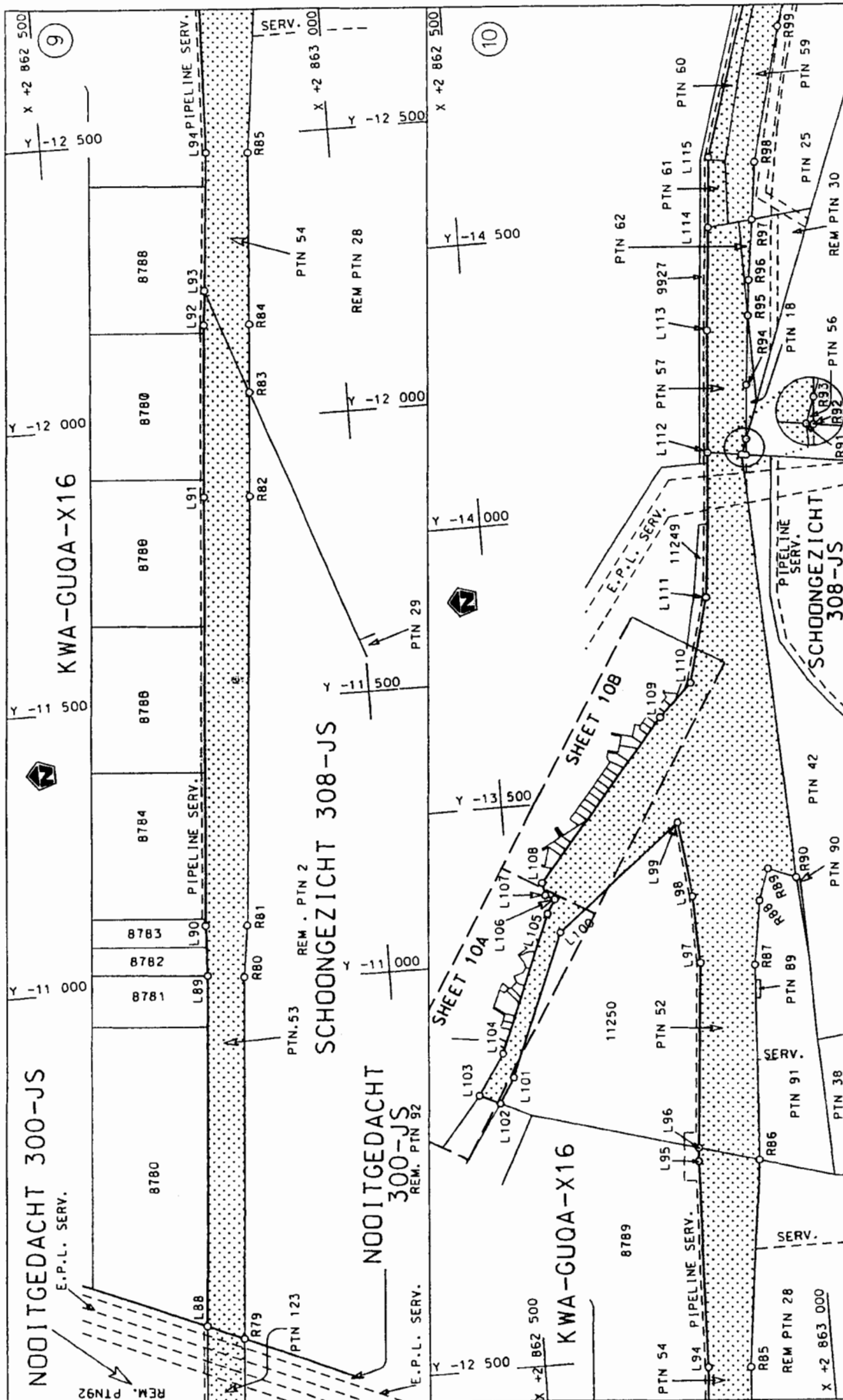

Die Suid Afrikaanse Nasionale Padogenskop Beperk The South African National Roads Agency Limited	Die figuur getoon The figure shown	steeldie podreserwe voor 'n gedeelte represents the road reserve of a portion van Nasionale Roete N4 of National Route	Vel Sheet 5	von of 18
			Plan P635/07	Section 3

D.O.9.A

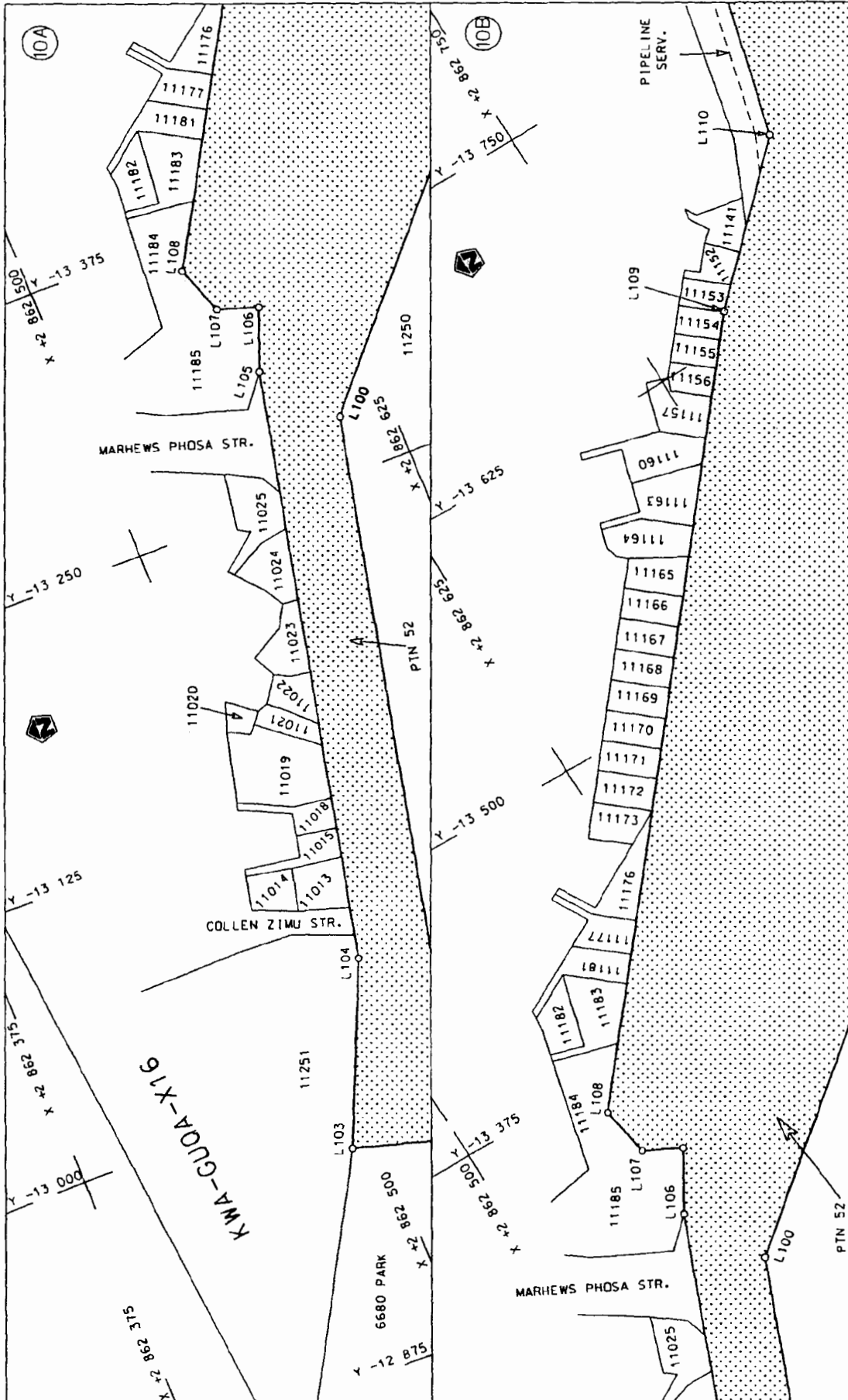

<p>Die Suid Afrikaanse Nasionale Padagentskap Beperk The South African National Roads Agency Limited</p>	<p>Die figuur getoon The figure shown</p>	<p>steldie podreserwe voor van 'n gedeelte represents the road reserve of a portion van Nasionale Roete N4 of National Route</p>	<p>Vel Sheet 6 of 18</p>
<p>Die Suid Afrikaanse Nasionale Padagentskap Beperk The South African National Roads Agency Limited</p>	<p>Die figuur getoon The figure shown</p>	<p>steldie podreserwe voor van 'n gedeelte represents the road reserve of a portion van Nasionale Roete N4 of National Route</p>	<p>Plan P635/07</p>

D.O.9.A

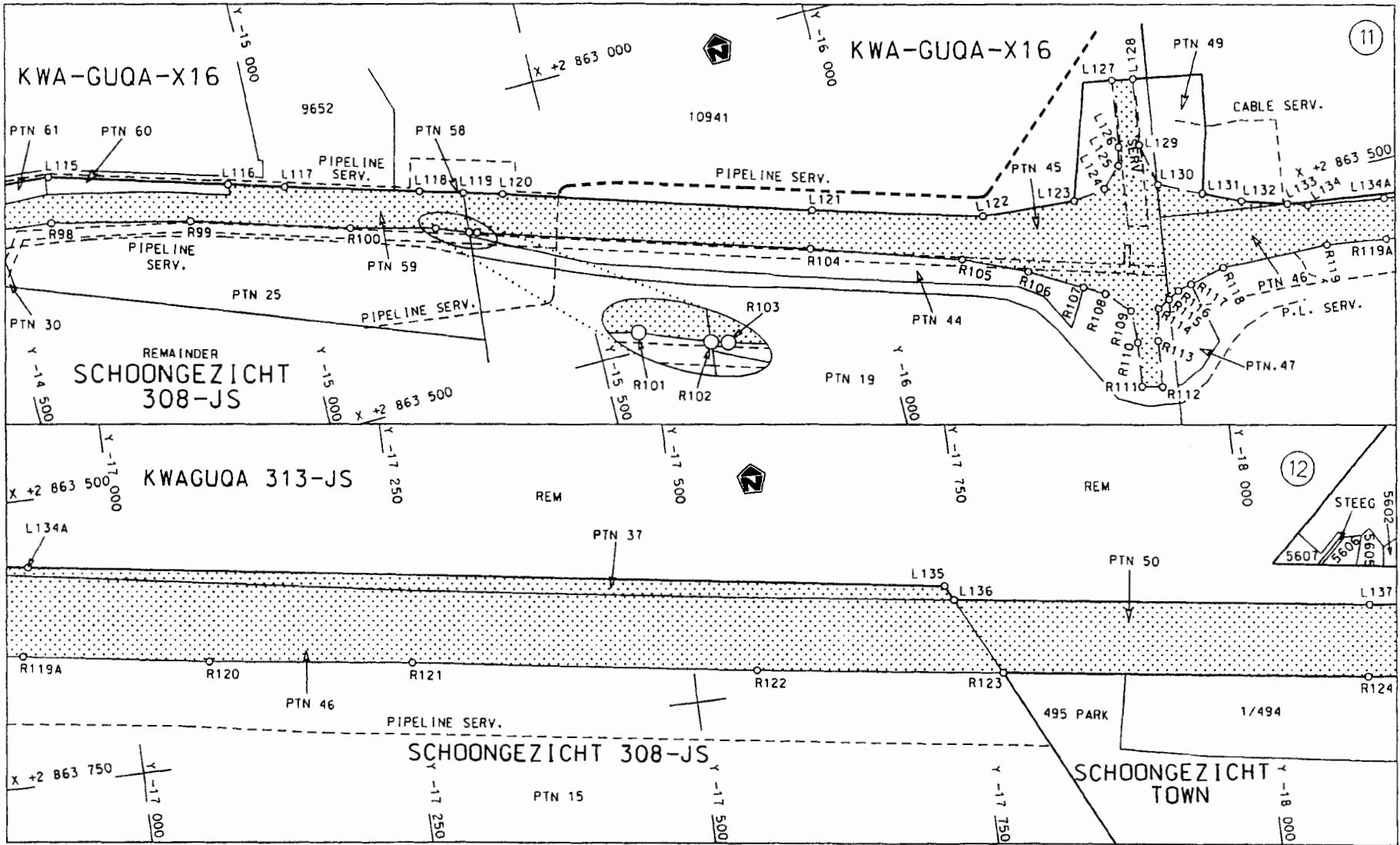

<p>Die Suid Afrikaanse Nasionale Padagentskap Beperk The South African National Roads Agency Limited</p>	<p>Die figuur getoon The figure shown</p>	<p>steldie padreserwe voor van 'n gedeelte represents the road reserve of a portion van Nasionale Roete N4 of National Route</p>	<p>Vel Sheet 7 van 18 Plan P635/07</p>
<p>N4 Seksie 3</p>			<p>3</p>

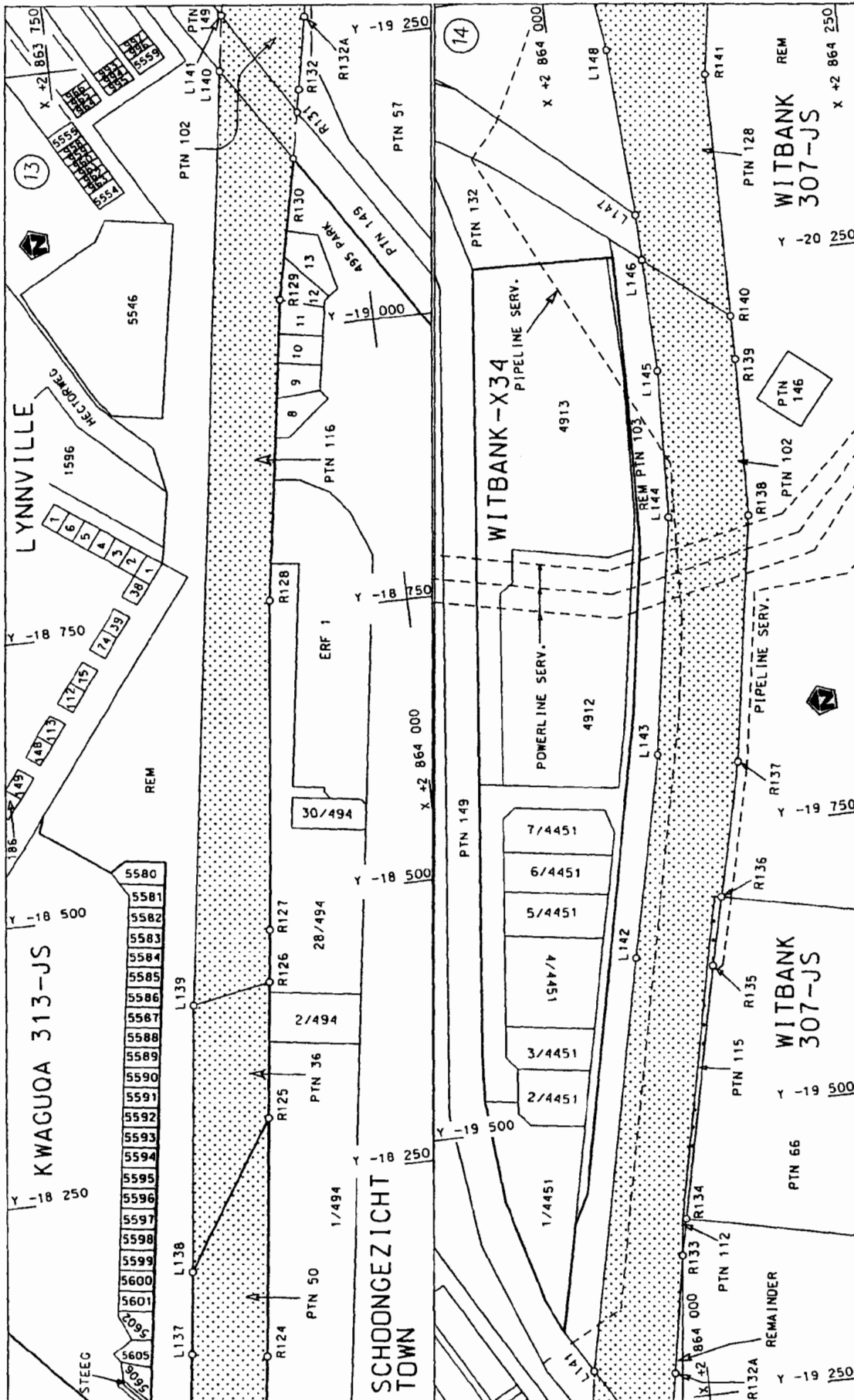

<p>Die Suid Afrikaanse Nasionale Padogenskop Beperk The South African National Roads Agency Limited</p>	<p>Die figuur getoon The figure shown</p>	<p>stelt die padreserwe voor van 'n gedeelte represents the road reserve of a portion van Nasionale Roete N4 of National Route</p>	<p>Vel Sheet 8 of 18 Plan P635/07</p>
---	---	--	---

D.O.9.A

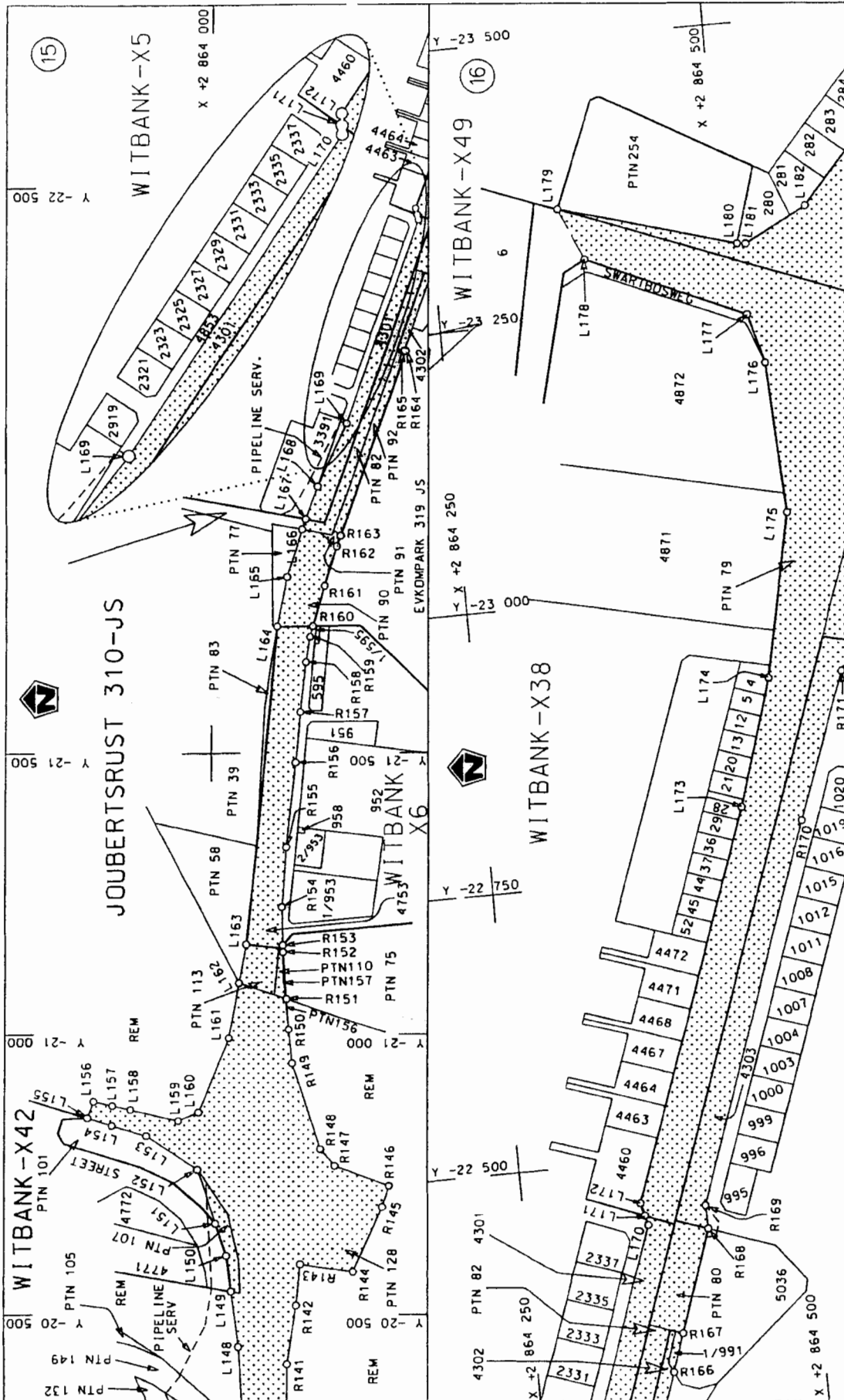

Die Suid Afrikaanse Nasionale Padagentskap Beperk
The South African National Roads Agency Limited

Die figuur getoon
The figure shown

stel die padreserwe voor van 'n gedeelte
represents the road reserve of a portion
van Nasionale Roete N4
of National Route

Vel 9 van 18
Sheet of 18

Plan P635/07
Seksie 3
Section

D.O.9.A

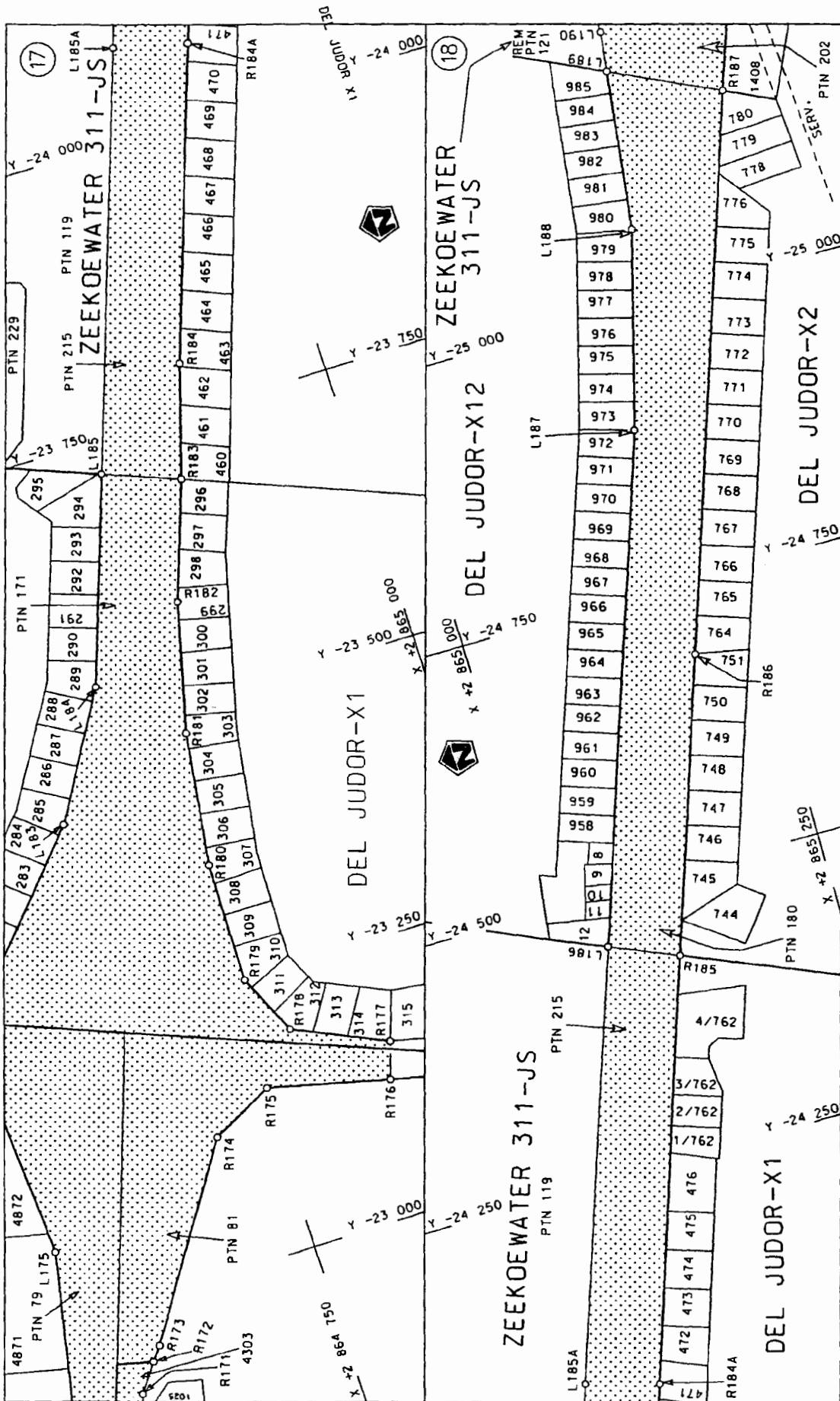

<p>Die Suid Afrikaanse Nasionale Padogentskap Beperk The South African National Roads Agency Limited</p>	<p>Die figuur getoon The figure shown</p>	<p>stelt die padreserwe voor van 'n gedeelte represents the road reserve of a portion van Nasionale Roete N4 of National Route</p>
<p>Vel Sheet 10 of 18 Plan P635/07</p>	<p>3</p>	<p>Seksie Section</p>

D.O.9.A

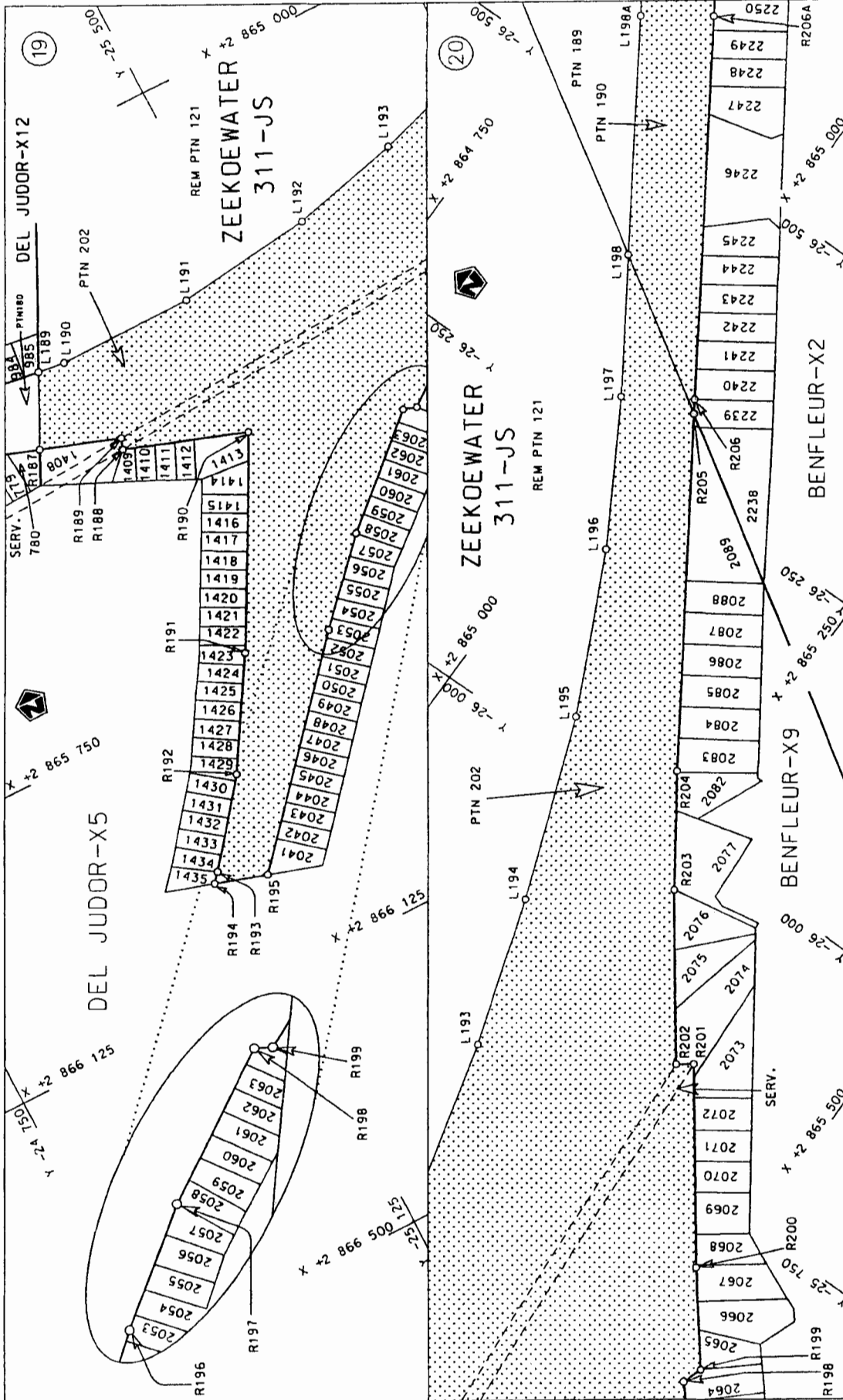

<p>Die Suid Afrikaanse Nasionale Padagentskap Beperk The South African National Roads Agency Limited</p>	<p>Die figuur getoon The figure shown</p>	<p>steidie podreserwe voor van 'n gedeelte represents the road reserve of a portion van Nasionale Roete N4 of National Route</p>	<p>Vel Sheet 11 of 18</p>
		<p>Seksie N4 Section</p>	<p>Plan P635/07</p>
<p>D.O.9.A</p>			

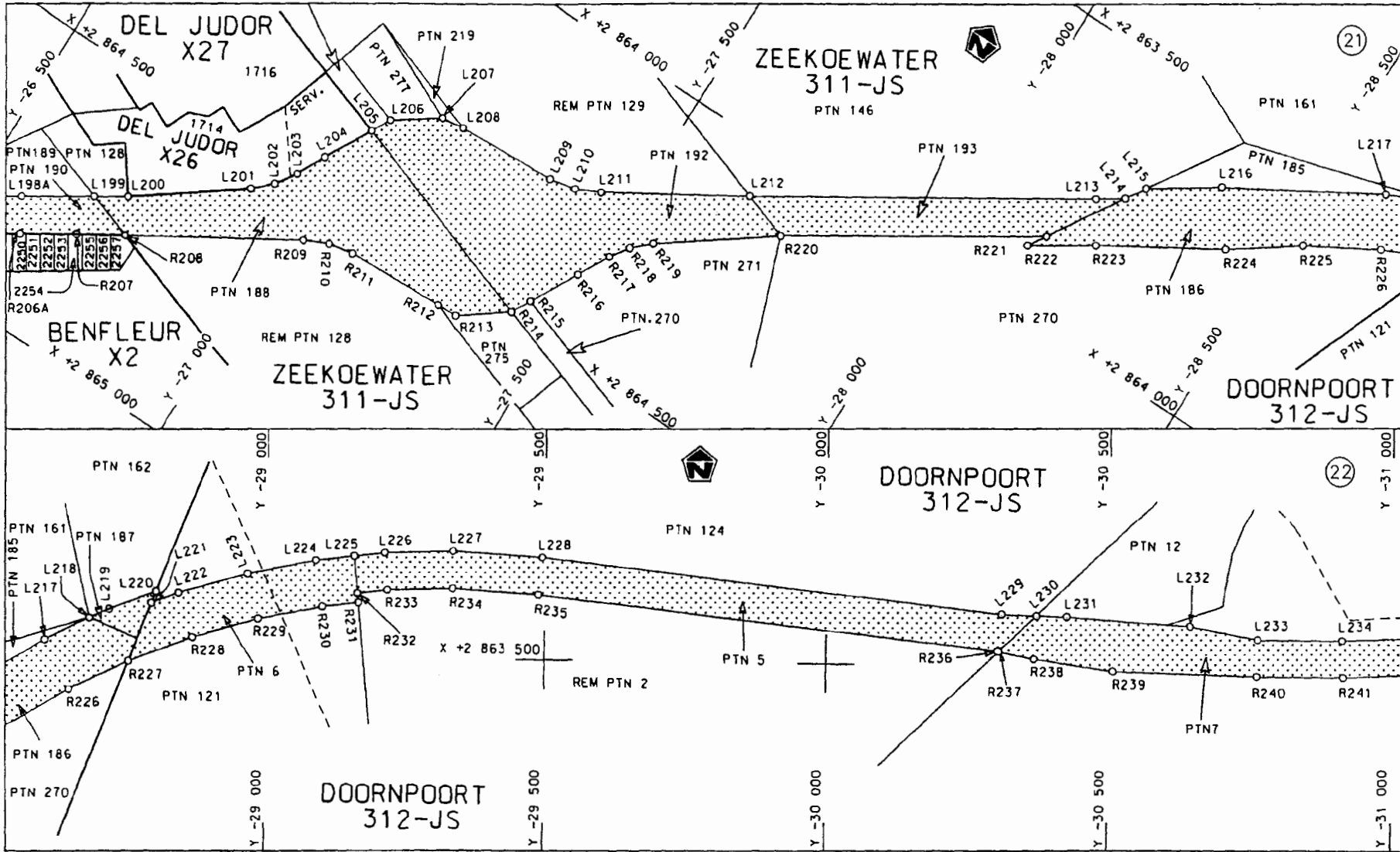

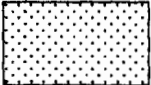
<p>Die Suid Afrikaanse Nasionale Padagentskap Beperk The South African National Roads Agency Limited</p>	<p>Die figuur getoon The figure shown</p> 	<p>steldie padreserwe voor van 'n gedeelte represents the road reserve of a portion van Nasionale Roete N4 of National Route N4</p> <p>Seksie 3 Section 3</p>	<p>Vel 12 van 18 Sheet of 18</p> <p>Plan P635/07</p>
--	---	---	--

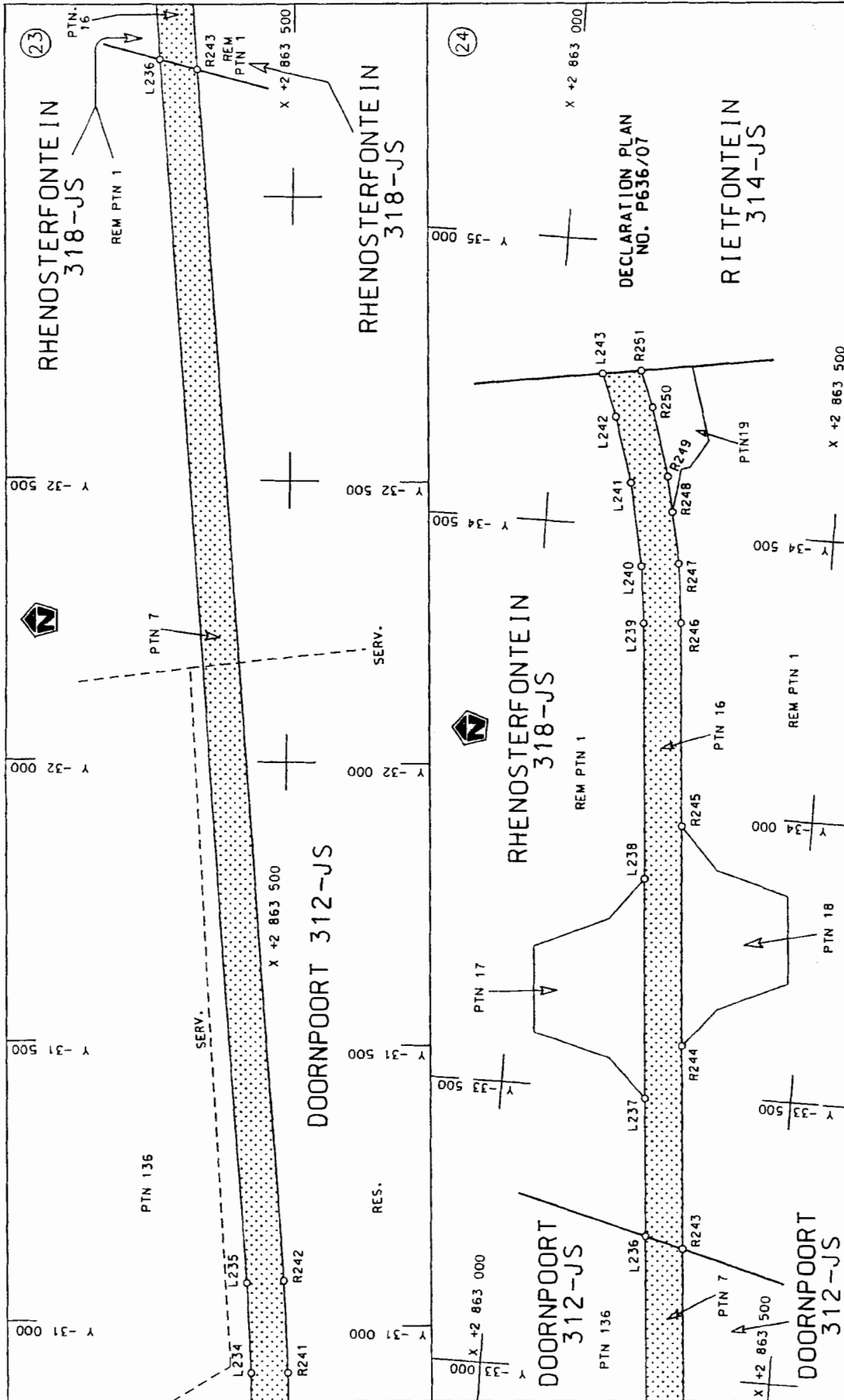

<p>Die Suid Afrikaanse Nasionale Padagentskap Beperk The South African National Roads Agency Limited</p>	<p>Die figuur getoon The figure shown</p> 	<p>steldie podreserwe voor van 'n gedeelte represents the road reserve of a portion van Nasionale Roete N4 Sektie of National Route N4 Section</p>	<p>Vel Sheet 13 of 18</p> <p>Plan P635/07</p>
--	---	--	---

D.O.9.A

PADRESERWE KOÖRDINATE				/ ROAD RESERVE CO-ORDINATES			
LINKERKANT/LEFT HAND SIDE				REGTERKANT/RIGHT HAND SIDE			
	Y	X	WG 29°		Y	X	
L1	5 920.25	2 863 222.61		R1	5 935.05	2 863 291.06	
L2	5 875.37	2 863 238.96		R2	5 900.03	2 863 304.48	
L3	5 818.97	2 863 258.46		R3	5 840.10	2 863 325.14	
L4	5 762.17	2 863 274.96		R4	5 718.84	2 863 357.05	
L5	5 704.47	2 863 288.66		R5	5 657.11	2 863 368.56	
L6	5 646.37	2 863 299.46		R6	5 594.72	2 863 375.26	
L7	5 587.87	2 863 308.86		R7	5 532.52	2 863 378.78	
L8	5 531.62	2 863 315.14		R8	5 469.84	2 863 380.98	
L9	5 472.04	2 863 317.06		R9	5 407.20	2 863 379.82	
L10	5 414.55	2 863 316.31		R10	5 344.80	2 863 375.53	
L11	5 353.71	2 863 312.30		R11	5 282.87	2 863 368.12	
L12	5 291.80	2 863 305.25		R12	5 221.34	2 863 357.86	
L13	5 233.43	2 863 295.26		R13	5 160.27	2 863 344.34	
L14	5 175.31	2 863 282.60		R14	5 072.18	2 863 319.09	
L15	5 089.78	2 863 257.92		R15	4 792.39	2 863 230.66	
L16	4 873.35	2 863 187.44		R16	4 791.76	2 863 227.74	
L17	4 776.20	2 863 155.76		R17	4 546.03	2 863 147.61	
L18	4 530.47	2 863 075.63		R18	4 287.64	2 863 063.35	
L19	4 307.36	2 863 002.88		R19	4 170.23	2 863 030.10	
L20	4 194.36	2 862 956.17		R20	4 054.06	2 862 990.78	
L21	4 046.50	2 862 917.74		R21	4 026.70	2 862 978.16	
L22	4 030.08	2 862 912.40		R22	3 736.65	2 862 883.60	
L23	3 365.09	2 862 695.50		R23	3 274.06	2 862 739.73	
L24	3 173.84	2 862 618.79		R24	3 159.75	2 862 713.33	
L25	3 058.83	2 862 557.27		R25	3 006.43	2 862 704.97	
L26	2 896.55	2 862 442.25		R26	2 943.60	2 862 701.45	
L27	2 884.32	2 862 426.44		R27	2 933.43	2 862 711.24	
L28	2 882.39	2 862 417.38		R28	2 952.08	2 862 839.73	
L29	2 836.62	2 862 195.70		R29	2 914.81	2 862 846.14	
L30	2 803.84	2 862 197.37		R30	2 889.02	2 862 719.15	
L31	2 839.17	2 862 434.64		R31	2 876.88	2 862 702.73	
L32	2 829.69	2 862 443.81		R32	2 725.22	2 862 595.17	
L33	2 736.08	2 862 436.41		R33	2 677.81	2 862 570.32	
L34	2 559.18	2 862 422.46		R34	2 579.85	2 862 518.81	
L35	2 432.09	2 862 396.18		R35	2 418.17	2 862 464.02	
L36	2 385.77	2 862 388.48		R36	2 374.19	2 862 455.96	
L37	2 339.45	2 862 382.13		R37	2 330.01	2 862 449.07	
L38	2 292.95	2 862 377.70		R38	2 285.52	2 862 443.49	
L39	2 244.70	2 862 374.73		R39	2 240.88	2 862 439.28	
L40	2 199.40	2 862 372.91		R40	2 229.51	2 862 438.55	
L41	2 152.77	2 862 371.35		R41	2 196.17	2 862 436.40	
L42	2 124.71	2 862 371.11		R42	2 151.48	2 862 434.85	
L43	1 860.81	2 862 370.81		R43	2 124.65	2 862 434.57	
L44	1 551.43	2 862 370.45		R44	1 534.62	2 862 434.02	
L45	1 531.95	2 862 370.43		R45	1 514.02	2 862 434.00	
L46	889.38	2 862 369.82		R46	909.30	2 862 433.43	
L47	617.26	2 862 369.27		R47	874.82	2 862 433.38	
L48	368.79	2 862 362.84		R48	617.08	2 862 432.87	
L49	311.41	2 862 361.03		R49	312.27	2 862 440.23	
L50	7.07	2 862 368.49		R50	7.03	2 862 432.24	
L51	-1 134.02	2 862 367.66		R51	-1 021.33	2 862 431.23	

Vel	14	Van	18	P635/07
Sheet		of		

PADRESERWE KOÖRDINATE				/ ROAD RESERVE CO-ORDINATES			
LINKERKANT/LEFT HAND SIDE				REGTERKANT/RIGHT HAND SIDE			
	Y	X	WG 29°		Y	X	
L52	-2 576.32	2 862 365.64	R52	-5 008.43	2 862 426.63		
L53	-3 384.69	2 862 364.64	R53	-5 701.57	2 862 425.83		
L54	-6 041.20	2 862 361.77	R54	-6 048.08	2 862 425.52		
L55	-6 392.76	2 862 361.22	R55	-6 392.73	2 862 424.81		
L56	-6 482.86	2 862 361.16	R56	-6 571.01	2 862 427.02		
L57	-6 573.27	2 862 363.56	R57	-6 660.01	2 862 431.01		
L58	-6 663.43	2 862 367.50	R58	-6 998.03	2 862 455.64		
L59	-6 753.64	2 862 374.15	R59	-7 297.96	2 862 490.46		
L60	-7 002.75	2 862 392.22	R60	-7 417.36	2 862 527.58		
L61	-7 329.04	2 862 397.63	R61	-7 534.35	2 862 607.43		
L62	-7 458.17	2 862 368.70	R62	-7 597.79	2 862 667.43		
L63	-7 728.75	2 862 242.09	R63	-7 655.85	2 862 723.40		
L64	-7 787.97	2 862 214.25	R64	-7 663.40	2 862 752.18		
L65	-7 804.37	2 862 194.18	R65	-7 637.90	2 862 871.59		
L66	-7 838.76	2 862 076.93	R66	-7 673.35	2 862 880.46		
L67	-7 874.18	2 862 086.20	R67	-7 707.64	2 862 763.48		
L68	-7 848.71	2 862 205.36	R68	-7 723.99	2 862 743.46		
L69	-7 853.97	2 862 234.05	R69	-7 742.70	2 862 735.94		
L70	-7 904.49	2 862 281.23	R70	-7 808.68	2 862 702.79		
L71	-7 979.18	2 862 351.39	R71	-8 053.58	2 862 588.39		
L72	-8 095.28	2 862 432.69	R72	-8 182.78	2 862 559.59		
L73	-8 213.48	2 862 470.39	R73	-8 365.68	2 862 555.09		
L74	-8 370.28	2 862 491.49	R74	-8 803.28	2 862 587.20		
L75	-8 715.48	2 862 516.60	R75	-9 522.00	2 862 639.92		
L76	-8 736.19	2 862 518.10	R76	-9 625.00	2 862 648.42		
L77	-8 755.09	2 862 397.30	R77	-9 779.61	2 862 660.12		
L78	-8 764.19	2 862 397.90	R78	-9 923.41	2 862 668.92		
L79	-8 745.39	2 862 518.70	R79	-10 364.11	2 862 700.72		
L80	-9 526.70	2 862 575.52	R80	-11 010.22	2 862 747.35		
L81	-9 630.20	2 862 581.82	R81	-11 102.62	2 862 758.65		
L82	-9 784.21	2 862 593.32	R82	-11 861.71	2 862 817.28		
L83	-9 927.71	2 862 604.72	R83	-12 046.19	2 862 830.28		
L84	-10 150.41	2 862 620.36	R84	-12 166.71	2 862 838.78		
L85	-10 076.31	2 862 535.42	R85	-12 469.92	2 862 857.78		
L86	-10 083.21	2 862 529.42	R86	-12 835.11	2 862 899.59		
L87	-10 162.91	2 862 621.73	R87	-13 185.11	2 862 919.00		
L88	-10 390.51	2 862 638.22	R88	-13 299.11	2 862 935.70		
L89	-11 017.02	2 862 683.75	R89	-13 354.21	2 862 954.40		
L90	-11 107.22	2 862 685.75	R90	-13 334.81	2 863 002.10		
L91	-11 866.31	2 862 737.38	R91	-14 090.75	2 862 963.98		
L92	-12 171.21	2 862 759.58	R92	-14 089.58	2 862 971.46		
L93	-12 231.81	2 862 764.62	R93	-14 117.14	2 862 973.71		
L94	-12 475.61	2 862 784.89	R94	-14 213.63	2 862 981.59		
L95	-12 840.11	2 862 795.79	R95	-14 335.90	2 862 993.88		
L96	-12 864.25	2 862 797.91	R96	-14 398.00	2 863 000.12		
L97	-13 196.22	2 862 826.71	R97	-14 504.23	2 863 012.81		
L98	-13 315.92	2 862 821.41	R98	-14 605.51	2 863 024.91		
L99	-13 448.82	2 862 804.71	R99	-14 843.90	2 863 082.34		
L100	-13 270.32	2 862 586.11	R100	-15 120.66	2 863 165.48		
L101	-13 016.02	2 862 485.21	R101	-15 269.05	2 863 203.32		
L102	-12 971.82	2 862 458.21	R102	-15 325.28	2 863 225.27		

Van	15	Van	18	P635/07
Sheet		of		

PADRESERWE KOÖRDINATE				/	ROAD RESERVE CO-ORDINATES			
LINKERKANT/LEFT HAND SIDE					REGTERKANT/RIGHT HAND SIDE			
	Y	X	WG 29°		Y	X		
L103	-12 988.62	2 862 423.01		R103	-15 338.83	2 863 229.14		
L104	-13 060.32	2 862 469.31		R104	-15 908.44	2 863 401.53		
L105	-13 305.22	2 862 566.11		R105	-16 165.84	2 863 485.83		
L106	-13 329.82	2 862 580.71		R106	-16 273.94	2 863 535.53		
L107	-13 338.12	2 862 564.71		R107	-16 362.84	2 863 586.23		
L108	-13 360.42	2 862 560.71		R108	-16 397.45	2 863 605.97		
L109	-13 637.32	2 862 789.02		R109	-16 434.57	2 863 646.00		
L110	-13 693.72	2 862 846.32		R110	-16 432.75	2 863 702.99		
L111	-13 843.30	2 862 884.22		R111	-16 421.04	2 863 779.04		
L112	-14 098.91	2 862 905.61		R112	-16 456.14	2 863 788.23		
L113	-14 315.03	2 862 921.97		R113	-16 468.44	2 863 709.09		
L114	-14 496.15	2 862 936.64		R114	-16 482.70	2 863 654.17		
L115	-14 620.19	2 862 946.69		R115	-16 504.62	2 863 642.99		
L116	-14 924.82	2 863 037.41		R116	-16 524.74	2 863 632.73		
L117	-15 023.27	2 863 066.83		R117	-16 549.44	2 863 627.24		
L118	-15 257.44	2 863 134.18		R118	-16 611.14	2 863 613.24		
L119	-15 332.31	2 863 155.67		R119	-16 800.74	2 863 619.24		
L120	-15 399.89	2 863 175.13		R120	-17 070.55	2 863 660.23		
L121	-15 928.17	2 863 337.23		R121	-17 252.15	2 863 684.33		
L122	-16 219.77	2 863 421.84		R122	-17 555.85	2 863 728.74		
L123	-16 383.74	2 863 435.90		R123	-17 773.35	2 863 757.94		
L124	-16 441.07	2 863 428.46		R124	-18 095.96	2 863 801.52		
L125	-16 475.45	2 863 395.97		R125	-18 304.34	2 863 827.34		
L126	-16 484.07	2 863 365.19		R126	-18 425.80	2 863 842.40		
L127	-16 501.22	2 863 250.22		R127	-18 472.30	2 863 848.16		
L128	-16 537.91	2 863 256.73		R128	-18 762.79	2 863 882.34		
L129	-16 520.62	2 863 370.89		R129	-19 026.73	2 863 922.22		
L130	-16 535.89	2 863 444.59		R130	-19 149.17	2 863 948.15		
L131	-16 608.24	2 863 479.04		R131	-19 189.65	2 863 956.37		
L132	-16 671.04	2 863 508.44		R132	-19 209.27	2 863 960.37		
L133	-16 749.24	2 863 533.24		R133	-19 375.13	2 863 990.75		
L134	-16 784.04	2 863 544.04		R134	-19 406.00	2 863 997.72		
L135	-17 731.97	2 863 675.53		R135	-19 627.82	2 864 047.73		
L136	-17 738.65	2 863 688.74		R136	-19 688.36	2 864 062.10		
L137	-18 105.14	2 863 738.42		R137	-19 806.11	2 864 090.16		
L138	-18 177.46	2 863 747.20		R138	-20 021.60	2 864 124.19		
L139	-18 412.29	2 863 775.72		R139	-20 159.79	2 864 129.33		
L140	-19 233.89	2 863 895.06		R140	-20 198.55	2 864 129.74		
L141	-19 282.72	2 863 902.15		R141	-20 413.52	2 864 132.18		
L142	-19 642.33	2 863 981.25		R142	-20 516.79	2 864 147.71		
L143	-19 820.12	2 864 020.86		R143	-20 589.77	2 864 154.33		
L144	-20 028.15	2 864 054.71		R144	-20 575.98	2 864 246.31		
L145	-20 157.65	2 864 060.66		R145	-20 689.47	2 864 296.73		
L146	-20 257.05	2 864 058.17		R146	-20 726.87	2 864 308.21		
L147	-20 296.71	2 864 057.26		R147	-20 762.69	2 864 214.32		
L148	-20 444.88	2 864 049.26		R148	-20 792.88	2 864 189.84		
L149	-20 541.69	2 864 036.55		R149	-20 947.92	2 864 140.75		
L150	-20 605.08	2 864 028.33		R150	-21 009.13	2 864 134.61		
L151	-20 661.19	2 864 009.34		R151	-21 063.70	2 864 130.59		
L152	-20 756.44	2 863 978.63		R152	-21 146.23	2 864 124.44		
L153	-20 817.58	2 863 890.66		R153	-21 158.28	2 864 124.13		

Vel	16	Van	18	P635/07
Sheet		of		

PADRESERWE KOÖRDINATE				/	ROAD RESERVE CO-ORDINATES			
LINKERKANT/LEFT HAND SIDE					REGTERKANT/RIGHT HAND SIDE			
	Y	X	WG 29°		Y	X		
L154	-20 836.37	2 863 831.11		R154	-21 226.12	2 864 122.20		
L155	-20 849.87	2 863 788.33		R155	-21 332.46	2 864 128.82		
L156	-20 879.86	2 863 798.42		R156	-21 483.55	2 864 144.33		
L157	-20 872.05	2 863 831.96		R157	-21 572.61	2 864 151.99		
L158	-20 864.80	2 863 863.13		R158	-21 660.69	2 864 162.36		
L159	-20 844.93	2 863 945.64		R159	-21 706.10	2 864 169.37		
L160	-20 860.21	2 863 979.74		R160	-21 725.11	2 864 174.61		
L161	-20 993.79	2 864 032.61		R161	-21 796.68	2 864 194.35		
L162	-21 091.95	2 864 049.55		R162	-21 866.31	2 864 215.25		
L163	-21 159.86	2 864 061.53		R163	-21 885.50	2 864 221.89		
L164	-21 724.76	2 864 112.82		R164	-22 210.29	2 864 334.24		
L165	-21 812.01	2 864 129.43		R165	-22 210.75	2 864 332.13		
L166	-21 896.92	2 864 154.92		R166	-22 312.67	2 864 366.68		
L167	-21 915.03	2 864 161.28		R167	-22 346.18	2 864 378.05		
L168	-21 973.05	2 864 181.36		R168	-22 435.67	2 864 408.39		
L169	-22 083.47	2 864 231.32		R169	-22 456.21	2 864 407.73		
L170	-22 443.45	2 864 356.52		R170	-22 790.66	2 864 522.58		
L171	-22 451.91	2 864 354.34		R171	-22 919.25	2 864 568.96		
L172	-22 463.27	2 864 351.41		R172	-22 943.83	2 864 586.52		
L173	-22 807.23	2 864 471.63		R173	-22 956.45	2 864 595.53		
L174	-22 918.89	2 864 505.05		R174	-23 119.41	2 864 700.06		
L175	-23 063.91	2 864 534.36		R175	-23 148.73	2 864 754.13		
L176	-23 196.98	2 864 527.53		R176	-23 122.74	2 864 859.15		
L177	-23 241.03	2 864 515.68		R177	-23 156.33	2 864 869.47		
L178	-23 302.64	2 864 379.10		R178	-23 193.54	2 864 789.22		
L179	-23 349.03	2 864 360.04		R179	-23 247.80	2 864 765.47		
L180	-23 304.47	2 864 512.55		R180	-23 356.64	2 864 768.31		
L181	-23 303.63	2 864 519.93		R181	-23 475.35	2 864 785.69		
L182	-23 332.05	2 864 574.46		R182	-23 590.81	2 864 815.04		
L183	-23 429.75	2 864 659.22		R183	-23 694.46	2 864 851.14		
L184	-23 539.61	2 864 723.84		R184	-23 793.87	2 864 881.51		
L185	-23 720.05	2 864 786.69		R185	-24 428.77	2 865 102.87		
L186	-24 454.37	2 865 044.50		R186	-24 685.79	2 865 192.39		
L187	-24 893.54	2 865 197.40		R187	-25 163.84	2 865 358.42		
L188	-25 066.19	2 865 245.98		R188	-25 265.83	2 865 394.50		
L189	-25 209.35	2 865 265.59		R189	-25 260.84	2 865 408.90		
L190	-25 244.76	2 865 270.34		R190	-25 416.48	2 865 463.06		
L191	-25 424.82	2 865 270.84		R191	-25 279.12	2 865 721.88		
L192	-25 603.34	2 865 247.36		R192	-25 195.90	2 865 861.41		
L193	-25 748.11	2 865 209.96		R193	-25 115.12	2 865 965.20		
L194	-25 877.60	2 865 168.68		R194	-25 104.57	2 865 977.65		
L195	-26 034.41	2 865 110.33		R195	-25 170.32	2 865 998.54		
L196	-26 169.98	2 865 045.12		R196	-25 387.99	2 865 743.72		
L197	-26 287.25	2 864 977.21		R197	-25 477.29	2 865 646.51		
L198	-26 392.33	2 864 909.78		R198	-25 606.60	2 865 528.51		
L199	-26 685.50	2 864 721.65		R199	-25 623.73	2 865 534.48		
L200	-26 735.95	2 864 689.29		R200	-25 694.64	2 865 479.16		
L201	-26 908.71	2 864 562.15		R201	-25 841.08	2 865 372.51		
L202	-26 940.33	2 864 531.98		R202	-25 832.10	2 865 360.18		
L203	-26 965.37	2 864 495.97		R203	-25 958.02	2 865 268.51		
L204	-26 991.66	2 864 444.52		R204	-26 044.88	2 865 209.07		

Vel	17	Van	18	P635/07
Sheet		of		

PADRESERWE KOÖRDINATE				ROAD RESERVE CO-ORDINATES			
LINKERKANT/LEFT HAND SIDE				REGTERKANT/RIGHT HAND SIDE			
	Y	X	WG 29°		Y	X	
L205	-27 037.46	2 864	360.11	R205	-26 310.82	2 865	037.76
L206	-27 055.73	2 864	326.43	R206	-26 321.60	2 865	030.74
L207	-27 133.46	2 864	271.52	R207	-26 693.40	2 864	792.29
L208	-27 173.87	2 864	265.73	R208	-26 766.51	2 864	748.19
L209	-27 351.26	2 864	256.83	R209	-27 036.71	2 864	585.16
L210	-27 397.94	2 864	246.76	R210	-27 079.05	2 864	565.12
L211	-27 439.95	2 864	226.85	R211	-27 123.06	2 864	556.00
L212	-27 665.32	2 864	089.18	R212	-27 300.83	2 864	545.99
L213	-28 183.91	2 863	760.75	R213	-27 338.03	2 864	543.98
L214	-28 227.09	2 863	731.85	R214	-27 416.84	2 864	484.77
L215	-28 248.28	2 863	698.50	R215	-27 435.30	2 864	451.11
L216	-28 359.78	2 863	623.60	R216	-27 481.41	2 864	366.87
L217	-28 610.77	2 863	476.50	R217	-27 511.57	2 864	311.76
L218	-28 689.67	2 863	439.30	R218	-27 534.11	2 864	279.54
L219	-28 724.47	2 863	423.40	R219	-27 565.77	2 864	250.05
L220	-28 807.07	2 863	392.81	R220	-27 748.41	2 864	116.48
L221	-28 799.19	2 863	412.50	R221	-28 144.38	2 863	862.04
L222	-28 847.27	2 863	394.51	R222	-28 124.58	2 863	893.20
L223	-28 966.97	2 863	360.61	R223	-28 226.77	2 863	827.60
L224	-29 089.07	2 863	336.41	R224	-28 422.27	2 863	709.60
L225	-29 158.07	2 863	328.31	R225	-28 534.78	2 863	629.90
L226	-29 212.67	2 863	321.91	R226	-28 654.38	2 863	561.01
L227	-29 336.97	2 863	317.51	R227	-28 759.38	2 863	512.01
L228	-29 495.17	2 863	325.91	R228	-28 871.87	2 863	469.91
L229	-30 309.97	2 863	411.92	R229	-28 985.57	2 863	437.81
L230	-30 371.57	2 863	413.32	R230	-29 101.37	2 863	414.81
L231	-30 425.37	2 863	414.52	R231	-29 165.97	2 863	407.31
L232	-30 642.77	2 863	429.13	R232	-29 164.40	2 863	391.61
L233	-30 762.17	2 863	449.53	R233	-29 217.57	2 863	385.41
L234	-30 912.77	2 863	449.33	R234	-29 336.77	2 863	381.11
L235	-31 071.47	2 863	440.83	R235	-29 488.47	2 863	389.41
L236	-33 243.07	2 863	267.33	R236	-30 303.27	2 863	475.22
L237	-33 487.82	2 863	247.94	R237	-30 305.37	2 863	475.52
L238	-33 878.92	2 863	216.93	R238	-30 367.67	2 863	487.82
L239	-34 330.34	2 863	181.15	R239	-30 507.37	2 863	507.22
L240	-34 431.44	2 863	169.35	R240	-30 760.67	2 863	512.93
L241	-34 577.74	2 863	140.35	R241	-30 914.47	2 863	512.93
L242	-34 692.14	2 863	106.56	R242	-31 076.57	2 863	504.33
L243	-34 765.54	2 863	078.36	R243	-33 225.57	2 863	332.63
				R244	-33 587.81	2 863	303.89
				R245	-33 976.82	2 863	273.02
				R246	-34 335.44	2 863	244.55
				R247	-34 440.94	2 863	232.85
				R248	-34 530.96	2 863	214.72
				R249	-34 593.50	2 863	202.09
				R250	-34 712.72	2 863	166.92
				R251	-34 775.81	2 863	142.64

Vel	18	Van	18	P635/07
Sheet		of		