

---

**GOVERNMENT NOTICE**  
**GOEWERMENTSKENNISGEWING**

---

**DEPARTMENT OF TRANSPORT**  
**DEPARTEMENT VAN VERVOER**

No. 145

8 February 2008

**THE SOUTH AFRICAN NATIONAL ROADS**  
**AGENCY LIMITED**

Registration No: 98/09584/06

**DECLARATION AMENDMENT OF NATIONAL ROAD N4 SECTION 4**

AMENDMENT OF DECLARATION NO'S. 190 OF 1985, 296 OF 1972, 358 OF 1977, 160 OF 1986 AND  
186 OF 1987.

By virtue of section 40 (1)(b) of the South African National Roads Agency Limited and the National Roads Act, 1998 (Act No. 7 of 1998), I hereby amend the following declarations by substituting **(I)** Declaration No. 190 of 1985, the section from the common boundary between farms Rhenosterfontein 318 – JS and Rietfontein 314 – JS on sheet 7 up to sheet 8 of Plan No. P341/84 and the applicable co-ordinates, **(II)** Declaration No. 296 of 1972, **(III)** Declaration No. 358 of 1977, **(IV)** Declaration No. 160 of 1986 and **(V)** Declaration No. 186 of 1987, the section from sheet 1 up to the common boundary between farms Kleinfontein 432 – JS and Leeuwfontein 431 – JS on sheet 2 of Plan No. P358/86 and the applicable co-ordinates, with the subjoined sheets 1 to 15 of Plan no.P636/07.

**(National Road N4 Section 4: Rhenosterfontein – Leeuwfontein)**

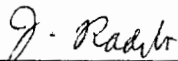

**MINISTER OF TRANSPORT**

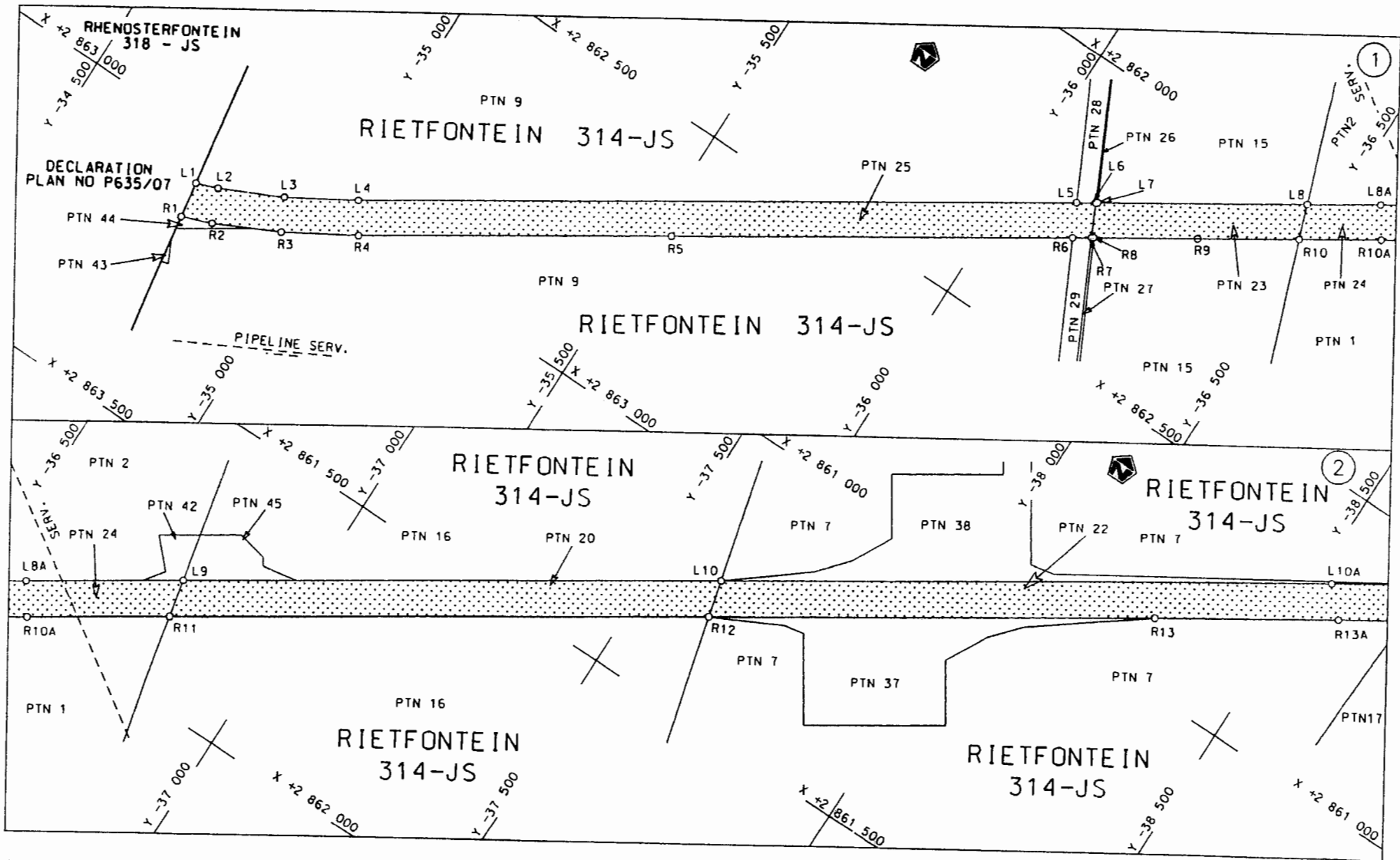

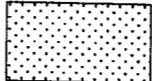
Die Suid Afrikaanse Nasionale Padogentskop Beperk The South African National Roads Agency Limited	Die figuur getoon The figure shown		steldie padreserwe voor van 'n gedeelte represents the road reserve of a portion van Nasionale Roete N4 of National Route N4	Vel Sheet 1 van of 15
			4 Seksie Section	Plan P636/07

D.O.9.A

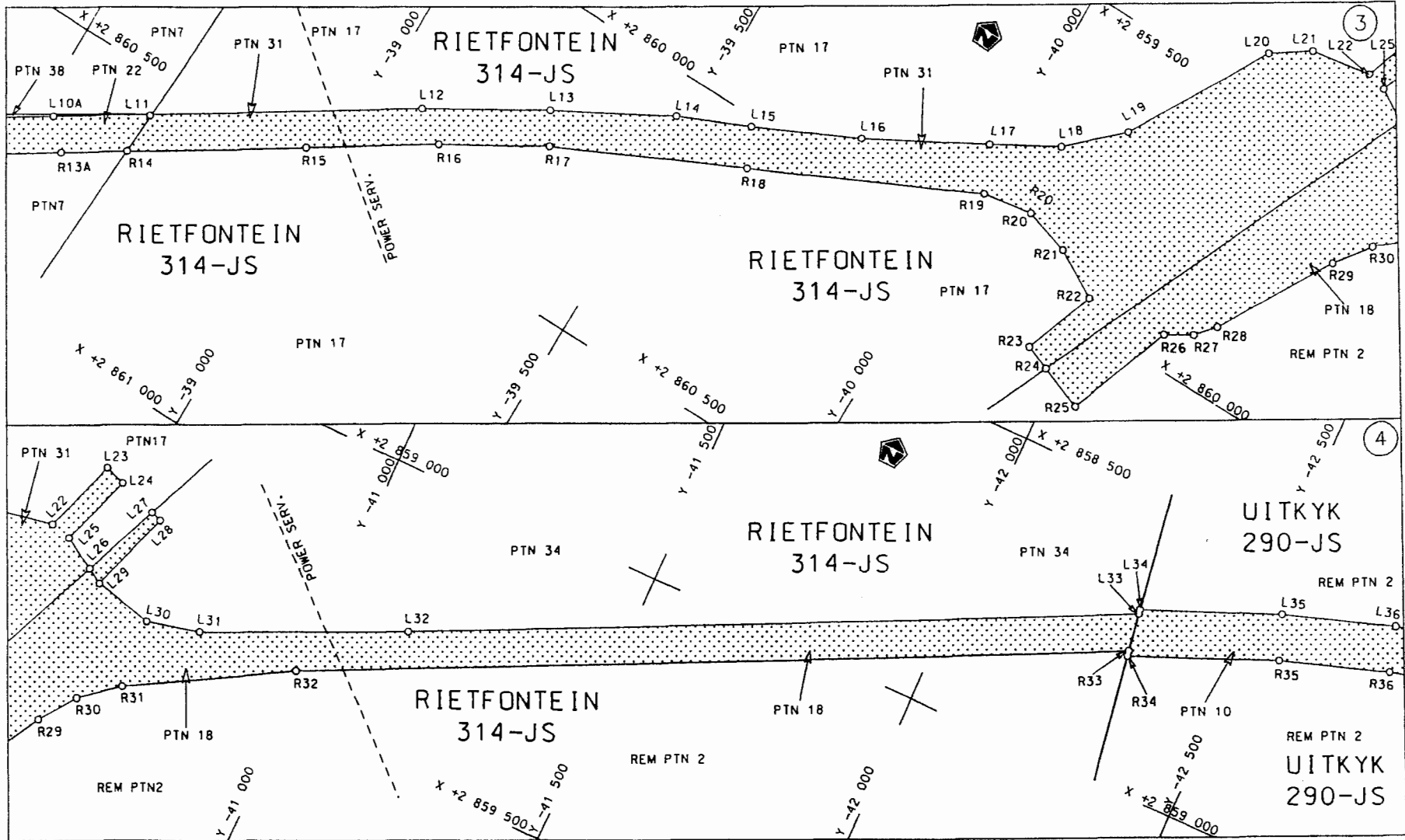

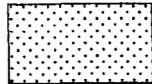
<p>Die Suid Afrikaanse Nasionale Padagentskap Beperk The South African National Roads Agency Limited</p>	<p>Die figuur getoon The figure shown</p> 	<p>steldie padreserwe voor van 'n gedeelte represents the rood reserve of a portion van Nasionale Roete N4 Seksie of National Route N4 Section 4</p>	<p>Vel Sheet 2 von of 15 Plan P636/07</p>
--	---	--	---

D.O.9.A

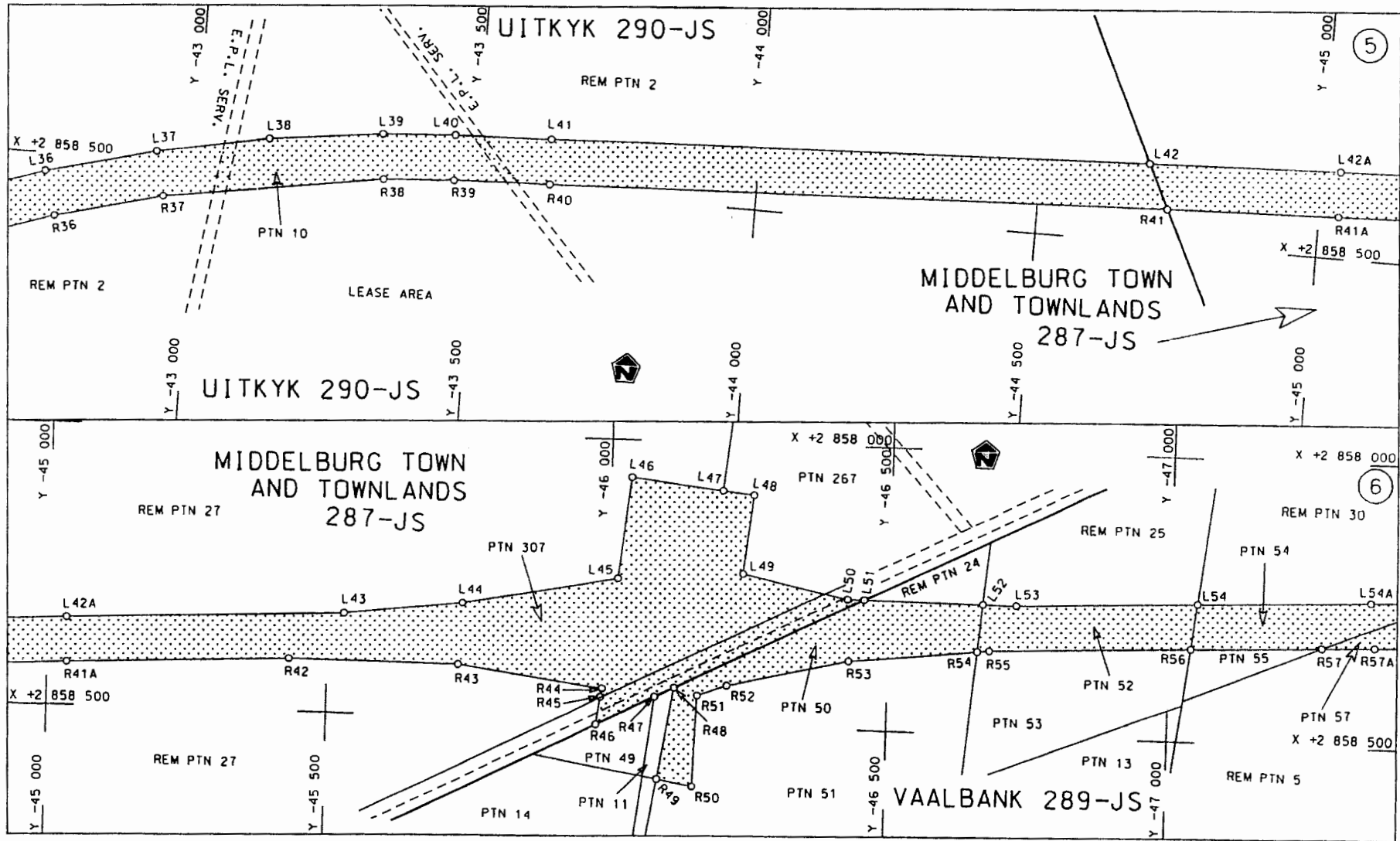

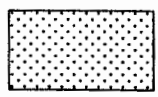
Die Suid Afrikaanse Nasionale Padagentskop Beperk The South African National Roads Agency Limited	Die figuur getoon The figure shown		steldie padreserwe voor van 'n gedeelte represents the road reserve of a portion van Nasionale Roete N4 Seksie 4 of National Route N4 Section 4	Vel Sheet 3 van of 15
				Plan P636/07

D.O.9.A

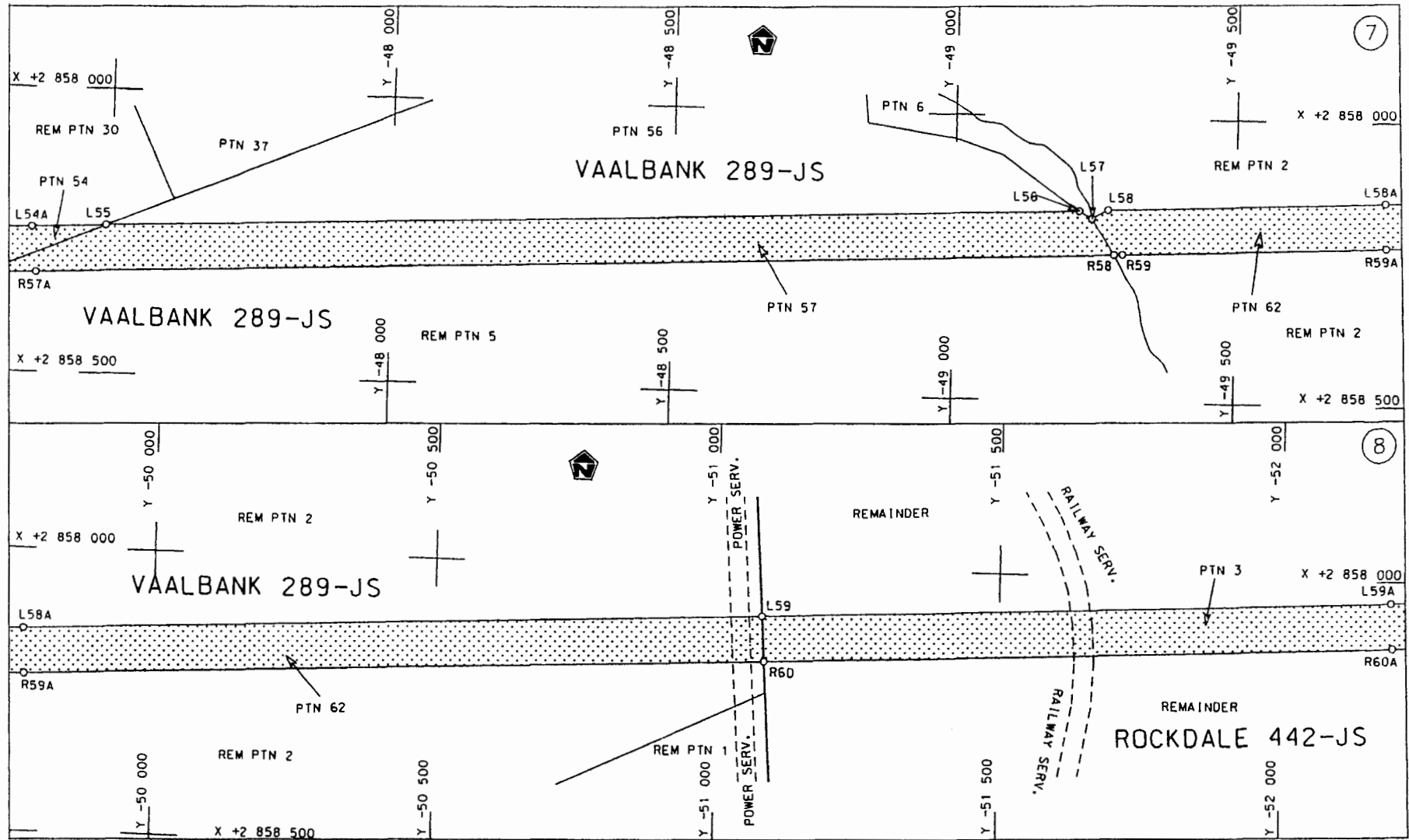

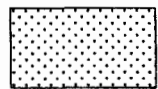
<p>Die Suid Afrikaanse Nasionale Padagentskap Beperk The South African National Roads Agency Limited</p>	<p>Die figuur getoon The figure shown</p>		<p>steldie padreserwe voor van 'n gedeelte represents the road reserve of a portion van Nasionale Roete N4 Sektie 4 of National Route N4 Section 4</p>	<p>Vel Sheet 4 van of 15 Plan P636/07</p>
--	---	---	--	---

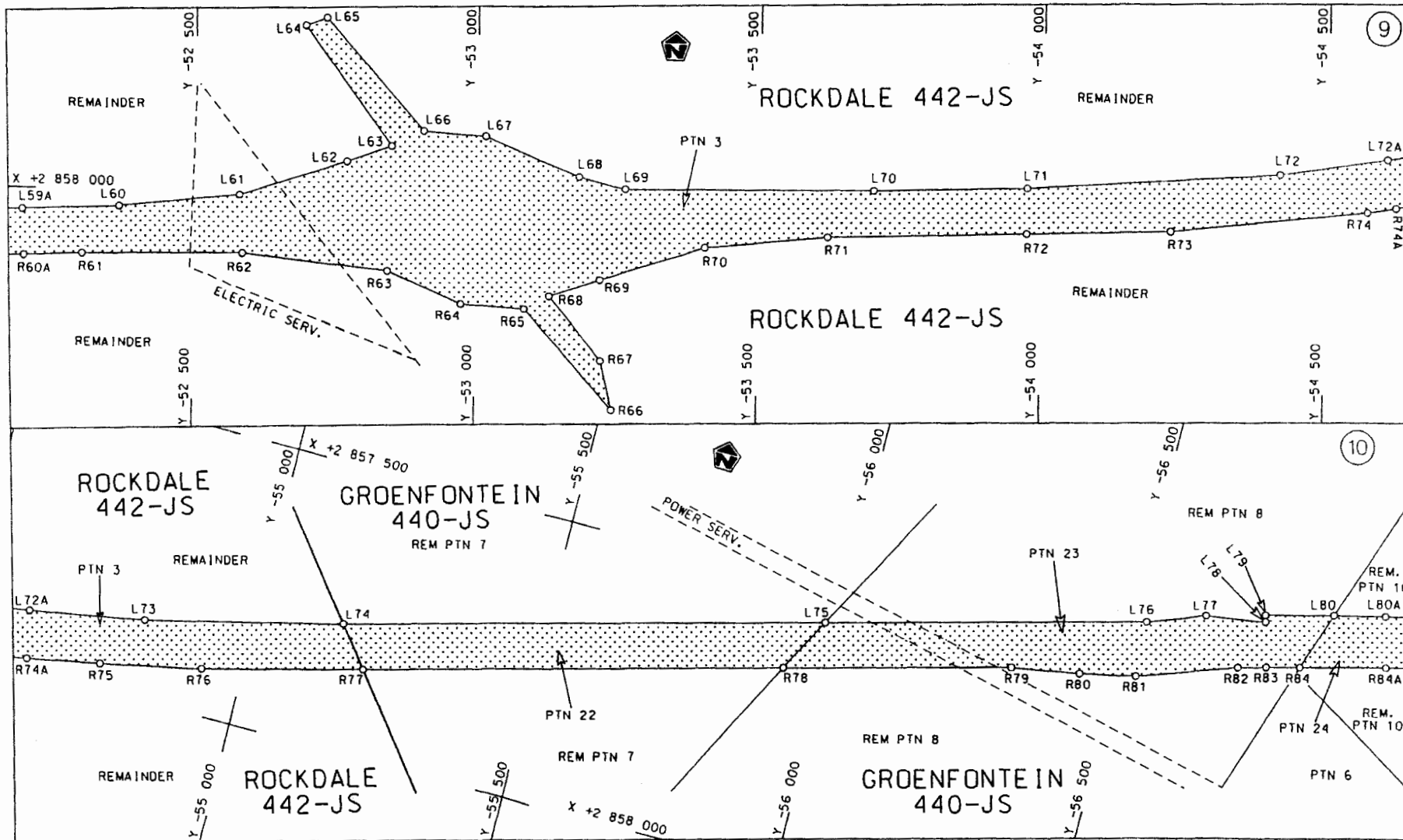

Die Suid Afrikaanse Nasionale Padagentskap Beperk  
The South African National Roads Agency Limited

Die figuur getoon  
The figure shown



steldie padreserwe voor van 'n gedeelte  
represents the road reserve of a portion  
van Nasionale Roete N4 Seksie 4  
of National Route N4 Section 4

Vel Sheet 5 van 15  
Plan P636/07

D.O.9.A

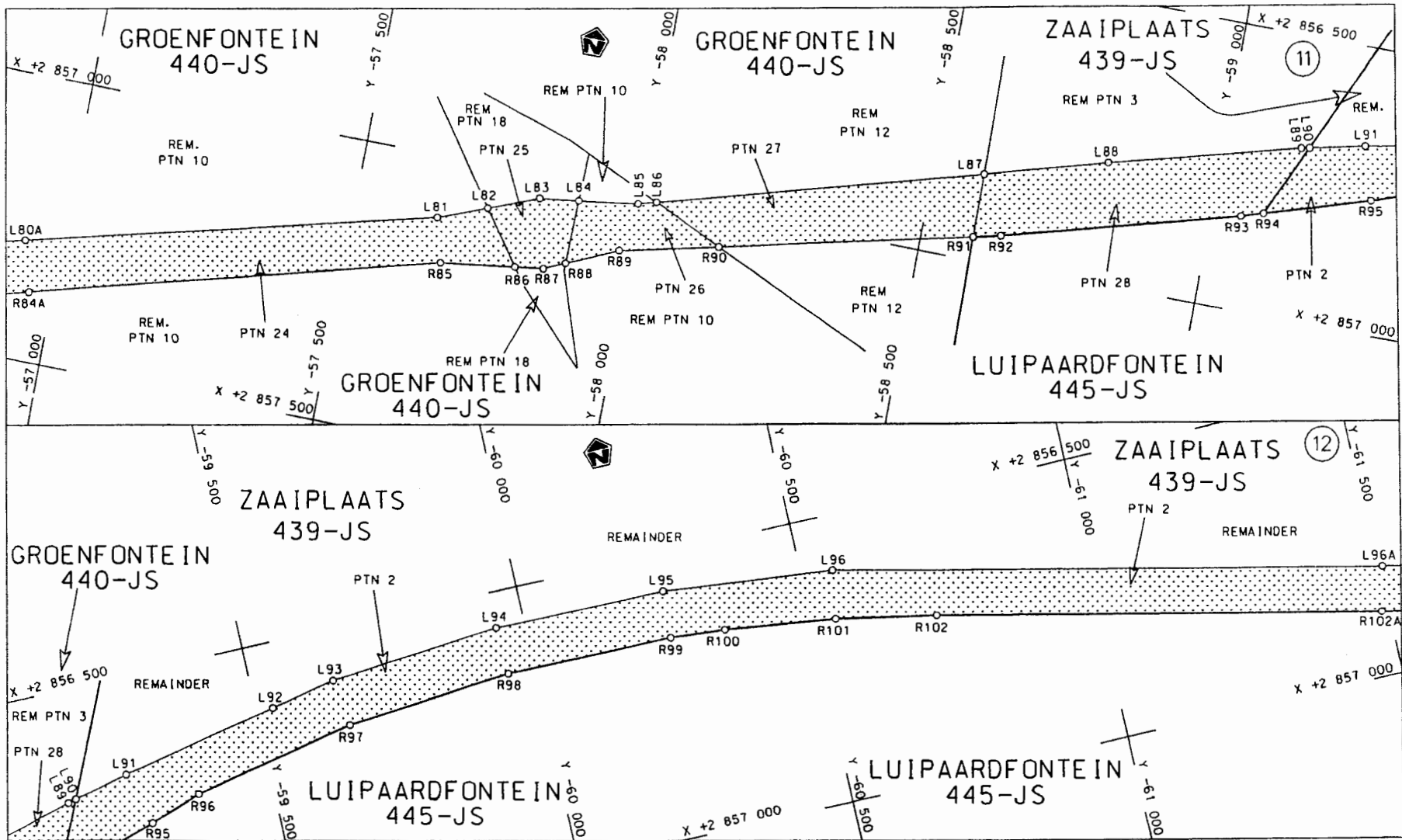

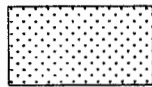
<p>Die Suid Afrikaanse Nasionale Padagentskap Beperk The South African National Roads Agency Limited</p>	<p>Die figuur getoon The figure shown</p> 	<p>steldie padreserwe voor van 'n gedeelte represents the road reserve of a portion van Nasionale Roete N4 Seksie of National Route N4 Section 4</p>	<p>Vel Sheet 6 von of 15 Plan P636/07</p>
--	---	--	---

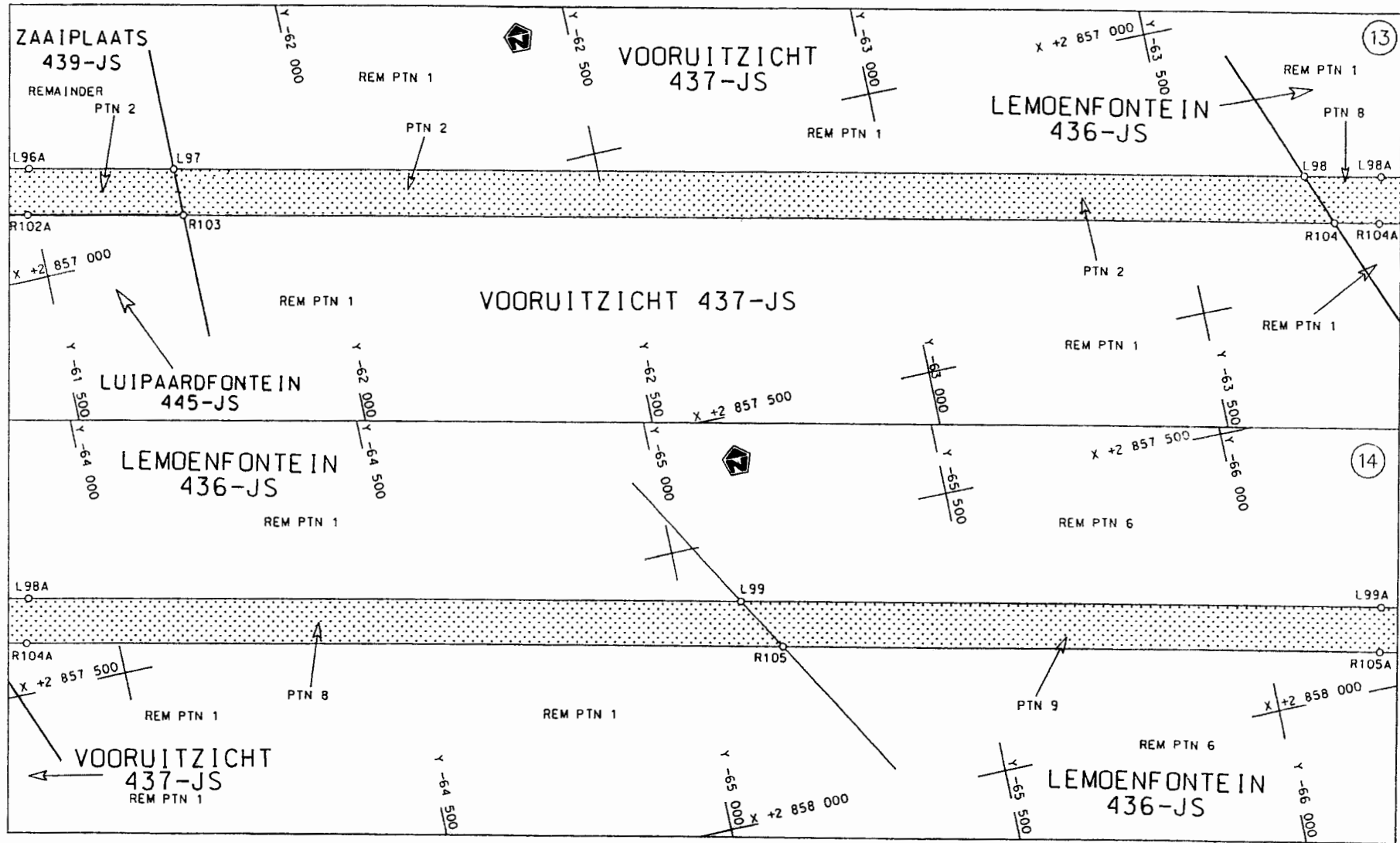

Die Suid Afrikaanse Nasionale Padagentskap Beperk The South African National Roads Agency Limited	Die figuur getoon The figure shown		steldie padreserwe voor van 'n gedeelte represents the road reserve of a portion van Nasionale Roete N4 Sektie 4 of National Route N4 Section 4	Vel Sheet 7 van of 15 Plan P636/07
--	---------------------------------------	---	--	---------------------------------------

D.O.9.A



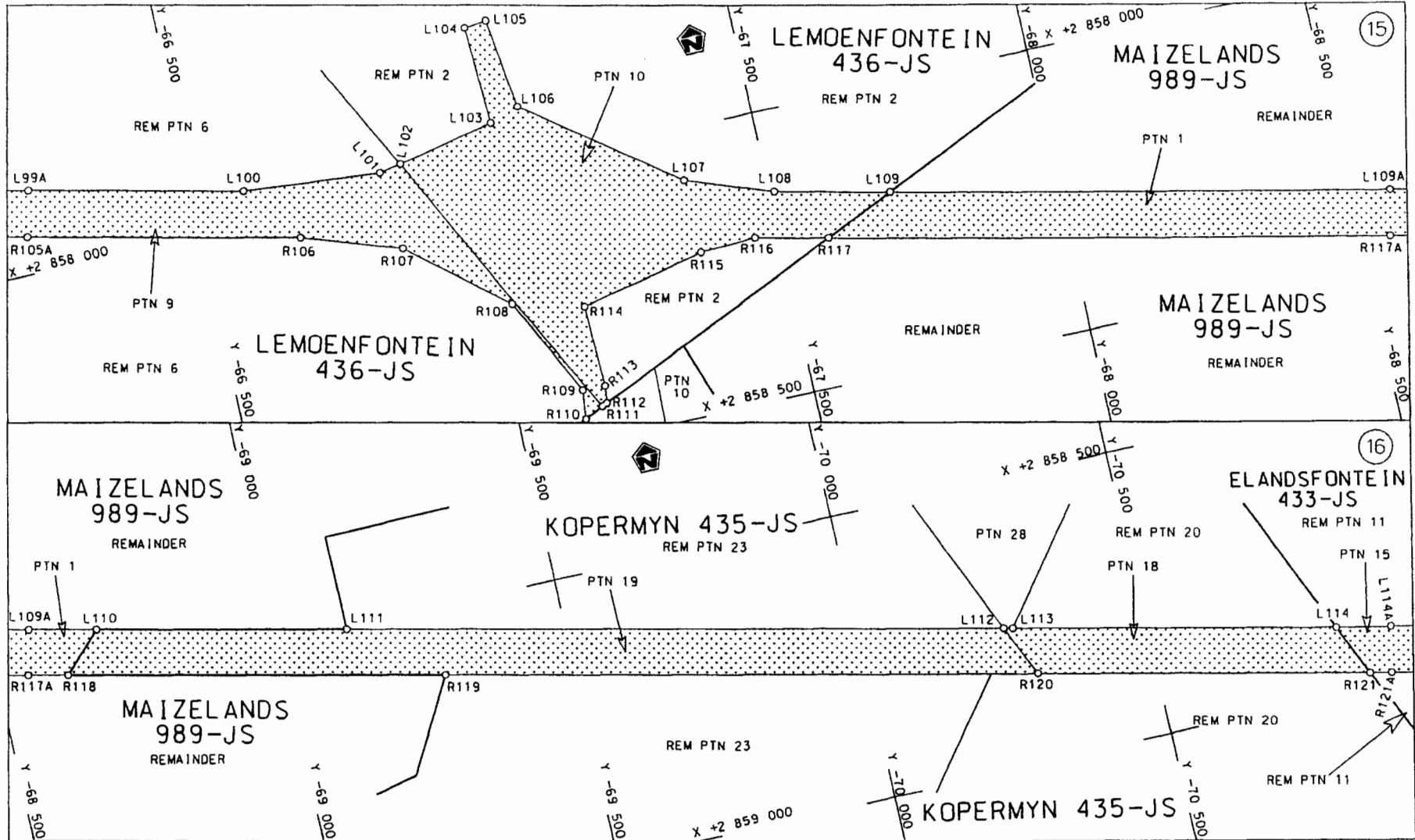

<p>Die Suid Afrikaanse Nasionale Padagentskap Beperk The South African National Roads Agency Limited</p>	<p>Die figuur getoon The figure shown</p> 	<p>steldie padreserwe voor van 'n gedeelte represents the road reserve of a portion van Nasionale Roete N4 Seksie Section of National Route 4</p>	<p>Vel Sheet 8 van 15 Plan P636/07</p>
--	---	---	--

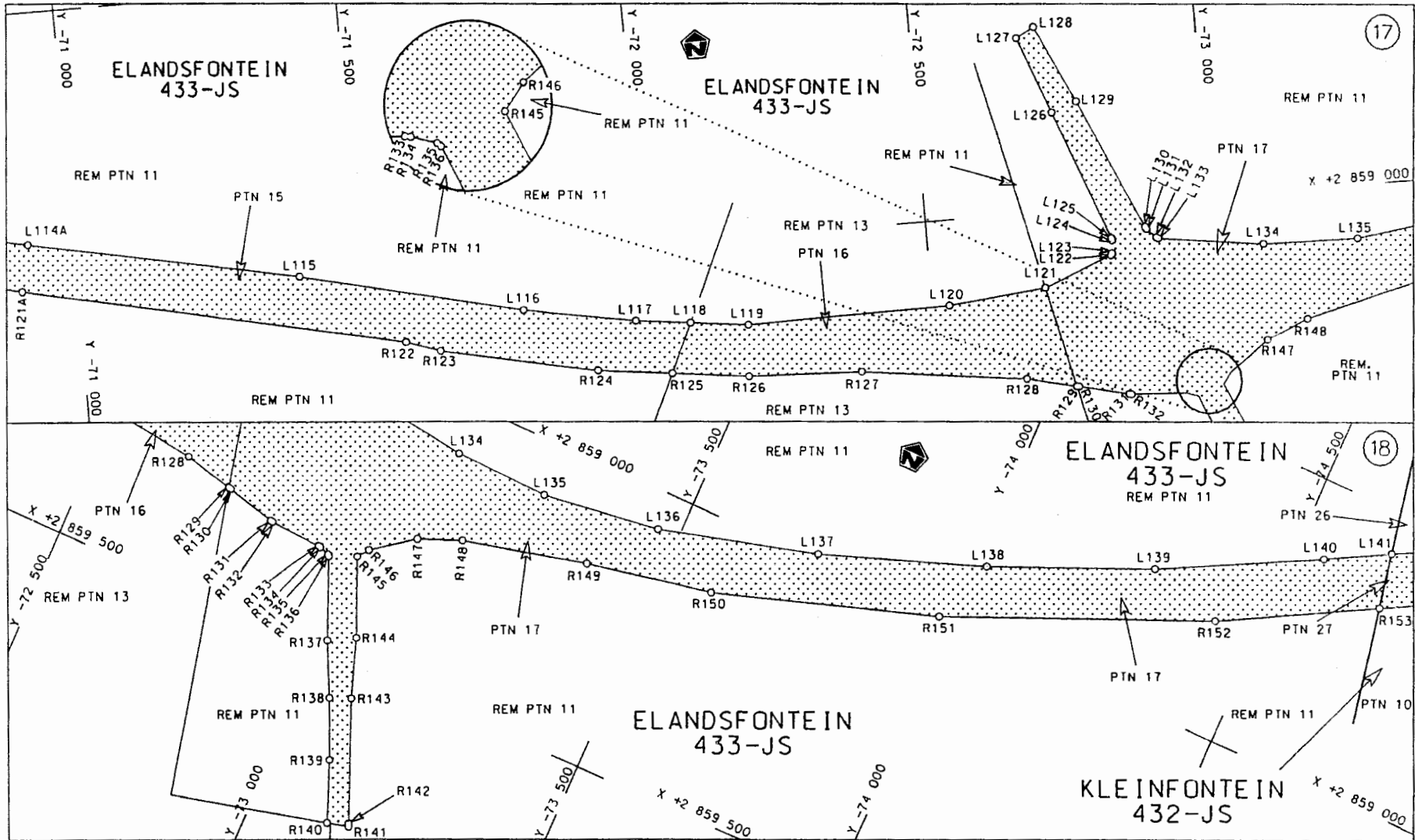

<p>Die Suid Afrikaanse Nasionale Padagentskap Beperk The South African National Roads Agency Limited</p>	<p>Die figuur getoon The figure shown</p>	<p>steldie padreserwe voor van 'n gedeelte represents the road reserve of a portion von Nasionale Roete N4 Seksie Section of National Route 4</p>	<p>Vel Sheet 9 van of 15 Plan P636/07</p>
--	---	---	---

D.O.9.A

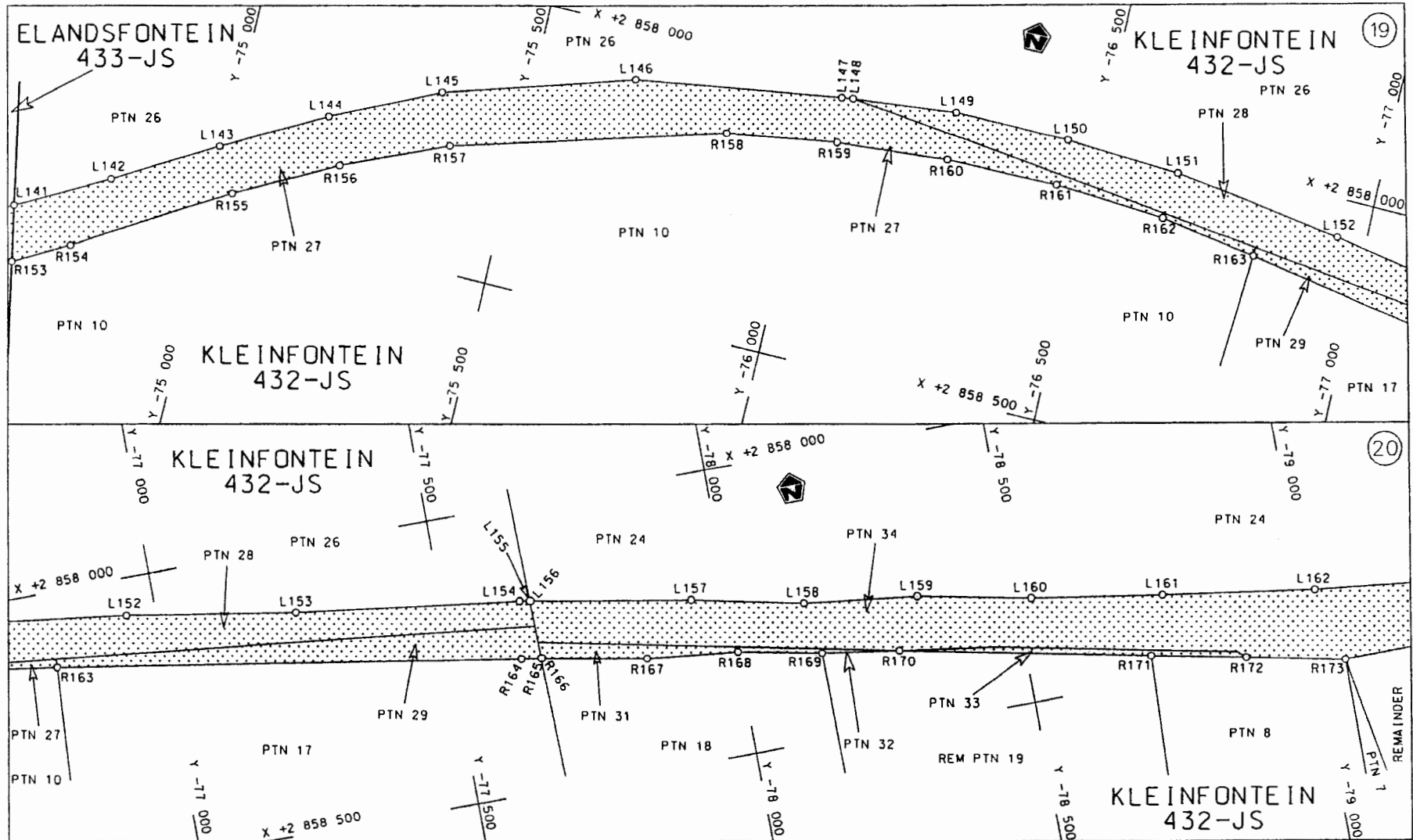

<p>Die Suid Afrikaanse Nasionale Padagentskap Beperk The South African National Roads Agency Limited</p>	<p>Die figuur getoon The figure shown</p>		<p>steldie padreserwe voor van 'n gedeelte represents the road reserve of a portion van Nasionale Roete N4 Seksie of National Route N4 Section 4</p>	<p>Vel Sheet 10 van 15 of 15</p>
				<p>Plan P636/07</p>

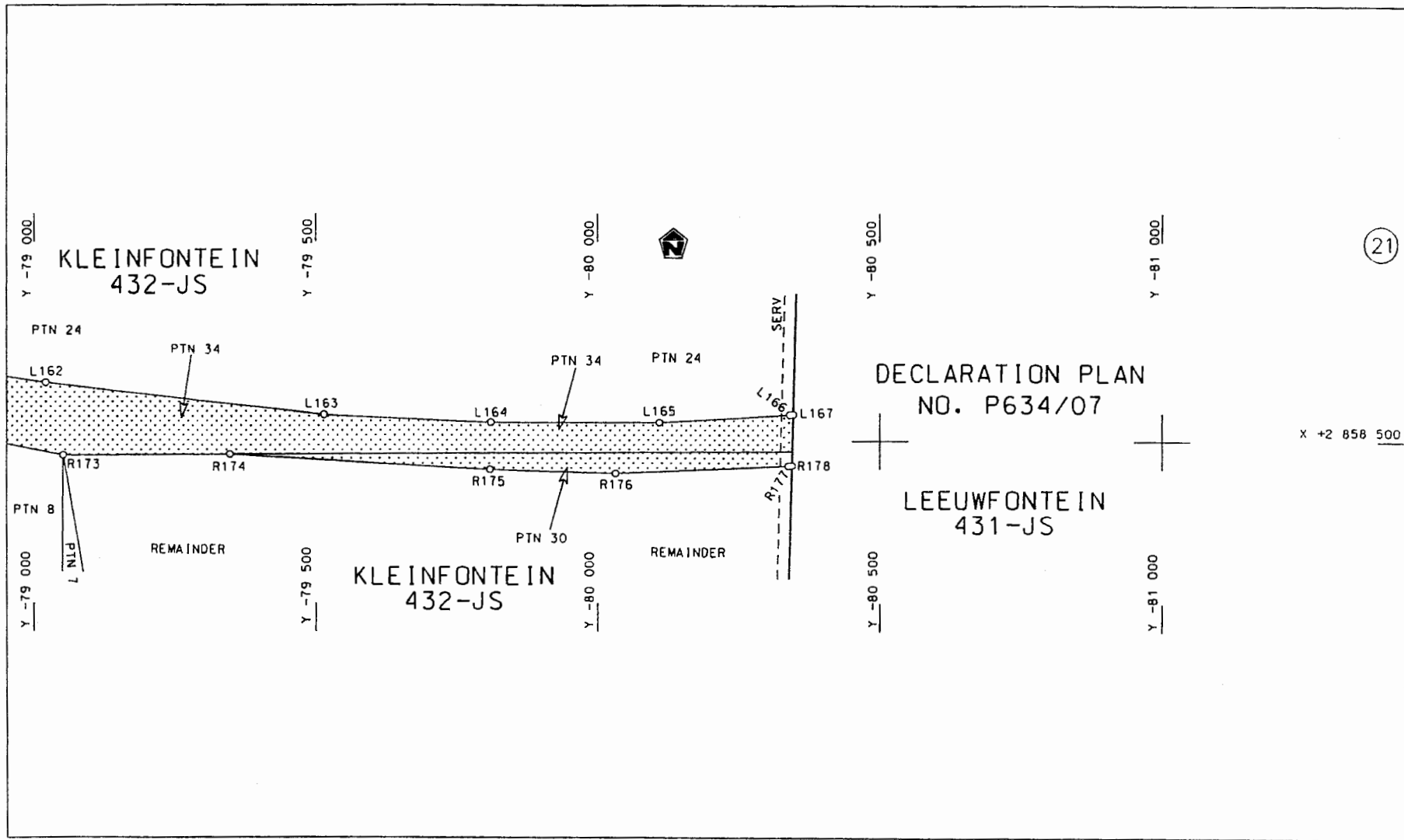

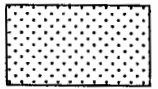
Die Suid Afrikaanse Nasionale Padagentskop Beperk	Die figuur getoon		steldie padreserwe voor van 'n gedeelte represents the road reserve of a portion van Nasionale Roete N4	Vel Sheet 11 van 15
The South African National Roads Agency Limited	The figure shown		Seksie of National Route N4      Seksie Section 4	Plan P636/07

D.O.9.A

PADRESERWE KOÖRDINATE				/	ROAD RESERVE CO-ORDINATES			
LINKERKANT/LEFT HAND SIDE					REGTERKANT/RIGHT HAND SIDE			
	Y	X	WG 29°		Y	X		
L1	-34 765.54	2 863	078.36	R1	-34 775.81	2 863	142.64	
L2	-34 803.61	2 863	063.88	R2	-34 829.01	2 863	122.22	
L3	-34 911.20	2 863	012.31	R3	-34 940.95	2 863	068.41	
L4	-35 026.97	2 862	943.97	R4	-35 061.65	2 862	997.31	
L5	-36 106.26	2 862	240.33	R5	-35 533.15	2 862	689.90	
L6	-36 135.12	2 862	221.53	R6	-36 135.00	2 862	297.60	
L7	-36 137.86	2 862	219.46	R7	-36 163.61	2 862	278.95	
L8	-36 451.32	2 862	015.21	R8	-36 166.75	2 862	276.63	
L9	-36 801.00	2 861	787.29	R9	-36 322.17	2 862	175.36	
L10	-37 611.47	2 861	258.51	R10	-36 473.90	2 862	076.48	
L11	-38 676.43	2 860	563.70	R11	-36 815.33	2 861	853.84	
L12	-39 080.34	2 860	300.45	R12	-37 627.95	2 861	323.65	
L13	-39 275.80	2 860	180.96	R13	-38 297.79	2 860	886.63	
L14	-39 472.53	2 860	071.44	R14	-38 672.83	2 860	641.95	
L15	-39 595.96	2 860	016.04	R15	-38 941.01	2 860	467.68	
L16	-39 773.97	2 859	930.85	R16	-39 139.05	2 860	338.02	
L17	-39 973.67	2 859	820.11	R17	-39 308.19	2 860	236.38	
L18	-40 085.09	2 859	756.06	R18	-39 628.64	2 860	082.88	
L19	-40 172.48	2 859	671.91	R19	-40 012.60	2 859	900.48	
L20	-40 313.21	2 859	423.04	R20	-40 101.18	2 859	886.47	
L21	-40 378.63	2 859	378.20	R21	-40 184.05	2 859	911.63	
L22	-40 485.95	2 859	359.39	R22	-40 267.91	2 859	959.33	
L23	-40 533.17	2 859	228.78	R23	-40 220.65	2 860	087.26	
L24	-40 569.22	2 859	241.05	R24	-40 265.49	2 860	103.54	
L25	-40 522.49	2 859	369.48	R25	-40 344.70	2 860	132.31	
L26	-40 577.90	2 859	403.52	R26	-40 413.19	2 859	944.31	
L27	-40 638.71	2 859	266.76	R27	-40 458.04	2 859	917.18	
L28	-40 657.79	2 859	273.70	R28	-40 487.02	2 859	883.46	
L29	-40 604.59	2 859	419.73	R29	-40 604.22	2 859	680.98	
L30	-40 709.52	2 859	445.49	R30	-40 650.88	2 859	618.61	
L31	-40 803.01	2 859	421.80	R31	-40 716.23	2 859	566.57	
L32	-41 140.17	2 859	267.05	R32	-40 987.31	2 859	412.02	
L33	-42 308.37	2 858	700.08	R33	-42 318.64	2 858	765.81	
L34	-42 307.14	2 858	692.16	R34	-42 319.98	2 858	774.44	
L35	-42 539.11	2 858	596.07	R35	-42 566.82	2 858	670.85	
L36	-42 731.43	2 858	532.32	R36	-42 754.19	2 858	609.05	
L37	-42 927.56	2 858	481.96	R37	-42 945.25	2 858	559.86	
L38	-43 126.91	2 858	444.64	R38	-43 335.09	2 858	500.15	
L39	-43 328.04	2 858	420.59	R39	-43 460.13	2 858	492.11	
L40	-43 456.58	2 858	412.26	R40	-43 632.97	2 858	484.68	
L41	-43 629.53	2 858	404.75	R41	-44 729.58	2 858	437.59	
L42	-44 692.40	2 858	359.11	R42	-45 431.92	2 858	407.32	
L43	-45 528.45	2 858	323.09	R43	-45 732.39	2 858	408.40	
L44	-45 737.65	2 858	298.57	R44	-45 992.30	2 858	442.31	
L45	-46 015.35	2 858	246.25	R45	-45 990.02	2 858	457.55	
L46	-46 035.44	2 858	067.36	R46	-45 982.87	2 858	505.34	
L47	-46 198.72	2 858	085.69	R47	-46 085.66	2 858	454.31	
L48	-46 254.09	2 858	091.93	R48	-46 119.83	2 858	437.35	
L49	-46 238.42	2 858	231.05	R49	-46 093.18	2 858	597.59	
L50	-46 426.63	2 858	270.41	R50	-46 156.05	2 858	608.10	
L51	-46 455.91	2 858	270.52	R51	-46 161.53	2 858	449.87	

Vel	12	Van	15	P636/07
Sheet		of		

PADRESERWE KOÖRDINATE				/ ROAD RESERVE CO-ORDINATES			
LINKERKANT/LEFT HAND SIDE				REGTERKANT/RIGHT HAND SIDE			
	Y	X	WG 29°		Y	X	
L52	-46 666.69	2 858 271.44		R52	-46 214.15	2 858 430.49	
L53	-46 727.11	2 858 271.71		R53	-46 431.46	2 858 380.40	
L54	-47 047.87	2 858 257.95		R54	-46 658.72	2 858 356.15	
L55	-47 491.04	2 858 238.94		R55	-46 680.43	2 858 353.83	
L56	-49 222.77	2 858 164.65		R56	-47 037.95	2 858 338.49	
L57	-49 245.57	2 858 177.84		R57	-47 273.48	2 858 328.38	
L58	-49 273.44	2 858 162.49		R58	-49 285.93	2 858 241.98	
L59	-51 080.55	2 858 085.29		R59	-49 301.02	2 858 241.36	
L60	-52 365.12	2 858 029.79		R60	-51 085.60	2 858 164.82	
L61	-52 580.60	2 858 005.77		R61	-52 301.27	2 858 112.69	
L62	-52 769.51	2 857 944.64		R62	-52 586.91	2 858 107.40	
L63	-52 847.69	2 857 916.40		R63	-52 843.29	2 858 133.98	
L64	-52 693.37	2 857 710.78		R64	-52 974.46	2 858 189.77	
L65	-52 730.42	2 857 696.70		R65	-53 088.20	2 858 196.55	
L66	-52 904.51	2 857 889.28		R66	-53 243.60	2 858 368.88	
L67	-53 014.89	2 857 895.56		R67	-53 223.11	2 858 283.57	
L68	-53 180.88	2 857 961.10		R68	-53 131.79	2 858 172.37	
L69	-53 262.09	2 857 981.26		R69	-53 220.02	2 858 141.08	
L70	-53 701.73	2 857 972.50		R70	-53 404.66	2 858 080.04	
L71	-53 972.66	2 857 960.84		R71	-53 622.50	2 858 055.90	
L72	-54 416.55	2 857 925.98		R72	-53 973.08	2 858 040.87	
L73	-54 807.69	2 857 860.91		R73	-54 226.08	2 858 029.88	
L74	-55 151.92	2 857 778.34		R74	-54 573.26	2 857 987.42	
L75	-55 978.14	2 857 556.82		R75	-54 750.31	2 857 955.07	
L76	-56 527.05	2 857 409.62		R76	-54 927.90	2 857 918.39	
L77	-56 625.06	2 857 371.33		R77	-55 205.62	2 857 847.55	
L78	-56 729.87	2 857 355.18		R78	-55 925.97	2 857 653.59	
L79	-56 726.76	2 857 343.50		R79	-56 315.60	2 857 549.44	
L80	-56 844.43	2 857 311.89		R80	-56 434.95	2 857 528.94	
L81	-57 647.55	2 857 108.93		R81	-56 532.59	2 857 507.46	
L82	-57 732.63	2 857 074.81		R82	-56 702.35	2 857 445.36	
L83	-57 820.21	2 857 039.70		R83	-56 750.63	2 857 432.43	
L84	-57 889.80	2 857 030.15		R84	-56 808.86	2 857 416.81	
L85	-57 995.14	2 857 015.70		R85	-57 668.27	2 857 186.25	
L86	-58 026.90	2 857 006.61		R86	-57 799.91	2 857 167.89	
L87	-58 589.51	2 856 845.60		R87	-57 849.95	2 857 160.92	
L88	-58 802.99	2 856 784.51		R88	-57 887.56	2 857 143.91	
L89	-59 136.99	2 856 695.45		R89	-57 977.30	2 857 103.33	
L90	-59 151.46	2 856 692.28		R90	-58 150.82	2 857 062.51	
L91	-59 248.70	2 856 670.98		R91	-58 591.41	2 856 958.86	
L92	-59 530.12	2 856 614.50		R92	-58 639.33	2 856 947.35	
L93	-59 645.97	2 856 591.45		R93	-59 052.99	2 856 833.15	
L94	-59 949.17	2 856 563.69		R94	-59 091.85	2 856 821.03	
L95	-60 253.44	2 856 566.21		R95	-59 276.35	2 856 763.51	
L96	-60 556.11	2 856 597.51		R96	-59 367.44	2 856 731.95	
L97	-61 761.58	2 856 865.69		R97	-59 657.60	2 856 674.57	
L98	-63 726.02	2 857 302.69		R98	-59 952.30	2 856 647.40	
L99	-65 103.15	2 857 609.05		R99	-60 248.20	2 856 649.84	
L100	-66 591.01	2 857 940.04		R100	-60 346.13	2 856 657.21	
L101	-66 832.56	2 857 961.35		R101	-60 542.36	2 856 682.12	
L102	-66 871.19	2 857 954.42		R102	-60 718.35	2 856 715.56	

Vel	13	Van	15	P636/07
Sheet		of		

PADRESERWE KOÖRDINATE				/	ROAD RESERVE CO-ORDINATES			
LINKERKANT/LEFT HAND SIDE					REGTERKANT/RIGHT HAND SIDE			
	Y	X	WG	29°	Y	X		
L103	-67 045.22	2 857 917.68		R103	-61 761.29	2 856 947.65		
L104	-67 034.94	2 857 744.63		R104	-63 761.74	2 857 392.63		
L105	-67 074.72	2 857 740.51		R105	-65 159.05	2 857 703.46		
L106	-67 097.52	2 857 898.97		R106	-66 671.48	2 858 039.88		
L107	-67 356.76	2 858 090.61		R107	-66 844.00	2 858 098.13		
L108	-67 508.90	2 858 144.22		R108	-67 012.77	2 858 233.71		
L109	-67 708.17	2 858 188.52		R109	-67 101.04	2 858 407.65		
L110	-68 689.07	2 858 406.62		R110	-67 095.49	2 858 457.95		
L111	-69 121.66	2 858 502.85		R111	-67 128.95	2 858 443.23		
L112	-70 254.43	2 858 754.82		R112	-67 138.04	2 858 439.25		
L113	-70 269.99	2 858 758.30		R113	-67 141.11	2 858 409.13		
L114	-70 825.31	2 858 883.51		R114	-67 136.16	2 858 265.58		
L115	-71 393.56	2 859 000.11		R115	-67 358.62	2 858 218.71		
L116	-71 781.98	2 859 091.62		R116	-67 457.26	2 858 214.68		
L117	-71 976.70	2 859 127.28		R117	-67 584.26	2 858 243.01		
L118	-72 071.75	2 859 138.89		R118	-68 623.12	2 858 473.90		
L119	-72 173.37	2 859 151.30		R119	-69 274.51	2 858 618.79		
L120	-72 529.15	2 859 147.68		R120	-70 295.20	2 858 845.84		
L121	-72 701.02	2 859 131.05		R121	-70 866.04	2 858 974.42		
L122	-72 821.64	2 859 085.08		R122	-71 569.68	2 859 129.55		
L123	-72 823.68	2 859 082.30		R123	-71 628.61	2 859 150.67		
L124	-72 825.27	2 859 059.67		R124	-71 903.59	2 859 208.11		
L125	-72 824.73	2 859 055.82		R125	-72 032.13	2 859 224.26		
L126	-72 738.28	2 858 829.96		R126	-72 166.76	2 859 241.17		
L127	-72 686.75	2 858 695.14		R127	-72 366.62	2 859 250.42		
L128	-72 718.59	2 858 677.62		R128	-72 654.56	2 859 287.24		
L129	-72 782.44	2 858 813.50		R129	-72 741.58	2 859 307.69		
L130	-72 884.80	2 859 041.60		R130	-72 745.89	2 859 308.70		
L131	-72 886.99	2 859 044.87		R131	-72 832.47	2 859 329.85		
L132	-72 902.79	2 859 060.89		R132	-72 836.49	2 859 330.41		
L133	-72 906.17	2 859 062.84		R133	-72 927.69	2 859 335.50		
L134	-73 087.64	2 859 087.58		R134	-72 931.69	2 859 336.19		
L135	-73 255.25	2 859 091.65		R135	-72 948.99	2 859 341.73		
L136	-73 461.35	2 859 064.19		R136	-72 951.65	2 859 344.33		
L137	-73 737.74	2 858 986.80		R137	-73 007.64	2 859 477.99		
L138	-74 016.31	2 858 884.61		R138	-73 051.65	2 859 568.00		
L139	-74 288.37	2 858 766.40		R139	-73 096.44	2 859 668.56		
L140	-74 551.77	2 858 627.85		R140	-73 137.13	2 859 771.63		
L141	-74 657.34	2 858 569.76		R141	-73 174.40	2 859 762.48		
L142	-74 814.64	2 858 484.07		R142	-73 174.15	2 859 761.90		
L143	-74 987.34	2 858 382.19		R143	-73 086.98	2 859 553.22		
L144	-75 164.84	2 858 285.48		R144	-73 052.31	2 859 453.37		
L145	-75 348.26	2 858 196.08		R145	-72 997.22	2 859 324.62		
L146	-75 677.75	2 858 090.77		R146	-73 011.48	2 859 305.84		
L147	-76 040.16	2 858 034.63		R147	-73 080.91	2 859 253.97		
L148	-76 060.02	2 858 031.60		R148	-73 154.42	2 859 223.79		
L149	-76 242.31	2 858 012.86		R149	-73 371.96	2 859 169.39		
L150	-76 445.37	2 858 013.70		R150	-73 589.97	2 859 125.04		
L151	-76 648.12	2 858 023.52		R151	-73 974.02	2 858 997.39		
L152	-76 947.98	2 858 064.35		R152	-74 419.60	2 858 804.40		
L153	-77 244.03	2 858 112.98		R153	-74 675.93	2 858 663.79		

Vel	14	Van	15	P636/07
Sheet		of		

PADRESERWE KOÖRDINATE				/ ROAD RESERVE CO-ORDINATES			
LINKERKANT/LEFT HAND SIDE				REGTERKANT/RIGHT HAND SIDE			
	Y	X	WG 29°		Y	X	
L154	-77 636.90	2 858	163.83	R154	-74 771.35	2 858	611.17
L155	-77 654.22	2 858	166.63	R155	-75 028.80	2 858	456.86
L156	-77 656.14	2 858	166.94	R156	-75 203.63	2 858	364.65
L157	-77 936.48	2 858	216.19	R157	-75 383.90	2 858	285.27
L158	-78 132.05	2 858	257.68	R158	-75 855.84	2 858	145.65
L159	-78 330.85	2 858	281.74	R159	-76 050.44	2 858	114.02
L160	-78 527.16	2 858	321.28	R160	-76 246.53	2 858	096.85
L161	-78 756.62	2 858	358.15	R161	-76 443.53	2 858	094.01
L162	-79 020.70	2 858	398.13	R162	-76 640.38	2 858	105.16
L163	-79 514.24	2 858	453.75	R163	-76 809.96	2 858	130.69
L164	-79 812.02	2 858	467.61	R164	-77 621.76	2 858	262.96
L165	-80 110.23	2 858	467.71	R165	-77 656.29	2 858	267.70
L166	-80 341.63	2 858	453.58	R166	-77 658.17	2 858	267.96
L167	-80 347.73	2 858	453.13	R167	-77 841.55	2 858	302.14
				R168	-78 000.74	2 858	319.38
				R169	-78 147.56	2 858	348.46
				R170	-78 282.57	2 858	368.28
				R171	-78 717.71	2 858	457.61
				R172	-78 880.18	2 858	490.73
				R173	-79 051.85	2 858	525.97
				R174	-79 349.36	2 858	524.46
				R175	-79 810.19	2 858	551.10
				R176	-80 031.68	2 858	557.87
				R177	-80 339.16	2 858	544.36
				R178	-80 345.43	2 858	543.78

Vel	15	Van	15	P636/07
Sheet		of		