

---

GOVERNMENT NOTICE  
GOEWERMENTSKENNISGEWING

---

DEPARTMENT OF TRANSPORT  
DEPARTEMENT VAN VERVOER

No. 142

8 February 2008

THE SOUTH AFRICAN NATIONAL ROADS  
AGENCY LIMITED

Registration No: 98/09584/06

DECLARATION AMENDMENT OF NATIONAL ROAD P720

AMENDMENT OF DECLARATION NO. 1353 OF 2003

By virtue of Section 40(1)(b) of the South African National Roads Agency Limited and National Roads Act, 1998 (Act No. 7 of 1998), I hereby amend Declaration No. 1353 of 2003, by substituting it with the subjoined sheets 1 to 5 of Plan No. P632/07.

**[National Road P720: N2 – Golela {Swaziland Border} (10km)]**



**MINISTER OF TRANSPORT**

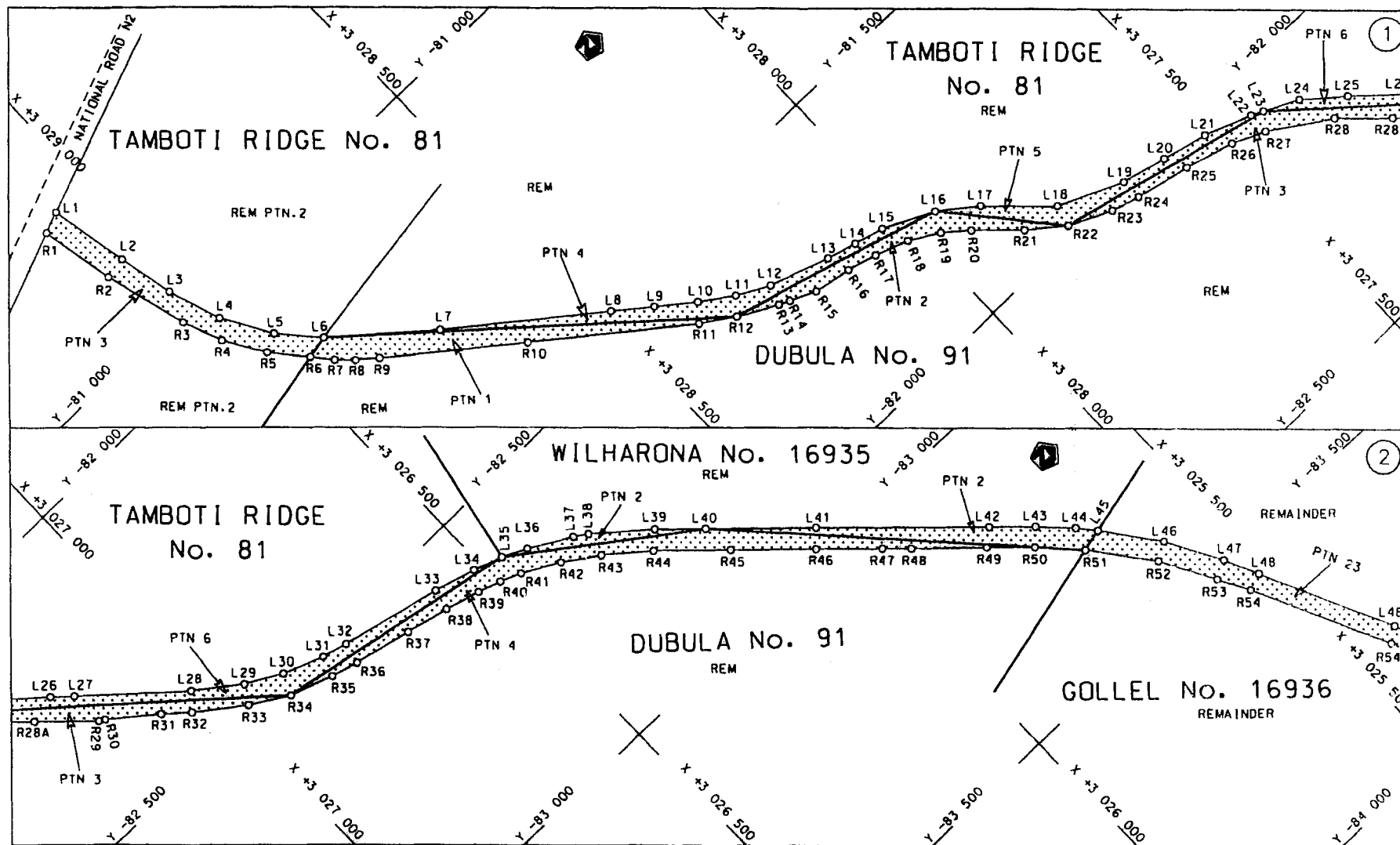

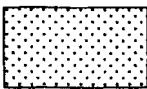
Die Suid Afrikaanse Nasionale Padagentskap Beperk	Die figuur getoon	 steldie podreserwe voor van 'n gedeelte represents the road reserve of a portion van Nasionale Roete P720      Seksie of National Route                      Section	Vel Sheet 1 von of 5
The South African National Roads Agency Limited	The figure shown		Plan P632/07

D.O.9.A

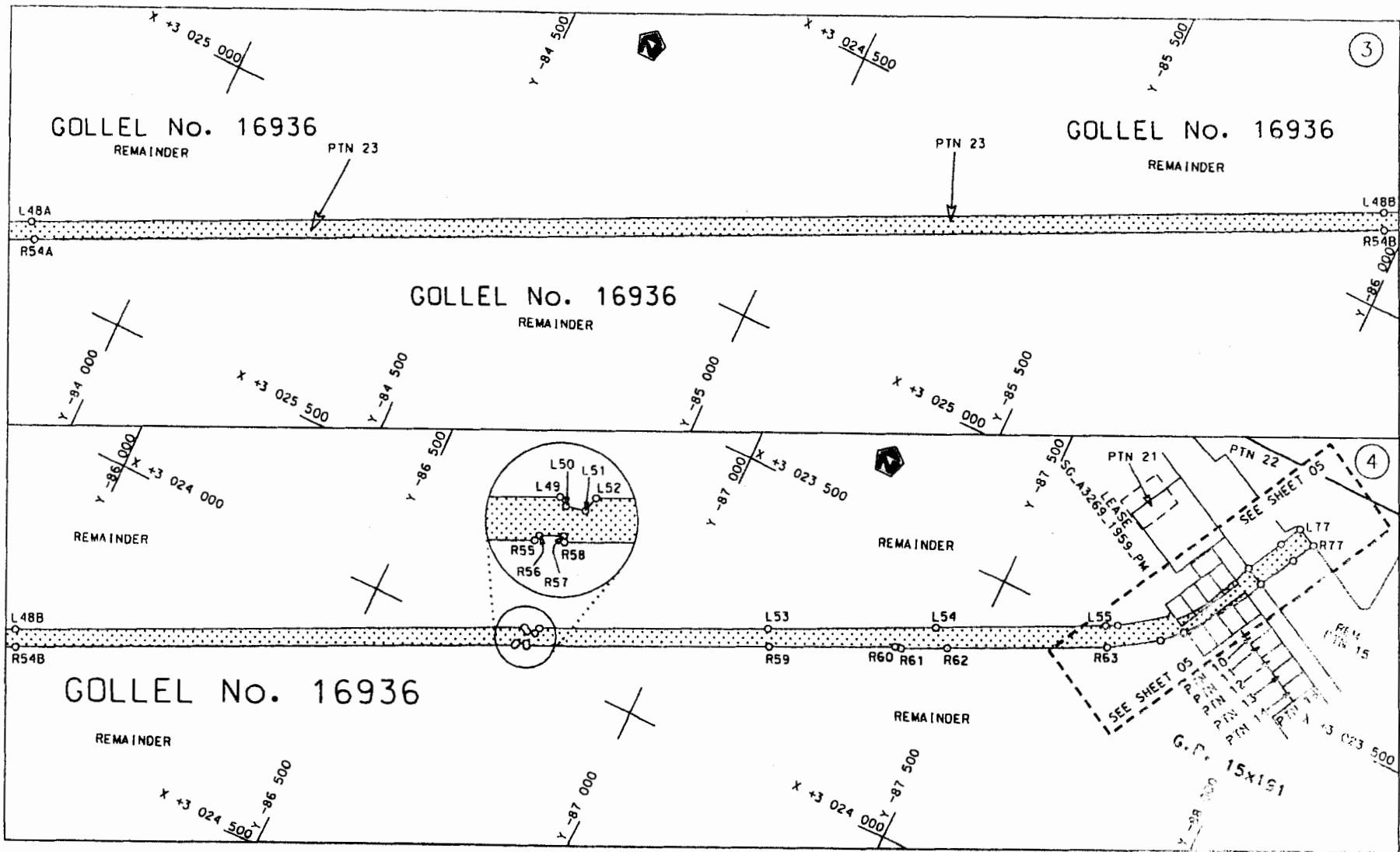

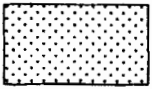
<p>Die Suid Afrikaanse Nasionale Padogentskop Beperk The South African National Roads Agency Limited</p>	<p>Die figuur getoon The figure shown</p> 	<p>steldie padreserwe voor van 'n gedeelte represents the road reserve of a portion von Nasionale Roete P720 Seksie of National Route P720 Section</p>	<p>Vel Sheet 2 van of 5</p> <p>Plan P6327</p>
--	---	--	---

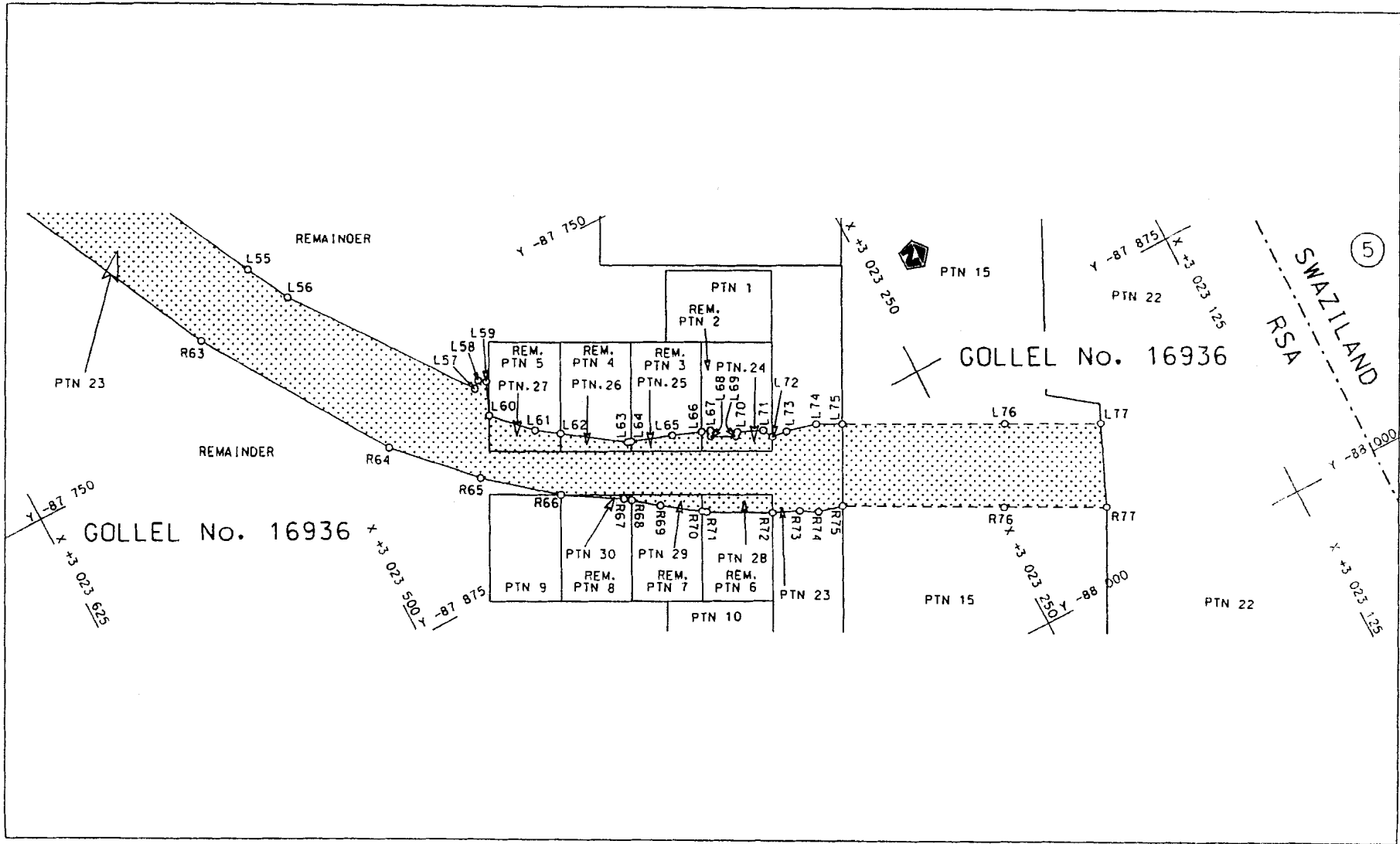

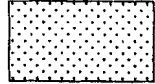
<p>Die Suid Afrikaanse Nasionale Padogenskap Beperk The South African National Roads Agency Limited</p>	<p>Die figuur getoon The figure shown</p> 	<p>steldie padreserwe voor van 'n gedeelte represents the road reserve of a portion van Nasionale Roete P720 Seksie of National Route P720 Section</p>	<p>Vel Sheet 3 van 5 Plan P632/07</p>
---	---	--	---

D.O.9.A

PADRESERWE KOÖRDINATE				ROAD RESERVE CO-ORDINATES		
LINKERKANT/LEFT HAND SIDE				REGTERKANT/RIGHT HAND SIDE		
	Y	X	WG 31°		Y	X
L1	-80 727.454	3 029 070.398		R1	-80 741.238	3 029 107.917
L2	-80 866.518	3 029 044.322		R2	-80 872.075	3 029 083.384
L3	-80 964.552	3 029 023.406		R3	-81 019.183	3 029 042.753
L4	-81 058.363	3 028 990.449		R4	-81 089.026	3 029 014.372
L5	-81 144.462	3 028 940.330		R5	-81 159.375	3 028 971.733
L6	-81 210.110	3 028 882.210		R6	-81 217.980	3 028 922.761
L7	-81 342.752	3 028 725.305		R7	-81 251.477	3 028 894.770
L8	-81 529.722	3 028 484.848		R8	-81 277.386	3 028 868.348
L9	-81 576.966	3 028 423.881		R9	-81 304.152	3 028 835.920
L10	-81 624.211	3 028 362.914		R10	-81 465.913	3 028 627.788
L11	-81 663.490	3 028 307.033		R11	-81 652.615	3 028 387.430
L12	-81 694.145	3 028 250.431		R12	-81 690.398	3 028 331.079
L13	-81 731.533	3 028 144.236		R13	-81 727.998	3 028 263.125
L14	-81 745.964	3 028 091.905		R14	-81 736.803	3 028 244.147
L15	-81 760.396	3 028 039.573		R15	-81 757.840	3 028 198.654
L16	-81 802.644	3 027 951.813		R16	-81 771.222	3 028 132.236
L17	-81 851.533	3 027 887.609		R17	-81 785.367	3 028 080.207
L18	-81 946.077	3 027 789.740		R18	-81 806.358	3 028 021.756
L19	-81 996.221	3 027 676.662		R19	-81 835.932	3 027 970.256
L20	-82 016.105	3 027 596.933		R20	-81 870.091	3 027 928.565
L21	-82 035.989	3 027 517.203		R21	-81 935.475	3 027 860.211
L22	-82 067.636	3 027 434.489		R22	-81 983.505	3 027 799.269
L23	-82 077.524	3 027 414.139		R23	-82 018.950	3 027 725.758
L24	-82 106.024	3 027 354.310		R24	-82 033.618	3 027 675.815
L25	-82 161.150	3 027 288.074		R25	-82 054.480	3 027 579.592
L26	-82 232.843	3 027 206.807		R26	-82 079.255	3 027 492.858
L27	-82 260.996	3 027 175.017		R27	-82 105.311	3 027 436.127
L28	-82 397.519	3 027 020.133		R28	-82 173.149	3 027 331.535
L29	-82 454.776	3 026 944.061		R29	-82 322.079	3 027 173.651
L30	-82 488.720	3 026 881.601		R30	-82 327.602	3 027 164.144
L31	-82 516.593	3 026 810.639		R31	-82 389.180	3 027 086.169
L32	-82 529.025	3 026 765.905		R32	-82 425.239	3 027 045.166
L33	-82 571.365	3 026 588.325		R33	-82 485.997	3 026 964.208
L34	-82 592.719	3 026 514.838		R34	-82 525.233	3 026 898.068
L35	-82 610.772	3 026 463.550		R35	-82 552.110	3 026 822.331
L36	-82 631.677	3 026 419.660		R36	-82 565.577	3 026 774.591
L37	-82 672.986	3 026 346.407		R37	-82 589.696	3 026 672.519
L38	-82 687.962	3 026 323.763		R38	-82 607.738	3 026 596.741
L39	-82 762.658	3 026 233.915		R39	-82 625.566	3 026 535.392
L40	-82 824.431	3 026 168.073		R40	-82 639.768	3 026 494.920
L41	-82 958.732	3 026 024.994		R41	-82 654.987	3 026 458.359
L42	-83 168.306	3 025 803.344		R42	-82 690.009	3 026 393.163
L43	-83 224.570	3 025 743.231		R43	-82 730.259	3 026 332.972
L44	-83 275.549	3 025 693.402		R44	-82 788.334	3 026 261.285
L45	-83 305.403	3 025 667.973		R45	-82 881.833	3 026 161.687
L46	-83 399.020	3 025 597.570		R46	-82 985.611	3 026 050.993
L47	-83 494.810	3 025 543.940		R47	-83 066.159	3 025 965.798
L48	-83 554.390	3 025 515.960		R48	-83 100.754	3 025 928.918
L49	-86 766.280	3 023 946.040		R49	-83 190.712	3 025 831.257
L50	-86 772.930	3 023 950.210		R50	-83 249.660	3 025 768.734
L51	-86 787.040	3 023 947.120		R51	-83 314.489	3 025 707.851

Vel	4	Van	5	P632/07
Sheet		of		

PADRESERWE KOÖRDINATE				ROAD RESERVE CO-ORDINATES			
LINKERKANT/LEFT HAND SIDE				REGTERKANT/RIGHT HAND SIDE			
	Y	X	WG 31°		Y	X	
L52	-86 789.950	3 023 935.760		R52	-83 417.080	3 025 628.580	
L53	-87 157.370	3 023 759.100		R53	-83 510.690	3 025 575.670	
L54	-87 426.018	3 023 626.194		R54	-83 564.680	3 025 545.140	
L55	-87 696.870	3 023 492.110		R55	-86 763.130	3 023 981.940	
L56	-87 715.970	3 023 482.110		R56	-86 764.600	3 023 977.390	
L57	-87 790.430	3 023 427.220		R57	-86 780.560	3 023 970.080	
L58	-87 787.880	3 023 424.110		R58	-86 782.810	3 023 974.070	
L59	-87 789.980	3 023 421.110		R59	-87 172.610	3 023 786.050	
L60	-87 803.630	3 023 427.010		R60	-87 375.470	3 023 688.100	
L61	-87 818.580	3 023 412.110		R61	-87 385.870	3 023 686.100	
L62	-87 825.160	3 023 402.750		R62	-87 459.340	3 023 650.080	
L63	-87 842.470	3 023 378.110		R63	-87 715.090	3 023 525.070	
L64	-87 843.010	3 023 376.570		R64	-87 795.200	3 023 473.110	
L65	-87 849.080	3 023 359.110		R65	-87 825.780	3 023 443.110	
L66	-87 853.750	3 023 346.670		R66	-87 848.840	3 023 415.150	
L67	-87 855.140	3 023 342.970		R67	-87 863.480	3 023 391.110	
L68	-87 857.580	3 023 344.110		R68	-87 865.590	3 023 388.390	
L69	-87 862.680	3 023 334.110		R69	-87 873.580	3 023 378.110	
L70	-87 861.280	3 023 332.510		R70	-87 884.630	3 023 362.830	
L71	-87 866.080	3 023 322.110		R71	-87 885.880	3 023 361.110	
L72	-87 870.410	3 023 319.860		R72	-87 899.910	3 023 335.310	
L73	-87 871.280	3 023 313.110		R73	-87 904.780	3 023 324.110	
L74	-87 874.480	3 023 300.110		R74	-87 909.080	3 023 317.110	
L75	-87 879.870	3 023 289.820		R75	-87 911.660	3 023 306.440	
L76	-87 913.360	3 023 225.980		R76	-87 945.330	3 023 243.370	
L77	-87 933.071	3 023 188.406		R77	-87 966.787	3 023 203.177	

Vel 5 Sheet	5	Van	5	of P632/07
----------------	---	-----	---	---------------